

# Topological derivation of Black Hole entropy by analogy with a chain polymer

Masaru Siino<sup>1</sup>

*Department of Physics, Tokyo Institute of Technology,  
Oh-Okayama, Meguro-ku, Tokyo 152-, Japan*

## Abstract

The spatial topology of an event horizon is related to the crease set of the event horizon. Furthermore, the catastrophe theory tells that a generic event horizon has not a point-wise crease set (implying spherical black hole) but one with dimensions (providing non-trivial topology of the event horizon) under small non-spherical perturbations, while a spherically symmetric black hole spacetime is dynamically stable. This means a generic almost spherical black hole has a very crumpled crease set in a microscopic scale though the crease set is similar to a point-wise crease set in a macroscopic scale. In the present article, we count the number of such micro-states of an almost spherical black hole by analogy with an elastic chain polymer. This estimation of a black hole entropy reproduces the well known Bekenstein-Hawking entropy of a Schwarzschild black hole.

## 1 Introduction: A topological viewpoint of Event Horizon

One of the most remarkable aspects of the Black Hole entropy[1] is that it is not proportional to the volume of a black hole but to the area of its event horizon, while an entropy is an extensive variable in statistical mechanics.

From one point of view, this is realized that the entropy is not of the black hole but of the event horizon which is the boundary of the black hole region. In this sense, some author have been derived the black hole entropy by relating it to the degrees of freedom only on the event horizon, e.g., quantum geometry[2] or a technique in the context of ADS/CFT correspondence[3], and others discuss the statistical meaning of the boundary in the context of entanglement[4]. Furthermore, the technique of Euclidean path integral[5] is also on this standpoint as the relevant contribution to the black hole entropy comes from a boundary integration at the event horizon.

On the other hand, a recently developed technique of D-brane to derive the black hole entropy seems to be related to the whole of the black hole spacetime in itself[6], though it is not fully clear what is estimated by it. In this sense, it may be valid to regard the black hole entropy as the entropy of the black hole region, after all.

---

<sup>1</sup>E-mail:msiino@th.phys.titech.ac.jp

If the black hole entropy is really of the black hole region, we will need a reason why it is proportional to the area of the event horizon. In this article, we try to estimate an entropy which have been contained into a black hole region during the black hole formation, in a topological sense. Then we would show that the black hole entropy which is proportional to the area of the event horizon can be derived without being directly related to the area of the event horizon. Moreover, this entropy would be able to be regarded as the count of the ways to form a final black hole and interpreted from the view point of the black hole region.

When we concentrate on the topological feature of an event horizon, it can be reduced to the structure of the crease set of the event horizon[7]. On the crease set, two or more generators of the event horizon cross and the event horizon is not smooth[8]. Furthermore the catastrophe theory[9][10][11] tells that the generic structure of the crease set is composed of not a point related to a spherical black hole but two-dimensional sets and their bifurcations. By an appropriate timeslice, this two-dimensional crease set provides a toroidal event horizon. Hence, in this sense, the spherical topology of event horizon is structurally unstable.

Here it should be noted that these facts do not mean that a black hole and its crease set are always highly anisotropic. Since the catastrophe theory implies that the spherical topology changes under the small perturbation in a corresponding microscopic scale, the anisotropy would be very small in some cases. For example, when almost spherically symmetric matter collapses to an almost spherical black hole, in microscopic scale its crease set will be highly distorted and bifurcated, and its event horizon will be with very complicated topology, while in a macroscopic scale the crease set can be treated as a point and the event horizon is with a spherical topology.

These aspects make us expect that the crease set possesses a micro-canonical entropy. In the present article, we estimate the entropy of the crease set by analogy with a chain polymer, since the one-dimensional crease set possesses similar structure to the chain polymer (and two-dimensional one will be similar in statistics). Assuming that a multiply folded crease set changes its form like the chain polymer, we can estimate the entropy of the crease set. Then we are going to interpret this entropy as the entropy of falling matters. We will have gotten an entropy coincident with the Bekenstein-Hawking entropy.

In the next section, we recall the way to calculate the entropy of a chain polymer in a simple Ising model. The third section shows how to estimate the entropy associated with a considering black hole from such a topological view point. The final section is devoted to summary, discussions and speculations.

## 2 Entropy of Chain Polymer

In this section, we recall a simple Ising model of elasticity of a chain polymer[12]. Suppose a large number  $N$  of monomers with a length  $a$  form a chain polymer with a total length

$Na$ . Nevertheless, this polymer would be folded into an appropriate length  $l < Na$ . To give a simple model of folding it, we suppose that each element of the monomers can be directed only to the right or the left in equal probabilities, for example as shown in figure 1.

In micro-canonical statistics, the length  $l$  should be a parameter describing a state of the system. The number of allowed configurations  $W(l)$  is given by

$$W = \frac{2N!}{N_{\rightarrow}!N_{\leftarrow}!} = \frac{2N!}{(\frac{1}{2}N - l/a)!(\frac{1}{2}N + l/a)!}, \quad (1)$$

where  $N_{\rightarrow}$  and  $N_{\leftarrow}$  are the number of right- and left-directed elements, respectively. Then, using the Stirling formula  $\log N! \simeq N \log N - N$ , the entropy of this polymer becomes

$$S = \log W \simeq N \log N - (\frac{1}{2}N - l/a) \log(\frac{1}{2}N - l/a) - (\frac{1}{2}N + l/a) \log(\frac{1}{2}N + l/a). \quad (2)$$

Under the assumption that the length  $l$  is much smaller than  $Na$ , this is approximated as

$$S(l) = N \log 2 - \frac{l^2}{2Na^2} + O(N \cdot (l/Na)^4) \quad (3)$$

$$= S(l=0) - \frac{l^2}{2Na^2} + O(N \cdot (l/Na)^4), \quad (4)$$

where we use  $\log(1+x) = x - x^2/2 + \dots$ , ( $x \sim l/Na \ll 1$ ).

This gives a simple model of elasticity. Indeed, from the first law of thermodynamics  $TdS = dU - fdl$ , an elastic force  $f$  obeys well known Hooke's law in the leading order as

$$f = T \left( \frac{\partial S}{\partial l} \right)_U = -\frac{Tl}{Na^2}, \quad (5)$$

where  $T$  and  $U$  are the temperature and the internal energy. The force is proportional to the temperature  $T$ . Actually, a rubber band contracts when it is warmed up, while an iron wire expands.

### 3 Black Hole Entropy

Now we will estimate an entropy associated with the crease set of an event horizon. On the crease set, two or more generators of the event horizon cross. The closure of the crease set is the set of the endpoint of the event horizon generators, and the event horizon is indifferentiable there[7][8]. From Ref.[7], the spatial topology of an event horizon in a timeslicing is determined only by the timeslicing of the crease set. This implies that the crease set possesses all of the topological information of the black hole. In other words, an event horizon is completely determined if once we know the crease set and all of the light rays starting from the crease set, since the event horizon should be their envelope. Hence we expect that the crease set gives all of the global information about the event horizon

while the light rays can be determined only by a local geometry. In this section, we try to estimate the entropy associated with that global information carried by the crease set of the event horizon.

In our point of view, the entropy of the crease set is brought by falling bodies when they fall beyond the event horizon of a black hole. Since the crease set is the multiple point of the generator of the event horizon, its own structure will be changed provided that a falling body affects a congruence of the generators of the event horizon when the falling body crosses it. Then both of the topology of the event horizon and the structure of the crease set reflect some information included in the configuration of matter outside of the black hole. If we suppose that the topology of a black hole finally settles to a single spherical one after all outside matter has fallen into the black hole, this information of the topology of the event horizon turns out to be absorbed into the black hole. Therefore we expect this information corresponds to the black hole entropy and try to estimate the entropy of the crease set.

To consider the degeneracy of the crease set, one might assign the degrees of freedom to each Planckian scale segment of the crease set as the simplest model. The crease set, however, can be two-, one- or zero-dimensional. Each fundamental element becomes Planckian area or length or vanishes, respectively. For example, the entropy of a one-dimensional crease set with a length  $L$  will intuitively be estimated as  $S = \log W = \log(C^{L/l_{pl}})$ , where  $C$  is the number of possible states for each fundamental element. This is not what we have expected since  $L$  could not be proportional to the area of the event horizon in the case of the one-dimensional crease set.

On the contrary, on the analogy of a chain polymer, we will derive an entropy of the crease set proportional to the area of the event horizon in the following. To determine an entropy, we count the logarithm of the micro-state degeneracy. Though there may be various models of the micro-state, in the present article we apply the following very simple Ising model similar to the chain polymer.

First, we consider only the case of one-dimensional crease set for simplicity since the case of two-dimensional crease set will be different only by a factor in their entropy. On the other hand, from the catastrophe theory it is concluded that the point-wise crease set is not generic[9][10][11]. This implies that even for an almost spherically symmetric collapsing of matter, the matter and spacetime are not rigorously spherically symmetric ‘in a microscopic scale’ because of an anisotropic small perturbation. This will cause a highly folded crease set, which is confined within a very small region. Then it is not point-wise in a microscopic scale but in a macroscopic scale (see the bottom-left of figure 2).

There should be many ways to fold and confine the crease set. Considering a number of ideal small fundamental elements of the crease set to fold, this situation is very similar to the chain polymer discussed in the previous section (compare figure 1 and figure 2). Then we will count the number of them and estimate a related entropy, by the analogy with the chain polymer.

In the case of the chain polymer, its entropy  $S_{CP}$  is given by (4) and we think that the entropy of the crease set  $S_C$  is same as  $S_{CP}$ ;

$$S_C(l) = S_{CP}(l) = S_{CP}(0) - \frac{l^2}{2Na^2}, \quad (6)$$

where  $l$  is the length of the crease set.  $N$  and  $a$  are the number and length of the ideal fundamental element, respectively.

In our discussion, the state with  $l = 0$  (the left branch of figure 2) is regarded as an almost spherically symmetric black hole, since this state is macroscopically similar to a spherical black hole with a zero-dimensional (point-wise) crease set. On the other hand, to make the black hole most anisotropic, collapsing matter must be most tilted in a special direction and this configuration will not allow the degeneration of the micro-state. Nevertheless, the black hole would not be allowed to take such an arbitrary tilted configurations; rather, it is natural that there is an upper bound  $l_{max}$  for  $l$  since a black hole with infinitely large  $l$  seems to be unphysical. Then if we have an upper bound  $l_{max}$  (the right branch of figure 2), it will be valid to regard  $S(l_{max})$  as the zero-point of the entropy of the black hole. Therefore the entropy of an almost spherical black hole is given by

$$S_{BH}(l = 0) \equiv S_C(l = 0) - S_C(l_{max}) = \frac{l_{max}^2}{2Na^2}. \quad (7)$$

We may expect that the upper bound  $l_{max}$  is about a final black hole mass  $M$ , since it is the only reasonable scale in a gravitational dust collapse. Furthermore, the hoop conjecture[13] requires the length of the crease set should be bounded by  $2\pi M$ [14]. Hence we assume  $l_{max} \simeq 2\pi M$ . In addition to it, we should assume  $l_{max}/a \ll N$  in order to derive eqn.(4) in the previous section. The consistency and validity of this condition will be discussed later. Hence we observe that this entropy proportional to the area of the event horizon  $\mathcal{A} \propto \mathcal{M}^\epsilon$ .

By the way, eqn.(7) has an unpreferable factor  $a^2/N$ . Expecting that this entropy coincides to the Bekenstein-Hawking entropy,  $Na^2$  should be on a scale of  $l_{pl}^2$ . This turns out that  $a$  is  $\frac{l_{pl}}{\sqrt{N}} \ll l_{pl}$  as  $N$  is a very large number. Since it is unreasonable to give a much smaller structure than Planckian length to quantum spacetime, we cannot accept such a small  $a$ .

This problem of the scale of a small segment is resolved by considering the branches of the crease set. As pointed out in [9][11], there are possibilities that the crease set is branched at a hinge where the crease set can angle. We assume that a new branch (child chain) with a length  $\alpha l$  ( $\alpha < 1$ , since a child should be smaller than its mother by definition) comes up at some hinges in a probability  $\beta$  (see also figure 3) and is composed of  $N$  elements, which will be justified later. The number of such a branch is given by the probability and the number of mother's hinges as  $\beta N$ .

Moreover there are also grandchildren and further descendants. Naively, the number of  $n$ -th descendants might be considered to be  $(\beta N)^n$  in geometrical progression. However

this is not realistic because we require infinite volume to embed all the family of geometrical progression  $\Sigma_i^\infty (\beta N)^i$ . Since the territory of a child and his all descendants would be limited around each of  $N$  hinges of the mother chain, we assume that the number of  $n$ -th descendants is  $\beta^n N$  rather than  $(\beta N)^n$ . By this assumption, the total length of the family becomes  $N \Sigma_i^\infty \alpha^i \beta^i l$  and will converge so as to be embedded, as the  $n$ -th descendant is with a length  $\alpha^n l$ . Then the total number of degenerated micro-states is given by

$$W_{tot} = W(l) \cdot W(\alpha l)^{N\beta} \cdot W(\alpha^2 l)^{N\beta^2} \dots, \quad (8)$$

where  $n$ -th factor is the contribution of all  $(n-1)$ -th descendants. The entropy of a crease set (7) is changed by a factor and now we are not worried about the factor  $1/N$  any more: the total entropy is

$$\begin{aligned} S_{Ctot} = \log W_{tot} &= S_0 - \frac{l^2}{2Na^2} - \frac{(\alpha l)^2}{2Na^2} N\beta - \frac{(\alpha^2 l)^2}{2Na^2} N\beta^2 - \dots + O(l^4) \\ &= S_0 - \frac{l^2}{2a^2} \left( \frac{1}{N} + \alpha^2 \beta + \alpha^4 \beta^2 + \dots + \alpha^{2n} \beta^n + \dots \right) + O(l^4) \\ &\sim S_0 - \frac{\alpha^2 \beta}{1 - \alpha^2 \beta} \frac{l^2}{2a^2}, \\ S_{BH} &= \frac{\alpha^2 \beta}{1 - \alpha^2 \beta} \frac{l_{max}^2}{2a^2} \end{aligned}$$

where  $S_0$  is the sum of all  $l$ -independent terms. On the third line, it is supposed that  $N$  is sufficiently large. Though the infinite sum might have any cut off, it would change the result only by a numerical factor of the order of magnitude of one.

If we rigorously require  $S = \mathcal{A}/4l_{pl}^2 = \pi M^2/l_{pl}^2$ , the relation

$$\begin{aligned} \frac{4\pi^2 M^2}{2l_{pl}^2} \frac{\alpha^2 \beta}{1 - \alpha^2 \beta} &= \frac{\pi M^2}{l_{pl}^2} \\ \frac{\alpha^2 \beta}{1 - \alpha^2 \beta} &= \frac{1}{2\pi}, \end{aligned}$$

will determine  $\alpha^2 \beta$ , since hoop conjecture say  $l_{max} \sim 2\pi M$  and  $a$  should naturally be  $l_{pl}$ .

Now we must discuss the case of a non-chain-like crease set. Indeed, Refs [10][9][11][15] tell us that it is important to consider a crease set with two dimensions. The discussion of a two-dimensional crease set can be proceeded with, as following. Intuitively, the two-dimensional crease set has two independent degrees of freedom to fold. This will cause the state counting to become the square of that of an one-dimensional crease set and its entropy to be two times. For further accurate estimation, it might be valid to discuss in the theory of random surface. In the case of the random surface, the regular term of its entropy around  $l = 0$  is also proportional to  $l^2$ [16]. Then the elastic force is always proportional to the amount of its deformation (see eqn.(5)) independently of its form, size and dimensions. This is consistent with the general Hooke's law, i.e. a stress tensor is proportional to a distortion tensor.

So we summary the estimation as

$$S_{BH} = F(n)G(\alpha^2\beta)\frac{\mathcal{A}}{4l_{pl}^2}, \quad (9)$$

where  $F(n)$  and  $G(\alpha^2\beta)$  are numerical factors of the order of magnitude of one related to the dimensions and branching of the crease set, respectively.

Finally, we discuss the assumptions we have made above. Here we should discuss the meaning of  $N$  and the validity of the assumptions about the amount of it. In the present estimation we have supposed that the number of mother's elements  $N$  is a fixed large number when the collapsing changes  $l$  between extremely anisotropic collapse  $l = l_{max}$  and almost spherical collapse  $l = 0$ , and  $0 < l/a < l_{max}/a$  is much less than  $N$ .

One may be doubtful that these assumption is consistent to physical situation. To make clear this point, we consider the relation between  $N$  and the falling bodies as following and illustrated in figure 2. We think an ideal process in which some small elements with a volume  $l_{pl}^3$  and a mass  $m$  fall into a black hole. The top of figure 2 illustrates that a falling body gravitationally deforms a generator of the event horizon, and consequently the crease set will form a hinge and be angled there. If many bodies randomly fall into the black hole (see the left branch of figure 2), the crease set will be repeatedly angled in various directions and finally confined into a small region. Therefore we guess that almost spherical collapse can occur through such a random falling process of a large number of small bodies. On the other hand, if the small bodies are not random but ordered to be anisotropic in a special direction (the right branch of figure 2), the crease set will be more spread and the anisotropic black hole is once formed. Then the entropy of the crease set is related to that randomness of falling bodies. To determine  $N$ , it will be valid to relate the number of the hinges of the crease set and the falling ideal volume elements with a volume  $l_{pl}^3$ , into which the collapsing matter could be decomposed.

In a simple-mind, we regard the number of the collapsing ideal volume elements as the number of the hinges of the mother chain  $N$ . The consistent interpretation of the child and descendant chain is following (and see figure 3). The mother chain is angled by a falling body directly when the body crosses event horizon generators and there comes up a child chain (dotted arrows) in a probability  $\beta$ . Besides, this child chain is also affected by another falling volume element through three point interaction (one body making the child chain, another body and one event horizon generator) since gravitation is long range force. Therefore we consider that the hinges of the child chain are formed by this three point interaction. Then the hinges of the child chain are assigned to the two falling volume elements (indicated by waving lines in Fig.3), one of which have made the child chain. Hence the child chain possesses  $N$  hinges. Similarly, a  $n$ -th descendant chain also forms  $\sim N$  hinges under the influences of  $(n + 1)$  different elements. This consistently gives an explanation to the formation and number of the hinges of the descendant chain.

Now we consider the number of elements  $N \sim M/m$ , inheriting the number of falling volume elements  $l_{pl}^3$  with a mass  $m$ . The mass  $m$  of the volume element should be much

smaller than Planckian mass so that it will not be a black hole but an ordinary matter. Then we have following inequalities,

$$N \sim \frac{M}{m} \gg \frac{M}{l_{pl}} \sim \frac{l_{max}}{l_{pl} = a} > \frac{l}{a}. \quad (10)$$

Therefore we have confirmed all parameters are in a realistic range and the assumptions are consistent.

The picture illustrated in figure 2 might be something kinematical while the process we think of is dynamical. Nevertheless, this will put an interpretation that this black hole entropy reflects the number of the ways to form an almost spherical black hole.

## 4 Summary, Discussions and Speculations

In the present article, we have demonstrated that the Bekenstein-Hawking entropy of the Schwarzschild black hole can be derived independently of the area of the event horizon as the entropy of its crease set. This put an interpretation on the black hole entropy, i.e. it carries topological information of the collapsing matter corresponding to the configuration of the falling volume elements in spacetime.

We have considered only Schwarzschild black hole as a final state of gravitational collapse. One may feel that it is important to extending the result to a rotating black hole. At present, however, we cannot imagine what shape of an event horizon is appropriate to compare with the Kerr black hole, as a zero of the entropy. A discussion of a chain polymer also should be changed. To discuss these problems, we should relate the angular momentum to any character of the crease set, as the mass of black hole have been related to the maximum length  $l_{max}$  of the crease set.

Moreover we would like to comment on the identity of the entropy estimated in the present article. As discussed in the end of the previous section, the entropy is related to the falling bodies. To be concrete, the entropy measures the disorder of the position and velocity of the falling bodies. Of course, this is not all of the entropy that falling bodies carry. In other words, the black hole entropy could be directly related to only the entropy of this disorder. The entropy is the logarithm of the number of the possible configurations of falling matter to form a final Schwarzschild black hole, if we can decompose the falling matter into ideal small volume elements  $l_{pl}^3$  with mass  $m \ll m_{pl}$  and omit the process that tilted black holes settle to a Schwarzschild black hole radiating gravitational waves.

Finally, we estimate the upper bound of a thermal elastic force of the crease set. Substituting the Hawking temperature  $T_H \sim 1/M$  into  $f = -T\partial S/\partial l (l = l_{max})$ , we observe  $f \sim 1/a^2$  is independent of  $M$ . Though its realistic meaning is not clear, this aspect coincides with the fact that the brokenness of Hooke's law occurs independently of the scale or form of the elastic body. Here we speculate that this coincidence implies the validity of the present developments (especially, the assumption  $l_{max} \sim 2\pi M$  from the hoop conjecture). The mechanism of the failure of a black hole formation or the naked



singularity formation, which is the result of the hoop conjecture, might be realized by analogy with the existence of such an elastic limit.

As a reader is noticed, the present estimation does not work in different spacetime dimensions. It is because of the absence of the hoop conjecture in the other spacetime dimensions. In turn, this fact might be able to speculate new conjectures in other spacetime dimensions if we require that this estimation reproduce the Bekenstein-Hawking entropy also in other spacetime dimensions.

## Acknowledgments

This work is based on another research with Dr. Koike. The author thanks to Prof. R. M. Wald for his helpful discussion.

## References

- [1] J. D. Bekenstein, *Lett. Nuovo Cimento* **11**467 (1974)
- [2] I. B. Khriplovich, K. Krasnov *Phys. Rev.* **D** 3505 (1997), A. Ashtekar, J. Baez, A. Corichi and K. Krasnov, *Phys. Rev. Lett.* **80** 904 (1998)
- [3] A. Strominger *JETP* **9802** 009 (1998), S. Carlip *Class. Quant. Grav.* **16** 3327 (1999)
- [4] L. Bombelli, R. K. Koul, J. Lee and R. D. Sorkin *Phys. Rev.* **D34** 373 (1986), M. Srednicki *Phys. Rev. Lett.* **71** 666 (1993), S. Mukohyama, M. Seriu and H. Kodama *Phys. Rev.* **D58** 064001 (1998)
- [5] G. Horowitz, S. Hawking and S. Ross *Phys. Rev.* **D51** 4302 (1995)
- [6] A. Strominger and C. Vafa *Phys. Lett.* **B379** 99 (1996)
- [7] M. Siino *Phys. Rev.* **D58** 104016 (1998)
- [8] Beem and Królak, gr-qc/9709046
- [9] T. Koike and M. Siino, in preparation
- [10] M. Siino *Phys. Rev.* **D59** 064006 (1999)
- [11] V.I. Arnold in *Dynamical systems VIII, Encyclopedia of Mathematical Science Vol. 39* Springer-Verlag, Chap 2, Sec. 3
- [12] H. M. Japmes and E. Guth, *J. Chem. Phys.* **11** 455 (1943), *J. Polymer Sci.* **iv** 153 (1949)  
R. Kubo, *J. Phys. Soc. Japan* **2** 47-,51-,84- (1947)

- [13] K. Thorne in *Magic Without Magic : John Archibald Wheeler* edited by J. Klauder (Freeman, San Francisco 1972) p231
- [14] D. Ida, K. Nakao, M. Siino and S. Hayward *Phys. Rev.* **D58** 121501 (1998)
- [15] S. L. Shapiro, S. A. Teukolsky and J. Winicour *Phys. Rev.* **D52** 6982 (1995)
- [16] A. B. Zamolodchikov *Phys. Lett.* **117B** 87 (1982)

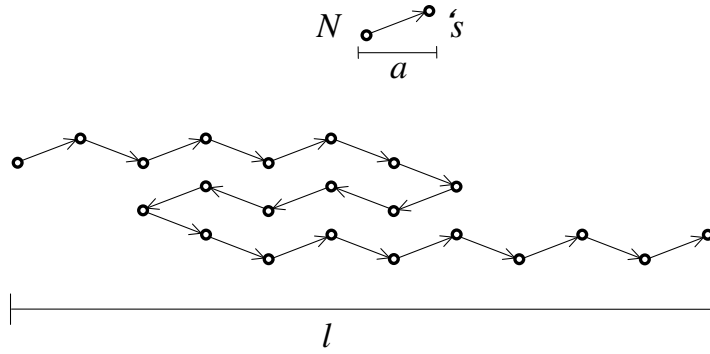

Figure 1: A simple Ising model of the elasticity of a chain polymer is exemplified. A chain polymer is composed of  $N$  monomers with a length  $a$ . Each monomer can be directed only to the left or the right. Though the maximum length of the chain should be  $Na$ , the highly folded chain is with a length  $l \ll Na$ .

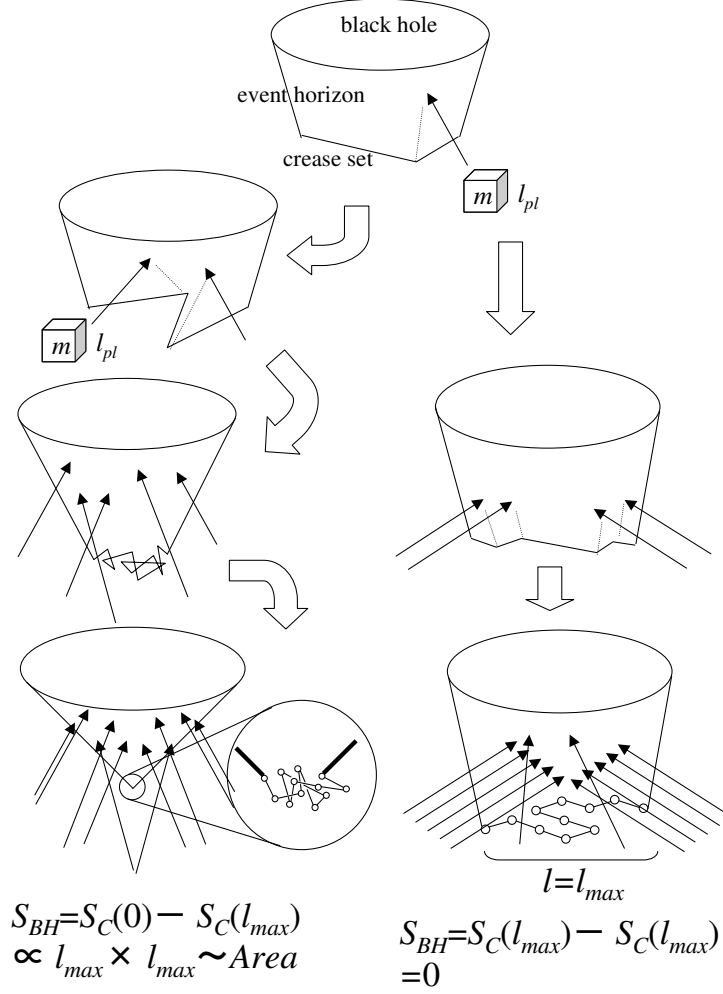

Figure 2: Two types of black hole formation are illustrated. The left branch is an almost spherically symmetric collapse. A small volume element  $l_{pl}^3$  with a mass  $m$  affects a generator of the event horizon when it fall into the black hole. As illustrated on the top, this effect cause the bending of the crease set of the event horizon. If many small bodies fall into the black hole from random directions at random time, the crease set is bent many times in various directions and confined in a small region. The resultant black hole seems almost spherically symmetric in macroscopic scale. On the other hand, the right branch is an extremely anisotropic collapse. Since many of the falling bodies are ordered to be from a special direction, the bending effect will not make the crease set so small.

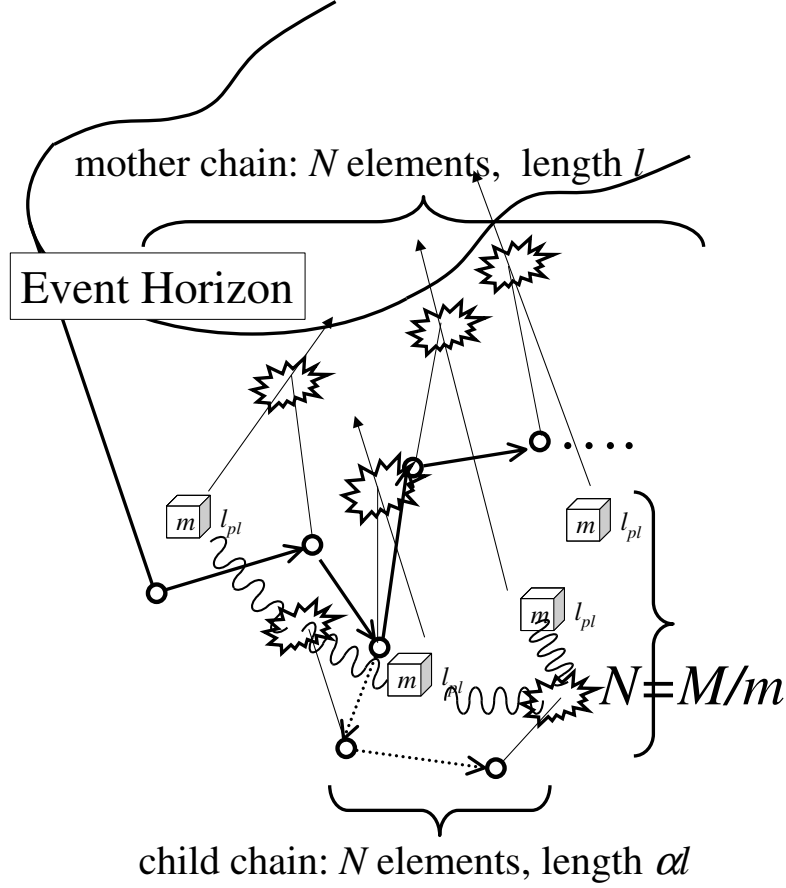

Figure 3: The number of the hinges of the mother chain is  $N$ , since the number of falling volume elements is  $N = M(\text{total mass})/m(\text{a mass of a volume})$ . Bold (dotted) arrows are the segments of the crease set forming the mother (child) chain. A child chain comes up from the hinge of the mother chain in a probability  $\beta$ . Each small volume element of matter fall into the black hole along arrows directed above. They cross the event horizon and affect its generators (narrow vertical line) at exploding symbols. On the other hand, three point interactions affect the generators along wavy lines. The child chain forms  $N$  hinges by these three point interactions.