

# PersonaKit (PK): A Plug-and-Play Platform for User Testing Diverse Roles in Full-Duplex Dialogue

**Hyunbae Jeon**

Department of Computer Science  
Emory University  
Atlanta, GA, USA  
harry.jeon@emory.edu

**Jinho D. Choi**

Department of Computer Science  
Emory University  
Atlanta, GA, USA  
jinho.choi@emory.edu

## Abstract

As spoken dialogue systems expand beyond traditional assistant roles to encompass diverse personas—such as authoritative instructors, uncooperative merchants, or distracted workers—they require distinct, human-like turn-taking behaviors to maintain psychological immersion. However, current full-duplex systems often default to a rigid, overly accommodating “always-*yield*” policy during overlapping speech, which severely undermines character consistency for non-submissive roles. Evaluating alternative, persona-specific turn-taking strategies through empirical user studies is challenging because building real-time full-duplex test environments requires substantial engineering overhead. To address this, we present PersonaKit (PK), an open-source, low-latency web platform for the rapid prototyping and evaluation of conversational agents. Using intuitive JSON configurations, researchers can define personas, specify probabilistic interruption-handling behaviors (e.g., *yield*, *hold*, *bridge*, or *override*), and automatically deploy comparative A/B surveys. Through an in-the-wild evaluation with 8 distinct personas, we demonstrate that PersonaKit provides an extensible, end-to-end framework for studying complex sociolinguistic behaviors in next-generation spoken agents.

## 1 Introduction

The shift of spoken dialogue systems from half-duplex to full-duplex (Skantze, 2021; Ma et al., 2025) moves the frontier of immersive-agent design from text quality to *sociolinguistic behavior*: how agents manage overlapping speech. In natural conversation, turn-taking is heavily mediated by interpersonal roles and status (Sacks et al., 1974).

An authoritative military instructor handles an interruption very differently than a subservient virtual assistant (Benůš, 2011). Yet most commercial full-duplex systems default to an *always-*yield** policy, immediately ceding the floor on user speech and breaking immersion for non-submissive roles. Testing how conversational pragmatics affect user perception requires significant engineering effort across WebRTC audio, Voice Activity Detection (VAD), dynamic LLM prompt injection, and latency tracking. We developed **PersonaKit (PK)** to eliminate this bottleneck. PK contributes (i) an open-source, plug-and-play web platform for full-duplex persona evaluation, (ii) a JSON-based mechanism making persona-conditioned interruption policies first-class configurable objects, and (iii) an end-to-end workflow from live deployment through auto-generated surveys to structured log export.

## 2 Related Work

Full-duplex spoken language models (Ma et al., 2025) have magnified the need for robust turn-taking modeling (Skantze, 2021), but classic systematics (Sacks et al., 1974) remain hard to integrate into LLM-driven agents. Persona modeling, meanwhile, has a long history in dialogue (Zhang et al., 2018), yet existing evaluations are predominantly text-based, ignoring the acoustic pragmatics of dominance, yielding, and barge-in recovery. PK bridges these two threads by exposing turn-taking strategy itself as a persona parameter and providing the infrastructure to evaluate it in live voice interaction.

## 3 System Architecture

PersonaKit isolates low-latency audio engineering from experimental design: researchers interact with the platform entirely through a web dashboard and four JSON

**Code:** [github.com/HarryJeon24/PersonaStudyKit](https://github.com/HarryJeon24/PersonaStudyKit)  
**Demo:** [persona-studykit.run.app](https://persona-studykit.run.app)  
**Video:** [youtu.be/oSrmQtIM4tI](https://youtu.be/oSrmQtIM4tI)

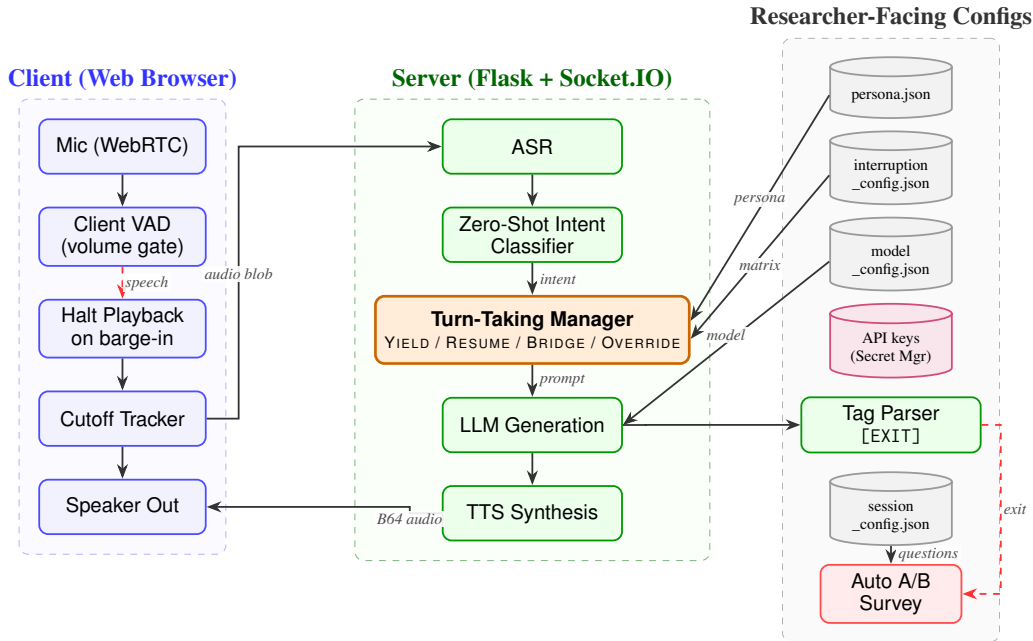

Figure 1: PersonaKit architecture. The browser performs client-side VAD and tracks the exact *cutoff text* on barge-in. The Flask server classifies the intent of the user’s interruption, then the Turn-Taking Manager selects a strategy (Yield / Resume / Bridge / Override) by reading `persona.json` and `interruption_config.json`. `model_config.json` routes generation and TTS to the chosen providers; API keys are held in a secrets store. All experimental behavior is configured through JSON—no source code is modified.

files—`persona.json` (scenario, role, opening prompt), `interruption_config.json` (strategy matrix), `session_config.json` (survey), and `model_config.json` (LLM/TTS routing). The stack is open source (Python/Flask + vanilla JS), so researchers can clone PK, run it locally, or swap in new providers.

### 3.1 Client-Side VAD and Audio Tracking

The frontend uses WebRTC for microphone capture with a client-side VAD node that halts local playback on barge-in. PK tracks byte-level playback to log the *cutoff text* (what the bot vocalized before being interrupted) and the *remaining text* it still intended to say; both return to the server so the LLM knows precisely where it was interrupted.

### 3.2 Turn-Taking as a Persona Tool

When interrupted, the server transcribes the user’s utterance and classifies its intent into four categories grounded in prior phonetic and conversation-analytic work: **Competitive** (seeks the floor to contradict or override), **Cooperative** (adds information without derailing), **Topic Change** (pivots subject), and **Backchannel** (short affirmations, not floor-taking). Researchers define a strategy matrix in `interruption_config.json` mapping these in-

tents to four actions (**Yield**, **Resume/Hold**, **Bridge**, **Override**) with probability weights—e.g., a dominant persona might weight Competitive interruptions as 50% Resume, 25% Override, 15% Bridge, 10% Yield, while a cooperative persona inverts these.

**How probabilities drive generation.** The matrix is applied *before* generation. On each interruption, the Turn-Taking Manager reads the intent, samples an action from its categorical distribution, and injects that action as a control token into the LLM’s system prompt (e.g., “[STRATEGY=RESUME]: finish your previous sentence, ignoring the user”), so the LLM generates *conditioned on* a pre-committed action. The Autonomous condition (Style C) skips sampling and lets the LLM choose its own strategy zero-shot.

### 3.3 Automated Lifecycle and Data Export

Sessions end on a `MAX_TURNS` cap or a verbal `TERMINATE` intent; the LLM emits an in-character farewell with a hidden `[EXIT]` tag that triggers the post-session survey. Each session exports the dialogue transcript, an event log with per-turn intent, strategy, and cutoff/remaining text, and all survey responses as JSON or CSV.

Quadrant	Personas
Q1: High Agency, Low Comm.	Drill Sergeant, Tavern Keeper
Q2: High Agency, High Comm.	Salesperson, Tour Guide
Q3: Low Agency, High Comm.	AI Assistant, Librarian
Q4: Low Agency, Low Comm.	DMV Clerk, Distracted Chef

Table 1: Persona catalog mapped to the Interpersonal Circumplex (Wiggins, 1979).

## 4 Pilot User Study

**Study Design.** Five participants ( $N=5$ ) completed the full study, engaging with 8 occupational personas balanced across the Interpersonal Circumplex (Table 1), yielding 120 dialogue sessions. For each persona, users experienced three randomized within-subject conditions: **Style A** (Always-Yield baseline), **Style B** (Probabilistic, JSON-tuned strategy weights), and **Style C** (Autonomous, where the LLM selects a strategy zero-shot from the persona prompt). Condition order was randomized per persona and the underlying LLM and voice were held fixed across styles.

**Evaluation Metrics.** After each persona, participants completed a comparative Likert survey on  $\{-1, 0, +1\}$  rating Reaction Naturalness (“*felt human-like and natural*”; Bartneck et al., 2009), Persona Consistency (“*remained consistent with the role*”; Gomes et al., 2013), and Interaction Fluidity (“*turn transitions felt smooth*”; Skantze, 2021), followed by a forced-choice preference item and a free-text justification. Default end-to-end barge-in latency under our OpenAI/ElevenLabs configuration was  $\sim 1-2$  s.

**Results.** Table 2 reports per-quadrant means across five completers (10 ratings per cell). Two patterns emerge. **High-agency personas (Q1)** appear to benefit from non-yielding strategies: Reaction Naturalness rises from 0.20 (Yield) to 0.60 (Probabilistic), and 60% of forced-choice votes favored Autonomous. **Low-agency, high-communion personas (Q3)** tended to favor yielding, with 70% preferring Always-Yield. Q2 preferred Probabilistic (50%), and Q4 preferred Yield (50%) yet reached its highest naturalness (0.67) under Probabilistic. Per-persona logs are released with the repository for finer-grained analysis.

**Emergent Interruption Behaviors.** Table 3 shows participant free-text feedback exported automatically. The raw logs further reveal persona-consistent behaviors that Always-Yield would

	Style	Nat.	Cons.	Flu.	Pref. (%)
<b>Q1</b>	A (Yield)	0.20	0.70	0.50	20
	B (Prob.)	<b>0.60</b>	0.60	<b>0.70</b>	20
	C (Auto.)	0.30	<b>0.70</b>	0.60	<b>60</b>
<b>Q2</b>	A (Yield)	0.50	<b>1.00</b>	<b>0.70</b>	40
	B (Prob.)	<b>0.60</b>	<b>1.00</b>	<b>0.70</b>	<b>50</b>
	C (Auto.)	0.30	0.70	0.60	10
<b>Q3</b>	A (Yield)	<b>0.50</b>	<b>1.00</b>	<b>0.90</b>	<b>70</b>
	B (Prob.)	0.30	<b>1.00</b>	0.70	10
	C (Auto.)	0.30	0.90	0.70	20
<b>Q4</b>	A (Yield)	0.50	0.80	0.60	<b>50</b>
	B (Prob.)	<b>0.67</b>	<b>0.90</b>	<b>0.70</b>	30
	C (Auto.)	0.30	0.80	0.60	20

Table 2: Mean Likert ratings on  $\{-1, 0, +1\}$  for Reaction Naturalness, Persona Consistency, and Interaction Fluidity, plus forced-choice preference (Pref. %), by Interpersonal Circumplex quadrant and interruption style ( $N=5$  completers, 2 personas per quadrant, 10 ratings per cell). Best entry per quadrant in **bold**.

P_ID	Qualitative Feedback
P1	[Drill Sergeant] “I liked how he ignored me when I interrupted him. Just like a real boot camp sometimes.”
P2	[Tavern Keeper] “Style C is not as impatient as the previous two styles.”
P3	[Tour Guide] “Since it was supposedly an enthusiastic one, B was good because it was trying to finish what it was saying.”
P4	[Tavern Keeper] “They couldn’t pick between meal and ale so I had fun with C.”

Table 3: Sample qualitative feedback auto-collected by PK’s survey engine, drawn verbatim from the exported study logs.

erase. In one Drill Sergeant session under Probabilistic, the bot’s intended line was “*Louder, recruit! I can’t hear you over your weakness! Repeat it again!*”; the user cut it off at “*Repeat it*”, leaving remaining text “*again!*”. Classified as COMPETITIVE and sampled as RESUME, the bot finished with “*...again!*”—a coherent barge-in recovery that Always-Yield would have dropped entirely.

## 5 Demonstration Scenarios

At SIGDIAL, attendees experience PK from both sides. They watch the dashboard re-route turn-taking logic by uploading a new JSON, then speak through the laptop’s microphone (or their own phone; see Figure 2) and try to interrupt a *Grumpy Tavern Keeper* (configured to hold the floor) versus a *Standard AI Assistant* (configured to yield).

Swapping between the two characters without a line of code change lets attendees directly feel how interruption policy reshapes perceived role realism even when the underlying LLM is unchanged.

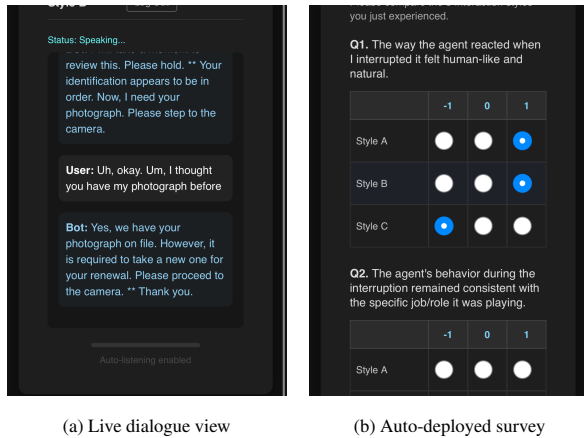

Figure 2: PersonaKit runs on both desktop and mobile. (a) The participant view shows turns from each side, persona and style labels, and live VAD status. (b) The post-session comparative survey is generated automatically from `session_config.json`.

## 6 Use Cases Beyond This Study

While our evaluation targets persona-conditioned interruption, PK is a general-purpose testbed for full-duplex dialogue research. **Persona prototyping:** researchers can iterate on the persona prompt, turn-taking matrix, and scenario in `persona.json` and immediately run a live user study—the primary workflow the tool is built for. **Custom surveys:** `session_config.json` accepts arbitrary Likert, forced-choice, and free-text banks for other constructs (e.g., trust, task success). **Model comparison:** because routing lives in `model_config.json`, LLM vendors, voices, or local open-weight models can be swapped while persona and policy are held fixed. **Data collection:** the event log pairs each interruption with its intent, sampled strategy, and follow-up utterance, a ready seed set for supervised barge-in policies or RLHF reward models.

## 7 Limitations

Our pilot ( $N=5$ ) is descriptive, not inferential; larger samples and cross-demographic replication are needed before stronger claims about circumplex-to-strategy mappings can be made. Intent classification relies on a zero-shot LLM prompt and was not independently validated against human labels, so it can mislabel ambigu-

ous back-channels under noisy acoustics. The four-action vocabulary (Yield, Resume, Bridge, Override) also excludes fine-grained prosodic cues such as pitch reset, latching, and gaze—a deliberate tradeoff favoring configurability over acoustic fidelity.

## 8 Conclusion

PersonaKit exposes turn-taking as a JSON-configurable persona parameter and automates the full study lifecycle from recruitment to export. Our pilot study ( $N=5$ ) suggests that preferred turn-taking policies may vary with persona role, illustrating PK’s usefulness as a testbed for studying such effects. PK is open source and ready for community extension.

## References

- Christoph Bartneck, Dana Kulić, Elizabeth Croft, and Susana Zoghbi. 2009. Measurement instruments for the anthropomorphism, animacy, likeability, perceived intelligence, and perceived safety of robots. *International Journal of Social Robotics*, 1(1):71–81.
- Štefan Benuš. 2011. Pragmatic aspects of temporal accommodation in turn-taking. *Journal of Pragmatics*, 43(12):3001–3027.
- Pedro Gomes, Carlos Martinho, and Ana Paiva. 2013. Metrics for character believability in interactive narrative. In *Interactive Storytelling*, pages 92–103. Springer.
- Ziyang Ma, Yakun Song, Chenpeng Du, Jian Cong, Zhuo Chen, Yuping Wang, Yuxuan Wang, and Xie Chen. 2025. Language model can listen while speaking. In *Proceedings of the AAAI Conference on Artificial Intelligence*.
- Harvey Sacks, Emanuel A. Schegloff, and Gail Jefferson. 1974. A simplest systematics for the organization of turn-taking for conversation. *Language*, 50(4):696–735.
- Gabriel Skantze. 2021. Turn-taking in conversational systems and human-robot interaction: A review. *Computer Speech & Language*, 67:101178.
- Jerry S. Wiggins. 1979. A psychological taxonomy of trait-descriptive terms: The interpersonal domain. *Journal of Personality and Social Psychology*, 37(3):395–412.
- Saizheng Zhang, Emily Dinan, Jack Urbanek, Arthur Szlam, Douwe Kiela, and Jason Weston. 2018. Personalizing dialogue agents: I have a dog, do you have pets too? In *Proceedings of ACL*.

## **Equipment Requirements for Demonstration**

PersonaKit runs in any modern browser on a laptop or phone, so requirements for the demo are minimal.

**Equipment provided by authors.** A laptop with built-in microphone and speakers, running PK via its cloud-deployed instance; a phone as a secondary client to show mobile compatibility; and a pair of over-ear headphones that attendees can use if the demo area is noisy.

**Furniture and equipment requested from organizers.** A standard demo table (one attendee at a time, plus a presenter), two power outlets, and reliable conference Wi-Fi. No projector or external monitor is needed.

**Interaction flow.** The demo is open to all attendees: each walks up, speaks with the agent through the provided laptop or phone, and (on request) switches between a *Grumpy Tavern Keeper* and a *Standard AI Assistant* to experience how persona-conditioned turn-taking changes the feel of the interaction. A consent notice is shown before each session, and any transcripts retained briefly for on-site walkthroughs are deleted at the end of the demo.