

Meflex: A Multi-agent Scaffolding System for Entrepreneurial Ideation Iteration via Nonlinear Business Plan Writing

Lan Luo¹, Dongyijie Primo Pan¹, Junhua Zhu¹, Muzhi Zhou¹, and Pan Hui^{1,2}

¹ Hong Kong University of Science and Technology (Guangzhou), Guangzhou, China
 lluo476@connect.hkust-gz.edu.cn, dpan750@connect.hkust-gz.edu.cn,
 junhuazhu@hkust-gz.edu.cn, mzzhou@hkust-gz.edu.cn, panhui@hkust-gz.edu.cn

² The Hong Kong University of Science and Technology, Hong Kong, China

Abstract. Business plan (BP) writing plays a key role in entrepreneurship education by helping learners construct, evaluate, and iteratively refine their ideas. However, conventional BP writing remains a rigid, linear process that often fails to reflect the dynamic and recursive nature of entrepreneurial ideation. This mismatch is particularly challenging for novice entrepreneurial students, who struggle with the substantial cognitive demands of developing and refining ideas. While reflection and meta-reflection are critical strategies for fostering divergent and convergent thinking, existing writing tools rarely scaffold these higher-order processes. To address this gap, we present the Meflex System, a large language model (LLM)-based writing tool that integrates BP writing scaffolding with a nonlinear idea canvas to support iterative ideation through reflection and meta-reflection. We report findings from an exploratory user study with 30 participants that examined the system’s usability and cognitive impact. Results show that Meflex effectively scaffolds BP writing, promotes divergent thinking through LLM-supported reflection, and enhances meta-reflective awareness while reducing cognitive load during complex idea development. These findings highlight the potential of non-linear LLM-based writing tools to foster deeper and coherent entrepreneurial thinking.

Keywords: Ideation · Meta-reflection · Entrepreneurship Education · Business Plan Writing · Large Language Model.

1 INTRODUCTION

Business plan (BP) writing is a critical component of entrepreneurship education. While traditionally aimed at presenting business ideas to investors [14], BP writing is increasingly seen in educational contexts as a pedagogical scaffolding that helps learners construct, evaluate, and iteratively refine their entrepreneurial ideas [13, 25]. Despite this pedagogical potential, BP writing remains a rigid, linear process centered on a single idea [30, 22]. This stands in contrast to entrepreneurial ideation which is inherently dynamic and iterative [32]. It involves

continuously revisiting initial abstract ideas through core business plan components such as problem identification, pain-point analysis and so on [1]. The substantial cognitive demands of iterative ideation often hinder idea development and opportunity recognition among novice entrepreneurial students [16].

Reflection is a promising cognitive strategy for supporting entrepreneurial ideation through divergent thinking [51]. By prompting learners to critically examine their assumptions, consider alternative perspectives, and adapt their ideas in response to new insights, it fosters deeper cognitive engagement [43, 42]. In particular, it plays a vital role in fostering divergent thinking, which enables learners to generate creative possibilities [34], explore novel entrepreneurial directions [5], and overcome cognitive fixation [38]. However, effective ideation also demands the capacity to converge and refine ideas [41]. Meta-reflection is a higher level of cognitive engagement and refers to the capacity to monitor, evaluate, and regulate one’s own thinking [45]. Through meta-reflection, learners gain awareness of their problem-solving approaches [15], recognize reasoning limitations [45], and adjust cognitive strategies accordingly [57]. Yet few writing tools in entrepreneurial education are explicitly designed to scaffold these reflective and meta-reflective processes, leaving a critical gap in ideation support [51].

Recent advances in large language models (LLMs) offer new opportunities for addressing this gap. LLMs possess the capacity to engage in context-aware dialogue [46], generate alternative perspectives [55], and prompt critical questioning [36]. However, current LLM-based writing tools in entrepreneurial education primarily support linear and surface-level aspects of writing, such as grammar correction, content expansion, and structural coherence [47, 40], offering limited support for the iterative, non-linear nature of entrepreneurial ideation. They also lack scaffolding for higher-order processes like reflection and meta-reflection, which demands both divergent and convergent thinking to explore possibilities, evaluate alternatives, and refine ideas over time [27].

To address this gap, we propose a non-linear writing tools with LLM support to facilitate reflection and meta-reflection, enabling learners to regulate, critique, and iteratively improve their thinking across multiple ideation cycles [18, 56, 17]. This leads to the central research question: *How does the non-linear writing system with multi-agents scaffold BP writing and foster ideation?* To investigate it, we conducted an exploratory study with 30 participants using the Meflex system. Our main contributions are threefold. First, we developed **Meflex**, an multi-agent system that provides structured guidance and adaptive reflective scaffolding. Second, we introduced a non-linear writing interaction model that enables learners to flexibly revisit ideas through a visual canvas. Third, we empirically examined the influence of reflection and meta-reflection, revealing how these features enhance idea generation, synthesis, and cognitive integration in complex writing tasks.

2 Literature Review

2.1 BP Writing as a Pedagogical Scaffold for Ideation

BPs are widely recognized as structured framework for defining business goals, outlining strategies, projecting financial performance, and planning operations [20]. Traditionally, the business plan has been viewed as a tool for executing an established idea by organizing resources and presenting strategies for implementation [26, 30]. However, this perspective often overlooks the dynamic and iterative nature of idea development that underlies entrepreneurial practice [53]. More recent studies suggest that effective idea development relies not on internal projections alone, but on external validation through engagement with real-world data and feedback [31, 3]. From this viewpoint, BP writing BP writing is not merely about documenting a fixed idea, but about continuously revise and refining it in response to evolving market conditions, validated assumptions, and customer insights [9]. This repositions the BP as a dynamic thinking tool that evolves through feedback loops and contextual learning [20].

In entrepreneurship education, BP writing is increasingly adopted not only as an performance assessment tool but also as a pedagogical scaffold for practice-based learning [25]. Through iterative cycles of business plan writing activities, students engage in a process that supports reflection, peer critique, and contextual adaptation of entrepreneurial ideas [35, 39]. BP writing thus functions as a structural scaffolding by supporting students in understanding the fluid and iterative nature of ideation in entrepreneurial practice.

2.2 Reflection and Meta-reflection Interventions in Ideation

Reflection and meta-reflection serve as critical mechanisms for facilitating such cognitive engagement, enabling learners to evaluate their ideas, identify gaps, and refine their reasoning over time [43, 42]. Reflection refers to the learner's ability to examine and assess their current thinking, enabling iterative improvement and deeper cognitive engagement [2]. Many student entrepreneurs struggle with developing their ideas, often finding it difficult to move beyond initial concepts or explore alternative possibilities [4]. These challenges highlight the importance of supporting not only the structural development of business ideas, but also the cognitive processes that underlie creative ideation. To address these challenges, [24] highlight the potential of business plans to support reflective thinking, critical analysis, and the iterative development of entrepreneurial ideas. They advocate for a student-centered approach in which BPs serve not merely as assessment tools, but as active instruments for learning and idea evolution. Such a view emphasizes the cognitive demands of ideation, which often requires learners to engage in reflection and continuous refinement [27].

Beyond first-order reflection, meta-reflection supports learners in evaluating how their ideas evolved over time, enabling deeper awareness of their own thinking processes [50]. While reflection focuses on assessing one's current thinking, meta-reflection emphasizes the trajectory of that thinking by examining

how initial assumptions were challenged, what factors influenced key changes, and how alternative directions emerged [12, 45]. This recursive awareness not only strengthens cognitive flexibility but also promotes a sense of ownership and intentionality in the ideation process [11]. In entrepreneurship education, such metacognitive practices are especially valuable, as idea development often involves nonlinear progress, iterative pivots, and uncertainty. By explicitly surfacing the rationale behind conceptual shifts, meta-reflection helps student entrepreneurs make sense of ambiguity and better navigate the iterative nature of opportunity exploration.

2.3 LLM-based Writing Tools for Entrepreneurial Ideation

LLMs have demonstrated strong potential in supporting entrepreneurial ideation by helping users generate, refine, and expand on early-stage ideas [7, 19]. For example, systems like Collaborative Canvas embed LLMs into shared virtual workspaces to facilitate collaborative brainstorming [19]. Beyond ideation, LLMs not only provide direct feedback but also support structured writing by enabling feedback-driven revision and modular content development [49]. System like Friction [54] uses LLMs to break down complex feedback into manageable units, promoting structured reflection and more effective revisions, while the End User Authoring system [49] supports rapid initialization and iterative refinement of classification criteria. Structured writing, such as business plan writing, benefit from LLMs’ ability to improve clarity, coherence, and content organization [37]. Tools like Rambler [28], WHAT-IF [21], and LegalWriter [52] further demonstrate how LLMs can scaffold writing by offering structural prompts, reorganizing content, and supporting domain-specific reasoning.

Despite these advancements, current LLM-based writing tools often lack mechanisms to support self-reflection during the ideation process. The study [33] shows that early integration of LLMs can reduce both the quantity and novelty of user-generated ideas, as it may constrain the creative freedom needed for divergent thinking. This effect, known as idea fixation, can also diminish a writer’s sense of autonomy and ownership over their work, ultimately limiting the creative potential of the final output. Moreover, many LLM systems [23, 10] prioritize generating polished text over supporting the iterative and reflective processes essential for developing deeper writing skills. As a result, these tools often overlook the critical role of reflection, creativity, and critical thinking in the writing process [10, 48]. To address this, future LLM-supported writing tools should be designed not only to produce high-quality outputs but also to encourage ongoing reflection and metacognition, allowing writers to refine their ideas over time and maintain a sense of creative ownership.

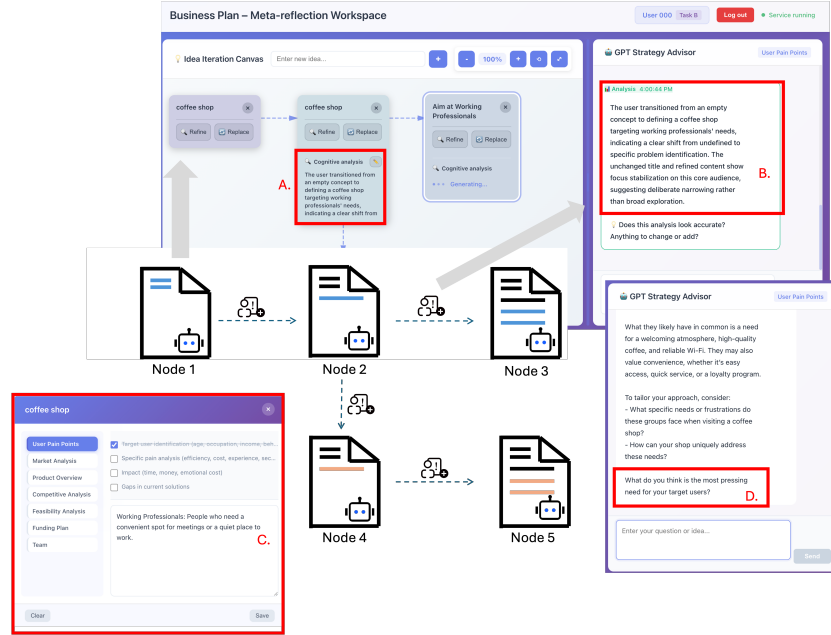

Fig.1. Three primary sections: the idea iteration canvas, the structural writing workspace, and the LLM assistant panel.

3 Meflex System

3.1 System Overview

The Meflex system interface in Fig.1 is designed to support business plan writing through the scaffolding, consisting of three primary sections: **the ideation canvas**, **the structure writing workspace**, and **the LLM assistant panel**.

The **ideation canvas** (Fig. 1, Left) allows users to progressively develop their entrepreneurial ideas through a visual workspace. Once an idea card is created, users can double-click it to open the **structure writing workspace** (Fig. 1 (C)), which provides section-specific scaffolding for composing the business plan. This workspace offers predefined structural modules (e.g., User Pain Points, Market Analysis, Funding Plan), each accompanied by LLM-assisted prompts and examples to guide writing in the **LLM assistant panel** (Fig. 1, Right). In parallel, each LLM response is followed by a reflective question (Fig. 1 (D)) that encourages users to reconsider assumptions, explore alternatives, or extend their ideas beyond the current formulation. These reflective prompts are designed to stimulate divergent thinking and often lead users to create new branches or revisions in the ideation canvas.

Users can create new idea cards by extending an existing one either horizontally or vertically. A horizontal extension denotes incremental refinement of the same idea. For instance, extending from Node 1 to Node 2 copies the content

of Node 1 into Node 2, enabling users to revise and elaborate on their original thinking in a continuous manner. A vertical extension denotes a conceptual branching from the same origin. For example, when both Node 2 and Node 3 are created from Node 1, they inherit its content and develop in parallel, enabling users to explore different variations or alternative approaches to the original idea.

As multiple idea nodes accumulate on the canvas, it becomes increasingly important to help users track how their thoughts have developed. Each idea card includes a meta-reflection segment (Fig. 1 (A)), automatically generated by the LLM, explaining how the current idea evolved from earlier iterations. In the LLM panel (Fig. 1 (D)), users can engage in reflective dialogue to revise or deepen this meta-cognitive insight. By surfacing connections across branches and highlighting the rationale behind changes, the system encourages users to monitor, evaluate, and refine their reasoning while maintaining a coherent understanding of both incremental progress and conceptual shifts.

3.2 Multi-Agents Roles and Prompts

To support entrepreneurial ideation, we integrate five key scaffolding strategies [25] into system design: (1) Guidance, offering structured steps, prompts, and analytic tools (e.g., TAM, SWOT); (2) Contextualization, using LLMs to flexibly initiate and develop business ideas from diverse entry points by embedding them into meaningful entrepreneurial contexts; (3) Engagement, fostering motivation through interactive and immersive feedback [8]; (4) Interaction, enabling multi-turn dialogues to refine ideas [44]; and (5) Reflection, enhancing metacognitive awareness through prompts and summaries [42]. These scaffolds guide learners from idea generation to refinement, and are operationalized through dedicated LLM-powered agent modules.

Building on these scaffolds, the system adopts a multi-agent LLM framework, where each business plan section is supported by a specialized agent offering role-specific prompts and guidance. This modular design enables context-aware assistance and diversified perspectives throughout the writing process. All LLM functionalities are powered by the DeepSeek API [29], which provides high-performance language modeling to support real-time, flexible generation and interaction. Table 1 summarizes the prompt strategies used in each module.

4 Method

4.1 Participant

We recruited 30 participants from the university (labeled as P1 to P30) through an open call distributed via an online questionnaire. Participation was entirely voluntary, and the study aimed to assess the effectiveness of our system in business plan writing and meta-reflection. The study protocol was reviewed and

Table 1. Overview of Prompt Strategies for Business Plan Modules

Roles	LLM Prompt
User Pain Points	Analyze and identify the target users’ core pain points, their current solutions, and deeper unmet needs in real contexts.
Market Analysis	Discuss market size, growth trends, segmentation, and external drivers that shape the business landscape.
Product Overview	Define the product’s value proposition, key features, use cases, and how it addresses user needs.
Competitive Analysis	Evaluate main competitors, alternatives, and differentiation strategy to build a sustainable advantage.
Feasibility Analysis	Assess technical, operational, and financial feasibility, including risks and implementation timeline.
Funding Plan	Design a realistic fundraising plan, including funding needs, investor profile, and return expectations.
Team	Present team strengths, member roles, relevant experience, and future hiring or organizational plans.
Reflection	Guide the user to reflect on their current reasoning and decisions by asking open-ended questions.
Meta-Reflection	Analyze the cognitive shift between idea versions and synthesize how the new thinking evolved.

approved by the university’s Institutional Review Board (IRB). All participants provided informed consent prior to the study, and their responses were anonymized for analysis.

Among them, 17 identified as male and 13 as female. The average age was 22.83 years ($SD = 4.98$). Participants came from diverse academic backgrounds, including majors such as Communication and Media Arts, Artificial Intelligence, Human-Computer Interaction, Data Science and Analytics, Psychology, and Industrial Engineering. In terms of academic level, participants ranged from undergraduate Year 1 to postgraduate Year 9. Most were in the early years of undergraduate study, with Year 1 ($n = 10$) being the largest group. Regarding entrepreneurial experience, 21 participants had no prior startup experience, while 9 reported some level of experience.

4.2 Testing Procedure and Data Analysis

The user study was divided into three phases: **Pre-Study**, **In-Study**, and **Post-Study**. In the **Pre-Study phase**, participants completed a demographic questionnaire and received a 10-minute Zoom demo covering core features such as node manipulation on the *idea canvas*, initiating reflection with the LLM assistant, and reviewing meta-reflections. During the **In-Study phase**, participants selected one of ten predefined entrepreneurial topics (e.g., eco apps, travel planning, e-bike sharing) and spent 40–60 minutes using the system to develop and refine business ideas. In the **Post-Study phase**, participants completed a Likert-scale questionnaire on scaffolding and interaction design, followed by

a 10–15 minute interview for qualitative feedback. For **data analysis**, we conducted thematic analysis of the interview transcripts. Two researchers independently coded the data, identifying key themes such as "Scaffolding Support", "Reflection Engagement", and so on. They refined a shared codebook through discussion, resolving disagreements in team meetings. This analysis revealed patterns in idea development, flexible writing structure, and reflective system use.

5 Findings

5.1 How usable and effective does the Meflex system scaffold users in writing a business plan?

To evaluate the usability of the LLM-supported writing scaffolding, the Meflex was evaluated using the standardized System Usability Scale (SUS) [6], which employs a 7-point Likert format, focusing on three dimensions: **guidance**, **contextualization**, and **engagement** (1 = Strongly Disagree, 7 = Strongly Agree). The Figure 2 illustrates the actual score ranges (from minimum to maximum) as horizontal bars, with black dots marking the mean score for each item. The "mean \pm standard deviation" labels further indicate the central tendency and variability across participants.

Overall, the results reveal consistently positive user perceptions, with most items receiving mean scores between 5.5 and 6.5 on a 7-point Likert scale. Items such as Q1, Q2, Q3, and Q10 achieved the highest mean scores (all above 5.8), indicating strong perceived effectiveness and clarity in system interaction. And Q4 received slightly lower mean scores and exhibited wider score ranges, suggesting greater variability in user experiences for those aspects. This may point to potential areas for further improvement in system design or communication strategies. Despite these variations, standard deviations remained relatively low (typically below 0.7), indicating a high level of agreement among participants. Together with the generally narrow rating ranges, this suggests the system delivered a stable and consistent usability experience across users.

Furthermore, qualitative feedback reinforces these quantitative findings. Participants (P2, P5, P8, P11, P14, P19, P25) frequently described the system’s scaffolding as instrumental in managing the complexity of writing a business plan. In particular, the combination of a to-do list interface and LLM-based dialogue support helped reduce uncertainty, sustain engagement, and enable iterative refinement (P5, P19, P25). The to-do list provided clear structure and broke down the task into manageable units (P2, P5, P14). As P8 noted, *"The to-do list made me feel I had a roadmap... it didn't overwhelm me, and I could pick up right where I left off."* Similarly, P7 remarked, *"It felt manageable because I could focus on one thing at a time. The list kept me on track."* These comments suggest that structured guidance made the writing process more approachable, especially for users unfamiliar with business planning.

Complementing the structured guidance, the LLM assistant provided adaptive support that accommodated users with varying levels of experience (P7,

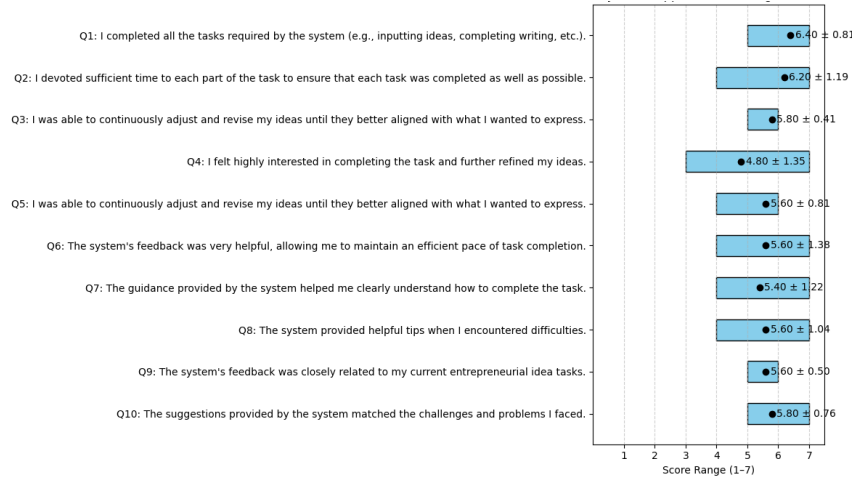

Fig. 2. User Satisfaction with Scaffolding

P12, P16, P21). Whether participants were familiar with business plan writing or not, the assistant offered tailored prompts and follow-up questions that adjusted to their current progress and input. For example, P21 with less experienced participant shared, *"I didn't know much about business plans, but the assistant broke things down for me and asked simple questions that helped me understand what to write."* Meanwhile, P16 with more confident user described: *"I already had a basic plan in mind, and the assistant pushed me further—it kept asking questions that made me rethink my assumptions."* These examples show that the system could offer both foundational guidance and deeper prompts, helping users engage at their own level and supporting both comprehension and critical thinking.

5.2 How does non-linear writing in Meflex system influences entrepreneurial ideation?

The non-linear writing design in the Meflex system—particularly the ability to revisit, refine, and reorganize ideas across multiple stages—proved central to supporting entrepreneurial ideation. Rather than enforcing a rigid, step-by-step structure, the system allowed users to navigate freely across modules and return to earlier thoughts, fostering a more dynamic and iterative creative process (P9, P11, P15, P25). Participants (P9, P25) reported that this modular organization helped them distinguish between ideas that were conceptually parallel and those that represented progressive refinement. P9 noted that separating early assumptions into different nodes clarified their relationships: *"I could clearly see which parts were alternatives and which ones were building on each other. That made it easier to decide what to keep and what to revise"*.

In addition to segmenting content, the node-based structure made the evolution of ideas more traceable (P8, P11, P14, P26). Participants could visually identify how one node branched into another (e.g., Node 2 leading to Node 4), revealing how their thinking developed over time. This visibility prompted self-reflection and recursive refinement. As P14 noted, *"When I looked back at how Node 4 came from Node 2, I realized my thinking had shifted—I could see that change clearly."* P11 echoed this, stating, *"Seeing the path helped me understand what triggered each idea. It wasn't random—I could trace the logic."* Similarly, P8 shared, *"The branching view let me retrace my steps. I noticed how earlier thoughts shaped what came next, and sometimes that made me go back and revise."* P26 added, *"It felt like watching my idea grow, not just listing points. I saw where things connected or didn't, and fixed them."* Together, these reflections illustrate how the visualized structure of non-linear writing supported users in monitoring their ideation process and engaging in meaningful revision.

5.3 How do GPT-generated reflection prompts and meta-reflection summaries support entrepreneurial ideation?

Participants (P11, P18, P21) found GPT-generated reflection prompts valuable in encouraging deeper self-examination of their ideas. These prompts guided users to assess the validity, completeness, and consistency of their thinking, prompting them to question assumptions and consider alternative perspectives. As P26 noted, *"The questions made me pause and think if my solution really solves the problem I described. I wouldn't have done that on my own."* This kind of reflective scaffolding pushed participants beyond surface-level idea generation. P10 similarly shared, *"It kept nudging me—'have you thought about who really needs this?' That helped me sharpen my target audience."* Rather than offering answers, the assistant acted as a metacognitive partner, supporting users in iteratively refining their ideas through structured self-questioning.

Beyond local reflection, meta-reflection summaries also helped participants make sense of how different nodes and ideas were connected across their business plan drafts (P3, P12, P16). By synthesizing content across modules, these summaries offered a high-level overview that made the structure of their thinking more visible and easier to navigate. Several participants (P1, P3, P16) reported that the summaries encouraged them to revisit and refine earlier inputs based on new insights. For example, P15 noted, *"After reading the summary, I realized my customer segment and value proposition didn't quite match. That made me go back and rewrite part of it."* By surfacing potential inconsistencies, the system allowed users to focus their attention where revisions were needed, instead of manually cross-checking sections. Instead of manually tracing connections between sections, users could rely on the meta-reflection to highlight inconsistencies or gaps. P30 similarly reflected, *"It reminded me that everything should connect—it wasn't just writing section by section."* In this way, meta-reflections served as cognitive scaffolds that not only reduced users' mental load but also supported the integration of modular content into a coherent entrepreneurial narrative.

6 Discussion and Future Work

This study introduces Meflex, a novel human-AI co-writing system that reimagines the ideation process through nonlinear writing. By enabling users to externalize and iterate on modular components of a business plan, Meflex supports entrepreneurial ideation as a recursive, flexible, and reflective process. The system combines structured scaffolding with adaptive LLM assistance, allowing users to compose, revise, and relate ideas across modular nodes. Through a mixed-method evaluation, including usability metrics and qualitative interviews, we demonstrate that this hybrid approach helps users manage cognitive load, deepen idea development, and maintain global coherence in their writing.

One key contribution of Meflex is its ability to support ideation through a combination of structure and flexibility. The system enables users to concentrate on individual sections while remaining aware of the overall logic of the business narrative. Meta-reflection summaries reinforce this process by synthesizing information across nodes, identifying inconsistencies, and prompting users to make targeted revisions. However, as participant P14 noted, the current meta-reflection feature focuses only on tracking changes in written text and does not yet capture the interactions between users and the LLM. This highlights a potential direction for future improvement. By analyzing the content and flow of user-LLM discussions, the system could generate richer insights into how ideas evolve and where LLM support plays the most significant role.

In sum, Meflex advances a new paradigm for AI-assisted writing, one that treats ideation as a nonlinear, reflective, and dialogic process. By blending modular composition with adaptive feedback, the system scaffolds entrepreneurial thinking beyond surface-level content generation. Future iterations may enhance this model by capturing conversational trajectories and offering more interactive meta-cognitive support.

References

1. Albers, A.A., Tekaatt, J., Kühn, I.A., Dumitrescu, I.R.: Requirement profiles as a foundation for customer-centric ideation in business-to-business markets. *Procedia CIRP* **84**, 1120–1127 (2019)
2. Atkins, S., Murphy, K.: Reflection: a review of the literature. *Journal of advanced nursing* **18**(8), 1188–1192 (1993)
3. Baker, W.H., Addams, H.L., Davis, B.: Business planning in successful small firms. *Long range planning* **26**(6), 82–88 (1993)
4. Bock, A.J.: *The business model book: Design, build and adapt business ideas that drive business growth*. Pearson UK (2018)
5. Bohlayer, C., Timm, J.M., Halberstadt, J.: Navigating the dimensions of criticality: exploring reflective processes in critical entrepreneurship education. *International Journal of Entrepreneurial Behavior & Research* (2025)
6. Brooke, J., et al.: Sus-a quick and dirty usability scale. *Usability evaluation in industry* **189**(194), 4–7 (1996)

7. Choi, Y., Kang, E.J., Choi, S., Lee, M.K., Kim, J.: Proxona: Supporting creators' sensemaking and ideation with llm-powered audience personas. In: *Proceedings of the 2025 CHI Conference on Human Factors in Computing Systems*. CHI '25, Association for Computing Machinery, New York, NY, USA (2025). <https://doi.org/10.1145/3706598.3714034>, <https://doi.org/10.1145/3706598.3714034>
8. Clarizia, F., Colace, F., Lombardi, M., Pascale, F., Santaniello, D.: Chatbot: An education support system for student. In: *Cyberspace Safety and Security: 10th International Symposium, CSS 2018, Amalfi, Italy, October 29–31, 2018, Proceedings 10*. pp. 291–302. Springer (2018)
9. DaSilva, C.M., Trkman, P.: Business model: What it is and what it is not. *Long range planning* **47**(6), 379–389 (2014)
10. Diallo, A., Bikakis, A., Dickens, L., Hunter, A., Miller, R.: Rule-guided feedback: Enhancing reasoning by enforcing rule adherence in large language models. *arXiv preprint arXiv:2503.11336* (2025)
11. Dozzi, M.D.: Is (self-) reflection a form of intentionality? sartre's dilemma. *European Journal of philosophy* **32**(1), 85–99 (2024)
12. Du Toit, P.H.: A meta-reflection on my emerging as a scholar of action research. *South African Journal of Higher Education* **32**(6), 425–439 (2018)
13. Envick, B.R.: Design thinking methods for business plan development: A structured approach to idea generation that promotes creativity. *Global Journal of Business Pedagogy (GJBP)* **4**(1) (2020)
14. Fayolle, A., Gailly, B.: The impact of entrepreneurship education on entrepreneurial attitudes and intention: Hysteresis and persistence. *Journal of small business management* **53**(1), 75–93 (2015)
15. Georgiev, G.V., Nagai, Y.: Model of meta-reflection and in-depth analysis of knowledge creation process in design. *International Journal of Knowledge and Systems Science (IJKSS)* **2**(2), 49–67 (2011)
16. Greavu, A.: An overview of business writing: Challenges and solutions. *Studies in Business and Economics* **14**(1), 60–71 (2019)
17. Greene, J.A., Bolick, C.M., Robertson, J.: Fostering historical knowledge and thinking skills using hypermedia learning environments: The role of self-regulated learning. *Computers & Education* **54**(1), 230–243 (2010)
18. Hacker, D.J., Dunlosky, J., Graesser, A.C.: *Metacognition in educational theory and practice*. Routledge (1998)
19. He, J., Houde, S., Gonzalez, G.E., Silva Moran, D.A., Ross, S.I., Muller, M., Weisz, J.D.: Ai and the future of collaborative work: Group ideation with an llm in a virtual canvas. In: *Proceedings of the 3rd Annual Meeting of the Symposium on Human-Computer Interaction for Work. CHIWORK '24*, Association for Computing Machinery, New York, NY, USA (2024). <https://doi.org/10.1145/3663384.3663398>, <https://doi.org/10.1145/3663384.3663398>
20. Honig, B.: Entrepreneurship education: Toward a model of contingency-based business planning. *Academy of management learning & education* **3**(3), 258–273 (2004)
21. Huang, R., Martin, L.J., Callison-Burch, C., et al.: What-if: Exploring branching narratives by meta-prompting large language models. *arXiv preprint arXiv:2412.10582* (2024)
22. Jackson, A.: The advantage of an iterative writing process for novels and short stories (2022)

23. Jeon, H., Yoon, S., Lee, K., Kim, S.H., Kim, E.H., Cho, S., Ko, Y., Yang, S., Dabbish, L., Zimmerman, J., Kim, E.m., Lim, H.: Letters from future self: Augmenting the letter-exchange exercise with llm-based agents to enhance young adults' career exploration. In: Proceedings of the 2025 CHI Conference on Human Factors in Computing Systems. CHI '25, Association for Computing Machinery, New York, NY, USA (2025). <https://doi.org/10.1145/3706598.3714206>, <https://doi.org/10.1145/3706598.3714206>
24. Jones, C., Penaluna, A.: Moving beyond the business plan in enterprise education. *Education+ Training* **55**(8/9), 804–814 (2013)
25. Junhua, Z., Lan, L.: Designing the future of entrepreneurship education: Exploring an ai-empowered scaffold system for business plan development. In: 2025 5th International Conference on Artificial Intelligence and Education (ICAIE). pp. 184–193. IEEE (2025)
26. Karlsson, T., Honig, B.: Judging a business by its cover: An institutional perspective on new ventures and the business plan. *Journal of business venturing* **24**(1), 27–45 (2009)
27. Kier, A.S., McMullen, J.S.: Entrepreneurial imaginativeness in new venture ideation. *Academy of Management Journal* **61**(6), 2265–2295 (2018)
28. Lin, S., Warner, J., Zamfirescu-Pereira, J., Lee, M.G., Jain, S., Cai, S., Lertvitayakumjorn, P., Huang, M.X., Zhai, S., Hartmann, B., et al.: Rambler: Supporting writing with speech via llm-assisted gist manipulation. In: Proceedings of the 2024 CHI Conference on Human Factors in Computing Systems. pp. 1–19 (2024)
29. Liu, A., Feng, B., Xue, B., Wang, B., Wu, B., Lu, C., Zhao, C., Deng, C., Zhang, C., Ruan, C., et al.: Deepseek-v3 technical report. arXiv preprint arXiv:2412.19437 (2024)
30. Mansoori, Y., Lackeus, M.: Comparing effectuation to discovery-driven planning, prescriptive entrepreneurship, business planning, lean startup, and design thinking. *Small Business Economics* **54**(3), 791–818 (2020)
31. Neidell, L.: Taking a flyer on wind technology. *Planning Review* **16**(6), 28–48 (1988)
32. Ogutveren-Gonul, O.: Teaching and implementing ideation in entrepreneurship: A systematic approach. *Journal of Entrepreneurship and Business Innovation* **5**(2), 27–45 (2019)
33. Qin, P., Yang, C.L., Li, J., Wen, J., Lee, Y.C.: Timing matters: How using llms at different timings influences writers' perceptions and ideation outcomes in ai-assisted ideation. In: Proceedings of the 2025 CHI Conference on Human Factors in Computing Systems. CHI '25, Association for Computing Machinery, New York, NY, USA (2025). <https://doi.org/10.1145/3706598.3713146>, <https://doi.org/10.1145/3706598.3713146>
34. Razdorskaya, O.: Reflection and creativity: the need for symbiosis. *Procedia-Social and Behavioral Sciences* **209**, 433–438 (2015)
35. Reagle, C., Maggioni, V., Boicu, M., Albanese, M., Joshi, M., Sklarew, D., Peixoto, N.: From idea to prototype: introducing students to entrepreneurship. In: 2017 IEEE Integrated STEM Education Conference (ISEC). pp. 71–75. IEEE (2017)
36. Reinhart, A., Markey, B., Laudénbach, M., Pantusen, K., Yurko, R., Weinberg, G., Brown, D.W.: Do llms write like humans? variation in grammatical and rhetorical styles. *Proceedings of the National Academy of Sciences* **122**(8), e2422455122 (2025)
37. Robidoux, C.: Rhetorically structured content: Developing a collaborative single-sourcing curriculum. *Technical Communication Quarterly* **17**(1), 110–135 (2007)

38. Rosseel, J., Anseel, F.: When reflection hinders creative problem-solving: a test of alternative reflection strategies. *Journal of Business and Psychology* **37**(2), 429–441 (2022)
39. Roy, D.: Concept mapping and summary writing as complementary strategies for developing efl content comprehension. *International Journal of Computer-Assisted Language Learning and Teaching (IJCALLT)* **11**(3), 39–55 (2021)
40. Ruan, S., Jiang, L., Xu, Q., Liu, Z., Davis, G.M., Brunskill, E., Landay, J.A.: Englishbot: An ai-powered conversational system for second language learning. In: *Proceedings of the 26th International Conference on Intelligent User Interfaces*. pp. 434–444 (2021)
41. Runco, M.A., et al.: Divergent thinking, creativity, and ideation. *The Cambridge handbook of creativity* **413**, 446 (2010)
42. Sadler-Smith, E.: Learning styles: a holistic approach. *Journal of European industrial training* **20**(7), 29–36 (1996)
43. Secundo, G., Del Vecchio, P., Schiuma, G., Passiante, G.: Activating entrepreneurial learning processes for transforming university students' idea into entrepreneurial practices. *International Journal of Entrepreneurial Behavior & Research* **23**(3), 465–485 (2017)
44. Tegos, S., Demetriadis, S., Karakostas, A.: Promoting academically productive talk with conversational agent interventions in collaborative learning settings. *Computers & Education* **87**, 309–325 (2015)
45. Thorpe, A., Garside, D.: (co) meta-reflection as a method for the professional development of academic middle leaders in higher education. *Management in education* **31**(3), 111–117 (2017)
46. Venkatraman, S., Tripto, N.I., Lee, D.: Collabstory: Multi-llm collaborative story generation and authorship analysis. *arXiv preprint arXiv:2406.12665* (2024)
47. Wambsganss, T., Kueng, T., Soellner, M., Leimeister, J.M.: Arguetutor: An adaptive dialog-based learning system for argumentation skills. In: *Proceedings of the 2021 CHI conference on human factors in computing systems*. pp. 1–13 (2021)
48. Wan, Y., Pu, G., Sun, J., Garimella, A., Chang, K.W., Peng, N.: "kelly is a warm person, joseph is a role model": Gender biases in llm-generated reference letters. *arXiv preprint arXiv:2310.09219* (2023)
49. Wang, L., Yurechko, K., Dani, P., Chen, Q.Z., Zhang, A.X.: End user authoring of personalized content classifiers: Comparing example labeling, rule writing, and llm prompting. In: *Proceedings of the 2025 CHI Conference on Human Factors in Computing Systems*. CHI '25, Association for Computing Machinery, New York, NY, USA (2025). <https://doi.org/10.1145/3706598.3713691>, <https://doi.org/10.1145/3706598.3713691>
50. Wang, Y., Zhu, Y., XintongBao, X., Zhang, W., Dai, S., Chen, K., Li, W., Huang, G., Tang, S., Zhuang, Y.: Meta-reflection: A feedback-free reflection learning framework. In: *Proceedings of the 63rd Annual Meeting of the Association for Computational Linguistics (Volume 1: Long Papers)*. pp. 3958–3976 (2025)
51. Wardoyo, C., Narmaditya, B.S., Handayati, P., Fauzan, S., Prayitno, P.H., Sahid, S., Wibowo, A.: Determinant factors of entrepreneurial ideation among university students: A systematic literature review. *Heliyon* **9**(6) (2023)
52. Weber, F., Wambsganss, T., Neshaei, S.P., Soellner, M.: Legalwriter: An intelligent writing support system for structured and persuasive legal case writing for novice law students. In: *Proceedings of the 2024 CHI Conference on Human Factors in Computing Systems*. CHI '24, Association for Computing Machinery, New York, NY, USA (2024). <https://doi.org/10.1145/3613904.3642743>, <https://doi.org/10.1145/3613904.3642743>

53. Wheadon, J.D., Duval-Couetil, N.: Business plan development activities as a pedagogical tool in entrepreneurship education. *The Journal of Engineering Entrepreneurship* **5**(1), 31–48 (2014)
54. Zhang, C., Ju, K., Bidoshi, P., Yen, Y.C.G., Rzeszutarski, J.M.: Friction: Deciphering writing feedback into writing revisions through llm-assisted reflection. In: *Proceedings of the 2025 CHI Conference on Human Factors in Computing Systems*. CHI '25, Association for Computing Machinery, New York, NY, USA (2025). <https://doi.org/10.1145/3706598.3714316>, <https://doi.org/10.1145/3706598.3714316>
55. Zhang, Y., Jin, H., Meng, D., Wang, J., Tan, J.: A comprehensive survey on process-oriented automatic text summarization with exploration of llm-based methods. *arXiv preprint arXiv:2403.02901* (2024)
56. Zimmerman, B.J.: Self-regulated learning and academic achievement: An overview. *Educational psychologist* **25**(1), 3–17 (1990)
57. Zuber-Skerritt, O.: Critical reflection. In: *Professional learning in higher education and communities: Towards a new vision for action research*, pp. 76–101. Springer (2015)