

TrackStudio: An Integrated Toolkit for Markerless Tracking

Hristo Dimitrov^{1*}, Giulia Dominijanni^{1,2}, Viktorija Pavalkyte¹, Tamar R. Makin¹

¹MRC Cognition and Brain Sciences Unit, University of Cambridge

²Center for Neuroprosthetics and School of Engineering, École Polytechnique Fédérale de Lausanne

*For correspondence: hristo.dimitrov@mrc-cbu.cam.ac.uk

Abstract

Markerless motion tracking has advanced rapidly in the past 10 years and currently offers powerful opportunities for behavioural, clinical, and biomechanical research. While several specialised toolkits provide high performance for specific tasks, using existing tools still requires substantial technical expertise. There remains a gap in accessible, integrated solutions that deliver sufficient tracking for non-experts across diverse settings.

TrackStudio was developed to address this gap by combining established open-source tools into a single, modular, GUI-based pipeline that works out of the box. It provides automatic 2D and 3D tracking, calibration, preprocessing, feature extraction, and visualisation without requiring any programming skills. We supply a user guide with practical advice for video acquisition, synchronisation, and setup, alongside documentation of common pitfalls and how to avoid them.

To validate the toolkit, we tested its performance across three environments using either low-cost webcams or high-resolution cameras, including challenging conditions for body position, lightning, and space and obstructions. Across 76 participants, average inter-frame correlations exceeded 0.98 and average triangulation errors remained low (<13.6mm for hand tracking), demonstrating stable and consistent tracking. We further show that the same pipeline can be extended beyond hand tracking to other body and face regions. TrackStudio provides a practical, accessible route into markerless tracking for researchers or laypeople who need reliable performance without specialist expertise.

Introduction

Tracking of the human movements has been critical for a vast majority of research on motor control and neuromotor disorders. For example, motion capture has been pivotal in defining the fundamental biomechanics of human gait and movement coordination¹ as well as characterizing fine motor impairments in Parkinson's disease². Nevertheless, motion tracking has often required specialised equipment and expertise to collect annotated movement data. Since the advent of optoelectronic systems, which record reflective markers placed on body landmarks, optical tracking has become the gold standard of movement tracking due to its high precision³⁻⁵. However, the use of optical

tracking requires specialised equipment and tends to be restricted to specialised environments (research labs, production studios, etc.). Optical tracking entails further technical limitations, such as (relative) high cost and required technical skill for an effective setup. Furthermore, the use of markers represents a fundamental limitation due to the requirement for constant visibility and precise placement, which will directly affect the accuracy of the system and complicate the setup. Other alternatives, such as inertial measurement units (IMUs)^{6,7} or magnetic tracking⁸ have been developed to address some of these issues e.g. reducing cost and requirements for marker visibility. However, these approaches have not gained broader adoption, as their sensitivity to environmental interference (metals and magnets), tendency for error drift, and need for specialised expertise continue to pose barriers.

Markerless tracking (MLT), which is the use of plain video footage to identify and track key landmarks on the human body, offers an alternative to marker-based tracking⁹⁻¹¹. Current progress in computer vision and machine learning^{12,13} allows for full automation of the process without the need for manual video annotation, simplifying the processing and expanding its usage to technical people outside the field of computer vision. The process of MLT (illustrated in Figure 1) begins in 2D with an automated detection of specific body parts in single images or videos (e.g. the position of a wrist, elbow, or fingertip). These landmarks are identified by computer vision models, which effectively act as “virtual markers” which are placed consistently across video frames in a process called 2D Annotation. Due to readily available large, annotated image datasets, and because the task is constrained to image coordinates, several pre-trained, off-the-shelf tools now exist and make automated landmark detection more accessible. For instance, MediaPipe Hand Landmarker¹⁴, provides robust hand landmark detection across images, video, and live camera streams, while OpenPose¹³ can detect body, face, and hand key points in real time, even in multi-person settings. These 2D tools eliminate the need for manual marking (such as in optical tracking) and make pose estimation available without the need for creating new models.

For many applications, however, 2D information is not enough. While 2D tracking can show where a joint appears in an image/video, it cannot capture depth, orientation, or the relative position of body parts in space. This data might be critical for analyses of movement kinematics, such as calculating joint angles, measuring stride length, or extracting other biomechanically meaningful features. Obtaining this information requires reconstructing 3D poses from multiple camera views. Conceptually, this relies on 3D triangulation – the process of locating a point in space by combining its 2D positions from different cameras. For triangulation to correctly relate 2D pixel coordinates to 3D, the cameras themselves must be precisely calibrated – that is, their position, orientation, and lens distortions must be known. To obtain these parameters, typically, a reference checkerboard with known dimensions is recorded (illustrated in Figure 1) and then processed by a camera-calibration algorithm. Additional challenges for triangulation include ensuring that the same landmark is consistently identified across views (multi-view correspondence) and reducing noise in the reconstructed trajectories. Toolkits such as Anipose¹⁵ and Pose3D¹⁶ offer tools for 3D triangulation and camera calibration as an open-source solution. Anipose also provides video overlays of resulting virtual markers and can integrate with another existing tracker

software called DeepLabCut¹⁷, to enable tracking of external objects and certain animals.

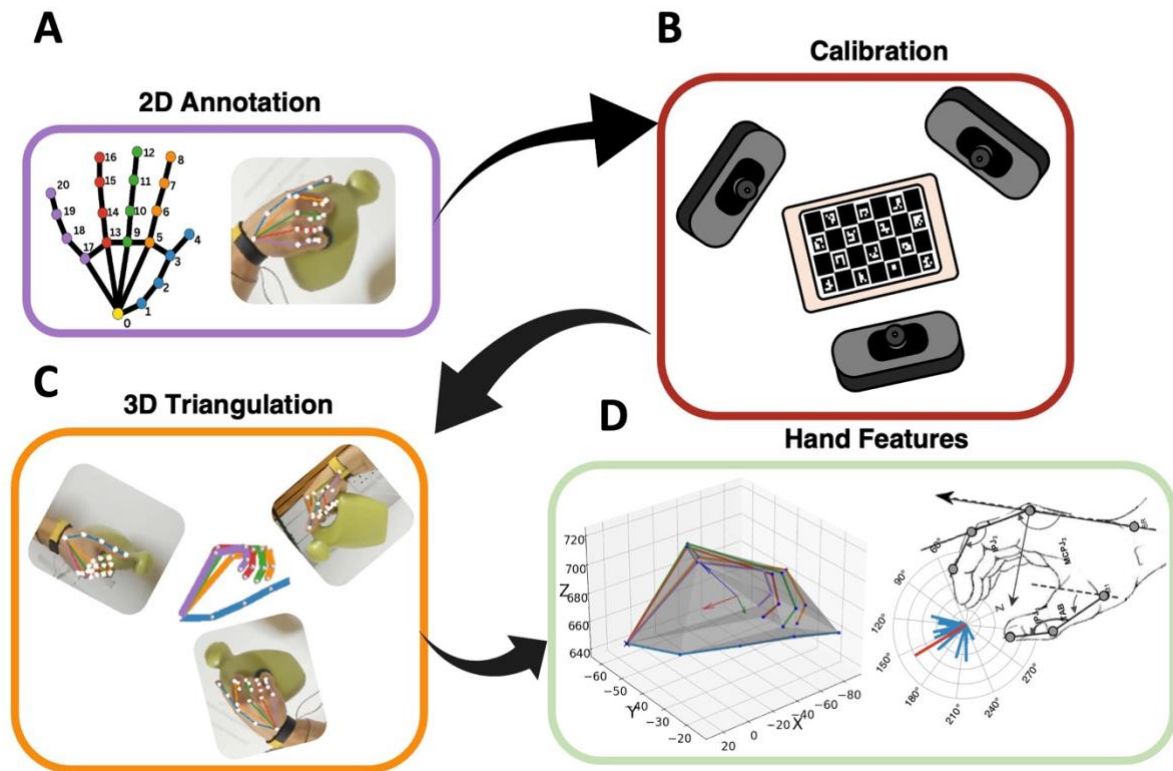

Figure 1. A) 2D Hand Annotation based on Mediapipe Hand Landmarks. B) Example of a calibration process, required to obtain 3D information. C) Exemplary results of 3D data annotation. The displayed video frame has the hand landmarks labelled onto the original video. In the middle, there is a projection of the 3D acquired data of that frame. D) Extracting hand features such as angles and volumes.

All these tools (MediaPipe, OpenPose, Anipose, DeepLabCut) eliminate the manual annotation process, simplify camera calibration, and improve consistency and reproducibility. Additionally, recent advancement in MLT make the process simpler and more accurate with each year. For example, the Radical Live service¹⁸ removes the need for high-end computers due to its cloud service, and new algorithms, such as HandDAGT¹⁹, use novel graph transformer architectures to improve hand tracking.

Despite the barriers of specialised equipment and machine learning accuracy being lifted by various recent packages and toolkit^{20–22}, MLT is still not fully accessible for general use. The necessity for users to have coding knowledge, ability to diagnose installation issues, and be able to navigate through inconsistent standards, presents a technical barrier for wider MLT adoption. For comparison, Nexus (Vicon, Oxford, UK), a popular software for optical tracking, provides an intuitive graphical user interface (GUI) with ready-to-use features without the need of any coding or installation troubleshooting. Here we aim to close this gap by presenting TrackStudio – a toolkit that provides an accessible software tool for people wishing to employ MLT without requiring extensive technical background. This community open-source resource also

enables experts to expand the toolkit through integrating different methods for annotating 2D, 3D, or computing camera calibration for a variety of videos.

The TrackStudio toolkit is a collection of custom-written code and open-source libraries, aimed at simplifying and optimising MLT. It is designed to provide easy access and adequate performance in generalised settings, which could be easily utilised by non-experts. In addition to MLT, the toolkit includes modules for video trimming, extraction of interpretable hand features, and visualisation of preprocessing steps, as well as 2D/3D video labelling to support accessible quality inspection. All of these features are packed into a Python GUI, allowing users to utilise different tools and change their behaviour without having to interact with or write any code. The only inputs the TrackStudio requires are video recording(s) using a simple web camera(s), and a recording of a calibration board if 3D MLT is required (instructions provided in the Appendix).

Methods and Materials

Toolkit Overview

TrackStudio and the tools for video trimming, feature extraction, visualisation, configuration file editing, and tools integration have been created by the lead author (H. Dimitrov). The tools used for 2D/3D annotation, video labelling, and calibration are utilised from open-source libraries.

2D video annotation is performed using Google's MediaPipe framework¹⁴. This tool was chosen due to its robust and lightweight implementation, as well as the stable performance in a variety of settings (lights, background, etc.)^{23–25}. However, the standalone 3D model has some performance limitations regarding depth estimation^{25,26}. Therefore, Anipose's approach¹⁵ as utilised for 3D triangulation, video labelling, and integration with DeepLabCut (used for animal models and inclusion of custom markers¹⁷). By leveraging the strengths of these open-source libraries, we aim to extract optimal performance in a variety of conditions, while maintaining modularity for future expansion in the fast-moving MLT field.

One of the biggest challenges for using tools such as MediaPipe¹⁴, OpenPose¹³, or Anipose¹⁵ is their maintenance and the continuously changing behaviour of packages they rely on. This results in installation issues — e.g., incompatibility between package versions within and across different tools as well as issues due to operating systems and silicone. Thus, the approach we take is to package and upload the environments required for these tools, which prevents all of these issues. The disadvantage of this approach is that the user is limited to a particular version of these open-source tools. However, this approach guarantees functionality and maintain installation simplicity, especially since these tools are not updated frequently but the packages that they use are, which can break the system's utility.

Another important part of the MLT process is how to obtain high-quality (and synchronised) recordings, as the results will always depend on video data quality.

Factors like occlusions (either self or external objects/barriers), light conditions, movement speed, lens and recording distortions, clothing, or calibration quality can significantly affect the performance of any markerless (and in many cases optical) tracking. At the same time, we aim to provide the easiest and least demanding setup, which can be used in diverse environments. Thus, we have created a brief manual (see Appendix) aimed at illustrating how to install TrackStudio, record quality videos, perform MLT, and address challenges pertaining to common pitfalls of MLT. In addition, we provide experimental validation of the toolkit across 3 different setups, each introducing its own MLT challenges.

Experimental Validation

Validation Environments

To test the TrackStudio toolkit in realistic and challenging settings, we recorded 76 participants in 3 different setups (seated, supine, and mixed), interacting with different objects. These setups vary in number and type of cameras, tracked body parts, space, light conditions, background, body position, and objects and tasks (creating variations in occlusions). This is aimed to provide evaluation of the performance of the toolkit in variable conditions. The first two environments (seated and supine) involve recordings completed with simple web cameras (Logitec Brio, 1080p, 60Hz) and evaluating the capabilities of a low-cost setup. The third environment involves high-resolution RGB cameras (FLIR Blackfly S BFS-U3-23S3C-C). It aims to evaluate the capabilities of the toolkit for tracking multiple body parts across different body positions (sitting and standing), in a confined space, with multiple tasks, obstructions, and multi-days recordings.

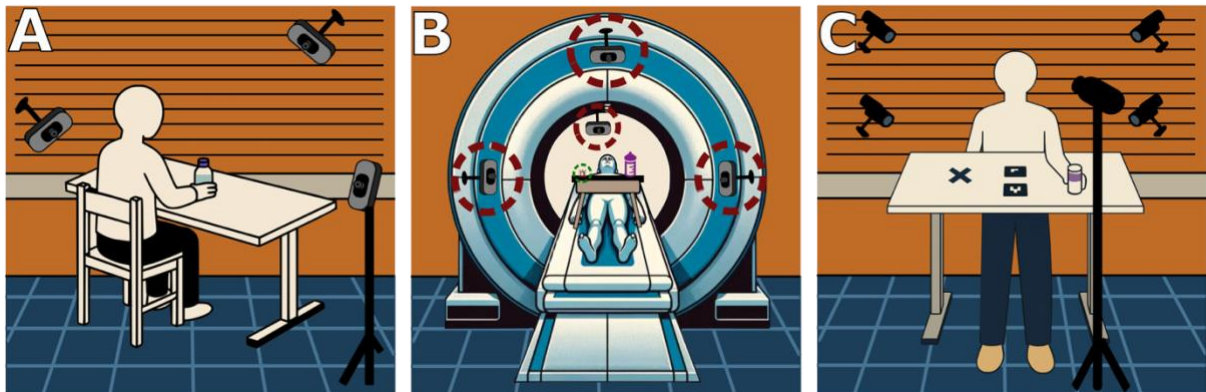

Figure 2. Validation environments, illustrating the sitting setup with 3 web cameras (A), the lying down setup with 4 web cameras (B), and the mixed setup with 5 high-res cameras (C). For the lying down setup, web cameras are circled in red and LED in green for clarity.

The seated environment tested the hand tracking performance across different tasks. The setup consisted of a table surrounded by three cameras, with participants sitting on a chair and performing object manipulation tasks (Figure 2A). The data from this setup represents 45 people (27 female, mean age = 25.2 ± 4.47). Each participant performed a set of three tasks involving challenging manipulations of everyday

objects²⁷. Furthermore, participants also completed the same tasks wearing an augmentation device (The Third Thumb by Dani Clode Designs) on the tracked hand used for object manipulation. This hand-worn device introduces further occlusions to the setup. Each task was repeated multiple times, yielding 10 minutes of video per task and a total of approximately 30 minutes of automatically labelled, tracked videos per participant and condition (with and without wearing an augmentation device). The three cameras were synchronised by the timestamps of the recording computer.

The supine environment tested hand tracking performance in a challenging body position in a constraint, low-light environment. The supine setup took place in a mock MRI room and consisted of four web cameras, with participants lying on the MRI bed being partially positioned inside the bore (only their head and neck). A height-adjustable table with an integrated LED light was mounted on the participants' torso, serving as both a base for object placement and the designated start position of their hands. The LED was used for camera synchronisation (Figure 2C). Participants interacted with 10 different daily-life objects in two distinct ways – performing actions away from the body and towards the body. This setup produced data from 25 participants (12 female, mean age = 42.7 ± 3.91), comprising a total of 10 minutes of auto-labelled tracked video data.

The mixed environment tested hand, upper-body and face tracking across multiple days and with position changes (sitting and standing) within a session. The setup used five high-resolution RGB machine-vision cameras distributed around the testing space. A red LED light was mounted in the upper corner of each camera to ensure video synchronisation. Participants performed seven different object manipulation tasks while sitting at a table and repeated a subset of three of these tasks while standing, with the table height adjusted accordingly (Figure 2B). Here too, the hand augmentation device was worn for the majority (five) of the tasks during sitting and for all of the tasks during standing, imposing an additional occlusion challenge for tracking the biological fingers. This setup was tested on 5 participants (3 female, mean age = 32.7 ± 3.91). Each task was repeated multiple times, producing approximately 10 minutes of video per task. Hence, there was a total of ~70 minutes of automatically labelled, tracked video in the sitting condition and 30 minutes for the standing condition per participant per session. In total, there were 5 sessions in 5 consecutive days.

Testing Setup	Number of Participants	Number of Cameras	Number of Tasks	Recording across days	Tracking Data (per participant/session)	Tracking Type
Seated	45 (27 female, mean age = 25.2 ± 4.47)	3 Webcams (Logitech Brio)	3	Single session only	60 min	Hand
Supine	26 (14 female, mean age = 54.7 ± 12.8)	4 Webcams (Logitech Brio)	2	Single session only	20 min	Hand
Mixed	5 (3 female, mean age = 25.7 ± 3.91)	5 High-Res Cameras (FLIR Blackfly S)	7	5	70 min (sitting), 30min (standing) per session	Hand, upper arm, face

Table 1. Summary of testing setups details.

Pipeline Performance Metrics

To assess the performance of the pipeline, we have focused on quality metrics for MLT (for more details on ground truth comparison, see Tony Hii et al., 2023). The quality metrics are: 1) inter-frame Person's cross-correlation; 2) movement smoothness; 3) 3D error approximation. Inter-frame Person's cross-correlation is at the level of the marker's 3D vector magnitude and is performed between each 5ms of data, discarding the change of direction. We use 5 ms intervals instead of consecutive frames and ignore correlations during changes of direction to avoid artificially high (minimal motion between frames) or low (natural movement reversal) values that do not reflect true tracking performance. The inter-frame cross-correlation per trial is computed by taking the median across all hand markers. Movement smoothness was quantified using the log dimensionless jerk (LDJ) metric. It represents the time- and amplitude-normalised integral of the squared jerk (the third derivative of position), providing a dimensionless measure of motion smoothness^{28,29}. The LDJ per trial is computed by taking the median across all hand markers. As a guideline for interpreting LDJ, previous research indicates that simple actions/object manipulations result in LDJ in the range of 7–10^{30,31} and more complex movements/actions in the range of 11–14³². Lastly, the 3D error approximation is representative of the amount of error incurred during the 3D triangulation. It is computed by calculating the error between the marker predicted by the 2D annotation and the 3D marker reprojected back into 2D space. To calculate this error in meaningful units (instead of camera pixels), we have converted pixels to mm by using the distance between the camera and the tracked body-part and the camera lens' parameters. The error per trial is computed by taking the median across all hand markers. To contextualise acceptable magnitudes, state-of-the-art multiview triangulation methods typically achieve ~13–34 mm mean per-joint position error on human benchmarks^{33,34}. To capture further the number of large errors, we have calculated the percentage of errors that are above 10mm (for hand and face) and above 30mm (for elbows and shoulders), calculated per video frame and expressed as a percentage of the total number of frames. All of the MLT and metrics computation was performed on a standard laptop (Dell G5, Intel Core i5-8300H, Nvidia GeForce GTX 1060, 16GB RAM).

Statistical analysis

All statistical analyses were conducted in JASP (v0.18.3)³⁵ using both frequentist and Bayesian approaches. For each setup, the three metrics (inter-frame cross-correlation, LDJ, and 3D error approximation) were reduced to a single median per subject per condition/task.

For the seated and supine setups, conditions were compared using paired t-tests (i.e., within-participant comparisons tested across participants) with accompanying Bayesian t-tests. For the Bayesian t-tests, the corresponding Bayes Factor (BF_{10}), defined as the relative support for the alternative hypothesis, was reported. We used the threshold of $BF < 1/3$ as positive evidence in support of the null, consistent with previous research^{36,37}. The Cauchy prior width was set at 0.707. Furthermore, agreement between the two fixed conditions (augmentation device worn vs not worn or away vs towards) was assessed using the two-way mixed-effects, absolute-agreement,

single-measure ICC (ICC(3,1)), with ICC < 0.5 = poor, 0.5–0.75 = moderate, 0.75–0.9 = good, and > 0.9 = excellent reliability.

For the mixed setup, for each body part (hand, face, arms), data were examined for consistency across days and between augmentation device conditions (device worn vs not worn) when sitting using both frequentist and Bayesian two-way repeated-measures ANOVAs (factors: Day × Device). If neither analysis indicated reliable effects or interactions, defined as non-significant frequentist results and $BF_{10} < 1$, data were considered stable and averaged across days and task types. This criterion was used solely to confirm measurement stability, as limited-sample Bayesian analyses often produce inconclusive Bayes Factors even when true differences are minimal^{36,38,39}. Descriptive statistics (mean ± SD) of the aggregated data are reported thereafter.

Assumptions were checked via Q–Q plots and Shapiro–Wilk on paired differences (t-tests) or residuals (ANOVA); sphericity was tested with Greenhouse–Geisser correction applied when violated. Where distributional assumptions were materially violated, Wilcoxon signed-rank tests were applied, and z-statistic and Rank-Biserial Correlation were reported instead of t-score and Cohen's d.

Results

To assess TrackStudio's performance with low-cost webcams under different conditions, we examined inter-frame cross-correlation, movement smoothness (LDJ), and re-projection error (absolute and percentage >10 mm) in the seated (Figure 3) and supine (Figure 4) setups. Cross-correlations were extremely high in both configurations (seated: $r = 0.98 \pm 0.004$; supine: $r = 0.999 \pm 0.0001$), indicating smooth transitions and minimal marker jumps, e.g. due to occlusions. LDJ values followed previously reported trends: simple movements yielded lower LDJs (7–10)^{30,31} and more complex actions produced higher values (11–14)³². The supine setup, involving a single object manipulation movement (low complexity), showed an average LDJ of 8.36 ± 0.33 , while the seated setup, which required continuous performance of daily manipulation tasks (higher complexity), registered 10.55 ± 0.36 .

3D error (incurred during triangulation) remained small across participants (seated: $13.6 \text{ mm} \pm 10 \text{ mm}$; supine: $8.95 \text{ mm} \pm 4.1 \text{ mm}$), with very few large errors (seated: $0.58\% \pm 0.17\%$; supine: $0.55\% \pm 0.16\%$). These errors are consistent with state-of-the-art results on human benchmarks^{33,34}. Furthermore, there was no significant effect on error from either the added obstruction in the seated setup ($p = 0.37$, $z = 0.91$, Rank-Biserial = 0.156, $BF_{10} = 0.23$, ICC = 0.67) or the task type in the supine setup ($p = 0.094$, $z = -1.689$, Rank-Biserial = -0.379, $BF_{10} = 0.636$, ICC = 0.95). Likewise, inter-frame cross-correlations did not differ between the two seated conditions ($p = 0.08$, $t = -1.783$, $d = -0.266$, $BF_{10} = 0.69$, ICC = 0.44) or the two supine tasks ($p = 0.248$, $t = -1.183$, $d = -0.232$, $BF_{10} = 0.388$, ICC = 0.56). As expected, LDJ differed significantly within both setups, reflecting the differing movement complexities (seated: $p = 0.006$, $t = 2.886$, $d = 0.43$, $BF_{10} = 6.01$, ICC = 0.49; supine: $p < 0.001$, $t = -4.151$, $d = -0.814$, $BF_{10} = 90.3$, ICC = 0.75).

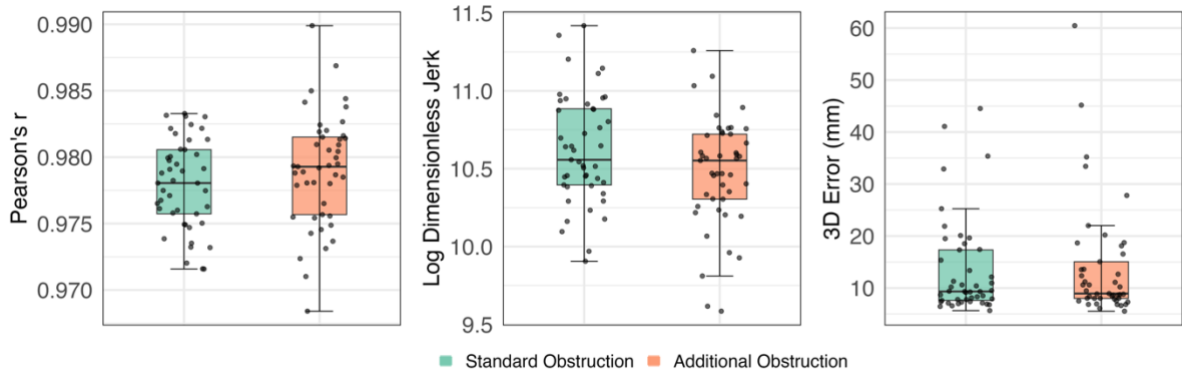

Figure 3. Seated setup analysis plots, illustrating inter-frame cross-correlation, log dimensionless jerk, and 3D error, with colours signifying different conditions.

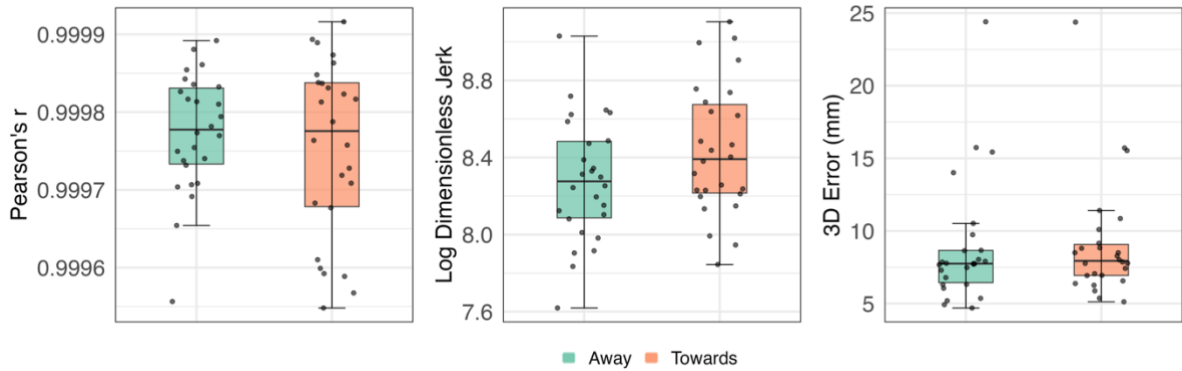

Figure 4. Supine setup analysis plots, illustrating inter-frame cross-correlation, log dimensionless jerk, and 3D error, with colours signifying different conditions.

To explore the benefits of higher-resolution cameras, we evaluated a mixed setup involving sitting and standing tasks, tracking the hand, face, and arms in a confined space over five consecutive days. No significant day-to-day or device-wearing differences were detected ($0.98 > p > 0.14$, $0.09 < BF_{10} < 0.95$), therefore Figure 5 shows participant-wise averages across days. Cross-correlations were again extremely high across all segments (0.999 ± 0.0001). Hand movements showed LDJ values (9.75 ± 0.62) similar to those in the seated webcam setup, reflecting comparable task structure. 3D reprojection error for the hand was the lowest among all setups ($4.41 \text{ mm} \pm 0.53 \text{ mm}$), with almost no large errors ($0.0048\% \pm 0.0016\%$). Errors for face ($9.52 \text{ mm} \pm 3 \text{ mm}$) and arms ($17.6 \text{ mm} \pm 5.65 \text{ mm}$) were higher but still acceptable, likely reflecting the difficulty of tracking facial features and the anatomical size of the elbow and shoulder joint centres. All of the errors still reside within the current results of state-of-the-art approaches tested on human benchmarks^{33,34}.

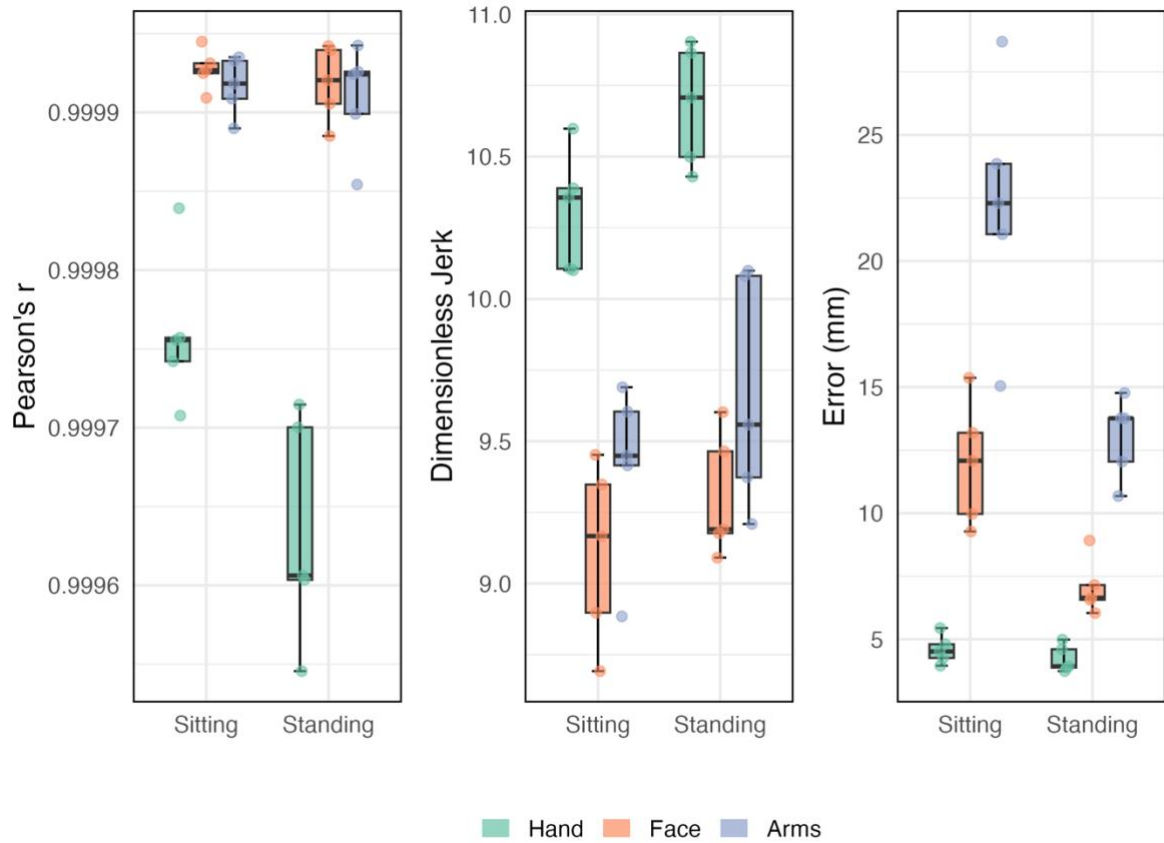

Figure 5. Mixed setup analysis plots, illustrating inter-frame cross-correlation, log dimensionless jerk, and 3D error, with colours signifying different body parts and x-axis denoting different conditions.

Discussion

To move MLT beyond expert use, we aimed to shift the focus from demonstrations of technical accuracy toward expectations of usability, repeatability, and adaptability. The TrackStudio toolkit presented here demonstrates that a streamlined, pre-configured workflow can deliver stable performance across different tasks and environments without the need for technical expertise.

The strength of the pipeline lies not in outperforming task-specific implementations under ideal conditions, but in delivering dependable results across imperfect ones. In many research contexts, the practical barrier is not whether a model can achieve sub-millimetre precision, but whether the pipeline can be deployed with limited setup time and budget, non-specialist staff, and variable recording environments. The current findings suggest that TrackStudio occupies this middle ground effectively: it enables reproducible tracking without requiring control over hardware, room layout, or extensive expertise.

More broadly, the work highlights the importance of reducing not only algorithmic complexity but also procedural friction. Many existing pipelines fail to translate beyond expert labs because the barrier lies in configuration, installation, or uncertainty over

how to align components. By packaging a predefined environment with documentation, defaults, and recovery from common pitfalls, TrackStudio offers practical accessibility to support a broader user base, which struggles with command line interfaces.

At the same time, the toolkit does not preclude expert use and upgrades to its utility. Its modular organisation allows substitution of models for 2D/3D tracking, calibration methods, and extension to additional body regions or multi-person tracking. The preliminary tests of face and arm tracking illustrate this adaptability, even if performance varies with anatomical complexity and marker definition. These differences are expected and highlight where task-specific refinement may be needed if sub-centimetre precision is critical.

There are, of course, boundaries to what a general-purpose workflow can resolve. Highly dynamic full-body motion, setups with severe or unpredictable occlusion, or domains requiring clinical-grade kinematic accuracy may still benefit from tailored optimisation or marker-based systems. Likewise, while the current evaluation covered three representative contexts, they also highlighted some limitations. These environments were still strictly constrained to a single individual within an appropriately sized space. When the space was not appropriately sized, the equipment needed to be improved in order to maintain setup viability – example best represented by our mixed setup. The reason for the high-end cameras for the mixed setup was to improve the cameras' field-of-view and shutter speed. Furthermore, once past three cameras, the more cameras needed for a setup the higher the need for a better video capture and data transfer capabilities of the recording computer. This also affects further the accuracy of camera synchronisation and makes it harder to have a single LED visible by all cameras (hence we used an LED per camera in the mixed setup). Nonetheless, the aim of the present work was not to eliminate the need for specialised solutions, but to make MLT realistically accessible in scenarios where it is currently under-used.

In the near future, we plan to expand the TrackStudio toolkit to different operating systems (Linux-based and MacOS-based), add advanced feature extraction tools, and expand the methods for synchronisation. With this, we hope to expand further the utility and usability of the toolkit as well as improve the camera synchronisation process.

Conclusion

By offering a pre-configured, GUI-based system, that can support diverse recording conditions without bespoke engineering, TrackStudio lowers the threshold for MLT adoption and encourages experimentation rather than discouragement at the setup stage. In doing so, it also opens possibilities for educational activities, pilot work, and exploratory recording where the cost of failure is typically too high to justify time investment. TrackStudio does not represent an optimal system, but rather a practical one: a toolkit that lowers the barrier to entry while remaining adaptable.

Bibliography:

1. Winter, D. A. *Biomechanics and Motor Control of Human Movement*. (John Wiley & Sons, 2009).
2. Roemmich, R. T. *et al.* Interlimb coordination is impaired during walking in persons with Parkinson's disease. *Clinical Biomechanics* **28**, 93–97 (2013).
3. Scataglini, S. *et al.* Accuracy, Validity, and Reliability of Markerless Camera-Based 3D Motion Capture Systems versus Marker-Based 3D Motion Capture Systems in Gait Analysis: A Systematic Review and Meta-Analysis. *Sensors* **24**, (2024).
4. Kanko, R. M., Laende, E. K., Davis, E. M., Selbie, W. S. & Deluzio, K. J. Concurrent assessment of gait kinematics using marker-based and markerless motion capture. *J Biomech* **127**, 110665 (2021).
5. van der Kruk, E. & Reijne, M. M. Accuracy of human motion capture systems for sport applications; state-of-the-art review. *Eur J Sport Sci* **18**, 806–819 (2018).
6. Filippeschi, A. *et al.* Survey of Motion Tracking Methods Based on Inertial Sensors: A Focus on Upper Limb Human Motion. *Sensors* **17**, (2017).
7. García-de-Villa, S., Casillas-Pérez, D., Jiménez-Martín, A. & García-Domínguez, J. J. Inertial Sensors for Human Motion Analysis: A Comprehensive Review. *IEEE Trans Instrum Meas* **72**, 1–39 (2023).
8. Franz, A. M. *et al.* Electromagnetic Tracking in Medicine—A Review of Technology, Validation, and Applications. *IEEE Trans Med Imaging* **33**, 1702–1725 (2014).
9. Mathis, A., Schneider, S., Lauer, J. & Mathis, M. W. A Primer on Motion Capture with Deep Learning: Principles, Pitfalls, and Perspectives. *Neuron* **108**, 44–65 (2020).
10. Kanko, R. M., Laende, E. K., Davis, E. M., Selbie, W. S. & Deluzio, K. J. Concurrent assessment of gait kinematics using marker-based and markerless motion capture. *J Biomech* **127**, 110665 (2021).
11. Scataglini, S. *et al.* Accuracy, Validity, and Reliability of Markerless Camera-Based 3D Motion Capture Systems versus Marker-Based 3D Motion Capture Systems in Gait Analysis: A Systematic Review and Meta-Analysis. *Sensors* **24**, (2024).
12. Wang, J. *et al.* Deep High-Resolution Representation Learning for Visual Recognition. *IEEE Trans Pattern Anal Mach Intell* **43**, 3349–3364 (2021).
13. Cao, Z., Hidalgo, G., Simon, T., Wei, S.-E. & Sheikh, Y. OpenPose: Realtime Multi-Person 2D Pose Estimation Using Part Affinity Fields. *IEEE Trans Pattern Anal Mach Intell* **43**, 172–186 (2021).
14. Zhang, F. *et al.* MediaPipe Hands: On-device Real-time Hand Tracking. *CoRR abs/2006.10214*, (2020).
15. Karashchuk, P. *et al.* Anipose: A toolkit for robust markerless 3D pose estimation. *Cell Rep* **36**, 109730 (2021).
16. Sheshadri, S., Dann, B., Hueser, T. & Scherberger, H. 3D reconstruction toolbox for behavior tracked with multiple cameras. *J Open Source Softw* **5**, 1849 (2020).
17. Mathis, A. *et al.* DeepLabCut: markerless pose estimation of user-defined body parts with deep learning. *Nat Neurosci* **21**, 1281–1289 (2018).

18. RADiCAL Motion. Real-time AI motion capture in your browser | RADiCAL Live. <https://radicalmotion.com/live> (2025).
19. Cheng Wencan and Kim, E. and K. J. H. HandDAGT: A Denoising Adaptive Graph Transformer for 3D Hand Pose Estimation. in *Computer Vision – ECCV 2024* (ed. Leonardis Aleš and Ricci, E. and R. S. and R. O. and S. T. and V. G.) 35–52 (Springer Nature Switzerland, Cham, 2025).
20. Uhlich, S. D. et al. OpenCap: Human movement dynamics from smartphone videos. *PLoS Comput Biol* **19**, 1–26 (2023).
21. TensorFlow. MoveNet: Ultra Fast and Accurate Pose Detection Model. <https://www.tensorflow.org/hub/tutorials/movenet> (2024).
22. MMPose Contributors. OpenMMLab Pose Estimation Toolbox and Benchmark. <https://github.com/open-mmlab/mmpose> (2020).
23. Bittner, M. et al. Towards Single Camera Human 3D-Kinematics. *Sensors* **23**, (2023).
24. Tony Hii, C. S. et al. Frontal Plane Gait Analysis using Pose Estimation Models. in *2nd IEEE National Biomedical Engineering Conference, NBEC 2023* 1–6 (Institute of Electrical and Electronics Engineers Inc., 2023). doi:10.1109/NBEC58134.2023.10352623.
25. De Coster, M., Rushe, E., Holmes, R., Ventresque, A. & Dambre, J. Towards the extraction of robust sign embeddings for low resource sign language recognition. *ArXiv* <http://arxiv.org/abs/2306.17558> (2023).
26. Amprimo, G., Ferraris, C., Masi, G., Pettiti, G. & Priano, L. GMH-D: Combining Google MediaPipe and RGB-Depth Cameras for Hand Motor Skills Remote Assessment. in *Proceedings - 2022 IEEE International Conference on Digital Health, ICDH 2022* 132–141 (Institute of Electrical and Electronics Engineers Inc., 2022). doi:10.1109/ICDH55609.2022.00029.
27. Dowdall, L. et al. Developing a Sensory Representation of an Artificial Body Part. *bioRxiv* <https://doi.org/10.1101/2025.06.16.658246> (2025) doi:10.1101/2025.06.16.658246.
28. Balasubramanian, S., Melendez-Calderon, A. & Burdet, E. A Robust and Sensitive Metric for Quantifying Movement Smoothness. *IEEE Trans Biomed Eng* **59**, 2126–2136 (2012).
29. Flash, T. & Hogan, N. The coordination of arm movements: an experimentally confirmed mathematical model. *Journal of Neuroscience* **5**, 1688–1703 (1985).
30. Bayle, N. et al. Comparison of Various Smoothness Metrics for Upper Limb Movements in Middle-Aged Healthy Subjects. *Sensors* **23**, (2023).
31. Engdahl, S. M. & Gates, D. H. Reliability of upper limb movement quality metrics during everyday tasks. *Gait Posture* **71**, 253–260 (2019).
32. Gulde, P. & Hermsdörfer, J. Smoothness Metrics in Complex Movement Tasks. *Front Neurol* **Volume 9-2018**, (2018).
33. Bartol, K., Bojanić, D., Petković, T. & Pribanić, T. Generalizable Human Pose Triangulation. Preprint at <https://arxiv.org/abs/2110.00280> (2022).
34. Iskakov, K., Burkov, E., Lempitsky, V. & Malkov, Y. Learnable Triangulation of Human Pose. in *International Conference on Computer Vision (ICCV)* (2019).
35. JASP Team. JASP (Version 0.95.4)[Computer software]. Preprint at <https://jasp-stats.org/> (2025).

36. Dienes, Z. Using Bayes to get the most out of non-significant results. *Front Psychol* **Volume 5-2014**, (2014).
37. Wetzels, R. *et al.* Statistical Evidence in Experimental Psychology: An Empirical Comparison Using 855 t Tests. *Perspectives on Psychological Science* **6**, 291–298 (2011).
38. van Doorn, J., Aust, F., Haaf, J. M., Stefan, A. M. & Wagenmakers, E.-J. Bayes Factors for Mixed Models: Perspective on Responses. *Comput Brain Behav* **6**, 127–139 (2023).
39. Keyzers, C., Gazzola, V. & Wagenmakers, E.-J. Using Bayes factor hypothesis testing in neuroscience to establish evidence of absence. *Nat Neurosci* **23**, 788–799 (2020).
40. Anaconda Software Distribution. Computer software. Vers. 2-2.4.0. Anaconda. <https://anaconda.com> (2016).
41. Bailey, H. OBS Project Contributors. *Open Broadcasting Software* <https://www.obsproject.org/> (2017).
42. Kothe, C. *et al.* The Lab Streaming Layer for Synchronized Multimodal Recording. *Imaging Neuroscience* **3**, IMAG.a.136 (2025).

Appendix – TrackStudio Manual

Prerequisites

For installation purposes, the user should already have Anaconda⁴⁰ software installed (<https://www.anaconda.com/docs/getting-started/anaconda/install>).

Before installing TrackStudio toolkit, download the toolkit's files from GitHub (<https://github.com/dimitrov-hristo/Markerless-Tracking-GUI>) and virtual environments files from FigShare (<https://doi.org/10.6084/m9.figshare.30556418.v1>). They must all be in the same folder.

Installation

To install TrackStudio you need to double-click the installation file (install_TrackStudio.bat). The installation process may take up to 40 minutes. In the unlikely event the installer can't automatically find your Anaconda folder, you'll be prompted to enter the path.

During installation (Supplementary Figure 1), the installer will:

1. Set up MediaPipe virtual environment → prompts “press any key” to continue.
2. Set up Anipose virtual environment (this is the longest step) and runs a quick installation test → prompts “press any key.”
3. Update TrackStudio files → prompts “press any key.”
4. Finalise the setup → final “press any key,” and you're done.

Note: The first launch of the GUI may take a few extra seconds while initial variables are created.

The screenshot shows a Windows command prompt window titled "C:\WINDOWS\system32\cmd. x". The output text is as follows:

```
Conda base path found: C:\Users\usrId\AppData\Local\anaconda3
Using Conda base path: C:\Users\usrId\AppData\Local\anaconda3
Current directory is: D:\TrackStudio_GUI_Files
The mediapipe environment directory being set up is: C:\Users\usrId\AppData\Local\anaconda3\envs\mediapipeEnv
Environment for MediaPipe is set. Continuing with setting up the GUI environment.
Press any key to continue . . .
The anipose environment directory being set up is: C:\Users\usrId\AppData\Local\anaconda3\envs\markerlessTrackingEnv
The GUI environment is installing. This can take approx. 20-40 mins.
Running 'anipose' test in environment markerlessTrackingEnv
Usage: anipose [OPTIONS] COMMAND [ARGS]...

Options:
  --version          Show the version and exit.
  --config FILE      The config file to use instead of the default "config.toml".
  --help            Show this message and exit.

Commands:
  analyze
  angles
  calibrate
  calibration-errors
  convert-videos
  draw-calibration
  extract-frames
  filter
  filter-3d
  label-2d
  label-2d-filter
  label-2d-proj
  label-3d
  label-3d-filter
  label-combined
  label-filter-compare
  project-2d
  run-all
  run-data
  run-viz
  summarize-2d
  summarize-2d-filter
  summarize-3d
  summarize-errors
  tracking-errors
  train-autoencoder
  triangulate
  visualizer

*Anipose ran successfully in markerlessTrackingEnv. Continue to path changes.*
Press any key to continue . . .
Current directory is: D:\TrackStudio_GUI_Files
1 file(s) moved.
Successfully updated "batch_executable.bat"
Press any key to continue . . .
1 file(s) moved.
All tasks completed
Press any key to continue . . .
```

Three arrows point from the text to specific parts of the output:

- An arrow points to the first section of the output, labeled "Installing MediaPipe Environment".
- An arrow points to the second section of the output, labeled "Installing Anipose Environment".
- An arrow points to the final section of the output, labeled "Finalising file updates and installation".

Supplementary Figure 1. Installation window visualisation, indicating where each step takes place.

After installation, the TrackStudio GUI can be launched by double-clicking the application file (TrackStudio.vbs). Advanced code information is provided on the GitHub page.

Before You Start: Recording & Organising Video Recordings

Video Recordings

An easy way to record several cameras on one computer is to use OBS (Open Broadcaster Software)⁴¹. Open one OBS window per camera (e.g., three cameras → three OBS windows). Example OBS profiles and settings are available on the project's GitHub.

Naming & Saving Camera Recordings

For a seamless MLT process, always save your video footage in a dedicated directory for video recordings. TrackStudio will mirror your folders (e.g., participant → task → trial), but the lowest-level folder (e.g., trial1) must contain video files only—no notes, images, or other files.

When recording cameras, give each camera a unique name using this format:

- Start with “_” or “-”
- Then “cam”
- Then a letter (a-z) or number (1-9)

3-camera examples: “-camA, -camB, -camC” or “_cam1, _cam2, _cam3”.

You can set the suffixes used for each OBS window in Advanced Settings → Recording and File Formatting (see Supplementary Figure 2).

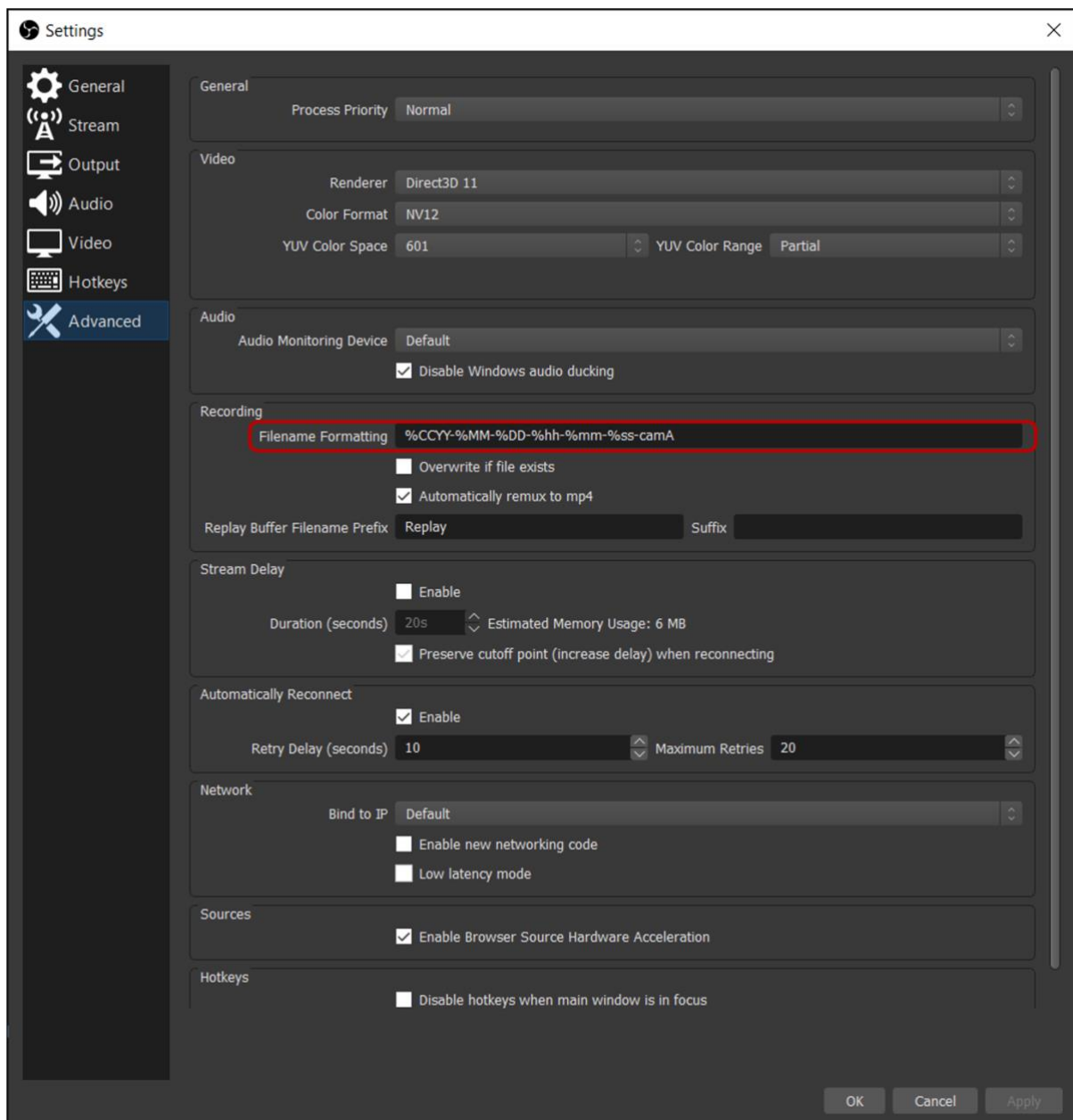

Supplementary Figure 2. Setting section of Open Broadcasting Software (OBS). Each camera recording should have a unique suffix at the end of the recorded file name.

Optional: Using more than 3 webcams

Most users won't need this. For 4+ cameras or high-resolution / high-frame-rate cameras, check:

- Cables/ports: Use cables that support your camera needs (e.g. high-resolution cameras may require USB-C 3.2 Gen 2 or better). Slow cables can cause dropped frames.
- USB port limits: A laptop/desktop might have four USB-C ports but only two internal USB controllers ("boards"), meaning the connections are shared. If video lengths are not matching due to USB speed limitations, add a dedicated USB expansion card (desktop) or reduce the resolution/frame rate per camera.

- Computer performance: Your computer must be able to process and display multiple live video streams and save them to its hard drive. If it can't, video frames may skip at random (these cannot be recovered). *Tips:* Record to a fast SSD, close other apps, reduce previews, and consider lowering FPS/resolution.

Synchronisation

There are two different kinds of synchronisation:

- Event synchronisation – aligning videos with your task events (e.g., trial start/end).
- Camera synchronisation – making sure all cameras show the same moment on the same video frame.

For 3D MLT, camera synchronisation is **essential**. Even a small delay (tens of milliseconds) can break things. For example, camera A shows a hand open, while camera B already shows it closing. If you build a 3D view from those two video frames, the result will be wrong, because the two views are from different moments.

Important note about global computer timestamps

Global computer timestamps are useful for event synchronisation only (matching videos to your task). They do not make cameras aligned with each other. Each camera video is independent when it transfers the data to the computer. Hence, a simple start/stop timestamps can leave cameras out of sync. There are softwares that can extract timestamps for each camera separately (see below).

Ways to Synchronise Cameras

- Software timestamping:
Use of a software tool, such as LabRecorder (<https://github.com/labstreaminglayer/App-LabRecorder>)⁴², to extract separate timestamps per camera and event. Often adequate for slower motions or tolerant tasks, but can be inaccurate for time-critical applications, and cannot be verified.
- Visual or audio cue (recommended):
Use an LED light that turns ON/OFF at known times (e.g. task start/transition/end) and is visible in every camera or use a sharp sound (a beep) recorded by all cameras. This provides a clear, shared timing marker you can see/hear later and verify. If using sound, ensure audio is recorded in the video files.

Best practices for LED sync

- Make sure every camera can see the LED clearly at all times. If not, add more LEDs that switch ON/OFF together. *Tips:* for multiple LEDs, you can place an LED in the corner of each camera, which is not blocking the main view but is always visible.
- Use a dark background behind the LED (e.g. black cloth) so ON/OFF changes are obvious.

- Don't let anything block the LED during ON/OFF events. If it's hidden in any view, syncing and auto-trimming may fail.
- Simple wiring/scripts examples are available on GitHub.

Quick start checklist

- ☐ One OBS window per camera; you can use the provided OBS settings.
- ☐ Name cameras -camA, -camB, -camC (or _cam1, _cam2, ...).
- ☐ If using 4+ cameras: check cable speed, USB bandwidth/limits, and computer performance (fast SSD helps).
- ☐ Choose a sync method if required:
 - For 2D task alignment only → global computer timestamps (does not align cameras).
 - Basic camera sync → software timestamping.
 - Preferred camera sync → LED or sound that's visible/audible to every camera.
- ☐ Record a 10–15 s test. Check for no dropped frames and verify the sync cue occurs on the same frame number in every view.

Record a 1-minute test. Check for no dropped frames and that the sync cue appears in every view (sample script available on GitHub).

Usage

TrackStudio (Supplementary Figure 3) is operated through a graphical interface, but it does not enforce a step-by-step wizard. Hence, complete tasks in order according to your goal:

- If you need 3D Annotation, you must first run 2D Annotation AND Camera Calibration. Make sure that camera views are time-aligned (see *Synchronisation* below).
- If you need to label/export 2D and/or 3D videos, you must first generate the 2D and/or 3D Annotation for them.

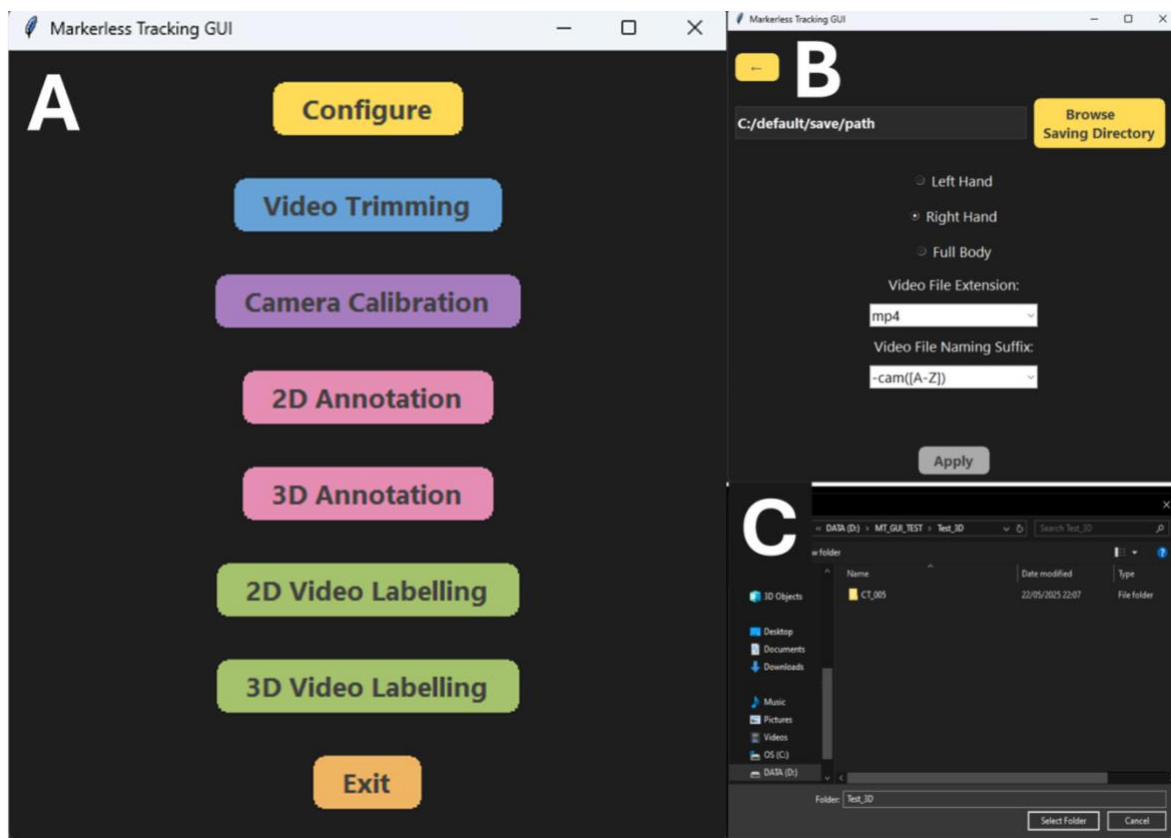

Supplementary Figure 3. TrackStudio GUI. **A)** TrackStudio main window. **B)** Configuration section of TrackStudio GUI. **C)** Example of prompt to select input directory (e.g. for Automatic Video Trimming, 2D/3D Annotation, or 2D/3D Video Labelling).

Selecting Saving Directory for TrackStudio

TrackStudio is designed to handle any folder structure you have for your data, as long as you have **video recordings only** in the final folder (e.g. “Task 1”, see Supplementary Figure 4). When you choose a Saving Directory in the GUI, there can be two instances:

1) First time using this folder – new Saving Directory (Supplementary Figure 4A)

- If you’ve never run TrackStudio in the selected directory, the first processing step you run (e.g., Video Trimming or 2D Annotation) will:
 - Recreate your original folder structure (e.g., participant → task → trial) inside the Saving Directory, and
 - Saves trimmed videos there (if Video Trimming is first selected) or copies your video files into the directory (if 2D Annotation is selected).
- Your original files stay where they are (Supplementary Figure 4A – “Original Recording Directory”). TrackStudio works from the trimmed videos or copies (Supplementary Figure 4A – “New Empty Saving Directory”).

2) Continuing in an existing MLT folder (Supplementary Figure 4B)

- This folder already has results from Video Trimming and/or 2D Annotation and later steps.
- TrackStudio will use it as your working folder and save any new results alongside the existing ones.
- No new directories are created.

Tips:

- Choose a fast drive (SSD) for your Saving Directory to reduce processing time.
- Make sure there is enough free space (videos are copied the first time) – TrackStudio will notify you if larger files are moved.
- Keep the lowest-level folders video-only to avoid import problems.

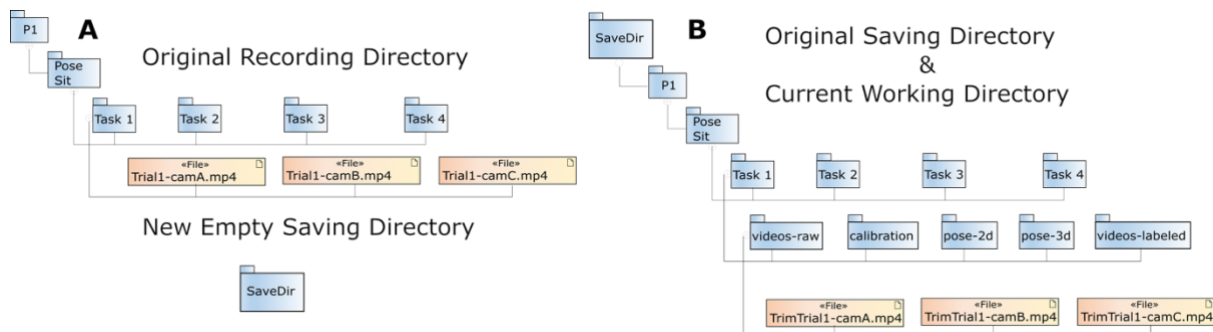

Supplementary Figure 4. Examples of the two cases for selecting a “Saving Directory”.

A) An example of the beginning of the MLT process, where no steps have been executed and an empty folder is chosen as the “Saving Directory”. B) An example of a “Saving Directory” where some MLT work (calibration, 2D & 3D annotation, and 2D video labelling) has already been done. If TrackStudio is re-opened and the user wants to complete, for example, 3D video labelling for all of the files that they have previously worked on, they should choose this “Working Directory” as a “Saving Directory”.

Steps for Markerless Tracking with TrackStudio

TrackStudio includes several tools (“windows”). You only use the ones you need, but some steps depend on others:

- 2D Video Labelling requires 2D Annotation first.
- 3D Annotation requires Camera Calibration and 2D Annotation.
- 3D Video Labelling comes after 3D Annotation.
- 2D/3D Video Labelling is optional—skip it if you don’t need labelled videos for visualisation.

You can stop at any time and resume later; your progress is saved in your Saving Directory. For instance, after completing the Camera Calibration, you can close the GUI and proceed with 3D Annotation next time you open TrackStudio, by selecting the same Saving Directory.

When TrackStudio first opens, only Configure and Video Trimming are enabled. Complete Configure to unlock the other steps.

Below are all the steps pertaining to MLT using TrackStudio:

- 1) **(Always Necessary on Launch!) Configure** – every time you open the GUI, you need to complete a configuration step (see Supplementary Figure 3A and B), consisting of selecting:
 - a. Saving Directory - location where TrackStudio will store all your results (see “Selecting Saving Directory for TrackStudio” above).
 - b. Body part to track – Right Hand, Left Hand, or Full Body. If you want to track multiple body parts, then you will need to go through all the MLT steps for each body part separately.
 - c. Video file extension – e.g. .mp4 or .mkv (match what you have recorded originally for your video files).
 - d. Camera name suffix – the text at the end of the recording name that identifies each camera file. For example, if you have 3 cameras and your Trial1 names are “Trial1–camA.mp4”, “Trial1–camB.mp4”, and “Trial1–camC.mp4”, then the file naming suffix is going to be “–cam([A-Z])”.

Once the configuration is completed click “Apply” and go back to Start Menu.

- 2) **Video Trimming** – use this if you need to trim your videos and/or synchronise them using an LED(s) light. When you click Video Trimming, choose a mode:
 - a. **Manual**
 - Pick a video, set start and end frames (use the arrow controls or type a number), then click **Trim**.
 - The trimmed video is saved under videos-raw/ inside your Saving Directory (TrackStudio mirrors your original folder structure)
 - Repeat for the next video.
 - b. **Automatic (Lights)** – see “Best practices for LED sync” above
 - Based on detecting a red LED light turning ON at the start and OFF at the end of a trial/event.
 - Choose a folder (a participant folder, a trial folder, or anything in between). TrackStudio will scan and trim all videos in subfolders.
 - Click Select ROI (Region of Interest) – see Supplementary Figure 5. For each camera view:
 1. A frame appears. Draw a small square around the LED.
 2. Press Enter to move to the next camera view and repeat.
 3. When all cameras are marked, you will see “ROI Selected” – click Trim.
 - Trimmed videos are saved under videos-raw/ in your Saving Directory.

Advanced options for Automatic (Lights) video trimming

- Multiple trims within a video – set how many ON–OFF trials/events are inside one long recording. It will trim that number of videos.

- Recording length (in seconds) – enter a fixed duration if every trial/event has the same length (improves cut accuracy).
- Light On threshold (0–255) – increase if your LED is dim; 255 is pure bright red.

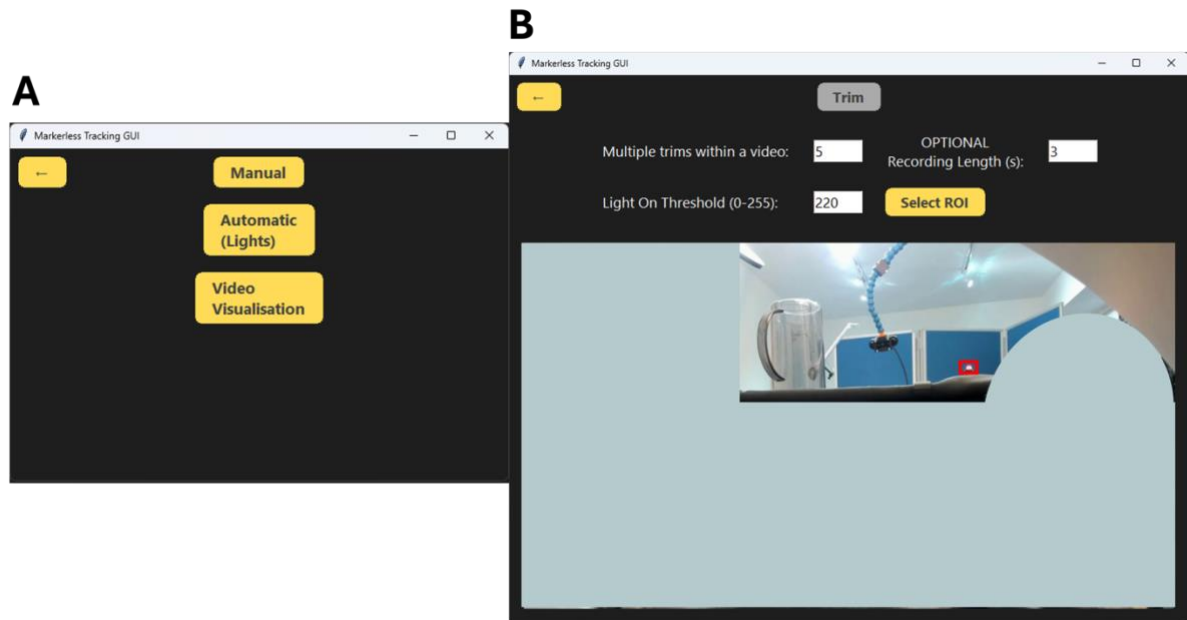

Supplementary Figure 5. TrakStudio's Video Trimming window (A), with the Automatic (Lights) window (B) illustrating LED region selection and optional trimming settings.

- 3) Camera Calibration (required for 3D) – the Camera Calibration window, contains 2 sub-windows “**Change Board Parameters**” and “**Calibrate**”:
 - a. **Change Board Parameters** – select only if you used a non-default calibration board (size, type, etc. – see Anipose documentation for details: <https://anipose.readthedocs.io/en/latest/params.html>). It will allow you to specify your calibration board parameters in a graphical way (no coding needed).
 - b. **Calibrate** – select the folder with your calibration videos. Track studio will estimate each camera's distortion and alignment parameters. During calibration:
 - GUI window will display calibration progress messages.
 - Once complete, final calibration error will be displayed
 - A calibration file (calibration.toml) containing camera parameters is saved in a calibration/ folder inside your Saving Directory (and updated in TrackStudio). your saving directory as well as update this file in your TrackStudio directory.

IMPORTANT:

- Do this before 3D Annotation
- Quality matters: poor calibration footage can cause calibration to fail or result in highly inaccurate 3D Annotation. The Calibration Practical

Recommendation section provides guidance on achieving reliable, high-quality calibration recordings.

- If you record multiple calibrations per participant (e.g. seated vs standing camera positions), you have to work in the sub-directory of each of the calibrations for “Calibration” and the following “3D Annotation” and later steps for that participant. For example, run Standing calibration → 3D Annotation (standing tasks) before you do the Seated calibration. If you do Standing calibration → Seated calibration → 3D Annotation (standing tasks), TrackStudio will use the Seated calibration and the standing 3D results will be wrong.
- 4) 2D Annotation – this step performs 2D MLT and creates files containing 2D coordinates of virtual markers corresponding to the body part you have chosen in the configuration section.
- Select a folder that contains your trimmed (and synchronised if 3D required later on) videos.
 - Outputs are saved in your Saving Directory, mirroring your original structure and adding the needed subfolders for the underlying open-source tools.
- 5) 3D Annotation – combines 2D Annotation results across cameras (using your calibration) to produce 3D coordinates.
- Requirements: 2D Annotation and a matching Calibration completed for the selected folder directory.
 - Select a folder (within your Saving Directory) that shares one calibration. For example:
 - If Participant_001 used one calibration for all tasks, select the Participant_001 folder for calibration and 3D Annotation.
 - If Participant_001 used multiple calibrations within a session (e.g. seated vs standing), run Calibration and 3D Annotation per task within the task’s folder (e.g. Participant_001/Seated/).
- 6) 2D Video Labelling (optional) – overlays 2D Annotation results onto their respective videos, visualising the results of the tracked body parts.
- Select the folder (within your Saving Directory) that contains the 2D Annotation results for the videos you want to review.
 - Useful for quality checks; not required for 3D Annotation.
- 7) 3D Video Labelling (optional) – creates a tiled video showing the original views with overlaid 3D Annotation results for visualisation.
- Select the folder (within your Saving Directory) that contains the 3D Annotation results for the videos you want to review.
 - Note: if a recording used more than 4 cameras, the combined preview shows overlays on the first 4 views only (a limitation of the underlying video tiling library). Your 3D data is still computed from all the cameras you used.

For advanced users and developers, the GitHub page explains how each script works and how to adjust or extend TrackStudio (e.g., to swap in another 2D/3D tracking method).

Practical Recommendations

Visibility & Camera Views

- Minimise occlusions whenever possible.
- Do a short test, recording complete task movements, and decide how many cameras are needed to fully capture all movements in the space.
- For 3D MLT, the tracked body part must be visible in at least two camera views at all times. Hence, at least 2 cameras are needed but it's recommended to use 3 or more.
- Full-body or complex movements will require a higher number of cameras and a larger space for recording, with cameras evenly distributed around the room and positioned at different heights.

Frame Rate & Hardware

- For rapid movements, high frame rate cameras (120–240 fps) are advisable to reduce motion blur and maintain stable tracking.
- More/higher-end cameras increase load: you'll need fast USB 3.x ports, a strong CPU, and often a GPU for smooth preview (see "Video Recordings").
- If the system can't keep up, you'll get dropped frames (lost data).

Lighting & Clothing

- Keep the space well-lit and avoid shadows, especially during calibration.
- Avoid loose clothing or patterned fabrics – they may interfere with body landmark detection, similar to challenges in optical tracking.
- Prefer simple, well-fitting clothes (e.g., scrubs), especially for full-body recordings

Recommendations for Improving Calibration Video Recordings:

- 1) Ensure the environment is well-lit. Poor lighting can prevent the calibration board from being properly detected.
- 2) Avoid reflections on the printed calibration board. Glossy paper, clear tape, or laminating the board may introduce reflections that interfere with detection.
- 3) Verify the calibration board is printed at the correct scale and with high contrast. Some printers automatically resize prints to fit the page, which may compromise calibration accuracy. The dark areas of the board should be fully black to enhance feature detection.
- 4) Leave sufficient margins for holding the board. This prevents hand occlusions. Mounting a handle at the back of the board is recommended.
- 5) Use a ChArUco calibration board. This type is more tolerant to occlusions and partial views. Not all board corners must be visible in every camera view.

- 6) We recommend recording calibration videos for at least 1 minute per camera. For example, with three cameras, a total calibration duration of approximately 3 minutes is advised.
- 7) Monitor the recording during calibration. Position the board so that all cameras have an unobstructed view. This should be your starting and ending position.
 - a. Begin recording and keep the board visible to all cameras for approximately 20 seconds.
 - b. Then, move the board closer to one camera at a time. Each up-close view should be visible to only one camera at a time (avoid partial board views in neighbouring cameras).
 - c. During the up-close phase, hold the board steady, then gently rotate it to capture different angles and lighting conditions. Spend about 40 seconds to 1 minute per camera.
 - d. After each close-up, slowly move the board backwards until it is fully visible in two cameras. Hold it in this position briefly and rotate it slightly to capture various perspectives (while avoiding partial detections).
 - e. Repeat the process for each camera so that all cameras record both up-close and shared views (e.g., A+B, B+C, A+C).
 - f. Finally, return to the starting position where all cameras can see the full board, and slowly rotate it again.