

Designing Beyond Language: Sociotechnical Barriers in AI Health Technologies for Limited English Proficiency

Michelle Huang

University of Illinois Urbana-Champaign
Urbana, Illinois, USA
mh106@illinois.edu

Koustuv Saha*

University of Illinois Urbana-Champaign
Urbana, Illinois, USA
ksaha2@illinois.edu

Violeta J. Rodriguez

University of Illinois Urbana-Champaign
Urbana, Illinois, USA
vjrodrig@illinois.edu

Tal August*

University of Illinois Urbana-Champaign
Urbana, Illinois, USA
taugust@illinois.edu

Abstract

Limited English proficiency (LEP) patients in the U.S. face systemic barriers to healthcare beyond language and interpreter access, encompassing procedural and institutional constraints. AI advances may support communication and care through on-demand translation and visit preparation, but also risk exacerbating existing inequalities. We conducted storyboard-driven interviews with 14 patient navigators to explore how AI could shape care experiences for Spanish-speaking LEP individuals. We identified tensions around linguistic and cultural misunderstandings, privacy concerns, and opportunities and risks for AI to augment care workflows. Participants highlighted structural factors that can undermine trust in AI systems, including sensitive information disclosure, unstable technology access, and low literacy. While AI tools can potentially alleviate social barriers and institutional constraints, there are risks of misinformation and reducing human-to-human interactions. Our findings contribute AI design considerations that support LEP patients and care teams via rapport-building, educational and language support, and minimizing disruptions to existing practices.¹

CCS Concepts

• **Human-centered computing** → **HCI design and evaluation methods**; *Natural language interfaces*.

Keywords

healthcare, limited English proficiency (LEP), Artificial Intelligence (AI), storyboards, interviews, patient navigators

1 Introduction

Patient-provider communication is strongly linked to health outcomes and quality of care [13, 106, 138]. Effective communication builds therapeutic relationships, satisfaction, trust, and long-term health outcomes [53, 138], while poor communication contributes to errors, compromised patient safety, and inefficient use of resources [143, 148]. Language barriers in particular can exacerbate these challenges. In the U.S., over 25 million individuals aged 5 years and older report speaking English less than “very well” [146]. These individuals with limited English proficiency (LEP) are more likely

to experience misdiagnoses, medication complications, poorer adherence to treatment plans, and decreased comprehension of diagnoses [27, 44, 46, 143]. Consequently, patient-provider communication, relationship-building, and shared decision-making break down [44, 109], reducing both patient and provider satisfaction [5].

Digital health technologies, such as telehealth, online patient portals, and mobile health applications, can facilitate asynchronous communication and on-demand information access, which in principle could improve the quality and convenience of healthcare by enabling continuous and accessible support [39, 41, 92]. However, LEP populations underutilize these resources due to persistent implementation barriers such as low digital and health literacy, unreliable Internet access, and ethical and privacy concerns [3, 77, 92, 104, 112]. Even technologies designed specifically to accommodate LEP individuals, such as multilingual patient portals, are often poorly integrated or have limited functionalities, thus discouraging use [11].

Emerging AI-powered health technologies have the potential to provide personalized and timely medical support and translation [47, 71, 98], enabling LEP patients to engage with the healthcare system more effectively. For example, on-demand AI translation can facilitate patient-provider conversations [97], and new large language model (LLM)-powered chatbots can summarize and simplify complex medical information [52] or help patients prepare for visits [90, 123]. However, most AI-powered interventions target digitally literate, English-speaking patients [69, 101], and the underlying models generally struggle to adapt to marginalized cultural [124] and language backgrounds [18, 125]. Furthermore, little is known about how AI interventions should be designed and governed when language barriers intersect with cultural norms, privacy fears, and low literacy, especially in contexts where human intermediaries (e.g., patient navigators) already play a critical role. Therefore, the rapid deployment of such AI health interventions risks replicating or further exacerbating existing disparities [3].

In this paper, we seek to understand the risks and opportunities that AI health interventions pose for LEP patients, guided by the following research questions (RQs):

RQ1: How can linguistic, cultural, or sociotechnical factors shape how LEP patients perceive health technologies?

RQ2: How can AI health technologies facilitate culturally responsive, trustworthy, and effective communication and collaboration between LEP patients and healthcare teams?

*Both authors are advisors of this work.

¹Supplementary materials available at <https://github.com/mhuang412/designing-beyond-language>

To address the above RQs, we conducted 14 storyboard-centered interviews with individuals who support Spanish-speaking LEP individuals receiving care in the U.S. These individuals, whom we collectively refer to as *patient navigators*, assisted patients in various ways, including accompanying them to provider visits, translating, teaching digital skills, and bridging resources. Their role as mediators between patients and providers lends them insights into the broader contexts and relational dynamics that shape LEP patient experiences. Consequently, they build on their experiences to reason about the feasibility and risks of developing AI technologies to facilitate equitable communication and care.

From these interviews, we identified key communication and systemic challenges that Spanish-speaking LEP patients face, such as low literacy and privacy concerns. These challenges also highlighted possible risks and opportunities for using AI, such as reducing social barriers to care while potentially diminishing existing human support. Our findings underscore the importance of adapting to cultural and linguistic nuances, overcoming various types of literacy barriers, and respecting user privacy to foster trust. These findings inform practical guidelines for developing AI tools that support LEP populations. Our contributions are summarized as follows:

- First, we illuminate cultural, communication, and structural challenges faced by Spanish-speaking LEP patients, their providers, and patient navigators.
- Second, we identify both perceived risks and opportunities for AI to support patient experiences.
- Third, we propose design guidelines and opportunities for AI tools that support patient access to healthcare resources and mediate culturally sensitive interactions.

Together, these contributions aim to inform when to—and when not to—develop AI health interventions and how to do so in a way that is attuned to the needs of linguistically and culturally diverse patient populations.

2 Related Work

2.1 Mediating Clinical Communication with LEP Individuals

Effective healthcare requires two-way communication in which providers contribute medical expertise and patients share their needs and preferences [65, 154]. Strong interpersonal communication has been shown to influence patient outcomes as much as, if not more than, clinical instruction [16], leading to improved adherence to treatment plans [138], understanding of diagnoses [76], and satisfaction [122]. Conversely, impeded communication is linked to more errors [143], worsened decision-making [109], and lower rates of physician visits and preventive services [42, 66, 155]. For LEP individuals, these challenges are compounded by linguistic [127], cultural [82], intersectional [111], and procedural [45] barriers. Therefore, there is growing interest in improving health outcomes by studying communication strategies that integrate patients' lived experiences and values [25, 128].

Research shows that language-concordant care, whether via direct communication [99] or interpretation [36, 38], leads to fewer communication errors [73] and higher satisfaction and perceived

quality of care [32] for LEP individuals. Despite these benefits, interpretation services remain underutilized due to barriers such as limited availability, cost, time constraints, and policies [67, 68, 79]. Even when interpretation is available, institutional policies can constrain interpreters to verbatim translation rather than clarification or advocacy, leaving unresolved misunderstandings and limiting relationship-building—conditions that shape what AI can realistically improve. Beyond linguistic access, broader sociocultural factors complicate LEP communication. Patients may self-censor due to stigma, fear of judgment, or mistrust of institutions [37, 84]. These dynamics highlight the need for cultural sensitivity, empathy, and attention to the broader contexts of patients' lives. Patient navigators and community health workers (CHWs) function as critical infrastructure for marginalized communities, supporting interpretation, care coordination, documentation, and advocacy [78]. Prior work highlights how these roles reduce access barriers but also create invisible labor and emotional burdens [147]. Thus, understanding how AI might support or destabilize this ecosystem is necessary for equitable deployment.

2.2 AI Tools in Healthcare

Recent AI advancements have potential to support healthcare systems by improving clinical decision-making and workflows, resource allocations, medical imaging, patient monitoring, medical translations, and patient-provider relationships [17, 81, 94, 130]. However, prior work has also identified key challenges and risks when implementing AI for healthcare, including data privacy, lack of transparency in decision-making, misinformation, bias mitigation, and cultural sensitivity [24, 26, 48, 62, 94, 135, 161].

AI has potential to support marginalized communities in receiving care by overcoming language barriers, providing personalized health information, and offering support in rural or low-resource areas [47, 74]. Barwise et al. [17] explored patients' perception of using predictive models for interpreter prioritization and Mehandru et al. [97] used physician-in-the-loop methods to improve reliance of machine translation in settings where no human translators were available. Other work has also explored using chatbots for pre-clinical consultations [90, 123] and helping patients read physician notes [72], discharge instructions [163], and medical information [52]. While AI presents many exciting possibilities to support patient care, the majority of such interventions are focused on English or translating into English, posing issues for low-resource languages such as reinforcing biases and overlooking cultural and infrastructural challenges that may cause AI to exacerbate rather than alleviate inequities in underserved populations [64, 152, 162]. The LLMs driving much of current AI developments are known to encode biases on race [56, 125], gender [33], language [7], and culture [124]. While these challenges and biases are known, there is work needed to determine if and how AI can be designed for LEP communities while taking into consideration current model limitations and existing healthcare support systems.

2.3 Considerations for Health Technologies in Marginalized Communities

While digital health technologies generally expand access to care [6, 117, 139], they are often underutilized by LEP patients [49, 58,

104], thus exacerbating existing inequalities [89, 160]. For example, during and after the COVID-19 pandemic, LEP patients utilized video visits and online patient portals at a lower rate than English-proficient patients [121].

Several structural factors impede health technology access and utilization for LEP individuals. Limited reading, digital, and health literacy can restrict meaningful engagement with digital tools [82, 136], yet digital health literacy is key to realizing equitable advancements in healthcare [22]. Prior work in HCI also highlights the need for AI technologies to be culturally sensitive [31, 150] in order to be more trustworthy and accessible to marginalized users. Furthermore, LEP populations face generally lower rates of access to technology [55], but even when access is available, they report distrust in digital services and difficulty understanding privacy policies [140], fueling their hesitation in adopting technology that solicits their personal information. Recent legal actions and policies in the U.S. have compounded these concerns [43, 108], underscoring the need to prioritize privacy and trust in equitable technology design. There are, however, community-based health service approaches that have proven to be accessible and productive for LEP individuals. SMS programs, WhatsApp groups, and CHW-linked tools used by Latino immigrant communities have been shown to support self-management and information access [4, 10].

In consideration of the barriers, benefits, and risks for technology to support LEP individuals in healthcare, it is important to understand how these technologies can be implemented equitably and safely [110]. There is little recent work that explores all of these factors together for LEP populations in particular. Accordingly, we report our findings around the barriers and experiences that LEP individuals may face when receiving healthcare, and in what ways AI technology can be designed to facilitate communication with their healthcare teams.

3 Methods

3.1 Study Context

In this study, we interviewed patient navigators who support Spanish-speaking LEP individuals when interacting with healthcare systems in the U.S. We focused on patient navigators, rather than patients themselves, because as we reflected on the tensions involved in conducting research with a marginalized community (in this case, LEP individuals seeking care), we were concerned that starting with LEP individuals might risk perpetrating further harm to the community by taking data and information and providing little in return [87]. Speaking directly with patients at the outset could also risk misrepresenting or excluding key aspects of their experiences if we failed to frame the right questions or if patients were hesitant to disclose sensitive information, especially since the lead researcher in the study was not themselves a part of this community (Section 3.7). In contrast, patient navigators routinely accompany many patients through the care-seeking process, providing crucial perspectives that surface both recurring experiences and specific incidents that reveal how patients engage with healthcare and technology. Talking to navigators allowed us to gain an understanding of the culture and background of LEP individuals, identify potential avenues for giving back to the community (e.g., presenting at community events, conducting follow-up design workshops), and

build relationships with these communities for further research into technologies that are sensitive to the needs and lived experiences of LEP individuals. We recognize that navigators themselves may also be part of LEP communities or other marginalized groups. Accordingly, we worked closely with three navigators to provide feedback on pilot studies and assess what value such a study might bring to navigators. We discuss future work building on our findings to bring benefits of new AI health tools to both LEP individuals and patient navigators (Section 5).

Initial feedback from navigators was that LEP individuals vary widely in their care experiences due to the range of languages, backgrounds, and cultures. In response to this feedback, we focused on Spanish-speaking LEP individuals for two reasons: Spanish is by far the most commonly spoken language at home after English in the U.S. [146], and the majority of organizations we worked with focused primarily on Spanish speakers, giving us greater access to navigators and community resources with this population. However, as we will further discuss in our findings (Section 4.1), even with a shared language, individuals had varying experiences and identities (e.g., be immigrants from various countries or U.S.-born). In the rest of this paper, we refer to Spanish-speaking LEP individuals as just *LEP individuals*, for simplicity.

3.2 Study Design

3.2.1 Interest survey. Interested patient navigators completed an online screening survey that asked for demographic information, including age range, gender, ethnicity, occupation, organization, years of relevant experience in their roles, and languages spoken. We also adapted a 5-question basic AI literacy questionnaire [51] in the interest form (see Appendix A). After completing the survey questions, participants signed up for a 60-minute interview within the next week. A copy of the consent form was included for the participants to review and sign before the interview.

3.2.2 Storyboard interviews. We conducted 60-minute semi-structured storyboard interviews over Zoom with patient navigators who filled out the survey. All interviews were conducted in English. Participants were compensated with a \$20 Amazon gift card at the completion of the study. This study was approved by our organization's Institutional Review Board.

Each interview began with questions about the navigator's background, job responsibilities, and the characteristics of the patients they typically supported. We also asked about challenges they face in their role and challenges their patients face in order to identify pain points in current practices and relationships between Spanish-speaking LEP patients, navigators, and providers as opportunities for AI intervention. We then extended these discussions to consider possible outcomes of integrating AI tools in patient care.

Participants exhibited a range of knowledge on AI and ways in which they interacted with LEP individuals. To establish common ground across participants [30], we structured our interviews around six pre-defined storyboards. Storyboards can solicit immediate reactions and underlying needs probed by the hypothetical scenarios depicted [30, 57, 75]. These storyboards surfaced participants' reactions and concerns towards potential AI systems, use cases, and patient responses that they might not otherwise think of. We explored the use of AI systems in various stages of care (e.g.

before, during, and after provider visits) and in various capacities (e.g. translating, explaining, comforting).

For each interview, we screen-shared a slide deck with images of the storyboards. Participants were informed that the goal of the study was to understand their experiences with patients as a patient navigator and their perceptions of potential AI technologies. Storyboards were randomly ordered for each participant to control for potential bias introduced by ordering effects. For each storyboard, we asked if the storyboard was relatable to them and what their immediate reactions were. Then, follow-up questions were asked based on their responses or drawn from a semi-structured interview guide (available in the supplementary materials) as needed. Follow-up questions included: *What are challenges that patients face during provider visits? How do patients generally seek medical information? How often do patients consider data privacy, whether online or offline?*

3.3 Storyboard Construction

Following prior health-focused studies in HCI [75, 164], we constructed the storyboards using an iterative method drawing from existing literature and our research team's expertise (Section 3.7). We synthesized 34 papers across HCI, AI, and medical journals that propose use cases, risks, and benefits of AI in healthcare and for LEP individuals in particular. Then, a clinical psychologist and expert in health equity for under-served populations, in particular Spanish-speaking communities, reviewed proposed storyboards to ensure they were comprehensive, realistic, and would elicit meaningful discussions. We consolidated storyboards in six dimensions covering possible applications of AI health technologies for LEP patients (see Table 1). These dimensions included AI performance (linguistic nuances and reliability of information), ease of use (for patients and within clinical workflows), and systemic factors (access to technology and ethical concerns). Each dimension was used to create a 4-panel storyboard scenario that followed the same general structure: 1) patient encounters a challenge, 2) AI tool is introduced as a potential solution or support, 3) effects (either positive or negative) of AI emerge, and 4) patient reflects on the interaction with AI. Two example storyboards are shown in Figure 1, and all storyboards are provided in the supplementary materials. A version of each storyboard with English translations was available for participants with limited Spanish proficiency.

All storyboards depict patients as the direct users of AI (except for the "Language & Communication" theme in which a patient and navigator interact with AI together) because we initially centered this work around AI design considerations for LEP patients in isolation since this group is often left out of technology design. However, navigators later revealed barriers that complicate this reality, as further discussed in Section 5.1 and Section 5.3. Furthermore, we intended for the scenarios to have a mix of positive and negative outcomes to encourage participants to consider the tensions between the benefits and risks of AI for LEP patient care. We strove to depict realistic AI-based current commercial or prototype systems (e.g. translation systems, chatbots). However, since storyboards inherently depict imagined rather than observed behavior, we intended to use them to elicit expectations, concerns, and situated judgments. This limitation is further discussed in Section 5.4.

3.4 Recruitment

We initially recruited navigators from two community non-profits that one of our research team members had prior connections with. We drafted the recruiting email and flyer that the point of contact at each organization distributed to their staff and organizational networks for voluntary sign-ups. These flyers and emails contained a link to the interest survey (Section 3.2.1).

With the intention of gaining a holistic understanding of navigator and patient experiences, we aimed to interview patient navigators who worked across a diverse set of roles (e.g. interpretation, digital literacy, case management) and Spanish-speaking communities (e.g. children vs. adults, immigrants vs. U.S.-born, literate vs. illiterate). With this in mind, we also cold-emailed several other organizations in the region that provided health-adjacent services to Spanish-speaking populations. Eligibility criteria for scheduling an interview included being willing to participate in an interview, being able to communicate in English, and having experience directly interacting with Spanish-speaking patients in some capacity. We conducted interviews until data saturation was reached and no new information was collected (Section 3.6).

3.5 Participants

We recruited 14 patient navigators (8 female, 6 male) who supported Spanish-speaking LEP patients in the U.S. Participant roles included patient advocates, health liaisons, caseworkers, medical students, and interpreters. Participants came from eight distinct organizations, including medical schools, local community non-profits, and public school districts. Most of these organizations specifically serve, or at least have strong ties to, the Spanish-speaking or broader immigrant communities in their local areas. Therefore, patients either actively seek support from these organizations or are referred to them by word-of-mouth. The communities that these 14 participants work with generally consist of first- or second-generation immigrants from Hispanic countries. Because many of these LEP immigrants are undocumented, tightened immigration policies in the U.S. have led to greater institutional distrust and fear that disclosing their personal information may lead back to immigration enforcements. Therefore, navigators spent considerable efforts helping these individuals overcome barriers due to their status, such as applying for health insurance without a social security number.

These navigators also represent organizations with diverse medical care practices and resources. For example, some organizations allowed the use of ad hoc interpreters, while others required strictly professional interpreters. Some clinics had access to interpreters for low-resource languages like Q'anjob'al, while other clinics struggled to access even common languages like Spanish. Although we did not intentionally recruit patient navigators with similar cultural backgrounds as Spanish-speaking LEP individuals, 12 out of 14 participants reported speaking English and Spanish as their primary languages and having strong ties to the communities as first- or second-generation immigrants. We conducted interviews in English to align with participants' professional working language and to reduce risks of misinterpretation in analysis. See Table 2 for a full breakdown of participants' demographics and roles.

Though not a requirement to participate in the study, participants also exhibited fairly high degrees of familiarity and proficiency with

Table 1: Storyboard themes with motivating questions and supporting literature.

Dimension	Motivating Ideas	Relevant Literature
Language & Communication	Can AI support accurate and productive conversations? Can AI capture cultural and semantic nuances?	[7], [12], [47], [52], [72], [90], [97], [163]
Relationality & Comfort	Can patients interact with AI comfortably? Can AI cater to the patient's specific needs and background?	[18], [56], [90], [131], [157]
Clinical Safety & Accuracy	Can AI give accurate, safe, and appropriate medical information? Are AI outputs biased or culturally insensitive?	[1], [56], [70], [97], [123], [124], [125], [149], [163]
Fairness, Equity, & Access	Does AI assume certain user privileges or characteristics? Can AI worsen disparities?	[49], [55], [64], [74], [82], [89], [152], [162]
Clinical Integration & Support	Can AI enhance clinical productivity? How can AI support clinical staff safely and effectively?	[1], [12], [123], [129], [142], [151]
Privacy, Transparency, & Ethics	Do patients understand how their data will be handled? Can AI alleviate or aggravate institutional issues or policies?	[43], [48], [94], [108], [140]

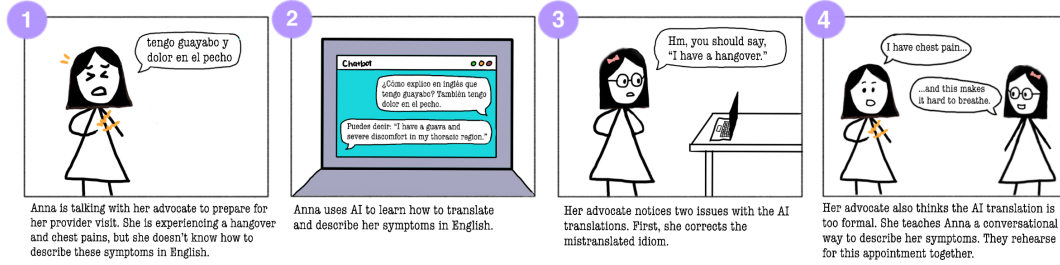
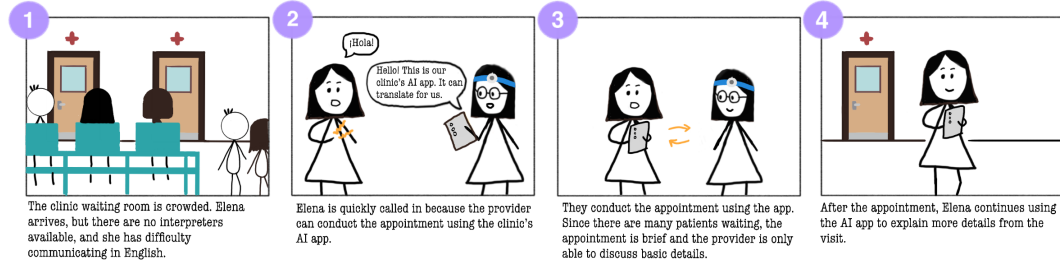
**(a) Language & Communication theme: AI mistranslations of idioms and medical jargon showcase potential shortcomings.****(b) Clinical Integration & Support theme: AI translator can support patient care when clinics are understaffed.****Figure 1: Example storyboards used in our interviews.**

AI technologies. On a 5-point Likert scale ranging from 1 (strongly disagree) to 5 (strongly agree), participants reported understanding basic AI concepts ($M = 3.86$, $SD = 0.86$) and being able to judge the benefits and risks of AI ($M = 3.64$, $SD = 0.74$). All participants had extensive experience using AI tools such as ChatGPT or Google Translate in their work.

3.6 Data Collection & Analysis

All interviews were conducted, recorded, and transcribed via Zoom. One author reviewed each transcript for accuracy, removed pauses and filler words, and paraphrased quotations cited in this paper. We followed Braun and Clark's reflexive thematic analysis approach [20, 21]. To familiarize ourselves with the data, two authors coded a subset of the interview transcripts independently. Each researcher

identified quotes that were associated with our research questions and grouped these quotes with short descriptions. The two authors met to share initial ideas of interest and quotes, prompting a discussion of emerging trends that developed further into preliminary themes. These discussions included the rest of the research team in weekly and ad-hoc group meetings over the course of two weeks. The first author then reviewed the themes against the coded transcripts to ensure they were representative of the original codes. Following this consistency check, the first author coded the remaining interview transcripts.

Given the sensitive nature of the study, we anonymized participant responses, and removed all personally identifiable information during transcript review and analysis. All quotes we report have been paraphrased to remove any personally identifiable information

Table 2: Summary of participants, including Occupation, Age, Gender, Race, Languages Spoken, and Years Working with Spanish-Speaking Patients (Yrs. w/ SSP).

ID	Occupation	Age	Gender	Ethnicity/Race	Languages Spoken	Yrs. w/ SSP
P1	Health Program Coordinator	25-34	Woman	Hispanic/Latinx	English, Spanish	1-3 years
P2	Patient Advocate	18-24	Woman	Hispanic/Latinx	English, Spanish	3-5 years
P3	Caseworker	35-44	Man	Black/African American	English, Spanish, French	<1 year
P4	Community Worker	18-24	Woman	Black/African American	English, French, Lingala, Swahili	<1 year
P5	Community Navigator Volunteer	25-34	Woman	Hispanic/Latinx	English, Spanish	5-10 years
P6	Home Visitor	45-54	Woman	White	English, Spanish	15+ years
P7	Parent Liaison	25-34	Man	Hispanic/Latinx	English, Spanish	<1 years
P8	Community Health Worker	35-44	Man	Hispanic/Latinx	English, Spanish	15+ years
P9	Medical Student	35-44	Man	Hispanic/Latinx	English, Spanish	3-5 years
P10	Latino Family Liaison	55-64	Woman	Hispanic/Latinx	English, Spanish	15+ years
P11	Medical Student	18-24	Man	Hispanic/Latinx & White	English, Spanish	3-5 years
P12	Digital Literacy Program Coordinator	18-24	Woman	Hispanic/Latinx	English, Spanish	1-3 years
P13	Social Worker	45-54	Woman	Hispanic/Latinx	English, Spanish	15+ years
P14	Digital Literacy Program Coordinator	18-24	Man	Hispanic/Latinx	English, Spanish	1-3 years

while preserving the semantic content and intent of participants' statements. We retained key linguistic markers (e.g., references to dialect mismatch, idioms) when essential to the analytic claim.

3.7 Positionality Statement

Our research team is based in the U.S. and comprises researchers of many identities. We collectively have experience in HCI, digital health, AI ethics, and clinical psychology. We were cautious that our background in HCI and AI might lead us to a solutionist perspective in this study (i.e., that AI *should* be applied to overcome barriers), which we actively tried to avoid by creating storyboards rather than prototypes and focusing on potential risks of AI in addition to opportunities. The team also includes an immigrant, native Spanish-speaking clinical psychologist who has lived experience, expertise, and clinical experience working with LEP populations, providing insight into the framing and content of the storyboards. Her personal connection with two community organizations aided with recruitment (Section 3.4), establishing familiarity and trust in our research team for those participants. The interviewing researcher is a second-generation immigrant with professional proficiency in Spanish, helping to establish some trust and familiarity with the participants. However, as this researcher does not come from a similar cultural background as the patient navigators or Spanish-speaking LEP population, this difference may have influenced what participants chose to disclose and what the researcher picked up from participant responses.

4 Results

In this section, we cover our findings that address our two research questions. We start by highlighting how LEP individuals' access to health technologies can be impeded by linguistic (Section 4.1), cultural (Section 4.2), and digital (Section 4.3 & 4.4) divides. We then describe how patient navigators saw the possible applications (Section 4.5) and risks (Section 4.6) of AI tools for LEP individuals. In this section and the following, we use the term *clients* to refer to the Spanish-speaking LEP individuals that the patient navigators work with, reflecting the terminology most commonly used by the navigators themselves. Table 3 summarizes our findings of the barriers that LEP individuals face (RQ1, Section 4.1-Section 4.4), and Table 4 summarizes our findings of the risks and opportunities for AI to

support health communication (RQ2, Section 4.5-Section 4.6). Both tables also include associated AI design considerations (Section 5).

4.1 Linguistic variation complicated communication surrounding care (RQ1)

All patient navigators consistently emphasized that being non-native English speakers imposed communication challenges on clients when accessing care. However, these language barriers included linguistic variation that went beyond the support of translators (human or AI-powered).

Within native Spanish speakers, dialectal and colloquial differences between various countries or regions sometimes created misunderstandings (P9, P10, P12). Furthermore, merely being from a country where Spanish is the official language did not guarantee that an individual spoke Spanish. Some navigators reported supporting individuals from Guatemala, where the official and most spoken language is Spanish, but where there are also over 20 Mayan languages spoken, such as Q'anjob'al or K'iche'. As a native Spanish speaker from Mexico, P10 recounts an experience while supporting her students:

"Kids from Guatemala and Honduras have words I've never heard before. Sometimes they try to explain it, and it becomes even more confusing. One of the kids described his condition as 'falling asleep,' and I was trying to explain seizures, but they have a different word for seizures in his language from Guatemala... Even when we all speak Spanish, we all have different words."

This linguistic variation posed challenges for medical interpretation, as most Spanish interpreters that the navigators and their patients encountered were from Mexico and thus less familiar with other dialects or languages. P10 explained that individuals *"speaking Q'anjob'al or other Guatemalan languages often struggle, since phone interpreters use words they can't understand."* Patients recognized the limitations of interpretation services. For example, when asked for language preferences, Guatemalan individuals often default to Spanish despite inevitable misunderstandings because Spanish interpreters were easier to access (P3, P5).

Table 3: Summary of barriers LEP individuals face with respect to health technologies (RQ1), how those barriers manifest, and associated design implications for AI. Bullet points map observed challenges to a potential implication for AI design.

Barrier	Observed Challenges	Implications for AI
Linguistic variations	<ul style="list-style-type: none"> Dialectal or regional colloquialisms within a language Context-sensitive word choices Indigenous languages within a Spanish-speaking country 	<ul style="list-style-type: none"> Adapt to dialects and colloquialisms to account for regional and cultural nuances Align models to individual preferences and mannerisms Expand models for low-resource languages
Cultural differences	<ul style="list-style-type: none"> Traditional or home remedies may conflict with western medical advice Fear of being judged prevents full disclosure Respect for authority discourages contradicting or asking questions 	<ul style="list-style-type: none"> Acknowledge cultural practices and values while offering practical steps for care Capture nonverbal cues that signify discomfort Avoid didactic or dismissive tones that misalign advice by ignoring cultural nuances
Literacy	<ul style="list-style-type: none"> Low reading literacy in English and/or Spanish Low digital literacy due to limited experience with usable technology (phones, computers, Internet) Lack of specialized medical knowledge complicates understanding health information 	<ul style="list-style-type: none"> Offer voice- or picture-based controls Accompany AI with resources to teach prompting and information validation skills; build simpler models that do not require state-of-the-art devices Provide simplified explanations that do not require extensive prior medical knowledge
Privacy	<ul style="list-style-type: none"> Reluctance to provide personal information Fear that personal data could end up in unwanted entities Hesitancy to engage with digital systems, preferring in-person means 	<ul style="list-style-type: none"> Access AI services without requiring personal information; anonymize when possible Minimize storing data and history; offer options to anonymize Build models that run locally on-device, without requiring external data transmission

The context of conversations also played a role in the nuances and connotations of words or expressions. P9 explained that although medical terminology is generally universal, “words like ‘stomach’, ‘chest’, ‘shoulder’, or ‘neck’ can vary slightly. Sometimes translators use words from different dialects or formalities, which can confuse patients. Small differences can sometimes be the issue for patients.” However, navigators generally agreed that patients still understand the main points even if specific words differ slightly. The dialect mismatches contributed more to friction than reduced their comfort and ease of interaction with the medical system.

4.2 Cultural differences led to friction with the U.S. healthcare system (RQ1)

Navigators pointed to clients’ cultural beliefs and values that clashed with U.S. healthcare practices and western medicine. P10 described her students’ distrust of the U.S. health system, saying that “even students who have been here for many years don’t go to the doctor here. They talk to their grandmas or their moms in Guatemala... and their family sends them medicine.” P10 also recalled a particular instance in which the cultural belief of *brujería* (witchcraft) of her student from Guatemala obstructed his opportunity to receive care in the United States:

“He kept having horrible cramps in his legs at night and spine pain. We went to the doctor, who recommended x-rays and additional tests, but he never wanted to go. He said he knew what he had: a problem caused by a type of demon in Guatemala, and

the only cure was to see a curandero there. This is more common than I would like to see. Many kids say, ‘I went to the doctor, and they say I don’t have anything, but I know I have it, and they cannot see it because they’re not from my country. Only people from my country can see it.’”

Many clients preferred to follow the medical traditions from their native cultures, which may sometimes be at odds with healthcare practices recommended in the U.S. Clients often refrained from disclosing their home practices to providers of differing backgrounds due to fear of being judged (P5), thus increasing the disconnect between providers and their knowledge of cultural practices. P6 highlighted an example around sleep practices for babies:

“Doctors recommend cribs, but families often co-sleep. They’ll usually tell the doctor they use cribs because they know it’s the expected answer. If I’m there, I might say, ‘If they’re co-sleeping, what should they keep in mind?’ That way the doctor can offer safer practices.”

The cultural disconnect can be further complicated by a deeply-rooted respect for authority that Hispanic cultures often uphold. P6 explained that “the doctor is the authority, the translator is the authority, and [the patients] just sit there nodding their head, so they often leave saying they didn’t understand.” P10 and P11 echoed nearly identical experiences. The navigators also acknowledged that being proactive necessitated advocating for their clients when communicating with providers and other authority figures. P6 said:

"When I see that it doesn't look like they're understanding something, I prompt them like, 'Remember you told me you had a question about this?' So it's become a really big part of what I do."

4.3 Reading and digital literacy limited technology use (RQ1)

Both reading literacy and digital literacy were barriers for many Spanish-speaking individuals in the communities that the patient navigators supported. P11 acknowledged a generation of immigrants that *"had to move to the States in the middle of their schooling, and switching languages mid-education has an impact. Not all of them finished secondary education."* Consequently, most clients who were illiterate could not read English nor Spanish, rendering it nearly impossible to utilize phones or computers without assistance. Navigators agreed, however, that even if their clients were educated or literate, specialized medical knowledge would still pose issues in understanding care information.

In some cases, navigators aimed to circumvent reading literacy issues via technology accessibility features such as sending audio messages rather than text or touching pictures to navigate (P6). However, these practices sometimes collided with clients' lack of digital literacy. P6 described an unexpected challenge when accommodating Guatemalan families with low reading literacy:

"I created a flyer with pictures and a QR code that they could scan and hear the information in Q'anjob'al, but we learned that a lot of families didn't know how to use a QR code. I thought this was a really easy way for them to be able to hear information in their native language, but then there was another barrier."

Digital literacy varied greatly across LEP individuals. Navigators attributed generational differences to the range of familiarity with technology: *"Most adults never had to use a computer before. Families here for many years already have teenage or adult children who handle technology, so adults don't feel the need... even to use email. However, new immigrants, here for 5-10 years, force themselves to learn technology because even job applications are online now"* (P10). P8 stated that most of his adult clients use flip phones or landlines and do not feel the need to use a smartphone, even if given one. On the other hand, navigators that worked with teenagers and young adults explained that their younger clients are comfortable with technology. P10, a school district family liaison, explained that it is easy for teenagers that had never used a phone or computer before immigrating to the U.S. to adopt these technologies effectively.

Low digital literacy often stemmed from barriers to accessing technology in the first place, creating additional sources of stress and confusion when seeking medical care. Clients of P13, a social worker in a major metropolitan area, often *"use old phones... which are now considered obsolete. They run into connection problems, apps that don't work well, or just really slow devices. Patients sometimes give up. That adds stress - on top of being sick, now they're also struggling with technology."* P3 echoed this sentiment, citing financial burdens as a barrier to accessing usable phones or apps. Several navigators said very few of their clients owned laptops or computers, and P6 and P14 said most of their clients did not have stable internet at home (P6's clients lived in trailer parks and had to go outside the trailer to get better phone service) and instead relied on mobile

hotspots. P4 noticed that most individuals do not even know about new technology, highlighting a lack of educational resources in the community. This unfamiliarity with technology creates discomfort: P12 described that one of the students in her digital literacy class *"was so nervous, scared to even touch the computer. She didn't want to break it."* Barriers to access and low digital literacy caused patients to struggle with even small tasks that seemed trivial even to navigators (P6). For example, patient navigators needed to show their clients how to join Zoom meetings (P6), maneuver the cursor on computers (P12), and overcome frustration with applications that require verification or extra steps (P13).

At the same time, LEP individuals recognized the importance of technology for accessing care. P3 realized that his clients *"understand the importance of investing in technology."* P12 and P14, program coordinators of a digital literacy program within a social services organization that serves Spanish-speaking individuals, aimed to increase educational resources and access to technology. They taught individuals in the community how use computers, AI, and the internet to search for information. P14 said that if given opportunities and support to overcome access barriers, *"students and community members genuinely want to learn—they have the desire to improve."* All navigators agreed that with proper support and guidance, AI has the potential to improve the wellbeing of their clients by increasing on-demand information access and translations for language support.

4.4 Privacy concerns further discourage use of technology (RQ1)

Independent of literacy issues, LEP individuals had heightened distrust of digital privacy policies and therefore hesitation to use technology, being afraid that their data would be used wrongly or end up in the possession of unintended entities (P8, P10). While nearly all navigators agreed that patients were generally wary of sharing personal data, one offered a contrasting view: P7, a school district parent liaison, reasoned that most of the families he works with cannot even read well in Spanish, so ethical concerns rarely cross their minds. However, some navigators drew examples from other applications that underscored their clients' concern for guarding their personal data. P5 worked with clients who *"keep money in a shoebox. If they don't trust banks or the government, they surely won't ask [AI] for help."* P6 worked with families who refuse to even obtain driver's licenses:

"They say, 'No, I'll be in the system, [government of officials] will find me.' It's a very real fear that impacts their lives and decisions in big ways. They know people who've been stopped without a license, they know the fees, the risks of police and court. And that's still preferable to them compared to being in the system."

These concerns stem primarily from administrative policies and immigration status (P3, P5, P12, P13), even for first-generation immigrants who have relatives or friends that are undocumented (P9). Many navigators themselves have experienced recently growing distrust from their own clients, despite already having established familiarity and trust. This reluctance to share personal information extends to patients' unwillingness to seek healthcare services, which usually require patients to disclose personal data (P8). Lack

of familiarity with technology also created distrust: “[Clients] feel uneasy when websites ask for personal information. A lot of it comes from lack of knowledge—they don’t understand what a chatbot is, so they assume it’s a robot trying to steal their information” (P14).

Interestingly, navigators drew distinctions between types of data that their clients would be comfortable sharing with clinics and technology. P14 outlined the difference as: “They’re very protective of sensitive information like Social Security numbers or bank accounts. But they’re comfortable sharing details about feelings, medical issues, recipes, or business ideas—things that can’t be stolen or hacked.” Other navigators generally agreed, drawing the line between “willing to give symptoms and medical history and maybe an email” but “hesitant with phone numbers, addresses, or other personally identifying information” (P6). These boundaries also extended to AI, as most navigators reasoned that clients would be comfortable sharing their symptoms with AI to get information, but would be less willing to log in to an account and save their chat history.

Navigators employed various strategies to assuage their clients’ privacy concerns. P4 emphasized to her clients the confidential nature of their interactions, informing them of their rights to take action or bring her to justice if their information is shared with any outside sources. P3, P8, P10, P12, and P13 employed similar strategies but also noted the trade-offs: as P3 explained, “We need to sometimes reassure them that... the state won’t share their information. The forms even say the information is confidential. Sometimes we tell them they’re not required to give certain information, so many clients end up providing only very basic information.” P10 emphasizes that her clients need reassurance that their information would not be shared with anyone else, leveraging the personal relationship and trust she established with her clients in order to obtain the information needed to support them.

4.5 Opportunities for AI: reducing social barriers and institutional constraints (RQ2)

Having characterized barriers shaping LEP patients’ technology experiences (RQ1), we now describe how navigators envision AI playing a role in communication dynamics and care workflows. Navigators identified two ways that AI systems would be uniquely positioned to support LEP individuals seeking care: reducing sentiments of alienation and alleviating resource constraints.

Navigators described that many of their clients felt unheard, rejected, or embarrassed by the healthcare system. P1 explains that “in Hispanic culture, people like to talk, share details, and give background. Appointments are usually rushed, so doctors usually want ‘yes/no’ answers about symptoms, but patients may tell their whole life story first. That mismatch in communication style can definitely be a barrier.” Other patients left appointments feeling like their concerns went unheard due to language or cultural misunderstandings that impeded their ability and confidence to advocate for themselves (P5, P11). Oftentimes institutional restrictions on interpreters prevented them from addressing these issues. At P6’s clinic, the interpreters must strictly provide word-for-word translations, barred from intervening when they perceive misunderstandings between patients and providers. Patients also experienced embarrassment or discomfort when describing medical conditions, especially if doing so in English, causing the patients to refrain from elaborating on

their conditions (P2). Lastly, telehealth methods, albeit convenient, may exacerbate these communication disconnects. P5 lamented that telehealth “make[s] it hard because you can’t see the patient to gauge their pain, and Wi-Fi issues make it worse.” Collectively, these barriers caused patients to feel alienated and not seek care: “Because English isn’t their first language, they’re extra cautious. They feel vulnerable and worry about being scammed. They know they’re a group people might take advantage of, so they’re wary” (P14). Patient navigators proposed that some of these issues could be alleviated by AI. For example, P2 reasoned that talking to a chatbot about a medical condition would eliminate the sense of embarrassment or social judgment that resides in a human-to-human conversation. P6 proposed the idea of an AI interface that transcribes patient-provider conversations in real-time and detects potentially confusing concepts or jargon in the conversation, allowing patients to gain clarification in real-time without causing embarrassment by verbally interrupting or admitting their confusion. P11 reasoned that talking to AI as a post-visit debrief could help patients feel better by externalizing their sentiments and receiving comfort.

Navigators also identified ways that AI systems could alleviate institutional burdens and resource constraints. Most clinics and emergency rooms are frequently stretched thin, forcing patients to endure long wait times for an interpreter or a provider, or even reschedule their appointments completely. Navigators agreed that AI could help fill the interpretation gaps by serving as an on-demand translator for when human interpreters are not readily available, thus alleviating wait times and frustration for LEP patients. Navigators whose work required communicating large volumes of complex information to clients noted that AI could help identify errors and ensure consistency, especially when fatigue set in from long work hours (P3). Some navigators also cited not having enough bandwidth to routinely follow-up with clients, such as to ensure correct understanding and adherence to care plans (P13). P9 proposed an AI system that proactively sends check-in questionnaires to patients on a regular basis to help monitor their progress and health without relying on scheduling official visits. This regular communication would also serve as an intervention mechanism to prevent patients from waiting until they are very sick to seek help (P10).

4.6 Risks of AI: loss of human connection and validation strategies (RQ2)

While navigators pointed to opportunities for AI to enhance LEP patient care, they also raised concerns about the uniquely-human support that many patients need. Nearly all of the navigators emphasized the significance of human presence as a source of comfort and encouragement for individuals while navigating healthcare, difficult circumstances, or loneliness. P10 described her personal journey battling a long-term medical condition:

“When I was at appointments, I was hearing new, scary information. What was really helpful was having someone next to me—a nurse who was very caring—who kept asking if I wanted to stop, if I understood, if I wanted water, if she could help me in any way. That human aspect is very important, especially when hearing scary news. In complex cases, having a human who shows care and presence is important.”

Table 4: Summary of risks and opportunities for AI health technologies to facilitate communication (RQ2) and associated design implications for AI. Bullet points map observed behavior to a potential implication for AI design.

	Theme	Observed Behavior	Implications for AI
Opportunities	Reduce social barriers	<ul style="list-style-type: none"> • Patients feel unheard by providers due to language or cultural misunderstandings • Patients feel embarrassed or uncomfortable when describing medical conditions • Telehealth distance emphasizes alienation 	<ul style="list-style-type: none"> • Provide on-demand conversational support that eliminates social pressures of a human-human conversation • Detect confusion or jargon in real-time conversations and provide simplified explanations • Provide on-demand support by allowing patients to externalize their sentiments
	Alleviate resource constraints	<ul style="list-style-type: none"> • Long wait times for interpreters • Navigators are overburdened to properly follow-up with patients • Long work hours increase risk of navigator errors and decreased service quality 	<ul style="list-style-type: none"> • Provide on-demand translation • Proactively send check-in questionnaires to monitor patient progress • Automate navigator work, identify errors, and ensure consistency
Risks	Loss of Human Connection	<ul style="list-style-type: none"> • Human presence is significant source of comfort • Patients want to feel that someone cares 	<ul style="list-style-type: none"> • Keep navigators in the loop to use AI alongside patients • Use AI to support rather than replace patient-navigator relationships
	Misinformation	<ul style="list-style-type: none"> • Patients may not be able to validate AI information or translations • Patients may overrely on AI-generated information 	<ul style="list-style-type: none"> • Build in accuracy checks, safety filters, and plain-language summaries • Provide educational supports to teach skills around assessing trustworthiness

P14 gave the examples that his clients would rather hand a physical resume to a person in an office, rather than submitting it online, and they would rather have someone personally explain confusing documents such as a privacy policy, rather than asking for explanations from AI. He highlighted that *"it's the personable aspect that matters. They need to feel like someone cares,"* which is conveyed through the personal physical interactions. Navigators worried that these needs would at best make clients uncomfortable with AI and at worse remove a key asset of human support. P5, a community navigator from Mexico, explained:

"An AI might know the facts, but it's not Mexican, didn't grow up in Mexico, so it doesn't really understand me the way a person would. For example, Mexican remedy traditions—American doctors don't get them, but other people [from similar cultures] do. AI knows a lot about an egg cleanse, but it hasn't experienced it, so it doesn't really know why we do it."

Navigators also anticipated risks with misinformation and mis-translations from AI. Most navigators experienced inaccurate information or translations themselves when they used AI in their work, but they worried that their clients would not have the same capabilities to validate outputs. P9 contended that AI translation systems *"really only work for bilingual people. I've had students submit translations without knowing how to adjust words depending on the context."* Other navigators reported similar experiences with AI performing poorly when translating idioms or words in specific contexts. On issues of misinformation, P10 asserted that her clients *"don't ensure information online is accurate. Many trust social media for important information. For example, if TikTok said the president would give green cards to everyone, they believe it. They don't know how to verify information yet."* Similarly, P11 emphasized

medical misinformation from social media and word-of-mouth as a significant issue:

"Patients often lecture me about diets or remedies they saw on Facebook. Sometimes it's legitimate, sometimes it's not. Maybe it's not immediately harmful, but it complicates care. I've had patients stop blood pressure medication after hearing from friends it causes dizziness. That was a known side effect we had already explained. So then we have to re-educate, rebuild trust, and sometimes switch them to another medication just to remove the stigma around the original drug name. It complicates care - not necessarily bad, but challenging."

Navigators, then, extrapolate these concerns to AI as an information source. Some called for digital literacy education that includes building skills in validating information accuracy, assessing trustworthiness of information sources, navigating online culture, and learning cybersecurity.

5 Discussion

In this study, patient navigators saw clear potential for AI technologies to improve healthcare access and quality for LEP individuals. However, we avoid framing AI as a solution to structural inequities, as successful introduction of AI depends on how well these systems integrate into these existing interpersonal (e.g., patient-navigator or patient-provider) and sociotechnical ecosystems. Thus, in this section, we discuss opportunities and risks for developing AI tools that facilitate communication between LEP individuals, providers, and navigators. For many patients, trust in and consequent adoption of a system is inseparable from the policies and institutions that govern it [15], meaning that even well-designed technologies can fail if they do not address broader systemic inequities. Thus, we discuss the

implications of our study within these broader structural contexts. We do not generalize the following discussion and considerations to all LEP or even all Spanish-speaking LEP individuals.

5.1 Design considerations for embedding AI technology into existing sociotechnical infrastructures

Prior research in care-centered computing advocates for integrating health technologies within existing platforms or systems familiar to patient users [10, 28, 118] to minimize burdens and disruptions of adapting to new systems. Consistent with this principle, navigators in our study discussed the difficulties for LEP individuals to adopt new technologies, skills, or even visit a new clinic, as many LEP individuals rely heavily on navigators, family members, or other sources of support to mediate communication, explain processes, or advocate on their behalf. Therefore, rather than demanding users migrate to completely new platforms, we propose integrating AI according to the following principles.

Platform congruence. To minimize burdens of learning new practices, AI should be deployed on devices and platforms that LEP individuals already use. Navigators explained that their clients were generally more comfortable and had more access to phones (as opposed to computers, laptops, wearables, or other forms of technology). Therefore, AI tools should be mobile-friendly or even mobile-centric. Going further, chatbots could send reminders, answer questions, or translate information along familiar channels, such as SMS or WhatsApp [1, 145]. This **"meet them where they are" approach** removes the cognitive load of navigating new interfaces or devices, allowing new AI to integrate quietly in established technological practices.

Small Language Models. AI must recognize limitations imposed by the digital divide and institutional distrust. Our findings highlight a privacy paradox in which AI requires personal data or third party APIs to tailor generated responses, yet LEP populations are often highly reticent to share their information due to distrust in institutional policies and fearing surveillance. Here, the technical constraints of the digital divide offer a solution to the psychological constraints of trust. By employing either small language models (SLMs) that have fewer parameters or models that can be publicly downloaded (e.g., the Olmo3 model family [105] or gpt-oss [2]) and run locally, developers can simultaneously address two problems. Models that can run on a mobile device [86] can function without stable internet, addressing P6's observation of families relying on intermittent hotspots in mobile trailers. Psychologically, on-device processing ensures data sovereignty such that because data stays on device, the risk of interception or institutional misuse is minimized [35]. While such models might sacrifice some compute-intensive capabilities (e.g. deep reasoning [107]), allowing patients to access tools locally may be more effective than policy statements in reassuring privacy. Furthermore, giving users agency over their data through options to use nicknames, ephemeral chat modes, or privacy-enhancing systems [114] can further align the system with user needs for privacy. However, on-device processing does not eliminate all risk (e.g., device loss, coercive access, or organizational policies around tool use), so privacy protections must also include

usability-centered safeguards (e.g., quick-delete, no default history, clear threat models). AI design should also explicitly consider risks such as inadvertent disclosure to family members, clinic staff, or authorities; device sharing; and fear of surveillance tied to immigration enforcement. These threats shift design priorities toward minimal data retention, non-identifying access modes, and clear user control over what is stored or shared [85].

Enforcing trust and appropriate power dynamics. Prior work established that cultural values may influence acceptance and choice of technology [54, 120] due to factors such as alignment of communication style, sensitivity in presenting information, and readability of information [31]. For instance, navigators emphasized that high respect for authority in Hispanic cultures rendered patients unwilling to fully disclose their symptoms. Therefore, in order to encourage comfortable and transparent interactions, AI systems should adopt the tone of an intermediary between medical authority and accessible peer by integrating computational approaches to politeness [29] or style transfer [119]. In this way, AI can serve as a **supportive scaffold that reinforces rather than usurps the established relationships** of trust between patients and navigators. A practical pattern is "coach and translator": the system helps patients rehearse questions in their preferred dialect, flags jargon, and generates respectful question prompts (e.g., "Can you explain that in another way?") while explicitly encouraging patients to defer medical decisions to clinicians.

5.2 AI-driven personalization to support long tail linguistic, cultural, and literacy variation

Linguistic variation. Languages and cultures are not monolithic. In our study, navigators highlighted how dialectal differences can cause misunderstandings, even if interpretation is available. Furthermore, individuals from predominantly Spanish-speaking countries did not necessarily speak Spanish. Though recent years have seen improvements in the multi-lingual capabilities of LLMs [34, 59], our findings suggest AI systems should **prioritize dialect-level adaptation**, ensuring that they can flexibly account for regional, cultural, and individual nuances [23]. However, existing frontier models remain limited in recognizing rich diatopic variability, including in languages like Spanish [96, 141], highlighting the need for benchmark datasets that can rigorously evaluate LLM capabilities in understanding and responding to diverse dialects [50, 95]. Personalization here requires systems to align with individual communication preferences, which can be achieved via few-shot learning [80] or other alignment methods [131, 157] that offer avenues for AI to continually learn the patient's vocabulary and preferences.

Cultural variation. While health practices are deeply rooted in cultural care routines, navigators explained that patients often conceal cultural practices such as egg cleanses from providers due to fear of judgment or failure to understand. While providers currently use questionnaires and wearable technology [19, 93] to capture patient lifestyle and background, raw data alone rarely translates into cultural empathy. AI tools have potential to synthesize **culturally-appropriate insights grounded in lived experiences** for providers [113]. One way of achieving this is to

pair a generalist high-level LLM and a group of culturally-tuned LLMs in order to incorporate diverse cultural perspectives [137] and thus validate medical advice against specialized cultural norms. Furthermore, in-context adaption via sociodemographic prompting or cultural role-play [63, 133] can allow the agent to proactively identify and bridge value gaps between patients and providers. In this way, an AI system could, for example, detect hesitance regarding a treatment plan and generate culturally relevant analogies or explanations that align with the patient's lived experience [113]. However, this requires a shift from static profiling to dynamic cultural alignment, ensuring that systems avoid stereotyping by continuously learning from the user's specific feedback and value signals [40, 158].

Conversely, for patient-facing interactions, AI systems should **recognize how cultural beliefs around medicine intersect with biomedical recommendations**, framing guidance in a way that is both culturally sensitive and clinically appropriate. Value-sensitive design suggests that systems should acknowledge the user's lived experiences before pivoting to clinical corrections to maintain trust and adherence [88]. In situations where following cultural beliefs could lead to serious health consequences, such as the case of P10's student who believed *brujería* (witchcraft) caused his excruciating leg and spine pain, AI should be governed by context-aware safety alignment [134] to gently prioritize biomedical advice, ensuring that critical interventions are not overlooked. AI can minimize the risk of alienating patients during critical moments by framing medical interventions as necessary complements to, rather than replacements for, their cultural practices.

Literacy variation. Assumptions of baseline literacy or technological familiarity often exclude marginalized users from health technologies or general digital services [8, 153, 160]. Literacy, however, is multi-dimensional, encompassing reading, digital, health, and even specialized forms of AI literacy such as scientific and data literacy [91]. Navigators emphasized that LEP individuals often struggle concurrently with multiple dimensions of literacy such that an AI tool that simplifies text to a 5th-grade level is still inaccessible since many patients lack the skills to type queries or navigate interfaces, often relying on other modalities such as voice messages to communicate. Therefore, AI systems should **adapt content and modality simultaneously to address multi-dimensional literacy gaps**. The complexity of content can be dynamically adjusted by providing definitions of unfamiliar terms, plain-language summaries [14], or simplifications based on a user's demonstrated reading [102] or health literacy level [126]. Furthermore, AI interfaces for LEP populations should be multimodal by default. Given the dual threads of agents that can navigate complex digital environments [61, 100, 132] and generative voice-based interfaces that can overcome reading and typing barriers [83, 115], there is an opportunity to develop voice-based agents that can, for example, help patients navigate other tools (e.g., Zoom, digital calendars, and email). Voice-based translation agents [60] may also support the frequent over-the-phone interactions between interpreters, patients, and providers. Furthermore, text-to-image models can generate visual explanations [156] such as diagrams showing how to take medication, tailored to the specific medication or dosage. Leveraging

generative AI capabilities to move beyond text-centric interventions can help bridge the multifaceted literacy gaps faced by LEP individuals.

5.3 When AI might not be the best approach

Our study highlighted that while AI systems hold potential to support LEP individuals seeking care, they may not always be the most appropriate or effective solution. In some contexts, introducing complex technological ecosystems may create more friction than strengthening existing or deploying low-tech strategies.

Navigators in our study echoed the call in research communities for technology that complements, rather than replaces, human expertise in healthcare settings [9, 129]. However, our results highlight a tension: while most navigators were optimistic that the benefits of AI for LEP individuals would outweigh risks, **successful deployment of AI places the burden on navigators to teach and monitor their clients** who may be unfamiliar with or unwilling to adopt new technologies due to barriers in literacy and access to hardware. Thus, LEP adoption of AI creates a form of invisible labor [103], which navigators expressed their willingness to shoulder because increasing digital literacy and overall education empowers patients to advocate for themselves. However, because human-in-the-loop systems would offload burdens of error checking and training on these already-stretched navigators, designing AI for this ecosystem may require intermediaries [116] specifically for navigators.

Many communication needs could also be adequately addressed through offline resources rather than technology. Static resources (e.g., FAQs, worksheets, pamphlets) that are helpful for conveying important health information are traditionally written by providers or navigators. Rather than attempting to replace these materials, **AI could instead play a supporting role** by, for example, generating these resources that are then refined by humans. These resources could then be distributed with minimal digital access as printed sheets or shared audio files [149]. This hybrid workflow allows providers and navigators to leverage the generative power of AI without imposing the privacy risks and usability hurdles of LEP patient-AI interaction [144].

Introducing AI necessitates AI literacy that goes beyond basic digital skills [91]. Navigators described already investing significant effort in teaching their clients foundational digital skills such as using computers, sending emails, and logging into online patient portals. Learning additional skills such as prompt engineering or information validation increases the barrier to entry for patients to adopt AI safely and productively [159]. When the **cognitive load of learning the tool may outweigh immediate utility**, investments in improving existing workflows, interpreter access, or patient education may create more immediate impact as a first step rather than deploying new AI tools.

5.4 Limitations and Future Work

While the storyboard scenarios provided a useful structure for discussion, they reflect hypothetical scenarios, thus capturing patient navigators' expectations and attitudes rather than observed behaviors. Furthermore, the storyboards may have guided participants toward particular ideas or interpretations. Nevertheless, because

all but one of the interviewed navigators found the scenarios to be realistic, they were able to relate the fictional scenarios to their actual lived experiences, thus grounding the discussions in real examples that allowed them to critically reflect on how AI might affect their existing practices and relationships. Future work should incorporate in-situ or observational methods such as participatory design sessions or diary studies that capture actual behaviors and decision-making processes.

Our findings are also context-specific and do not necessarily generalize to other LEP populations or even Spanish-speaking populations in different regions of the U.S. Cultural, linguistic, and systemic characteristics of any particular area may shape the needs and experiences of those patients and navigators in ways that may differ from our study context. Therefore, while navigators can generalize across patients in their own regions and cultural backgrounds, they cannot speak for LEP individuals that they do not regularly interact with. Additionally, because this study captures only the perspectives of navigators, which we selected as an early-phase, risk-sensitive step into LEP communities and cultural norms before talking to patients directly, this unilateral perspective raises two limitations. First, their position as intermediaries between patients and providers may bias their perceptions. For instance, while they may have concerns of AI around potential job displacement, all navigators emphasized aspects of their roles that were irreplaceable, such as driving patients to the hospital or teaching them how to use online portals. Nonetheless, their responses may still be inherently influenced by their positionality as navigators. Second, since these insights reflect secondhand interpretations rather than firsthand experiences of patients themselves, triangulating findings with provider and LEP patient perspectives would capture a more holistic narrative. Navigators may overestimate patients' willingness to adopt AI tools or understate concerns that patients do not disclose to intermediaries. Therefore, future work should validate these themes through participatory sessions with LEP patients and providers. Building prototypes or low-fidelity design probes informed by the findings of this study, such as voice-based interfaces, could ground the participatory discussions with patients while offering insight into the validity and extensions of our findings. In this way, we can ensure that AI systems are built to be responsive and effective to the needs of the communities they intend to serve.

6 Conclusion

In this study, we interviewed 14 patient navigators who support Spanish-speaking LEP individuals in receiving healthcare. We identified key sociotechnical and cultural factors that shape the way LEP individuals access health technologies and communicate with providers. Our findings reveal linguistic, cultural, literacy, and privacy barriers that LEP individuals face when interacting with healthcare services and technologies. These findings motivate opportunities for AI to be situated within existing practices and limitations, while considering issues of data privacy, misinformation, and cultural alignment. Future work should solicit the perspectives of LEP individuals to directly inform AI system designs that best support marginalized communities in receiving healthcare.

References

- [1] Najeeb Gambo Abdulhamid, Millicent Ochieng, Kalika Bali, Elizabeth Ankrh, Naveena Karusala, Keshet Ronen, and Jacki O'Neill. 2024. Can Large Language Models Support Medical Facilitation Work? A Speculative Analysis. In *Proceedings of the 4th African Human Computer Interaction Conference* (East London, South Africa) (AfriCHI '23). Association for Computing Machinery, New York, NY, USA, 64–70. doi:10.1145/3628096.3628752
- [2] Sandhini Agarwal, Lama Ahmad, Jason Ai, Sam Altman, Andy Applebaum, Edwin Arbus, Rahul K Arora, Yu Bai, Bowen Baker, Haiming Bao, et al. 2025. gpt-oss-120b & gpt-oss-20b model card. *arXiv preprint arXiv:2508.10925* (2025).
- [3] Mohamed Mustaf Ahmed, Olalekan John Okesanya, Noah Olabode Olaleke, Olaniyi Abideen Adigun, Uthman Okikiola Adebayo, Tolutope Adebimpe Oso, Gilbert Eshun, and Don Eliseo 3rd Lucero-Prisno. 2025. Integrating Digital Health Innovations to Achieve Universal Health Coverage: Promoting Health Outcomes and Quality Through Global Public Health Equity. *Healthcare (Basel)* 13, 9 (May 2025), 1060. doi:10.3390/healthcare13091060
- [4] Marine-Ayan Ibrahim Aibo, Shreya Kangovi, K Casey Lion, and Aditi Vasan. 2024. Community Health Workers: A Key Workforce to Promote Health Equity for Children in Immigrant Families. *Academic pediatrics* 24, 5 Suppl (2024), 16.
- [5] Hilal Al Shamsi, Abdullah G Almutairi, Sulaiman Al Mashrafi, and Talib Al Kalbani. 2020. Implications of language barriers for healthcare: a systematic review. *Oman medical journal* 35, 2 (2020), e122.
- [6] Najeeb Al-Shorbaji. 2022. Improving Healthcare Access through Digital Health: The Use of. *Healthcare Access* (2022), 315.
- [7] Tuka Alhanai, Adam Kasumovic, Mohammad M Ghassemi, Aven Zitzelberger, Jessica M Lundin, and Guillaume Chabot-Couture. 2025. Bridging the gap: enhancing LLM performance for low-resource African languages with new benchmarks, fine-tuning, and cultural adjustments. In *Proceedings of the AAAI Conference on Artificial Intelligence*, Vol. 39. 27802–27812.
- [8] Maria Alcocer Alkureishi, Zi-Yi Choo, Ali Rahman, Kimberly Ho, Jonah Benning-Shorb, Gena Lenti, Itzel Velázquez Sánchez, Mengqi Zhu, Sachin D Shah, and Wei Wei Lee. 2021. Digitally disconnected: qualitative study of patient perspectives on the digital divide and potential solutions. *JMIR human factors* 8, 4 (2021), e33364.
- [9] James Alrassi, Peter J Katsufakis, and Latha Chandran. 2021. Technology can augment, but not replace, critical human skills needed for patient care. *Academic Medicine* 96, 1 (2021), 37–43.
- [10] Yohualli Balderas-Medina Anaya, Giselle D Hernandez, Stephanie A Hernandez, and David E Hayes-Bautista. 2021. Meeting them where they are on the web: addressing structural barriers for Latinos in telehealth care. *Journal of the American Medical Informatics Association* 28, 10 (2021), 2301–2305.
- [11] Denise Anthony, Celeste Campos-Castillo, and Akira Nishii. 2024. Patient-Centered Communication, Disparities, and Patient Portals in the US, 2017–2022. *The American Journal of Managed Care* 30, 1 (2024). doi:10.37765/ajmc.2024.89483
- [12] Maria Antoniak, Aakanksha Naik, Carla S Alvarado, Lucy Lu Wang, and Irene Y Chen. 2024. Nlp for maternal healthcare: Perspectives and guiding principles in the age of llms. In *Proceedings of the 2024 ACM Conference on Fairness, Accountability, and Transparency*. 1446–1463.
- [13] Neeraj K Arora. 2003. Interacting with cancer patients: the significance of physicians' communication behavior. *Social science & medicine* 57, 5 (2003), 791–806.
- [14] Tal August, Lucy Lu Wang, Jonathan Bragg, Marti A. Hearst, Andrew Head, and Kyle Lo. 2023. Paper Plain: Making Medical Research Papers Approachable to Healthcare Consumers with Natural Language Processing. *ACM Trans. Comput.-Hum. Interact.* 30, 5, Article 74 (Sept. 2023), 38 pages. doi:10.1145/3589955
- [15] Ghareeb Bahari, Ibrahim Mutambik, Abdullah Almuqrin, and Zahyah H Alharbi. 2024. Trust: how it affects the use of telemedicine in improving access to assistive technology to enhance healthcare services. *Risk Management and Healthcare Policy* (2024), 1859–1873.
- [16] Edward E Bartlett, Marsha Grayson, Randol Barker, David M Levine, Archie Golden, and Sam Libber. 1984. The effects of physician communications skills on patient satisfaction; recall, and adherence. *Journal of chronic diseases* 37, 9-10 (1984), 755–764.
- [17] Amelia K Barwise, Susan Curtis, Daniel A Diedrich, and Brian W Pickering. 2024. Using artificial intelligence to promote equitable care for inpatients with language barriers and complex medical needs: clinical stakeholder perspectives. *Journal of the American Medical Informatics Association* 31, 3 (2024), 611–621.
- [18] Jeffrey Basoah, Daniel Chechelnitsky, Tao Long, Katharina Reinecke, Chrysoula Zerva, Kaitlyn Zhou, Mark Díaz, and Maarten Sap. 2025. Not Like Us, Hunt: Measuring Perceptions and Behavioral Effects of Minoritized Anthropomorphic Cues in LLMs. In *Proceedings of the 2025 ACM Conference on Fairness, Accountability, and Transparency (FAccT '25)*. Association for Computing Machinery, New York, NY, USA, 710–745. doi:10.1145/3715275.3732045
- [19] Nazleen Bharmal, Alex Rennick, Amy Shideler, Madeleine Blazel, Robert Jones, Chi' Wilson, and Elizabeth R Pfoh. 2023. Health-related social needs: which patients respond to screening and who receives resources? *Journal of General Internal Medicine* 38, 12 (2023), 2695–2702.
- [20] Virginia Braun and Victoria Clarke. 2006. Using thematic analysis in psychology. *Qualitative research in psychology* 3, 2 (2006), 77–101.

- [21] Virginia Braun and Victoria Clarke. 2019. Reflecting on reflexive thematic analysis. *Qualitative research in sport, exercise and health* 11, 4 (2019), 589–597.
- [22] Karin Schölin Bywall, Therese Norgren, Beatrice Avagnina, Marta Pisano Gonzalez, and Sarah Wamala Andersson. 2025. Promoting digital health literacy among immigrants in Sweden: opportunities and challenges for healthcare services. *Journal of Public Health* (2025), 1–7.
- [23] Martin Capdevila, Esteban Villa Turek, Ellen Karina Chumbe Fernandez, Luis Felipe Polo Galvez, Andrea Marroquin, Rebeca Vargas Quesada, Johanna Crew, Nicole Vallejo Galarraga, Christopher Rodriguez, Diego Gutierrez, et al. 2025. Crossing Borders Without Crossing Boundaries: How Sociolinguistic Awareness Can Optimize User Engagement with Localized Spanish AI Models Across Hispanophone Countries. *arXiv preprint arXiv:2505.09902* (2025).
- [24] Valerio Capraro, Austin Lentsch, Daron Acemoglu, Selin Akgun, Aisel Akhmedova, Ennio Bilancini, Jean-François Bonnefon, Pablo Brañas-Garza, Luigi Butera, Karen M Douglas, et al. 2024. The impact of generative artificial intelligence on socioeconomic inequalities and policy making. *PNAS nexus* 3, 6 (2024), 191.
- [25] Zhanming Chen, Alisha Ghaju, May Hang, Juan Fernando Maestre, and Ji Youn Shin. 2025. Designing Health Technologies for Immigrant Communities: Exploring Healthcare Providers' Communication Strategies with Patients. In *Proceedings of the 2025 CHI Conference on Human Factors in Computing Systems (CHI '25)*. Association for Computing Machinery, New York, NY, USA, Article 1045, 19 pages. doi:10.1145/3706598.3713782
- [26] Margaret Chustecki. 2024. Benefits and risks of AI in health care: Narrative review. *Interactive Journal of Medical Research* 13, 1 (2024), e53616.
- [27] John A Crane. 1997. Patient comprehension of doctor-patient communication on discharge from the emergency department. *The Journal of emergency medicine* 15, 1 (1997), 1–7.
- [28] Humphrey Curtis, Erin Beneteau, Edward Cutrell, Denae Ford, Sasa Junuzovic, Ann Paradiso, John Tang, and Martez E Mott. 2025. "I use video calling in all areas of my life": Understanding the Video Calling Experiences of Chronically Ill People. In *Proceedings of the 2025 CHI Conference on Human Factors in Computing Systems*. 1–22.
- [29] Cristian Danescu-Niculescu-Mizil, Moritz Sudhof, Dan Jurafsky, Jure Leskovec, and Christopher Potts. 2013. A computational approach to politeness with application to social factors. In *Proceedings of the 51st Annual Meeting of the Association for Computational Linguistics (Volume 1: Long Papers)*, Hinrich Schuetze, Pascale Fung, and Massimo Poesio (Eds.). Association for Computational Linguistics, Sofia, Bulgaria, 250–259. <https://aclanthology.org/P13-1025/>
- [30] Scott Davidoff, Min Kyung Lee, Anind K Dey, and John Zimmerman. 2007. Rapidly exploring application design through speed dating. In *International conference on ubiquitous computing*. Springer, 429–446.
- [31] Roshini Deva, Dhruv Ramani, Tanvi Divate, Suhani Jalota, and Azra Ismail. 2025. "Kya family planning after marriage hoti hai?": Integrating Cultural Sensitivity in an LLM Chatbot for Reproductive Health. In *Proceedings of the 2025 CHI Conference on Human Factors in Computing Systems (CHI '25)*. Association for Computing Machinery, New York, NY, USA, Article 638, 23 pages. doi:10.1145/3706598.3713362
- [32] Lisa Diamond, Karen Izquierdo, Dana Canfield, Konstantina Matsoukas, and Francesca Gany. 2019. A systematic review of the impact of patient–physician non-English language concordance on quality of care and outcomes. *Journal of general internal medicine* 34, 8 (2019), 1591–1606.
- [33] YiTian Ding, Jinman Zhao, Chen Jia, Yining Wang, Zifan Qian, Weizhe Chen, and Xingyu Yue. 2025. Gender bias in large language models across multiple languages: A case study of ChatGPT. In *Proceedings of the 5th Workshop on Trustworthy NLP (TrustNLP 2025)*. 552–579.
- [34] CM Downey, Terra Blevins, Dhvani Serai, Dwija Parikh, and Shane Steinert-Threlkeld. 2024. Targeted multilingual adaptation for low-resource language families. *arXiv preprint arXiv:2405.12413* (2024).
- [35] Mateusz Dubiel, Yasmine Barghouti, Kristina Kudryavtseva, and Luis A Leiva. 2024. On-device query intent prediction with lightweight LLMs to support ubiquitous conversations. *Scientific reports* 14, 1 (2024), 12731.
- [36] Jonathan L Dunlap, Joshua D Jaramillo, Raji Koppolu, Robert Wright, Fernando Mendoza, and Matias Bruzoni. 2015. The effects of language concordant care on patient satisfaction and clinical understanding for Hispanic pediatric surgery patients. *Journal of pediatric surgery* 50, 9 (2015), 1586–1589.
- [37] Renee El-Krab, Natalie Brousseau, and Seth C Kalichman. 2023. Medical mistrust as a barrier to HIV prevention and care. *Journal of behavioral medicine* 46, 6 (2023), 897–911.
- [38] Christy Eskes, Helen Salisbury, Mark Johannsson, and Yasmin Chene. 2013. Patient satisfaction with language-concordant care. *The Journal of Physician Assistant Education* 24, 3 (2013), 14–22.
- [39] Victor C Ezeamii, Okelue E Okobi, Hassana Wambai-Sani, Gamamedaliyanage S Perera, Shakhnoza Zaynieva, Chinwe C Okonkwo, Mohamed M Ohaiba, Pamela C William-Enemali, Okiemute R Obodo, and Ngozika G Obiefuna. 2024. Revolutionizing Healthcare: How Telemedicine Is Improving Patient Outcomes and Expanding Access to Care. *Cureus* 16, 7 (Jul 2024), e63881. doi:10.7759/cureus.63881
- [40] Xianzhe Fan, Qing Xiao, Xuhui Zhou, Jiaxin Pei, Maarten Sap, Zhicong Lu, and Hong Shen. 2025. User-Driven Value Alignment: Understanding Users' Perceptions and Strategies for Addressing Biased and Discriminatory Statements in AI Companions. In *Proceedings of the 2025 CHI Conference on Human Factors in Computing Systems (CHI '25)*. Association for Computing Machinery, New York, NY, USA, Article 910, 19 pages. doi:10.1145/3706598.3713477
- [41] Farhad Fatehi, Mahnaz Samadbeik, and Azar Kazemi. 2020. What is Digital Health? Review of Definitions. *Studies in Health Technology and Informatics* 275 (Nov 2020), 67–71. doi:10.3233/SHTI200696
- [42] Kevin Fiscella, Peter Franks, Mark P Doescher, and Barry G Saver. 2002. Disparities in health care by race, ethnicity, and language among the insured: findings from a national sample. *Medical care* 40, 1 (2002), 52–59.
- [43] Paul J Fleming, Nicole L Novak, and William D Lopez. 2019. US immigration law enforcement practices and health inequities. *American Journal of Preventive Medicine* 57, 6 (2019), 858–861.
- [44] Glenn Flores et al. 2006. Language barriers to health care in the United States. *N Engl J Med* 355, 3 (2006), 229–231.
- [45] Ruth A Frank. 2000. Medical communication: non-native English speaking patients and native English speaking professionals. *English for Specific Purposes* 19, 1 (2000), 31–62.
- [46] Tejal K Gandhi, Helen R Burstin, E Francis Cook, Ann L Puopolo, Jennifer S Haas, Troyen A Brennan, and David W Bates. 2000. Drug complications in outpatients. *Journal of general internal medicine* 15, 3 (2000), 149–154.
- [47] Ariana Genovese, Sahar Borna, Cesar A Gomez-Cabello, Syed Ali Haider, Srinivasagam Prabha, Antonio J Forte, and Benjamin R Veenstra. 2024. Artificial intelligence in clinical settings: a systematic review of its role in language translation and interpretation. *Annals of Translational Medicine* 12, 6 (Dec 2024), 117. doi:10.21037/atm-24-162
- [48] Federico Germani, Giovanni Spitale, Nikola Biller-Andorno, et al. 2024. The dual nature of AI in information dissemination: ethical considerations. *JMIR AI* 3, 1 (2024), e53505.
- [49] Nancy P Gordon, Antonia Torreblanca, Rachel G Ford, Sharon Ou, and Mark W Lin. 2025. lower use of and Potential Barriers to using Patient Portals among limited english Proficient latino and Chinese american adults: a health Techquity Concern. *Perm J* 29 (2025), 1–22.
- [50] Maria Grandury, Javier Aula-Blasco, Júlia Falcão, Clémentine Fourier, Miguel González Saiz, Gonzalo Martínez, Gonzalo Santamaria Gomez, Rodrigo Agerrí, Nuria Aldama García, Luis Chiruzzo, et al. 2025. La Leaderboard: A Large Language Model Leaderboard for Spanish Varieties and Languages of Spain and Latin America. In *Proceedings of the 63rd Annual Meeting of the Association for Computational Linguistics (Volume 1: Long Papers)*. 32482–32524.
- [51] Simone Grassini. 2024. A psychometric validation of the pailq-6: Perceived artificial intelligence literacy questionnaire. In *Proceedings of the 13th Nordic Conference on Human-Computer Interaction*. 1–10.
- [52] Yue Guo, Wei Qiu, Yizhong Wang, and Trevor Cohen. 2021. Automated lay language summarization of biomedical scientific reviews. In *Proceedings of the AAAI Conference on Artificial Intelligence*, Vol. 35. 160–168.
- [53] Jennifer Fong Ha and Nancy Longnecker. 2010. Doctor-patient communication: a review. *Ochsner journal* 10, 1 (2010), 38–43.
- [54] Christina N Harrington, Radhika Garg, Amanda Woodward, and Dimitri Williams. 2022. "It's kind of like code-switching": Black older adults' experiences with a voice assistant for health information seeking. In *Proceedings of the 2022 CHI Conference on Human Factors in Computing Systems*. 1–15.
- [55] Robin T Higashi, Bhaskar Thakur, Emily C Repasky, Alejandra Casillas, Bryan D Steitz, Timothy P Hogan, Christoph U Lehmann, Eric D Peterson, Ann Marie Navar, and Robert W Turer. 2025. Digital Health Technology Use Among Spanish Speakers in the US: A Scoping Review. *JAMA Network Open* 8, 5 (2025), e2510386–e2510386.
- [56] Valentin Hofmann, Pratyusha Ria Kalluri, Dan Jurafsky, and Sharese King. 2024. AI generates covertly racist decisions about people based on their dialect. *Nature* 633, 8028 (2024), 147–154.
- [57] Kenneth Holstein, Bruce M. McLaren, and Vincent Alevan. 2019. Designing for Complementarity: Teacher and Student Needs for Orchestration Support in AI-Enhanced Classrooms. In *Artificial Intelligence in Education: 20th International Conference, AIED 2019, Chicago, IL, USA, June 25-29, 2019, Proceedings, Part I* (Chicago, IL, USA). Springer-Verlag, Berlin, Heidelberg, 157–171. doi:10.1007/978-3-030-23204-7_14
- [58] Loretta Hsueh, Jie Huang, Andrea K Millman, Anjali Gopalan, Rahul K Parikh, Silvia Teran, and Mary E Reed. 2021. Disparities in use of video telemedicine among patients with limited English proficiency during the COVID-19 pandemic. *JAMA Network Open* 4, 11 (2021), e2133129–e2133129.
- [59] Xu Huang, Wenhao Zhu, Hanxu Hu, Conghui He, Lei Li, Shujian Huang, and Fei Yuan. 2025. Benchmax: A comprehensive multilingual evaluation suite for large language models. *arXiv preprint arXiv:2502.07346* (2025).
- [60] Patricia Hudelson and François Chappuis. 2024. Using voice-to-voice machine translation to overcome language barriers in clinical communication: an exploratory study. *Journal of General Internal Medicine* 39, 7 (2024), 1095–1102.

- [61] Faria Huq, Zora Zhiruo Wang, Frank F. Xu, Tianyue Ou, Shuyan Zhou, Jeffrey P. Bigham, and Graham Neubig. 2025. CowPilot: A Framework for Autonomous and Human-Agent Collaborative Web Navigation. *ArXiv abs/2501.16609* (2025). <https://api.semanticscholar.org/CorpusID:275931872>
- [62] Salma H Hussain. 2024. Humanizing Medical AI: Toward Culturally Responsive and Inclusive Healthcare Algorithms. *Journal of Equity Nexus* 1, 2 (2024), 10–17.
- [63] EunJeong Hwang, Bodhisattwa Majumder, and Niket Tandon. 2023. Aligning language models to user opinions. In *Findings of the Association for Computational Linguistics: EMNLP 2023*. 5906–5919.
- [64] Nchebe-Jah Iloanusi and Soon Ae Chun. 2024. AI impact on health equity for marginalized, racial, and ethnic minorities. In *Proceedings of the 25th annual international conference on digital government research*. 841–848.
- [65] Christin Iroegbu, Delphine S Tuot, Lisa Lewis, and Lea Ann Matura. 2025. The Influence of Patient–Provider Communication on Self-Management Among Patients With Chronic Illness: A Systematic Mixed Studies Review. *Journal of Advanced Nursing* 81, 4 (2025), 1678–1699.
- [66] Elizabeth Jacobs, Alice Hm Chen, Leah S Karliner, NIELS Agger-Gupta, and Sunita Mutha. 2006. The need for more research on language barriers in health care: a proposed research agenda. *The Milbank Quarterly* 84, 1 (2006), 111–133.
- [67] Elizabeth A Jacobs, Donald S Shepard, Jose A Suaya, and Esta-Lee Stone. 2004. Overcoming language barriers in health care: costs and benefits of interpreter services. *American journal of public health* 94, 5 (2004), 866–869.
- [68] Fabienne N Jaeger, Nicole Pellaud, Bénédicte Laville, and Pierre Klausner. 2019. Barriers to and solutions for addressing insufficient professional interpreter use in primary healthcare. *BMC health services research* 19, 1 (2019), 753.
- [69] Yiqiao Jin, Mohit Chandra, Gaurav Verma, Yibo Hu, Munmun De Choudhury, and Srijan Kumar. 2024. Better to ask in english: Cross-lingual evaluation of large language models for healthcare queries. In *Proceedings of the ACM Web Conference 2024*. 2627–2638.
- [70] Eunkyoung Jo, Young-Ho Kim, Sang-Houn Ok, and Daniel A Epstein. 2025. Understanding Public Agencies’ Expectations and Realities of AI-Driven Chatbots for Public Health Monitoring. In *Proceedings of the 2025 CHI Conference on Human Factors in Computing Systems*. 1–17.
- [71] Kevin B Johnson, Wei-Qi Wei, Dilhan Weeraratne, Mark E Frisse, Karl Misulis, Kyu Rhee, Juan Zhao, and Jane L Snowden. 2021. Precision Medicine, AI, and the Future of Personalized Health Care. *Clinical and Translational Science* 14, 1 (Jan 2021), 86–93. doi:10.1111/cts.12884
- [72] Hita Kambhampettu, Jamie Flores, and Andrew Head. 2025. Traceable Texts and Their Effects: A Study of Summary-Source Links in AI-Generated Summaries. In *Proceedings of the Extended Abstracts of the CHI Conference on Human Factors in Computing Systems*. 1–7.
- [73] Leah S Karliner, Elizabeth A Jacobs, Alice Hm Chen, and Sunita Mutha. 2007. Do professional interpreters improve clinical care for patients with limited English proficiency? A systematic review of the literature. *Health services research* 42, 2 (2007), 727–754.
- [74] Roopwant Kaur and Salwa Mekled. 2025. Enhancing Dental Care for Patients With Limited English Proficiency: Integrating Interpretation, Cultural Competency, and Artificial Intelligence. *Journal of Dental Education* (2025), e13942.
- [75] Anna Kawakami, Shreya Chowdhary, Shamsi T Iqbal, Q Vera Liao, Alexandra Olteanu, Jina Suh, and Koustuv Saha. 2023. Sensing wellbeing in the workplace, why and for whom? envisioning impacts with organizational stakeholders. *Proceedings of the ACM on Human-Computer Interaction* 7, CSCW2 (2023), 1–33.
- [76] Denise M Kennedy MBA, John P Fasolino MD, David J Gullen MD, et al. 2014. Improving the patient experience through provider communication skills building. *Patient Experience Journal* 1, 1 (2014), 56–60.
- [77] Ruby Khan, Sumbal Khan, Hailah M. Almohaimeed, Amany I. Almars, and Bakht Pari. 2025. Utilization, challenges, and training needs of digital health technologies: Perspectives from healthcare professionals. *International Journal of Medical Informatics* 197 (2025), 105833. doi:10.1016/j.ijmedinf.2025.105833
- [78] Resham B Khatri, Aklilu Endalamaw, Daniel Erku, Eskinder Wolka, Frehiwot Nigatu, Anteneh Zewdie, and Yibeltal Assefa. 2024. Enablers and barriers of community health programs for improved equity and universal coverage of primary health care services: A scoping review. *BMC primary care* 25, 1 (2024), 385.
- [79] Elaine C Khoong and Alicia Fernandez. 2021. Addressing gaps in interpreter use: time for implementation science informed multi-level interventions. *Journal of general internal medicine* 36, 11 (2021), 3532–3536.
- [80] Jaehyung Kim and Yiming Yang. 2025. Few-shot Personalization of LLMs with Mis-aligned Responses. In *Proceedings of the 2025 Conference of the Nations of the Americas Chapter of the Association for Computational Linguistics: Human Language Technologies (Volume 1: Long Papers)*, Luis Chiruzzo, Alan Ritter, and Lu Wang (Eds.). Association for Computational Linguistics, Albuquerque, New Mexico, 11943–11974. doi:10.18653/v1/2025.naacl-long.598
- [81] Eileen Koski and Judy Murphy. 2021. AI in Healthcare. In *Nurses and midwives in the digital age*. IOS Press, 295–299.
- [82] Gerardo Lazaro, Julio Dient Taillepiere, and Chelsea Richwine. 2024. Literacy and Language barriers to overcome in laboratory medicine. *Clinics in laboratory medicine* 44, 4 (2024), 629–645.
- [83] Matthew Le, Apoorv Vyas, Bowen Shi, Brian Karrer, Leda Sari, Rashed Moritz, Mary Williamson, Vimal Manohar, Yossi Adi, Jay Mahadeokar, and Wei-Ning Hsu. 2023. Voicebox: Text-Guided Multilingual Universal Speech Generation at Scale. In *Thirty-seventh Conference on Neural Information Processing Systems*. <https://openreview.net/forum?id=gzCS252hCO>
- [84] Andrea Gurmankin Levy, Aaron M Scherer, Brian J Zikmund-Fisher, Knoll Larkin, Geoffrey D Barnes, and Angela Fagerlin. 2018. Prevalence of and factors associated with patient nondisclosure of medically relevant information to clinicians. *JAMA network open* 1, 7 (2018), e185293–e185293.
- [85] Tianshi Li, Sauvik Das, Hao-Ping Lee, Dakuo Wang, Bingsheng Yao, and Zhiping Zhang. 2024. Human-centered privacy research in the age of large language models. In *Extended Abstracts of the CHI Conference on Human Factors in Computing Systems*. 1–4.
- [86] Xiang Li, Zhenyan Lu, Dongqi Cai, Xiao Ma, and Mengwei Xu. 2024. Large Language Models on Mobile Devices: Measurements, Analysis, and Insights. In *Proceedings of the Workshop on Edge and Mobile Foundation Models* (Minato-ku, Tokyo, Japan) (EdgeFM ’24). Association for Computing Machinery, New York, NY, USA, 1–6. doi:10.1145/3662006.3662059
- [87] Calvin A Liang, Sean A Munson, and Julie A Kientz. 2021. Embracing four tensions in human-computer interaction research with marginalized people. *ACM Transactions on Computer-Human Interaction (TOCHI)* 28, 2 (2021), 1–47.
- [88] Q Vera Liao and Jennifer Wortman Vaughan. 2024. AI Transparency in the Age of LLMs: A Human-Centered Research Roadmap. *Harvard Data Science Review Special Issue* 5 (may 31 2024). <https://hdsr.mitpress.mit.edu/pub/aclq9qy>.
- [89] Danny W Lingonegoro, Xavier Sanchez-Flores, and Jennifer T Huang. 2021. How telemedicine may exacerbate disparities in patients with limited English proficiency. *Journal of the American Academy of Dermatology* 84, 6 (2021), e289.
- [90] Dingdong Liu, Yujing Zhang, Bolin Zhao, Shuai Ma, Chuhan Shi, and Xiaojuan Ma. 2025. Scaffolded Turns and Logical Conversations: Designing Humanized LLM-Powered Conversational Agents for Hospital Admission Interviews. In *Proceedings of the 2025 CHI Conference on Human Factors in Computing Systems (CHI ’25)*. Association for Computing Machinery, New York, NY, USA, Article 643, 23 pages. doi:10.1145/3706598.3714196
- [91] Duri Long and Brian Magerko. 2020. What is AI literacy? Competencies and design considerations. In *Proceedings of the 2020 CHI conference on human factors in computing systems*. 1–16.
- [92] Samaneh Madanian, Ivana Nakarada-Kordic, Stephen Reay, and T’heniel Chetty. 2023. Patients’ perspectives on digital health tools. *PEC Innovation* 2 (May 2023), 100171. doi:10.1016/j.pecim.2023.100171
- [93] Selene S Mak, Rebecca L Kinney, Anne L Bailey, Allison E Gaffey, Mark R Relyea, Elias K Spanakis, and Garrett I Ash. 2025. Integrating Consumer-Grade Wearable Devices and Patient-Generated Health Data into Clinical Care: Perspectives from Healthcare Professionals at a Learning Health System. *Journal of General Internal Medicine* (2025), 1–12.
- [94] Shiva Maleki Varnosfaderani and Mohamad Forouzanfar. 2024. The role of AI in hospitals and clinics: transforming healthcare in the 21st century. *Bioengineering* 11, 4 (2024), 337.
- [95] Gonzalo Martínez, Marina Mayor-Rocher, Cris Pozo Huertas, Nina Melero, Maria Grandury, and Pedro Reviriego. 2025. Spanish is not just one: A dataset of Spanish dialect recognition for LLMs. *Data in Brief* (2025), 112088.
- [96] Marina Mayor-Rocher, Cristina Pozo, Nina Melero, Gonzalo Martínez, Maria Grandury, and Pedro Reviriego. 2025. It’s the same but not the same: Do LLMs distinguish Spanish varieties? *arXiv preprint arXiv:2504.20049* (2025).
- [97] Nikita Mehndru, Sweta Agrawal, Yimin Xiao, Ge Gao, Elaine Khoong, Marine Carpuat, and Niloufar Salehi. 2023. Physician Detection of Clinical Harm in Machine Translation: Quality Estimation Aids in Reliance and Backtranslation Identifies Critical Errors. In *Proceedings of the 2023 Conference on Empirical Methods in Natural Language Processing*, Houda Bouamor, Juan Pino, and Kalika Bali (Eds.). Association for Computational Linguistics, Singapore, 11633–11647. doi:10.18653/v1/2023.emnlp-main.712
- [98] D. Douglas Miller and Eric W Brown. 2018. Artificial Intelligence in Medical Practice: The Question to the Answer? *The American Journal of Medicine* 131, 2 (Feb 2018), 129–133. doi:10.1016/j.amjmed.2017.10.035
- [99] Rose L Molina and Jennifer Kasper. 2019. The power of language-concordant care: a call to action for medical schools. *BMC medical education* 19, 1 (2019), 378.
- [100] Hussein Mozannar, Gagan Bansal, Cheng Tan, Adam Fourney, Victor Dibia, Jingya Chen, Jack Gerrits, Tyler Payne, Matheus Kunzler Maldaner, Madeleine Grunde-McLaughlin, Eric Zhu, Griffin Bassman, Jacob Alber, Peter Chang, Ricky Loynd, Friederike Niedtner, Ece Kamar, Maya Murad, Rafah Hosn, and Saleema Amershi. 2025. Magentic-UI: Towards Human-in-the-loop Agentic Systems. *ArXiv abs/2507.22358* (2025). <https://api.semanticscholar.org/CorpusID:280391757>
- [101] Lior Naamati-Schneider and Dorit Alt. 2024. Beyond digital literacy: The era of AI-powered assistants and evolving user skills. *Education and information technologies* 29, 16 (2024), 21263–21293.

- [102] Numaan Naeem, Abdellah El Mekki, and Muhammad Abdul-Mageed. 2025. EDUADAPT: A Question Answer Benchmark Dataset for Evaluating Grade-Level Adaptability in LLMs. In *Proceedings of the 2025 Conference on Empirical Methods in Natural Language Processing*. 34224–34251.
- [103] Bonnie A. Nardi and Yrjö Engeström. 1999. A Web on the Wind: The Structure of Invisible Work. *Comput. Supported Coop. Work* 8, 1–2 (Feb. 1999), 1–8. doi:10.1023/A:1008694621289
- [104] Sarah Nouri, Elaine C Khoong, Courtney R Lyles, and Leah Karliner. 2020. Addressing equity in telemedicine for chronic disease management during the Covid-19 pandemic. *NEJM Catalyst Innovations in Care Delivery* 1, 3 (2020).
- [105] Team Olmo, Allyson Ettinger, Amanda Bertsch, Bailey Kuehl, David Graham, David Heineman, Dirk Groeneveld, Faeze Brahman, Finbarr Timbers, Hamish Ivson, et al. 2025. Olmo 3. *arXiv preprint arXiv:2512.13961* (2025).
- [106] Lucille ML Ong, Mechteld RM Visser, Frits B Lammes, and Johanna CJM De Haes. 2000. Doctor–patient communication and cancer patients’ quality of life and satisfaction. *Patient education and counseling* 41, 2 (2000), 145–156.
- [107] OpenAI. 2025. Introducing Deep Research. Accessed: 2025-06-30.
- [108] Kathleen R Page and Sarah Polk. 2017. Chilling effect? Post-election health care use by undocumented and mixed-status families. *New England Journal of Medicine* 376, 12 (2017), e20.
- [109] Anghela Z Paredes, Jay J Idrees, Eliza W Beal, Qinyu Chen, Emily Cerier, Victor Okunrintemi, Griffin Olsen, Steven Sun, Jordan M Cloyd, and Timothy M Pawlik. 2018. Influence of English proficiency on patient-provider communication and shared decision-making. *Surgery* 163, 6 (2018), 1220–1225.
- [110] Andrea G. Parker, Laura M. Vardoulakis, Jatin Alla, and Christina N. Harrington. 2025. Participatory AI Considerations for Advancing Racial Health Equity. In *Proceedings of the 2025 CHI Conference on Human Factors in Computing Systems (CHI ’25)*. Association for Computing Machinery, New York, NY, USA, Article 803, 24 pages. doi:10.1145/3706598.3713165
- [111] Shena Parthab Taylor, Colette Nicole, and Martin Maguire. 2013. Cross-cultural communication barriers in health care. *Nursing Standard* 27, 31 (2013).
- [112] Lily Payvandi, Chase Parsons, Fabienne C Bourgeois, and Jonathan D Hron. 2022. Inpatient Telehealth Experience of Patients with Limited English Proficiency: Cross-sectional Survey and Semistructured Interview Study. *JMIR Formative Research* 6, 4 (Apr 2022), e34354. doi:10.2196/34354
- [113] Dorian Peters, Fernanda Espinoza, Marco Da Re, Guido Ivetta, Luciana Benotti, and Rafael A Calvo. 2025. Towards culturally-appropriate conversational AI for health in the majority world: An exploratory study with citizens and professionals in Latin America. *arXiv preprint arXiv:2507.01719* (2025).
- [114] Dzung Pham, Jade Sheffey, Chau Minh Pham, and Amir Houmansadr. 2025. ProxyGPT: Enabling User Anonymity in LLM Chatbots via (Un)Trustworthy Volunteer Proxies. *arXiv:2407.08792 [cs.CR]* <https://arxiv.org/abs/2407.08792>
- [115] Alisha Pradhan, Amanda Lazar, and Leah Findlater. 2020. Use of Intelligent Voice Assistants by Older Adults with Low Technology Use. *ACM Trans. Comput.-Hum. Interact.* 27, 4, Article 31 (Sept. 2020), 27 pages. doi:10.1145/3373759
- [116] Md. Aminur Rahman, Rayhan Rashed, Sharmin Akther Purabi, Noshin Ulfat, Sriram Chellappan, and A. B. M. Alim Al Islam. 2021. Dakter Bari: Introducing Intermediary to Ensure Healthcare Services to Extremely Impoverished People. *Proc. ACM Hum.-Comput. Interact.* 5, CSCW1, Article 44 (April 2021), 30 pages. doi:10.1145/3449118
- [117] Lori Raney, David Bergman, John Torous, and Michael Hasselberg. 2017. Digitally driven integrated primary care and behavioral health: How technology can expand access to effective treatment. *Current Psychiatry Reports* 19, 11 (2017), 86.
- [118] Holger Regenbrecht, Tobias Langlotz, Christine Ho, Mark George, Andrew Gray, Russell Walmsley, and Michael Schultz. 2014. Field test of a questionnaire-based mobile health reporting system. In *Proceedings of the 26th Australian Computer-Human Interaction Conference on Designing Futures: the Future of Design*. 384–387.
- [119] Emily Reif, Daphne Ippolito, Ann Yuan, Andy Coenen, Chris Callison-Burch, and Jason Wei. 2022. A Recipe for Arbitrary Text Style Transfer with Large Language Models. In *Proceedings of the 60th Annual Meeting of the Association for Computational Linguistics (Volume 2: Short Papers)*, Smaranda Muresan, Preslav Nakov, and Aline Villavicencio (Eds.). Association for Computational Linguistics, Dublin, Ireland, 837–848. doi:10.18653/v1/2022.acl-short.94
- [120] Katharina Reinecke and Abraham Bernstein. 2011. Improving performance, perceived usability, and aesthetics with culturally adaptive user interfaces. *ACM Trans. Comput.-Hum. Interact.* 18, 2, Article 8 (July 2011), 29 pages. doi:10.1145/1970378.1970382
- [121] Jorge A Rodriguez, Joseph R Betancourt, Thomas D Sequist, and Ishani Ganguli. 2021. Differences in the use of telephone and video telemedicine visits during the COVID-19 pandemic. *The American journal of managed care* 27, 1 (2021), 21.
- [122] Mollie A Ruben, Danielle Blanch-Hartigan, and Judith A Hall. 2020. Communication skills to engage patients in treatment. *The Wiley Handbook of Healthcare Treatment Engagement: Theory, Research, and Clinical Practice* (2020), 274–296.
- [123] Mana Samiee, Joel Wester, Rune Moberg Jacobsen, Michael Skovdal Rathleff, and Niels van Berkel. 2025. General Practitioners’ Perspectives on a Pre-Consultation Chatbot for Shared Decision-Making. In *Proceedings of the 2025 ACM Designing Interactive Systems Conference (DIS ’25)*. Association for Computing Machinery, New York, NY, USA, 3117–3131. doi:10.1145/3715336.3735674
- [124] Sebastin Santy, Jenny Liang, Ronan Le Bras, Katharina Reinecke, and Maarten Sap. 2023. NLPositionality: Characterizing Design Biases of Datasets and Models. In *Proceedings of the 61st Annual Meeting of the Association for Computational Linguistics (Volume 1: Long Papers)*, Anna Rogers, Jordan Boyd-Graber, and Naoaki Okazaki (Eds.). Association for Computational Linguistics, Toronto, Canada, 9080–9102. doi:10.18653/v1/2023.acl-long.505
- [125] Maarten Sap, Dallas Card, Saadia Gabriel, Yejin Choi, and Noah A. Smith. 2019. The Risk of Racial Bias in Hate Speech Detection. In *Proceedings of the 57th Annual Meeting of the Association for Computational Linguistics*, Anna Korhonen, David Traum, and Lluís Màrquez (Eds.). Association for Computational Linguistics, Florence, Italy, 1668–1678. doi:10.18653/v1/P19-1163
- [126] Dean Schillinger, Renu Balyan, Scott A Crossley, Danielle S McNamara, Jennifer Y Liu, and Andrew J Karter. 2021. Employing computational linguistics techniques to identify limited patient health literacy: findings from the ECLIPSE study. *Health services research* 56, 1 (2021), 132–144.
- [127] Barbara C Schouten, Antoon Cox, Gözde Duran, Koen Kerremans, Leyla Köseoglu Banning, Ali Lahdidioui, Maria Van Den Muijsenbergh, Sanne Schinkel, Hande Sungur, Jeanine Suurmond, et al. 2020. Mitigating language and cultural barriers in healthcare communication: Toward a holistic approach. *Patient Education and Counseling* 103, 12 (2020), 2604–2608.
- [128] Woosuk Seo, Ayse G Buyuktur, Sung Won Choi, Laura Sedig, and Sun Young Park. 2021. Challenges in the parent-child communication of health-related information in pediatric cancer care. *Proceedings of the ACM on Human-Computer Interaction* 5, CSCW1 (2021), 1–24.
- [129] Emre Sezgin. 2023. Artificial intelligence in healthcare: complementing, not replacing, doctors and healthcare providers. *Digital health* 9 (2023), 20552076231186520.
- [130] Mohammed Yousef Shaheen. 2021. Applications of Artificial Intelligence (AI) in healthcare: A review. *ScienceOpen Preprints* (2021).
- [131] Omar Shaikh, Michelle S Lam, Joey Hejna, Yijia Shao, Michael S Bernstein, and Diyi Yang. 2024. Show, Don’t Tell: Aligning Language Models with Demonstrated Feedback. *CoRR* (2024).
- [132] Omar Shaikh, Shardul Sapkota, Shan Rizvi, Eric Horvitz, Joon Sung Park, Diyi Yang, and Michael S Bernstein. 2025. Creating General User Models from Computer Use. *arXiv preprint arXiv:2505.10831* (2025).
- [133] Omar Shaikh, Caleb Ziemis, William Held, Aryan Pariani, Fred Morstatter, and Diyi Yang. 2023. Modeling cross-cultural pragmatic inference with codenames duet. In *Findings of the Association for Computational Linguistics: ACL 2023*. 6550–6569.
- [134] Hua Shen, Tiffany Kneare, Reshmi Ghosh, Yu-Ju Yang, Nicholas Clark, Tanu Mitra, and Yun Huang. 2025. Valuecompass: A framework for measuring contextual value alignment between human and llms. In *Proceedings of the 9th Widening NLP Workshop*. 75–86.
- [135] Jiayue Melissa Shi, Dong Whi Yoo, Keran Wang, Violeta J Rodriguez, Ravi Karkar, and Koustuv Saha. 2025. Mapping Caregiver Needs to AI Chatbot Design: Strengths and Gaps in Mental Health Support for Alzheimer’s and Dementia Caregivers. *arXiv preprint arXiv:2506.15047* (2025).
- [136] Benjamin Smith and Jared W Magnani. 2019. New technologies, new disparities: the intersection of electronic health and digital health literacy. *International journal of cardiology* 292 (2019), 280–282.
- [137] Taylor Sorensen, Jared Moore, Jillian Fisher, Mitchell Gordon, Niloofar Mireshghallah, Christopher Michael Rytting, Andre Ye, Liwei Jiang, Ximing Lu, Nouha Dziri, et al. 2024. A roadmap to pluralistic alignment. *arXiv preprint arXiv:2402.05070* (2024).
- [138] Richard L Street Jr, Gregory Makoul, Neeraj K Arora, and Ronald M Epstein. 2009. How does communication heal? Pathways linking clinician–patient communication to health outcomes. *Patient education and counseling* 74, 3 (2009), 295–301.
- [139] Jina Suh, Sachin R Pendse, Robert Lewis, Esther Howe, Koustuv Saha, Ebele Okoli, Judith Amores, Gonzalo Ramos, Jenny Shen, Judith Borghouts, et al. 2024. Rethinking technology innovation for mental health: framework for multi-sectoral collaboration. *Nature Mental Health* 2, 5 (2024), 478–488.
- [140] Aswita Tan-McGrory, Lee H Schwamm, Christopher Kirwan, Joseph R Betancourt, and Esteban A Barreto. 2022. Addressing virtual care disparities for patients with limited English proficiency. *American Journal of Managed Care* 28, 1 (2022).
- [141] Eric S Tellez, Daniela Moctezuma, Sabino Miranda, Mario Graff, and Guillermo Ruiz. 2023. Regionalized models for Spanish language variations based on Twitter. *Language resources and evaluation* 57, 4 (2023), 1697–1727.
- [142] Aaron A Tierney, Gregg Gayre, Brian Hoberman, Britt Mattern, Manuel Ballesca, Patricia Kipnis, Vincent Liu, and Kristine Lee. 2024. Ambient artificial intelligence scribes to alleviate the burden of clinical documentation. *NEJM Catalyst Innovations in Care Delivery* 5, 3 (2024), CAT–23.
- [143] Abhishek Tiwary, Ajwani Rimal, Buddhi Paudyal, Keshav Raj Sigdel, and Budha Basnyat. 2019. Poor communication by health care professionals may lead

- to life-threatening complications: examples from two case reports. *Wellcome open research* 4 (2019), 7.
- [144] Kentaro Toyama. 2015. *Geek heresy: Rescuing social change from the cult of technology*. PublicAffairs.
- [145] JA Unger, Keshet Ronen, Trevor Perrier, Brian DeRenzi, Jennifer Slyker, AL Drake, Dyphna Mogaka, John Kinuthia, and Grace John-Stewart. 2018. Short message service communication improves exclusive breastfeeding and early postpartum contraception in a low-to middle-income country setting: a randomised trial. *BJOG: An International Journal of Obstetrics & Gynaecology* 125, 12 (2018), 1620–1629.
- [146] U.S. Census Bureau. 2022. 2022 Census: Language Use in the United States.
- [147] Nervo Verdezoto, Naveen Bagalkot, Syeda Zainab Akbar, Swati Sharma, Nicola Mackintosh, Deirdre Harrington, and Paula Griffiths. 2021. The invisible work of maintenance in community health: challenges and opportunities for digital health to support frontline health workers in Karnataka, South India. *Proceedings of the ACM on Human-Computer Interaction* 5, CSCW1 (2021), 1–31.
- [148] Peter Vermeir, Dominique Vandijk, Sophie Degroote, Renaat Peleman, Rik Verhaeghe, Eric Mortier, Giorgio Hallaert, Sabine Van Daele, Walter Buylaert, and Dirk Vogelaers. 2015. Communication in healthcare: a narrative review of the literature and practical recommendations. *International journal of clinical practice* 69, 11 (2015), 1257–1267.
- [149] Callum Verran. 2024. Artificial intelligence-generated patient information leaflets: a comparison of contents according to British Association of Dermatologists standards. *Clinical and Experimental Dermatology* 49, 7 (2024), 711–714.
- [150] Morgan Vigil-Hayes, Ann Futterman Collier, Shelby Hagemann, Giovanni Castillo, Keller Mikkelsen, Joshua Dingman, Andrew Muñoz, Jade Luther, and Alexandra McLaughlin. 2021. Integrating Cultural Relevance into a Behavioral mHealth Intervention for Native American Youth. *Proc. ACM Hum.-Comput. Interact.* 5, CSCW1, Article 165 (April 2021), 29 pages. doi:10.1145/3449239
- [151] Smrithi Vijayakumar, V Vien Lee, Qiao Ying Leong, Soo Jung Hong, Agata Blasiak, and Dean Ho. 2023. Physicians’ perspectives on AI in clinical decision support systems: interview study of the CURATE. AI personalized dose optimization platform. *JMIR Human Factors* 10 (2023), e48476.
- [152] Azmine Toughik Wasi. 2025. AI for Social Good and Public Impact in Marginalized Communities: A Cross-Cultural Framework. In *International Conference on Social Impact of AI*. Springer, 1–12.
- [153] Lara Whitehead, Jason Talevski, Farhad Fatehi, and Alison Beauchamp. 2023. Barriers to and facilitators of digital health among culturally and linguistically diverse populations: qualitative systematic review. *Journal of medical Internet research* 25 (2023), e42719.
- [154] Nyna Williams, Chris Fleming, and Annie Doubleday. 2017. Patient and provider perspectives on shared decision making: a systematic review of the peer-reviewed literature. *Journal of Comparative Effectiveness Research* 6, 8 (2017), 683–692.
- [155] Steven Woloshin, Lisa M Schwartz, Steven J Katz, and H Gilbert Welch. 1997. Is language a barrier to the use of preventive services? *Journal of general internal medicine* 12, 8 (1997), 472–477.
- [156] Qian Wu, Zheyao Gao, Longfei Gou, Yifan Hou, Ann Sin Nga Lau, and Qi Dou. 2025. HealthCards: Exploring Text-to-Image Generation as Visual Aids for Healthcare Knowledge Democratizing and Education. In *Proceedings of the 2025 Conference on Empirical Methods in Natural Language Processing*, Christos Christodoulopoulos, Tanmoy Chakraborty, Carolyn Rose, and Violet Peng (Eds.). Association for Computational Linguistics, Suzhou, China, 27524–27546. doi:10.18653/v1/2025.emnlp-main.1401
- [157] Shujin Wu, May Fung, Cheng Qian, Jeonghwan Kim, Dilek Hakkani-Tur, and Heng Ji. 2024. Aligning llms with individual preferences via interaction. *arXiv preprint arXiv:2410.03642* (2024).
- [158] Shujin Wu, Yi R. Fung, Cheng Qian, Jeonghwan Kim, Dilek Hakkani-Tur, and Heng Ji. 2025. Aligning LLMs with Individual Preferences via Interaction. In *Proceedings of the 31st International Conference on Computational Linguistics*, Owen Rambow, Leo Wanner, Marianna Apidianaki, HEND AL-KHALIFA, Barbara Di Eugenio, and Steven Schockaert (Eds.). Association for Computational Linguistics, Abu Dhabi, UAE, 7648–7662. <https://aclanthology.org/2025.coling-main.511/>
- [159] Shixian Xie, John Zimmerman, and Motahhare Eslami. 2025. Exploring What People Need to Know to be AI Literate: Tailoring for a Diversity of AI Roles and Responsibilities. In *Proceedings of the 2025 CHI Conference on Human Factors in Computing Systems (CHI ’25)*. Association for Computing Machinery, New York, NY, USA, Article 1018, 16 pages. doi:10.1145/3706598.3713841
- [160] Rui Yao, Wenli Zhang, Richard Evans, Guang Cao, Tianqi Rui, and Lining Shen. 2022. Inequities in health care services caused by the adoption of digital health technologies: scoping review. *Journal of medical Internet research* 24, 3 (2022), e34144.
- [161] Dong Whi Yoo, Jiayue Melissa Shi, Violeta J Rodriguez, and Koustuv Saha. 2025. AI Chatbots for Mental Health: Values and Harms from Lived Experiences of Depression. *arXiv preprint arXiv:2504.18932* (2025).
- [162] Xiaojun Yuan, DeeDee Bennett Gayle, Thora Knight, and Elisabeth Dubois. 2023. Adoption of artificial intelligence technologies by often marginalized populations. *Social Vulnerability to COVID-19: Impacts of Technology Adoption and Information Behavior* (2023), 31–49.
- [163] Jonah Zaretsky, Jeong Min Kim, Samuel Baskharoun, Yunan Zhao, Jonathan Austrian, Yindalon Aphinyanaphongs, Ravi Gupta, Saul B Blecker, and Jonah Feldman. 2024. Generative artificial intelligence to transform inpatient discharge summaries to patient-friendly language and format. *JAMA network open* 7, 3 (2024), e240357–e240357.
- [164] Angie Zhang and Min Kyung Lee. 2025. Knowledge Workers’ Perspectives on AI Training for Responsible AI Use. In *Proceedings of the 2025 CHI Conference on Human Factors in Computing Systems*. 1–18.

A AI Literacy Questionnaire

In the recruitment form, we adapted a basic AI literacy questionnaire from [51]. All questions were asked on a 5-point Likert scale ranging from 1 (strongly disagree) to 5 (strongly agree). The questions were as follows, along with the mean and standard deviation of the participant responses:

- (1) I understand the basic concepts of artificial intelligence. ($M = 3.86, SD = 0.86$)
- (2) I can judge the pros and cons of AI. ($M = 3.64, SD = 0.74$)
- (3) I keep up with the latest AI trends. ($M = 2.86, SD = 1.03$)
- (4) I am comfortable talking about AI with others. ($M = 3.86, SD = 1.23$)
- (5) I can think of new ways to use existing AI tools. ($M = 3.36, SD = 1.08$)

A.1 Storyboards

We include the list of all the storyboards in our study in [Figure 2](#).

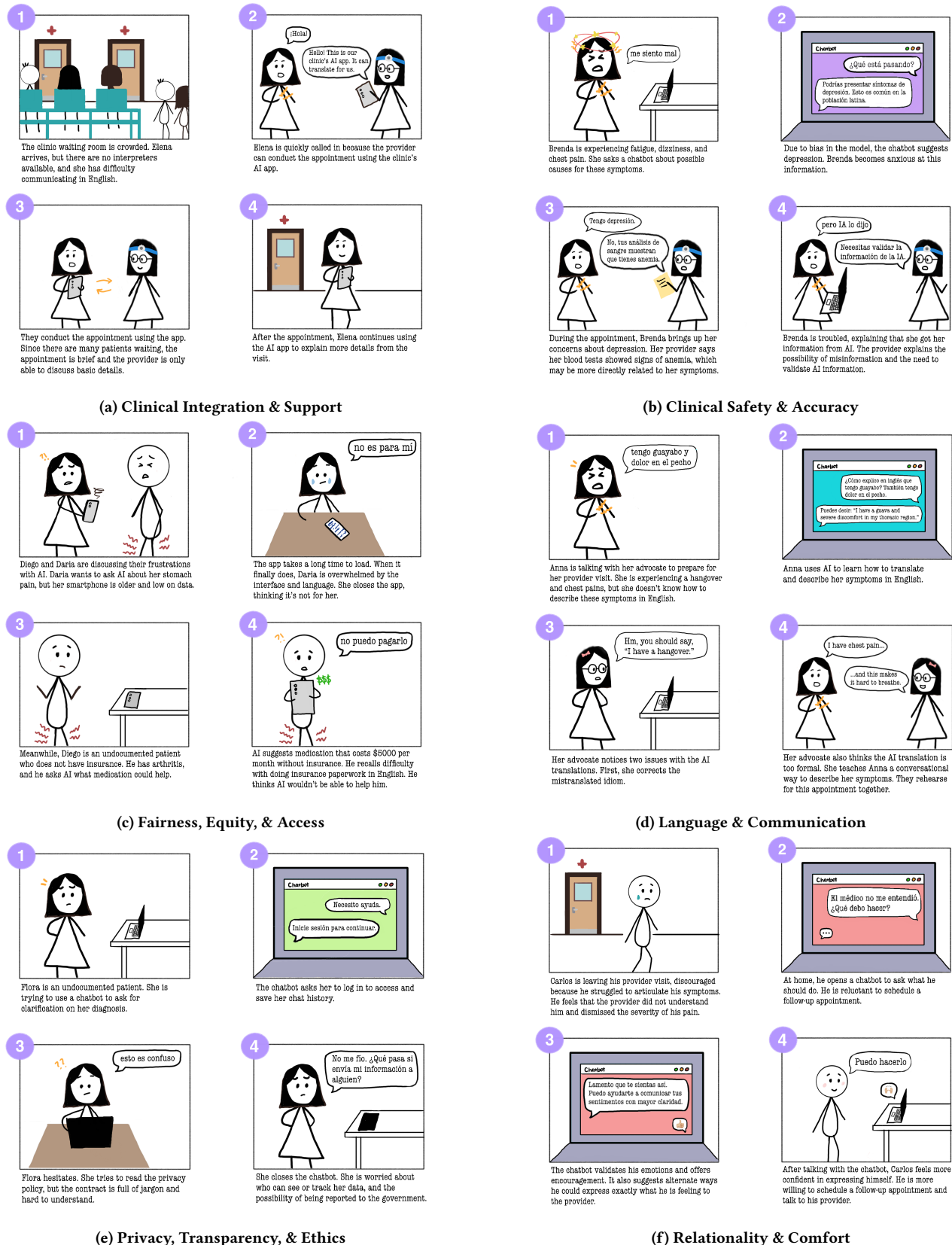

Figure 2: Storyboards used in interviews with patient navigators.