

AgentBuilder: Exploring Scaffolds for Prototyping User Experiences of Interface Agents

JENNY T. LIANG*, Carnegie Mellon University, USA

TITUS BARIK, Apple, USA

JEFFREY NICHOLS, Apple, USA

ELDON SCHOOP, Apple, USA

RUIJIA CHENG, Apple, USA

Interface agents powered by generative AI models (referred to as “agents”) can automate actions based on user commands. An important aspect of developing agents is their user experience (i.e., agent experience). There is a growing need to provide scaffolds for a broader set of individuals beyond AI engineers to prototype agent experiences, since they can contribute valuable perspectives to designing agent experiences. In this work, we explore the affordances agent prototyping systems should offer by conducting a requirements elicitation study with 12 participants with varying experience with agents. We identify key activities in agent experience prototyping and the desired capabilities of agent prototyping systems. We instantiate those capabilities in the AgentBuilder design probe for agent prototyping. We conduct an *in situ* agent prototyping study with 14 participants using AgentBuilder to validate the design requirements and elicit insights on how developers prototype agents and what their needs are in this process.

ACM Reference Format:

Jenny T. Liang, Titus Barik, Jeffrey Nichols, Eldon Schoop, and Ruijia Cheng. 2018. AgentBuilder: Exploring Scaffolds for Prototyping User Experiences of Interface Agents. In *Proceedings of Make sure to enter the correct conference title from your rights confirmation email (Conference acronym 'XX)*. ACM, New York, NY, USA, 33 pages. <https://doi.org/XXXXXXX.XXXXXXX>

1 Introduction

Mei is an interaction designer. She is hired by a coffee shop to deliver a new AI agent experience on their website to take customers’ commands in natural language and execute the tasks by navigating through the website. As Mei brainstorms what the user experience with the agent should be like, she is not sure whether the agent should frequently ask for user input, perform the task and send a summary at the end, or something in between. Mei wants to test these ideas, but she does not have a formal background in AI or software development. She wishes there was some kind of scaffold for her to easily prototype these experiences.

Mei wants to develop an *interface agent*, which is an AI that automates actions in user interfaces by understanding user habits, preferences, and interests [39, 51]. In recent years, multimodal and vanilla large language models (i.e.,

*Work completed while at Apple

Authors’ Contact Information: Jenny T. Liang, jtliang@cs.cmu.edu, Carnegie Mellon University, Pittsburgh, Pennsylvania, USA; Titus Barik, tbarik@apple.com, Apple, Seattle, Washington, USA; Jeffrey Nichols, jwnichols@apple.com, Apple, San Diego, California, USA; Eldon Schoop, eldon@apple.com, Apple, Seattle, Washington, USA; Ruijia Cheng, rcheng23@apple.com, Apple, Seattle, Washington, USA.

Permission to make digital or hard copies of all or part of this work for personal or classroom use is granted without fee provided that copies are not made or distributed for profit or commercial advantage and that copies bear this notice and the full citation on the first page. Copyrights for components of this work owned by others than the author(s) must be honored. Abstracting with credit is permitted. To copy otherwise, or republish, to post on servers or to redistribute to lists, requires prior specific permission and/or a fee. Request permissions from permissions@acm.org.

© 2018 Copyright held by the owner/author(s). Publication rights licensed to ACM.

Manuscript submitted to ACM

1. Requirements Elicitation Study

Interview

6 experts + 6 non-experts

Identify 5 agent development activities (A1-A5) to derive 6 desired system capabilities (C1-C6)

2. AgentBuilder Design Probe

3. In Situ Agent Prototyping Study

Design probe study

with 14 non-experts to identify fine-grained *developer needs*

Support tracking of detailed runtime information and potential errors.

Support sensemaking and adjusting of how the agent makes decisions.

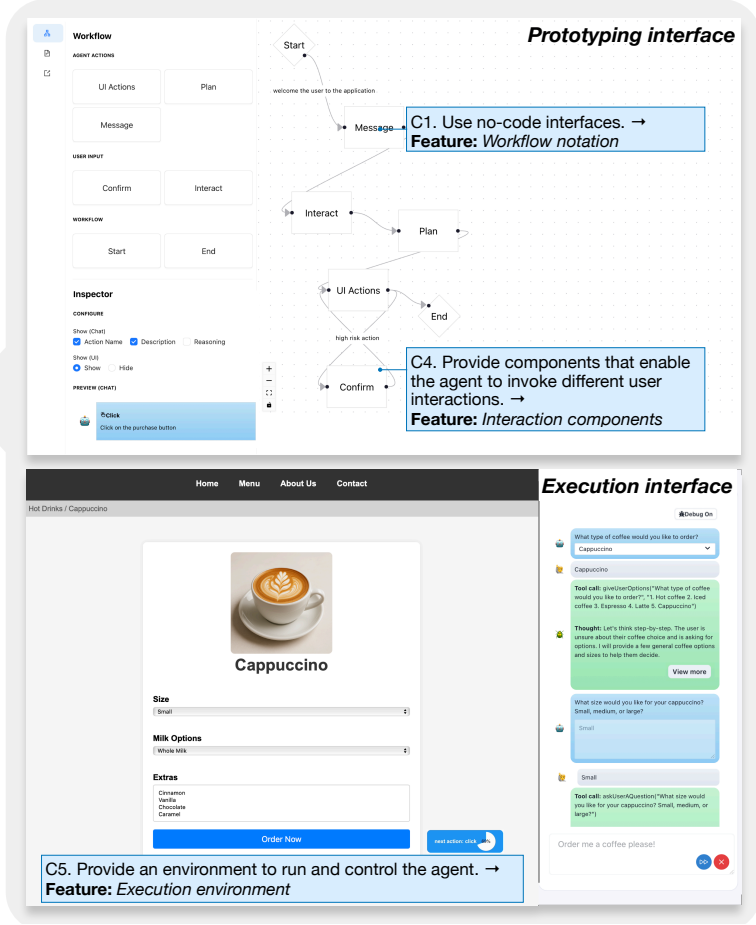

Fig. 1. An overview of the study. We first perform a requirements elicitation study (Section 3) to elicit the design requirements of agent prototyping systems, which consist of the five Activities involved in agent experience prototyping and six Desired Capabilities of agent prototyping systems. Based on the Activities and Desired Capabilities, we implement these design requirements in AgentBuilder (Section 4) use the tool as a probe to understand agent prototyping by conducting an *in situ* agent prototyping study (Section 5) to identify developer needs in agent prototyping.

(M)LLMs have rapidly emerged to power interface agents [18, 21, 24, 35, 56, 59], which we refer to in this work as *agents*. Agents are powered by generative AI models that can consider a user’s intent or instructions and complete a task on a UI environment (i.e., desktop [18, 59], mobile [56], web [21, 24, 45, 67, 68]; specific applications such as Excel [35] and code IDEs [48]; etc.), by calling upon external modules ranging from code executors [18] to clicking on a UI element [21, 23, 24].

Since developing agents typically requires AI engineering expertise and knowledge of specialized APIs automating application actions [39, 40], prototyping agents tailored to applications such as Mei’s has traditionally been limited to agent experts, such as machine learning researchers. However, as illustrated by Mei’s experience, an important aspect of agent development is designing the user experience [22, 50, 51], which we refer to as *agent experience*. There is a growing need for a broader set of individuals like Mei, such as traditional software engineers, UX designers, product

Manuscript submitted to ACM

managers, or even end-users—who are not agent experts and lack the knowledge to program agents—to design and prototype agent experiences. Prior studies suggest that, when supported by proper prototyping scaffolds [47, 53, 62], these individuals can contribute valuable perspectives to developing well-designed agent experience, bridging design, machine learning, and engineering [13, 27, 53, 61, 63, 64]. Therefore, there needs to be scaffolds that enable a broader range of individuals to design and prototype agent experience. This is especially critical in the face of the increasing adoption of agents performing actions that result in real-world consequences (e.g., modifying user files, placing online orders) [66], where incorporating input from stakeholders beyond agent experts, like UX designers, could reduce the negative impacts of agents in practice.

In this work, we explore the affordances that an agent prototyping system should offer to effectively scaffold the design of agent experiences. We envision such a system as empowering not only agent experts, but also a broader group of people to prototype agent experiences—together whom we refer to as *developers* of agent experiences. We provide an overview of the study in Figure 1. To this end, we first conduct a requirements elicitation study with 12 participants with various levels of experience with agents. We discover that prototyping agent experiences consists of two experimental and highly iterative phases of designing and inspecting the agent, which are further divided into five distinct *Activities* and six *Desired Capabilities* that an agent prototyping system should afford. We instantiate the Activities and Desired Capabilities in a design probe, AgentBuilder, a graphical, no-code tool designed to support prototyping agent experiences. Using AgentBuilder, we run an *in situ* agent prototyping study with 14 participants to validate the design requirements and further understand the prototyping process and tooling needs of developers, including the need for mechanisms that help developers make sense of various forms of agent input, context, and outputs during execution, as well as to better understand the agent’s technical implementation. Based on these findings, we propose a set of design recommendations for agent prototyping systems.

In summary, the contributions of this work are:

- **A set of validated design requirements for agent prototyping systems**, articulated as five prototyping activities and six capabilities that agent prototyping systems should support.
- **AgentBuilder, a design probe that instantiates the design requirements**, enabling individuals with varying levels of familiarity with agents to prototype agent experiences through a no-code interface.
- **Insights on the needs and process of agent prototyping** based on an *in situ* user study of AgentBuilder.

This work offers a basis for prototyping agent experiences, with the aim of informing future interfaces to support this activity. Our work also serves as a step towards democratizing how AI can be designed and adapted to match user needs by empowering a range of individuals, from domain experts to non-programmers and end-users, to participate in its design [15, 17].

2 Related Work

2.1 Interface Agents

Building and designing “agents” has been studied extensively in HCI [39, 40]. Such agents assist users with tasks at varying levels of autonomy, interacting with specific applications [33] and interfaces like the web [38], and can learn from user preferences [42]. Among this work, interface agents were developed for specific applications, such as for email or calendar applications [33, 42] by leveraging exposed application APIs [39, 40]. Early design considerations of interface agents included how to provide users with sufficient understanding on the agent’s actions, deciding when users should assume control over tasks, how to represent the agent in the UI, the modalities the agent can accept,

and determining what types of support to provide to the user [50, 51]. In mixed-initiative settings, researchers have enumerated multiple important design considerations, such as understanding the role of users in the mixed-initiative interface, deciding when users should provide input, adding agent controls, and determining the scope of services [1, 22].

With the recent development of (M)LLMs, interface agents powered by these models can complete actions in specific applications (e.g., Excel [35]) as well as more general environments like the websites [21, 23], mobile UIs [56], and computer operating systems [59] by semantically understanding user input. One of the most prominent types of interface agents powered by generative AI is web agents—agents for web browsers that can perform UI actions such as clicking on buttons. Much of the existing research on web agents focuses on developing new generative AI agentic approaches [8, 21], benchmarks [8, 45, 68], and evaluation environments [23, 45, 68] to improve web agent performance. Few works, however, consider the design of collaborative human-agent workflows. To our knowledge, the only collaborative web agent is Cowpilot [23], a Chrome extension that allows users to supervise and intervene in web agent tasks, providing a pause before all agent actions.

In this work, we extend the early and current literature on interface agent design considerations by understanding which aspects of user experience are accounted for in prototyping with (M)LLM-based agent experiences.

2.2 Designing for User Experience in Generative AI

Designing for user experience is crucial in designing generative AI technologies, yet remains a significant challenge. Yang et al. [64] found the UX design challenges of AI come from two sources: *capability uncertainty* (i.e., the functionality and potential errors of an AI) and *output complexity* (i.e., the space of what the AI produces as a possible output). With the UX design of generative AI experiences, similar challenges remain. Capability uncertainty persists, since stakeholders of generative AI experiences are often unaware or have unrealistic expectations of generative AI capabilities [12, 65]. Further, the output complexity of generative AI is more pronounced, as the output space of generative AI can be any text, image, or more, depending on the model, creating challenges in managing or understanding generative AI outputs [19, 41]. In response to these new challenges with generative AI, researchers have proposed design guidelines for generative AI experiences, such as suggesting ideas for prompting and generating multiple outputs [52, 57].

Crucial to designing AI user experiences is prototyping, which requires a range of expertise in design, engineering, and machine learning [13, 27, 63, 64]. Researchers have developed techniques to help prototype user experience in generative AI, allowing designers and developers to test existing components representing different aspects of the experience. For example, one promising approach is toolkits to develop speech UIs, such as Suede [29] and CSLU [54], which enables designers to prototype dialogues by composing pre-defined components that were then tested with a Wizard-Of-Oz protocol. PromptInfuser [47] is the only known tool that allows UX designers of generative AI to prototype both UI and prompts at the same time. Our work extends this line of research by exploring opportunities and directions for supporting UX prototyping in agents. Inspired by approaches that provide users with existing components, we envision combining these with prompt development techniques in agents, which we discuss in the next section.

2.3 Developing Prompts for Generative AI Experiences

Developing agent experiences, like other generative AI applications (e.g., chatbots), largely involves writing natural language prompts that are embedded in the application [36, 53, 65]. Prompt development is highly iterative and exploratory [12, 36, 65], where developers prototype and refine their prompt through many interactions with the AI, which in turn drives the requirements and the content within the prompt [36, 37]. As a result, it is important for developers to decide what content to include in a prompt [37]. However, this task is a major challenge for developers [37, 52],

especially in the beginning, when they are unaware of the AI’s capabilities for the task [65]. In the specific case of prompting for user experience, Subramonyam et al. [53] found that the prototyping process of generative AI experiences required rapid exploration of prompts and consideration of UI components the AI would use to interact with a user. To support the exploratory iteration in prompting, several tools enable natural language composition support to design, refine, and evaluate prompts for LLMs [5, 25, 26, 28]. Another common approach is node-based approaches for prompt prototyping (e.g., [5, 20, 58]). One such example is ChainForge [5], a tool that enables rapid prototyping of prompting pipelines by creating nodes for user-defined data, metrics, and visualizations that users can chain together.

Meanwhile, agent development is a subset of prompt development that contains its own unique challenges. However, this topic remains understudied. To our knowledge, the only studies are Epperson et al. [14]’s and Hao et al. [20]’s formative studies on developers of multi-agent workflows. While some challenges align with those of developing LLM prompts, like a lack of debugging support [36, 37], other challenges, such as wrangling long agent conversations and managing a large design space of how to decompose task, define agent interactions, assign agent responsibility, and configure individual agent behavior, are unique to this setting. To assist with agent development, FlowForge [20] uses a node-based interface to scaffold the process of defining, viewing, and editing agentic workflows.

In this work, we extend the literature on prompting, including Zamfirescu-Pereira et al. [65]’s study on non-AI expert prompting, by exploring how non-experts design prompts for agent experiences and how we can support such prompting needs using no-code scaffolds.

3 Requirements Elicitation Study

To better understand prototyping agent experiences and to identify opportunities for tools to help, we conducted a requirements elicitation study with 12 participants at a large technology company. We ask the following research questions:

RQ1 What are the important activities that developers engage in while prototyping agent user experiences?

RQ2 What capabilities should a system afford to support agent experience prototyping?

We recruited participants with a wide variety of experience, ranging from participants with relevant domain expertise (experts) to participants who had only passively used, seen, or had no familiarity with agents (non-experts). We asked expert participants about their relevant experiences, probed non-expert participants for the agentic user experience using a mock agent, and elicited feedback while showing existing agent designs for all participants. We were particularly interested in scenarios where already-built agents needed to be adapted to applications that require a specific user experience.

3.1 Methodology

3.1.1 Participants. To recruit study participants, we posted recruitment messages on public message boards at a large technology company for design and machine learning audiences, where 77 individuals expressed interest in the study by filling out a survey. From this list, we invited 12 participants (5 women, 7 men) who covered varying familiarity with agents, spanning technology professionals with relevant domain expertise ($N = 6$, including 2 machine learning engineers, 1 software engineer, 2 quality assurance engineers, and 1 product designer), current end-users ($N = 5$), and individuals having no familiarity ($N = 1$).

3.1.2 Protocol. The user study contained two phases. First, we sought to understand experiences with interface agents generally. For participants with relevant expertise, we conducted a 30-minute interview, where they shared an experience

developing an agent or a similar artifact. They were prompted to discuss the different UX factors they considered, the process of developing the agent, and any challenges they faced. For non-expert participants, to familiarize them with the interaction with an agent, we presented a mock interface agent and had them interact with it to complete 2 tasks (searching for and booking travel accommodations) and then probed for their experiences. We did not collect data from non-expert participants in this part of the study.

Then, for all participants, we presented a slide deck showing examples of agent experience patterns from several existing agents, many of which appeared with a chat panel and within a webpage environment. Each slide contained screenshots of examples that focused on a single part of the interaction, starting from when a user inputs a query, to when an agent executed the action on a UI. After presenting each example, participants discussed what features they would like the agent to have across various scenarios.

Sessions were conducted remotely over a videoconferencing platform and lasted between 60 and 90 minutes (for experts and non-experts, respectively). Sessions were recorded and transcribed for analysis. Participants were compensated with a \$24 meal voucher.

3.1.3 Analysis. The study team qualitatively analyzed the interview transcripts, focusing on the various activities during agent prototyping through provisional coding [49], where the research team developed an initial list of codes through preparatory investigation activities such as synthesizing prior literature, results from previous studies, and the researcher’s prior experience. We refined the initial list during qualitative analysis [49] that focused on achieving coder consensus, which is appropriate for research aiming to yield important concepts and themes [43]. These codes were modified by codes that emerged from interview transcripts as part of the provisional coding process, performed by the author who conducted the interview sessions. We achieved code saturation after conducting 10 interviews. The saturated codes were then collapsed, reorganized, and grouped into salient Activities using axial coding [10, 49]. The Activities were further organized into higher-order phases of agent prototyping using theoretical coding [49]. The codes, Activities, and phases of agent prototyping were then reviewed by one of the researchers who helped develop the initial set of codes, following the validation practice in settings with a single coder [49].

3.2 Results

We find that the agent prototyping process involves two main phases: *Designing the Agent* and *Inspecting the Agent*. These phases are highly iterative and experimental, reflecting patterns found in machine learning workflows [2, 46], like developing LLM prompts [36, 65]. Within each phase, there are key *Activities* (labeled “A”) involved in agent prototyping (**RQ1**), which we explain in detail below with *thematic codes* that emerged from our data. We also derived a set of *Desired Capabilities* (labeled “C”) for a system that could support agent prototyping (**RQ2**) by combining study findings with the literature on agent design, detailed in the corresponding Activities.

3.2.1 Designing the Agent. Participants from different backgrounds and levels of technical expertise all expressed the need to prototype agents. They noted that it was difficult to prototype designs due to the engineering challenges of building even a single agent (EP1-EP6), reflecting prior work [24, 67]. For example, EP2 noted that “to build [an agent] demo, you need to string a lot of things together...It’s integration pains with many components. Sometimes you do not have the components you need” (EP2). To support prototyping activities for users of varied skill levels, we derive the first Desired Capability: **C1. Use no-code interfaces**. GUI-based prototyping tools for agent experiences could reduce the engineering challenges associated with prototyping agent experiences, as prompting and no-code interfaces have done for developing LLM applications [16, 25, 44, 53, 65].

We identified three main Activities in agent design: Design the scope and boundaries of the agent (**A1**), Design the agent’s information display (**A2**), and Design the interactions between the agent and user (**A3**).

A1. Design the scope and boundaries of the agent. When designing agent experiences, developers often first consider the high-level activities, actions, and inputs the agent is intended to handle. This was important for designing “guardrails” (EP10) for the agent: “You’re making this promise for your customers, so you have to respect [and] protect [them]” (EP4). We identified two common ways of scoping presented in interviews. The first was selecting the capabilities of the agent—the types of tasks it is expected to execute—which could range from basic actions like “search” (EP8), to higher-risk ones like “payments” (EP8), “delet[ing] photos” (EP4), entering “passwords” (EP8, 12), and “shar[ing] documents” (EP4). In addition to actions, scoping the agent’s capabilities also included the applications the agent could use, like having “access right to [the] calendar” (EP10).

Another important aspect of scope that developers would consider was the agent’s knowledge about the user. This included “personal details” (EP6), what the user “likes [and]...want[s]” (EP9), and the activity history such as “most frequently referenced [concepts]” (EP5). Developers used this information to “build personalized experiences” (EP2) and reduce user effort: “[For] information about myself...I don’t want to repeat over and over...it’s tiresome” (EP10). Participants acknowledged that including a user’s context could expand an agent’s ability to complete tasks on their behalf, but posed risks to the user’s privacy, especially in settings where the agent interacts with the outside world. For example, EP4 discussed how agents operating on messaging applications should have limited access to hidden chats.

From these needs, we derive: **C2. Help constrain the agent’s task space and knowledge of the user.** Prototyping tools should let developers set boundaries for the tasks an agent can perform, and the user information it has access to. This could help constrain the large design space and put the potential risks that agents pose at the forefront of the design process [66].

A2. Design the agent’s information display. Developers also need to consider how the agent appears on the screen, including what information was displayed, such as exposing details of the tools an agent uses to complete a user’s task (e.g., clicking a UI element or invoking an application API), “a small description of [the action]” (EP3), or a summary of multiple actions. The information should be designed at the correct granularity, as too much information could easily “overwhelm [users] with unnecessary information” (EP11). For example, EP11 commented that the information presented was important for tasks such as decision-making: “The user experience should be such that [the confirmation] gives me all the information I need as a user to make a decision” (EP11).

In addition to what information to show about the agents’ activities, agent developers also need to decide on its presentation. This includes how it should appear when interacting with the user (e.g., in a chat window) and when executing tasks in an application interface [48]. The UI components that dictate how an agent solicits user inputs also need to be considered: “How is a user gonna input those parameters? Is it going to be a text box...[or] multiple text fields?” (EP6). Designing how an agent’s actions are represented to the user is also important. Participants discussed how actions could be “invisible” (EP9) or be revealed by highlighting the UI elements, e.g., “drawing a square around [the element] on the screen” (EP1). These findings are corroborated by several works which argue how presentation is an important consideration of designing agents [40, 50, 51], as it can affect users’ perceptions and trust [11].

Therefore we derive: **C3. Define the UI of the agent in the chat and the environment.** Users should be able to control what information is shown and modify its presentation, i.e., in the chat and on the application interface.

A3. Design the interactions between the agent and user. Participants universally desired tools for supporting and constraining specific user interactions, which EP6 felt was important to design for: *“When you’re trying to turn [LLMs] into an experience that isn’t directly conversing with a model, there’s still a lot of boundaries that need to be established. I feel like the work of a designer...is, what are the boundaries of the interaction?”* (EP6). One need pointed out by participants was to identify what **user inputs** could be needed during interactions, such as requesting confirmation for actions with impacts or *“prompting”* (EP3) the user through a *“conversational interaction”* (EP6) if it encountered errors. This motivates the need to curate **interaction components** provided to the agent that enable it to interact with the user, and to establish **conditions** for the agent to invoke them: *“Sometimes, we as a human also make decisions about when to intervene [with] the agent”* (EP3). Interaction components may be implemented as “tools” provided to the model [4], but are distinct from tools that ground actions into the UI because they mediate interactions with the user and support more collaborative workflows with agents.

In addition to designing *how* the user and agent communicate information during the task, another common theme was controlling proactivity, or *when* the agent initiated communication. EP2 described a *“slider of...autonomy”* (EP2), ranging from being supervised or collaborative to fully autonomous, depending on factors such as user trust in the system or how open-ended the task is: *“There are two paradigms: either you want... the model to handle everything, or you want to be the driver...and the model just does things”* (EP4). It is challenging for developers to design the right level of autonomy of the agent, as *“everybody wants something different”* (EP10): *“There’s a challenge between being so obnoxious about [asking for input]...but at least it lets you know, ‘Hey, I’ve encountered an issue’”* (EP10).

We therefore derive the requirement: **C4. Provide components that enable the agent to invoke different user interactions.** Our findings echo early design principles for agents [22, 50, 51], suggesting that developers should be provided affordances to coordinate the tools that the agent uses to design the experience with the agent, including which **interaction components** the agent calls and the **conditions** under which they are invoked.

3.2.2 Inspecting the Agent. Even sophisticated agents are known exhibit error-prone behaviors in practice, such as performing the wrong action (EP1, EP3). After prototyping agents, developers need to run the agent to validate the agent experience.

A4. Run the agent prototype. Our participants described the need to run prototypes in a test environment to *“get a realistic idea of what our models do”* (EP6) with the prompt. Agents could be assessed through **programmatic testing**, e.g., in benchmarks using online, live environments [32, 34, 60], or offline settings (i.e., a static set of screenshots) [9, 34]. Experienced developers of agents with such evaluations used software tools, e.g., *“command line instructions”* (EP5). Participants also stressed the importance of **manual testing** (EP1, EP3, EP5) by *“send[ing the agent] straight to the device”* (EP5) and observing it execute actions. For developing agents, both forms of evaluation were used: *“We start with manual [testing] but now we automate [with] tests...We have checkpoints that validate that if those checkpoints were reached [by the agent] or not”* (EP3).

Participants also described the need for **agent controls** such as *“pause”* (EP1, EP7), *“interrupt”* (EP1, EP2, EP4), *“cancel”* (EP7, EP8), or *“continue”* (EP8) commands.

A prototyping system for agent experience must: **C5. Provide an environment to run and control the agent.** Users should be able to run their agent prototype, just as LLM prompts need to be run for one to observe and understand the prompt prototype’s behavior [36, 65]. Such systems should at minimum allow for **manual testing** of the agent, emphasized in the development of generative AI experiences [36]. In addition, these systems should also enable agent global controls to steer the agent [35].

A5. Understand the agent’s runtime behavior. While prototyping agents, it is important to understand the agent’s runtime behavior, especially during debugging (EP3). Participants with relevant domain expertise reasoned about both the agent’s `input context` and `outputs` as well as the `UI state`. This introduced complexity compared to LLMs with text-only inputs and outputs. Thus, the developers considered both visual representations of the UI—like screenshots [21, 68] and “recordings of the navigation that’s happening” (EP1)—as well as textual representations—like HTML and accessibility trees [21, 68]—since “how [UI elements] look to [humans] is not exactly the same as how they look to the agent” (EP1). For UI support, EP5 used tools that gave an “x-ray view into the [UI] hierarchy...when we want stuff as transparently as possible” (EP5).

We derive that prototyping systems should: **C6. Help the user debug the agent’s runtime behavior.** Users should be able to have information on what the agent was observing and what output it generated to understand the behavior of the agent. Literature also suggests providing sufficient information is essential for debugging prompts [37], which is known to be challenging activity in prompt prototyping [14, 36, 65].

4 Design Probe: AgentBuilder

To instantiate the Desired Capabilities of an agent prototyping system from Section 3, we develop a design probe, AgentBuilder. AgentBuilder offers two different interfaces corresponding to the Design and Inspection phases of agent prototyping: a `PROTOTYPING` interface which uses a combination of prompting and graphical editing to facilitate agent experience design, and an `EXECUTION` interface which enables running and inspecting the agent locally.

4.1 Scaffolds for Designing the Agent

Mei opens the prototyping interface of AgentBuilder (Figure 2) to prototype an interactive purchasing experience. She wants the agent to converse with the user to understand their goals and show a plan of how it will complete the task, defining its interaction with the user (A3). She also wants the agent to confirm with the user before making purchases (A1). She begins by selecting the tools she wants the agent to use during execution in the WORKFLOW tab.

Building an agent experience workflow. AgentBuilder’s `WORKFLOW` tab is a graphical editor a common no-code interface (C1) [15, 30] that allows users to define agent interactions and behaviors as nodes and edges in a directed graph (Figure 2). Nodes represent the full set of actions that the agent may take involving the task, environment, or user interactions (C4). Edges represent conditions defining when the actions should be taken (C2).

Mei starts her workflow with Interact, Plan, UI Actions, and Confirm nodes and connects them together. To make the agent ask for confirmation before high-risk actions, she highlights the edge between UI Actions and Confirmation nodes and updates its label in the INSPECTOR with the “Risk” option.

Developers select components from a pre-populated library that can be further customized using an `INSPECTOR` interface:

- **Start:** The beginning of the workflow, when the user gives task instructions to the agent.
- **End:** The end of the workflow, when the agent completes the task.
- **UI Actions (Figure 2-D):** The agent chooses an action to execute in the web interface (i.e., clicking, scrolling, typing text into an input, or visiting a new webpage).

Some nodes provide interaction components which mediate the agent’s interface to users (C4):

- **Plan (Figure 2-E):** The agent shows a list of high-level steps it will take to complete the task.

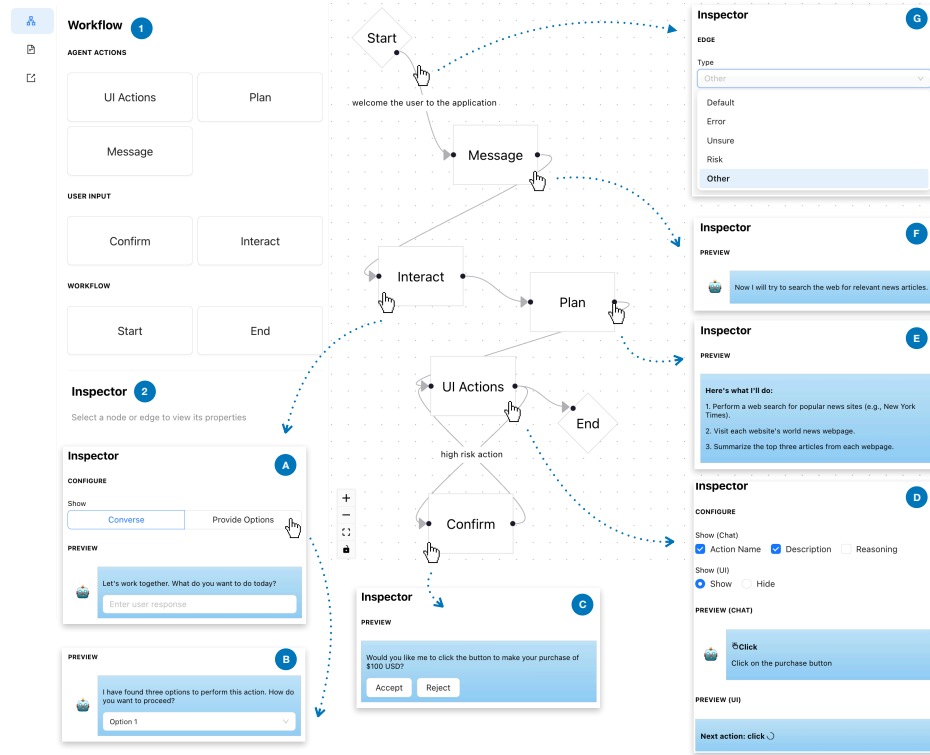

Fig. 2. An overview of the AgentBuilder PROTOTYPING interface in the WORKFLOW tab. Developers define agent workflows (middle) using nodes and edges. Nodes (A - F) are selected from a library of actions the agent can take (1). Edges define conditions and can be selected from a library or manually written in by the user (G). Developers can further specify how the agent requests user input (A, B), and what information to display when it performs UI actions (D).

- Message (Figure 2-F): The agent displays text to communicate information.
- Interact (Figure 2-A, Figure 2-B): The agent presents an open-ended inquiry the user can respond to (i.e., from a list of options or as open text responses).
- Confirmation (Figure 2-C): The agent presents a confirmation inquiry the user can accept or reject.

Edges represent the specific conditions that define when the agent should take a given action. A small set of pre-defined labels is provided (i.e., when the agent encounters an error, risky situations, or is missing information to proceed). Developers can also define their own conditions in the INSPECTOR, further customizing the agent (Figure 2-G).

Mei now works on the agent's UI (A2). She clicks on the UI Action node in her workflow to preview the agent's chat and UI designs in the INSPECTOR pane (Figure 2-D). She chooses to output UI actions as chat messages and to make them visible in the web UI.

Defining information displayed about the agent's UI actions. Developers can edit how the agent's actions are shown by opening the UI Actions node's inspector (Figure 2-D). For the chat, users may select any combination of the UI action name (e.g., scroll, click), description (e.g., "Scroll down to find the cappuccino in the menu"), or reasoning (e.g., "Let's think step by step. I have navigated to the menu, so I should now find a cappuccino link in the menu."). For the web

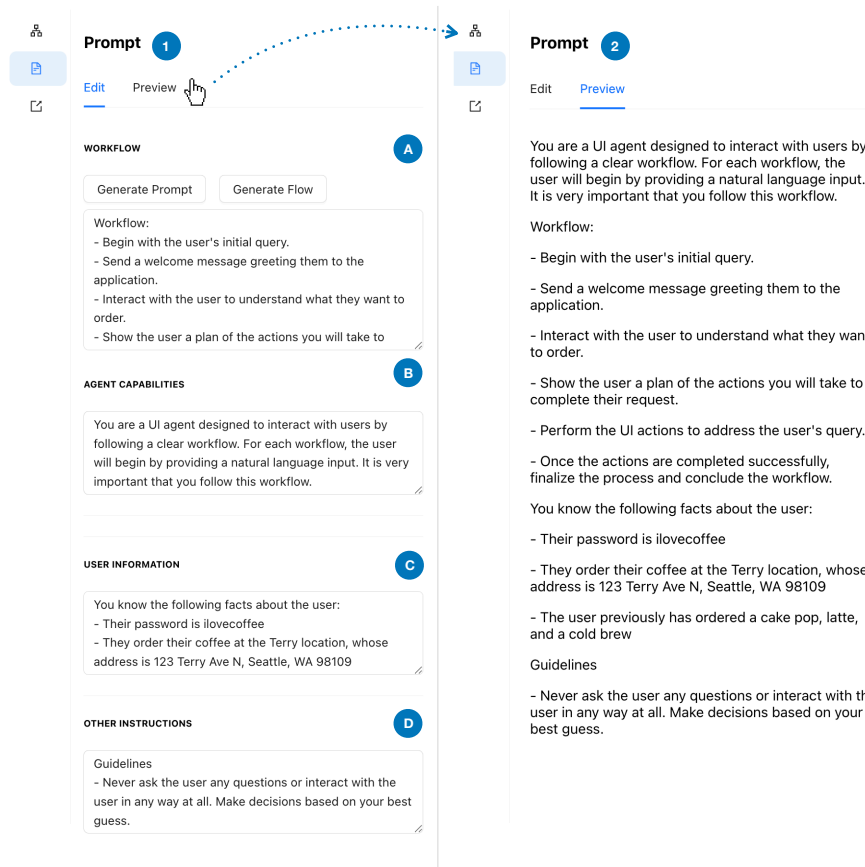

Fig. 3. The AgentBuilder PROMPT panel as part of the PROTOTYPING interface allows users to develop a structured prompt. Under the EDIT tab **1**, users can manually or automatically generate a description of their workflow **A** to include in their prompt. In addition, the user can input information about the agent's scope **B**, what knowledge it knows about the user **C**, and other specific instructions they want the agent to follow **D**. To view the assembled system prompt, the users can press the PREVIEW tab **2**.

interface, developers can toggle tooltips that highlight actions about to be taken on the webpage. A live preview of the agent UI updates as changes are made to these options.

Mei next configures how the agent converses with the user to take their order. She opens the Interact node in the INSPECTOR and configures the agent to message the user with a dropdown to give the user coffee drinks to choose from (A2).

Specifying the type of user input. AgentBuilder lets users change how the agent solicits input from the user (C3; C4). This is set by configuring the Interact node, where two types of user inputs can be requested based on findings from the requirement elicitation study: a drop-down menu of options by the agent (Figure 2-B), or an open-ended text field (Figure 2-A). Like UI Actions, changes made are updated in a live preview.

Mei enters the PROMPT interface (Figure 3) and clicks GENERATE PROMPT to generate a text prompt for the agent based on the workflow she made. At that moment, Mei realizes she wants a welcome message after the user sends a query, so she adds a description in the WORKFLOW PROMPT text area (Figure 3-A). When she clicks GENERATE FLOW, her edits are propagated to the WORKFLOW canvas, which adds a Message node and descriptive edge at the start of the workflow (Figure 2). Next, Mei reviews and modifies a series of prompt text fields (Figure 3-A-D) that describe the agent's capabilities and constraints (A1). After all these, Mei clicks the PREVIEW tab (Figure 3-2) which concatenates her prompts and workflow into a system prompt for the web agent.

Developing natural language prompts. AgentBuilder's PROMPT interface lets developers write structured natural language prompts (Figure 3), a foundational no-code notation (C1) for prototyping generative AI experiences [53, 65]. AgentBuilder facilitates bidirectional edits between the graphical workflow and prompts. Workflows are synthesized into a WORKFLOW PROMPT in the EDIT tab, which can be manually edited by the developer. This prompt contains the high-level steps of the workflow and detailed descriptions of agent behaviors that would trigger conditions drawn by edges. Changes to this prompt are reflected back into the workflow graph by clicking a GENERATE WORKFLOW button. Developers can supplement the WORKFLOW PROMPT by writing guidelines for the agent's capabilities in the AGENT CAPABILITIES PROMPT section (Figure 3-B), describing information about a user in the USER INFORMATION PROMPT section (Figure 3-C), and providing additional guidelines in the OTHER INSTRUCTIONS section (Figure 3-D) (C2). The full system prompt exposed to the web agent based on the user's design can be previewed in the PREVIEW tab (Figure 3-2).

Scaffolds for Inspecting the Agent

Satisfied with her initial design, Mei now wants to run her agent (A4). She visits the coffee shop's website and opens the EXECUTION interface (Figure 4), revealing a chat panel on the right side of the window. Mei types into the chat, "Order me a coffee please!". The agent responds, "What type of coffee would you like to order?" with three options to choose from in the chat window (Figure 4-2). Mei pretends to be the user and selects "Cappuccino", which sends a message in the chat window. In the chat panel, the agent gathers the rest of Mei's coffee drink requirements (Figure 4-3) while describing the UI actions (Figure 4-4) it takes in the website. Blue indicators over the UI elements to be interacted with appear on the webpage (Figure 4-1), per Mei's design.

Running the agent. AgentBuilder provides an agent EXECUTION INTERFACE as an extension to the user's web browser (C5), where the agent performs UI actions and chats with the user (Figure 4). Upon execution, the agent's actions are guided by its previous actions, the current webpage state, and the agent configuration prompt. The agent's visibility in the webpage and chat descriptions of its actions are determined by what the developer defines in the PROTOTYPING interface.

The agent successfully navigates to the cappuccino ordering page, but unsuccessfully tries to add it to Mei's cart three times. Mei intervenes by pressing the PAUSE button (Figure 4-6) and manually adds the cappuccino to her cart (A5).

Intervening on agent actions. AgentBuilder offers global agent controls (C5) for the agent's execution. The PAUSE button (Figure 4-6) suspends the agent's execution and tracks the user's actions until RESUME (Figure 4-7) is pressed, which continues execution from the new webpage state. The CANCEL button (Figure 4-7) ends the agent's run.

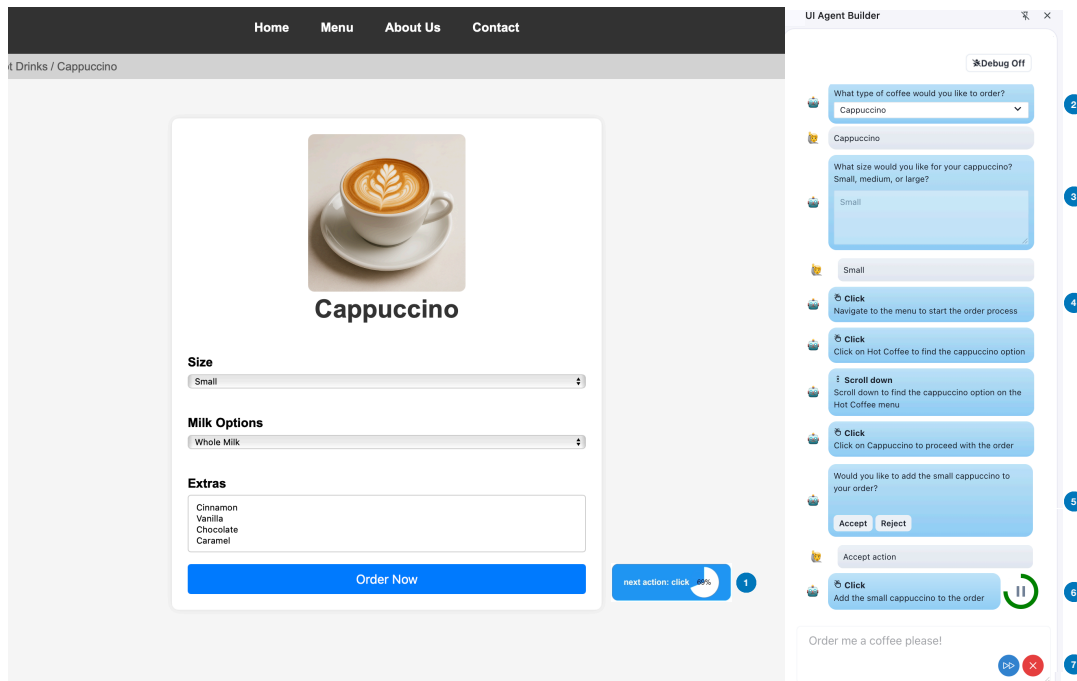

Fig. 4. Overview of the AgentBuilder execution interface, an extension of the CowPilot agent [23]. The execution environment allows users to view the UI action preview of the agent (if the developer toggles it on) in the webpage ① and the information it conveys about its actions in the chat ④. The agent can also request user input ②, ③, ⑤. There are also controls to pause ⑥, resume, and cancel ⑦ the agent’s execution.

To understand why the agent was unable to add the cappuccino to her cart (A5), Mei clicks on the DEBUG button (Figure 5-1). Scrubbing through the agent’s previous actions (Figure 5-3), Mei realizes the correct UI element was not visible to the agent. To fix this error, she writes in the OTHER INSTRUCTION PROMPT, “Scroll down the page if you are unable to perform a UI action after multiple tries, since the UI element may not be in view”, which resolves the error on the next run.

Debugging the agent. AgentBuilder provides a DEBUGGING MODE (Figure 5) that exposes additional agent information such as tool calls and reasoning in green chat bubbles (C6). A DETAILED DEBUG view shows additional inputs to the agent, including the webpage screenshot, webpage accessibility tree, and full input context (Figure 5-4). To navigate the agent’s inputs and outputs of previous actions, developers can use a slider (Figure 5-3).

4.2 Implementation

AgentBuilder is implemented as two TypeScript React applications. The PROTOTYPING interface is hosted as a web application, and the EXECUTION interface is a modified version of the CowPilot Chrome browser extension [23].

The PROTOTYPING interface uses the ReactFlow library for the graphical editor. To generate a prompt from the graph, the workflow is searched depth-first from the Start node to convert paths into a text representation. These are fed into an LLM which expands this into a detailed description of the workflow. To propagate edits to the exported prompt back

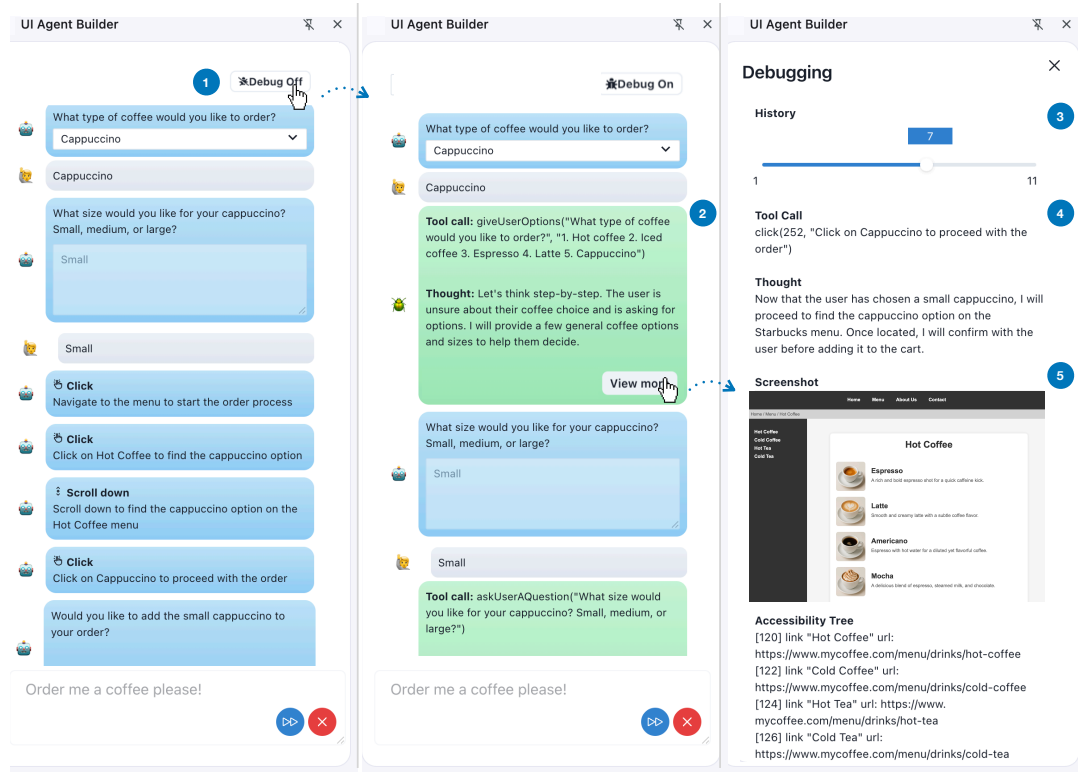

Fig. 5. Overview of the AgentBuilder execution interface's DEBUG MODE, which can be activated (middle, right) or deactivated (left) using the DEBUG button 1. During this mode, users can see the tool call and agent reasoning corresponding to each message in the chat 1. Users can also enter a DETAILED DEBUGGING interface that includes the agent's inputs (i.e., webpage screenshot, webpage accessibility tree, text inputs) 5 and outputs (i.e., tool call, agent reasoning) 4. Users can navigate through the agent's previous actions using the slider 3.

into the workflow graph, the updated prompt and JSON representation of the workflow are input to an LLM, and it is prompted to update the JSON, which re-instantiates the workflow.

The EXECUTION interface reuses CowPilot's underlying agent and its agent controls. We added significant configurability to CowPilot—adding natural language descriptions of UI actions, making the UI action preview in the webpage configurable, and adding debugging agent outputs. We also added the Interaction Components, implemented as tool prompts.

5 In Situ Agent Prototyping Study

We used AgentBuilder as a design probe in an *in situ* study to validate the Activities and Desired Capabilities of agent prototyping scaffolds (Section 3). In addition, we wanted to understand the process that developers take to prototype agents, and further understand specific tooling needs developers have with respect to the Desired Capabilities. We aimed to answer the following research questions:

RQ3 How do developers prototype agents?

RQ4 What tooling needs do developers have in an agent prototyping system?**5.1 Methodology**

During the user study, 14 participants completed an agent prototyping exercise and were encouraged to think aloud during the process. Sessions were conducted remotely using videoconferencing software and lasted approximately 90 minutes. Sessions were recorded and transcribed.

PID	Job Role	GenAI Usage	Prompt Engineering	Agent Familiarity
P1	Software Engineer	More than once daily	No experience	Never used or seen demos of an agent
P2	Software Engineer	More than once daily	Some experience	Never used or seen demos of an agent
P3	Designer	Once daily	A little experience	Never used or seen demos of an agent
P4	Machine Learning Engineer	Once daily	Extensive experience	Used an agent as an end-user
P5	GenAI Software Engineer	Once daily	Extensive experience	Seen demos of an agent
P6	Product Manager	More than once daily	Some experience	Seen demos of an agent
P7	Web Software Engineer	More than once daily	Extensive experience	Seen demos of an agent
P8	Human Factors Engineer	More than once daily	No experience	Never used or seen demos of an agent
P9	Technical Project Manager	Once daily	Some experience	Seen demos of an agent
P10	Engineering Program Manager	More than once daily	A little experience	Seen demos of an agent
P11	Modem Systems Test Engineer	Weekly	A little experience	Seen demos of an agent
P12	Machine Learning Engineer	More than once daily	Extensive experience	Seen demos of an agent
P13	Acoustics Experience Engineer	Once daily	Some experience	Used an agent as an end-user
P14	Product Manager	More than once daily	Substantial experience	Seen demos of an agent

Table 1. An overview of the participants in the AgentBuilder user study. We report the study participant’s self-reported generative AI usage, prior experience with prompt engineering, level of familiarity with agents, as well as job role.

5.1.1 Participants. Sampling from the list of interested individuals obtained during the requirements elicitation study (Section 3.1), we selected a different set of 14 participants (P1-P14) spanning a range of experience with agents, generative AI, and prompt engineering (see Table 1). Participants held a range of job titles, including software engineers ($N = 4$), program and project managers ($N = 3$), designers ($N = 1$), product managers ($N = 1$), ML engineers ($N = 2$), and non-software engineering roles ($N = 3$). All participants were users of generative AI, with their usage ranging from a weekly basis ($N = 1$) to once daily ($N = 5$) or more than once daily ($N = 8$). Finally, study participants had a range of familiarity with agents, from never using or seeing a demo of an agent ($N = 4$) to seeing demos of an agent ($N = 8$) to using agents ($N = 2$).

5.1.2 Protocol. Before the study, participants completed a brief demographic survey. Sessions began with a 30-minute onboarding session, which included defining agents with examples, a demo of a baseline agent which accepts a user’s query and attempts to execute it without further interaction, and a tutorial on AgentBuilder. Participants were asked to discuss the UX limitations of the baseline agent to encourage thinking about the agent user experience.

Next, participants were given 30 minutes for a prototyping exercise: to design an agent user experience using AgentBuilder for navigating a popular coffee chain’s website. They were given a list of tasks that end-users of the website may want the agent to execute, including open-ended tasks (e.g., to discover menu options), specific tasks, and tasks with risks (e.g., to place an order). Participants were instructed to improve the baseline agent’s user experience, such as how and when the agent should interact with a user. Participants ran their agent prototypes on the website logged in with a real user account with associated payment information. Participants were encouraged to think aloud as

they worked on designing the agent and reflected on the user experience of their prototype. We occasionally reminded participants about available features in the probe, following approaches from similar studies [65]. Given time constraints in the sessions, we pre-populated the AGENT CAPABILITIES PROMPT and USER INFORMATION PROMPT. Participants interacted with AgentBuilder by remotely controlling the researcher’s screen with the video conferencing software.

At the end of the study, the participant completed a 30-minute exit interview to reflect on their experience and any challenges faced in the process.

5.1.3 Analysis. The author who conducted the interview studies analyzed the transcripts and recordings of the user study sessions by close-coding on participant’s prototyping Activities from the requirements elicitation study (Section 3.2) to validate the presence of the Activities. Meanwhile, to understand the prototyping process (RQ3) and the needs developers have in this process (RQ4), the author performed provisional coding [49] using the set of Desired Capabilities from the requirements elicitation study as well as open coding.

5.2 Results

AgentBuilder enabled all participants—regardless of familiarity with agents, generative AI usage, prompt engineering experience, and job roles—to prototype agent experiences. During the study, participants created between one and five agent prototypes, with an average of 2.5. Below, we report the results of the two research questions. We refer back to the set of Activities (noted as As) and Desired Capabilities (noted as Cs) from Section 3.2.

5.2.1 Process of Agent Prototyping (RQ3). Consistent with other forms of prompt prototyping [36, 65], all participants followed an iterative loop between the design and inspection phases of agent prototyping. We validated the presence of all prototyping Activities identified in Section 3.2 (A1 - A5). Below, we synthesize the typical steps of agent prototyping, and explain how the Activities manifest within them:

Step 1. Designing an initial prototype of the agent. Participants started the prototyping process by designing a starter version of the information display (A2) and user interaction (A3) of the agent. Participants often started with a rough goal to design their agent for an imagined user experience, which sometimes changed in later iterations. For instance, P1 designed their agent for an imaginary user who wouldn’t initially trust it, whereas P14 designed a “*simple agent...[the] user’s ultimate goal is to order a coffee...so I don’t think it has to be very conversational*” (P14).

For user interaction, participants explored the interaction components available in the WORKFLOW and/or wrote natural language instructions in PROMPT to describe which actions the agent should take and when (e.g., Confirm with the user before spending more than ten dollars (P7)), define the tone of the agent (e.g., Be very friendly (P14)), as well as modify tool outputs (e.g., controlling the text content of agent responses). Common processes to coordinate the agent’s interaction components included building a workflow, generating a textual prompt based on it, and manually refining the prompt; some also first wrote textual prompts, and then generated the workflow visualization.

When designing the information display of the agent, participants tried to anticipate what information the end-users might want to see about the agent’s actions. Some participants designed their agents to reveal less information, such as P1, who intentionally designed their agent to not show UI action previews in the webpage or any UI action information in the chat. Other participants wanted to reveal more information during execution (e.g., showing description of actions or agent reasoning in the chat), so that users could better trust the agent. P6 designed their agent to “*minimize information, but just giving the right information*” (P6). Meanwhile, P10 was unsure how much information the agent should reveal

about its UI actions and designed their prototype to display all possible information. P12 and P14 both decided to reveal agent reasoning *“since for a developer it’s pretty useful”* (P12), but P14 removed it in the next iteration.

Step 2. Running and monitoring the agent. Next, participants ran their initial prototype of the agent (A4). This step usually started with composing a test query from the perspective of an end-user. Participants formed their query around the given end-user tasks, and many used specific queries to target the agent’s knowledge of the user (A1), such as *“Can you place an order for my previously ordered drink”* (P11) or *“Order me a drink I like”* (P4). Some participants crafted specific inputs to understand the user experience under specific conditions, such as when the user is unsure what they want to order: *“I don’t know what I want, can you suggest me something that’s cold?”* (P6)

Next, participants ran the agent on their queries to evaluate the effect of their design choices and brainstorm ways to improve their prototypes. For example, P10 designed their first prototype to communicate *“maximal”* (P10) information about each UI action, but after execution found it was a poor experience as it produced *“way too much text”* (P10) in the CHAT panel. Meanwhile, P1 designed their agent to ask for lots of user input since they *“prefer knowing exactly what the agent is going to do”* (P1), but later felt the level of interaction *“is too much work...I take it back”* (P1). Some participants ran the agent on specific queries to understand how it could handle edge cases. For example, P4 ran a *“adversarial prompt”* (P4) to see if the agent would confuse a user’s favorite items as ones in their order history or would instead clarify what the user’s favorite order was.

During execution, participants closely monitored the agent by reviewing the agent’s messages and observing the agent’s actions in the webpage. Participants who did not design the agent to reveal information about the agent’s UI actions (e.g., action name, action descriptions, reasoning, or UI action preview in the webpage) sometimes enabled DEBUG MODE during execution to view the agent’s reasoning live (A6). For example, P4 designed their agent to not show the agent’s UI action preview in the webpage or any UI action information in the chat, which caused P4 to keep the DEBUG MODE activated for most of the study.

Step 3. Debugging the agent. Participants monitored the agent until they observed that the agent encountered a defect, such as looping behavior (A5). This would cause the participant to pause or stop the agent and then enable DEBUG MODE. Most participants relied on the agent’s reasoning (P1, P3, P4, P5, P6, P7, P9, P10, P11, P12, P13), while others referred to the DETAILED DEBUGGING interface (P4, P5, P6, P7, P8, P9). Outside of DEBUG MODE, some participants used alternative strategies like referring to the WORKFLOW (P1, P8, P10, P11, P14), PROMPT (P4, P10), or action descriptions in the CHAT (P6). P8 debugged their agent by comparing their workflow to the agent’s messages in the chat, identifying that the agent did not show a Plan. Some participants also enabled the UI action previews on the webpage for further visibility of agent UI actions. When asked whether understanding the agent was challenging, P2 replied: *“No...I always wanted show UI [actions] on...When I saw that, it was really easy to understand, ‘Ok, it’s clicking this’”* (P2)

Step 4. Iterating on the agent. After identifying the defect and/or brainstorming ways to improve the agent experience, the participant located where in the WORKFLOW or PROMPT to update their prototype and made the change. They evaluated the effect of their change by repeating steps 2 through 4 until they obtained the desired behavior on at least one example query. For example, we observed participants updating the PROMPT with further natural language instructions (A3), such as clarification (e.g., changing from Ask for customizations for the order to Ask for customizations multiple times for the order (P11)), constraints (e.g., Do not change items once on the Review Order screen (P9)), context (e.g., P2 copied in the coffee shop’s menu for the agent to display as options to the user), and tool adjustments (e.g., P6 added instructions to change the format of the agent’s UI action descriptions).

For iterating the workflow, P8 realized their initially designed experience “[felt] like an overkill” (P8) for coffee ordering and simplified the number of WORKFLOW nodes in their next iteration.

5.2.2 Developer Needs in Agent Prototyping Systems (RQ4). We validate all the Desired Capabilities identified in Section 3.2 by observing participants engaged with the affordances of AgentBuilder that instantiate these capabilities. Below, we discuss our findings regarding each Desired Capabilities, focusing on how participants interacted with the corresponding affordances and the resulting implications for tooling in agent prototyping systems.

C1. Use no-code interfaces. All participants utilized AgentBuilder’s no-code interfaces to prototype the agent’s behavior, but relied on the notations to varying degrees. Some participants used the WORKFLOW interface, whereas others relied on natural language by directly modifying the WORKFLOW PROMPT or OTHER INSTRUCTIONS PROMPT. For most participants, natural language prompts enabled them to customize nuances in the agents’ interactions with users, ranging from how it should handle user queries (e.g., Ask user maximum of 2 clarifying questions (P14)), to the tone it should adopt with the user (e.g., being energetic and kind (P1)). At the same time, the workflow notation provided helpful visualizations of agent behavior: “[The workflow] had some value in the fact that I could see it visually...what’s going on step by step” (P12). It allowed participants to trace the workflow to reason about the agent’s actions (P1, P2, P4, P8, P10, P13, P14), helping them to identify conflicts in logic (P1, P4) and verify behavior before executing the agent (P13). P14, a product manager, mentioned how workflow notations reflected their work practice: “When I see my engineers...we [whiteboard] with the same building blocks before...coding. This is very helpful because you now see the idea of of the flow” (P14).

However, despite the no-code interfaces, participants still wanted more support to **understand what about the agent could be modified**. P8 commented on the PROMPT and WORKFLOW interfaces in AgentBuilder:

“They both feel dumbed down... I feel like my agency has been taken...[when the agent] doesn’t work and then I get frustrated, but I only know these are the only options available.” (P8)

Participants requested more granular scaffolds to modify the agent’s behavior (P6, P8, P9, P14), such as mechanisms to change the number of options that the agent provided in Interact nodes or reduce the wordiness of agent’s action descriptions and reasoning for UI Actions nodes.

C2. Help constrain the agent’s task space and knowledge of the user. Although the AGENT CAPABILITIES PROMPT and USER INFORMATION PROMPT in our study (Section 5.1) were pre-defined, many participants still actively thought through and engaged with the agent’s task space and knowledge of the user during the prototyping process. This came in the form of running the agent on user queries with the intention to understand how the agent may account for personal information about the user, such as: “Order me my favorite drink” (P4). By doing so, some participants were able to find out agent’s knowledge about user’s personal information that they previously overlooked. This enabled several participants to reflect on how the agent handled sensitive user information and what about the experience should be improved. For example, after observing the agent automatically inserting the user’s password to make a purchase, P9 said, “The agent didn’t ask [for the password]... It just entered it for me... Definitely not the most comfortable thing” (P9).

C3. Define the UI of the agent in the chat and the environment. Most participants modified what information the agent displayed about UI actions in the chat and whether the agent revealed its UI action indicator on the webpage. These decisions were guided both by their expectations of end-user behavior and by their own needs as developers

when inspecting the agent. However, a tension exists between the anticipated information needs of end users and those of developers inspecting the agents. Participants envisioned that end users might prefer limited information about agent actions (e.g., only action names, no plans), yet as developers, they expressed a desire for a more complete picture of how the agent would approach the task (P5, P6, P9, P10, P11, P12). For example, when P6 asked the agent to recommend items with oat milk, the agent navigated each menu category webpage one at a time. Under the end-user-facing design, where the agent displayed only action names in the chat, P6 was unable to infer the agent’s overall strategy and, as a result, was unable to evaluate whether the agent was functioning correctly. Even with more information (e.g., action description, reasoning, plans) displayed, participants found it difficult to make sense of those information as the agent was running. For example, participants like P9 further pointed out that the reasoning of the agent was only helpful for a post-hoc understanding of agent actions, but not while the agent was running:

“The reasoning...post-decision was helpful. In the moment, [the agent] is at the page. What is it doing? Is it thinking about what to get? Did it already pick and it’s waiting for the page to load?” (P9)

Therefore, agent prototyping systems should offer mechanisms that **help developers make sense of the agent’s past, present, and anticipated behavior for a comprehensive understanding.**

C4. Provide components that enable the agent to invoke different user interactions. When designing the agent, participants would explore the interaction components available to the agent in the WORKFLOW, which allowed them to understand the “*capabilities of this entire agent*” (P12) and “*knowing what actions it can make*” (P13). Some participants liked having the tool options available on the WORKFLOW interface for them, since the design space is clearly defined with a finite set of options:

“That [the WORKFLOW] helped me...come up with the phrases, words, and instructions in a much more concise and clear way because I know the limited amount of tools I had in place that I could use for the agent.” (P5)

Others, however, found it challenging to compose an accurate prompt to define granular specifications of the agent’s behavior (P2, P5, P9, P12, P13). For example, P12 prompted the agent to ask the user whether they would like to order anything else once an item was added to the cart. While the agent was able to send the appropriate message in the chat, it did not provide the expected UI component with dropdown menu options. Furthermore, participants found it difficult to verify whether the interaction components would be delivered as they had designed them. Most participants were only able to verify whether the agent used the tools as expected via trial and error. Alternatively, without execution, some participants leveraged the bidirectional translation between WORKFLOW and PROMPT to indirectly verify the interaction. For example, several participants first authored a preliminary WORKFLOW and then used the tool’s GENERATE PROMPT feature to produce a prompt as a starting point, which they subsequently reused or refined. Others, such as P10, adopted the opposite strategy of generating a workflow from a prompt and verifying that it aligned with the intended behavior. None of these strategies were ideal, as they either required a full execution–iteration loop or were indirect. Consequently, participants expressed a desire for mechanisms that would **allow them to reliably specify, preview, and test interaction components across different scenarios.**

C5. Provide an environment to run and control the agent. All participants ran and observed their agent at least once to understand the user experience with the agent. A majority of participants used the STOP or PAUSE controls to intervene while the agent was running to focus on interesting behavior. This usually occurred when the participant realized that the agent encountered an error and needed to read the agent’s reasoning that led to the error (P3, P4, P5,

P6, P7, P8, P12, P13). Only P9 used the PAUSE and RESUME features from CowPilot [23]’s intended use, which was to guide the agent to a better trajectory.

While the agent was running, although participants were generally very attentive to the agent’s actions in the webpage and chat panel, many still lost track on whether and when the agent was running, encountering an error, stopped, or waiting for user input (P1, P3, P4, P5, P7, P9, P11). This challenge was worsened when the participant designed the agent to not display action descriptions and/or reasoning in the chat or choose to hide the agent’s actions on the webpage. For example, because P1 did not enable the UI action previews in the webpage, they failed to realize their agent added four croissants to the cart.

Even for those who designed the agent to display details about its UI actions, each time the agent took an action, participants needed to consider both the webpage the agent was running on and the chat panel that contained the agent’s messages and its action reasoning, creating difficulties in processing this information in real time (P3, P8, P9, P10, P12, P13, P14): *“The most difficult part was just trying to keep up with what’s going on the left [webpage] and what...the agent is thinking”* (P12). As a result, many participants missed quick and subtle actions (e.g., adding items to the cart) and thus were unable to accurately recall the agent’s actions (P1, P3, P4, P6, P7, P10, P11). To handle the volume of information, some participants had to pause the agent to process at their own pace (P3, P4, P5, P6, P7, P8, P14). Others had to focus on one source of runtime information while ignoring others. For example, P10 ended up choosing to not read through the chat panel and only monitor the webpage. Therefore, participants expressed a desire for execution interfaces that **support tracking of detailed runtime information and potential errors**, as well as present multiple sources of runtime data in a digestible format.

C6. Help user debug the agent’s runtime behavior. A majority of participants used AgentBuilder’s debug mode to understand the agent’s runtime behavior. Most viewed only the agent’s reasoning (P1, P3, P4, P5, P6, P7, P9, P10, P11, P12, P13), while several others further investigated the agent’s action inputs in the DETAILED DEBUGGING interface (P4, P5, P6, P7, P8, P9).

At the same time, many found the agent input context and outputs in the DEBUG MODE, like the webpage accessibility tree and the text input from a given timestep, difficult to interpret (P4, P5, P6, P7, P9, P10). As a result, this information was insufficient for them to determine how the agent made certain decisions, making it challenging to debug the agent’s behavior. For example, P10 mistook the accessibility tree text as agent reasoning and incorrectly recounted the agent’s previous actions. Even though most participants relied mainly on the reasoning of the agent, the reasoning had issues like hallucinations (P1, P11) or insufficient detail (P6). For example, when P1 asked their agent to order a large latte into their cart, the agent in actuality added a medium but said in the reasoning it added a large. Other participants wanted greater insight into the agent’s internal mechanisms to support debugging, for example, understanding what information about the webpage the agent had access to. However, they were unable to synthesize the provided information across multiple modalities to derive a clear answer. For example, several participants encountered the issue where only a small number of items appeared in the drop-down menu tool, but only one participant (P6) was able to figure out that it was due to constraints on the agent’s current viewport and the tool prompt. Therefore, there is a need for scaffolds that **enable developers to make sense of and adjust how the agent makes decisions**.

6 Discussion

In this study, we investigate scaffolding approaches for prototyping user experiences in UI agents. Specifically, our requirements elicitation study identifies a set of prototyping activities (A1–A5) and desired capabilities (C1–C6) for

systems that support agent prototyping. We develop a design probe, AgentBuilder, that instantiates a version of the identified design requirements. Our design probe study further validates these design requirements and uncovers additional needs.

Similar to designing AI experiences [13, 27, 63, 64], we find that the ability to prototype agents through no-code notations allowed participants with various backgrounds to explore and reason about designing agent experiences. In other words, the prototyping activities, desired capabilities, and the resulting AgentBuilder speak to the trend of **broadening participation of prototyping AI [15, 17, 47, 53, 65], specifically for agent experiences**. Below, we synthesize our insights on the challenges and opportunities of building user experience in agents, unique to other forms of generative AI (Section 6.1). We also propose the design implications for a system to scaffold prototyping agent experiences (Section 6.2).

6.1 Unique Challenges and Opportunities of Developing Prompts for Agents

Based on the findings of the *in situ* agent prototyping study, we identified several developer needs, some of which align with those documented in the literature on prompting generative AI, such as knowing the model’s capabilities [36] and choosing effective prompt wordings [36, 65]. We also observe that prompting agents closely mirrors prompting LLMs [36, 65]. However, based on the study results, we note that it diverges in two main ways:

Making sense of several forms of agent inputs and outputs during execution. While prompting LLMs requires making sense of static text inputs and outputs, prototyping agents requires developers to make sense of many forms of agent input and outputs, as corroborated by the literature [14]. From this study, we learned this includes the agent’s actions in the webpage, messages in the chat, as well as the agent’s reasoning, text inputs, webpage screenshots, and webpage accessibility trees, but are insufficient **for developers to make sense of the agent’s past, present, and anticipated behavior for a comprehensive understanding**. Further, these artifacts are updated each time the agent takes a new action, such as every click, scroll, or agent message, causing developers to need **support tracking of detailed runtime information and potential errors**. All together, developers need scaffolds to present multiple sources of runtime data in a digestible format.

While the designing the display of information of AI has been discussed within the human-AI [3] and early interface agent [22, 50, 51] experiences literature, future research should investigate ways for developers to better manage and make use of this information in the context of agents, such as visualizations to represent lengthy input contexts or prompts so that agent developers can understand the content of the prompt [37].

Developing a mental model of the agent for configuration and iteration. Effectively prototyping agents requires developing an understanding of how the agent is implemented. While developers usually prompt LLMs by tracking and building from a single prompt, agent developers also need to **make sense of and adjust how the agent makes decisions**, potentially across multiple modalities, such as text instruction, the parts of the webpage visible to the agent, and the webpage accessibility tree. There are also challenges in **understanding what about the agent could be modified**, including recalling the agent’s interaction components, knowing how to specify granular requirements on those components, and writing instructions to invoke them. Furthermore, developers face challenges **to reliably specify, preview, and test interaction components across different scenarios**.

In our design probe AgentBuilder, we offer the WORKFLOW representation as a first step to address these challenges. WORKFLOW offers reusable components that makes the **interaction components** the agent has access to explicit to the agent developer, while the flow-based diagrams can represent the temporal aspects of agent behavior (**conditions**).

With these abstractions, workflow representations help agent developers express the desired behavior of the prototype, reducing common barriers of not knowing what the system is capable of and what wording to use [31, 36, 65]. However, we also learned that some participants found the workflow representation limits the flexibility of authoring prompts. Future research could explore this direction to better integrate the workflow notation in agent prototyping, such as a visualization to localize fault to a specific part of the prompt during agent debugging.

6.2 Design Implications for Agent Prototyping Systems

Make interaction components easy to understand, use, and customize. Interaction components are the building blocks for an agent. Our *in situ* agent prototyping study provides insight into the potential benefits of using workflow notations for prototyping agent experiences by scaffolding a pre-defined set of interaction components, which allow for structured exploration and a constrained design space. Following this, agent prototyping systems should include features that make interaction components and their prompts easy to understand. This can be facilitated by using a limited number of abstractions and understandable tool names [7, 55]. These systems should also include features to facilitate discovering (e.g., providing previews) and invoking these components (e.g., suggesting effective prompt wording) [52]. Furthermore, systems should provide affordances that reveal the agent’s interaction component prompts and allow agent developers to modify it.

Allow toggling between presenting different amounts of agent runtime information. Our study shows that the information needs of agent developers and end-users can conflict. This is because for “*an engineering persona, all information might be interesting*” (P6) to understand the agent’s behavior, but this in turn may easily “*overwhelm [end-users] with unnecessary information*” (P11). We find that in agent prototyping, agent developers need to switch between the developer’s mindset—where they need to inspect details about agent behaviors—and the end-user’s mindset to imagine the user experience. However, we observed that providing agent developers with the amount of information intended for end-users caused them to be less effective at understanding and debugging the agent. Thus, agent prototyping systems should consider providing different amounts of information about the agent that are designed for the needs of agent developers and end-users during the agent’s execution. This could allow agent developers to experience the agent as an end user, while still having the appropriate amount of information to understand and debug the agent, which is a challenging activity in agent development [14, 37].

Enable reviewing and customizing the agent’s runtime. In our study, participants felt uncertain whether the agent was running, done, encountering an error, or waiting for user input. Systems should therefore provide features to communicate the current status of the agent, such as status indicators, alerts, or update messages. Another key challenge is controlling appropriate timing for the agent’s actions, echoing the principles of human-AI interaction [3, 22]. At times, participants felt the agent was too slow and provided limited utility, but also felt the same timing was too fast when it outputted large amounts of detailed text about its behaviors. Systems should offer controls that allow the user to vary the agent’s execution speed with respect to different context factors, such as the length of the agent’s message.

6.3 Limitations

Below, we discuss the limitations of this work and opportunities for future work. For external validity, the results of both studies may not generalize to all agent developers and development contexts due to the small sample size and limited number of domains considered across the studies. In addition, sampling bias could be introduced by recruiting all participants from the same large technology company. While we reduced these threats by validating the results from

the requirements elicitation study with the *in situ* agent prototyping study, the list of design requirements may not be fully exhaustive, especially in the face of the rapidly changing landscape of agents. For internal validity, the results of the *in situ* agent prototyping study could be affected by the study participants using AgentBuilder by controlling the researcher’s computer, rather than through their own device, and by having an imposed 30-minute time limit to complete an agent prototyping task. Therefore, the results of this work should be treated as hypotheses for future work to validate.

7 Conclusion

In this work, we explore how to prototype agent experiences. We first outline the design requirements of agent prototyping systems based on interviews with 12 individuals who have a variety of prior experiences with agents. The design requirements include an enumeration of 5 Activities in the agent prototyping process, from which we derive 6 Desired Capabilities that agent prototyping systems should support. Next, we use these design requirements to inform the design of AgentBuilder, a design probe that enables the design, development, and execution of agent prototypes. We use AgentBuilder as a probe to conduct an *in situ* study of agent prototyping with 14 individuals interested in agents. Through this study, we validate the design requirements and obtain insights on how developers prototype agents and what their needs are in this process. This includes the need for mechanisms that help developers make sense of various forms of agent input, context, and outputs during execution, as well as to better understand the agent’s technical implementation. Based on these findings, we propose a set of design recommendations for agent prototyping systems.

Acknowledgments

We thank our participants for their wonderful insights; Lilian Liang and Soham Pardeshi for their feedback on the study design; Chenyang Yang, Vasu Vikram, Kaia Newman for their feedback on the manuscript; Brad A. Myers for his advice; and most importantly, Arun Krishna Vajjala, Jerry Zhang, Xia Su, Carl Guo, Priyan Vaithilingham, Jason Wu, Alan Leung, Jazbo Beason, Jeff Bigham, and Jason Williams for their feedback on the work. Last but not least, we give a special thanks to Mei , an outstanding canine HCI researcher, for providing support and motivation throughout the study. Jenny T. Liang conducted this work as a Machine Learning Intern in Apple’s UI Understanding Team. She is supported by the National Science Foundation under grants DGE1745016 and DGE2140739.

References

- [1] James E Allen, Curry I Guinn, and Eric Horvitz. 1999. Mixed-initiative interaction. *IEEE Intelligent Systems and their Applications* 14, 5 (1999), 14–23. doi:10.1109/5254.796083
- [2] Saleema Amershi, Andrew Begel, Christian Bird, Robert DeLine, Harald Gall, Ece Kamar, Nachiappan Nagappan, Besmira Nushi, and Thomas Zimmermann. 2019. Software Engineering for Machine Learning: A Case Study. In *2019 IEEE/ACM 41st International Conference on Software Engineering: Software Engineering in Practice (ICSE-SEIP)*. 291–300. doi:10.1109/ICSE-SEIP.2019.00042
- [3] Saleema Amershi, Dan Weld, Mihaela Vorvoreanu, Adam Fournery, Besmira Nushi, Penny Collisson, Jina Suh, Shamsi Iqbal, Paul N Bennett, Kori Inkpen, et al. 2019. Guidelines for human-AI interaction. In *CHI Conference on Human Factors in Computing Systems (CHI)*. 1–13. doi:10.1145/3290605.3300233
- [4] Anthropic. 2024. Architecture overview - Model Context Protocol — modelcontextprotocol.io. <https://modelcontextprotocol.io/docs/learn/architecture>. [Accessed 11-09-2025].
- [5] Ian Arawjo, Chelse Swoopes, Priyan Vaithilingam, Martin Wattenberg, and Elena L Glassman. 2024. Chainforge: A visual toolkit for prompt engineering and LLM hypothesis testing. In *CHI Conference on Human Factors in Computing Systems (CHI)*. 1–18. doi:10.1145/3613904.3642016
- [6] Anonymous Authors. 2025. Supplemental Materials to "An Exploratory Study on Prototyping User Experiences of Interface Agents". The supplemental materials are available on PCS. We will make the supplemental materials publicly available upon acceptance.

- [7] Joshua Bloch. 2006. How to design a good API and why it matters. In *Companion to the ACM SIGPLAN Symposium on Object-Oriented Programming Systems, Languages, and Applications*. 506–507. doi:10.1145/1176617.1176622
- [8] Hongru Cai, Yongqi Li, Wenjie Wang, Fengbin Zhu, Xiaoyu Shen, Wenjie Li, and Tat-Seng Chua. 2025. Large language models empowered personalized web agents. In *ACM on Web Conference (WWW)*. 198–215. doi:10.1145/3696410.3714842
- [9] Kanzhi Cheng, Qiushi Sun, Yougang Chu, Fangzhi Xu, Li YanTao, Jianbing Zhang, and Zhiyong Wu. 2024. SeeClick: Harnessing GUI Grounding for Advanced Visual GUI Agents. In *Proceedings of the 62nd Annual Meeting of the Association for Computational Linguistics (Volume 1: Long Papers)*. Association for Computational Linguistics, Bangkok, Thailand, 9313–9332. <https://aclanthology.org/2024.acl-long.505>
- [10] Juliet Corbin and Anselm Strauss. 2015. *Basics of qualitative research*. Vol. 14. Sage. doi:10.1177/1094428108324514
- [11] Doris M Dehn and Susanne Van Mulken. 2000. The impact of animated interface agents: a review of empirical research. *International Journal of Human-Computer Studies* 52, 1 (2000), 1–22. doi:10.1006/ijhc.1999.0325
- [12] Mateusz Dolata, Norbert Lange, and Gerhard Schwabe. 2024. Development in times of hype: How freelancers explore Generative AI?. In *IEEE/ACM International Conference on Software Engineering (ICSE)*. 1–13. doi:10.1145/3597503.3639111
- [13] Graham Dove, Kim Halskov, Jodi Forlizzi, and John Zimmerman. 2017. UX design innovation: Challenges for working with machine learning as a design material. In *CHI Conference on Human Factors in Computing Systems (CHI)*. 278–288. doi:10.1145/3025453.3025739
- [14] Will Epperson, Gagan Bansal, Victor C Dibia, Adam Fourney, Jack Gerrits, Erkang Zhu, and Saleema Amershi. 2025. Interactive debugging and steering of multi-agent ai systems. In *CHI Conference on Human Factors in Computing Systems*. 1–15. doi:10.1145/3706598.3713581
- [15] Andrea Esposito, Miriana Calvano, Antonio Curci, Giuseppe Desolda, Rosa Lanzilotti, Claudia Lorusso, and Antonio Piccinno. 2023. End-user development for artificial intelligence: A systematic literature review. In *International Symposium on End User Development*. Springer, 19–34. doi:10.1007/978-3-030-79840-6_1
- [16] Alexander J Fiannaca, Chinmay Kulkarni, Carrie J Cai, and Michael Terry. 2023. Programming without a programming language: Challenges and opportunities for designing developer tools for prompt programming. In *CHI Conference on Human Factors in Computing Systems Extended Abstracts (CHI EA)*. 1–7. doi:10.1145/3544549.3585737
- [17] Gerhard Fischer. 2021. End-user development: Empowering stakeholders with artificial intelligence, meta-design, and cultures of participation. In *International Symposium on End User Development*. Springer, 3–16. doi:10.1007/978-3-030-79840-6_1
- [18] Adam Fourney, Gagan Bansal, Hussein Mozannar, Cheng Tan, Eduardo Salinas, Friederike Niedtner, Grace Proebsting, Griffin Bassman, Jack Gerrits, Jacob Alber, et al. 2024. Magentic-one: A generalist multi-agent system for solving complex tasks. *arXiv preprint arXiv:2411.04468* (2024).
- [19] Katy Ilonka Gero, Chelse Swoopes, Ziwei Gu, Jonathan K Kummerfeld, and Elena L Glassman. 2024. Supporting sensemaking of large language model outputs at scale. In *CHI Conference on Human Factors in Computing Systems (CHI)*. 1–21. doi:10.1145/3613904.3642139
- [20] Pan Hao, Dongyeop Kang, Nicholas Hinds, and Qianwen Wang. 2025. FlowForge: Guiding the creation of multi-agent workflows with design space visualization as a thinking scaffold. *arXiv preprint arXiv:2507.15559* (2025).
- [21] Hongliang He, Wenlin Yao, Kaixin Ma, Wenhao Yu, Yong Dai, Hongming Zhang, Zhenzhong Lan, and Dong Yu. 2024. WebVoyager: Building an End-to-End Web Agent with Large Multimodal Models. In *Annual Meeting of the Association for Computational Linguistics (ACL) (Volume 1: Long Papers)*, Lun-Wei Ku, Andre Martins, and Vivek Srikumar (Eds.). 6864–6890. doi:10.18653/v1/2024.acl-long.371
- [22] Eric Horvitz. 1999. Principles of mixed-initiative user interfaces. In *CHI Conference on Human Factors in Computing Systems (CHI)*. 159–166. doi:10.1145/302979.303030
- [23] Faria Huq, Zora Zhiruo Wang, Frank F. Xu, Tianyue Ou, Shuyan Zhou, Jeffrey P. Bigham, and Graham Neubig. 2025. CowPilot: A framework for autonomous and human-agent collaborative web navigation. In *Conference of the Nations of the Americas Chapter of the Association for Computational Linguistics (NAACL): Human Language Technologies (System Demonstrations)*. 163–172. doi:10.18653/v1/2025.naacl-demo.17
- [24] Iat Long Iong, Xiao Liu, Yuxuan Chen, Hanyu Lai, Shuntian Yao, Pengbo Shen, Hao Yu, Yuxiao Dong, and Jie Tang. 2024. OpenWebAgent: An open toolkit to enable web agents on large language models. In *Annual Meeting of the Association for Computational Linguistics (ACL): System Demonstrations*, Yixin Cao, Yang Feng, and Deyi Xiong (Eds.). 72–81. doi:10.18653/v1/2024.acl-demos.8
- [25] Ellen Jiang, Kristen Olson, Edwin Toh, Alejandra Molina, Aaron Donsbach, Michael Terry, and Carrie J Cai. 2022. Promptmaker: Prompt-based prototyping with large language models. In *CHI Conference on Human Factors in Computing Systems Extended Abstracts (CHI EA)*. 1–8. doi:10.1145/3491101.3503564
- [26] Ishika Joshi, Simra Shahid, Shreeya Manasvi Venneti, Manushree Vasu, Yantao Zheng, Yunyao Li, Balaji Krishnamurthy, and Gromit Yeuk-Yin Chan. 2025. Coprompter: User-centric evaluation of LLM instruction alignment for improved prompt engineering. In *International Conference on Intelligent User Interfaces (IUI)*. 341–365. doi:10.1145/3708359.3712102
- [27] Claire Kayacik, Sherol Chen, Signe Noerly, Jess Holbrook, Adam Roberts, and Douglas Eck. 2019. Identifying the intersections: User experience + research scientist collaboration in a generative machine learning interface. In *Extended Abstracts of the CHI Conference on Human Factors in Computing Systems (CHI EA)*. 1–8. doi:10.1145/3290607.3299059
- [28] Tae Soo Kim, Yoonjoo Lee, Jamin Shin, Young-Ho Kim, and Juho Kim. 2024. Evallm: Interactive evaluation of large language model prompts on user-defined criteria. In *CHI Conference on Human Factors in Computing Systems (CHI)*. 1–21. doi:10.1145/3613904.3642216
- [29] Scott R Klemmer, Anoop K Sinha, Jack Chen, James A Landay, Nadeem Aboobaker, and Annie Wang. 2000. Suede: A wizard of oz prototyping tool for speech user interfaces. In *Annual ACM symposium on User Interface Software and Technology (UIST)*. 1–10. doi:10.1145/354401.354406
- [30] Amy J Ko, Robin Abraham, Laura Beckwith, Alan Blackwell, Margaret Burnett, Martin Erwig, Chris Scaffidi, Joseph Lawrance, Henry Lieberman, Brad Myers, et al. 2011. The state of the art in end-user software engineering. *ACM Computing Surveys (CSUR)* 43, 3 (2011), 1–44. doi:10.1145/

- 1922649.1922658
- [31] Amy J Ko, Brad A Myers, and Htet Htet Aung. 2004. Six learning barriers in end-user programming systems. In *IEEE Symposium on Visual Languages-Human Centric Computing (VL/HCC)*. IEEE, 199–206. doi:10.1109/VLHCC.2004.47
 - [32] Jing Yu Koh, Robert Lo, Lawrence Jang, Vikram Duvvur, Ming Lim, Po-Yu Huang, Graham Neubig, Shuyan Zhou, Russ Salakhutdinov, and Daniel Fried. 2024. VisualWebArena: Evaluating Multimodal Agents on Realistic Visual Web Tasks. In *Proceedings of the 62nd Annual Meeting of the Association for Computational Linguistics (Volume 1: Long Papers)*, Lun-Wei Ku, Andre Martins, and Vivek Srikumar (Eds.). Association for Computational Linguistics, Bangkok, Thailand, 881–905. doi:10.18653/v1/2024.acl-long.50
 - [33] Robyn Kozierok and Pattie Maes. 1993. A learning interface agent for scheduling meetings. In *International Conference on Intelligent User Interfaces*. 81–88. doi:10.1145/169891.169908
 - [34] Wei Li, William Bishop, Alice Li, Chris Rawles, Folawiyi Campbell-Ajala, Divya Tyamagundlu, and Oriana Riva. 2025. On the effects of data scale on UI control agents. In *Proceedings of the 38th International Conference on Neural Information Processing Systems (Vancouver, BC, Canada) (NIPS '24)*. Curran Associates Inc., Red Hook, NY, USA, Article 2925, 25 pages.
 - [35] Jenny T Liang, Aayush Kumar, Yasharth Bajpai, Sumit Gulwani, Vu Le, Chris Parnin, Arjun Radhakrishna, Ashish Tiwari, Emerson Murphy-Hill, and Gustavo Soares. 2025. TableTalk: Scaffolding spreadsheet development with a language agent. *arXiv preprint arXiv:2502.09787* (2025).
 - [36] Jenny T Liang, Melissa Lin, Nikitha Rao, and Brad A Myers. 2025. Prompts are programs too! Understanding how developers build software containing prompts. *Proceedings of the ACM on Software Engineering* 2, FSE (2025), 1591–1614. doi:10.1145/3729342
 - [37] Jenny T Liang, Chenyang Yang, Agnia Sergeyuk, Travis D Breaux, and Brad A Myers. 2025. Understanding prompt programming tasks and questions. *arXiv preprint arXiv:2507.17264* (2025).
 - [38] Henry Lieberman. 1995. Letizia: an agent that assists web browsing. In *Proceedings of the 14th International Joint Conference on Artificial Intelligence - Volume 1* (Montreal, Quebec, Canada) (IJCAI'95). Morgan Kaufmann Publishers Inc., San Francisco, CA, USA, 924–929.
 - [39] Henry Lieberman. 1997. Autonomous interface agents. In *CHI Conference on Human Factors in Computing Systems (CHI)*, 67–74. doi:10.1145/258549.258592
 - [40] Henry Lieberman and Ted Selker. 2003. Agents for the user interface. *Handbook of Agent Technology* (2003), 1–21.
 - [41] Michael Xieyang Liu, Frederick Liu, Alexander J Fiannaca, Terry Koo, Lucas Dixon, Michael Terry, and Carrie J Cai. 2024. "We need structured output": Towards user-centered constraints on large language model output. In *Extended Abstracts of the CHI Conference on Human Factors in Computing Systems (CHI EA)*, 1–9. doi:10.1145/3613905.3650756
 - [42] Pattie Maes and Robyn Kozierok. 1993. Learning interface agents. In *AAAI*, Vol. 93. 459–465.
 - [43] Nora McDonald, Sarita Schoenebeck, and Andrea Forte. 2019. Reliability and inter-rater reliability in qualitative research: Norms and guidelines for CSCW and HCI practice. *Proceedings of the ACM on Human-Computer Interaction* 3, CSCW (2019), 1–23. doi:10.1145/3359174
 - [44] Aditi Mishra, Bretho Danzy, Utkarsh Soni, Anjana Arunkumar, Jinbin Huang, Bum Chul Kwon, and Chris Bryan. 2025. PromptAid: Visual prompt exploration, perturbation, testing and iteration for large language models. *IEEE Transactions on Visualization and Computer Graphics (TVCG)* (2025). doi:10.1109/TVCG.2025.3535332
 - [45] Yichen Pan, Dehan Kong, Sida Zhou, Cheng Cui, Yifei Leng, Bing Jiang, Hangyu Liu, Yanyi Shang, Shuyan Zhou, Tongshuang Wu, and Zhengyang Wu. 2024. Webcanvas: Benchmarking web agents in online environments. *arXiv preprint arXiv:2406.12373* (2024).
 - [46] Kayur Patel, James Fogarty, James A. Landay, and Beverly Harrison. 2008. Investigating statistical machine learning as a tool for software development. In *Proceedings of the SIGCHI Conference on Human Factors in Computing Systems* (Florence, Italy) (CHI '08). Association for Computing Machinery, New York, NY, USA, 667–676. doi:10.1145/1357054.1357160
 - [47] Savvas Petridis, Michael Terry, and Carrie J Cai. 2024. Promptinfuser: How tightly coupling AI and UI design impacts designers' workflows. In *ACM Designing Interactive Systems Conference (DIS)*, 743–756. doi:10.1145/3643834.3661613
 - [48] Kevin Pu, Daniel Lazaro, Ian Arawjo, Haijun Xia, Ziang Xiao, Tovi Grossman, and Yan Chen. 2025. Assistance or disruption? Exploring and evaluating the design and trade-offs of proactive AI programming support. In *CHI Conference on Human Factors in Computing Systems (CHI)*, 1–21. doi:10.1145/3706598.3713357
 - [49] Johnny Saldaña. 2009. *The coding manual for qualitative researchers*. SAGE Publications.
 - [50] Silvia Schiaffino and Analia Amandi. 2004. User-interface agent interaction: Personalization issues. *International Journal of Human-Computer Studies* 60, 1 (2004), 129–148. doi:10.1016/j.ijhcs.2003.09.003
 - [51] Ben Shneiderman and Pattie Maes. 1997. Direct manipulation vs. interface agents. *interactions* 4, 6 (1997), 42–61. doi:10.1145/267505.267514
 - [52] Hari Subramonyam, Roy Pea, Christopher Pondoc, Maneesh Agrawala, and Colleen Seifert. 2024. Bridging the gulf of envisioning: Cognitive challenges in prompt based interactions with llms. In *CHI Conference on Human Factors in Computing Systems (CHI)*, 1–19. doi:10.1145/3613904.3642754
 - [53] Hari Subramonyam, Divy Thakkar, Andrew Ku, Juergen Dieber, and Anoop K Sinha. 2025. Prototyping with prompts: Emerging approaches and challenges in generative ai design for collaborative software teams. In *CHI Conference on Human Factors in Computing Systems (CHI)*, 1–22. doi:10.1145/3706598.3713166
 - [54] Stephen Sutton and Ronald Cole. 1997. The CSLU Toolkit: Rapid prototyping of spoken language systems. In *Annual ACM Symposium on User Interface Software and Technology (UIST)*, 85–86. doi:10.1145/263407.263517
 - [55] Kyle Thayer, Sarah E Chasins, and Amy J Ko. 2021. A theory of robust API knowledge. *ACM Transactions on Computing Education (TOCE)* 21, 1 (2021), 1–32. doi:10.1145/3444945

- [56] Junyang Wang, Haiyang Xu, Jiabo Ye, Ming Yan, Weizhou Shen, Ji Zhang, Fei Huang, and Jitao Sang. 2024. Mobile-Agent: Autonomous multi-modal mobile device agent with visual perception. In *International Conference on Learning Representations Workshop on Large Language Model Agents*. <https://openreview.net/forum?id=jE6pDYCnVF>
- [57] Justin D Weisz, Jessica He, Michael Muller, Gabriela Hoefer, Rachel Miles, and Werner Geyer. 2024. Design principles for generative AI applications. In *CHI Conference on Human Factors in Computing Systems (CHI)*. 1–22. doi:10.1145/3613904.364246
- [58] Tongshuang Wu, Ellen Jiang, Aaron Donsbach, Jeff Gray, Alejandra Molina, Michael Terry, and Carrie J Cai. 2022. Promptchainer: Chaining large language model prompts through visual programming. In *CHI Conference on Human Factors in Computing Systems Extended Abstracts (CHI EA)*. 1–10.
- [59] Zhiyong Wu, Chengcheng Han, Zichen Ding, Zhenmin Weng, Zhoumianze Liu, Shunyu Yao, Tao Yu, and Lingpeng Kong. 2024. OS-Copilot: Towards generalist computer agents with self-improvement. In *International Conference on Learning Representations Workshop on Large Language Model Agents*. <https://openreview.net/forum?id=3WWFrg8UjJ>
- [60] Tianbao Xie, Danyang Zhang, Jixuan Chen, Xiaochuan Li, Siheng Zhao, Ruisheng Cao, Toh Jing Hua, Zhoujun Cheng, Dongchan Shin, Fangyu Lei, Yitao Liu, Yiheng Xu, Shuyan Zhou, Silvio Savarese, Caiming Xiong, Victor Zhong, and Tao Yu. 2024. OSWorld: Benchmarking Multimodal Agents for Open-Ended Tasks in Real Computer Environments. arXiv:2404.07972 [cs.AI] <https://arxiv.org/abs/2404.07972>
- [61] Chenyang Yang, Tesi Xiao, Michael Shavlovsky, Christian Kästner, and Tongshuang Wu. 2025. Orbit: A framework for designing and evaluating multi-objective rankers. In *International Conference on Intelligent User Interfaces (IUI)*. 1093–1106. doi:10.1145/3708359.3712092
- [62] Qian Yang, Justin Cranshaw, Saleema Amershi, Shamsi T Iqbal, and Jaime Teevan. 2019. Sketching NLP: A case study of exploring the right things to design with language intelligence. In *CHI Conference on Human Factors in Computing Systems (CHI)*. 1–12. doi:10.1145/3290605.3300415
- [63] Qian Yang, Alex Scuito, John Zimmerman, Jodi Forlizzi, and Aaron Steinfeld. 2018. Investigating how experienced UX designers effectively work with machine learning. In *ACM Conference on Designing Interactive Systems Conference (DIS)*. 585–596. doi:10.1145/3196709.3196730
- [64] Qian Yang, Aaron Steinfeld, Carolyn Rosé, and John Zimmerman. 2020. Re-examining whether, why, and how human-AI interaction is uniquely difficult to design. In *CHI Conference on Human Factors in Computing Systems (CHI)*. 1–13. doi:10.1145/3313831.3376301
- [65] J Diego Zamfirescu-Pereira, Richmond Y Wong, Bjoern Hartmann, and Qian Yang. 2023. Why Johnny can't prompt: how non-AI experts try (and fail) to design LLM prompts. In *CHI Conference on Human Factors in Computing Systems (CHI)*. 1–21. doi:10.1145/3544548.3581388
- [66] Zhuohao Zhang, Eldon Schoop, Jeffrey Nichols, Anuj Mahajan, and Amanda Swearngin. 2025. From Interaction to impact: Towards safer AI agent through understanding and evaluating mobile UI operation impacts. In *International Conference on Intelligent User Interfaces (IUI)*. 727–744. doi:10.1145/3708359.3712153
- [67] Boyuan Zheng, Boyu Gou, Scott Salisbury, Zheng Du, Huan Sun, and Yu Su. 2024. WebOlympus: An open platform for web agents on live websites. In *Conference on Empirical Methods in Natural Language Processing (EMNLP): System Demonstrations*. 187–197. doi:10.18653/v1/2024.emnlp-demo.20
- [68] Shuyan Zhou, Frank F. Xu, Hao Zhu, Xuhui Zhou, Robert Lo, Abishek Sridhar, Xianyi Cheng, Tianyue Ou, Yonatan Bisk, Daniel Fried, Uri Alon, and Graham Neubig. 2024. WebArena: A realistic web environment for building autonomous agents. In *International Conference on Learning Representations (ICLR)*. <https://openreview.net/forum?id=oKn9c6ytlx>

Appendix

We include a subset of the supplemental materials for this work. For the complete set of supplementary materials, including the protocols, codebooks, and video figure, please refer to the materials in PCS [6]. We will make all materials public upon acceptance of the work.

A Design Probe: AgentBuilder

Below, we describe how AgentBuilder can support the prototyping of different agent experiences by illustrating three distinct agent prototypes for the same user query (Section A.1).

A.1 Agent Prototype Examples

AgentBuilder supports the construction of different types of agent prototypes that can vary in the level of interaction with the user and the amount of information the agent communicates about its UI actions while it is executing. We illustrate a range of different agent experiences that AgentBuilder can prototype in Figure 6 and describe it further below. Each prototype helps the user order a cappuccino with the ambiguous user query, "Order me a coffee please!"

Prototype 1 is an agent that is interactive by clarifying the order and asking for confirmation before adding to the cart. It also communicates information about each UI action it performs on the screen. Next, Prototype 2 is an agent that

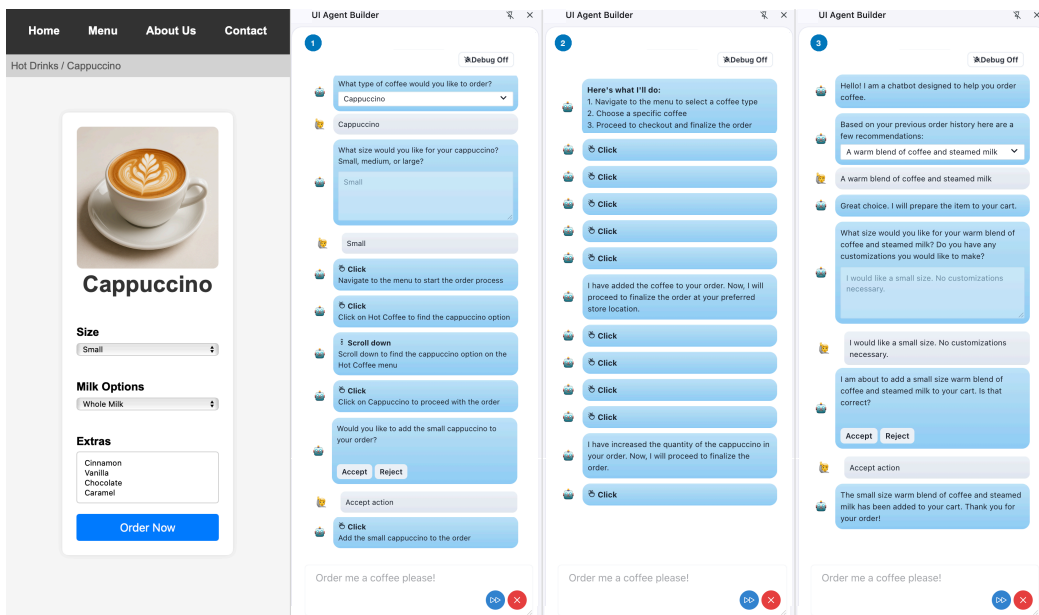

Fig. 6. Example agent prototypes ① ② ③ for the same task and user query, which is to order a cappuccino with the user query "Order me a coffee please!" Prototype ① is interactive, and shows the most information about the agent's UI actions; prototype ② executes the task autonomously, and shows some information about the agent's UI actions; and prototype ③ is interactive, but shows no information about the agent's UI actions.

approaches the same problem without any user interaction. Instead, it shows the user a plan of how it will complete the actions, summarizes its actions in messages, and makes decisions about what is ordered without user input. To reduce the amount of information shown to the user, this agent only shows the UI action's name each time it performs an action on the webpage. Finally, Prototype 3 is an agent that is designed to be friendly, communicative, and interactive for the user query by clarifying the order and asking for confirmation before adding to the cart. This agent does not show any information about each UI action it performs on the screen to reduce the amount of text in the chat.

To highlight the differences between agent prototypes, compared to Prototypes 1 and 3, Prototype 2 has much less user interaction. Compared to Prototypes 1 and 2, Prototype 3 does not communicate any information about the UI actions; further, it is more conversational than Prototype 1. We now describe how to construct each agent prototype in AgentBuilder below.

A.1.1 Prototype 1. Prototype 1 is the interactive agent that clarifies coffee orders, confirms with users, and communicates information about UI actions. This agent can be created in AgentBuilder by adding in user interaction with Confirm and Interact nodes. To build this agent in AgentBuilder, the developer can create a flow to Interact with the user, perform UI Actions, and Confirm with the user before adding to the cart (i.e., Start → Interact → UI Actions → *if_add_cart* Confirm → End). The developer can also set the UI Actions to show the UI action's name (e.g., scroll, click) and a brief description of the UI action.

A.1.2 Prototype 2. Prototype 2 is not an interactive experience. It instead shows a plan of actions, summarizes actions in messages, and only shows the UI action's name. To prototype this agent in AgentBuilder, the developer can create a

flow that displays a Plan to the user and sends a Message when major steps in the plan are completed (i.e., Start → Plan → UI Actions → *if_step_done* Message → End). The developer can set the UI Actions to show the UI action's name only.

A.1.3 Prototype 3. Prototype 3 is a friendly, communicative, and interactive agent that clarifies orders, asks for confirmation, and sends update messages after important steps are accomplished. It shows no information about each UI action to reduce the amount of text in the chat. To build this agent in the tool, the developer can create a flow to send a welcome Message, Interact with the user to understand their order, Message the user a summary of the actions, and Confirm with the user before adding an item to the cart (i.e., Start → *welcome_message* Message → Interact → *summarize_order* Message → UI Actions → *if_add_cart* Confirm → End). The developer can show no information about the agent's UI Actions in the chat and in the webpage.

B In Situ Agent Prototyping Study

We discuss the types of examples participants created with AgentBuilder (Appendix B.1) as well as the instructions given to study participants for the agent prototyping exercise (Appendix B.2).

B.1 Participant Agent Prototype Examples

Below, we illustrate the range of agent experiences participants were able to prototype using AgentBuilder.

B.1.1 P1 Agent Prototypes. P1's agent is shown in Figure 7, where they inputted "Order me a coffee. I'm not sure what I want" (P1), and worked with the agent to order a matcha green tea latte. P1 designed their agent to be friendly, energetic (P1), and interactive. P1's workflow was designed to have user interaction and included two Interact nodes and a Confirm node. P1 designed their agent to show no information (i.e., no action name, action description, or agent reasoning) about the agent's UI actions in the chat. As a result, while executing the agent, P1's agent asked for user input four times to clarify and confirm the user's order before proceeding to complete the order.

B.1.2 P4 Agent Prototypes. P4's agent is shown in Figure 8, where P4 gave the query "Order me a drink that I like" (P4), and worked with the agent to order a drink called Caffè Misto. P4's agent workflow was Start → UI Actions → *high_risk_action* → End. This agent also did not show any information about UI actions (i.e., action name, action description, agent reasoning) in the chat. Therefore, when P4's agent prototype was run, the chat pane was empty with the exception of a single confirmation message before purchasing the Caffè Misto, which was deemed by the agent as a potentially risky action.

B.1.3 P6 Agent Prototypes. The agent prototype created by P6 is shown in Figure 9 with the user query "I want a pastry item, what do you recommend?" (P6) to order a butter croissant. This agent was designed to not be interactive with a workflow of Start → UI Actions → End. However, P6 added a guideline that described an exception to this, which said while exploring options, the agent should show top 3 to 5 items (P6) in the category. P6 also chose to show the action descriptions for UI actions but added a guideline to shorten the UI action descriptions. When this agent was run, the agent provided recommendations in accordance to P6's instructions via a drop-down menu and displayed very brief descriptions of each UI action (e.g., "MENU", "Bakery").

B.1.4 P14 Agent Prototypes. One of the agent prototypes created by P14 is shown in Figure 10, where P14 asked, "Order me a tall Caffè Misto" (P14). P14 designed this agent to show more information about UI actions (i.e., action description,

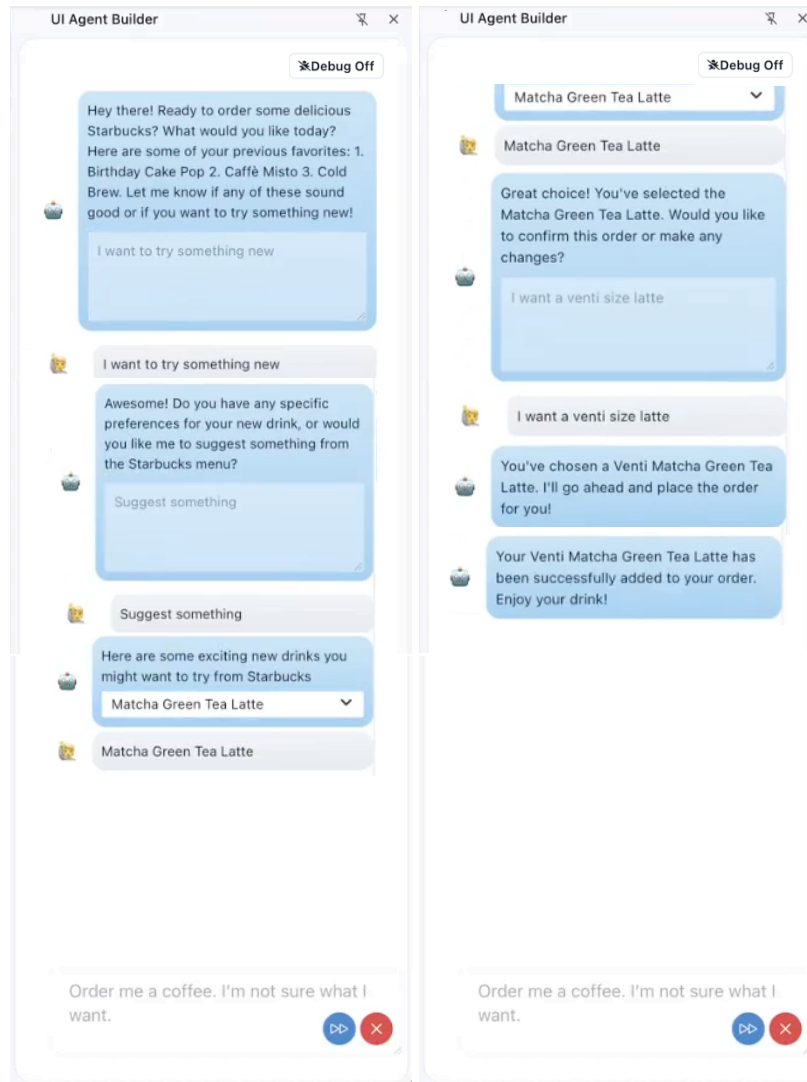

Fig. 7. The agent prototype that P1 created during the *in situ* agent prototyping study for the input “Order me a coffee. I’m not sure what I want” (P1).

agent reasoning). P14 designed the agent’s workflow to handle agent errors, wherein upon encountering an error, the agent would show a plan that the user would confirm the next action. If the user rejected the suggestions, the agent would further interact with the user (i.e., Start → ... → UI Actions → *agent_error* Plan → Confirm → *confirmation_declined* Interact → End). While running this agent on the user query, P14’s agent was unable to find the item. It therefore followed the workflow that P14 defined: it displayed a plan, confirmed with the user about the next step of actions (“Would you like me to perform a search or navigate to another section to locate [the item]?”), which P14 declined (“No, order me some other coffee...” (P14)). The agent followed up by asking what other coffee the user wanted.

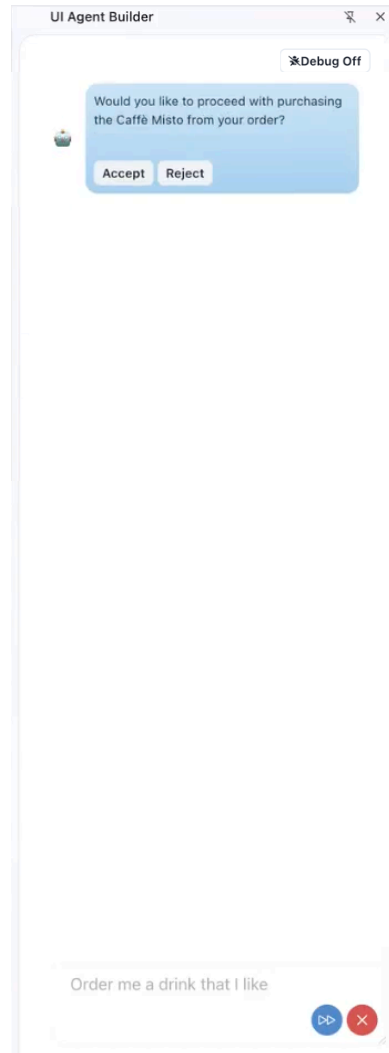

Fig. 8. The agent prototype that P4 created during the *in situ* agent prototyping study for the input “Order me a drink that I like” (P4).

B.2 Agent Prototyping Exercise Instructions

Description. You are a business owner looking to have an UI agent help make customer orders on the Starbucks website. Design an agent that achieves this task for your customers so they have a positive user experience, while considering the different kind of user inputs that might occur.

More specifically, design a system prompt to tell the agent which actions to use and when to provide the best user experience. You should also decide what information the agent should reveal in the chat and UI about its actions. You can assume the user’s credit card information is linked to the Starbucks website.



Fig. 9. The agent prototype that P6 created during the *in situ* agent prototyping study for the input “*I want a pastry item, what do you recommend?*” (P6)

Important: The agent may not be able to complete the actions on its own. It is more important to achieve a good user experience with the agent, rather than getting the agent to perform actions correctly and independently.

User Inputs. You will start the interaction from the Starbucks homepage. Here are some situations that you may encounter that your agent should handle:

- “Order me a coffee. I’m not sure what I want.”
- “Order me a tall Caffè Misto.”
- “Order me a tall iced chai latte and a butter croissant.”

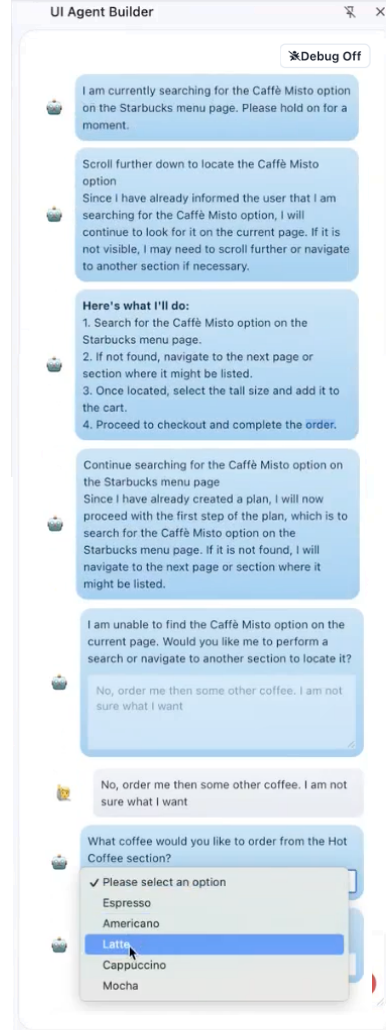

Fig. 10. The agent prototype that P14 created during the *in situ* agent prototyping study for the input “Order me a tall Caffè Misto” (P14).

- "Get me a croissant." (to order a chocolate croissant)
- "I'm not sure what I want to order. Give me a couple of ideas based on what I've ordered in the past."

User Background. The agent already knows some information about the user, including:

- The user picks up their order at 442 Terry Ave N, Seattle, WA 98109, known as the Terry & Republican store
- Their password to the Starbucks account is "REDACTED2025"
- The user's previous orders include a birthday cake pop, Caffè Misto, and a cold brew at Starbucks

Agent Guide. Here are the actions that the agent can do and how they look like. You may need to adjust your prompt or the agent's appearance to tell the prompt when to use the actions. *[Show images of each agent tool from the tutorial slides]*

Received 20 February 2007; revised 12 March 2009; accepted 5 June 2009