

TTT3R: 3D RECONSTRUCTION AS TEST-TIME TRAINING

Xingyu Chen¹ Yue Chen¹ Yuliang Xiu¹ Andreas Geiger² Anpei Chen¹¹Westlake University ²University of Tübingen, Tübingen AI Center

Figure 1: **Left:** CUT3R [81] encodes observations into a state (memory) S_{t-1} , then interacts with new observation X_t and retrieves 3D information by reading out the output token Y_t . However, it suffers from the forgetting problem and degrades significantly as the number of input views increases. **Right:** We treat the state S_t as a fast weight updated via gradient descent, where the learning rate β_t and the gradient ∇_t are predicted by the frozen slow weights. These slow weights are learned from training datasets and act as a meta-learner, enabling the fast weight to serve as an associative memory. In addition, TTT3R makes online state updates by balancing the retention of historical information S_{t-1} with a confidence-aware learning rate β_t . This visualization also incorporates a state reset process, please see Sec. A for details.

ABSTRACT

Modern Recurrent Neural Networks have become a competitive architecture for 3D reconstruction due to their linear-time complexity. However, their performance degrades significantly when applied beyond the training context length, revealing limited length generalization. In this work, we revisit the 3D reconstruction foundation models from a Test-Time Training perspective, framing their designs as an online learning problem. Building on this perspective, we leverage the alignment confidence between the memory state and incoming observations to derive a closed-form learning rate for memory updates, to balance between retaining historical information and adapting to new observations. This training-free intervention, termed TTT3R, substantially improves length generalization, achieving a $2\times$ improvement in global pose estimation over baselines, while operating at 20 FPS with just 6 GB of GPU memory to process thousands of images. Code available in [rover-xingyu.github.io/TTT3R](https://github.com/rover-xingyu/TTT3R).

1 INTRODUCTION

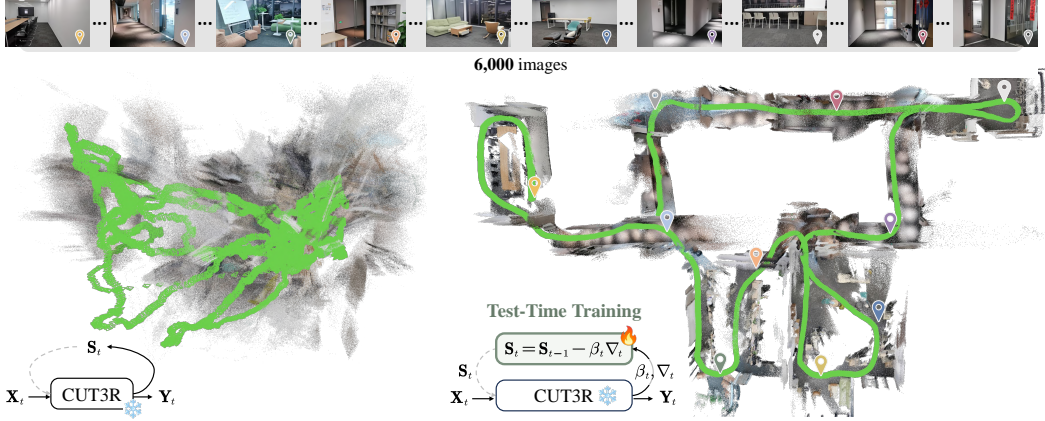
3D reconstruction foundation models aim to predict camera poses and scene representations from a set of input RGB images. Building on the sequence modeling [68], recent advances [79, 83, 93] successfully map sequences of images into pixel-aligned pointmaps [10, 11]. Among these methods, the Transformer [74] has emerged as the dominant architecture, owing to its training efficiency and ability to capture long-range dependencies. However, a fundamental limitation lies in the quadratic growth of computational and memory costs with respect to sequence length. Despite various engineering optimizations, such as KV-cache compression [40] and flash attention [21], the softmax attention remains unchanged and continues to face limited scalability for long contexts [41].

Real-world applications often require handling an arbitrary number of images. As Figure 2 shows, recent feed-forward methods (e.g., VGGT [79], Point3R [87]) suffer from high memory consumption. Notably, only CUT3R [81] achieves constant memory usage with RNN-based design. However, as illustrated in Figure 1, CUT3R fails to generalize to long sequences due to training on most 64-frame sequences. Motivated by these observations, we ask ourselves if there are lessons from modern RNNs that can be used as design principles for 3D reconstruction.

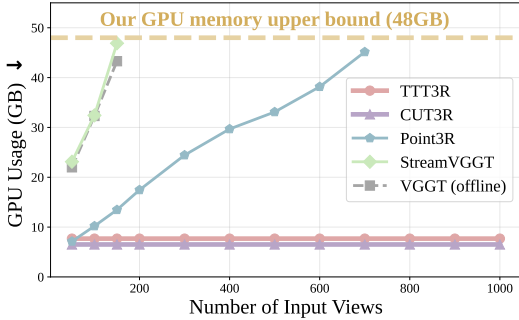

Figure 2: GPU memory cost for inference.

Recent advances in Recurrent Neural Networks (RNNs) demonstrate performance on par with Transformers on language tasks [32, 34]. Recurrent architectures compress the history context into a fix-length memory state, with each output depending solely on the current state and the incoming observation. This recurrent mechanism offers two benefits: efficient processing of long sequences with linear computational complexity, and the ability to scale to longer sequences by simply rolling out the state. Nevertheless, these benefits often come at the cost of substantial performance degradation, particularly when the sequence length exceeds the training context [55, 76].

This naturally raises two questions: (1) why do these models fail to provide robust length generalization? and (2) how can length generalization be achieved? To answer these questions, several studies [8, 55, 91] have investigated the length generalization of RNNs, identifying correlations with state overfitting [82], state forgetting [16, 33], and unexplored state distributions [55]. Solutions such as training on longer sequences and employing Truncated Backpropagation Through Time (TBTT) [55, 67, 86] have been proposed to improve length generalization. While these techniques have been incorporated into recent 3D reconstruction foundation models, such as CUT3R [81], they still struggle to generalize to sequences comprising hundreds of images.

In this work, we revisit the state update rule of recurrent 3D reconstruction models through the lens of Test-Time Training (TTT) [7, 65, 80, 92], and systematically investigate the factors that hinder their ability to generalize across varying sequence lengths. Specifically, inspired by recent findings that recurrent models struggle with length generalization due to state overfitting [55], we reformulate state updating as a TTT-style online learning process [7, 41, 80]. In our framework, the historical information is compressed into a state online. We interpret the state as a fast weight [57, 58] learned at test time from the input in-context tokens, rather than from the training dataset. This perspective provides a principled understanding of state overfitting, suggesting that associative recall [9, 53] over long contexts, combined with gradient-based updates using adaptive learning rates to balance forgetting and learning [5, 6, 32, 41, 57, 66, 89], can substantially enhance length generalization.

Furthermore, we find that CUT3R [81] can be interpreted as a test-time training mechanism, whereas simply extending the sequence length during training leads to extremely low FLOPs utilization. Therefore, we propose a simple yet effective inference-time state update rule, termed **TTT3R**, derived as a closed-form state transition for online associative recall in CUT3R. This transition function explicitly defines the learning rate required to update the state at test time, thereby enabling length generalization. Our approach exploits internal confidence signals to selectively suppress low-quality state updates. This yields a stable, training-free gating mechanism that mitigates catastrophic forgetting [35] without requiring fine-tuning or additional parameters.

We evaluate TTT3R on standard 3D reconstruction benchmarks, which are typically configured with short-sequence inputs. In this setting, TTT3R performs competitively with state-of-the-art online reconstruction models [81, 87, 97] and demonstrates significant improvements with long-sequence inputs. More importantly, these gains in length generalization come at NO additional computational cost over the baseline, thanks to the proposed state update rule.

Overall, we introduce a new TTT-based framework to analyze the dynamics of stateful 3D reconstruction models. Based on this, we propose a simple, empirical state update rule to enhance sequence length generalization for CUT3R.

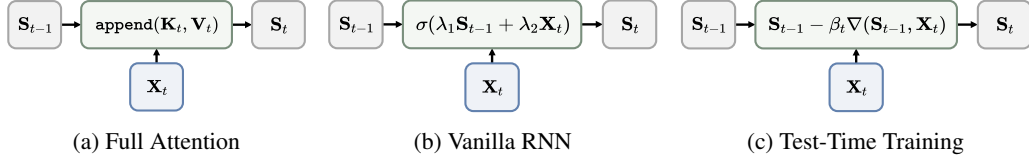

Figure 3: **Sequence Modeling Layers.** Full attention appends states, which incurs a quadratic cost. In contrast, vanilla RNNs use a fixed-size state with linear complexity, but they suffer from the forgetting problem. Our approach adopts Test-Time Training (TTT), treating the state as fast weights learned during test time via gradient descent with adaptive learning rates, which improves length generalization.

2 RELATED WORK

SfM and SLAM. Structure-from-Motion (SfM) [2, 36, 50, 51, 59, 62, 63] and Simultaneous Localization and Mapping (SLAM) [22, 27, 39, 44, 45, 96] have long been the foundation for 3D structure reconstruction and camera pose estimation. These methods rely on associating 2D correspondences [4, 23, 43, 44, 56] or minimizing reprojected photometric errors [27, 28], followed by bundle adjustment (BA) [1, 11, 69, 71, 72, 78] for structure and motion refinement. Although highly effective when assembled into comprehensive systems [44, 59], these approaches often struggle in conditions of small camera parallax or ill-posed conditions (e.g., dynamic or textureless), leading to performance degradation. In this work, we investigate data-driven models with generalizable priors to enable dense 3D reconstruction even from dynamic and textureless video sequences.

Offline Reconstruction Foundation Model. The pioneering feedforward 3D reconstruction method DUST3R [83] introduced an end-to-end formulation that directly predicts two pixel-aligned pointmaps [10, 11, 61] from an image pair. By leveraging a Transformer-based architecture [26] and direct point supervision on large-scale 3D datasets, DUST3R inherently accounts for image matching [3, 15] and pose estimation [25, 42], resulting in a reconstruction foundation model. Although some follow-up methods [15, 94] extend DUST3R for robust dynamic scene reconstruction, they inherit the limitation of DUST3R, requiring costly global alignment when the number of input views exceeds two. To address this issue, Fast3R [88] and VGGT [79] propose to use a large feedforward transformer with global attention that handles multiview inputs and predicts per-view pointmaps simultaneously, without the need for post-processing, leading to state-of-the-art 3D point and camera pose reconstruction. However, relying on the full attention [74] causes a quadratic increase in computational and memory cost, and results in an offline process that requires re-running inference over all images whenever a new frame arrives. Instead, we aim for compute-efficient, on-the-fly streaming inference that supports long-sequence, real-time interactive, and compute-efficient applications.

Online Reconstruction Foundation Model. To improve the reconstruction efficiency, several works introduce memory mechanisms to maintain information from past frames, enabling incremental reasoning and add pointmaps to a canonical 3D space. StreamVGGT [97] concurrently caches historical keys and values as memory in a causal transformer framework, allowing incremental processing. However, similar to full attention in VGGT [79], the computation and GPU memory usage in StreamVGGT grow redundantly. A promising alternative is the use of recurrent neural network architectures [13, 18, 77], such as CUT3R [81], which maintain a constant-sized memory state, while incrementally integrating new observations by simultaneously updating the state with the newly added view and retrieving historical information from the state. Although the recurrent formulation effectively reduces computational complexity and keeps inference memory usage consistently low, the memory-based methods suffer from the forgetting problem from earlier frames, leading to significant performance degradation as the number of input views increases. To mitigate the forgetting issue, Point3R [87] proposes an explicit point-based memory, where the history tokens are anchored in the reconstructed 3D point positions. While the explicit memory cache mitigates the forgetting, it causes memory cost that grows linearly as the number of views increases because the reconstructed points accumulate. In this work, we take an opposite path, exploring a closed-form state update rule that enhances the length generalization of implicit state memory to reasoning over thousands of views, while keeping memory and computation costs consistently low and unchanged as input view growth.

Modern RNN. Recent developments in RNN layers, serve as more efficient alternatives to quadratic complex full-attention layers [74], have demonstrated competitive performance in language modeling tasks. One line of research originates from a recurrent variant of attention [34, 57], known as linear attention [34], which uses the standard inner product between the query and key rather than the

exponential softmax, allowing the output to be recurrently computed in linear time. However, linear attention equally compresses all key value pairs into its finite-sized state, resulting in performance degradation as the sequence length increases. To address this limitation, various works [5, 47, 66, 89], such as Mamba [20, 32], have proposed adding forgetting gates, in which previous values are attenuated by a factor before the new memory is stored, to prevent the state from diverging over time. Recently, many of these models have been cast into a framework of test-time training/regression [7, 65, 80], which views the recurrent update of state as online learning [41] from context [24, 75], balancing between retaining historical memory and adapting to new information, as shown in Figure 3. The iterate states are also known as fast weights [57, 58], as they change in-context with each timestep, rapidly adapting to the input tokens. In contrast to the slow weights in neural networks—which act as meta-learners [29] and are only adjusted during training—fast weights are learned to function as associative memory [9, 53]. Recent examples of such layers include DeltaNet [57, 90], TTT [65, 95], and Titans [6], each of these layers was derived from a specific choice of retention and adaptation. Inspired by their success, we propose to introduce a general test-time training framework that enables 3D reconstruction models to achieve both view scalability and memory retention.

3 METHOD

Our method processes a continuous stream of images received online. For each incoming image $\mathbf{I}_t \in \mathbb{R}^{W \times H \times 3}$, we aim to estimate, in real time and on the fly: the camera pose $\mathbf{T}_t \in \mathbb{R}^{3 \times 4}$, the camera intrinsic $\mathbf{C}_t \in \mathbb{R}^{3 \times 3}$, and the canonical point cloud $\mathbf{P}_t \in \mathbb{R}^{W \times H \times 3}$. We begin in Section 3.1 by introducing sequence modeling to understand and compare different prominent classes of methods that address the pointmap regression problem. Section 3.2 then reformulates recent incremental 3D reconstruction methods from a Test-Time Training perspective. Finally, in Section 3.3, we propose TTT3R, showing how the cross-attention between memory and observation can be leveraged as a confidence-guided state update rule for online associative recall.

3.1 SEQUENCE MODELING FOR POINTMAP REGRESSION

To transform a sequence of images to pixel-aligned pointmaps that lie in a unified global coordinate space, a generic formulation can be written as:

$$\begin{aligned}\mathbf{X}_t &= \text{Tokenize}(\mathbf{I}_t) \\ \mathbf{S}_t &= \text{Update}(\mathbf{S}_{t-1}, \mathbf{X}_t) \\ \mathbf{Y}_t &= \text{Read}(\mathbf{S}_t, \mathbf{X}_t) \\ \mathbf{P}_t &= \text{De-tokenize}(\mathbf{Y}_t)\end{aligned}\tag{1}$$

where the input image \mathbf{I}_t is patchified into a set of image tokens $\mathbf{X}_t \in \mathbb{R}^{(h \times w) \times c}$ through an image tokenizer [26], such as DINO [14, 46] and CroCo [84, 85]. The image tokens \mathbf{X}_t update the previous state \mathbf{S}_{t-1} into the current state \mathbf{S}_t using new information. The model then retrieves information stored in the updated state \mathbf{S}_t by reading out the output token $\mathbf{Y}_t \in \mathbb{R}^{(h \times w) \times c}$. Following the readout operation, the corresponding pixel-aligned 3D pointmaps are extracted via dense prediction de-tokenizers, such as linear layers with pixel shuffle [60] and a DPT head [54]. The camera pose \mathbf{T}_t and the camera intrinsic \mathbf{C}_t , can either be solved from pixel-aligned 3D pointmaps using the PnP [37] and Weiszfeld [49] algorithms, or regressed from image tokens \mathbf{X}_t through the MLP or trunk attention layers [78, 79].

This sequence formulation offers a unified perspective for interpreting pointmap-oriented 3D reconstruction foundation models, where the update and read operations serves as the core distinction among different methods. They fall into two categories: full attention-based and RNN-based, each introducing specialized designs to the update rules of sequence modeling layers.

For full attention-based methods, such as Fast3R [88] and VGGT [79], all frames interact through global all-to-all self-attention, which can be interpreted as progressive state concatenation with growing state length:

$$\begin{aligned}\text{Update}(\mathbf{S}_{t-1}, \mathbf{X}_t) &= \mathbf{S}_{t-1}.\text{append}(\mathbf{K}_{\mathbf{X}_t}, \mathbf{V}_{\mathbf{X}_t}) \\ \text{Read}(\mathbf{S}_t, \mathbf{X}_t) &= \mathbf{X}_t + \text{softmax}(\mathbf{Q}_{\mathbf{X}_t} \mathbf{K}_{\mathbf{S}_t}^\top) \mathbf{V}_{\mathbf{S}_t}\end{aligned}\tag{2}$$

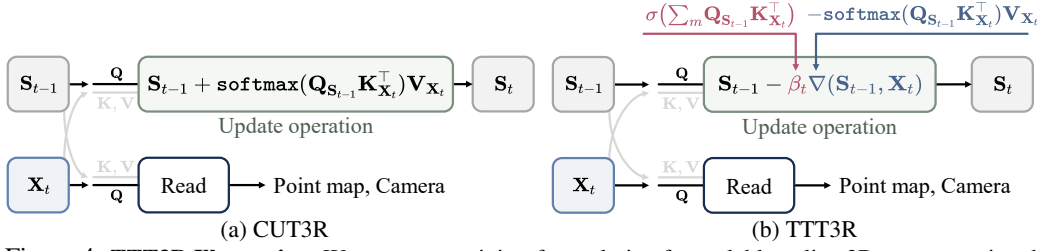

Figure 4: **TTT3R Illustration.** We present a training-free solution for scalable online 3D reconstruction that mitigates forgetting issue in CUT3R. (a) Vanilla CUT3R [81] pipeline. (b) Our reformulation from a test-time training perspective introduces a confidence-guided state update, where alignment confidence between memory and observations serves as per-token learning rates. See Eq. 8 for more details.

where state $S_{t-1} = [(K_{X_1}, V_{X_1}), \dots, (K_{X_{t-1}}, V_{X_{t-1}})]$ is a list of key-value pairs. Each key-value pair (K_{X_t}, V_{X_t}) and query Q_{X_t} are transformed from the input token X_t via linear layers, and $K_{S_t} = \text{concat}[K_{X_1}, \dots, K_{X_t}]$, $V_{S_t} = \text{concat}[V_{X_1}, \dots, V_{X_t}]$. This modeling requires $\mathcal{O}(t^2)$ computing complexity, since all output tokens Y_1, \dots, Y_t must be updated upon receiving X_t . To efficiently process streaming input, StreamVGGT [97] uses a causal attention architecture to model the causal nature of streaming data, which restricts each frame to attend only to itself and preceding tokens, allowing only Y_t to be updated given X_t . Causal attention enables incremental processing and reduces the computational cost to $\mathcal{O}(t)$. However, it shares a similar limitation with full attention: the state is represented as a key-value list that grows redundantly at $\mathcal{O}(t)$, leading to increasing memory consumption as the number of views increases.

For RNN-based methods [13, 18, 77, 81, 87], each incoming frame interacts with the state via one-to-one cross-attention, allowing for fixed-length state:

$$\text{Update}(S_{t-1}, X_t) = S_{t-1} + \text{softmax}(Q_{S_{t-1}} K_{X_t}^T) V_{X_t} \quad (3)$$

where the state $S_{t-1} \in \mathbb{R}^{n \times c}$, consisting of n tokens with channel dimension c , encodes the scene with a constant length. $Q_{S_{t-1}}$ denotes the query projection obtained by applying a linear transformation to the state S_{t-1} . Although this recurrent formulation effectively reduces the computational complexity to $\mathcal{O}(1)$ and inference memory usage constant at $\mathcal{O}(1)$, it suffers from forgetting and exhibits significant performance degradation as the number of input views increases.

3.2 REVISIT RNN-BASED RECONSTRUCTION THROUGH TTT

Test-Time Training (TTT) [65] introduces fast weights [58] as rapidly adaptable states that are updated during both training and inference to dynamically capture context. In contrast, slow weights (i.e., model parameters) remain frozen during inference. Formally, TTT represents the state as a fixed-length fast weight $S_{t-1} \in \mathbb{R}^{n \times c}$ and updates it via gradient descent:

$$\text{Update}(S_{t-1}, X_t) = S_{t-1} - \beta_t \nabla(S_{t-1}, X_t) \quad (4)$$

where $\nabla(S_{t-1}, X_t)$ is a learned gradient function of the previous state S_{t-1} and the current observation X_t , aiming to encourage the network to associate the current observation with the state, and β_t is the learning rate. Intuitively, this online learning process encodes the KV-cache from the current observation into a fixed length of memory (i.e., state) as accurately as possible [80].

For example, linear TTT (or DeltaNet [57, 90]) minimizes the reconstruction error $\|(S_{t-1} K_{X_t} - V_{X_t})\|^2$ by optimizing the state S to accurately reconstruct the observation value V_{X_t} . This objective yields an analytical gradient:

$$\text{Update}(S_{t-1}, X_t) = S_{t-1} - \beta_t \nabla(S_{t-1}, X_t) \quad (5)$$

$$\frac{(S_{t-1} K_{X_t} - V_{X_t}) K_{X_t}^T}{\sigma(\sum_m Q_{S_{t-1}} K_{X_t}^T) - \text{softmax}(Q_{S_{t-1}} K_{X_t}^T) V_{X_t}}$$

Next, we analyze the learning rate term β , which serves as the most critical hyperparameter and has been extensively studied in recent advances. It is typically represented as: 1) a learnable scalar parameter $\beta \in \mathbb{R}^1$ in RetNet [66]; 2) an input-dependent scalar function $\beta_t = \sigma(\ell_\beta(X_t)) \in \mathbb{R}^1$ in DeltaNet [57, 90], TTT [65], and Mamba-2 [20]; and 3) a per-token function $\beta_t = \sigma(\ell_\beta(X_t)) \in \mathbb{R}^{n \times 1}$ in Gated Linear Attention [89], which enables token-wise adaptive learning rates across all n state tokens. Up to this point, we reformulate the Eq. 3 using the above TTT formulation:

$$S_{t-1} + \text{softmax}(Q_{S_{t-1}} K_{X_t}^T) V_{X_t} = S_{t-1} - \beta_t \nabla(S_{t-1}, X_t) \quad (6)$$

$$\frac{1.0}{\sigma(\sum_m Q_{S_{t-1}} K_{X_t}^T) - \text{softmax}(Q_{S_{t-1}} K_{X_t}^T) V_{X_t}}$$

The gradient is defined as a linear combination of the observation values $\mathbf{V}_{\mathbf{X}_t} \in \mathbb{R}^{(h \times w) \times c}$, weighted by the softmax alignment scores $\text{softmax}(\mathbf{Q}_{\mathbf{S}_{t-1}} \mathbf{K}_{\mathbf{X}_t}^\top) \in \mathbb{R}^{n \times (h \times w)}$ between the state query $\mathbf{Q}_{\mathbf{S}_{t-1}} \in \mathbb{R}^{n \times c}$ and the observation key $\mathbf{K}_{\mathbf{X}_t} \in \mathbb{R}^{(h \times w) \times c}$. This formulation has been demonstrated to be effective [83] for learning emergent functional 3D/4D alignment by implicitly matching cross-view context [15].

However, the softmax operation limits CUT3R’s ability to balance retaining historical information with incorporating new inputs, as it forces the model to fully adapt to the latest observations. Specifically, because softmax weights are normalized to sum to 1.0 along the observation-token dimension, the model always prioritizes new information \mathbf{X}_t over the historical state \mathbf{S}_{t-1} , leading to catastrophic forgetting.

3.3 CONFIDENCE-GUIDED STATE UPDATE RULE

Our core idea is to utilize alignment confidence between memory and observation to guide state updates, with this confidence serving as the learning rate in the TTT formulation. Figure 4 provides an overview of TTT3R.

Recall that the cross-attention (i.e., $\mathbf{Q}_{\mathbf{S}_{t-1}} \mathbf{K}_{\mathbf{X}_t}^\top$) aggregates information along the spatial dimension $m = \{1, \dots, h\} \times \{1, \dots, w\}$ of the image into n state tokens. This process yields normalized attention weights for each state token, which are then used to compute a weighted sum over the value tokens $\mathbf{V}_{\mathbf{X}_t}$. To address the forgetting issue, we retain the original attention formulation but introduce a per-token learning rate $\beta_t \in \mathbb{R}^{n \times 1}$, derived from the alignment confidence between the state queries $\mathbf{Q}_{\mathbf{S}_{t-1}}$ and the observation keys $\mathbf{K}_{\mathbf{X}_t}$:

$$\beta_t = \sigma(\sum_m \mathbf{Q}_{\mathbf{S}_{t-1}} \mathbf{K}_{\mathbf{X}_t}^\top) \quad (7)$$

This learning rate can act as a soft gate in gated attention, incorporating it into the attention output allows for better long-context extrapolation [52]. Consequently, the full closed-form state update rule is given by:

$$\text{Update}(\mathbf{S}_{t-1}, \mathbf{X}_t) = \mathbf{S}_{t-1} - \beta_t \nabla(\mathbf{S}_{t-1}, \mathbf{X}_t) \quad (8)$$

Note that, rather than ignoring quality variations and updating all state uniformly - which we find leads to suboptimal performance due to low-quality state updates (e.g., textureless regions, see Figure 5) - we leverage cross-attention statistics to estimate the alignment confidence of state updates and accordingly assign per-token learning rates β_t . That is, a higher alignment confidence in state updates generally indicates a stronger match between the state and observation with lower uncertainty, leading to a larger update step in our formulation. By aggregating token-level statistics, we suppress low-quality state updates to enhance performance. A similar principle - leveraging internal confidence signals to selectively filter updates - has been explored in concurrent work [30] to improve test-time reasoning for large language models.

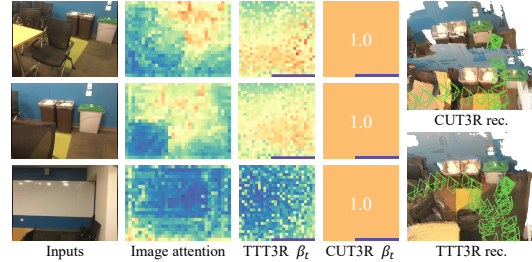

Figure 5: By incorporating image attention (i.e., $\mathbf{Q}_{\mathbf{S}_{t-1}} \mathbf{K}_{\mathbf{X}_t}^\top \in \mathbb{R}^{n \times (h \times w)}$) as per-token learning rates $\beta_t \in \mathbb{R}^{n \times 1}$, TTT3R mitigates catastrophic forgetting and facilitates online loop closure.

This formulation enables a training-free, plug-and-play intervention for CUT3R, which can be directly applied to downstream tasks without additional fine-tuning.

4 EXPERIMENTS

We evaluate our method on a variety of tasks, including camera pose estimation (Section 4.1), video depth estimation (Section 4.2), and 3D reconstruction (Section 4.3).

Baselines. We first compare TTT3R with the state-of-the-art online 3D reconstruction method CUT3R [81], which performs on-the-fly reconstruction with an RNN-based architecture over stream-

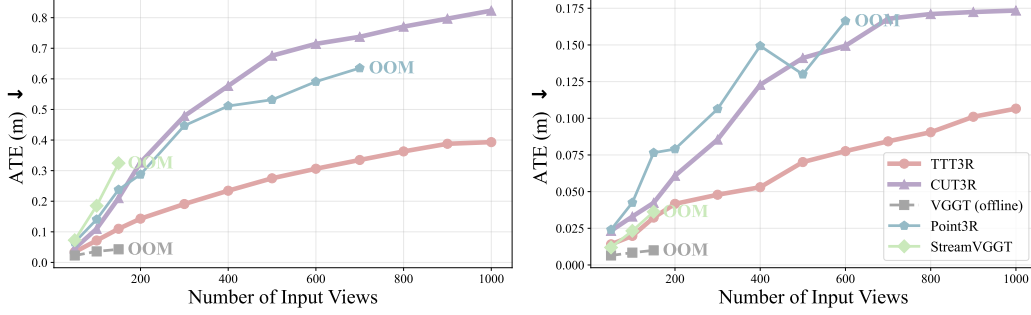

Figure 6: **Comparison of Camera Pose Estimation.** Results on ScanNet [19] (left) and TUM-D [64] (right). *OOM* denotes the method out-of-memory beyond this point.

ing images. We also evaluate against Point3R [87] and StreamVGGT [97], which extend CUT3R and VGGT [79], respectively, to longer sequences by fine-tuning with explicit pointmap memory or KV-cache-based state representations. In contrast, our approach introduces a general sequence modeling framework and an adaptive state learning rate, enabling a training-free solution. In the following experiments, we compare these methods in terms of reconstruction accuracy, GPU memory usage, and inference speed. See Sec. B.1 and Sec. B.2 of *Sup.Mat.* for more details.

4.1 CAMERA POSE ESTIMATION

Following prior works [81, 94], we evaluate camera pose accuracy on TUM dynamics [64] and ScanNet [19] datasets. We adopt the standard metric, Absolute Translation Error (ATE), computed after applying Sim(3) alignment [73] between the estimated and ground-truth camera trajectories.

The results of the long-sequence evaluation are shown in Figure 6. For reference, we also include VGGT, an offline method that can be considered as an upper bound for online methods, since its full attention mechanism preserves the entire history context without forgetting. We further evaluate inference efficiency in Figure 7 and Figure 2, reporting two metrics: frames per second (FPS) and peak GPU memory usage (GB). All models are evaluated on a single 48GB NVIDIA GPU, with the number of input views varied from 50 to 1000 and early termination if out-of-memory occurs.

As expected, VGGT and StreamVGGT, both based on full attention, are relatively slow and prone to memory exhaustion. CUT3R, in contrast, maintains consistently low GPU usage and real-time inference but struggles to retain information over long sequences, leading to inaccurate pose estimation. Point3R achieves improved accuracy over CUT3R by trading off GPU usage and runtime, but inference is slow and memory runs out beyond 700 frames. By reformulating CUT3R, our method achieves accurate pose estimation (with a $2\times$ improvement) while preserving the same inference speed and memory efficiency as CUT3R.

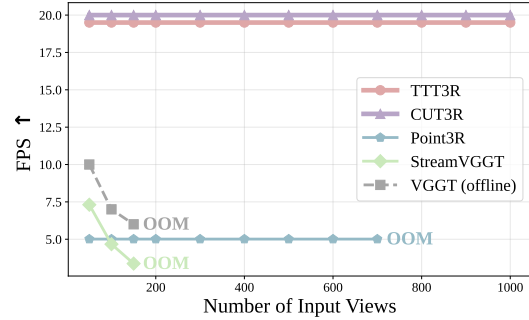
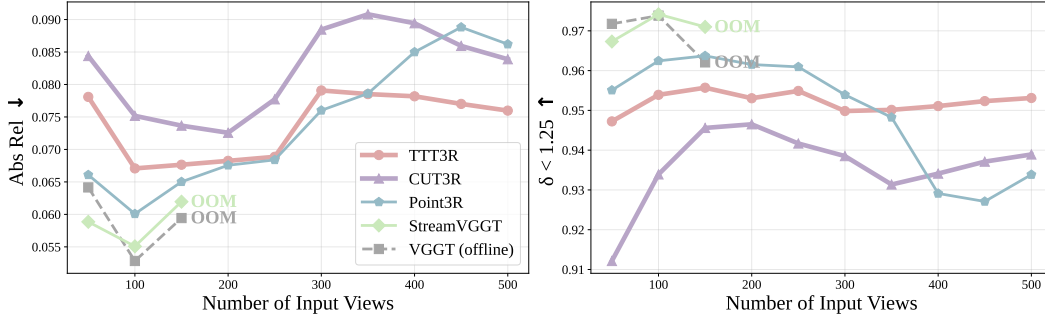

Figure 7: **Runtime** comparison on ScanNet [19]. *OOM* denotes the method out-of-memory beyond this point.

Please refer to Sec. B.3 in *Sup.Mat.* for qualitative comparisons of camera trajectory estimation.

4.2 VIDEO DEPTH ESTIMATION

Following common practice [81, 94], we evaluate video depth estimation on the KITTI [31] and Bonn [48] datasets, which cover dynamic/static as well as indoor/outdoor scenes. We adopt standard metrics: absolute relative error (Abs Rel) and $\delta < 1.25$ (percentage of predicted depths within a 1.25-factor of true depth). Video depth estimation measures both per-frame quality and inter-frame consistency, by aligning predicted depth maps to ground truth with a per-sequence scale, thereby evaluating relative depth accuracy. For methods that predict metric pointmaps (i.e., outputs in meters with absolute scale), we also report results without scale alignment, evaluating predictions directly in metric units to assess absolute-scale accuracy.



(a) Scale-invariant relative depth evaluation on Bonn [48] dataset.

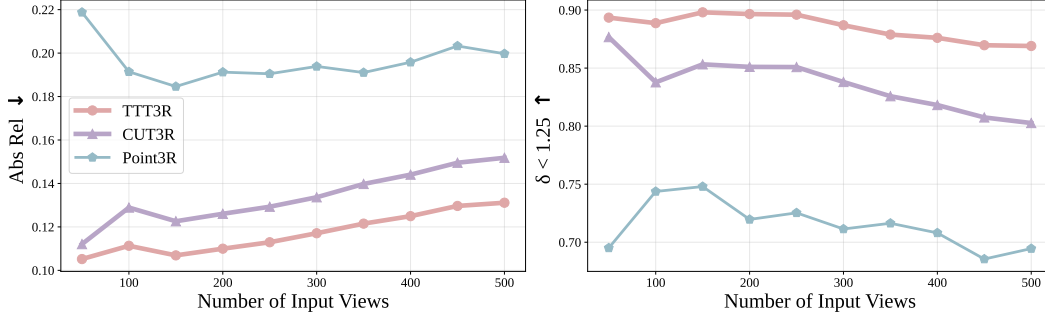

(b) Metric depth evaluation on KITTI [31], excluding VGGT-based methods that don't support metric depth.

Figure 8: Comparison of Video Depth Estimation. OOM denotes out-of-memory beyond this point.

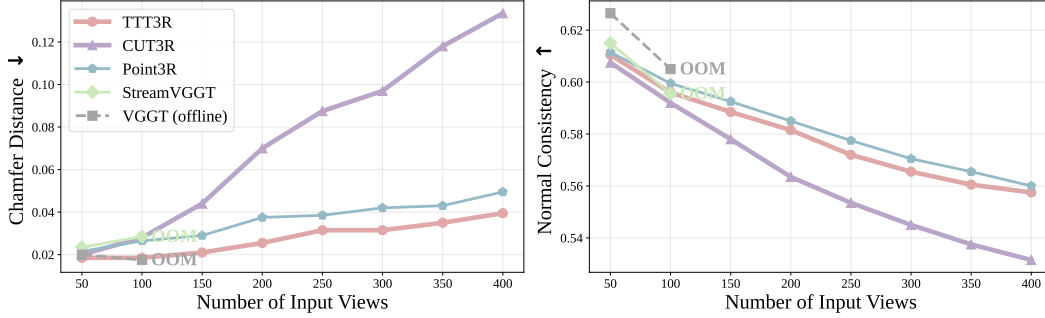

Figure 9: Comparison of 3D Reconstruction on 7-scene [61].

Figure 8 shows quantitative comparison against online baselines. VGGT and StreamVGGT run out of memory after about 150 frames due to their reliance on full attention. Nonetheless, they serve as an upper bound in per-sequence relative depth evaluation. For metric depth estimation, we report only CUT3R, Point3R, and TTT3R, as these are the only online methods predicting metric pointmaps.

Point3R achieves strong scale-invariant accuracy on short sequences (≤ 300 frames) due to its explicit pointmap memory, but suffers from forgetting and degraded metric-scale accuracy on longer sequences. In contrast, our approach consistently improves over baselines and achieves the best overall performance, without the need of fine-tuning. See Sec. B.4 of *Sup.Mat.* for more results.

4.3 3D RECONSTRUCTION

We follow previous work [77, 81] to evaluate 3D reconstruction on the 7-scene [61] dataset by measuring the distances between estimated pointmaps and ground-truth point clouds. As in prior work [17, 77, 81], we use chamfer distance and normal consistency as evaluation metrics. Chamfer distance is computed as the average of accuracy (nearest Euclidean distance from a reconstructed point to ground truth) and completeness (the reverse). Unlike prior approaches [77, 81], which sparsely sample 3–5 frames per scene, we evaluate performance on long image sequences to assess the memorization capability of different models.

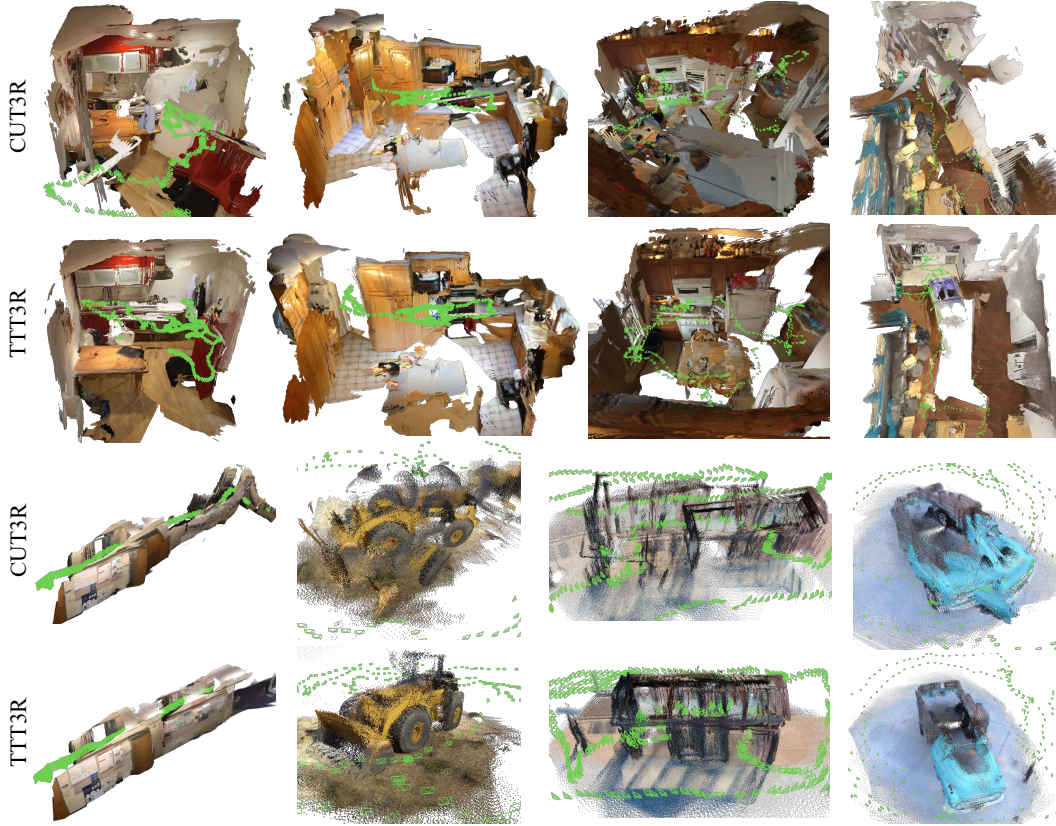

Figure 10: **Qualitative Results for 3D Reconstruction.** Compared to CUT3R, TTT3R improves sequence length generalization, mitigates forgetting, and enables online loop closure. Other baselines (e.g., VGGT, Point3R) are omitted due to OOM on long sequences. ▶ Check our [website](#) to see more video comparisons.

Figure 9 shows that our method significantly outperforms other online approaches such as CUT3R [81] and StreamVGGT [97], and achieves results comparable to the top offline, full-attention method VGGT, while operating online in real-time with only 6GB GPU memory. This highlights the effectiveness of our method for 3D reconstruction. Figure 10 presents a qualitative comparison with CUT3R. TTT3R achieves more accurate reconstructions, whereas CUT3R suffers from catastrophic forgetting, leading to drifted camera poses, broken geometry, severe distortions, and ghosting artifacts. For more 3D reconstruction results, please refer to Sec. B.5 in *Sup.Mat.*

5 DISCUSSION

This paper presents TTT3R, providing a Test-Time Training perspective for recent 3D reconstruction foundation models, and proposes a simple yet efficient modification to CUT3R that enhances its length generalization. Our experiments demonstrate that TTT3R achieves robust long-sequence 3D reconstruction and outperforms state-of-the-art methods in most cases. The update is performed during the forward pass without model fine-tuning, making it a lightweight, plug-and-play solution.

Limitations. TTT3R mitigates but does not resolve state forgetting, and it has not yet matched strong offline methods (e.g., VGGT) in reconstruction accuracy, where full attention - despite being slower and more memory-demanding - preserves the entire history context. While TTT3R shows a clear boost of test-time regression for associative recall, its design space remains largely unexplored. Recent work [6, 7, 80, 95] highlights a vast opportunity to develop more effective, stable, and parallelizable recurrent architectures. We hope our findings will motivate future research to revisit the foundations of 3D reconstruction models and further improve the reconstruction accuracy and length generalization.

Acknowledgments. We thank the members of *Inception3D* and *Endless AI* Labs for their help. *Xingyu Chen* and *Yue Chen* are funded by the Westlake Education Foundation. *Xingyu Chen* is also supported by the Natural Science Foundation of Zhejiang province, China (No. QKWL25F0301). *Andreas Geiger* are supported by the ERC Starting Grant LEGO-3D (850533) and DFG EXC number 2064/1 - project number 390727645.

REFERENCES

- [1] Sameer Agarwal, Noah Snavely, Steven M Seitz, and Richard Szeliski. Bundle adjustment in the large. In *ECCV*, 2010. 3
- [2] Sameer Agarwal, Yasutaka Furukawa, Noah Snavely, Ian Simon, Brian Curless, Steven M Seitz, and Richard Szeliski. Building rome in a day. *ACM Communications*, 2011. 3
- [3] Honggyu An, Jinhyeon Kim, Seonghoon Park, Jaewoo Jung, Jisang Han, Sunghwan Hong, and Seungryong Kim. Cross-view completion models are zero-shot correspondence estimators. *arXiv*, 2412.09072, 2024. 3
- [4] Herbert Bay, Andreas Ess, Tinne Tuytelaars, and Luc Van Gool. Speeded-up robust features (surf). *Computer vision and image understanding*, 2008. 3
- [5] Maximilian Beck, Korbinian Pöppel, Markus Spanring, Andreas Auer, Oleksandra Prudnikova, Michael Kopp, Günter Klambauer, Johannes Brandstetter, and Sepp Hochreiter. xlstm: Extended long short-term memory. In *NeurIPS*, 2024. 2, 4
- [6] Ali Behrouz, Peilin Zhong, and Vahab Mirrokni. Titans: Learning to memorize at test time. *arXiv preprint arXiv:2501.00663*, 2024. 2, 4, 9
- [7] Ali Behrouz, Meisam Razaviyayn, Peilin Zhong, and Vahab Mirrokni. It’s all connected: A journey through test-time memorization, attentional bias, retention, and online optimization. *arXiv preprint arXiv:2504.13173*, 2025. 2, 4, 9
- [8] Assaf Ben-Kish, Itamar Zimmerman, Shady Abu-Hussein, Nadav Cohen, Amir Globerson, Lior Wolf, and Raja Giryes. Decimamba: Exploring the length extrapolation potential of mamba. *arXiv preprint arXiv:2406.14528*, 2024. 2
- [9] Alberto Bietti, Vivien Cabannes, Diane Bouchacourt, Herve Jegou, and Leon Bottou. Birth of a transformer: A memory viewpoint. In *NeurIPS*, 2023. 2, 4
- [10] Eric Brachmann, Alexander Krull, Sebastian Nowozin, Jamie Shotton, Frank Michel, Stefan Gumhold, and Carsten Rother. Dsac-differentiable ransac for camera localization. In *CVPR*, 2017. 1, 3
- [11] Eric Brachmann, Jamie Wynn, Shuai Chen, Tommaso Cavallari, Áron Monszpart, Daniyar Turmukhambetov, and Victor Adrian Prisacariu. Scene coordinate reconstruction: Posing of image collections via incremental learning of a relocalizer. In *ECCV*, 2024. 1, 3
- [12] Daniel J Butler, Jonas Wulff, Garrett B Stanley, and Michael J Black. A naturalistic open source movie for optical flow evaluation. In *ECCV*, 2012. 19, 20, 21
- [13] Yohann Cabon, Lucas Stofl, Leonid Antsfeld, Gabriela Csurka, Boris Chidlovskii, Jerome Revaud, and Vincent Leroy. Must3r: Multi-view network for stereo 3d reconstruction. In *CVPR*, 2025. 3, 5
- [14] Mathilde Caron, Hugo Touvron, Ishan Misra, Hervé Jégou, Julien Mairal, Piotr Bojanowski, and Armand Joulin. Emerging properties in self-supervised vision transformers. In *ICCV*, 2021. 4
- [15] Xingyu Chen, Yue Chen, Yuliang Xiu, Andreas Geiger, and Anpei Chen. Easi3r: Estimating disentangled motion from dust3r without training. *arXiv preprint arXiv:2503.24391*, 2025. 3, 6, 17, 19, 21
- [16] Yingfa Chen, Xinrong Zhang, Shengding Hu, Xu Han, Zhiyuan Liu, and Maosong Sun. Stuffed mamba: Oversized states lead to the inability to forget. *arXiv preprint arXiv:2410.07145*, 2024. 2
- [17] Yue Chen, Xingyu Chen, Anpei Chen, Gerard Pons-Moll, and Yuliang Xiu. Feat2gs: Probing visual foundation models with gaussian splatting. *arXiv*, 2412.09606, 2024. 8
- [18] Zhuoguang Chen, Minghui Qin, Tianyuan Yuan, Zhe Liu, and Hang Zhao. Long3r: Long sequence streaming 3d reconstruction. *arXiv preprint arXiv:2507.18255*, 2025. 3, 5

- [19] Angela Dai, Angel X Chang, Manolis Savva, Maciej Halber, Thomas Funkhouser, and Matthias Nießner. Scannet: Richly-annotated 3d reconstructions of indoor scenes. In *CVPR*, 2017. 7, 19, 20
- [20] Tri Dao and Albert Gu. Transformers are ssms: Generalized models and efficient algorithms through structured state space duality. *arXiv preprint arXiv:2405.21060*, 2024. 4, 5
- [21] Tri Dao, Dan Fu, Stefano Ermon, Atri Rudra, and Christopher Ré. Flashattention: Fast and memory-efficient exact attention with io-awareness. In *NeurIPS*, 2022. 1
- [22] Andrew J Davison, Ian D Reid, Nicholas D Molton, and Olivier Stasse. Monoslam: Real-time single camera slam. *PAMI*, 2007. 3
- [23] Daniel DeTone, Tomasz Malisiewicz, and Andrew Rabinovich. Superpoint: Self-supervised interest point detection and description. In *CVPRW*, 2018. 3
- [24] Benoit Dherin, Michael Munn, Hanna Mazzawi, Michael Wunder, and Javier Gonzalvo. Learning without training: The implicit dynamics of in-context learning. *arXiv preprint arXiv:2507.16003*, 2025. 4
- [25] Siyan Dong, Shuzhe Wang, Shaohui Liu, Lulu Cai, Qingnan Fan, Juho Kannala, and Yanchao Yang. Reloc3r: Large-scale training of relative camera pose regression for generalizable, fast, and accurate visual localization. *arXiv*, 2412.08376, 2024. 3
- [26] Alexey Dosovitskiy, Lucas Beyer, Alexander Kolesnikov, Dirk Weissenborn, Xiaohua Zhai, Thomas Unterthiner, Mostafa Dehghani, Matthias Minderer, Georg Heigold, Sylvain Gelly, et al. An image is worth 16x16 words: Transformers for image recognition at scale. *arXiv preprint arXiv:2010.11929*, 2020. 3, 4
- [27] Jakob Engel, Thomas Schöps, and Daniel Cremers. Lsd-slam: Large-scale direct monocular slam. In *ECCV*, 2014. 3
- [28] Jakob Engel, Vladlen Koltun, and Daniel Cremers. Direct sparse odometry. *PAMI*, 2017. 3
- [29] Chelsea Finn, Pieter Abbeel, and Sergey Levine. Model-agnostic meta-learning for fast adaptation of deep networks. In *ICML*, 2017. 4
- [30] Yichao Fu, Xuwei Wang, Yuandong Tian, and Jiawei Zhao. Deep think with confidence. *arXiv preprint arXiv:2508.15260*, 2025. 6
- [31] Andreas Geiger, Philip Lenz, Christoph Stiller, and Raquel Urtasun. Vision meets robotics: The kitti dataset. *The international journal of robotics research*, 2013. 7, 8, 20, 21
- [32] Albert Gu and Tri Dao. Mamba: Linear-time sequence modeling with selective state spaces. *arXiv preprint arXiv:2312.00752*, 2023. 2, 4
- [33] Samy Jelassi, David Brandfonbrener, Sham M Kakade, and Eran Malach. Repeat after me: Transformers are better than state space models at copying. *arXiv preprint arXiv:2402.01032*, 2024. 2
- [34] Angelos Katharopoulos, Apoorv Vyas, Nikolaos Pappas, and François Fleuret. Transformers are rnns: Fast autoregressive transformers with linear attention. In *ICML*, 2020. 2, 3
- [35] James Kirkpatrick, Razvan Pascanu, Neil Rabinowitz, Joel Veness, Guillaume Desjardins, Andrei A Rusu, Kieran Milan, John Quan, Tiago Ramalho, Agnieszka Grabska-Barwinska, et al. Overcoming catastrophic forgetting in neural networks. *Proceedings of the national academy of sciences*, 2017. 2
- [36] Johannes Kopf, Xuejian Rong, and Jia-Bin Huang. Robust consistent video depth estimation. In *CVPR*, 2021. 3, 19, 20
- [37] Vincent Lepetit, Francesc Moreno-Noguer, and Pascal Fua. Epnnp: An accurate o(n) solution to the pnp problem. In *ICCV*, 2009. 4

- [38] Vincent Leroy, Yohann Cabon, and Jerome Revaud. Grounding image matching in 3d with MAST3R. In *ECCV*, 2024. 17, 19, 21
- [39] Zhengqi Li, Richard Tucker, Forrester Cole, Qianqian Wang, Linyi Jin, Vickie Ye, Angjoo Kanazawa, Aleksander Holynski, and Noah Snavely. MegaSaM: accurate, fast, and robust structure and motion from casual dynamic videos. In *CVPR*, 2025. 3
- [40] Aixin Liu, Bei Feng, Bin Wang, Bingxuan Wang, Bo Liu, Chenggang Zhao, Chengqi Deng, Chong Ruan, Damai Dai, Daya Guo, et al. Deepseek-v2: A strong, economical, and efficient mixture-of-experts language model. *arXiv preprint arXiv:2405.04434*, 2024. 1
- [41] Bo Liu, Rui Wang, Lemeng Wu, Yihao Feng, Peter Stone, and Qiang Liu. Longhorn: State space models are amortized online learners. *arXiv preprint arXiv:2407.14207*, 2024. 1, 2, 4
- [42] Thibaut Loiseau, Guillaume Bourmaud, and Vincent Lepetit. AlligatOr: Pre-training through co-visibility segmentation for relative camera pose regression. *arXiv preprint arXiv:2503.07561*, 2025. 3
- [43] David G Lowe. Distinctive image features from scale-invariant keypoints. *International journal of computer vision*, 2004. 3
- [44] Raul Mur-Artal, Jose Maria Martinez Montiel, and Juan D Tardos. Orb-slam: a versatile and accurate monocular slam system. *IEEE transactions on robotics*, 2015. 3
- [45] Richard A Newcombe, Steven J Lovegrove, and Andrew J Davison. Dtam: Dense tracking and mapping in real-time. In *ICCV*, 2011. 3
- [46] Maxime Oquab, Timothée Darcet, Théo Moutakanni, Huy Vo, Marc Szafraniec, Vasil Khalidov, Pierre Fernandez, Daniel Haziza, Francisco Massa, Alaaeldin El-Nouby, et al. Dinov2: Learning robust visual features without supervision. *arXiv preprint arXiv:2304.07193*, 2023. 4
- [47] Antonio Orvieto, Samuel L Smith, Albert Gu, Anushan Fernando, Caglar Gulcehre, Razvan Pascanu, and Soham De. Resurrecting recurrent neural networks for long sequences. In *ICML*, 2023. 4
- [48] Emanuele Palazzolo, Jens Behley, Philipp Lottes, Philippe Giguere, and Cyrill Stachniss. Refusion: 3d reconstruction in dynamic environments for rgb-d cameras exploiting residuals. In *IROS*, 2019. 7, 8, 20, 21
- [49] Frank Plasteria. The weiszfeld algorithm: proof, amendments, and extensions. *Foundations of location analysis*, 2011. 4
- [50] Marc Pollefeys, Reinhard Koch, and Luc Van Gool. Self-calibration and metric reconstruction inspite of varying and unknown intrinsic camera parameters. *International Journal of Computer Vision*, 1999. 3
- [51] Marc Pollefeys, Luc Van Gool, Maarten Vergauwen, Frank Verbiest, Kurt Cornelis, Jan Tops, and Reinhard Koch. Visual modeling with a hand-held camera. *International Journal of Computer Vision*, 2004. 3
- [52] Zihan Qiu, Zekun Wang, Bo Zheng, Zeyu Huang, Kaiyue Wen, Songlin Yang, Rui Men, Le Yu, Fei Huang, Suozhi Huang, et al. Gated attention for large language models: Non-linearity, sparsity, and attention-sink-free. *arXiv preprint arXiv:2505.06708*, 2025. 6
- [53] Hubert Ramsauer, Bernhard Schöfl, Johannes Lehner, Philipp Seidl, Michael Widrich, Thomas Adler, Lukas Gruber, Markus Holzleitner, Milena Pavlović, Geir Kjetil Sandve, et al. Hopfield networks is all you need. *arXiv preprint arXiv:2008.02217*, 2020. 2, 4
- [54] René Ranftl, Alexey Bochkovskiy, and Vladlen Koltun. Vision transformers for dense prediction. In *ICCV*, 2021. 4
- [55] Ricardo Buitrago Ruiz and Albert Gu. Understanding and improving length generalization in recurrent models. *arXiv preprint arXiv:2507.02782*, 2025. 2, 17

- [56] Paul-Edouard Sarlin, Daniel DeTone, Tomasz Malisiewicz, and Andrew Rabinovich. Superglue: Learning feature matching with graph neural networks. In *CVPR*, 2020. 3
- [57] Imanol Schlag, Kazuki Irie, and Jürgen Schmidhuber. Linear transformers are secretly fast weight programmers. In *ICML*, 2021. 2, 3, 4, 5
- [58] Jürgen Schmidhuber. Learning to control fast-weight memories: An alternative to dynamic recurrent networks. *Neural Computation*, 1992. 2, 4, 5
- [59] Johannes Lutz Schönberger and Jan-Michael Frahm. Structure-from-motion revisited. In *CVPR*, 2016. 3
- [60] Wenzhe Shi, Jose Caballero, Ferenc Huszár, Johannes Totz, Andrew P Aitken, Rob Bishop, Daniel Rueckert, and Zehan Wang. Real-time single image and video super-resolution using an efficient sub-pixel convolutional neural network. In *CVPR*, 2016. 4
- [61] Jamie Shotton, Ben Glocker, Christopher Zach, Shahram Izadi, Antonio Criminisi, and Andrew Fitzgibbon. Scene coordinate regression forests for camera relocalization in RGB-D images. In *CVPR*, 2013. 3, 8
- [62] Noah Snavely, Steven M Seitz, and Richard Szeliski. Photo tourism: exploring photo collections in 3d. In *SIGGRAPH*, 2006. 3
- [63] Noah Snavely, Steven M Seitz, and Richard Szeliski. Modeling the world from internet photo collections. *International journal of computer vision*, 2008. 3
- [64] Jürgen Sturm, Nikolas Engelhard, Felix Endres, Wolfram Burgard, and Daniel Cremers. A benchmark for the evaluation of rgb-d slam systems. In *2012 IEEE/RSJ international conference on intelligent robots and systems*, 2012. 7, 19, 20
- [65] Yu Sun, Xinhao Li, Karan Dalal, Jiarui Xu, Arjun Vikram, Genghan Zhang, Yann Dubois, Xinlei Chen, Xiaolong Wang, Sanmi Koyejo, et al. Learning to (learn at test time): Rnns with expressive hidden states. *arXiv preprint arXiv:2407.04620*, 2024. 2, 4, 5
- [66] Yutao Sun, Li Dong, Shaohan Huang, Shuming Ma, Yuqing Xia, Jilong Xue, Jianyong Wang, and Furu Wei. Retentive network: A successor to transformer for large language models. *arXiv preprint arXiv:2307.08621*, 2023. 2, 4, 5
- [67] Ilya Sutskever. *Training recurrent neural networks*. PhD thesis, University of Toronto, 2013. 2
- [68] Ilya Sutskever, Oriol Vinyals, and Quoc V Le. Sequence to sequence learning with neural networks. In *NeurIPS*, 2014. 1
- [69] Chengzhou Tang and Ping Tan. Ba-net: Dense bundle adjustment network. *arXiv preprint arXiv:1806.04807*, 2018. 3
- [70] Aether Team, Haoyi Zhu, Yifan Wang, Jianjun Zhou, Wenzheng Chang, Yang Zhou, Zizun Li, Junyi Chen, Chunhua Shen, Jiangmiao Pang, et al. Aether: Geometric-aware unified world modeling. *arXiv preprint arXiv:2503.18945*, 2025. 17, 19, 21
- [71] Zachary Teed and Jia Deng. Droid-slam: Deep visual slam for monocular, stereo, and rgb-d cameras. In *NeurIPS*, 2021. 3
- [72] Bill Triggs, Philip F McLauchlan, Richard I Hartley, and Andrew W Fitzgibbon. Bundle adjustment—a modern synthesis. In *Vision Algorithms: Theory and Practice: International Workshop on Vision Algorithms Corfu, Greece*, 2000. 3
- [73] Shinji Umeyama. Least-squares estimation of transformation parameters between two point patterns. *PAMI*, 1991. 7, 20
- [74] Ashish Vaswani, Noam Shazeer, Niki Parmar, Jakob Uszkoreit, Llion Jones, Aidan N Gomez, Łukasz Kaiser, and Illia Polosukhin. Attention is all you need. In *NeurIPS*, 2017. 1, 3

- [75] Johannes Von Oswald, Eyvind Niklasson, Ettore Randazzo, João Sacramento, Alexander Mordvintsev, Andrey Zhmoginov, and Max Vladymyrov. Transformers learn in-context by gradient descent. In *ICML*, 2023. 4
- [76] Roger Waleffe, Wonmin Byeon, Duncan Riach, Brandon Norick, Vijay Korthikanti, Tri Dao, Albert Gu, Ali Hatamizadeh, Sudhakar Singh, Deepak Narayanan, et al. An empirical study of mamba-based language models. *arXiv preprint arXiv:2406.07887*, 2024. 2
- [77] Hengyi Wang and Lourdes Agapito. 3d reconstruction with spatial memory. *arXiv*, 2408.16061, 2024. 3, 5, 8, 18, 19, 21
- [78] Jianyuan Wang, Nikita Karaev, Christian Rupprecht, and David Novotny. Vggsfm: Visual geometry grounded deep structure from motion. In *CVPR*, 2024. 3, 4
- [79] Jianyuan Wang, Minghao Chen, Nikita Karaev, Andrea Vedaldi, Christian Rupprecht, and David Novotny. Vggt: Visual geometry grounded transformer. In *CVPR*, 2025. 1, 2, 3, 4, 7, 17, 19, 21
- [80] Ke Alexander Wang, Jiaxin Shi, and Emily B Fox. Test-time regression: a unifying framework for designing sequence models with associative memory. *arXiv preprint arXiv:2501.12352*, 2025. 2, 4, 5, 9
- [81] Qianqian Wang, Yifei Zhang, Aleksander Holynski, Alexei A. Efros, and Angjoo Kanazawa. Continuous 3d perception model with persistent state. In *CVPR*, 2025. 1, 2, 3, 5, 6, 7, 8, 9, 18, 19, 20, 21
- [82] Shida Wang. Longssm: On the length extension of state-space models in language modelling. *arXiv preprint arXiv:2406.02080*, 2024. 2
- [83] Shuzhe Wang, Vincent Leroy, Yohann Cabon, Boris Chidlovskii, and Jerome Revaud. DUS3R: geometric 3d vision made easy. In *CVPR*, 2024. 1, 3, 6, 17, 19, 21
- [84] Philippe Weinzaepfel, Vincent Leroy, Thomas Lucas, Romain Brégier, Yohann Cabon, Vaibhav Arora, Leonid Antsfeld, Boris Chidlovskii, Gabriela Csurka, and Jérôme Revaud. Croco: Self-supervised pre-training for 3d vision tasks by cross-view completion. In *NeurIPS*, 2022. 4
- [85] Philippe Weinzaepfel, Thomas Lucas, Vincent Leroy, Yohann Cabon, Vaibhav Arora, Romain Brégier, Gabriela Csurka, Leonid Antsfeld, Boris Chidlovskii, and Jérôme Revaud. Croco v2: Improved cross-view completion pre-training for stereo matching and optical flow. In *ICCV*, 2023. 4
- [86] Ronald J Williams and Jing Peng. An efficient gradient-based algorithm for on-line training of recurrent network trajectories. *Neural computation*, 1990. 2
- [87] Yuqi Wu, Wenzhao Zheng, Jie Zhou, and Jiwen Lu. Point3r: Streaming 3d reconstruction with explicit spatial pointer memory. *arXiv preprint arXiv:2507.02863*, 2025. 2, 3, 5, 7, 18, 19, 21
- [88] Jianing Yang, Alexander Sax, Kevin J. Liang, Mikael Henaff, Hao Tang, Ang Cao, Joyce Chai, Franziska Meier, and Matt Feiszli. Fast3r: Towards 3d reconstruction of 1000+ images in one forward pass. In *CVPR*, 2025. 3, 4
- [89] Songlin Yang, Bailin Wang, Yikang Shen, Rameswar Panda, and Yoon Kim. Gated linear attention transformers with hardware-efficient training. *arXiv preprint arXiv:2312.06635*, 2023. 2, 4, 5
- [90] Songlin Yang, Bailin Wang, Yu Zhang, Yikang Shen, and Yoon Kim. Parallelizing linear transformers with the delta rule over sequence length. In *NeurIPS*, 2024. 4, 5
- [91] Zhifan Ye, Kejing Xia, Yonggan Fu, Xin Dong, Jihoon Hong, Xiangchi Yuan, Shizhe Diao, Jan Kautz, Pavlo Molchanov, and Yingyan Celine Lin. Longmamba: Enhancing mamba’s long context capabilities via training-free receptive field enlargement. *arXiv preprint arXiv:2504.16053*, 2025. 2
- [92] Yuheng Yuan, Qiuhong Shen, Shizun Wang, Xingyi Yang, and Xinchao Wang. Test3r: Learning to reconstruct 3d at test time, 2025. URL <https://arxiv.org/abs/2506.13750>. 2

- [93] Jiahui Zhang, Yuelei Li, Anpei Chen, Muyu Xu, Kunhao Liu, Jianyuan Wang, Xiao-Xiao Long, Hanxue Liang, Zexiang Xu, Hao Su, et al. Advances in feed-forward 3d reconstruction and view synthesis: A survey. *arXiv preprint arXiv:2507.14501*, 2025. 1
- [94] Junyi Zhang, Charles Herrmann, Junhwa Hur, Varun Jampani, Trevor Darrell, Forrester Cole, Deqing Sun, and Ming-Hsuan Yang. MonST3R: a simple approach for estimating geometry in the presence of motion. In *ICLR*, 2025. 3, 7, 17, 19, 20, 21
- [95] Tianyuan Zhang, Sai Bi, Yicong Hong, Kai Zhang, Fujun Luan, Songlin Yang, Kalyan Sunkavalli, William T Freeman, and Hao Tan. Test-time training done right. *arXiv preprint arXiv:2505.23884*, 2025. 4, 9
- [96] Zhoutong Zhang, Forrester Cole, Zhengqi Li, Noah Snavely, Michael Rubinstein, and William T. Freeman. Structure and motion from casual videos. In *ECCV*, 2022. 3, 19, 20
- [97] Dong Zhuo, Wenzhao Zheng, Jiahe Guo, Yuqi Wu, Jie Zhou, and Jiwen Lu. Streaming 4d visual geometry transformer. *arXiv preprint arXiv:2507.11539*, 2025. 2, 3, 5, 7, 9, 18, 19, 21

Appendix

Table of Contents

A State Reset	17
B More Results	17
B.1 Experimental Settings	17
B.2 Baselines	17
B.3 Camera Pose Estimation	20
B.4 Video Depth Estimation	20
B.5 3D Reconstruction	21
C Use of Large Language Models	22

A STATE RESET

As discussed in the limitation subsection (Sec. 5), TTT3R only mitigates but does not fully resolve state forgetting, resulting in failure beyond 1000 frames (as shown in Fig. 11, middle). This observation is consistent with the unexplored states hypothesis [55], which posits that models fail to generalize to longer sequences when their recurrence, applied to extended sequences, produces state distributions not encountered during training—suggesting that these models overfit to states produced early in the sequence when trained on short contexts. Based on this hypothesis, we incorporate a State Reset mechanism: the state is reset to its initial value every 100 frames, thereby preventing state overfitting (as shown in Fig. 11, right). The resulting chunks are then aligned using the global metric camera poses without any optimization, making TTT3R + State Reset a plug-and-play solution that preserves CUT3R’s inference speed and memory footprint.

Note that, for fair comparison, we **do not** employ State Reset in any quantitative experiments or analyses. The State Reset is only used for visualization demonstrations that exceed 1000 frames. Specifically, State Reset is applied in Fig. 1 to visualize the final outcome and in Fig. 12, where we also augment CUT3R with State Reset to provide an intuitive comparison.

B MORE RESULTS

B.1 EXPERIMENTAL SETTINGS

We present two experimental settings: (1) long sequence evaluation, to compare TTT3R with online methods that could handle hundreds of images, which is a challenging setting by measuring the state capability to memorize entire sequences, rather than short video clips; and (2) short sequence evaluation, to compare the performance of our method to a wide range of baselines (since these baselines, hindered by out-of-memory, are infeasible to handle long sequences). Please refer to the main paper for the long-sequence results. We report the short-sequence evaluation here in the supplement.

B.2 BASELINES

We first compare TTT3R with pairwise 3D reconstruction foundation models, including DUST3R [83], MAST3R [38], MonST3R [94], and Easi3R [15], which takes a pair of views as input and requires an extra global alignment stage to consolidate the pairwise predictions. We also compare with AETHER [70] and VGGT [79], which could predict all pointmaps simultaneously, without the need for post-processing, leading to state-of-the-art 3D point and camera pose reconstruction. However,

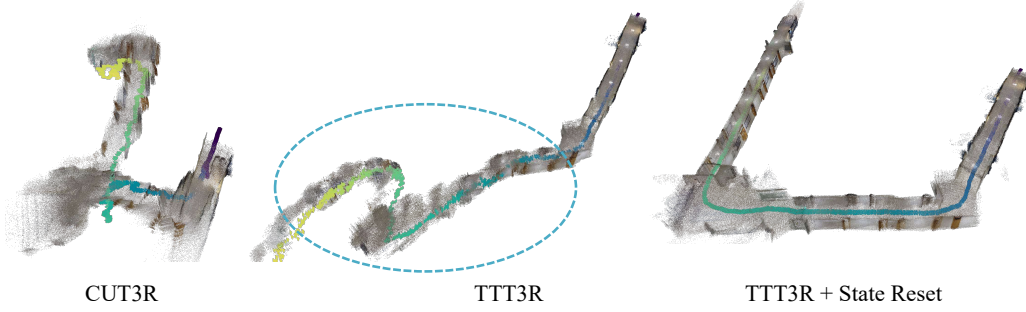

Figure 11: **State Reset for sequences beyond 1000 frames.** As discussed in the limitation subsection, TTT3R only mitigates but does not fully resolve state forgetting, resulting in failure beyond 1000 frames. For visualization demonstrations exceeding 1000 frames (Fig. 1 and Fig. 12), we further augment TTT3R with a State Reset mechanism: the state is reset every 100 frames, and the global metric camera pose is used as a cue to align the resulting chunks. Note that, for fair comparison, we **do not** employ State Reset in any quantitative experiments and analyses. State Reset is only applied in Fig. 1 to visualize the final outcome and in Fig. 12, where we also augment CUT3R with State Reset to provide an intuitive comparison.

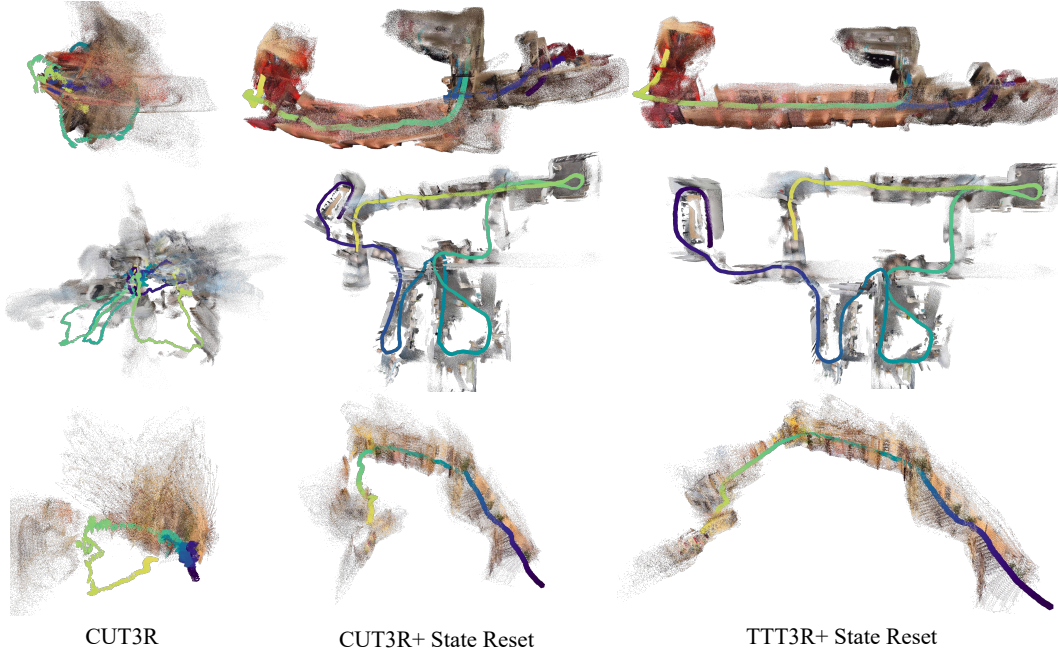

Figure 12: **In-the-wild Video Reconstruction - Sequences beyond 1000 frames.** While CUT3R + State Reset still suffers from drifting, TTT3R + State Reset enables robust long-sequence 3D reconstruction beyond 1000 frames. The TTT3R + State Reset is performed in the forward pass without any optimization, making it a plug-and-play solution that preserves CUT3R’s inference speed and memory footprint.

relying on global alignment or full attention limits all the aforementioned methods to handling only short image sequences, in an offline reconstruction manner, where it needs to rerun inference of all images whenever a new frame arrives. For online methods, we compare TTT3R with Spann3R [77] and CUT3R [81], which operates online with RNN-based architectures and could handle streaming images on the fly. For concurrent works that are most similar to our method, we compare TTT3R with Point3R [87] and StreamVGGT [97], which aim to extend CUT3R and VGGT to handle long image sequences, but take a different approach by fine-tuning CUT3R and VGGT with explicit pointmap memory and KV cache as state representation, respectively. Unlike these works, our method introduce sequence modeling as a general framework and reformulate CUT3R from the Test-Time Training (TTT) perspective. As a result, TTT3R achieves online associative recall by deriving a closed-form update rule, without requiring fine-tuning CUT3R or training extra parameterized components.

Method	Online	Sintel (50 frames)			TUM-dynamics (90 frames)			ScanNet (90 frames)		
		ATE ↓	RPE trans ↓	RPE rot ↓	ATE ↓	RPE trans ↓	RPE rot ↓	ATE ↓	RPE trans ↓	RPE rot ↓
Robust-CVD [36]	✗	0.360	0.154	3.443	0.153	0.026	3.528	0.227	0.064	7.374
CasualSAM [96]	✗	0.141	0.035	0.615	0.071	0.010	1.712	0.158	0.034	1.618
DUST3R [83]	✗	0.417	0.250	5.796	0.083	0.017	3.567	0.081	0.028	0.784
MASt3R [38]	✗	0.185	0.060	1.496	0.038	<u>0.012</u>	0.448	0.078	0.020	<u>0.475</u>
MonST3R [94]	✗	<u>0.111</u>	0.044	0.869	0.098	0.019	0.935	0.077	0.018	0.529
Easi3R [15]	✗	0.110	<u>0.042</u>	0.758	0.105	0.022	1.064	<u>0.061</u>	<u>0.017</u>	0.525
AETHER[70]	✗	0.189	0.054	0.694	0.092	<u>0.012</u>	1.106	0.176	0.028	1.204
VGGT [79]	✗	0.172	0.062	0.471	0.012	0.010	0.310	0.035	0.015	0.377
Spann3R [77]	✓	0.329	0.110	4.471	0.056	0.021	0.591	<u>0.096</u>	0.023	0.661
CUT3R [81]	✓	0.213	0.066	<u>0.621</u>	0.046	0.015	<u>0.473</u>	0.099	<u>0.022</u>	<u>0.600</u>
Point3R [87]	✓	0.351	0.128	1.822	0.075	0.029	0.642	0.106	0.035	1.946
StreamVGGT [97]	✓	0.251	0.149	1.894	0.061	0.033	3.209	0.161	0.057	3.647
TTT3R	✓	0.201	0.063	0.617	0.028	0.012	0.379	0.064	0.021	0.592

Table 1: **Evaluation on Camera Pose Estimation- Short Sequence** on Sintel [12], TUM-dynamic [64], and ScanNet [19] datasets. TTT3R achieves the best overall performance among online methods, while its accuracy has not yet matched strong offline methods (e.g., VGGT), where full attention - despite being slower and more memory-demanding - preserves the entire history context.

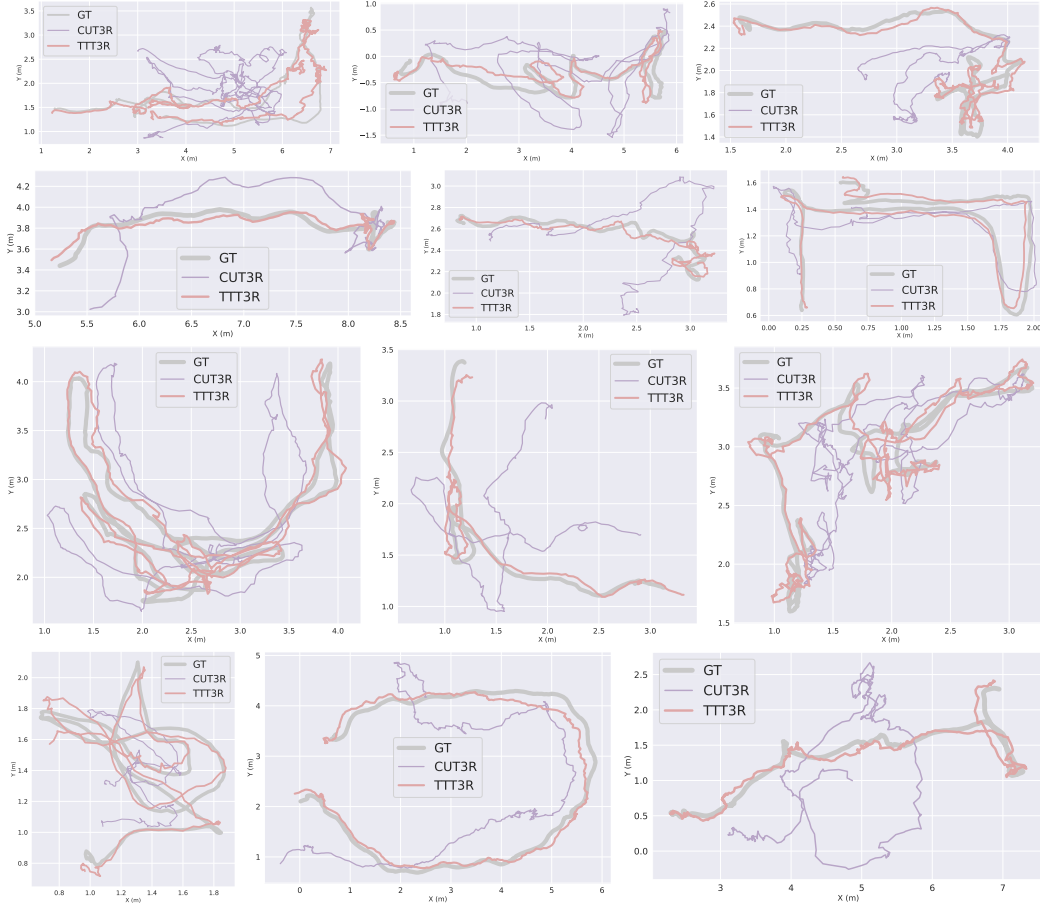

Figure 13: **Visualization of Estimated Camera Trajectories – Long Sequence.** The trajectories are plotted along the two axes with the highest variance to capture the most significant motion. Our estimated camera trajectory • TTT3R deviates less from the ground truth • GT compared to the baseline • CUT3R.

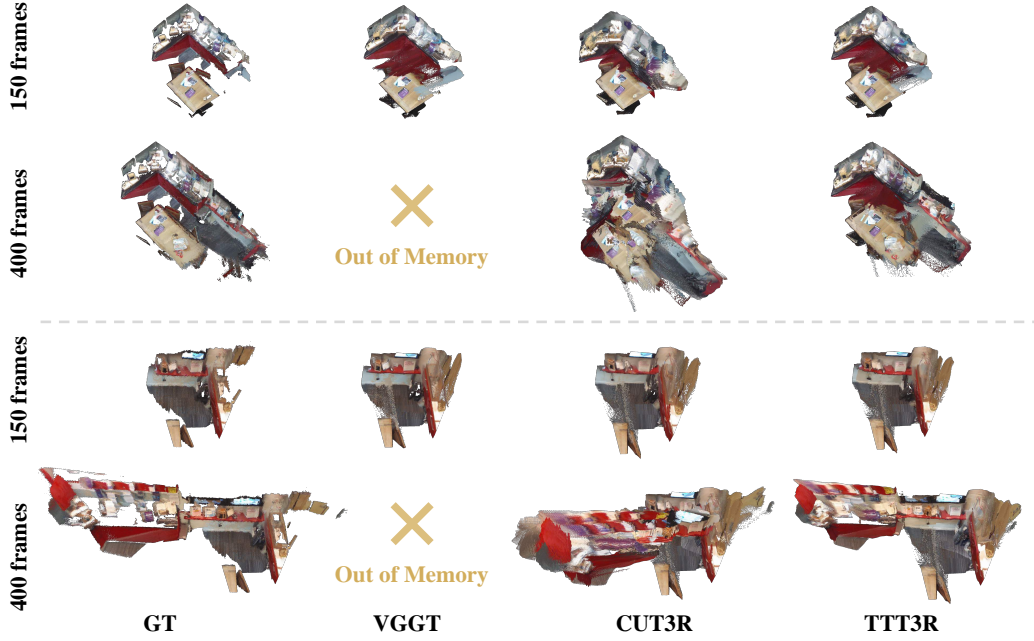

Figure 14: **Qualitative Results of 3D Reconstruction.** TTT3R improves length generalization over CUT3R while preserving its speed and memory efficiency. Offline methods (e.g., VGGT) achieve accurate reconstruction on short sequences (150 frames) but fail on longer sequences (400 frames) due to memory constraints.

B.3 CAMERA POSE ESTIMATION

Following prior works [81, 94], we evaluate camera pose estimation accuracy on Sintel [12], TUM dynamics [64], and ScanNet [19] datasets. We use standard error metrics: Absolute Translation Error (ATE), Relative Translation Error (RTE), and Relative Rotation Error (RRE), after applying the Sim(3) alignment [73] on the estimated camera trajectory to the ground truth. We compare with both 3D reconstruction foundation models and prior per-sequence optimize approaches, such as RobustCVD [36] and CasualSAM [96], which jointly optimize camera parameters and dense depth maps to fit each sequence.

The results of the long-sequence evaluation are presented in Figure 6. Since many baselines can only process short sequences due to out-of-memory, we also show the short sequence evaluation in Table 1, and separately highlight the leading approaches for methods that operate offline (i.e., require additional optimization or global attention) and those that do not (i.e., online). Although a gap persists between offline and online methods, our approach achieves the best overall performance among online methods, particularly in TUM-dynamics and ScanNet datasets.

We show qualitative comparisons of the estimation of the camera trajectory in Figure 13. TTT3R demonstrates a more accurate and robust camera pose estimation over CUT3R, effectively leveraging the inherent knowledge of the 3D reconstruction foundation model with just a few lines of plug-and-play code by proposing a general sequence modeling formulation and deriving novel state transition rule of CUT3R from a TTT perspective.

B.4 VIDEO DEPTH ESTIMATION

Following common practice [81, 94], we evaluate video depth estimation on KITTI [31], Sintel [12], and Bonn [48] datasets covering dynamic and static, indoor and outdoor scenes. We use absolute relative error (Abs Rel) and $\delta < 1.25$ (percentage of predicted depths within a 1.25-factor of true depth) as metrics. Video depth estimation evaluates per-frame depth quality and inter-frame depth consistency by aligning predicted depth maps to ground truth using a per-sequence scale, which measures the relative depth accuracy. For methods that predict metric pointmaps (i.e., outputs in

Alignment	Method	Online	Sintel (50 frames)		BONN (110 frames)		KITTI (110 frames)	
			Abs Rel ↓	$\delta < 1.25$ ↑	Abs Rel ↓	$\delta < 1.25$ ↑	Abs Rel ↓	$\delta < 1.25$ ↑
Per-sequence Scale	DUST3R [83]	✗	0.656	45.2	0.155	83.3	0.144	81.3
	MASt3R [38]	✗	0.641	43.9	0.252	70.1	0.183	74.5
	MonST3R [94]	✗	0.378	55.8	0.067	96.3	0.168	74.4
	Easi3R [15]	✗	0.377	<u>55.9</u>	<u>0.059</u>	<u>97.0</u>	0.102	91.2
	AETHER [70]	✗	0.324	50.2	0.273	59.4	0.056	97.8
	VGGT [79]	✗	0.287	66.1	0.055	97.1	<u>0.070</u>	<u>96.5</u>
	Spann3R [77]	✓	0.622	42.6	0.144	81.3	0.198	73.7
	CUT3R [81]	✓	0.421	47.9	0.078	93.7	<u>0.118</u>	<u>88.1</u>
	Point3R [87]	✓	0.452	48.9	0.060	<u>96.0</u>	0.136	84.2
	StreamVGGT [97]	✓	0.323	65.7	0.059	97.2	0.173	72.1
Metric Scale	TTT3R	✓	<u>0.404</u>	<u>50.0</u>	0.068	95.4	0.113	90.4
	MASt3R [38]	✗	1.022	14.3	0.272	70.6	0.467	15.2
	CUT3R [81]	✓	1.029	<u>23.8</u>	<u>0.103</u>	88.5	<u>0.122</u>	<u>85.5</u>
	Point3R [87]	✓	0.777	17.1	0.137	94.7	0.191	73.8
	TTT3R	✓	<u>0.977</u>	24.5	0.090	<u>94.2</u>	0.110	89.1

Table 2: **Evaluation of Video Depth Estimation - Short Sequence.** We report scale-invariant relative depth (aligned by a per-sequence scale) and metric scale absolute depth accuracy on Sintel [12], Bonn [48], and KITTI [31] datasets. TTT3R achieves state-of-the-art or competitive performance among online methods, leading in KITTI for both metric and scale-invariant evaluations and ranking first or second in Sintel and Bonn.

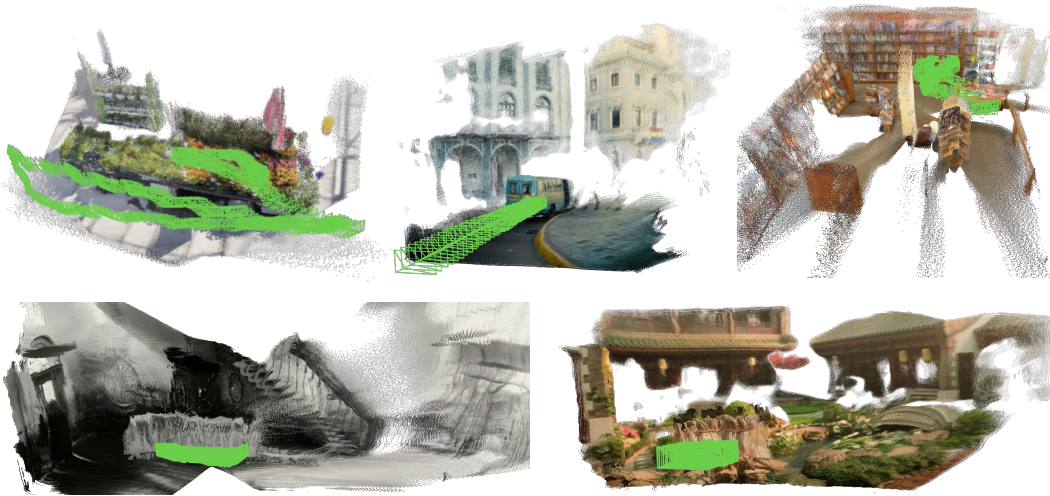

Figure 15: **In-the-Wild Video Reconstruction - Short Sequence.** TTT3R performs online 3D reconstruction by estimating camera parameters and dense geometry for each incoming image. It supports varying-length image inputs, either video streams or sparse photo collections, across both static and dynamic scenes.

meters with absolute scale), we also report results without scale alignment, evaluating predictions directly in metric units to assess absolute-scale accuracy.

Figure 8 presents the quantitative comparison between our method and the online baselines. Our approach delivers the best overall performance without ANY fine-tuning. The results in Table 2 show that even for short sequences, our method still achieves state-of-the-art or competitive performance in online methods, leading in KITTI dataset for both metric and scale-invariant evaluations and ranking one or two in Sintel and Bonn datasets.

B.5 3D RECONSTRUCTION

The results are presented in Figure 15, Figure 12 and Figure 14. TTT3R supports both video sequences and sparse photo collections, across static and dynamic scenes, and performs online 3D reconstruction by estimating camera parameters and dense geometry for each incoming frame. TTT3R is a simple modification to CUT3R that improves length generalization via a closed-form state update, enabling

robust long-sequence 3D reconstruction. The update is performed in the forward pass without any model fine-tuning, making it a plug-and-play solution, while preserving CUT3R’s inference speed and memory footprint and operating online at realtime and only cost 6GB GPU memory.

C USE OF LARGE LANGUAGE MODELS

We used a large language model to assist with copy editing—grammar checking, wording suggestions, and minor style and clarity improvements—after the scientific content, methodology, analyses, and conclusions had been written by the authors.