

# ConflictLens: LLM-Based Conflict Resolution Training in Romantic Relationship

JIWON CHUN\*, Texas A&M University, USA

GEFEI ZHANG\*, Zhejiang University of Technology, China

MENG XIA, Texas A&M University, USA

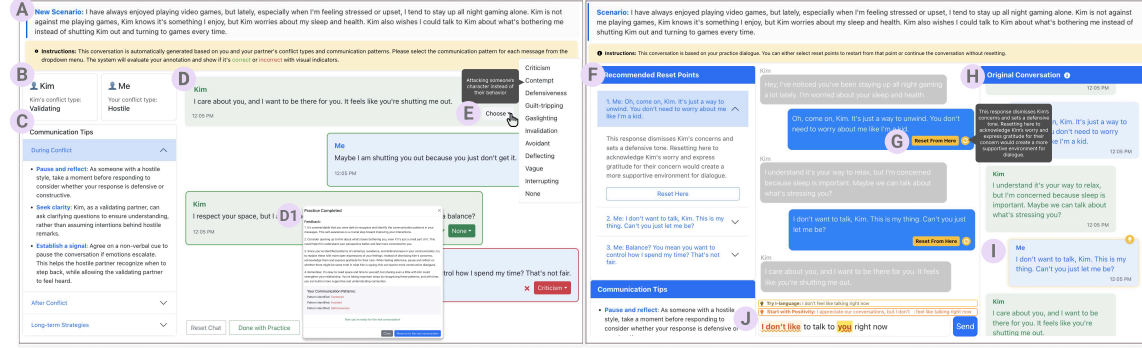

Fig. 1. Interface overview of the *ConflictLens*'s *Conflict Simulation Practice* (left, Page 4) and *Simulated Conversations* (right, Page 5). (A) introduces a realistic conflict scenario. (B) shows detected conflict styles for each participant. (C) has communication tips: during conflict, after conflict, and long-term strategies. (D) presents simulated conversations between the user and the partner, and (D1) provides a summary of feedback. (E) Dropdown to annotate negative communication behaviors. (F) has three system-recommended reset points. (G) is a recommended reset point with "Reset From Here" button with a refresh icon. (H) shows original conversation for comparison. (I) has highlighted matched messages for context. (J) Real-time rewrite suggestions.

Romantic conflicts are often rooted in deep psychological factors such as coping styles, emotional responses, and communication habits. Existing systems tend to address surface-level behaviors or isolated events, offering limited support for understanding the underlying dynamics. We present *ConflictLens*, an interactive system that leverages psychological theory and large language models (LLMs) to help individuals analyze and reflect on the deeper mechanisms behind their conflicts. The system provides multi-level strategy recommendations and guided dialogue exercises, including annotation, rewriting, and continuation tasks. A case study demonstrates how *ConflictLens* supports emotional insight, improves relational understanding, and fosters more constructive communication. This work offers a novel approach to supporting self-awareness and growth in romantic relationships.

CCS Concepts: • **Human-centered computing** → **Interactive systems and tools**.

Additional Key Words and Phrases: Romantic relationship, Communication training, Annotation, Dialogue simulation

## ACM Reference Format:

Jiwon Chun, Gefei Zhang, and Meng Xia. 2018. ConflictLens: LLM-Based Conflict Resolution Training in Romantic Relationship. In . ACM, New York, NY, USA, 7 pages. <https://doi.org/XXXXXXX.XXXXXXX>

\*Both authors contributed equally to this research.

Permission to make digital or hard copies of all or part of this work for personal or classroom use is granted without fee provided that copies are not made or distributed for profit or commercial advantage and that copies bear this notice and the full citation on the first page. Copyrights for components of this work owned by others than the author(s) must be honored. Abstracting with credit is permitted. To copy otherwise, or republish, to post on servers or to redistribute to lists, requires prior specific permission and/or a fee. Request permissions from [permissions@acm.org](mailto:permissions@acm.org).

© 2018 Copyright held by the owner/author(s). Publication rights licensed to ACM.

Manuscript submitted to ACM

## 1 INTRODUCTION

Close relationships are among the most crucial forms of human connection, deeply influencing individuals' mental health, well-being, and social adjustment [8, 16, 18, 21]. While these relationships include parent-child, sibling [5], and platonic bonds [1, 7], romantic relationships are uniquely complex due to their intense emotional attachment, long-term commitments, and psychological interdependence [13]. These dynamics make romantic interactions particularly prone to emotional volatility and psychological fluctuation [22]. For example, Kim et al. introduced Lily, a system that recommends romantic lyrics in real-time during couple texting to enhance emotional expression [14], highlighting the sensitivity of communication in romantic contexts.

Conflict is inevitable in romantic relationships but cannot be equated with general interpersonal disputes [15]. Romantic conflict often stems from emotional dependency, asymmetrical power dynamics, and ongoing challenges to individual identity and relational boundaries [20]. Unlike conflicts in professional or social settings, which tend to be more rational and detached, romantic disputes frequently involve emotional manipulation, unmet expectations, and subtle forms of psychological control [11]. If not properly addressed, such conflicts can escalate into long-term emotional harm, coercion, or even abuse. More importantly, conflict in romantic relationships often reflects deeper relational structures rather than isolated incidents. Partner interactions are shaped by attachment styles, communication habits, and stress-coping strategies. As such, responses to conflict vary widely, some partners withdraw or shut down, while others may lash out or over-accommodate. These behaviors are usually not conscious choices but learned coping patterns shaped by past experiences.

Although existing research has explored conflict resolution and communication training, such as Jagannath et al.'s guided conflict practice in Minecraft [12], Shaikh et al.'s Rehearsal system leveraging LLMs to simulate real-life scenarios [19], and Baughan et al.'s design exploration of tools for difficult conversations in intimate relationships [2], most efforts emphasize resolving discrete events. They often overlook the deeper individual and relational mechanisms that drive recurring conflict patterns.

Breaking recurring conflict patterns requires recognizing individual coping styles, communication habits, and emotional responses. Event-level strategies alone are insufficient for transforming these deeper mechanisms; structured analysis and guided practice are essential. To this end, we integrate psychological theory with multi-level recommendations, incorporating novel features including dialogue annotation, and training to support awareness and adjustment of relational patterns.

Building on this foundation, we collaborated with domain experts to design and develop an interactive system that leverages LLMs to support users in understanding and training conflict in romantic relationships. The system analyzes multimodal input data to provide tailored guidance aimed at improving users' emotional awareness, communication patterns, and relational dynamics. It consists of three stapes, each aligning with either understanding or training goals: **Conflict analysis (Understanding)**: Based on user-submitted chat logs or conflict descriptions, the system identifies each partner's conflict style and communication tendencies. **Conflict Strategy Recommendation (Bridging Understanding and Training)**: To address conflicts at different depths and support both immediate and long-term communication improvement. *ConflictLens* provides three types of personalized suggestions: *Whole-level Recommendation* advice targeting three phases: during conflict, post-conflict recovery, and long-term relational patterns. *Sentence-level Rewriting*, offering constructive alternatives to reduce blame and enhance empathy. *Words-level Recommendation* during practice sessions, guiding users toward healthier expressions (e.g., encouraging "I" statements over accusatory "you" statements). **Conflict Dialogue Practice (Training)**: To promote active reflection and reinforce

Table 1. Thirteen questions used to assess conflict resolution styles in romantic relationships [23].

Questions
Q1: We usually resolve conflicts by discussing the problem.
Q2: When we reach a compromise, the conflict usually ends.
Q3: Compromise is the best way for us to resolve conflicts.
Q4: To resolve disagreements, I try to give in a little.
Q5: I try to resolve disputes from my partner's perspective and wishes.
Q6: My partner and I try to avoid quarrels.
Q7: When we disagree, we argue loudly.
Q8: Our conflicts usually last for a long time.
Q9: Conflicts with my partner cause me distress.
Q10: When we have a conflict, I verbally attack my partner.
Q11: When conflicts arise, we take a break to cool down.
Q12: When we fight, I try to gain the upper hand.
Q13: In conflicts, I usually go along with my partner's opinion.

communication strategies through hands-on experience, the system generates tailored conversation exercises to help users build skills and insights. These exercises include: *Dialogue Annotation*: Users identify problematic language or interactional patterns. *Dialogue Revision*: Users rephrase parts of the dialogue to shift the conversation toward more constructive directions. *Dialogue Continuation*: Users complete or repair conversations, receiving feedback from the system on their response quality.

This paper presents the system's design and technical architecture, along with a case study demonstrating its initial effectiveness. Our findings suggest that the system supports users in improving not only their conflict communication skills but also their understanding of deeper relationship dynamics. It offers a promising foundation for educational and therapeutic interventions in the domain of intimate relationships.

## 2 SYSTEM DESIGN AND IMPLEMENTATION

*ConflictLens* guides users through a five-page interactive process designed to help romantic partners understand and improve their communication during conflict.

**Page 1: Upload Messages and Define Conflict** Users start by uploading screenshots of text message that contain a conflict in a romantic relationship (Fig. 2 (A)). The OpenAI API extracts text from the images and identifies the participants and ongoing conflict context allowing users to modify the conflict description before continuing (Fig. 2 (B)).

**Page 2: Conflict Type Questionnaire** On this page, the system presents both the user's and their partner's responses to a conflict resolution questionnaire [23] in Table 1, rated on a 5-point Likert scale from Strongly Disagree (1) to Strongly Agree (5) (Fig. 2 (C)). *ConflictLens* analyzes the uploaded messages on Page 1 to better understand the conflict. The OpenAI API estimates each person's questionnaire scores, which users can review and adjust if needed.

**Page 3: Conflict Type Analysis Results** To bridge Understanding and Training, *ConflictLens* identifies each person's conflict style (Table 2), based on Page 2 responses. The results are displayed at Fig. 2 (D), with the partner's conflict style in red and the user's in blue. Hovering over each label shows a short description to help users better understand what it means. Additionally, the system provides explanations of negative communication behavior based on their identified conflict style in Fig. 2 (E) along with communication recommendations. These whole-level recommendations are organized into three phases: when conflict happens, after conflict, and long-term strategies in Fig. 2 (F).

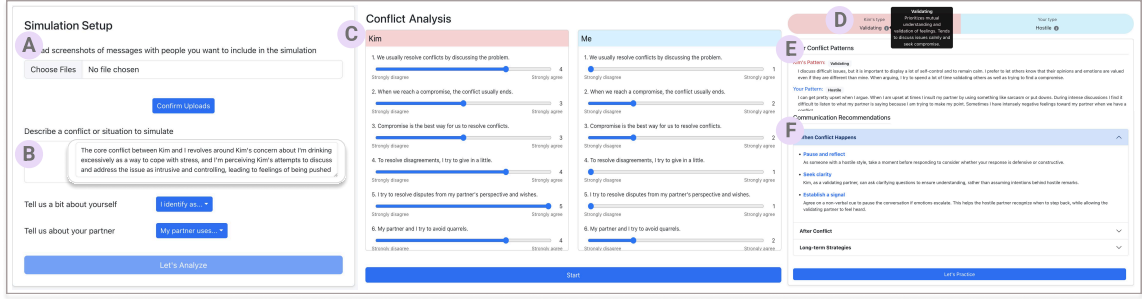

Fig. 2. Interface overview of the *ConflictLens*'s (A, B) *Upload Messages and Define Conflict* (Page 1). (C) *Conflict Type Questionnaire* (Page 2). (D, E, F) *Conflict Type Analysis Results* (Page 3).

Table 2. Descriptions of four conflict styles in romantic relationships [4, 24].

Type	Description
Avoidant	Tends to minimize disagreements and avoid confrontation. Values peace and harmony in relationships, often at the expense of addressing issues directly.
Validating	Prioritizes mutual understanding and validation of feelings. Tends to discuss issues calmly and seek compromise.
Volatile	Expresses emotions intensely and directly. Passionate in both positive and negative interactions, with high emotional reactivity.
Hostile	Shows high defensiveness and criticism during conflicts. May struggle with negative communication patterns that escalate disagreements.

Table 3. Types of negative communication behaviors used for annotation during conflict simulation.

Type	Description
Criticism [10]	Attacking someone's character instead of their behavior
Contempt [10]	Disrespect, mockery, sarcasm, name-calling
Defensiveness [10]	Seeing self as victim, warding off perceived attack
Guilt-tripping [9]	Making someone feel guilty to control them
Gaslighting [9]	Making someone doubt their reality or perceptions
Invalidation [9]	Dismissing or rejecting someone's feelings
Avoidant [17]	Withdrawing from conflict, stonewalling
Deflecting [17]	Changing the topic to avoid addressing issues
Vague [17]	Being unclear, not expressing needs directly
Interrupting [3]	Cutting off or talking over someone
None	No negative communication pattern present

**Page 4: Conflict Simulation Practice** After reviewing the personalized communication guide, users move on to an interactive simulation to train their communication skills. On this page (Fig. 1 (left)), the system generates a new conversation scenario based on the identified conflict styles of both the user and their partner (e.g., Hostile vs. Validating). This scenario in Fig. 1 (A) is intentionally designed to be different from the original message screenshots and reflects a realistic situation based on one of the most common conflict topics in romantic relationships: personal or partner habits [15]. Additionally, each person's conflict style and the corresponding communication recommendations from Page 3 are still provided to guide the interaction within the new scenario in Fig. 1 (B, C). Using the OpenAI API, the system simulates dialogues based on their conflict style between the two parties (Fig. 1 (D)), with messages displayed from the partner (green) and the user (blue). The system first determines who initiates the conversation by

referencing each person’s conflict style and negative communication patterns from Page 3. It then generates about 15 messages within the context. For each message, users are asked to annotate the communication problem (Fig. 1 (E)) by selecting one of the 11 behavior types listed in Table 3. These annotations help users recognize what went wrong in each exchange. The system evaluates each annotation and provides immediate feedback on whether it’s correct or not. Once annotation is complete, the system provides a summary of feedback that includes positive comments on what was done well, suggestions for improvement, and personalized insights based on the user’s communication patterns observed in the simulation (Fig. 1 (D1)).

**Page 5: Simulated Conversations** On Page 5 (Fig. 1 (right)), users engage in a continued conversation within the same simulated scenario. They can either continue with the current dialogue or select a reset point to revise a previous response using the feedback provided. The system recommends up to three reset points in Fig. 1 (F) which are specific user messages that could benefit from revision with an explanation for why each would be good for resetting. These recommended reset points are marked with a bolded “Reset From Here” button along with a refresh icon in Fig. 1 (G). While any user message can be a restart point, only recommended ones include these markers. To support reflection, the original conversation from Page 4 is shown on the right side for reference (Fig. 1 (H)). If there is a related message from the original conversation, it is automatically highlighted to provide contextual awareness like Fig. 1 (I). When users type a new message to continue the conversation, the system offers real-time feedback (Fig. 1 (J)). This includes highlighting specific parts of the message and suggesting alternatives aligned with non-violent communication strategies such as trying I-language or starting with positivity [2, 6]. Example rewrites are presented that maintain the same intention but with improved tone and clarity.

**Implementation** The system was implemented using React.js for the front-end, with styling handled by CSS. It is deployed on Vercel, and Firebase is used for back-end services and Firestore database management.

### 3 UNDERSTANDING BEFORE REPAIR: A CASE OF RELATIONAL INSIGHT

We invited a user named Jim, who was experiencing ongoing conflict in her romantic relationship. She and her partner, Kim, had disagreements stemming from personal lifestyle habits, such as returning home late and drinking. Jim began by uploading relevant text message conversations to the *ConflictLens* system and clicked “Confirm Uploads.” (Fig. 2 (A)) The system automatically extracted the text, identified conflict-related content, and presented the preliminary analysis results in Fig. 2 (B). Jim reviewed the analysis generated by the LLM and supplemented it with additional contextual details she deemed important, like the fact that she and her partner had experienced repeated conflicts over this issue.

Next, Jim clicked the “Let’s analyze” button, and the system conducted an automatic assessment of both her and Kim’s conflict styles (Fig. 2 (C)). She carefully examined the scores derived from the questionnaire and found the analysis about herself to be accurate. She modified one of Kim’s scores, lowering his “impulsivity” rating from 3 to 2, as she believed he was generally more composed and self-regulated compared to herself. In the subsequent Communication Guide interface, Jim learned that she belonged to the Hostile category, while Kim was categorized as Validating (Fig. 2 (D)). The system provided illustrated explanations of these conflict styles and their typical behavioral patterns during disagreement (Fig. 2 (E)). Jim gradually realized that she often struggled to listen, tended to express negative emotions directly, and was prone to emotional escalation. In contrast, Kim was described as calm, emotionally controlled, and inclined to seek constructive solutions even in conflict situations. Jim expressed that this analysis resonated with her and prompted new self-awareness regarding her communication patterns. Jim then reviewed the communication suggestions offered under the “When Conflict Happens” and “After Conflict” sections. She found these recommendations especially helpful, particularly the advice to pause and reflect before responding during a conflict, and to identify the triggers of

emotional escalation after the conflict (Fig. 2 (F)). In the “Long-Term Strategies” section, the system recommended that she and Kim conduct regular emotional check-ins and communication reviews to support the long-term quality of their relationship. Jim proceeded to the “Let’s Practice” module, where she interacted with simulated dialogue scenarios generated by the system based on their earlier conflict. She was asked to annotate each conversation segment using a set of ten predefined labels (Fig. 1 (E)). The system provided immediate feedback on her annotations, highlighting matches with the system’s labels in green and mismatches in red. Jim observed that some disagreements in labeling arose from the inherent ambiguity of the dialogue, noting that multiple interpretations could be valid. Upon completing the annotation task, the system generated personalized feedback based on her performance (Fig. 1 (D1)). Finally, Jim entered the “Real Conversation” module, where she could choose to either continue the conflict dialogue or revise it (Fig. 1 (G)). She explored both options, applying the system’s suggestions to adjust her communication strategies. Jim discovered that by exercising more patience and listening attentively, the dialogue became less confrontational. Because the system simulated Kim’s personality traits, her behavioral changes led to more productive exchanges and mutually satisfactory resolutions. Through her experience with *ConflictLens*, Jim reported gaining a clearer understanding of her typical reactions during conflict and a deeper appreciation of her partner’s communication style and intentions. She emphasized that the system’s analysis and recommendations felt both professional and highly relevant to real-life dynamics. The experience helped her learn to pause, reflect, and engage in more constructive communication during emotionally charged moments. Jim noted that the system did not simply provide binary judgments of right or wrong; rather, it guided her through a process of recognition, practice, and change. She concluded that *ConflictLens* made her realize that change is not a sudden decision, but a process that can be learned, supported, and sustained. She expressed a desire to continue applying these strategies in her daily relationship.

#### 4 CONCLUSION AND FUTURE WORK

Romantic conflict is a deeply emotional and complex phenomenon shaped by individual coping styles and relational dynamics. To support more meaningful reflection and skill development, we designed *ConflictLens*, an interactive system that integrates psychological theory and LLMs to help individuals analyze and improve their conflict communication. We developed a two-module system offering multi-level strategy recommendations and guided dialogue exercises, enabling users to explore their communication tendencies and relational patterns through structured interaction. A case study with a user experiencing ongoing relationship conflict illustrated how the system facilitated emotional insight, perspective-taking, and behavioral change. The user reported enhanced awareness of her own responses and greater empathy toward her partner, emphasizing the system’s relevance to real-life relational experiences. Our work demonstrates the potential of theory-informed, LLM-powered systems to support emotional learning and long-term relationship growth in romantic contexts.

Looking ahead, we aim to enhance *ConflictLens*’s analytical depth by incorporating contextual factors such as relationship stage and emotional closeness, as well as distinguishing between emotionally driven and fact-oriented conflicts. To enable more nuanced classification and interpretation, we plan to develop a conflict type classifier and annotate representative conflict scenarios from film and television media. These theory-aligned examples will be used to fine-tune LLMs, with the goal of improving the system’s sensitivity to complex interpersonal dynamics and generating more contextually adaptive guidance.

## REFERENCES

- [1] Kirsi Appelberg, Kalle Romanov, Marja-Liisa Honkasalo, and Markku Koskenvuo. 1991. Interpersonal conflicts at work and psychosocial characteristics of employees. *Social science & medicine* 32, 9 (1991), 1051–1056.
- [2] Amanda Baughan, Larry Tian, Pranav Shekar, Amy Zhang, and Alexis Hiniker. 2024. Supporting Hard Conversations in Close Relationships Through Design. *Proceedings of the ACM on Human-Computer Interaction* 8, CSCW2 (2024), 1–22.
- [3] Roger Brown. 2014. Politeness theory: Exemplar and exemplary. In *The legacy of Solomon Asch*. Psychology Press, 23–38.
- [4] Dean M Busby and Thomas B Holman. 2009. Perceived match or mismatch on the Gottman conflict styles: Associations with relationship outcome variables. *Family process* 48, 4 (2009), 531–545.
- [5] Daniel J Canary, William R Cupach, and Susan Messman. 1995. *Relationship conflict: Conflict in parent-child, friendship, and romantic relationships*. Sage Publications.
- [6] Ana Caraban, Evangelos Karapanos, Daniel Gonçalves, and Pedro Campos. 2019. 23 ways to nudge: A review of technology-mediated nudging in human-computer interaction. In *Proceedings of the 2019 CHI conference on human factors in computing systems*. 1–15.
- [7] Lore De Raeye, Nicole WH Jansen, Piet A van den Brandt, Rineke M Vasse, and IJmert Kant. 2008. Risk factors for interpersonal conflicts at work. *Scandinavian journal of work, environment & health* (2008), 96–106.
- [8] Morton Deutsch. 2008. A personal perspective on the history of the social psychological study of conflict resolution. *International handbook of organizational teamwork and cooperative working* (2008), 9.
- [9] Reden D GARCIA. 2023. WE SHOULD TALK ABOUT BRUNO: A SEQUENTIAL EXPLANATORY ANALYSIS ON MEN'S PSYCHOLOGICAL WELL-BEING AND INTIMATE PARTNER VIOLENCE. In *ICESSER CONFERENCE*. 70.
- [10] John Gottman. 2012. *Why marriages succeed or fail*. A&C Black.
- [11] Qing Huang and Shuting Yao. 2024. No response? Chronemic expectancy violation and relational turbulence in technologically-mediated romantic relational conflict. *Journal of Social and Personal Relationships* 41, 5 (2024), 1183–1206.
- [12] Krithika Jagannath, Katie Salen, and Petr Slovák. 2020. "(We) Can Talk It Out...": Designing for promoting conflict-resolution skills in youth on a moderated Minecraft Server. *Proceedings of the ACM on Human-Computer Interaction* 4, CSCW1 (2020), 1–26.
- [13] Jessica Kansky. 2018. What's love got to do with it? Romantic relationships and well-being. *Handbook of well-being* 1 (2018), 1–24.
- [14] Taewook Kim, Jung Soo Lee, Zhenhui Peng, and Xiaojuan Ma. 2019. Love in lyrics: An exploration of supporting textual manifestation of affection in social messaging. *Proceedings of the ACM on Human-Computer Interaction* 3, CSCW (2019), 1–27.
- [15] Dixie Meyer and Renata Sledge. 2022. The relationship between conflict topics and romantic relationship dynamics. *Journal of Family Issues* 43, 2 (2022), 306–323.
- [16] Bernard Oladosu Omisore and Ashimi Rashidat Abiodun. 2014. Organizational conflicts: Causes, effects and remedies. *International Journal of Academic Reserach in Economics and Management Sciences* 3, 6 (2014).
- [17] Sandra Petronio. 2010. Communication privacy management theory: What do we know about family privacy regulation? *Journal of family theory & review* 2, 3 (2010), 175–196.
- [18] Sandra V Sandy, Susan K Boardman, and Morton Deutsch. 2000. Personality and conflict. *The handbook of conflict resolution: Theory and practice* (2000), 289–315.
- [19] Omar Shaikh, Valentino Emil Chai, Michele Gelfand, Diyi Yang, and Michael S Bernstein. 2024. Rehearsal: Simulating conflict to teach conflict resolution. In *Proceedings of the 2024 CHI Conference on Human Factors in Computing Systems*. 1–20.
- [20] John Suler. 2011. The psychology of text relationships. In *Online counseling*. Elsevier, 21–53.
- [21] Digvijaysinh Thakore. 2013. Conflict and conflict management. *Iosr Journal Of Business And Management (Iosr-jbm)* 8, 6 (2013), 07–16.
- [22] Anita L Vangelisti. 2002. Interpersonal processes in romantic relationships. *Handbook of interpersonal communication* 3 (2002), 643–679.
- [23] Tammy L Zaccchilli, Clyde Hendrick, and Susan S Hendrick. 2009. The romantic partner conflict scale: A new scale to measure relationship conflict. *Journal of Social and Personal Relationships* 26, 8 (2009), 1073–1096.
- [24] Qingxiao Zheng, Daniela M Markazi, Yiliu Tang, and Yun Huang. 2021. "PocketBot Is Like a Knock-On-the-Door!": Designing a Chatbot to Support Long-Distance Relationships. *Proceedings of the ACM on Human-Computer Interaction* 5, CSCW2 (2021), 1–28.