

# Probabilistic Modeling of Human Teams to Infer False Beliefs

Paulo Soares, Adarsh Pyarelal, Kobus Barnard

University of Arizona

paulosoares@email.arizona.edu, adarsh@arizona.edu, kobus@arizona.edu

## Abstract

We develop a probabilistic graphical model (PGM) for artificially intelligent (AI) agents to infer human beliefs during a simulated urban search and rescue (USAR) scenario executed in a Minecraft environment with a team of three players. The PGM approach makes observable states and actions explicit, as well as beliefs and intentions grounded by evidence about what players see and do over time. This approach also supports inferring the effect of interventions, which are vital if AI agents are to assist human teams. The experiment incorporates manipulations of players' knowledge, and the virtual Minecraft-based testbed provides access to several streams of information, including the objects in the players' field of view. The participants are equipped with a set of marker blocks that can be placed near room entrances to signal the presence or absence of victims in the rooms to their teammates. In each team, one of the members is given a different legend for the markers than the other two, which may mislead them about the state of the rooms; that is, they will hold a false belief. We extend previous works in this field by introducing ToMCAT, an AI agent that can reason about individual and shared mental states. We find that the players' behaviors are affected by what they see in their in-game field of view, their beliefs about the meaning of the markers, and their beliefs about which meaning the team decided to adopt. In addition, we show that ToMCAT's beliefs are consistent with the players' actions and that it can infer false beliefs with accuracy significantly better than chance and comparable to inferences made by human observers.

## Introduction

Human-machine teaming has emerged in the last two decades as a way to describe the ideal way for humans to interact with artificially intelligent (AI) agents (Urlings and Jain 2001; Madni and Madni 2018), though not without some pushback (Groom and Nass 2007). At least one study has shown that humans are somewhat open to the idea of AI agents as teammates, rather than tools (Lyons et al. 2018). In this paper, we conceptualize human-machine teams not as exact analogues of human-human teams, but rather collaborations with the following features: autonomy, shared goals and knowledge, interdependence, and complementary responsibilities.

Copyright © 2021, Association for the Advancement of Artificial Intelligence (www.aaai.org). All rights reserved.

There is a growing consensus that for effective human-machine teaming, AI agents should be capable of building and maintaining models of their human teammates (Laird, Ranganath, and Gershman 2019). In other words, AI agents should develop a 'theory of mind' for their human teammates. We deviate slightly from the original definition of theory of mind (Premack and Woodruff 1978) and the way it is currently used in the literature. Rather than using the term to mean the ability to recognize that other humans have distinct mental states, in our work, we attempt to build an agent that *assumes* the existence of distinct human mental states and tries to infer them.

Unlike previous works that have focused on computational theory of mind for single humans in complex environments (Oguntola, Hughes, and Sycara 2021), or teams of artificial agents performing relatively simple tasks (Shum et al. 2019), our work studies teams of humans collaboratively performing tasks in a complex environment.

Research on human team performance shows that teams with strong 'shared mental models' perform better (Cannon-Bowers, Salas, and Converse 1993). We posit that one of the potentially helpful actions that can be performed by an agent with theory of mind is to detect when the mental models of its human teammates are misaligned and intervene to align them, thus strengthening the team's shared mental model and improve the team's performance.

To this end, we develop and evaluate a probabilistic graphical model (PGM) for inferring human belief states in a complex multi-participant simulated urban search and rescue task.

Notably, our approach has a number of desirable features:

- (1) Our model is *interpretable*, with latent variable nodes corresponding to high-level constructs that can easily interface with social science theories.
- (2) Our model explicitly represents the *team's shared mental model* as a latent node, separate from the individual mental models.
- (3) Our algorithm is *online*. Thus, the agent's models of the individual human teammates and the team's shared mental model are updated in real time, making it possible for the agent to intervene to correct misaligned mental models as soon as they are detected.

## Related Work

Recent works have addressed designing AI agents that can establish a theory of human minds using a variety of approaches. Rabinowitz et al. (2018) implemented an AI observer that used meta-learning over several policy-driven simulated agents to learn strong priors for the agents’ behaviors and accurately inferred subsequent actions on an unseen population. Their observer was also able to identify potential changes of desires in a hand-crafted false-belief scenario. However, experiments in this work were all conducted in small gridworld settings, with simulated agents, rather than human subjects. Moreover, the beliefs and desires were never directly measured. Rather, they were implicitly assumed given the predicted agents’ actions.

An AI observer using neural sequences in a more complex, multi-goal scenario also showed promising results on predicting strategies (Jain et al. 2020). Simulated agents followed a non-optimal trajectory based on behaviors collected from human subjects acting in the same environment. The AI observer was then trained on the behavior of these faux human agents and surpassed human observer predictions. However, this work did not incorporate beliefs and desires and did not address false-belief assumptions.

Whereas discriminative models can achieve significant performance levels in some scenarios, it is difficult to explain why the agents made a specific prediction. Oguntola, Hughes, and Sycara (2021) attempt to address this issue by adding explicit components such as human intents and concepts to these models to increase their interpretability.

Interpretability is crucial for agents that aim to develop a theory of the human mind, especially if these agents are to assist humans. It can explain the reasons why an AI agent arrived at a particular belief, or performed a particular intervention. We can compare the agents’ cognitive process to the mechanisms involved in the humans’ perception of the world and use this as a qualitative measure of the plausibility of the agent’s theories. Bayesian models are a natural framework to work with explicit representations of mental states and have already showed an ability to infer beliefs and desires, closely aligning with predictions made by human observers (Baker et al. 2017).

This approach has also shown to be a good choice to model non-optimal behavior in the context of planning (Zhi-Xuan et al. 2020; Alanqary et al. 2021). Humans do not always act optimally and might behave differently from an ideally rational agent. A core concept in a Bayesian framework is the manipulation of uncertainty, which, in turn, can be a solution to deal with such a problem.

A general limitation of most computational theory-of-mind related works is that they do not address the problem in a scenario in which more than one individual is involved. Therefore, they cannot explain changes in human behavior when they have to coordinate with each other. Developing a theory of a ‘team mind’ is a more challenging task, and might require revisiting some premises used for a single human scenario.

Marker	Legend A	Legend B
1	No victim here	Regular victim(s) here
2	Regular victim(s) here	No victim here
3	Critical victim(s) here	Critical victim(s) here

Table 1: The different marker legends received by the teammates in the experiment.

## Mission Design

The experiments consist of simulated urban search and rescue missions executed in a virtual world developed within Minecraft. The environment (see Figure 1a) is a collapsed office building. Teams of three humans must search the building for victims to triage. These victims may be located inside rooms or hidden under piles of rubble. The team earns a certain number of points for each victim that is triaged (‘critical’, i.e., severely injured victims, are worth more points than ‘regular’ victims, and require all three teammates to be present to triage them). The objective of the mission is to maximize the number of points earned by the team within a 15 minute time limit.

Players can choose among the following three possible roles, each of which has an associated tool with limited durability: (i) search specialists can use a stretcher to move regular victims from one location to another, (ii) engineers can use a hammer to clear rubble piles to reveal victims or open blocked areas, and (iii) medics can use a medkit to triage victims. There are no restrictions on the role each player can assume, and more than one player can take on the same role simultaneously if the team decides that would be a good strategy.

Roles are chosen at the beginning of the mission. A player can change their role by returning to a ‘base’ area, and also replenish their tools (stretcher/hammer/medkit), which have a limited number of uses. In this way, a time cost is associated with changing roles and using tools. Also, the players have access to the tool age at all times. Therefore, they might decide to replenish their tools before they become unusable.

Players communicate via voice chat with each other, through which they can coordinate their strategies and actions. The players can choose to place marker blocks labeled as either 1, 2, or 3 that they can use all around the building to track information relevant to the team (e.g., rooms with victims that need to be triaged). There is no limit on how many marker blocks players can use. Before the mission starts, each player receives a legend describing the meaning of the marker blocks. Two players receive legend A, while the third receives a different version, legend B, in which the meanings of markers 1 and 2 are swapped. This generates a false belief on the part of the player who gets legend B about the meaning of the marker blocks. The content of legends A and B are given in Table 1. The participants are not told that their legend might be different from that of their teammates. The legend assignment conditions has three equally likely cases corresponding to which player received legend B.

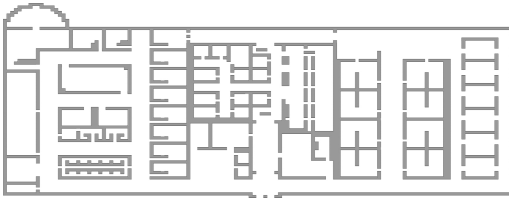

(a) 2D view of the building floor plan.



(b) Marker meaning legend B as displayed on the screen.

Figure 1: Floor map of the simulated environment and marker meaning legend B that one of the three players sees on the screen.

## Probabilistic Model of Minds

We propose an AI agent called ToMCAT (Theory of Mind-based Cognitive Architecture for Teams) to infer each player’s beliefs about marker meaning and the collective team agreement on marker meaning. Specifically, we infer which player received legend B, which we can validate.

ToMCAT reasons about which meaning the players are using for the markers as they place them in the environment or take action after markers have been in their in-game field of view. The agent represents its theory of the players’ and team’s minds using a probabilistic model for its beliefs about players’ individual and collective mental states. Latent random variables represent these states, and the agent updates its beliefs by doing inference over them, grounded by evidence about what the players see and do over time.

We choose a probabilistic approach for our agent to explicitly represent the players’ beliefs and states. This representation allows us to understand how the agent reasons about the players’ beliefs and facilitates evaluating the effect of potential interventions for assisting human teams. Further, we can inspect the representation and evaluate whether the model is reasonably achieving predictions.

In the instrumented mission domain, we hypothesize that players will start by placing markers consistent with the original legend they received. Moreover, the team might collectively follow a specific legend; this will explain situations in which players place markers that differ in meaning from the players’ original legends.

We use as evidence (i) observations of victims appearing in the players’ in-game field of view and (ii) placement of marker blocks 1 and 2. We captured the players’ in-game view using a resolution of 16:9, which spans the field of view in  $70^\circ$  vertically (default setting of Minecraft’s camera) and  $125^\circ$  horizontally (from the resolution ratio). We do not use placements of marker block 3 as evidence because

the meaning of this marker is the same for both legends, and thus we can reasonably assume that everyone has this belief. Additionally, we simplify the world by making the following assumptions:

- The team adopted legend does not change over time. Therefore, we can represent it as a single-time variable in the model. This is different from the probability changing over time as the agent observes more evidence. The agent’s belief about the true single value of this latent state will change over time.
- Players will use the markers according to the definitions provided in the legends. The agent might fail to infer the correct original assignment if the player used a meaning for the marker that is not consistent with legends A and B. (e.g., if a player chose to use markers to keep track of rooms with rubble that needed to be cleared).
- The players will perceive any victim in their in-game field of view, that is, we assume that every time a victim is visible on a player’s computer screen, the player will notice them. Victims are hidden inside rooms or under piles of rubble. Therefore, the players will invariably be close to the victims when they find them, which makes this assumption plausible.
- This perception will last five seconds on average, which means that if players place markers a long time after noticing victims, the agent will interpret that the players are using the markers to inform others that there is no victim nearby.
- Given the same victim perception, original and team legend, players will behave similarly. This implies that the parameters of the distributions in the model can be shared among the players.

Formally, the agent holds: (i) a belief about the original marker meaning legend that each participant received,  $O^{(i)}$  - where  $i \in \{1, 2, 3\}$  represents a specific player - (ii) a belief about which meaning the team decided to adopt collectively,  $T$ , (iii) a belief about whether the players perceived a victim in their in-game field of view,  $P_t^{(i)}$ , at a given time step  $t$  (each time step is one second in length), and (iv) a belief about the original legend assignment,  $A$ . This last latent state combines the beliefs about the individual players,  $O^{(i)}$ , embedding the restriction that only one of them received legend B. The model is grounded by victims in the players’ in-game field of view,  $F_t^{(i)}$ , and markers,  $M_t^{(i)}$ , they place at any time step (see Figure 2).

Hence, let  $\tau$  be the last time step in a trial. The model defines the following joint probability over latent beliefs and observations:

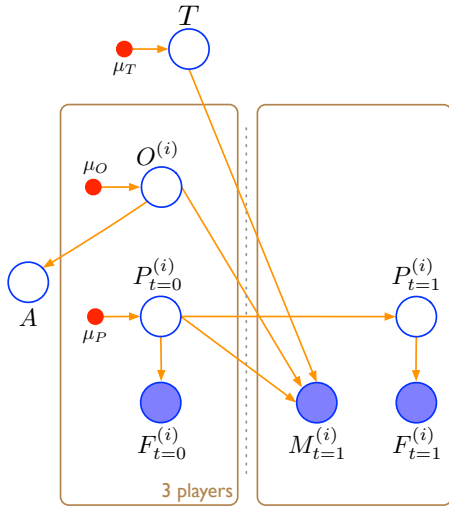

Letters	Description	Domain
<b>Notation</b>		
Superscript (i)	Player i	
Subscript t	Time t	
<b>Social parameters</b>		
A	ToMCAT model of belief about how original legends were distributed among the players	P1 got B P2 got B P3 got B
O	ToMCAT model of belief about the player's original legend	A, B
T	ToMCAT model of belief about the team adopted legend	A, B
<b>Behavioral parameters</b>		
P	ToMCAT model of victim perceived by the player	Not Perceived, Perceived
<b>Observations (evidence)</b>		
F	Victim detected in the player's in-game field of view	
M	Marker placed by the player	Marker 1, Marker 2

Figure 2: Players' mental states represented as a dynamic Bayes net (DBN). The model encodes the joint distribution of the agent's beliefs, grounded by what the players see and do.

$$\begin{aligned}
p(A, T, O^{(i)}, P_{0:\tau}^{(i)}, F_{0:\tau}^{(i)}, M_{1:\tau}^{(i)}) &= p(A|O^{(1)}, O^{(2)}, O^{(3)}) \\
& p(T) \prod_{i \in \{1,2,3\}} p(O^{(i)}) p(P_0^{(i)}) p(F_0^{(i)}|P_0^{(i)}) \\
& \prod_{t=1}^{\tau} p(M_t^{(i)}|P_{t-1}^{(i)}, O^{(i)}, T) p(F_t^{(i)}|P_t^{(i)}) p(P_t^{(i)}|P_{t-1}^{(i)})
\end{aligned} \quad (1)$$

Next, let  $I_{\text{Perceive}}$  be an indicator function of victim perception. We define the priors and conditional distributions as follows:

$$\begin{aligned}
\mu_T, \mu_O, \mu_P &= 0.5 \\
T &\sim \text{Binomial}(\mu_T) \\
O^{(i)} &\sim \text{Binomial}(\mu_O) \\
P_0^{(i)} &\sim \text{Binomial}(\mu_P) \\
P_t^{(i)}|P_{t-1}^{(i)} = \text{Not Perceived} &\sim \text{Categorical}([0.8, 0.2]) \\
P_t^{(i)}|P_{t-1}^{(i)} = \text{Perceived} &\sim \text{Categorical}([0.2, 0.8]) \\
F_t^{(i)}|P_t^{(i)} = x &\sim \text{Binomial}(I_{\text{Perceived}}(x)) \\
M_t^{(i)}|P_{t-1}^{(i)}, O^{(i)}, T &\sim \text{Binomial}(\theta) \\
\theta_j &\stackrel{iid}{\sim} \text{Beta}(1, 1), \text{ where } j \in [1, 8]
\end{aligned} \quad (2)$$

The categorical distributions of  $P_t^{(i)}|P_{t-1}^{(i)}$ , specify a transition matrix over the perception state. The chosen parameter values for this matrix result in a perception duration governed by a geometric distribution with parameter  $p = 0.2$ , based on the assumption that the player's focus of attention on the victims is about 5 seconds. We found that the model is not very sensitive to this parameter in the range of 3 to 10 seconds, so 5 seconds is a reasonable choice.

Also, to constrain the solution space to valid assignments only, we compute the conditional distribution of  $A$  as:

$$\begin{aligned}
A|O^{(1)}, O^{(2)}, O^{(3)} &= \\
& \begin{cases} \text{P1 got B, if } O^{(1)} = B, O^{(2)} = O^{(3)} = A \\ \text{P2 got B, if } O^{(2)} = B, O^{(1)} = O^{(3)} = A \\ \text{P3 got B, if } O^{(3)} = B, O^{(1)} = O^{(2)} = A \\ \sim \text{Categorical}(\frac{1}{3}, \frac{1}{3}, \frac{1}{3}), \text{ otherwise} \end{cases}
\end{aligned} \quad (3)$$

Finally, ToMCAT's belief about the original legend assignment is determined by the posterior  $p(A|F_{t:\tau}^{(i)}, M_{t:\tau}^{(i)})$  for all players  $i \in \{1, 2, 3\}$  and time steps  $t \in [0, \tau]$ .

## Inference

We perform approximate inference in the model using a particle filter algorithm (Gordon, Salmond, and Smith 1993). Given the tractability of the substructures in the model, we apply the Rao-Blackwellised version of this sequential inference method (Murphy and Russell 2001; Doucet, Godsill, and Andrieu 2003; Karlsson, Schon, and Gustafsson 2005). Formally, let  $X_{0:t}^{(1:3)}$  indicate all occurrences of player 1, 2 and 3 instances of a random variable  $X$  from time step 0 until time step  $t$ . The posterior can be decomposed in the following terms:

$$\begin{aligned}
p(P_{0:t}^{(1:3)}, O^{(1:3)}, T, A|M_{0:t}^{(1:3)}, F_{0:t}^{(1:3)}) &= \\
& \underbrace{p(P_{0:t}^{(1:3)}|M_{0:t}^{(1:3)}, F_{0:t}^{(1:3)})}_{(b)} \underbrace{p(O^{(1:3)}|M_{0:t}^{(1:3)}, P_{0:t}^{(1:3)})}_{(a)} \\
& \underbrace{p(T|M_{0:t}^{(1:3)}, P_{0:t}^{(1:3)}, O^{(1:3)})}_{(b)} p(A|O^{(1:3)})
\end{aligned} \quad (4)$$

We sample each  $O^{(i)}$  and  $T$  from the analytical form of the posteriors in (a) and (b) in Eq. 4, and we use particles to approximate the posteriors of the remaining terms.

## Evaluation

### Setup

In the original experiment, each team plays two different missions with different conditions and configurations of rubble blockages and victims locations. In this evaluation, we only use the first trial of each team to avoid introducing bias due to the knowledge the players will develop about the mission design and also because teams are more likely to bring the collective marker meaning they adopted in the first trial to the second, which would make the inference task extremely hard or even impossible.

We use 52 mission trials to train and evaluate our model using cross-validation. Independent human observers annotated 12 extra trials at three different points in time (180, 480 and 780 seconds after the beginning of the mission). We use this trial set to compare our agent’s performance with that of a human observer.

We use the last predictions as the final answer from the human observers, which should be their most confident output. Similarly, we use our agent’s predictions at time step 780. This guarantees that both ToMCAT and human agents have been exposed to the same evidence up to the decision point. Further, the human observers also know that only one player received a different legend, which is a constraint embedded in our model formulation.

We trained  $\theta$  in Equation 2 using Gibbs sampling for 600 iterations, from which we discard the first 100 as part of the burn-in phase. Additionally, we used 5000 particles for inference.

### Results

ToMCAT is a probabilistic agent, which means that the confidence of its beliefs will depend on how likely the given evidence explains specific hidden states. We transform the predictions from different human observers into probabilities to compare them against our agent’s predictions at different confidence levels. We define the prediction confidence of the human agent such that if for a given trial, all observers agreed on a given legend, the human agent is 100% confident about that legend. On the other hand, if only two humans agreed on that legend, the human agent is 2/3 confident about it and 1/3 confident about the legend chosen by the third human observer.

We compute the agents’ performance such that whenever they are not able to identify a winning legend (uniform probability across legends), we count that prediction as wrong. We then compare the accuracy of our agent against the probabilistic human agent at several confidence levels. Figure 3 shows that ToMCAT outperforms the human estimations in the full test set. As we increase the confidence level of the predictions, the human agent surpasses ToMCAT, but it reduces the coverage of the predicted trials. Conversely, except for the case in which we only count highly confident predictions (confidence above 0.9), ToMCAT achieves a rea-

	ToMCAT	Chance	Human
5-Fold CV Annotated Set	<b>0.65 ± 0.17</b>	0.33	Not available
	<b>0.41</b>	0.33	0.33

Table 2: Accuracies of ToMCAT, random and human agents at inferring false belief. In the first row, the figure for ToMCAT represents the accuracy obtained by doing 5-fold cross-validation on the 52 mission trials from the training set. This set does not contain human predictions. The second row shows the accuracy of the agents in the 12 mission trials from the human-annotated test set. Human observers performed no better than random chance on this set.

sonable accuracy and has higher coverage than the human agent.

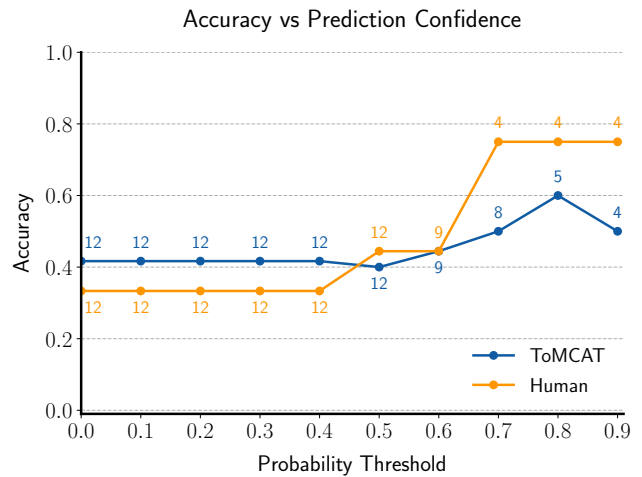

Figure 3: Accuracy of the human and ToMCAT agent at different confidence levels. The probability threshold defines the minimum probability that the agent had to achieve for the predicted class to count towards the accuracy computation. The numbers above and below the lines represent the number of trials for which the agent’s prediction probabilities were above the defined threshold level. The higher the threshold, the smaller the coverage since only the most confident predictions are taken into account.

To ensure that ToMCAT’s performance is consistent across different sets, we performed 5-fold cross-validation on the training set. The results reported in Table 2 show that ToMCAT can infer false belief significantly better than chance across different randomly split folds.

Additionally, we are interested in evaluating what premises ToMCAT uses to update its belief about human teammates. Our experiments show that ToMCAT developed a consistent theory of the players’ minds. ToMCAT correctly adjusts its belief about the marker meaning adopted by each player as they place markers in the game given their perception about a nearby victim. Interestingly, the belief about the legend adopted by the team was also rationally updated when the agent’s uncertainty about which player holds

a false belief changed. These results show that ToMCAT is correctly developing beliefs about individual and shared mental states.

Figure 4 shows an example of the agent’s beliefs changing over time for a given trial. Shortly after the first 3 minutes from the mission start, player 1 places a marker 2 to signal that there are victims near where the marker is placed, a behavior consistent with legend A. At this point, the agent does not have much information about this player’s actions and used this evidence to adjust its belief about the team adopted legend at the expense of incorrectly updating its belief about player 1’s legend. However, as player 1 keeps placing markers according to legend A, the agent can quickly adjust its belief about this player’s original legend.

In the meantime, the agent also observes that player 3 is placing markers consistent with the meaning provided by legend B. It rapidly infers that the player holds the false belief and adjusts its belief about the player’s and team’s legends accordingly.

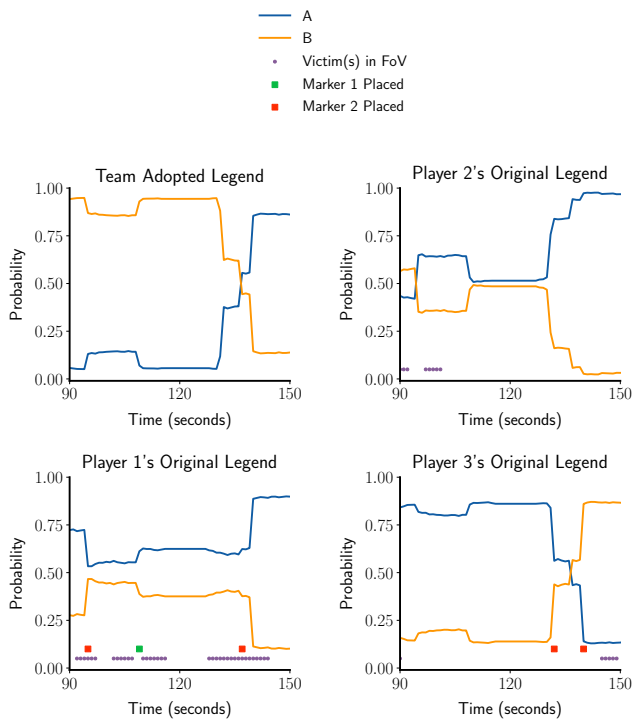

Figure 4: Agent’s beliefs about humans mental states being updated over time on a sample trial. As players perceive victims and place markers in the building, the agent updates its belief about which meaning the players individually and collectively are adopting for the markers.

Figure 5 illustrates how the agent changes its belief about original assignments across a whole trial. The plots illustrated that the agent is not always confident about its belief, but it can quickly adapt whenever it perceives a particular behavior.

We identified that the scenarios in which the model developed a wrong belief about the legend assignments were

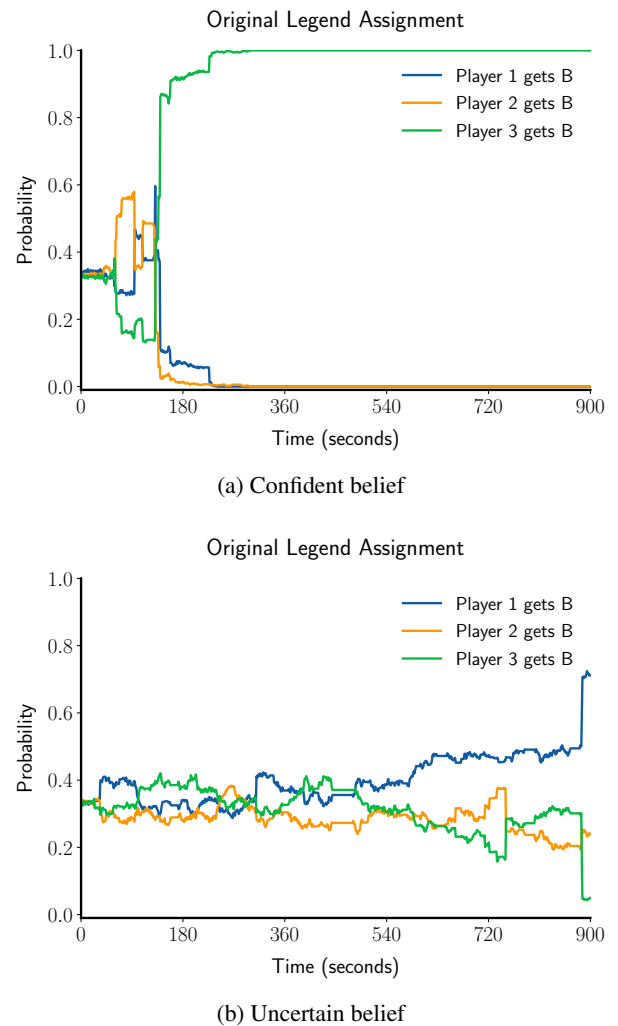

Figure 5: (a) An example of a trial in which players are active at placing markers. ToMCAT’s beliefs quickly adapts and it becomes very certain about the correct original assignment. (b) An example of a trial where players do not use the markers very often. ToMCAT is not very certain until the end of the mission when player 3 places a marker consistent with legend A, which increases ToMCAT current believe that player 1 is the one that holds the false belief.

mostly because players barely or never used markers or because players created a different use for them. In one instance, a player used marker 2 to keep track of rooms with rubble that needed to be cleared. The agent will incorrectly think players are using legend B as there are no victims around, just rubble. Another scenario in which the model develops a wrong belief about the assignments is when players mistakenly place wrong markers and immediately afterward replace them with correct ones. A final explanation would be the strong assumption we made that players perceive all the victims in their fields of view. The majority of these issues are tractable with simple improvements in the model, and we will address them in future work.



## Conclusion

Our experiments showed that ToMCAT was able to develop a rational theory of human minds to accurately identify false beliefs in the context of a search and rescue mission. Our agent explained players' behaviors not only by their states but also by a collective, shared state. Importantly, it is able to infer false beliefs for some trials with high levels of confidence (e.g., the one in Figure 5), thus making it a viable proposition to intervene at these points (e.g., approximately 200 seconds into the mission shown in Figure 5a.) to correct false beliefs and misaligned mental models.

ToMCAT performed significantly better than chance and achieved results comparable with human predictions. For future works, we will increase the number of human-annotated trials and explore different information asymmetry scenarios. ToMCAT knows that only one of the players received a different legend. However, there are cases in real life in which the form of information asymmetry cannot be determined beforehand, and the agent will need to infer that.

Finally, players are encouraged to communicate in the mission, and their speech is run through our automatic speech recognition (ASR) and rule-based information extraction pipelines. But the current agent does not ground its belief in this kind of information. We can likely improve ToMCAT's performance by using the outputs of our natural language processing systems as evidence to infer human mental states.

## Acknowledgments

This research was conducted as part of DARPA's Artificial Social Intelligence for Successful Teams (ASIST) program, and was sponsored by the Army Research Office and was accomplished under Grant Number W911NF-20-1-0002. The views and conclusions contained in this document are those of the authors and should not be interpreted as representing the official policies, either expressed or implied, of the Army Research Office or the U.S. Government. The U.S. Government is authorized to reproduce and distribute reprints for Government purposes notwithstanding any copyright notation herein.

## References

Alanqary, A.; Lin, G. Z.; Le, J.; Zhi-Xuan, T.; Mansinghka, V. K.; and Tenenbaum, J. B. 2021. Modeling the Mistakes of Boundedly Rational Agents Within a Bayesian Theory of Mind. *CoRR* abs/2106.13249. URL <https://arxiv.org/abs/2106.13249>.

Baker, C. L.; Jara-Ettinger, J.; Saxe, R.; and Tenenbaum, J. B. 2017. Rational quantitative attribution of beliefs, desires and percepts in human mentalizing. *Nature Human Behaviour* 1(4): 0064.

Cannon-Bowers, J. A.; Salas, E.; and Converse, S. 1993. Shared mental models in expert team decision making. *Individual and group decision making: Current issues* 221–46.

Doucet, A.; Godsill, S.; and Andrieu, C. 2003. On Sequential Monte Carlo Sampling Methods for Bayesian Fil-

tering. *Statistics and Computing* 10. doi:10.1023/A:1008935410038.

Gordon, N.; Salmond, D.; and Smith, A. F. M. 1993. Novel approach to nonlinear/non-Gaussian Bayesian state estimation.

Groom, V.; and Nass, C. 2007. Can robots be teammates?: Benchmarks in human-robot teams. *Interaction Studies* 8(3): 483 – 500. ISSN 15720373. URL <http://ezproxy.library.arizona.edu/login?url=https://search.ebscohost.com/login.aspx?direct=true&db=ufh&AN=27075930&site=ehost-live>.

Jain, V.; Jena, R.; Li, H.; Gupta, T.; Hughes, D.; Lewis, M.; and Sycara, K. P. 2020. Predicting Human Strategies in Simulated Search and Rescue Task. *CoRR* abs/2011.07656. URL <https://arxiv.org/abs/2011.07656>.

Karlsson, R.; Schon, T.; and Gustafsson, F. 2005. Complexity analysis of the marginalized particle filter. *IEEE Transactions on Signal Processing* 53(11): 4408–4411. doi:10.1109/TSP.2005.857061.

Laird, J.; Ranganath, C.; and Gershman, S. 2019. Future Directions in Human Machine Teaming Workshop. URL <https://basicresearch.defense.gov/Portals/61/Future%20Directions%20in%20Human%20Machine%20Teaming%20Workshop%20report%20%20%28for%20public%20release%29.pdf>.

Lyons, J. B.; Mahoney, S.; Wynne, K. T.; and Roebke, M. A. 2018. Viewing Machines as Teammates: A Qualitative Study. In *2018 AAI Spring Symposia, Stanford University, Palo Alto, California, USA, March 26-28, 2018*. AAI Press. URL <https://aaai.org/ocs/index.php/SSS/SSS18/paper/view/17524>.

Madni, A.; and Madni, C. 2018. Architectural Framework for Exploring Adaptive Human-Machine Teaming Options in Simulated Dynamic Environments. *Systems (Basel)* 6(4): 44. ISSN 2079-8954. doi:10.3390/systems6040044.

Murphy, K.; and Russell, S. 2001. *Rao-Blackwellised Particle Filtering for Dynamic Bayesian Networks*, 499–515. New York, NY: Springer New York. ISBN 978-1-4757-3437-9. doi:10.1007/978-1-4757-3437-9\_24. URL [https://doi.org/10.1007/978-1-4757-3437-9\\_24](https://doi.org/10.1007/978-1-4757-3437-9_24).

Oguntola, I.; Hughes, D.; and Sycara, K. P. 2021. Deep Interpretable Models of Theory of Mind For Human-Agent Teaming. *CoRR* abs/2104.02938. URL <https://arxiv.org/abs/2104.02938>.

Premack, D.; and Woodruff, G. 1978. Does the chimpanzee have a theory of mind? *Behavioral and Brain Sciences* 1(4): 515–526. doi:10.1017/S0140525X00076512.

Rabinowitz, N.; Perbet, F.; Song, F.; Zhang, C.; Eslami, S. M. A.; and Botvinick, M. 2018. Machine Theory of Mind. In Dy, J.; and Krause, A., eds., *Proceedings of the 35th International Conference on Machine Learning*, volume 80 of *Proceedings of Machine Learning Research*, 4218–4227. Stockholm, Sweden: PMLR. URL <http://proceedings.mlr.press/v80/rabinowitz18a.html>.

Shum, M.; Kleiman-Weiner, M.; Littman, M. L.; and Tenenbaum, J. B. 2019. Theory of Minds: Understanding Behavior in Groups through Inverse Planning. In *The Thirty-Third AAAI Conference on Artificial Intelligence, AAAI 2019, The Thirty-First Innovative Applications of Artificial Intelligence Conference, IAAI 2019, The Ninth AAAI Symposium on Educational Advances in Artificial Intelligence, EAAI 2019, Honolulu, Hawaii, USA, January 27 - February 1, 2019*, 6163–6170. AAAI Press. doi:10.1609/aaai.v33i01.33016163. URL <https://doi.org/10.1609/aaai.v33i01.33016163>.

Urlings, P.; and Jain, L. C. 2001. Teaming Human and Machine: A Conceptual Framework. In Abraham, A.; and Köppen, M., eds., *Hybrid Information Systems, First International Workshop on Hybrid Intelligent Systems, Adelaide, Australia, December 11-12, 2001, Proceedings*, Advances in Soft Computing, 711–721. Physica-Verlag.

Zhi-Xuan, T.; Mann, J. L.; Silver, T.; Tenenbaum, J.; and Mansinghka, V. 2020. Online Bayesian Goal Inference for Boundedly Rational Planning Agents. In Larochelle, H.; Ranzato, M.; Hadsell, R.; Balcan, M.; and Lin, H., eds., *Advances in Neural Information Processing Systems 33: Annual Conference on Neural Information Processing Systems 2020, NeurIPS 2020, December 6-12, 2020, virtual*. URL <https://proceedings.neurips.cc/paper/2020/hash/df3aebc649f9e3b674eeb790a4da224e-Abstract.html>.