

Indoor Localization using Bluetooth and Inertial Motion Sensors in Distributed Edge and Cloud Computing Environment

Yashar Kiarashi*

Emory University
USA

yash@dbmi.emory.edu

Chaitra Hedge*

Georgia Tech
USA

chegde@gatech.edu

Venkata Siva Krishna

Madala*

Georgia Tech
USA

vmadala3@gatech.edu

ArjunSinh Nakum

Georgia Tech
USA

arjun5inh@gatech.edu

Ratan Singh

Georgia Tech
USA

rsingh388@gatech.edu

Robert Tweedy

Emory University
USA

robert.tweedy@emory.edu

Gari D. Clifford

Emory University &
Georgia Tech
USA

gari@dbmi.emory.edu

Hyeokhyen Kwon

Emory University
USA

hhyeokk@emory.edu

Abstract

Spatial navigation of indoor space usage patterns reveals important cues about the cognitive health of individuals. In this work, we present a low-cost, scalable, open-source edge computing system using Bluetooth Low Energy (BLE) and Inertial Measurement Unit sensors (IMU) for tracking indoor movements for a large indoor facility (over 1600 m²) that was designed to facilitate therapeutic activities for individuals with Mild Cognitive Impairment. The facility is instrumented with 39 edge computing systems with an on-premise fog server, and subjects carry BLE beacon and IMU sensors on-body. We proposed an adaptive trilateration approach that considers the temporal density of hits from the BLE beacon to surrounding edge devices to handle inconsistent coverage of edge devices in large spaces with varying signal strength that leads to intermittent detection of beacons. The proposed BLE-based localization is further enhanced by fusing with an IMU-based tracking method using a dead-reckoning technique. Our experiment results, achieved in a real clinical environment, suggest that an ordinary medical facility can be transformed into a smart space that enables automatic assessment of the individual patients' movements.

Keywords

ambient health monitoring, indoor localization, edge computing, fog computing

ACM Reference Format:

Yashar Kiarashi, Chaitra Hedge, Venkata Siva Krishna Madala, ArjunSinh Nakum, Ratan Singh, Robert Tweedy, Gari D. Clifford, and Hyeokhyen Kwon. 2018. Indoor Localization using Bluetooth and Inertial Motion Sensors in Distributed Edge and Cloud Computing Environment. In *Proceedings*

*Equal Contribution

Permission to make digital or hard copies of all or part of this work for personal or classroom use is granted without fee provided that copies are not made or distributed for profit or commercial advantage and that copies bear this notice and the full citation on the first page. Copyrights for components of this work owned by others than ACM must be honored. Abstracting with credit is permitted. To copy otherwise, or republish, to post on servers or to redistribute to lists, requires prior specific permission and/or a fee. Request permissions from permissions@acm.org.
Conference'17, July 2017, Washington, DC, USA

© 2018 Association for Computing Machinery.
ACM ISBN 978-x-xxxx-xxxx-x/YY/MM...\$15.00
<https://doi.org/XXXXXXXXXXXXXX>

of ACM Conference (Conference'17). ACM, New York, NY, USA, 5 pages.
<https://doi.org/XXXXXXXXXXXXXX>

1 Introduction

Over the past decade, the presence of smart connected devices has led to a new wave of ambient monitoring of patients in clinical environments. Patients' movements in indoor spaces play a vital role in assessing health, particularly cognitive health [10]. A range of solutions have been proposed to support tracking a subject's location using various sensors: radio-frequency identification (RFID) [33], infrared (IR) [8], WiFi [32], and Bluetooth [36]. Among them, BLE-based solutions gained popularity for their unique advantages, being low-cost, low-power, and privacy-preserving solutions.

Although with many successes in BLE-based localization systems, it is yet to be validated for large indoor spaces (1600 m²), which challenges the uniform distribution of BLE receivers [3, 23]. Conventionally, the Received Signal Strength Indicator (RSSI) is used for BLE-based localization, representing distances between BLE beacons/transmitters [22]. In wide indoor spaces having multiple rooms and furniture with varying materials, RSSI can be inconsistent and unstable across the area due to environmental factors, including absorption, diffraction, reflection, interference, etc., which significantly hampers the localization accuracy [31].

In this study, we validate the feasibility of using a BLE- and IMU-based indoor localization system in an indoor space of over 1600 m², designed to carry out therapeutic services for individuals with Mild Cognitive Environment (MCI). MCI is a clinically-recognized stage between normal aging and dementia, marked by a decline in cognitive functions like memory and attention. The environment aimed to encourage MCI patients to participate in various therapeutic activities, including exercise and memory training, while fostering social interaction opportunities (e.g., during meals and in lounge areas). Automated patient localization and tracking system can provide important clues about their cognitive health while performing a wide range of activities.

The proposed BLE-based localization method, namely adaptive trilateration, uses temporal information of RSSI, which is the frequency of signals received from the beacons over time, that could effectively tackle the fluctuations in RSSI due to the environmental factors abovementioned. Additionally, integrating with IMU-based

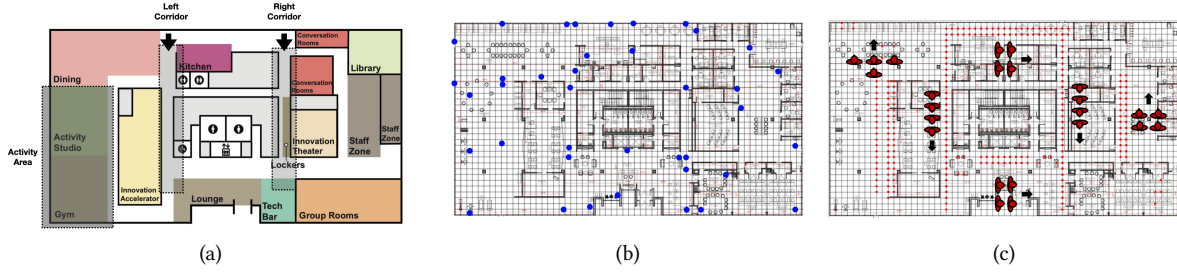

Figure 1: Study site and data collection. (a) Study sites are designed to include various utility spaces. (b) The locations of 39 edge computing devices (Raspberry Pi v4 model B) in the ceiling. (c) The location of subjects in our data collection.

dead reckoning, the proposed approach reliably and accurately localized multiple subjects continuously over time. The proposed privacy-preserving framework is also cost-effective and easy to install owing to low-cost edge computing devices (approximately \$200 per device). Our system is versatile and can be applied to analyze the movement and interactions of individuals in various contexts, such as healthcare facilities, where this study was conducted. We expect the proposed framework to transform typical indoor spaces into smart environments, providing low-cost, opportunistic services for ambient behavior assessments.

2 Related Work

Indoor localization with BLE: Indoor Localization using BLE is an active research area and is deployed largely in two different approaches: fingerprinting and trilateration [29, 37, 25, 4, 2, 24]. Fingerprinting can precisely localize subjects in absolute locations, which is widespread for its simplicity and bounded positioning error. However, it requires a detailed reference radio grid map assuming that BLE beacons are in fixed spaces. Otherwise, the radio grid map needs to be recalibrated whenever the BLE beacons are moved [6, 11]. In our study site, our edge devices had to be replaced or repositioned frequently so fingerprinting was not applicable.

Trilateration can localize subjects' relative location based on known locations of multiple (3+) BLE beacons using triangulation. Although conceptually simple, the major challenge is that it uses the path loss model to estimate the subject's distance (BLE scanner) from each BLE beacon based on signal strengths. As a result, RSSI needs to be stable to estimate an accurate and consistent location of subjects. Yet, RSSI can fluctuate due to environmental factors such as absorption, diffraction, or interference, which severely degrades localization accuracy. Specifically, in our study, edge devices were placed/hidden in the ceiling where complex metallic structures were present, which made the signal fluctuate, creating inconsistent measurements according to the signal directions. To tackle this challenge, we proposed an adaptive trilateration method that uses the temporal context of RSSI while subjects walk.

Sensor Fusion for Indoor Localization: Many works proposed using other wireless or on-body sensors along with BLE beacons [16, 9] to improve the localization accuracy. WiFi is widely used with BLE as it is easily available in any indoor environment nowadays [1, 15]. Previously, WiFi and BLE hybrid systems were used to optimize fingerprinting with fuzzy logic models [19]. Although effective, we did not use WiFi signals as it was disabled in our edge devices for security reasons. For on-body sensors, IMU sensors are widely used for inertial dead reckoning, which estimated heading and

step counts for deriving trajectory [13, 14, 21, 7]. In this work, we use the standard dead reckoning approach for IMU sensor on the subject's waist that is fused with BLE-based localization to improve localization accuracy [35, 26].

3 Indoor Localization fusing BLE and IMU

Study Environment: The therapeutic space consists of various functioning spaces, including a gym, kitchen, library, dining area, cinema, maker lab, and other bespoke rooms/spaces designed to improve cognition for individuals with MCI. See Figure 1 (a). To track movements in a wide space with a complex structure, we designed an edge computing framework that comprises 39 edge computing units, each containing a Raspberry Pi 4 Model B (4GB of RAM) equipped with a BLE 4 antenna that is placed on the ceiling [30, 17], shown in Figure 1 (b), where network and power sources are accessible nearby. While at the study site, each participant wore a belt bag containing a BLE beacon (Smart Beacon SB18-3 Kontakt.io) and a nine-axis IMU (the Yost 3-Space Data Logger). As subjects walk around, edge computing devices in the range read RSSI from BLE Beacon and accelerometer, gyroscope, and magnetometer from IMU sensors, which data is transmitted to an on-premise, Health Insurance Portability and Accountability Act (HIPAA)-compliant fog server connected via a private wired network that runs localization algorithms, as shown in Figure 2. We employed the Bleak [5] python package and scanned BLE beacons with the sampling frequency of 2Hz. This centralized approach to network storage and localization allows for efficient and accurate management of edge devices, making it an essential component of any privacy-preserving system.

BLE-based Localization: The RSSI value of a BLE signal represents the strength of the signal transmitted by the BLE Beacon and can estimate the distance between the transmitter and receiver. Our beacon has a broadcasting power of -12 dBm. The distance between a beacon and edge device in meters, d , is calculated from the measured RSSI value as follows:

$$d = 10^{\frac{MR_{RSSI} - IR_{RSSI}}{10N}} \quad (1)$$

Where MR_{RSSI} (i.e., 1m RSSI) is the RSSI at a distance of 1 m from the antenna, which the manufacturer gives, and IR_{RSSI} is the instantaneous RSSI measured by the receiver in Decibels (dB). N represents environmental surroundings near and between the receiver and transmitter, which is a function of the medium for electromagnetic wave propagation, such as air ducts or metal structures in the ceiling where edge computing devices are located. We manually derived N

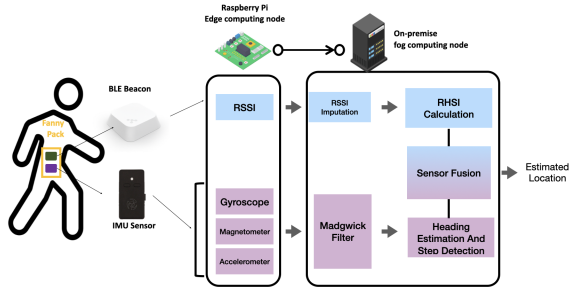

Figure 2: Overall diagram for the proposed indoor localization system using BLE and IMU fusion.

by measuring M_{RSSI} for each edge computing device, as different metallic structures surrounded each device in the ceiling.

Next, the derived distance from the beacon to each edge computing node, d , is integrated to determine subjects' locations adapting a trilateration-based approach [27]. In this work, we propose an adaptive trilateration that additionally considers temporal information, which was found to be robust in noisy environments with sparse BLE receiver distributions. The signals fluctuated due to the metallic objects inside the ceilings, where edge computing devices were located. This severely degraded the performance of the standard trilateration, which heavily relies on accurate distance measurement for points.

Shown in Figure 3, the proposed method considers the weighted average of the distances of nearby edge devices from the subject's beacon within a certain time frame. For every t time window, we calculate the Received Hits Strength Index (RHSI) for every edge device in the range of a beacon, p_1, p_2, \dots, p_n , which counts the number of hits for each edge device, h_1, h_2, \dots, h_n . We empirically found $t = 10\text{sec}$ sufficient to consider meaningful numbers of hits with sufficiently strong RSSI values across p_i s. Due to the fluctuations of RSSI from metallic structures in the ceiling, the hit made from beacons to each edge device was inconsistent, although with 2Hz sampling protocols.

Next, we integrate all RSSI values from all edge devices to localize subjects. First, we derived the potential locations of each subject considering pairs of edge devices. For example, the estimated location between p_i and p_j , which had h_i and h_j hits for the past 10sec , is $m_{i,j} = \frac{h_i p_i + h_j p_j}{h_i + h_j}$. We find this pair-wise location for all pairs of edge devices within the beacon range. Once we find $m_{1,2}, m_{1,3}, m_{1,4}, \dots, m_{n-1,n}$ for all edge device pairs, we calculate the overall weighted centroid using the total number of hits observed in a pair of the device combined, $w_{i,j} = h_i + h_j$. The final estimated location based on the BLE signal is $L_{BLE} = \frac{\sum_i \sum_j w_{i,j} m_{i,j}}{\sum_i \sum_j w_{i,j}}$.

BLE and IMU Fusion: Next, we fuse BLE-based localization with IMU-based tracking methods to improve the tracking and localization quality. First, we applied a standard dead-reckoning technique for an IMU sensor on the subjects' waist [18, 28]. We first denoise the signals by applying a low-pass filter and then estimate step counts and lengths from zero-crossings in accelerometry signals. The headings are estimated using Madgwick filter [20] from accelerometers, gyroscopes, and magnetometers.

The computed IMU-based trajectory is integrated with BLE-based localization with equal weight on each modality. Given a location estimated at time $t - 1$ using both BLE and IMU, $[x_{BLE+IMU}^{t-1}, y_{BLE+IMU}^{t-1}]$,

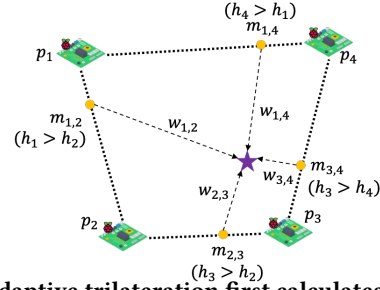

Figure 3: Adaptive trilateration first calculates potential locations, $m_{i,j}$, between each P_i s, p_i and p_j , based on the hits, h_i and h_j , where $i, j = 1, 2, 3, 4$. Then, the $m_{i,j}$ s are aggregated with weights, $w_{i,j} = h_i + h_j$, to localize the subject (star).

$y_{BLE+IMU}^{t-1}$, we estimate the potential location of a subject when only considering the IMU trajectory between time $t - 1$ and t , which is $[x_{IMU}^t, y_{IMU}^t] = [x_{IMU}^{t-1,t} + x_{BLE+IMU}^{t-1,t}, y_{IMU}^{t-1,t} + y_{BLE+IMU}^{t-1,t}]$. Once we have BLE-based location at time t , $[x_{BLE}^t, y_{BLE}^t]$, then we take average with IMU-based estimated location at time t , where BLE and IMU fused location is $[x_{BLE+IMU}^t, y_{BLE+IMU}^t] = [\frac{x_{IMU}^t + x_{BLE}^t}{2}, \frac{y_{IMU}^t + y_{BLE}^t}{2}]$. In summary, the proposed sensor fusion-based method complements BLE's sporadic (2Hz) but relatively smooth localization considering 10sec window with IMU's dense (42Hz) yet noisy trajectory estimation.

4 Experiment and Results

Our benchmark dataset involved three to four individuals walking and interacting as instructed in the study site, shown in Figure 1 (c). To ensure accurate annotation of the subjects' locations and corresponding timestamps, we placed 1-meter markers throughout the entire space. An observer manually labeled the closest marker location of each subject while they walked. With the benchmark datasets, we evaluate the proposed method for five main regions within the study site shown in Figure 1 (a): Right Corridor, Left Corridor, Kitchen, Lounge, and Activity Area.

We evaluated the performances on two levels: positioning error and room-level localization. The positioning error was calculated as Euclidean distance in meters between the estimated and ground-truth locations to understand the error margin of tracking fine-grained movements. The room-level localization was computed as the percentage of times each area/room was predicted correctly while the subject moved within the area. As much as granular movements are essential, understanding room-dwelling profiles can help understand the routine activities of individuals. As a baseline method, we used a standard trilateration approach for BLE-based localization [34] that only uses concurrent beacon hits available at a time for comparison with our proposed method.

Table 1 displays the positioning errors (in meters) and room-level localization accuracies (in %) at each area. Overall, when using BLE and IMU fusion, the proposed method (Table 1, 6th and 8th rows) showed 3.9 m positioning error and 87.1% room-level localization accuracy. This was a significant improvement for both absolute position error (1.56m) and room-level accuracy (4.9%) compared to the baseline method (Table 1, 2nd and 4th rows).

5 Discussion

Indoor Localization Performance: For the proposed method (Table 1, 5th and 6th rows), when only using the BLE-based approach,

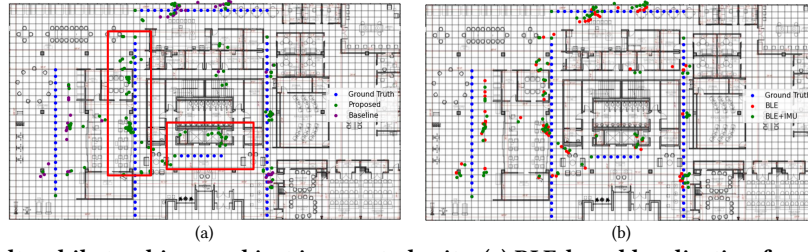

Figure 4: Qualitative results while tracking a subject in our study site. (a) BLE-based localization from baseline method (Purple) and the proposed method (Green). (b) Localization results from the proposed method when only using BLE (Red) and BLE and IMU fusion (Green). Ground-truth locations are shown in (Blue) for both figures.

Table 1: Positioning error (in meters) and room level localization accuracy (in %) in different areas using BLE or both BLE and IMU.

Sensor	Right Corridor	Left Corridor	Kitchen	Lounge	Activity Area	Average
Standard Trilateration						
Positioning error (m)						
BLE only	5.19	4.82	4.66	6.32	6.32	5.97
BLE & IMU	4.82	4.74	4.3	6.53	5.53	5.46
Room Level Accuracy (%)						
BLE only	96	68.6	73	50	81.7	73.8
BLE & IMU	97.3	81	82.6	60.2	88.3	82.2
Adaptive Trilateration						
Positioning error (m)						
BLE only	4.33	3.64	3.68	4.22	4.64	4.22
BLE & IMU	4.01	3.55	4.4	3.63	3.63	3.9
Room Level Accuracy (%)						
BLE only	100	76.3	77.6	58.3	95	81.4
BLE & IMU	100	84.6	83.6	70.6	96.7	87.1

the average localization error across the entire study site was 4.22 m. When BLE and IMU were fused for localization, the localization error was reduced to 3.9 m, showing that dead reckoning information can compensate for errors in BLE-based localization coming from fluctuating RSSI and unequal coverage of signals across space. The room-level localization (Table 1, 7th and 8th rows) was very effective, with an average accuracy of 87.1% when fusing BLE and IMU, which improved 5.7% from when only using BLE only. We consider the fine trajectory available from IMU helps to localize subjects near the borders between each area, as the dead-reckoning method can compensate for fluctuating RSSI when the subject is not moving.

Figure 4 shows qualitative results while following one subject in our study site. Left figure (Figure 4, a) shows the comparison between localization results with the baseline method (Figure 4, a, Red) and the proposed method (Figure 4, a, Purple) against ground-truth locations (Figure 4, a, Blue). Localization results from the baseline method are severely affected by missing detections as it only considers instantaneous BLE beacon hits for trilateration (Red box). The proposed method could track the subject well within 4 meters as shown in Table 1. Right figure (Figure 4, b) shows the comparison between the localization results from the proposed method from BLE-only (Figure 4, b, Red) and BLE-IMU fusion (Figure 4, b, Green). Concerning tracking a subject while moving, IMU fusion demonstrated slightly better performance (30 cm) with BLE-only localization results, as shown in the quantitative results.

Impact of Edge Device Distribution: Figure 5 shows the heatmap representations of the signal reception across the study area, which

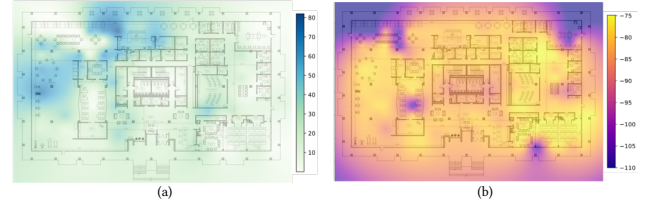

Figure 5: Coverage heatmaps of RSSI signals across study site. The (a) number of hits and (b) average RSSI signal observed in study site depends on the density of edge devices and their surrounding structures.

is collected at the equally spaced 131 locations in our study site. The signal reception and strength across our study site are inconsistent, with some regions having weak or unstable connections, such as Right Corridor and Lounge areas where high positioning error was showing Table 1. RSSI can fluctuate due to environmental factors, such as walls or furniture, which can block or redirect the signal [12]. As expected, local regions with more edge devices, such as Left Corridor, Kitchen, and Activity Area, have more number of hits (Figure 5, a) and higher average RSSI (Figure 5, b), which means more robust and more consistent signal strength from beacons. As a result, those areas demonstrated lower positioning errors in Table 1 compared to other regions. Signal coverage analysis explains the failure of standard trilateration in our study site, which depends on the accurate distance measures between each edge device and beacon.

6 Conclusion

This work proposes an open-source and scalable indoor localization approach fusing BLE and IMU wearable sensors using distributed edge computing systems in large indoor spaces. Our analysis shows that, especially for large indoor space (over 1600 m²) with complex structures, unequal distribution of edge devices can result in inconsistent coverage of signals that can significantly challenge the BLE-based localization approach. Yet, the proposed adaptive trilateration approach that uses the temporal density of hits from BLE beacons can robustly localize the position of multiple people with an average error of 4 m across the entire study space, also showing 87% accuracy for room-level localizations. Integrating IMU-based dead-reckoning with BLE-based localization further enhanced the system's accuracy. In our future work, we expect to deploy the proposed work to analyze space navigation behaviors for individuals with MCI, which is known to be an indicator of cognitive impairment [10].

References

- [1] Kiril Antevski, Alessandro EC Redondi, and Razvan Pitic. 2016. A hybrid ble and wi-fi localization system for the creation of study groups in smart libraries. In *2016 9th IFIP wireless and mobile networking conference (WMNC)*. IEEE, 41–48.
- [2] Mohammadamin Atashi, Parvin Malekzadeh, Mohammad Salimibeni, Zohreh Hajiakhondi-Meybodi, Konstantinos N Plataniotis, and Arash Mohammadi. 2021. Orientation-matched multiple modeling for rssi-based indoor localization via ble sensors. In *2020 28th European Signal Processing Conference (EUSIPCO)*. IEEE, 1702–1706.
- [3] Lu Bai, Fabio Ciravegna, Raymond Bond, and Maurice Mulvenna. 2020. A low cost indoor positioning system using bluetooth low energy. *Ieee Access*, 8, 136858–136871.
- [4] Chaimaa Basri and Ahmed El Khadimi. 2016. Survey on indoor localization system and recent advances of wifi fingerprinting technique. In *2016 5th International Conference on Multimedia Computing and Systems (ICMCS)*. IEEE, 253–259.
- [5] Henrik Blidh. 2022. Bleak. <https://bleak.readthedocs.io/en/latest/>. [Available online; Accessed on 21 November 2022]. (2022).
- [6] Xiaoyong Chai and Qiang Yang. 2007. Reducing the calibration effort for probabilistic indoor location estimation. *IEEE Transactions on Mobile Computing*, 6, 6, 649–662.
- [7] Diansheng Chen, Wei Feng, Qiteng Zhao, Muhua Hu, and Tianmiao Wang. 2012. An infrastructure-free indoor navigation system for blind people. In *Intelligent Robotics and Applications: 5th International Conference, ICIRA 2012, Montreal, QC, Canada, October 3-5, 2012, Proceedings, Part III* 5. Springer, 552–561.
- [8] I. cheol Jeong, D. Bychkov, S. Hiser, J. D. Kreif, L. M. Klein, E. H. Hoyer, and P. C. Searson. 2017. Using a real-time location system for assessment of patient ambulation in a hospital setting. *Archives of Physical Medicine and Rehabilitation*, 98, 7, 1366–1373.
- [9] Hui-Seon Gang and Jae-Young Pyun. 2019. A smartphone indoor positioning system using hybrid localization technology. *Energies*, 12, 19, 3702.
- [10] A. Ghosh, V. Puthusseriypady, D. Chan, C. Mascolo, and M. Hornberger. 2022. Machine learning detects altered spatial navigation features in outdoor behaviour of alzheimer's disease patients. *Scientific Reports*, 12, 1, 3160.
- [11] Raúl Guzmán-Quiros, Alejandro Martínez-Sala, José Luis Gómez-Tornero, and Joan García-Haro. 2015. Integration of directional antennas in an rssi fingerprinting-based indoor localization system. *Sensors*, 16, 1, 4.
- [12] Zohreh Hajiakhondi-Meybodi, Mohammad Salimibeni, Konstantinos N Plataniotis, and Arash Mohammadi. 2020. Bluetooth low energy-based angle of arrival estimation via switch antenna array for indoor localization. In *2020 IEEE 23rd International Conference on Information Fusion (FUSION)*. IEEE, 1–6.
- [13] Ke Huang, Ke He, and Xuecheng Du. 2019. A hybrid method to improve the ble-based indoor positioning in a dense bluetooth environment. *Sensors*, 19, 2, 424.
- [14] Harun Jamil, Faiza Qayyum, Faisal Jamil, and Do-Hyeun Kim. 2021. Enhanced pdr-ble compensation mechanism based on hmm and awcla for improving indoor localization. *Sensors*, 21, 21, 6972.
- [15] Loizos Kanaris, Akis Kokkinis, Antonio Liotta, and Stavros Stavrou. 2017. Fusing bluetooth beacon data with wi-fi radiomaps for improved indoor localization. *Sensors*, 17, 4, 812.
- [16] Marcin Kolakowski. 2017. Kalman filter based localization in hybrid ble-uwbb positioning system. In *2017 IEEE International Conference on RFID Technology & Application (RFID-TA)*. IEEE, 290–293.
- [17] Hyeokhyen Kwon et al. 2023. Indoor localization and multi-person tracking using privacy preserving distributed camera network with edge computing. *arXiv preprint arXiv:2305.05062*.
- [18] Xin Liu, Ning Li, Geng Xu, and Yonggang Zhang. 2020. A novel robust step detection algorithm for foot-mounted imu. *IEEE Sensors Journal*, 21, 4, 5331–5339.
- [19] Basem Al-Madani, Farid Orujov, Rytis Maskeliūnas, Robertas Damaševičius, and Algimantas Venčkauskas. 2019. Fuzzy logic type-2 based wireless indoor localization system for navigation of visually impaired people in buildings. *Sensors*, 19, 9, 2114.
- [20] Sebastian OH Madgwick, Andrew JL Harrison, and Ravi Vaidyanathan. 2011. Estimation of imu and marg orientation using a gradient descent algorithm. In *2011 IEEE international conference on rehabilitation robotics*. IEEE, 1–7.
- [21] Apostolos Meliones and Demetrios Sampson. 2018. Blind museumtourer: a system for self-guided tours in museums and blind indoor navigation. *Technologies*, 6, 1, 4.
- [22] Nic Newman. 2014. Apple ibeacon technology briefing. *Journal of Direct, Data and Digital Marketing Practice*, 15, 222–225.
- [23] Umair Mujtaba Qureshi, Zuneera Umair, and Gerhard Petrus Hancke. 2019. Evaluating the implications of varying bluetooth low energy (ble) transmission power levels on wireless indoor localization accuracy and precision. *Sensors*, 19, 15, 3282.
- [24] Hani Ramadhan, Yoga Yustiawan, and Joonho Kwon. 2020. Applying movement constraints to ble rssi-based indoor positioning for extracting valid semantic trajectories. *Sensors*, 20, 2, 527.
- [25] Alvin Riady and Gede Putra Kusuma. 2022. Indoor positioning system using hybrid method of fingerprinting and pedestrian dead reckoning. *Journal of King Saud University-Computer and Information Sciences*, 34, 9, 7101–7110.
- [26] Jenny Röbesaat, Peilin Zhang, Mohamed Abdelal, and Oliver Theel. 2017. An improved ble indoor localization with kalman-based fusion: an experimental study. *Sensors*, 17, 5, 951.
- [27] Sebastian Sadowski and Petros Spachos. 2018. Rssi-based indoor localization with the internet of things. *IEEE Access*, 6, 30149–30161.
- [28] Mohammad Salimibeni, Zohreh Hajiakhondi-Meybodi, Parvin Malekzadeh, Mohammadamin Atashi, Konstantinos N Plataniotis, and Arash Mohammadi. 2021. Iot-td: iot dataset for multiple model ble-based indoor localization/tracking. In *2020 28th European Signal Processing Conference (EUSIPCO)*. IEEE, 1697–1701.
- [29] Petros Spachos, Ioannis Papapanagiotou, and Konstantinos N Plataniotis. 2018. Microlocation for smart buildings in the era of the internet of things: a survey of technologies, techniques, and approaches. *IEEE Signal Processing Magazine*, 35, 5, 140–152.
- [30] Pradyumna Byappanahalli Suresha, Chaitra Hegde, Zifan Jiang, and Gari D. Clifford. 2022. An edge computing and ambient data capture system for clinical and home environments. *Sensors*, 22, 7. DOI: 10.3390/s22072511.
- [31] Kevin Townsend, Carles Cufi, Robert Davidson, et al. 2014. *Getting started with Bluetooth low energy: tools and techniques for low-power networking*. O'Reilly Media, Inc.
- [32] T. Van Haute, E. De Poorter, P. Crombez, F. Lemic, V. Handziski, N. Wirstrom, A. Wolisz, T. Voigt, and I. Moerman. 2016. Performance analysis of multiple indoor positioning systems in a healthcare environment. *International Journal of Health Geographics*, 15, 1, 1–15.
- [33] N. K. Vuong, S. Chan, and C. T. Lau. 2014. Automated detection of wandering patterns in people with dementia. *Gerontechnology*, 12, 3, 127–147.
- [34] Yapeng Wang, Xu Yang, Yutian Zhao, Yue Liu, and Laurie Cuthbert. 2013. Bluetooth positioning using rssi and triangulation methods. In *2013 IEEE 10th Consumer Communications and Networking Conference (CCNC)*. IEEE, 837–842.
- [35] Oliver Woodman and Robert Harle. 2008. Pedestrian localisation for indoor environments. In *Proceedings of the 10th international conference on Ubiquitous computing*, 114–123.
- [36] S. Yoo, S. Kim, E. Kim, E. Jung, K. Lee, and H. Hwang. 2018. Real-time location system-based asset tracking in the healthcare field: lessons learned from a feasibility study. *BMC Medical Informatics and Decision Making*, 18, 1, 1–10.
- [37] Faheem Zafari, Ioannis Papapanagiotou, and Konstantinos Christidis. 2015. Microlocation for internet-of-things-equipped smart buildings. *IEEE Internet of Things Journal*, 3, 1, 96–112.