

Direct Servo Control from In-Sensor CNN Inference with A Pixel Processor Array

Yanan Liu
Bristol Robotics Laboratory
University of Bristol
Bristol, UK
yanan.liu@bristol.ac.uk

Jianing Chen
School of Electrical & Electronic Engineering
University of Manchester
Manchester, UK
jianing.chen@manchester.ac.uk

Laurie Bose
Visual Information Laboratory
University of Bristol
Bristol, UK
lauriebose@gmail.com

Piotr Dudek
School of Electrical & Electronic Engineering
University of Manchester
Manchester, UK
p.dudek@manchester.ac.uk

Walterio Mayol-Cuevas
Visual Information Laboratory
University of Bristol
Bristol, UK
walterio.mayol-cuevas@bristol.ac.uk

Abstract—This work demonstrates direct visual sensory-motor control using high-speed CNN inference via a SCAMP-5 Pixel Processor Array (PPA). We demonstrate how PPAs are able to efficiently bridge the gap between perception and action. A binary Convolutional Neural Network (CNN) is used for a classic rock, paper, scissors classification problem at over 8000 FPS. Control instructions are directly sent to a servo motor from the PPA according to the CNN’s classification result without any other intermediate hardware.

Index Terms—in-sensor computing, SCAMP vision system, sensory motor, binary neural network

I. INTRODUCTION

Real-time image capture, processing, and decision making with low-power consumption are essential for next-generation smart sensors. If a complete neural network inference can be carried out on-sensor, it allows the sensor output to be reduced from entire images to only a small amount of meaningful extracted information used to determine actions. This considerably reduces the communication and energy costs with auxiliary devices. In-sensor visual computing is an area of growing interest [1]. The SCAMP vision system is such an in-sensor visual computing device that performs image processing while sensing and without recording images and while using low power consumption [2], [3]. This is in contrast to a conventional vision system and other non on-sensor computing cameras, where the understanding of the visual inputs happens only after the visual data is transmitted to, and processed by, CPUs and or GPUs, resulting in extra latency and power consumption. This paper illustrates how the SCAMP vision system can operate as an “edge AI” sensor, enabling on-sensor CNN inference and direct action execution with a servo motor, as shown in Fig. 1.

This work is accepted by ICRA2021 workshop On and Near-sensor Vision Processing, from Photons to Applications (ONSVP). This work was supported by UK EPSRC EP/M019454/1, EP/M019284/1, EPSRC Centre for Doctoral Training in Future Autonomous and Robotic Systems: FARSCOPE and China Scholarship Council (No. 201700260083).

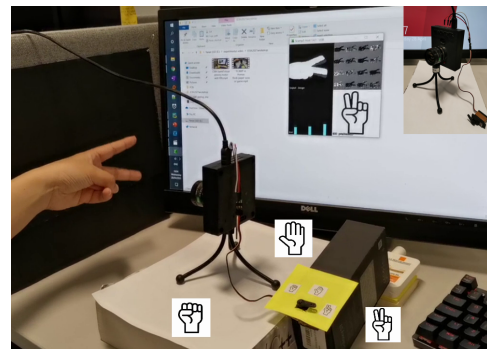

Fig. 1. A servo motor is directly driven by the SCAMP vision system without additional intermediate hardware. With the machine vision computing results from the SCAMP vision system, the servo can be instructed accordingly. An Align DS425M digital servo is used in this work.

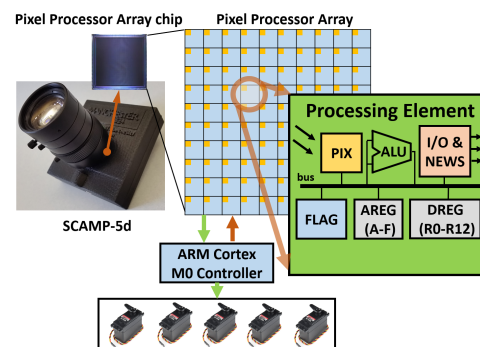

Fig. 2. The CNN inference in this work is wholly performed on the PPA and the servos can be controlled through GPIO from the ARM M0 controller. A maximum of 5 servos is supported to set up a more comprehensive sensory-motor system.

II. BINARY CNN ON THE PPA

During recent years, there have been many types of CNN binarization methods proposed [4] to minimise CNN model size,

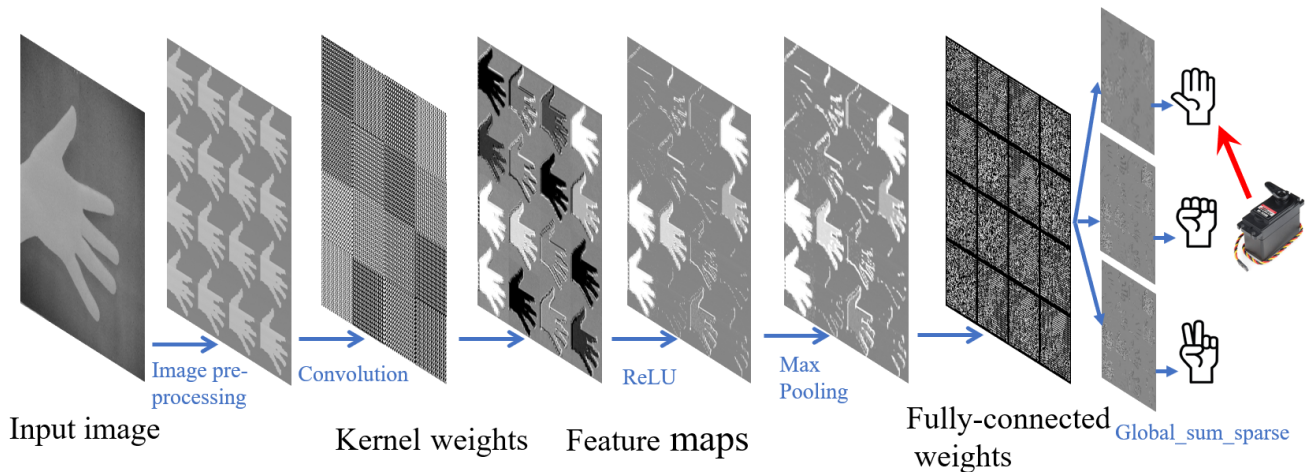

Fig. 3. Binary CNN inference on the PPA for hand gesture recognition with direct servo control. Image convolution, ReLU activation function, max pooling and fully connected are performed in parallel on the sensing plane.

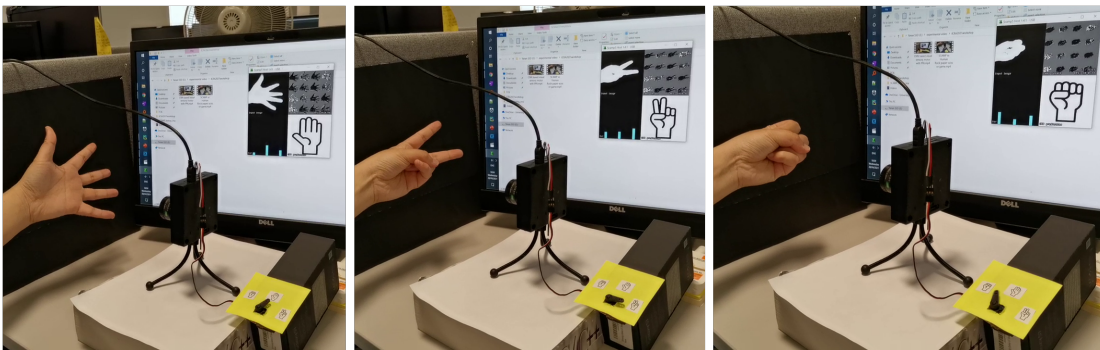

Fig. 4. CNN inference for hand gesture recognition with a servo as the result indicator.

improve inference efficiency, and reduce power cost. However, embedded hardware usually has its own dedicated hardware design which is not universally applicable to all forms of binary neural network. To deal with this problem for PPA, this work trains and deploys a binary CNN (with kernel weights and fully connected weights of $-1, 1$) onto PPA to fully take advantage of its in-sensor parallel computing feature. Binary weights for both convolutional and fully connected layers are stored in the digital registers (DREG) of the SCAMP processor array (Fig. 2). The processing scheme is illustrated in detail in Fig. 3. Firstly, the analogue PIX registers acquire light signals, forming the image to be passed through the network. Then the image is binarised, resized and replicated into a dimension of $16 \times 64 \times 64$ using on-sensor processing. Different convolution operations are then carried out simultaneously on these 16 replicated images. Then the activation function ReLU sets negative values to zero. Followed by the 2×2 maxpooling, a maximum value is selected and replicated within each 2×2 block. Lastly, the fully connected layer is implemented by activating each label's AREG and then using the SCAMP built-in global summation function to obtain the approximated value for each label. The index for the biggest summation

represents the final CNN inference result [5].

III. EXPERIMENTS

Fig. 1 and 4 shows the test-bed for the sensory-motor system. The USB link from the computer is used for power supply and transmission of visualisation data. We extended our previous work [5], [6] by adding the implementation of the direct servo control using the binary CNN inference results. This work is based on the SCAMP-collected hand gesture dataset which consist of gestures for 'rock', 'paper', and 'scissors'. The servo motor is controlled through pulse-width modulation on the ARM Cortex M0 processor embedded in the SCAMP system, where the computing results are shared from the PPA. We perform the experiments on three types of hand gesture recognition. This basic setup is used here as a test-bed for bridging perception to action. After the implementation of CNN on the SCAMP, the experimental results (details can be seen from the video results) offer recognition accuracy of $>97\%$ with a latency of $121\mu s$ and max theoretical throughput of 8264 FPS [5]. Note the data transmission to a computer for visualisation slows down the overall FPS, which can be noticed from the experimental video. In addition, the reaction of a servo to inference results

is slower than the visualisation updates which results from the low control frequency of only 333 Hz. The experimental video can be seen at <https://youtu.be/gHcuv275Qrk> with a $\times 20$ slow motion available from <https://youtu.be/SAMsIqqCZ7I>

IV. CONCLUSIONS AND FUTURE WORK

A visual sensory-motor scheme based on the PPA is presented in this work, where a servo is directly controlled by the focal-plane CNN inference without additional computing units. We believe that closing the gap between perception and action, through in-sensor computing strategies, is essential for agile and efficient robotic systems.

REFERENCES

- [1] F. Zhou and Y. Chai, "Near-sensor and in-sensor computing," *Nature Electronics*, vol. 3, no. 11, pp. 664–671, 2020.
- [2] J. Chen, S. J. Carey, and P. Dudek, "Scamp5d vision system and development framework," in *Proceedings of the 12th International Conference on Distributed Smart Cameras*, 2018, pp. 1–2.
- [3] S. J. Carey, A. Lopich, D. R. Barr, B. Wang, and P. Dudek, "A 100,000 fps vision sensor with embedded 535gops/w 256×256 simd processor array," in *2013 Symposium on VLSI Circuits*. IEEE, 2013, pp. C182–C183.
- [4] T. Simons and D.-J. Lee, "A review of binarized neural networks," *Electronics*, vol. 8, no. 6, p. 661, 2019.
- [5] Y. Liu, L. Bose, J. Chen, S. J. Carey, P. Dudek, and W. Mayol-Cuevas, "High-speed light-weight cnn inference via strided convolutions on a pixel processor array," in *The 31st British Machine Vision Conference (BMVC)*, 2020.
- [6] L. Bose, P. Dudek, J. Chen, S. J. Carey, and W. W. Mayol-Cuevas, "Fully embedding fast convolutional networks on pixel processor arrays," in *European Conference on Computer Vision – ECCV 2020*.