

Insights from BB-MAS - A Large Dataset for Typing, Gait and Swipes of the Same Person on Desktop, Tablet and Phone

Amith K. Belman*, Li Wang[†], S. S. Iyengar[†], Paweł Śniatała[‡],
Robert Wright[§], Robert Dora[§], Jacob Baldwin[§], Zhanpeng Jin^{||} and Vir V. Phoha*

*Syracuse University, {akamathb,vvphoha}@syr.edu

[†]Florida International University, {lwang059, iyengar}@cs.fiu.edu

[‡]Poznań University of Technology, pawel.sniatala@put.poznan.pl

[§]Assured Information Security, Inc., {wrightr, dorar, baldwin}@ainfosec.com

^{||}University at Buffalo, SUNY, zjin@buffalo.edu

Abstract—Behavioral biometrics are key components in the landscape of research in continuous and active user authentication. However, there is a lack of large datasets with multiple activities, such as typing, gait and swipe performed by the same person. Furthermore, large datasets with multiple activities performed on multiple devices by the same person are non-existent. The difficulties of procuring devices, participants, designing protocol, secure storage and on-field hindrances may have contributed to this scarcity. The availability of such a dataset is crucial to forward the research in behavioral biometrics as usage of multiple devices by a person is common nowadays. Through this paper, we share our dataset, the details of its collection, features for each modality and our findings of how keystroke features vary across devices. We have collected data from 117 subjects for typing (both fixed and free text), gait (walking, upstairs and downstairs) and touch on Desktop, Tablet and Phone. The dataset consists a total of about: 3.5 million keystroke events; 57.1 million data-points for accelerometer and gyroscope each; 1.7 million data-points for swipes; and enables future research to explore previously unexplored directions in inter-device and inter-modality biometrics. Our analysis on keystrokes reveals that in most cases, keyhold times are smaller but inter-key latencies are larger, on hand-held devices when compared to desktop. We also present; detailed comparison with related datasets; possible research directions with the dataset; and lessons learnt from the data collection.

Index Terms—Biometric Dataset, Keystroke, Gait, Stairs, Phone, Tablet, Desktop.



1 INTRODUCTION

THE recent advancements in active or continuous authentication using behavioral biometrics show that they are promising complements to existing one-time authentication methods like PINs, passwords, fingerprint, etc., generally deployed at the entry points of a system. Behavioral biometrics have an implicit usability advantage as the process of authentication is not separate from whatever the user intends to do with the system. In other words, whatever the user activity is, it becomes a mode of authentication. Researchers have explored various modalities such as keystrokes ([1], [2], [3]), gait ([4], [5], [6]), swipes on touch screen ([7], [8], [9]) to name a few. With growing number of devices used by a person, research in continuous authentication or behavior analysis will have span across devices and activities to stay relevant. However, the scarcity of benchmark datasets for such scenarios are a hindrance. Several attempts have been made to provide benchmark datasets for a single activity like keystrokes ([10], [11], [12], [13], [14], [15], [16]), gait ([17], [18], [19], [20]) or swipes ([7], [9], [21], [22]) on a single device family like desktop or phone. Few attempts were also made to share benchmark datasets with multiple activities using single device ([23], [24]). However, no benchmark dataset exists for multi-activity in multi-device scenario, where the same activities were performed

by the same users on multiple devices. We attempt to fill this gap and provide a benchmark dataset with BB-MAS (Behavioral Biometrics Multi-device and multi-Activity data from Same users) dataset where the same participants have provided typing, gait and swiping data on desktop, phone and tablet.

A total of 117 participants have provided data voluntarily. Each participant has performed typing (including transcription and free text), gait (including walking on a flat corridor, upstairs and downstairs) and swiping using desktop, phone and tablet. The data collection spanned about 3 months and various anonymized demographics information is provided for each participant. The unique ID allocated to the participant is used on all devices and activities.

1.1 Key Contributions:

- Insights from analysis on how the keystroke feature values vary between desktop, tablet and phone for the same users are presented. We find the keyhold times are smaller and inter-key latencies are larger on hand-held devices when compared to desktop. We posit that, difference in number of contact points while typing (fewer on hand-held device) may lead to such patterns.

- To the best of our knowledge, a dataset with the typing, gait and touch data from the same users on desktop, tablet and phone is not available publicly at the time of this writing. With data from 117 participants our dataset stands out as unique and rich for exploration in various directions. Each participant's session ranged between 2 to 2.5 hours, resulting in a total of about: 3.5 million keystroke events; 57.1 million data-points for accelerometer and gyroscope each; 1.7 million data-points for swipes.
- Features that are commonly described in literature, for data from all activities are described, extracted and shared alongside the raw data.
- We compare our dataset with other related datasets for keystroke, gait and swipe and highlight their novelty, differences and advantages.
- Possible research directions using the BB-MAS dataset are discussed and lessons learnt from this elaborate data-collection effort are shared to help future researchers on similar endeavours.

Data collection was carried out between April and June of 2017, after the IRB approval from our university. All participants signed consent forms and have willingly participated in this data collection. All data has been anonymized and any personal identifiers in the data are removed. All subjects, their data and demographic information can only be referenced through the unique participant ID provided to them.

2 DATA COLLECTION

The dataset was designed to capture the behavior of the same users performing various day-to-day activities, such as typing, gait and swipes on three commonly used devices such as, desktop, tablet and phone. Activities were deliberately designed to mimic real-life scenarios, for instance, the typing activity consists of both fixed and free text data, the gait activity consists of walking on flat corridors, walking downstairs and upstairs and touch and swipe data consists of activities such as reading and scrolling. The raw data and the features extracted are shared publicly and can be accessed at <http://dx.doi.org/10.21227/rpaz-0h66>.

2.1 Devices

Three most commonly used devices type in current times were selected for our data collection. A desktop, tablet and phone would cover most of our modern-day interactions with devices. The details of the devices used in our data collection are as below:

- **Desktops:** Two identical desktop stations were setup. Each desktop station consisted of a standard QWERTY keyboard (Dell kb212-b), an optical mouse (Dell ms111-p) and a Dell 21 inch monitor. The keystrokes, mouse movements and clicks were logged.
- **Tablets:** HTC-Nexus-9 tablets were used for the tablet section of the data collection. These tablets had a screen size of 8.9 inches, screen resolution of 1536 x 2048 pixels, device dimensions of 9 x 6 x 0.3 inches (Length X Width X Height) and weighed about 435 grams. Keystrokes, accelerometer, gyroscope and touch were logged.

- **Phones:** Two different models of phones, Samsung-S6 and HTC-One phones were used in the data collection. The Samsung Galaxy S6 had a screen size of 5.1 inches and screen resolution of 1440 x 2560 pixels with body dimensions of 143.4 x 70.5 x 6.8 mm and weighing 138 grams, whereas the HTC-One had a screen size of 5.0 inches and screen resolution of 1080 x 1920 pixels with body dimensions of 146.4 x 70.6 x 9.4 mm and weighing 160 grams. Keystrokes, accelerometer, gyroscope and touch were logged. The raw data files from different models are identified by the suffix in the file names explained in detail in Section 2.3.

As the default android keyboard does not allow logging of keystrokes, we created and used an android qwerty keyboard on screen which was similar to the default android qwerty keyboard. The phones and tablets were locked in portrait orientation and users were allowed to type on them with any comfortable posture that they preferred. The details of the data collected from these devices and their formats is described in Section 2.3. Figure 1 shows a screenshot of the application with the keyboard for phone. The application on tablet had the same layout but was scaled to match the default keyboard of an android tablet.

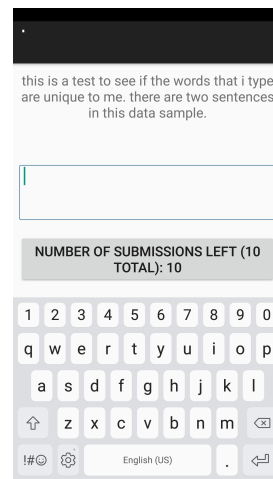

Fig. 1: A screenshot from our phone application showing our keyboard to match the default android keyboard.

2.2 How was the data collected?

Emails were sent out to all students, faculty, and staff to procure the participant population. Each participant had to spend two hours on average to perform the set of sequential tasks as illustrated in Fig. 2.

Upon arrival at the data collection location, each participant answered a set of questions that pertained to his/her demographics and technology usage. The participant was then assigned a unique ID and four devices: a desktop, a tablet and two phones (See Table 1). The participant then performed the tasks **a** to **m** in sequence. **a**) The participant was asked to sit at the desktop and type two sections of text (fixed-text), ten times each. Each piece of text consisted of two sentences and had an average of 112 characters. The participant was then given a shopping list consisting of six items. They had to use a popular web-browser (Mozilla

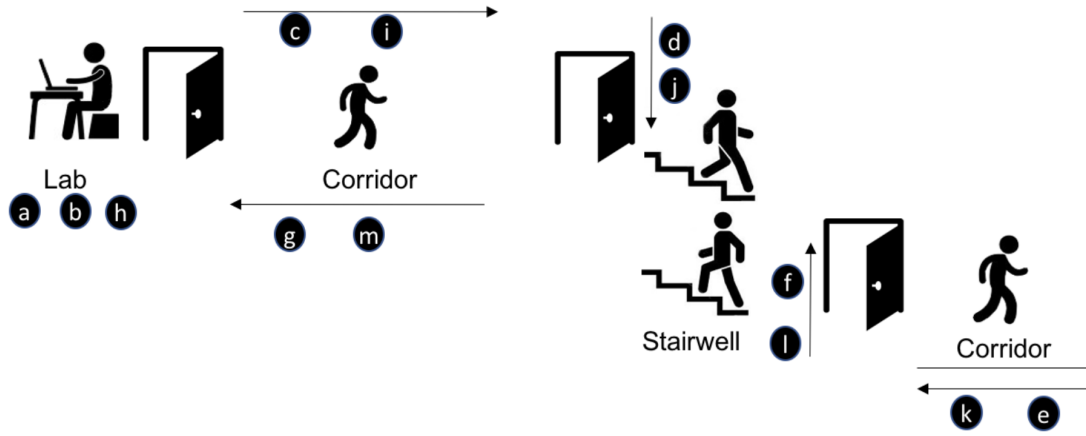

Fig. 2: The data collection procedure. Tasks a to m were performed by participants in sequence, the corresponding activities and data collected are described in Table 1

Firefox) to browse for the best prices for the six items on the list while making notes (on any familiar text editor) about prices, opinions and thoughts. The participant was then given a list of 12 questions of varying cognitive loads (see Appendix A - F) and asked to type their answers in any order he/she preferred for roughly about fifteen minutes. For the entire duration of task a, keystroke and mouse loggers were deployed on the desktop to log all the actions that the participant performed during this task. b) After the completion of task a, the participant was handed a tablet which was running an application where he/she was asked to type the two pieces of static text again followed by a series of ten questions with varying cognitive loads to be answered with a minimum of 50 characters. The questions were placed in a manner that required the participant to swipe vertically and horizontally between questions. For the entire duration of task b, keystroke, touch, accelerometer, and gyroscope loggers were deployed on the tablet to log all typing, swiping, touch, and movement events. After the completion of task b, the participant was asked to place a phone (Phone1) in his/her pants pocket and made to walk in a predefined path while holding the tablet in hand. The path consisted of three doorways and a stairwell, as shown in Figure 2. The tablet displayed buttons to be pressed by the participant before and after passing through a doorway and also before and after taking the staircase. The tasks c, e, and g required the participant to walk, and tasks d and f required the participant to climb downstairs and upstairs respectively. Throughout the tasks c to g, the tablet and the phone (Phone1) logged the accelerometer and gyroscope values. The tablet also logged the pressing of the buttons (doorway and staircase) by the participant.

Upon completion of task g, the tablet was taken from the participant and another phone (Phone2) was handed to them. For task h, Phone2 ran the same application as the tablet in task b, where the participant had to type the two pieces of static text followed by a series of ten questions (not repeated from task b) with varying cognitive loads to be answered with a minimum of 50 characters, requiring the user to swipe between questions. Phone2 logged all keystroke, touch, accelerometer and gyroscope values for

typing, swiping, touch, and movement events. Tasks i to m are similar to tasks c to g, differing only in that the participant held Phone2 (instead of the tablet) and Phone1 remained in pocket while performing tasks i to m. Phone1 and Phone2 logged all accelerometer and gyroscope values. Phone2 also logged the pressing of buttons (doorway and staircase) by the participant.

2.3 What is the format of the data?

The raw data from all sensors was originally written to sql databases for speed and accuracy. However, for the convenience of researchers, the raw data and the features extracted from them are organized in simple flat file structure in comma separated format (csv) shared at <http://dx.doi.org/10.21227/rpaz-0h66>. This section elaborates the organization and format of both raw data files and feature extracted files. Fig. 3 gives an overview of the entire dataset. It is important that the dataset is clearly understood by its researchers for successful research. Therefore, we explain our dataset in great detail in this section.

2.3.1 Raw Data

The raw data from each sensor for each user is stored in folder labelled with the user's ID. As shown in Fig. 3, folders "1" to "117" contain the raw data files for each user, the prefix <ID> is used to denote the user's ID. The details and format of the raw data files are as follows:

- **Keystroke Data:** The temporal data of every key press and release performed by the subject during tasks a, b and h (Table 1) were logged. These files are named;

- <ID>_Desktop_Keyboard.csv
- <ID>_HandTablet_Keyboard.csv
- <ID>_HandPhone_Keyboard.csv

accordingly. These files consist four columns, "EID": event ID (Integer); "key": the key triggering the key-event (String); "direction": the type of key-event (Integer, 0 for press and 1 for release); and "time": the timestamp of the key-event (String in date-time format with millisecond resolution). Table 2 provides an example of keystroke files with a snippet from user 1 in our dataset.

TABLE 1: Data collection tasks performed by the participants. For each participant we recorded activities on four devices - a Desktop, a Tablet and two Phones (pocket and hand).

Task	Device	Activity	Data	Duration (Approx.)
a	Desktop	Typing, Browsing	Keystroke and Mouse	50 min
b	Tablet	Typing	Keystroke, Swipe, Accelerometer, Gyroscope	25 min
c		Walking		
d	Tablet (in hand)	Climbing down stairs		
e	Phone1 (in pocket)	Walking	Accelerometer, Gyroscope	5 min
f		Climbing upstairs		
g		Walking		
h	Phone2 (in hand)	Typing	Keystroke, Swipe, Accelerometer, Gyroscope	25 min
i		Walking		
j	Phone2 (in hand)	Climbing down stairs		
k	Phone1 (in pocket)	Walking	Accelerometer, Gyroscope	5 min
l		Climbing upstairs		
m		Walking		

TABLE 2: Example for keystroke files from user 1.

EID	key	direction	time
0	t	0	2017-04-14 18:09:41.538
1	t	1	2017-04-14 18:09:41.679
2	i	0	2017-04-14 18:09:41.819
..

TABLE 4: Example for mouse button data from user 1.

EID	rX	rY	pX	pY	LR	state	time
0	6	-4	1285	242	0	0	2017-04-14 18:21:17.783
1	-1	3	811	265	0	1	2017-04-14 18:21:21.761
2	0	0	811	265	0	0	2017-04-14 18:21:22.120
..

- **Mouse Data:** In addition to keystrokes, data from mouse usage was also collected during task **a** (Table 1). Please note that there were sampling issues with the mouse data resulting in smaller files, they are included, nonetheless. Mouse events such as, movement, button and wheel were logged into files named;

- <ID>_Mouse_Move.csv
- <ID>_Mouse_Button.csv
- <ID>_Mouse_Wheel.csv

respectively. The Mouse_Move file has six columns, "EID": event ID (Integer); "rX" and "rY": the x and y coordinates relative to the active window (Integer); "pX" and "pY": the x and y coordinate on screen (Integer); and "time": the timestamp of the mouse-event (String in date-time format with millisecond resolution). The Mouse_Button file has eight columns, six of them are the same as described for Mouse_Move, "LR": mouse button (Integer, 0 for left or 1 for right) and "state": type of button event (Integer, 0 for press and 1 for release) are the additional columns. The Mouse_Wheel file has seven columns, six of them are the same as described for Mouse_Move in addition to, "delta": direction of scroll (Integer, Negative for scroll-down and positive for scroll-up). Tables 3, 4 and 5 provide an example mouse movement, button and wheel data respectively, from user 1.

TABLE 3: Example for mouse movement data from user 1.

EID	rX	rY	pX	pY	time
0	4	-8	1004	577	2017-04-14 18:09:29.948
1	8	-14	1919	0	2017-04-14 18:09:30.228
2	-2	-26	1916	0	2017-04-14 18:21:13.712
..

- **Accelerometer and Gyroscope Data:** For tasks from **b**

TABLE 5: Example for mouse wheel data from user 1.

EID	rX	rY	pX	pY	delta	time
0	0	0	1594	708	120	2017-04-14 18:23:10.936
1	0	0	1545	708	120	2017-04-14 18:23:12.000
2	0	0	1618	708	120	2017-04-14 18:23:12.575
..

through **m** (Table 1), the values from accelerometer and gyroscope sensors were logged on suitable devices, such as tablet: for tasks **c - g**; phone in pocket: for tasks **c - g** and **i - m**; and phone in hand: for tasks **i - g**. The sampling rate for these sensors was about 100Hz. The files with accelerometer and gyroscope from the tablet are named;

- <ID>_HandTablet_Accelerometer.csv
- <ID>_HandTablet_Gyroscope.csv

those from the phone in the pocket are named;

- <ID>_PocketPhone_Accelerometer.csv
- <ID>_PocketPhone_Gyroscope.csv

and from the phone in hand are named;

- <ID>_HandPhone_Accelerometer.csv
- <ID>_HandPhone_Gyroscope.csv

respectively. The accelerometer files have five columns, "EID": event ID (Integer); "Xvalue", "Yvalue", "Zvalue": the acceleration force in m/s^2 on x, y and z axes respectively, excluding the force of gravity (Float); and "time": the timestamp of the data point (String in date-time format with millisecond resolution). The gyroscope data have the same five columns, but "Xvalue", "Yvalue" and "Zvalue" is the rate of rotation in rad/s around x, y and z axis respectively (Float). Tables 6 and 7 show an example for accelerometer and gyroscope data respectively, from user 1.

- **Swipe Data:** For tasks **b** and **h**, data from swipes were

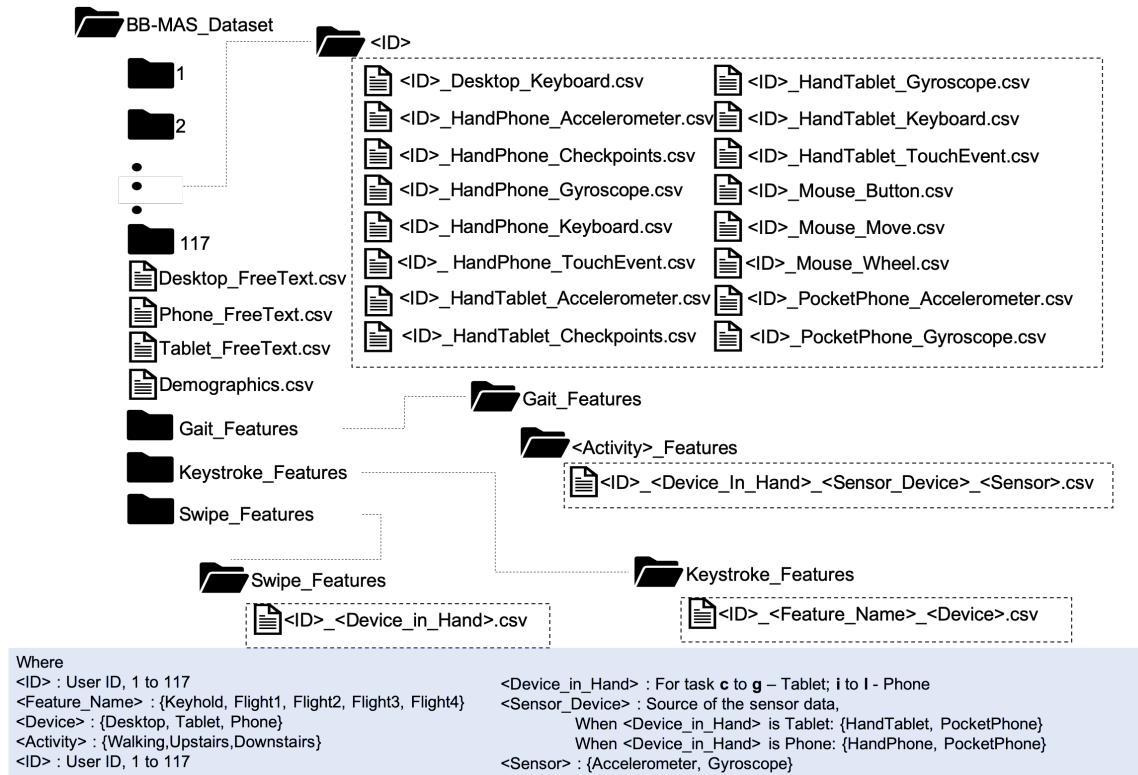

Fig. 3: Organisation of the files in our dataset.

TABLE 6: Example for accelerometer data from user 1.

EID	Xvalue	Yvalue	Zvalue	time
0	1.043	3.245	9.087	2017-04-14 18:56:40.215
1	0.995	3.303	8.936	2017-04-14 18:56:40.216
2	0.988	3.355	8.880	2017-04-14 18:56:40.234
..

TABLE 7: Example for gyroscope data from user 1.

EID	Xvalue	Yvalue	Zvalue	time
0	-0.045	0.036	-0.013	2017-04-14 18:56:40.440
1	-0.027	0.027	-0.017	2017-04-14 18:56:40.449
2	-0.013	0.022	-0.017	2017-04-14 18:56:40.461
..

recorded on the tablet and phone in hand respectively. These were logged into files named;

- <ID>_HandTablet_TouchEvent.csv
- <ID>_HandPhone_TouchEvent.csv

respectively. The touch data files have ten columns, "EID": event ID (Integer); "Xvalue" and "Yvalue": the x and y coordinates on screen (Float), "pressure": the approximate pressure applied to the surface by a finger (Float, normalized to a range from 0 (no pressure at all) to 1 (normal pressure)), "touchMajor" and "touchMinor": the length of the major and minor axis, respectively, of an ellipse that represents the touch area (Float, display pixels), "pointerID": index of the pointer/touch used in case of multiple touch points (Integer), "fingerOrientation": the orientation of the finger in radians relative to the vertical plane of the device (Float, 0 radians indicates that the major axis oriented upwards, is perfectly circular or is of unknown orientation), "actionType": indicates the type of event (Integer, 0: finger down/swipe begin, 1: finger

up/swipe end and 2: finger move/swipe); and "time": the timestamp of the data point (String in date-time format with millisecond resolution).

- **Checkpoints Data:** For the tasks **c - g** and **i - m**, we require checkpoints to separate the data into walking, upstairs and downstairs. The participants were asked to click on buttons on tablet (**c - g**) or phone in hand (**i - m**) to mark the opening and closing of doors and start and end of stairs. These checkpoints can be used to separate the data from all other sensors into different activities. Please note that a proctor followed the users during these tasks (making sure not to influence the activity) and noted down incidents where some users clicked the buttons either early or late by a few seconds, adjustments to such timestamps were made manually by adding or subtracting the number of seconds noted down by the proctor. Checkpoint files have three columns, "EID": event ID (Integer); "eventType": type of event (String, *DoorEntry*: user at doorway and is about to open door, *DoorExit*: user has crossed the doorway and the door has closed behind them, *StairEntry*: user about to start climbing up or down the staircase and *StairExit*: user has completed climbing up or down a staircase.); and "time": the timestamp of the data point (String in date-time format with millisecond resolution). Table 9 shows an example of checkpoint data from user 1. Using the checkpoint data, the accelerometer and gyroscope data can be segmented into three; a) between "DoorExit" and "DoorEntry" event represents walking on a flat corridor; b) between the first "StairEntry" and "StairExit" represents going downstairs; and between second "StairEntry

TABLE 8: Example for swipe data from user 1.

ID	Xvalue	Yvalue	pressure	touchMajor	touchMinor	pointerID	fingerOrientation	actionType	time
0	818.085	1546.25	1.0	0.976	0.488	0	0.0	0.0	2017-4-14 18:56:47:185
1	819.140	1545.0	1.0	2.929	2.929	0	0.0	0.0	null
2	820.074	1543.893	1.0	2.929	2.929	0	0.0	2.0	2017-4-14 18:56:47:209

TABLE 9: Example for checkpoint data from user 1.

EID	eventType	time
0	DoorEntry	2017-04-14 19:41:45.980
1	DoorExit	2017-04-14 19:41:50.639
..
4	StairEntry	2017-04-14 19:42:18.724
5	StairExit	2017-04-14 19:42:39.105
..

and "StairExit" represents going upstairs.

- **FreeText Data:** In tasks **a**, **b** and **h**, the users had to first transcribe two pieces of fixed text; a) "this is a test to see if the words that i type are unique to me. there are two sentences in this data sample."¹; and b) "second session will have different set of lines. carefully selected not to overlap with the first collection phase."¹. The files labelled "Desktop_FreeText.csv", "Tablet_FreeText.csv" and "Phone_FreeText.csv" provide the timestamp for each user, at which they completed the transcription section and moved to free text section. In our analyses we have considered the entire typing activity as a whole, these files are provided for researchers who may want to separate fixed text and free text for their work.

2.3.2 Features from Raw Data

We extracted popular features that are used in literature for each modality. The feature extraction for our dataset can be grouped into three parts, namely keystroke, gait and swipe features. The files consisting the extracted features have also been included in our dataset. We briefly describe the features and their storage below.

- **Keystroke Features:** We select the common twelve unigraphs (single key) and eighteen digraphs (pair of consecutive keys) that occurred the most number of times in all user's keystroke data. The unigraphs are: "BACKSPACE", "SPACE", "a", "e", "h", "i", "l", "n", "r", "S" and "t". The digraphs are: ('BACKSPACE', 'BACKSPACE'), ('SPACE', 'a'), ('SPACE', 'i'), ('SPACE', 's'), ('SPACE', 't'), ('e', 'SPACE'), ('e', 'n'), ('e', 'r'), ('e', 's'), ('n', 'SPACE'), ('o', 'SPACE'), ('o', 'n'), ('r', 'e'), ('s', 'SPACE'), ('s', 'e'), ('t', 'SPACE'), ('t', 'e') and ('t', 'h'). For a unigraph K_i we extract the *Keyhold* time of the key as a feature:

$$- \text{Keyhold}_{K_i} : K_i\text{Release} - K_i\text{Press}$$

For a digraph K_i and K_{i+1} the following temporal features are extracted:

- $\text{Flight1}_{K_i K_{i+1}} : K_{i+1}\text{Press} - K_i\text{Release}$
- $\text{Flight2}_{K_i K_{i+1}} : K_{i+1}\text{Release} - K_i\text{Release}$
- $\text{Flight3}_{K_i K_{i+1}} : K_{i+1}\text{Press} - K_i\text{Press}$
- $\text{Flight4}_{K_i K_{i+1}} : K_{i+1}\text{Release} - K_i\text{Press}$

The figure 4 illustrates the temporal features extracted from keystrokes. These files are stored in folder labelled

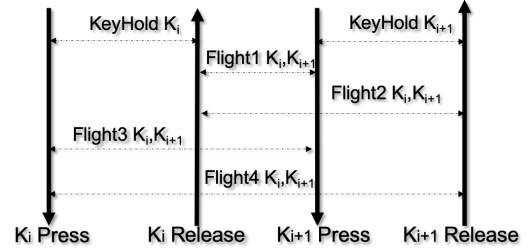

Fig. 4: Features extracted from keystroke data.

"Keystroke_Features" which contains the files names with syntax "<ID>_<Feature_Name>_<Device>.csv", where, <ID> is the user ID (1-117), <Feature_Name> is the keystroke feature (keyhold, flight1 - flight4) and <Device> is either desktop, tablet or phone. Each of these files have column denoting the key ("key" in case of keyhold, "key1" and "key2" in the case of flight) and a column with the value extracted for the feature.

- **Gait Features:** As the raw data for the gait is a pair of signals from the accelerometer and gyroscope we extract features from both. The gait data is further subdivided into three activities; "Walking" (on a flat corridor); "Downstairs" (going down the staircase); and "Upstairs" (going up the staircase). We use a window size of two seconds with a one second overlap between two consecutive windows. For each two second window we extract a host of features from the accelerometer and the gyroscope for x ("Xvalue"), y ("Yvalue"), z ("Zvalue") and m ($m = \sqrt{x^2 + y^2 + z^2}$). A brief description of the features and their column names in files are as follows:
 - Mean: mean of x , y , z and m data denoted $xmean$, $ymean$, $zmean$ and $mmean$ respectively.
 - Standard deviation: standard deviation of x , y , z and m data denoted $xstd$, $ystd$, $zstd$ and $mstd$ respectively.
 - Band power: band power x , y , z and m data denoted xbp , ybp , zbp and mbp respectively.
 - Energy: energy of the signals x , y , z and m denoted $xenergy$, $yenergy$, $zenergy$ and $menergy$ respectively.
 - Median frequency: median frequency of x , y , z and m signals denoted $xmfreq$, $ymfreq$, $zmfreq$ and $mmfreq$ respectively.
 - Inter quartile range: the inter quartile range of x , y , z and m data denoted $xiqr$, $yiqr$, $ziqr$ and $miqr$ respectively.
 - Range: range of the x , y , m and z signals denoted $xrange$, $yrange$, $zrange$ and $mrangle$ respectively.
 - Signal to noise ratio: the signal to noise ratio in x , y , z and m signals denoted $xsnr$, $ysnr$, $zsnr$ and $msnr$ respectively.
 - Dynamic time warping distance: the DTW distance between pairs of signals x - y , y - z and x - z denoted as $xydtw$, $yzdtw$ and $xzdtw$ respectively.
 - Mutual information: the mutual information between

1. The transcription sentences were selected based on two criteria: (1) inclusion of many frequently used words in the Oxford English Corpus, and (2) encouraging typing activity on both hands (on both sides on the keyboard). Transcription sentences were typed in lower case.

pairs of signals $x-y$, $x-z$, $x-m$, $y-z$, $y-m$ and $z-m$ denoted as xy_{mi} , xz_{mi} , xm_{mi} , yz_{mi} , ym_{mi} and zm_{mi} respectively.

- Correlation: the Pearson correlation coefficients between pairs of signals $x-y$, $y-z$ and $x-z$ signals denoted xy_{corr} , yz_{corr} and xz_{corr} respectively.

In the "Gait_Features" folder, we have sub-folders named "<Activity>_Features" where activity is either Walking, Downstairs or Upstairs. Each folder consists files with names following the syntax "<ID>_<Device_In_Hand>_<Sensor_Device>_<Sensor>.csv", where, <ID> is the user ID (1-117), <Device_In_Hand> is "Tablet" for tasks **c - g** and Phone for tasks **i - l**, <Sensor_Device> is the device from which data comes from (HandPhone, HandTablet, PocketPhone) and <Sensor> is either accelerometer or gyroscope.

- **Swipe Features:** For each swipe performed by users on tablet and phone during tasks **b** and **h** respectively, various features related to the speed and trajectory of the swipes are extracted. A brief description of the features and their column names in files are as follows:
 - Minimum x and y coordinates: the minimum x and y coordinates in the entire swipe denoted by min_x and min_y respectively.
 - Maximum x and y coordinates: the maximum x and y coordinates in the entire swipe denoted by max_x and max_y respectively.
 - Euclidean distance: the Euclidean distance between the start and end points of the swipe denoted by $euclid_{dist}$.
 - Distance list: Euclidean distance between points of a swipe denoted by $dlist$.
 - Angle: the tangent angle of the swipe denoted by tan_{angle} .
 - Time: the total time taken to for the swipe denoted by $totime$.
 - Velocity mean and standard deviation: the mean and standard deviation of velocity during the swipe, $vmean$ and $vstd$ respectively.
 - Velocity quartiles: the first, second and third quartiles of velocity during the swipe, $vquarts_0$, $vquarts_1$ and $vquarts_2$ respectively.
 - Acceleration mean and standard deviation: the mean and standard deviation of acceleration during the swipe, $amean$ and $astd$ respectively.
 - Acceleration quartiles: the first, second and third quartiles of acceleration during the swipe, $aquarts_0$, $aquarts_1$ and $aquarts_2$ respectively.
 - Pressure mean and standard deviation: the mean and standard deviation of pressure during the swipe, $pmean$ and $pstd$ respectively.
 - Pressure quartiles: the first, second and third quartiles of pressure during the swipe, $pquarts_0$, $pquarts_1$ and $pquarts_2$ respectively.
 - Area mean and standard deviation: the mean and standard deviation of area during the swipe, $areamean$ and $areastd$ respectively.
 - Area quartiles: the first, second and third quartiles of area during the swipe, $areaquarts_0$, $areaquarts_1$ and $areaquarts_2$ respectively.

- Direction: the direction of the swipe comparing the displacement of the fingertip in x and y direction, the direction of swipes is deduced as either left, right, up or down denoted by column *swipe_type*.

These files are stored in the directory "Swipe_Features" and named with syntax "<ID>_<Device_in_Hand>.csv", where, <ID> is the user ID (1-117) and <Device_in_Hand> (Tablet or Phone) is the device on which the swipe was performed.

2.4 Demographics

Each participant was given a unique ID and made to fill out a brief questionnaire consisting questions relating to demographic, physiology and background. This data is stored in the file labelled "Demographics.csv" in the form of thirteen columns, "User ID": unique ID given to each user (Integer); "Age": age of the participant in years (Integer); "Gender": the gender of the participants (Character, "F": Female, "M": Male and "O": Other); "Height": height of the participant in inches (Integer, inches); "Ethnicity": ethnicity of the participant (String); "Languages Spoken": languages that the participant can speak fluently (Tuple, [language1, ..., languageN]); "Typing Languages": languages in which the participant can type (Tuple, [language1, ..., languageN]); "Handedness": dominant hand for the participant ("Right", "Left" or "Ambidextrous"); "Desktop Hours", "Smartphone Hours" and "Tablet Hours": approximate range of hours in a day the participant spends using a desktop, phone and tablet respectively (Range, in hours: 0-1, 2-4, 5-7, 8-12, More than 12); "Typing Style": denotes touch and visual typists (Character, "a": Do not look at keyboard/Touch typist, "b": Must look at keyboard/Visual typist and "c": Occasionally look at keyboard/Visual typist); and "Major/Minor": participant's major and minor stream of education (String).

Table 10 summarizes the demographics of the participants in our dataset. The average age of participants in our study was about 25 years with more than half of the participants aged between 23 to 26 years. The youngest and oldest participants were 19 and 35 years of age respectively. The average height of participants was about 67 inches. The shortest and tallest being 54 and 74 inches respectively. The daily usage hours also reflect the popularity of these devices while desktops and phones appear to be used more than tablets.

2.5 Where is it stored and how to obtain it?

The entire dataset, feature files and demographic file are hosted at IEEE-Dataport [25]. The url of the dataset is <http://dx.doi.org/10.21227/rpaz-0h66> and is open-access complaint, so it can be downloaded with a free IEEE account.

3 ANALYSIS

Through this paper, we aim to provide in-dept description of our dataset. Therefore, we present results from initial research directions that we have explored. We hope the research community will benefit from the dataset and explore the various other directions of research that cannot be addressed in one single research article. We collect the statistics of the keystroke data and compare the average and

TABLE 10: Summary of demographic data.

Category	Size	Category	Size		
Age in years	19 - 22	22	Daily usage of desktop in hours	0 - 1	17
	23 - 26	61		2 - 4	58
	27 - 30	28		5 - 7	28
	>30	06		8 - 12	12
Sex	Female	45		>12	2
	Male	72	Daily usage of phone in hours	0-1	3
Height in inches	≤60	6		2-4	51
	60-65	40		5-7	43
	65-70	43		8-12	16
	>70	28	>12	4	
Spoken Languages	1	13	Daily usage of tablet	0 - 1	93
	2	64		2-4	20
	3	32		5-7	4
	>3	8	Typing style	Touch	31
		Visual		86	

TABLE 11: Keystroke data statistics: Number of keystroke events.

	Desktop	Tablet	Phone	All Devices
Average	11760	8952	9395	30153
Stdev	2132	1584	1472	3880
Min	4365	4580	5463	19252
Max	18716	17029	14694	41828

standard deviation of the keystroke features (Section 2.3.2) across the three different devices. This helps us provide insights about general typing behavior traits on various devices.

3.1 Statistics of keystroke data and insights from feature values across devices

Table 11 shows the statistics of keystroke data from our dataset. On an average each participant performed around 11,750, 8,950 and 9,400 keystrokes on desktop, tablet and phone respectively. Even in the minimum condition, each participant has performed 4,350, 4,550 and 5,450 keystrokes on the three devices respectively. When combined, the average keystrokes per user across all three devices is over 30,000 keystrokes and in minimum condition about 19,250.

Outlier Detection for Keystroke Features: From the keystroke data, we extract the all temporal keystroke features that are popular in literature (See Section 2.3.2). We use a simple filter to remove any instances of keys that were held down for two seconds or more. We also remove instances of the inter-key pauses that are greater than two seconds. We

TABLE 12: Summary of keyhold feature statistics. All values are in milliseconds.

Unigraph	Desktop		Tablet		Phone	
	$\mu(\text{avg})$	$\mu(\text{std})$	$\mu(\text{avg})$	$\mu(\text{std})$	$\mu(\text{avg})$	$\mu(\text{std})$
b space	168	211	128	175	128	129
space	114	57	77	18	89	17
a	137	68	98	22	103	19
e	123	58	85	20	90	18
h	116	53	73	16	81	16
i	119	61	71	16	85	17
l	102	50	71	16	89	19
n	122	63	72	16	83	16
o	118	61	72	15	87	16
r	129	63	78	19	85	17
s	130	60	87	21	94	18
t	116	54	76	20	81	16

assume that these were caused by pauses, where the user is either thinking or receiving instructions during the data collection.

3.1.1 Insights from keystroke feature values across devices

To observe how the keystroke features vary across devices, we calculate the average of the average feature values and average of the standard deviation of the feature values from all users in our dataset. To maintain clarity in presentation we use symbols $d1$ through $d18$ to denote the digraphs ($d1$: ('BACKSPACE', 'BACKSPACE'), $d2$: ('SPACE', 'a'), $d3$: ('SPACE', 'i'), $d4$: ('SPACE', 's'), $d5$: ('SPACE', 't'), $d6$: ('e', 'SPACE'), $d7$: ('e', 'n'), $d8$: ('e', 'r'), $d9$: ('e', 's'), $d10$: ('n', 'SPACE'), $d11$: ('o', 'SPACE'), $d12$: ('o', 'n'), $d13$: ('r', 'e'), $d14$: ('s', 'SPACE'), $d15$: ('s', 'e'), $d16$: ('t', 'SPACE'), $d17$: ('t', 'e') and $d18$: ('t', 'h')). Tables 12 to 16 present the values computed for each feature.

Observations: We observe that participants have considerably less keyhold times for all keys on the hand-held devices (tablet and phone). The average of the standard deviation in keyhold time are also very small, less than 50 milliseconds, in all cases except for "backspace". However, it is almost completely the opposite when we consider the flight1 to flight4 features from Tables 13 to 16. We observe that in case of hand-held devices the average feature values are larger than those on desktop. Especially in case of flight1, which is also called the inter-key latency, we can see the values are almost doubled for many digraphs ($d6$, $d10$, $d11$ etc.). It is also worth noticing that both the hand-held devices exhibit similar values in most cases and contrasts, if present, are only with the desktop keystroke features.

Insights: From our observations it appears that participants in general, take longer time between keys on phones and tablets when compared to a desktop keyboard. However, once the key is pressed the release event occurs much sooner on the phones and tablets implying that smaller amount on time is spent with the finger on the key. We posit that this occurrence maybe a result of lesser number of fingers being in contact with the typing surface on hand-held devices. In most cases participants type on tablets and phones with just their thumbs compared to their usage of many more fingers for the desktop keyboard thus increasing the keyhold time and reducing the inter-key latency on desktop.

TABLE 13: Summary of Flight1 feature statistics. All values are in milliseconds.

Digraph	Desktop		Tablet		Phone	
	$\mu(\text{avg})$	$\mu(\text{std})$	$\mu(\text{avg})$	$\mu(\text{std})$	$\mu(\text{avg})$	$\mu(\text{std})$
<i>d1</i>	20	258	80	280	20	228
<i>d2</i>	205	247	412	318	360	313
<i>d3</i>	277	247	513	316	472	290
<i>d4</i>	224	245	432	307	433	321
<i>d5</i>	218	240	441	327	408	298
<i>d6</i>	96	167	199	194	162	170
<i>d7</i>	115	151	175	138	144	126
<i>d8</i>	37	110	123	77	130	63
<i>d9</i>	123	114	169	87	162	80
<i>d10</i>	95	137	200	161	186	142
<i>d11</i>	95	110	254	151	236	120
<i>d12</i>	99	110	205	94	181	75
<i>d13</i>	22	92	118	73	121	59
<i>d14</i>	99	163	208	230	163	169
<i>d15</i>	87	97	148	67	147	63
<i>d16</i>	111	158	250	219	198	154
<i>d17</i>	58	94	138	81	136	68
<i>d18</i>	63	88	111	79	121	74

TABLE 14: Summary of Flight2 feature statistics. All values are in milliseconds.

Digraph	Desktop		Tablet		Phone	
	$\mu(\text{avg})$	$\mu(\text{std})$	$\mu(\text{avg})$	$\mu(\text{std})$	$\mu(\text{avg})$	$\mu(\text{std})$
<i>d1</i>	166	169	163	154	173	118
<i>d2</i>	333	248	509	310	462	308
<i>d3</i>	387	246	582	307	556	287
<i>d4</i>	348	247	520	301	529	317
<i>d5</i>	327	238	518	321	488	295
<i>d6</i>	204	165	278	192	253	170
<i>d7</i>	220	156	250	137	231	126
<i>d8</i>	174	114	200	80	217	65
<i>d9</i>	247	119	255	87	253	82
<i>d10</i>	212	148	275	157	274	144
<i>d11</i>	206	117	333	151	326	121
<i>d12</i>	228	122	275	94	263	76
<i>d13</i>	155	93	203	77	209	62
<i>d14</i>	209	165	286	225	255	170
<i>d15</i>	208	103	230	69	238	65
<i>d16</i>	219	158	328	215	288	154
<i>d17</i>	181	101	225	82	224	69
<i>d18</i>	182	97	186	79	202	77

TABLE 15: Summary of Flight3 feature statistics. All values are in milliseconds.

Digraph	Desktop		Tablet		Phone	
	$\mu(\text{avg})$	$\mu(\text{std})$	$\mu(\text{avg})$	$\mu(\text{std})$	$\mu(\text{avg})$	$\mu(\text{std})$
<i>d1</i>	194	156	179	146	187	110
<i>d2</i>	314	245	491	311	450	306
<i>d3</i>	387	248	588	307	559	288
<i>d4</i>	337	245	509	300	524	315
<i>d5</i>	326	236	518	320	496	294
<i>d6</i>	219	167	284	190	252	168
<i>d7</i>	238	154	265	136	236	120
<i>d8</i>	179	112	218	77	230	64
<i>d9</i>	246	122	251	86	248	80
<i>d10</i>	220	145	267	157	266	143
<i>d11</i>	210	114	326	152	320	119
<i>d12</i>	235	121	279	94	268	76
<i>d13</i>	163	93	197	74	208	60
<i>d14</i>	229	162	297	224	258	167
<i>d15</i>	219	100	237	69	246	63
<i>d16</i>	229	157	324	213	277	151
<i>d17</i>	178	93	216	81	220	69
<i>d18</i>	177	90	189	79	203	74

TABLE 16: Summary of Flight4 feature statistics. All values are in milliseconds.

Digraph	Desktop		Tablet		Phone	
	$\mu(\text{avg})$	$\mu(\text{std})$	$\mu(\text{avg})$	$\mu(\text{std})$	$\mu(\text{avg})$	$\mu(\text{std})$
<i>d1</i>	380	268	335	230	336	173
<i>d2</i>	441	249	587	302	552	301
<i>d3</i>	495	247	656	299	644	285
<i>d4</i>	459	246	598	294	620	310
<i>d5</i>	436	239	595	313	577	292
<i>d6</i>	327	174	363	188	342	167
<i>d7</i>	343	166	340	135	324	122
<i>d8</i>	315	132	294	82	317	68
<i>d9</i>	369	132	337	89	339	82
<i>d10</i>	336	161	342	155	354	144
<i>d11</i>	320	123	404	150	410	122
<i>d12</i>	362	141	350	95	351	78
<i>d13</i>	296	106	282	79	295	64
<i>d14</i>	339	172	376	222	348	166
<i>d15</i>	340	117	319	72	338	67
<i>d16</i>	337	165	402	210	367	150
<i>d17</i>	300	107	303	83	307	68
<i>d18</i>	296	110	264	79	284	77

4 POSSIBLE RESEARCH DIRECTIONS

- **User authentication for individual devices using keystrokes, gait or swipes:** Our dataset provides multiple modalities, activities and scenarios which can be used separately as individual device or activities for user authentication data.
- **Activity recognition:** We share data from multiple activities and sub-activities like; free text and fixed text in case of keystrokes; and walking, upstairs and downstairs in case of gait. Recognizing the activity or sub-activity provides better context for methods to be applied.
- **Feature engineering:** Many authentication and identification tasks can be improved with a better understanding of feature sets and their effectiveness for each of the modalities.
- **Inter-Device behavior patterns:** A unique property of our dataset that sets it apart from openly available datasets is that, the same participants performed many overlapping activities on multiple devices. Therefore, inter-device patterns in behavior in same activity or different activities can be researched. For example, “*Can the typing behavior of a user on desktop reveal their typing behavior on phone?*”.
- **Physiological or Demographic information leakage in activities:** As we provide a demographic information of each participant, researchers can also explore if the membership of participants in certain demographic group can be identified from different behavioral activities.
- **Demographic menagerie:** Existence of groups of users who perform differently at various authentication tasks has been shown in literature [26]. Demographic or physiological links to these groupings can be explored.

5 COMPARISON WITH OTHER DATA SETS

The datasets that are currently available for behavioral biometrics are collected with the focus on a single activity. We summarize and compare our dataset to other related datasets that are available in literature. We present the key

points of comparison with sizeable and related datasets in Table 17.

A majority of keystroke datasets are focused on fixed text data with short strings like password, repeated many times by each participant [10], [13], [14]. Most keystroke datasets are collected on desktops [10], [11], [15], [27] and very few are on hand-held devices, such as [13], which has a only 42 participants of which 37 participants used tablets and only 5 used phones. Such variations limit the usability of datasets. For gait data, there are two datasets that provide sub-activities, similar to our dataset, such as walking, going up and down the stair case [23], [24]. But, both these datasets have only 30 participants. *HuGaDB* [20], provides a dataset with 12 different activities collected with a body-sensor-network having 6 accelerometers and gyroscopes each and 2 electromyography (EMG) sensors that are placed on the participants body. Though this data approximates the body movements of participants very closely, it would not be suitable for continuous authentication due to the unrealistic placement of sensors compared to day-to-day use of phones. In case of *VideoGait* and *humanId* ([17], [29]), both having over 120 participants, a third party surveillance approach is more suitable as the datasets consists of video recordings of participants gait which is not suitable for on-device continuous authentication.

As touch and swipe as a behavioral biometric is comparatively less explored and the number of datasets is far fewer. All touch and swipe datasets compared in Table 17 collected similar raw data (coordinates, pressure, area and orientation) while using different ways to make participants perform the swipes.

All the datasets discussed above provide data for single activity on single device. How a particular activity from a user varies from device to device, or existence of correlation between different activities on different devices cannot be explored with these datasets. Heterogeneity Human-Activity Recognition dataset [30] consists data from multiple devices and multiple movement-related activities (no keystrokes), but as data was collected from only nine users and the device carrying conditions (eight phones carried together in a pouch at the waist and two watches worn on each hand) limit the usability of the dataset for behavioral biometrics.

Therefore, our dataset stands unique by providing data from the same 117 participants performing; a) typing activity, both fixed and free text, on desktop, tablet and phone; b) gait activity, including walking, upstairs and downstairs, with phone in hand, tablet in hand and phone in pocket; and c) swiping activity on tablet and phone.

6 LESSONS LEARNT

The process of collection, curation, pre-processing, storage and sharing of a dataset is indeed challenging. We dealt with various issues at each stage of this effort and share the key lessons learnt, for the benefit of research community, below:

- Overhead time for the entire process is nontrivial. Time involved in various legalities; preparation and approval of Institutional Review Board (IRB) documents; reaching out and procuring participants; and scheduling them is

nontrivial and require great consideration and planning beforehand.

- Special attention must be given to avoid Personally Identifiable Information (PII) trickling into data. Especially when data collection aims to capture free text, participants might unknowingly divulge personal information such as names, phone numbers, email ids etc., as part of their answers to questions. This can be corrected either in the protocol designing phase (careful consideration to questions) or in the pre-processing phase.
- An on-site proctor to oversee each participant's data collection can ensure quality of data especially when data involves capturing key timestamps for activity separation (Section 2.3.2, Checkpoint files). In a few cases we have made manual corrections (by adding or subtracting seconds noted by proctor) to the timestamps where a participant logged them either too early or too late.
- When data collection involves logging of timestamps on more than one device it is important to make sure the clocks on all devices involved are synchronized to within a few milliseconds of each other. We carried out several test runs to ensure synchronization of the timestamps on all devices, which was challenging as there were four devices (desktop, pocket-phone, hand-phone and tablet) to be used by every participant.
- Before sharing the data publicly, it is important to represent similar data from different devices in the same format for easier usability. For example; timestamps were logged in a string format (yyyy-mm-dd hr-min-sec.milliseconds) on the desktop and UNIX timestamp on all other devices; and key strokes were logged as characters or keys on the desktop but as ASCII codes on other devices. Therefore, it is better to standardize the data fields before sharing the dataset.
- Incomplete data can occur from unexpected application or sensor fault or when participants do not complete the entire process. For example, in our dataset, user 117 did not complete the tasks **h** to **m**, but other tasks were complete and are included in the final dataset. In rare cases, where there was too little information for a task or activity, it was better to remove the files for completeness of the shared data.
- In a previous data collection effort for keystrokes [31], we observed some participants tend to fill in low-quality or gibberish text in order to satisfy the minimum text-length criteria (if any) to finish the session earlier. Such occurrences reduce the quality of data and can be remedied either by clearly stating the dos and don'ts to the participants or by the on-site proctor observing and interrupting such behavior.

7 CONCLUSION AND FUTURE WORK

Through this paper, we share and provide the details of our large behavioral biometrics dataset for typing, gait and swiping activities of the same user on desktop, tablet and phone (Section 2). The availability of the data on different devices for the same person makes our dataset unique; and with data from 117 participants, also one of the largest. With this dataset researchers can try to explore questions that were not possible with previously available datasets such as;

TABLE 17: Comparison with other related datasets.

	Dataset	No. of users	Type of data	Type of activity	Device(s) used by participants	Highlights
Keystroke	U@B_KD [11]	148	Latencies	Fixed & Free text	Desktop	Four different keyboards used
	SBrook_KD [15]	196	Latencies	Free text	Desktop	Truthful Vs. Deceptive writing
	Video_KD [16]	30	Latencies & Video	Fixed text	Desktop	Movement and Motor aspects
	Pressure_KD [14]	100	Latencies & Pressure	Fixed text	Desktop	Pressure on desktop keyboard
	Android_KD [13]	42	Latencies & Pressure	Fixed text	37 Tablet & 5 Phone users	Addition of pressure features for Android
	Laser_2012 [12]	20	Latencies	Fixed & Free text	Desktop	Free vs Fixed text behavior
	CMU_KD [10]	51	Latencies	Fixed text	Desktop	Large number of repetitions by participants
	Clarkson_I [27]	39	Latencies & Video	Fixed & Free text	Desktop	Video of face and hand while typing
	Clarkson_II [28]	103	Latencies	Fixed and Free text	Desktop	Natural and uncontrolled includes mouse and app data
Gait	Kinematics [19]	42	3d Motion Capture using Force Plates	Overground & Treadmill	Force Plates (placed on body)	Anthropometric data & Pelvis Kinematics
	HuGaDB [20]	18	Accelerometer X 6 Gyroscope X 6 EMG X 2	12 Activities including Gait, Upstairs and Downstairs	Accelerometer, Gyroscope & EMG sensors (placed on body)	Body sensor network data
	VideoGait [17]	124	Video	Walking	-	Effect of Viewpoint, Clothing & Carrying
	humanID [29]	122	Video	Walking	-	12 Experiments with changes in conditions.
	HAR [24]	30	Accelerometer & Gyroscope	6 Activities including Gait, Upstairs and Downstairs	Smartphone	Activity recognition using smartphone
	UniMiB SHAR [23]	30	Accelerometer	Gait & Fall	Smartphone	Activity recognition & fall detection
Swipe	ASU_Touch [22]	75	X, Y coordinates Pressure Area of touch Orientation of finger	Swipe & Touch Gestures	Smartphone	Re-authentication using swipe gestures
	Touchalytics [21]	41		Swipe to scroll through images	Smartphone	Proposed 30 touch features
	LTU_Touch [9]	190		Swipe through questions	Smartphone	Evaluation of verifiers for touch data
	FAST [7]	40		Browsing	Smartphone	Fingergestures Authentication System using Touchscreen (FAST)
Our Dataset	Keystroke	Same 117 participants across the datasets	Latencies	Fixed and Free text	Desktop, Tablet & Phone	The same participants performing multiple, common day-to-day activities on multiple devices with real-life placement and usage of devices
	Gait		Accelerometer X 3 Gyroscope X 3	Walking, Upstairs & Downstairs	Tablet in hand Phone in hand Phone in pocket	
	Swipe		X, Y coordinates Pressure, Area of touch Orientation of finger	Swipe through questions	Tablet Phone	

"Does the typing of an individual on desktop reveal their typing on a tablet or phone? and vice versa"; "Can a person's demographics like age, height, etc., be predicted from the data of typing, gait or swiping activity on any of the devices?"; to name a few. Each of the files in our dataset are described in detail with example snippets for easier visualization and understanding (Section 2.3.1).

We explore, describe, extract and analyze the most popular features for each activity in our dataset. All features are described briefly and also included with the dataset repository (Section 2.3.2). The demographics of the participants is shared and includes various physiological and background information with good spread for most groups (Section 2.4). The analysis of the features reveals interesting insights. We found participants took more time between keys on phones and tablets when compared to a desktop keyboard but the release event was much sooner on the phones and tablets implying that smaller amount on time is spent with the finger on the key (Section 3). As the general style of typing on tablets and phones is with just the two thumbs as opposed to several fingers on desktop, we posit that this occurrence maybe a result of lesser number of fingers being in contact with the typing surface on hand-held devices thus increasing the keyhold time and reducing the inter-key latency on desktop.

This dataset helps address the scarcity in benchmark datasets for multi-device, multi-activity and multi-modality data from the same participants. Collection of a high-quality dataset that can be publicly shared for the benefit of the community, is indeed a tedious and demanding task. Throughout the process, lessons that we have shared in Section 6 are intended for future researchers who make similar endeavors to have an advantage. We also discuss several possible research directions (Section 4) that can be explored with the help of this dataset. As part of our future work we will be exploring these directions.

APPENDIX A COGNITIVE LOADS [32]

Task	Level	Required activity
Remember	1	Retrieve knowledge from long-term memory to explain
Understand	2	Explain, summarize or interpret
Apply	3	Apply, execute or implement
Analyze	4	Organize or break material into constituent parts
Evaluate	5	Critique or make judgments based on criteria
Create	6	Generate, plan or put elements together

APPENDIX B FIXED TEXT SENTENCES

- "this is a test to see if the words that i type are unique to me. there are two sentences in this data sample."

- "second session will have different set of lines. carefully selected not to overlap with the first collection phase."

APPENDIX C SHOPPING LIST

- Mountain Bike
- Plane tickets from Syracuse, New York to Los Angeles [1 week from today, Coach Seat]
- Bathing Suit (male or female)
- Converse All Star Hiking Boots
- 24 Pack of Gatorade (24-oz)
- Ground Transportation (Train, taxi, Bus) from Los Angeles to San Diego [2 weeks from Today]

APPENDIX D FREE TEXT QUESTIONS ON DESKTOP

- List some of the things that you like about Syracuse University.
- Which internet browser do you typically use (e.g, Google Chrome, Internet Explorer, Mozilla Firefox, etc.)?
- What improvements would you like to see in that browser?
- If you were to draw a picture of Syracuse University, what objects would you include in it?
- What is your favorite vacation spot? Why do you like to visit there?
- Give step-by-step driving directions to your favorite restaurant in the Syracuse Area, starting from your dorm room/ home.
- What hobbies or activities are you involved with outside of school/work? Why?
- Discuss step-by-step instructions for making your favorite type of sandwich. Write them so that the person who has never done this before can follow your instructions.
- What television programs do you watch for the news and current events? Why? If you do not watch anything on TV, what is your primary source for news information? What do you like about it?
- Give a brief, but sufficiently detailed plot description of your favorite book, story, or movie.
- What social networking websites do you use? What do you like or dislike about these websites? If you do not use any social network, how do you stay in touch with your friends and acquaintances. Why do you not use social networking websites?
- Who is your favorite actor, actress, singer, comedian, or TV personality? What do you like about them?

APPENDIX E FREE TEXT AND MULTIPLE-CHOICE QUESTIONS ON PHONE

- What type of Smartphone do you typically use?
 - Android
 - iPhone
 - Windows
 - None

- Other
- Which best describes you?
 - I have a very active imagination.
 - I take my civic duties, such as voting, seriously.
 - I crave excitement.
 - I would rather cooperate with people than compete with them.
 - I am a worrier.
 - I do not like to talk about myself.
- Of the courses you've taken in college, which was your favorite and why?
- Think about a class that you did not enjoy. What improvements would you like to see to make the course better?
- Re-read Question #2 and the responses. Which response do you feel is least applicable to you and why?
- Do you intend to pursue an advanced degree (e.g., Master's or Ph.D.)? Why or why not?
- Find a rule that makes four of the five options alike. Select the option that does not follow this rule:
 - 11.28.45.62
 - 200.217.234.251
 - 192.209.226.243
 - 214.231.248.265
 - 111.127.140.165
- (Horizontal swipes) Review Question #7 and the answer that you chose. Why was the rule you found/why did you select your answer?
- What are the topics of Question #6 and Question #10?
- Give step-by-step directions from this lab space to your dorm room, making specific notes of each time you would descend or ascend stairs.

APPENDIX F

FREE TEXT AND MULTIPLE-CHOICE QUESTIONS ON TABLET

- What type of Tablet do you typically use?
 - Android
 - iPad
 - Windows
 - Amazon Fire
 - None
 - Other
- Which best describes you?
 - I don't mind bragging about my skills and accomplishments.
 - I often forget to or neglect to put things back where I found them.
 - I am dominant, forceful, and/or assertive.
 - I am easy-going and lackadaisical.
 - I am set in my ways.
 - I shy away from crowds.
- What is your ideal job after graduation? Why?
- Why did you decide to attend Syracuse University?
- Re-read Question #2 and the responses. Which response do you feel is least applicable to you and why?
- If all mangoes are golden in color and no golden-colored things are cheap, which of the following is true?

- A. All mangoes are cheap.
- B. Golden-colored mangoes are not cheap.
- C. Either A or B are true.
- D. Both A and B are true.
- E. Neither A or B are true.
- Review Question #6 and the answer that you chose. Why did you select your answer?
- (Horizontal swipes) If Question #6 was changed to read "If some mangoes are golden in color and no golden-colored things are cheap", which answer would be correct and why?
- What are your thoughts on the current U.S. president? Which policies, if any, would you like to see changed and how?
- Discuss step-by-step the process for sending an email from your Syracuse email account. Write these instructions such that a person who has never done this before can follow your instructions.
- Please provide any comments that you have about the survey or the experiment thus far.

REFERENCES

- [1] K. S. Balagani, V. V. Phoha, A. Ray, and S. Phoha, "On the discriminability of keystroke feature vectors used in fixed text keystroke authentication," *Pattern Recognition Letters*, vol. 32, no. 7, pp. 1070 – 1080, 2011.
- [2] F. Monrose and A. D. Rubin, "Keystroke dynamics as a biometric for authentication," *Future Generation computer systems*, vol. 16, no. 4, pp. 351–359, 2000.
- [3] A. Serwadda, Z. Wang, P. Koch, S. Govindarajan, R. Pokala, A. Goodkind, D. Brizan, A. Rosenberg, V. V. Phoha, and K. Balagani, "Scan-based evaluation of continuous keystroke authentication systems," *IT Professional*, vol. 15, no. 4, pp. 20–23, July 2013.
- [4] D. Gafurov, K. Helkala, and T. Söndrol, "Biometric gait authentication using accelerometer sensor." *JCP*, vol. 1, no. 7, pp. 51–59, 2006.
- [5] D. Gafurov, E. Snekkenes, and P. Bours, "Gait authentication and identification using wearable accelerometer sensor," in *2007 IEEE workshop on automatic identification advanced technologies*. IEEE, 2007, pp. 220–225.
- [6] C. Wan, L. Wang, and V. V. Phoha, "A survey on gait recognition," *ACM Comput. Surv.*, vol. 51, no. 5, pp. 89:1–89:35, 2019. [Online]. Available: <https://dl.acm.org/citation.cfm?id=3230633>
- [7] T. Feng, Z. Liu, K. Kwon, W. Shi, B. Carbunar, Y. Jiang, and N. Nguyen, "Continuous mobile authentication using touchscreen gestures," in *2012 IEEE Conference on Technologies for Homeland Security (HST)*, Nov 2012, pp. 451–456.
- [8] S. Mondal and P. Bours, "Swipe gesture based continuous authentication for mobile devices," in *2015 International Conference on Biometrics (ICB)*, May 2015, pp. 458–465.
- [9] A. Serwadda, V. V. Phoha, and Z. Wang, "Which verifiers work?: A benchmark evaluation of touch-based authentication algorithms," in *IEEE Sixth International Conference on Biometrics: Theory, Applications and Systems, BTAS 2013, Arlington, VA, USA, September 29 - October 2, 2013*, 2013, pp. 1–8. [Online]. Available: <https://doi.org/10.1109/BTAS.2013.6712758>
- [10] K. S. Killourhy and R. A. Maxion, "Comparing anomaly-detection algorithms for keystroke dynamics," in *2009 IEEE/IFIP International Conference on Dependable Systems & Networks*. IEEE, 2009, pp. 125–134.
- [11] Y. Sun, H. Ceker, and S. Upadhyaya, "Shared keystroke dataset for continuous authentication," in *2016 IEEE International Workshop on Information Forensics and Security (WIFS)*, Dec 2016, pp. 1–6.
- [12] K. S. Killourhy and R. A. Maxion, "Free vs. transcribed text for keystroke-dynamics evaluations," in *Proceedings of the 2012 Workshop on Learning from Authoritative Security Experiment Results*. ACM, 2012, pp. 1–8.
- [13] M. Antal, L. Z. Szabó, and I. László, "Keystroke dynamics on android platform," *Procedia Technology*, vol. 19, pp. 820–826, 2015.

- [14] C. C. Loy, C. P. Lim, and W. K. Lai, "Pressure-based typing biometrics user authentication using the fuzzy artmap neural network," 2005.
- [15] R. Banerjee, S. Feng, J. S. Kang, and Y. Choi, "Keystroke patterns as prosody in digital writings: A case study with deceptive reviews and essays," in *Proceedings of the 2014 Conference on Empirical Methods in Natural Language Processing (EMNLP)*. Doha, Qatar: Association for Computational Linguistics, October 2014, pp. 1469–1473. [Online]. Available: <http://www.aclweb.org/anthology/D14-1155>
- [16] A. M. Feit, D. Weir, and A. Oulasvirta, "How we type: Movement strategies and performance in everyday typing," in *Proceedings of the 2016 CHI Conference on Human Factors in Computing Systems*, ser. CHI '16. New York, NY, USA: ACM, 2016, pp. 4262–4273. [Online]. Available: <http://doi.acm.org/10.1145/2858036.2858233>
- [17] S. Yu, D. Tan, and T. Tan, "A framework for evaluating the effect of view angle, clothing and carrying condition on gait recognition," in *Proceedings of the 18th International Conference on Pattern Recognition - Volume 04*, ser. ICPR '06. Washington, DC, USA: IEEE Computer Society, 2006, pp. 441–444. [Online]. Available: <https://doi.org/10.1109/ICPR.2006.67>
- [18] T. N. Nguyen, H. H. Huynh, and J. Meunier, "3d reconstruction with time-of-flight depth camera and multiple mirrors," *IEEE Access*, vol. 6, pp. 38 106–38 114, 2018.
- [19] C. A. Fukuchi, R. K. Fukuchi, and M. Duarte, "A public dataset of overground and treadmill walking kinematics and kinetics in healthy individuals," *PeerJ*, vol. 6, pp. e4640–e4640, Apr 2018. [Online]. Available: <https://www.ncbi.nlm.nih.gov/pubmed/29707431>
- [20] R. Chereshevnev and A. Kertész-Farkas, "Hugadb: Human gait database for activity recognition from wearable inertial sensor networks," *CoRR*, vol. abs/1705.08506, 2017. [Online]. Available: <http://arxiv.org/abs/1705.08506>
- [21] M. Frank, R. Biedert, E. Ma, I. Martinovic, and D. Song, "Touchalytics: On the applicability of touchscreen input as a behavioral biometric for continuous authentication," *Trans. Info. For. Sec.*, vol. 8, no. 1, pp. 136–148, Jan. 2013. [Online]. Available: <http://dx.doi.org/10.1109/TIFS.2012.2225048>
- [22] L. Li, X. Zhao, and G. Xue, "Unobservable re-authentication for smartphones," in *20th Annual Network and Distributed System Security Symposium, NDSS 2013, San Diego, California, USA, February 24-27, 2013*, 2013. [Online]. Available: <https://www.ndss-symposium.org/ndss2013/unobservable-re-authentication-smartphones>
- [23] D. Micucci, M. Mobilio, and P. Napolitano, "Unimib shar: A dataset for human activity recognition using acceleration data from smartphones," *Applied Sciences*, vol. 7, no. 10, 2017. [Online]. Available: <http://www.mdpi.com/2076-3417/7/10/1101>
- [24] D. Anguita, A. Ghio, L. Oneto, X. Parra, and J. L. Reyes-Ortiz, "Human activity recognition on smartphones using a multiclass hardware-friendly support vector machine," in *Proceedings of the 4th International Conference on Ambient Assisted Living and Home Care*, ser. IWAAL'12. Berlin, Heidelberg: Springer-Verlag, 2012, pp. 216–223.
- [25] A. K. Belman, L. Wang, S. S. Iyengar, P. Sniatala, R. Wright, R. Dora, J. Balwdin, Z. Jin, and V. V. Phoha, "Su-ais bbmas (syracuse university and assured information security - behavioral biometrics multi-device and multi-activity data from same users) dataset," 2019. [Online]. Available: <http://dx.doi.org/10.21227/rpaz-0h66>
- [26] N. Yager and T. Dunstone, "The biometric menagerie," *IEEE Transactions on Pattern Analysis and Machine Intelligence*, vol. 32, no. 2, pp. 220–230, Feb 2010.
- [27] E. Vural, J. Huang, D. Hou, and S. Schuckers, "Shared research dataset to support development of keystroke authentication," in *IEEE International Joint Conference on Biometrics*. IEEE, pp. 1–8.
- [28] C. Murphy, J. Huang, D. Hou, and S. Schuckers, "Shared dataset on natural human-computer interaction to support continuous authentication research," in *2017 IEEE International Joint Conference on Biometrics (IJCB)*, Oct 2017, pp. 525–530.
- [29] S. Sarkar, P. J. Phillips, Z. Liu, I. R. Vega, P. Grother, and K. W. Bowyer, "The humanid gait challenge problem: data sets, performance, and analysis," *IEEE Transactions on Pattern Analysis and Machine Intelligence*, vol. 27, no. 2, pp. 162–177, Feb 2005.
- [30] A. Stisen, H. Blunck, S. Bhattacharya, T. S. Prentow, M. B. Kjærgaard, A. Dey, T. Sonne, and M. M. Jensen, "Smart devices are different: Assessing and mitigating mobile sensing heterogeneities for activity recognition," in *Proceedings of the 13th ACM Conference on Embedded Networked Sensor Systems*, ser. SenSys '15. New York, NY, USA: ACM, 2015, pp. 127–140. [Online]. Available: <http://doi.acm.org/10.1145/2809695.2809718>
- [31] A. Serwadda, V. V. Phoha, and A. Kiremire, "Using global knowledge of users' typing traits to attack keystroke biometrics templates," in *Proceedings of the Thirteenth ACM Multimedia Workshop on Multimedia and Security*, ser. MM&Sec '11. New York, NY, USA: ACM, 2011, pp. 51–60. [Online]. Available: <http://doi.acm.org/10.1145/2037252.2037263>
- [32] D. G. Brizan, A. Goodkind, P. Koch, K. Balagani, V. V. Phoha, and A. Rosenberg, "Utilizing linguistically enhanced keystroke dynamics to predict typist cognition and demographics," *International Journal of Human-Computer Studies*, vol. 82, pp. 57 – 68, 2015.