

An Interactive Greedy Approach to Group Sparsity in High Dimension

Wei Qian ^{*a}, Wending Li ^{*b}, Yasuhiro Sogawa ^c, Ryohei Fujimaki ^c, Xitong Yang ^b,
and Ji Liu ^b

^aDepartment of Applied Economics and Statistics, University of Delaware, weiqian@udel.edu

^bDepartment of Computer Science, University of Rochester,
wending.li@rochester.edu; yangxitongbob@gmail.com;

ji.liu.uwisc@gmail.com

^c Knowledge Discovery Research Laboratories, NEC, USA,
y-sogawa@ah.jp.nec.com; rfujimaki@nec-labs.com

Abstract

Sparsity learning with known grouping structures has received considerable attention due to wide modern applications in high-dimensional data analysis. Although advantages of using group information have been well-studied by shrinkage-based approaches, benefits of group sparsity have not been well-documented for greedy-type methods, which much limits our understanding and use of this important class of methods. In this paper, generalizing from a popular forward-backward greedy approach, we propose a new interactive greedy algorithm for group sparsity learning and prove that the proposed greedy-type algorithm attains the desired benefits of group sparsity under high dimensional settings. An estimation error bound refining other existing methods and a guarantee for group support recovery are also established simultaneously. In addition, we incorporate a general M-estimation framework and introduce an interactive feature to allow extra algorithm flexibility without compromise in theoretical properties. The promising use of our proposal is demonstrated through numerical evaluations including a real industrial application in human activity recognition.

Key Words: human activity recognition, lasso, sensor selection, stepwise selection, variable selection

^{*}Contributed equally.

1 Introduction

High-dimensional data has become prevalent in many modern statistics and data mining applications. Given feature vectors $\mathbf{x}_1, \mathbf{x}_2, \dots, \mathbf{x}_n \in \mathbb{R}^p$ and a sparse coefficient vector $\mathbf{w}^* \in \mathbb{R}^p$, assume that response $y_i \in \mathbb{R}$ ($i = 1, \dots, n$) is generated from some distribution P_{θ_i} depending on θ_i with linear relation $\theta_i = \mathbf{x}_i^T \mathbf{w}^*$, and that the feature dimension p is much larger than n . Among various sparsity scenarios, we focus on group sparsity, where elements in \mathbf{w}^* can be partitioned into groups, and coefficients in each group are assumed to be either all zeros or all nonzeros. It is of primary interest to provide accurate estimation of \mathbf{w}^* and identify the relevant groups. If $\bar{k} := \|\mathbf{w}^*\|_{G,0}$ were known, where $\|\mathbf{w}\|_{G,0}$ is the number of nonzero groups in \mathbf{w} , the targeted problem can be naturally formulated through a general criterion function Q to find the “idealized” M-estimator

$$\bar{\mathbf{w}} = \arg \min_{\mathbf{w} \in \mathbb{R}^p} \left\{ Q(\mathbf{w}) := \frac{1}{n} \sum_{i=1}^n f_i(\mathbf{x}_i^T \mathbf{w}) \right\} \quad \text{s.t.} \quad \|\mathbf{w}\|_{G,0} \leq \bar{k}, \quad (1)$$

where $f_i(\cdot)$ is a given loss function determined by y_i . For example, under a standard linear model, we may choose least square loss $f_i(\theta_i) = (y_i - \theta_i)^2$; under generalized linear models (GLM) with canonical link (McCullagh and Nelder, 1989), we may use the negative log-likelihood. In practice, the estimator $\bar{\mathbf{w}}$ is “idealized” because it is computationally intractable (NP-hard) in high-dimensional settings and \bar{k} is not known *a priori*.

In standard sparsity learning, existing methods can be roughly categorized into shrinkage-type approaches (Tibshirani, 1996; Zou, 2006; Candes and Tao, 2005; Fan and Li, 2001; Zhang et al., 2010) and stepwise greedy-type approaches (Tropp, 2004; Zhang, 2011a; Ing and Lai, 2011). Following abundant work on standard sparsity, group sparsity has received considerable attention. Initially motivated from multi-level ANOVA models and additive models (Yuan and Lin, 2006), group sparsity learning has seen its use in many practical applications including genome wide association studies (e.g., Zhou et al., 2010), neuroimaging analysis (e.g., Jenatton et al., 2012; Jiao et al., 2017), multi-task learning (e.g., Lounici et al., 2011), actuarial risk segmentation (e.g., Qian et al., 2016), among many others. The benefits in estimation and inference using known grouping structure were also demonstrated through the celebrated group-lasso methods (see, e.g., Huang and Zhang, 2010; Huang et al., 2012; Lounici et al., 2011; Mitra et al., 2016 and references therein).

In this paper, we propose a new group sparsity learning algorithm that generalizes from the practically very popular forward-backward greedy-type approach (Zhang, 2011a). We call this new algorithm **Interactive Grouped Greedy Algorithm**, or IGA for abbreviation.

2 Related Work and Contribution

To facilitate detailed exposition of our work’s new contribution, in the following, we first introduce relevant notations (applicable to the entire paper) in Section 2.1 and connect our work to existing literature in Section 2.2 before summarizing the contribution in Section 2.3.

2.1 Notations

Given any set A , let $|A|$ be its cardinality. Let index sets g_1, g_2, \dots, g_m be m non-overlapped group indices that satisfy $\bigcup_{i=1}^m g_i = \{1, \dots, p\}$. We use G to denote the group (super) set $G = \{g_1, g_2, \dots, g_m\}$. Given a group set $S \subseteq G$, define $F_S := \bigcup_{g' \in S} g'$, which transforms the group set into a feature index set. Given vector $\mathbf{w} \in \mathbb{R}^p$ and index set g , define $\mathbf{w}_g \in \mathbb{R}^p$ to be the vector that keeps elements of \mathbf{w} indexed by g while setting all the other coordinates 0. Let $\text{supp}(\mathbf{w})$ be the index set of nonzero elements in \mathbf{w} , and let $\|\mathbf{w}\|_0$ be the size of $\text{supp}(\mathbf{w})$. Let $\|\cdot\|$ denote the usual ℓ_2 norm. Define the $\ell_{2,\infty}$ norm $\|\mathbf{w}\|_{G,\infty} := \max_{g \in G} \|\mathbf{w}_g\|$. Similarly, define the $\ell_{2,1}$ norm $\|\mathbf{w}\|_{G,1} := \sum_{g \in G} \|\mathbf{w}_g\|$. Also, define the group ℓ_0 norm $\|\mathbf{w}\|_{G,0} := \min\{|S| \mid \text{supp}(\mathbf{w}) \subset F_S, S \subset G\}$ to be the minimal number of groups covering $\text{supp}(\mathbf{w})$. Given integer s ($1 \leq s \leq m$), define $k_s = \max_{|S| \leq s, S \subset G} |F_S|$ to be the maximal cardinality of the union of s groups. Suppose the true coefficient vector \mathbf{w}^* is known to have a grouping structure G . Then $\bar{k} := \|\mathbf{w}^*\|_{G,0}$ is the number of relevant groups in the model, and $k_* := k_{\bar{k}}$ is the total number of elements in the relevant groups. Let $\Omega(h_1(x))$ be a function h_2 such that there exist two positive constants M and N with $N \leq M$, and we have $N|h_1(x)| \leq |h_2(x)| \leq M|h_1(x)|$ for sufficient large x .

2.2 Related Work

In group sparsity learning, an important and fruitful line of work comes from shrinkage-based approaches. In particular, extending from the lasso (Tibshirani, 1996), the group lasso has received considerable attention. The group lasso imposes the $\ell_{2,1}$ norm penalty on the targeted criterion function with a tuning parameter α by

$$\min_{\mathbf{w} \in \mathbb{R}^p} Q(\mathbf{w}) + \alpha \|\mathbf{w}\|_{G,1}, \quad (2)$$

and its methods and algorithms have been studied under both linear model (Yuan and Lin, 2006) and GLM (Kim et al., 2006; Meier et al., 2008) settings. Mostly under linear model settings, theoretical properties of the group lasso on both estimation and feature selection in high dimension have been investigated in, e.g., Nardi and Rinaldo (2008) and Wei and Huang (2010). Notably, under certain

variants of group restricted isometry property (RIP, Candes and Tao, 2005) or restricted eigenvalue (RE, Bickel et al., 2009) conditions, the group lasso was shown to be superior to the standard lasso in estimation and prediction (Huang and Zhang, 2010; Lounici et al., 2011), thereby proving the benefits of group sparsity.

On the other hand, it is expected that the group lasso will inherit the same drawbacks of the lasso, which include large estimation bias and relatively restrictive conditions on feature selection consistency (Fan and Li, 2001). Accordingly, various non-convex penalties such as SCAD (Fan and Li, 2001) and MCP (Zhang et al., 2010) were extended to allow incorporation of grouping structure and to replace the group lasso penalty in (2) so that consistent group selection can be achieved with less restrictive conditions than the group lasso (see, e.g., Huang et al., 2012; Jiao et al., 2017 and references therein).

Algorithm	Error Bound $O_p(\cdot)$	Required sample size $\Omega(\cdot)$	Reference
Lasso	$\frac{k_* \log(p)}{n}$	$k_* \log(p)$	van de Geer et al. (2011)
Dantzig	$\frac{k_* \log(p)}{n}$	$k_* \log(p)$	Candes and Tao (2007)
Multistage Lasso	$\frac{k_* + \Delta_2 \log(p)}{n}$	$k_* \log(p)$	Liu et al. (2012)
Multistage Dantzig	$\frac{k_* + \Delta_2 \log(p)}{n}$	$k_* \log(p)$	Liu et al. (2010)
MCP	$\frac{k_* + \Delta_1 \log(p)}{n}$	$k \log(p)$	Zhao et al. (2017)
OMP	$\frac{k_* \log(p)}{n}$	$k_*^2 \log(p)$	Zhang (2009)
OMP	$\frac{k_* \log(p)}{n}$	$k_* \log(p)$	Zhang (2011b)
FoBa	$\frac{k_* + \Delta_1 \log(p)}{n}$	$k_* \log(p)$	Zhang (2011a)
Group Lasso	$\frac{k_* + k \log(m)}{n}$	$k_* + \bar{k} \log(m)$	Huang and Zhang (2010)
Group OMP	$\frac{k_* + \Delta_3 p \log(p)}{n}$	–	Swirszcz et al. (2009)
Group OMP	$\frac{k_* \log(p)}{n}$	$k \log(p)$	Ben-Haim and Eldar (2011)
IGA	$\frac{k_* + \Delta_{IGA} \log(m)}{n}$	$k_* + \bar{k} \log(m)$	Our proposal
$\Delta_1 := \left \{i \in \text{supp}(\mathbf{w}^*) : \mathbf{w}_i^* \leq \Omega(\sqrt{\frac{\log(p)}{n}})\} \right $ $\Delta_2 := k_* - \left \left\{ i : i\text{-th largest element in } \mathbf{w}^* \geq \Omega(\sqrt{\frac{(k_* - i) \log(p)}{n}}) \right\} \right $ $\Delta_3 := \left \{g \in G : 0 < \ \mathbf{w}_g^*\ \leq \Omega(\sqrt{\frac{p \log(p)}{n}})\} \right $ $\Delta_{IGA} := \left \{g \in G : 0 < \ \mathbf{w}_g^*\ \leq \Omega(\sqrt{\frac{q + \log(m)}{n}})\} \right $			

Table 1: Comparison on the error bound $\|\hat{\mathbf{w}} - \mathbf{w}^*\|^2$ for $Q(\mathbf{w}) = \frac{1}{2n} \sum_{i=1}^n (y_i - \mathbf{x}_i^T \mathbf{w})^2$. $\hat{\mathbf{w}}$ is the estimator by each algorithm. Assume each group has equal size $q = p/m$.

Different from these shrinkage-based methods, the other main algorithm framework for group sparsity learning is the greedy-type methods. For *standard* sparsity learning, greedy algorithms have been studied extensively. For example, one of the representative algorithms is a forward

greedy algorithm known as the orthogonal matching pursuit (OMP, Mallat and Zhang, 1993). Its feature selection consistency (Zhang, 2009) and prediction/estimation error bounds (Zhang, 2011b) have been established under an irrepresentable condition and a RIP condition, respectively. Backward elimination steps were incorporated to greedy algorithms in Zhang (2011a) to allow correction of mistakes made by forward steps (known as FoBa algorithm). This seminal work attained more refined estimation results than that of OMP and the lasso by considering the delicate scenario of varying group signal strengths. Similar results on refined estimation error were also achieved by shrinkage-based methods with non-convex penalties (Zhao et al., 2017). Building on key understandings of the aforementioned greedy algorithms, much efforts were made to extend the OMP algorithms to handle group sparsity (Swirszcz et al., 2009; Ben-Haim and Eldar, 2011; Lozano et al., 2011). Although these group OMP algorithms have shown promising empirical performance, somewhat surprisingly, the explicitly justifiable benefits of group sparsity for greedy-type algorithms in terms of estimation convergence rate were yet to be documented under a general setting. The ℓ_2 estimation error bounds of some representative existing (group) sparsity learning methods are summarized in Table 1.

2.3 Our Contribution

The brief overview on related work above gives rise to three intriguing questions: (1) Can we devise a greedy-type algorithm that provides theoretically guaranteed benefits of group sparsity? Can we attain more refined estimation error bound than the group lasso? (2) If so, is there any guarantee on correct support recovery of relevant groups? (3) Is our proposal practically relevant to modern industrial applications and easy to use for practitioners?

- As the main contribution of our work, the proposed IGA algorithm affirmatively addresses all three questions above simultaneously. Consider a group sparse linear model with even group size $q = p/m$ and define the squared ℓ_2 estimation error $L_2(\hat{\mathbf{w}}) := \|\hat{\mathbf{w}} - \mathbf{w}^*\|^2$. Under a variant of the RIP condition, the IGA algorithm has $L_2(\hat{\mathbf{w}}) = O_p(\frac{k_* + \Delta_{\text{IGA}} \log(m)}{n})$, where Δ_{IGA} is the number of nonzero group with relatively weak signals (see Table 1 for precise definition). This estimation error has convergence rate matching $O_p(\frac{k_* + \bar{k} \log(m)}{n})$ under worst-case scenarios, confirming that our proposed greedy-type algorithm indeed gains the benefits of group sparsity as opposed to the slower convergence rate of $O_p(k_* \log(p)/n)$ for many standard sparsity learning methods. The desirable group support recovery property is also established for our proposal.
- Our proposal further develops a group forward-backward stepwise strategy by introducing extra algorithm flexibility to widen its applicability. It is worth noting that IGA is proposed under a

general M-estimation framework and can apply to a broad class of criterion functions well beyond a standard linear model. In particular, under a GLM setting, we demonstrate IGA’s promising and important industrial applications on sensor selection for human activity recognition. Another interesting layer of flexibility comes from an adjustable human interaction parameter that can potentially give practitioners more freedom to incorporate their own domain knowledge in feature selection without losing confidence of theoretical guarantees.

The rest of the paper is organized as follows. We introduce the proposed IGA algorithm in Section 3. Section 4 provides the theoretical analysis with a general criterion function $Q(\mathbf{w})$. Section 4.2 considers a special case where $Q(\mathbf{w})$ is the least square loss function and shows explicit estimation error bounds as well as group support recovery. Sections 5 and 6 show empirical studies using the IGA algorithm in comparison with other state-of-the-art feature/group selection algorithms. All technical lemmas and proofs are left in the Supplement.

3 Algorithms

The proposed IGA algorithm is an iterative stepwise greedy algorithm. At each iteration, a forward group selection step is performed, followed by a backward group elimination step. The forward step aims to identify one potentially useful group to be added to the estimator. This step typically identifies a set of candidate groups not selected yet that can drive down the criterion function $Q(\mathbf{w})$ the most. IGA is called *interactive* in that a human operator is allowed to select any group of his/her choice from the previous set of candidate groups. The selected group is then added to current group set for the next backward step. The backward step intends to correct mistakes made by forward steps and eliminate redundant groups that do not significantly drive down $Q(\mathbf{w})$. The forward-backward iteration stops when no group can be selected in the forward step.

The pseudo-code is given in Algorithm 1. For any index set $g = \{i_1, i_2, \dots, i_{|g|}\} \subset \{1, 2, \dots, p\}$, define $\mathbf{E}_g := [\mathbf{e}_{i_1}, \mathbf{e}_{i_2}, \dots, \mathbf{e}_{i_{|g|}}]$ to be a $p \times |g|$ matrix, where $\mathbf{e}_i \in \mathbb{R}^p$ is the unit vector whose i th element is 1 and all other elements are 0. Given $\mathbf{w} \in \mathbb{R}^p$ and index set g , let $\mathbf{w}_g \in \mathbb{R}^{|g|}$ be the sub-vector of \mathbf{w} corresponding to index g .

Specifically, we initialize the current set of groups $G^{(k)}$ as an empty set $G^{(k)} = \emptyset$ in Line 1, and then iteratively select and delete feature groups from $G^{(k)}$. Lines 3-5 provide the termination test: IGA terminates when no groups outside $G^{(k)}$ can decrease the criterion function $Q(\cdot)$ by a fixed threshold $\delta > 0$. Line 6 is the key step for forward group selection. First, we evaluate the quality of all groups outside of the current group set $G^{(k)}$ and, given a discount factor $\lambda \in (0, 1]$, construct a candidate group set \mathcal{A}_λ that includes all “good” groups. The human operator can then decide

Algorithm 1 IGA algorithm.

Require: $\delta > 0$ **Ensure:** $\mathbf{w}^{(k)}$

```
1:  $k = 0, \mathbf{w}^{(k)} = 0, G^{(0)} = \emptyset$ 
2: while TRUE do
3:   if  $Q(\mathbf{w}^{(k)}) - \min_{g \notin G^{(k)}, \alpha \in \mathbb{R}^{|g|}} Q(\mathbf{w}^{(k)} + \mathbf{E}_g \alpha) < \delta$  then
4:     Break
5:   end if
6:   select an element as  $g^{(k)}$  from the group set
    $\mathcal{A}_\lambda := \{g \notin G^{(k)} \mid (Q(\mathbf{w}) - \min_{\alpha \in \mathbb{R}^{|g|}} Q(\mathbf{w}^{(k)} + \mathbf{E}_g \alpha)) \geq \lambda (Q(\mathbf{w}) - \min_{g \notin G^{(k)}, \alpha \in \mathbb{R}^{|g|}} Q(\mathbf{w}^{(k)} + \mathbf{E}_g \alpha))\}$ 
7:    $G^{(k+1)} = G^{(k)} \cup \{g^{(k)}\}$ 
8:    $\mathbf{w}^{(k+1)} = \underset{\text{supp}(\mathbf{w}) \subset F_{G^{(k+1)}}}{\text{argmin}} Q(\mathbf{w})$ 
9:    $\delta^{(k+1)} = Q(\mathbf{w}^{(k)}) - Q(\mathbf{w}^{(k+1)})$ 
10:   $k = k + 1$ 
11: while TRUE do
12:   if  $\min_{g \in G^{(k)}} Q(\mathbf{w}^{(k)} - \mathbf{E}_g \mathbf{w}_g^{(k)}) - Q(\mathbf{w}^{(k)}) \geq \frac{\delta^{(k)}}{2}$  then
13:     Break
14:   end if
15:    $g^{(k)} = \underset{g \in G^{(k)}}{\text{argmin}} Q(\mathbf{w}^{(k)} - \mathbf{E}_g \mathbf{w}_g^{(k)})$ 
16:    $k = k - 1$ 
17:    $G^{(k)} = G^{(k+1)} \setminus \{g^{(k+1)}\}$ 
18:    $\mathbf{w}^{(k)} = \underset{\text{supp}(\mathbf{w}) \subset F_{G^{(k)}}}{\text{argmin}} Q(\mathbf{w})$ 
19: end while
20: end while
```

which group to select from \mathcal{A}_λ . Here the discount factor λ determines the extent to which human interaction is desired. Bigger λ typically gives smaller candidate group set and thereby less human involvement is allowed in group selection. In Lines 7-8, we recalculate the optimal coefficient of \mathbf{w} supported on the updated group set. At the end of the forward step, we calculate the gain from this step as $\delta^{(k)}$ in Line 9, which will feed into the subsequent backward step.

In the backward step, we intend to check if any group in current group set $G^{(k)}$ becomes redundant considering that some previously selected groups may be less important after new groups join from the forward steps. In Lines 12 – 14, for each group in $G^{(k)}$, we calculate the difference between the criterion function value restricted to the current group set and the function value restricted to the point with a single group removed from the current pool. If the smallest difference

is less than the threshold $\frac{\delta^{(k)}}{2}$, in Lines 15-18, we remove the least significant group, update the current group set $G^{(k)}$ and recalculate current estimator $\mathbf{w}^{(k)}$. This group elimination process continues until the function difference is less than $\frac{\delta^{(k)}}{2}$, i.e., all remaining selected groups are considered to have significant contribution.

In fact, the evaluation of quality on all feature groups in Lines 3 and Line 6 can be done in a more efficient way by using gradients of the criterion function $\nabla Q(\mathbf{w})$. Specifically, given a threshold value ε and a discount factor $0 < \lambda \leq 1$, if we replace corresponding statements in Lines 3 and Line 6 with $\|\nabla Q(\mathbf{w})\|_{G,\infty} < \varepsilon$ and $\{g \notin G^{(k)} \mid \|\nabla_g Q(\mathbf{w})\| \geq \lambda \arg\max_{g \notin G^{(k)}} \|\nabla_g Q(\mathbf{w})\|\}$, respectively, then we have another version of IGA algorithm. We call this new algorithm Gradient-based IGA algorithm (or GIGA for brevity). For presentation brevity, we left the GIGA algorithm in Algorithm 2 in Supplement B.

4 Theoretical Results

This section provides theoretical analysis of Algorithm 1. Using $\bar{\mathbf{w}}$ in (1) as a useful benchmark, we consider performance of IGA estimator $\mathbf{w}^{(k)}$ under a general criterion function Q in Section 4.1. Building on results of this general setting, we focus on sparse linear models in Section 4.2, and provide valuable insights into coefficient estimation and group support recovery.

4.1 A General Setting

We first introduce relevant definitions and assumptions regarding settings on the general criterion function $Q(\cdot)$. Unless stated otherwise, we consider a fixed design. Let \bar{G} be the sparsest group set covering all nonzero elements in $\bar{\mathbf{w}}$ and let $\mathcal{D} \subset \mathbb{R}^p$ be a compact feasible region for \mathbf{w} . Define

$$\rho_{-}(g) := \inf_{\text{supp}(\mathbf{u}) \subset g, \mathbf{w} \in \mathcal{D}} \frac{Q(\mathbf{w} + \mathbf{u}) - Q(\mathbf{w}) - \langle \nabla Q(\mathbf{w}), \mathbf{u} \rangle}{\frac{1}{2} \|\mathbf{u}\|^2}, \quad (3)$$

$$\rho_{+}(g) := \sup_{\text{supp}(\mathbf{u}) \subset g, \mathbf{w} \in \mathcal{D}} \frac{Q(\mathbf{w} + \mathbf{u}) - Q(\mathbf{w}) - \langle \nabla Q(\mathbf{w}), \mathbf{u} \rangle}{\frac{1}{2} \|\mathbf{u}\|^2}. \quad (4)$$

The restricted strongly convexity parameter and the restricted Lipschitz smoothness parameter (Huang and Zhang, 2010) are

$$\varphi_-(t) = \inf\{\rho_-(F_S) \mid S \subset G, |S| \leq t\}, \quad (5)$$

$$\varphi_+(t) = \sup\{\rho_+(F_S) \mid S \subset G, |S| \leq t\}, \quad (6)$$

respectively. Define the restricted condition number as $\kappa(t) = \frac{\varphi_+(t)}{\varphi_-(t)}$.

Assumption 1. *There exists an positive integer s satisfying*

$$\Omega(1) \leq \varphi_-(s) \leq \varphi_+(s) \leq \Omega(1), \quad (7)$$

$$s > \bar{k} + \frac{(\bar{k} + 1)(\sqrt{\kappa(s)} + 1)^2(\sqrt{2}\kappa(s))^2}{\lambda}. \quad (8)$$

In Assumption 1, (7) requires that $\varphi_+(s)$ and $\varphi_-(s)$ are upper bounded and bounded away from zero for large enough n . Given least square loss $Q(\mathbf{w}) = \frac{1}{2n}\|\mathbf{y} - X\mathbf{w}\|^2$ with $\mathbf{y} \in \mathbb{R}^n$ being the response vector and X being the $n \times p$ design matrix, (7) becomes a variant of the group-RIP condition (Huang and Zhang, 2010). Indeed, (7) is satisfied if there is a constant $0 < \eta < 1$, such that $(1 - \eta)\|\mathbf{w}\|^2 \leq \frac{1}{n}\|X\mathbf{w}\|^2 \leq (1 + \eta)\|\mathbf{w}\|^2$ for all $\|\mathbf{w}\|_{G,0} \leq s$.

The requirement in (8) of Assumption 1 is also mild. Note that $\kappa(s)$ is bounded if $Q(\mathbf{w})$ is a strongly convex function with bounded Lipschitzian gradient. Also, Lemma A.1 in Supplement A.1 shows that (8) holds with high probability under random design that \mathbf{x}_i 's are sub-Gaussian and the condition number of $\nabla^2 f_i(\cdot)$ is bounded; both least square function with $f_i(z) = \frac{1}{2}\|z - y_i\|^2$ and logistic regression with $f_i(z) = \log \frac{1}{1 + \exp\{-y_i z\}}$ ($y_i \in \{-1, 1\}$) fall under this scenario.

Theorem 4.1. *Suppose Assumption 1 holds. If δ in Algorithm 1 satisfies $\delta \geq C_\lambda \|\nabla Q(\bar{\mathbf{w}})\|_{G,\infty}^2$, where $C_\lambda = \frac{8\varphi_+(1)}{\lambda\varphi_-^2(s)}$, then IGA estimator $\mathbf{w}^{(k)}$ has following properties:*

- *Algorithm 1 terminates at $k < s - \bar{k}$;*
- $\|\bar{\mathbf{w}} - \mathbf{w}^{(k)}\|^2 \leq \Omega(\lambda^{-1}\|\nabla Q(\bar{\mathbf{w}})\|_{G,\infty}\bar{\Delta});$
- $Q(\mathbf{w}^{(k)}) - Q(\bar{\mathbf{w}}) \leq \Omega(\lambda^{-1}\|\nabla Q(\bar{\mathbf{w}})\|_{G,\infty}\bar{\Delta});$
- $|G^{(k)} \setminus \bar{G}| + |\bar{G} \setminus G^{(k)}| \leq \Omega(\lambda^{-1}\bar{\Delta}),$

where $\bar{\Delta} = |\{g \in \bar{G} : \|\bar{\mathbf{w}}_g\| < \Omega(\|\nabla Q(\bar{\mathbf{w}})\|_{G,\infty})\}|$.

The first claim states that the algorithm terminates. Using $\bar{\mathbf{w}}$ as a benchmark, the second and third bounds provide the ℓ_2 distance and the criterion function discrepancy of IGA estimator $\mathbf{w}^{(k)}$,

respectively. The last bound describes the group feature selection difference between $\mathbf{w}^{(k)}$ and $\bar{\mathbf{w}}$. Note that all error bounds depend on $\bar{\Delta}$, which counts the number of “weak” signal groups among nonzero groups in $\bar{\mathbf{w}}$. If all nonzero groups are strong enough and $\bar{\Delta}$ turns out to be zero, then $\mathbf{w}^{(k)}$ becomes equivalent to $\bar{\mathbf{w}}$ and the original NP hard problem (1) is exactly solved by Algorithm 1. Also note that although the discount factor λ slightly affect the error bound, if λ is bounded away from zero, it would not change the order of above error bounds while allowing the extra flexibility in human participation.

Analysis of gradient-based GIGA algorithm in Algorithm 2 provides similar theoretical results to Algorithm 1, and we leave them in Supplement B.

4.2 A Special Case: Sparse Linear Model

Consider true model that response vector $y \in \mathbb{R}^n$ is generated from $X\mathbf{w}^* + \varepsilon$ with ε being i.i.d. $N(0, 1)$. We use standard normal errors here, but our results can be easily generalized to sub-Gaussian errors. Suppose the columns of design matrix X are normalized to \sqrt{n} . We consider analysis of IGA algorithm with the least square criterion function $Q(\mathbf{w}) = \frac{1}{2n}\|\mathbf{y} - X\mathbf{w}\|^2$. To simplify the discussion, we will focus on the case that all m groups have equal size $q = p/m$, although our analysis can allow arbitrary group sizes.

In the following, Theorem 4.2 helps to connect Theorem 1 with the linear model.

Theorem 4.2. *Suppose Assumption 1 holds. Then the true coefficient vector \mathbf{w}^* satisfies*

$$\|\nabla Q(\mathbf{w}^*)\|_{G,\infty} \leq O_p\left(\frac{1}{\sqrt{n}}\left(\sqrt{\frac{p}{m}} + \sqrt{2\varphi_+(1)\log(m)}\right)\right).$$

The above is also true for the benchmark estimator $\bar{\mathbf{w}}$. That is,

$$\|\nabla Q(\bar{\mathbf{w}})\|_{G,\infty} \leq O_p\left(\frac{1}{\sqrt{n}}\left(\sqrt{\frac{p}{m}} + \sqrt{2\varphi_+(1)\log(m)}\right)\right) =: \xi_n. \quad (9)$$

The result of (9) above shows that if we set $\delta = C_\lambda \xi_n$, then the requirement on parameter δ in Theorem 4.1 holds in probability, and consequently, we can obtain explicit upper bounds using Theorem 4.1 for sparse linear model. Let G^* be the group set consisting of all nonzero groups in \mathbf{w}^* . Recall that $\Delta_{\text{IGA}} := |\{g \in G : 0 < \|\mathbf{w}_g^*\| \leq \Omega(\sqrt{\frac{q+\log(m)}{n}})\}|$ is the cardinality of the set of groups with relatively weak signals. In the following, we introduce the major results in both coefficient estimation and group support recovery in Theorem 4.3.

Theorem 4.3. *Suppose Assumption 1 holds, and set $\lambda = 0.5$ and $\delta = C_\lambda \xi_n$. Then IGA estimator $\mathbf{w}^{(k)}$ has the following properties:*

- $L_2(\mathbf{w}^{(k)}) := \|\mathbf{w}^* - \mathbf{w}^{(k)}\|^2 = O_p\left(\frac{k_* + \Delta_{IGA} \log m}{n}\right)$.
- *There is a constant $\tilde{C} > 0$ (not depending on n) such that if $\min_{g \in G^*} \|\mathbf{w}_g^*\| \geq \tilde{C} \sqrt{\frac{q + \log(m)}{n}}$, then group selection consistency holds that $P(G^{(k)} = G^*) \rightarrow 1$ as $n \rightarrow \infty$.*

Interestingly, the estimation consistency in Theorem 4.3 indeed demonstrates the benefits of group sparsity in estimation convergence rate: the estimation error $L_2(\mathbf{w}^{(k)})$ is upper bounded by $O_p(\frac{k_* + \bar{k} \log m}{n})$, which improves over the rate $O_p(\frac{k_* \log(p)}{n})$ of standard sparsity. In addition, our results can be more refined than the group lasso in the existence of strong group signals. In particular, under the beta-min condition that all m groups have ℓ_2 -norm lower bounded by $\Omega(\sqrt{\frac{q + \log(m)}{n}})$, $L_2(\mathbf{w}^{(k)})$ is improved to $O_p(k_*/n)$ by removing an additive term $\bar{k} \log m/n$, which can be a substantial improvement in high-dimensional settings $m \gg n$. Under the same conditions, Theorem 4.1 also shows that IGA is a consistent algorithm in group support recovery.

5 Simulations

We evaluated the performance of the IGA algorithm on simulation data in comparison with some representative algorithms shown in Table 1. Let $\hat{\mathbf{w}}$ be the estimator of an algorithm and let \hat{G} be the set of nonzero groups in $\hat{\mathbf{w}}$. Two evaluation measures were used: for group selection, define a “FG-measure” to be $2|\hat{G} \cap G^*|/(|\hat{G}| + |G^*|)$, which measures the group-level feature selection accuracy; for coefficient estimation accuracy, define estimation error to be $\|\hat{\mathbf{w}} - \mathbf{w}^*\|/\|\mathbf{w}^*\|$. Apparently, a good-performing algorithm tends to give large FG-measure and small estimation error.

We considered both linear regression (Case 1) and logistic regression (Case 2) settings. For Case 1, we used an additive model extended from Experiment 2 in Swirszcz et al. (2009). At each trial, we generated $n = 400$ data points with $p = 500$, which consist of 125 non-overlapping groups with 4 elements in each group. Features in each group were generated similar to Swirszcz et al. (2009), but we used fourth-order polynomial expansion instead. The number of nonzero groups was set to be 5, 7, 9, 11, or 13. After randomly selecting the non-zero groups $G^* \subset G$, we generated data from true model $y = \sum_{g \in G^*} \mathbf{w}_g^T \mathbf{x}_g + \varepsilon$, where each element in \mathbf{w}_g ’s ($g \in G^*$) followed independent uniform distribution $U(-0.5, 0.5)$ and $\varepsilon \sim N(0, 2)$. For Case 2, we extended Experiment 2 in Lozano et al. (2011), and the logistic function f was used to obtain the binary class label y_i ’s: $y_i = 1$ if $f(\eta_i) > 0.5$ and $y_i = -1$ otherwise, where $\eta = \sum_{g \in G^*} \mathbf{w}_g^T \mathbf{x}_g + \varepsilon$. The nonzero groups and

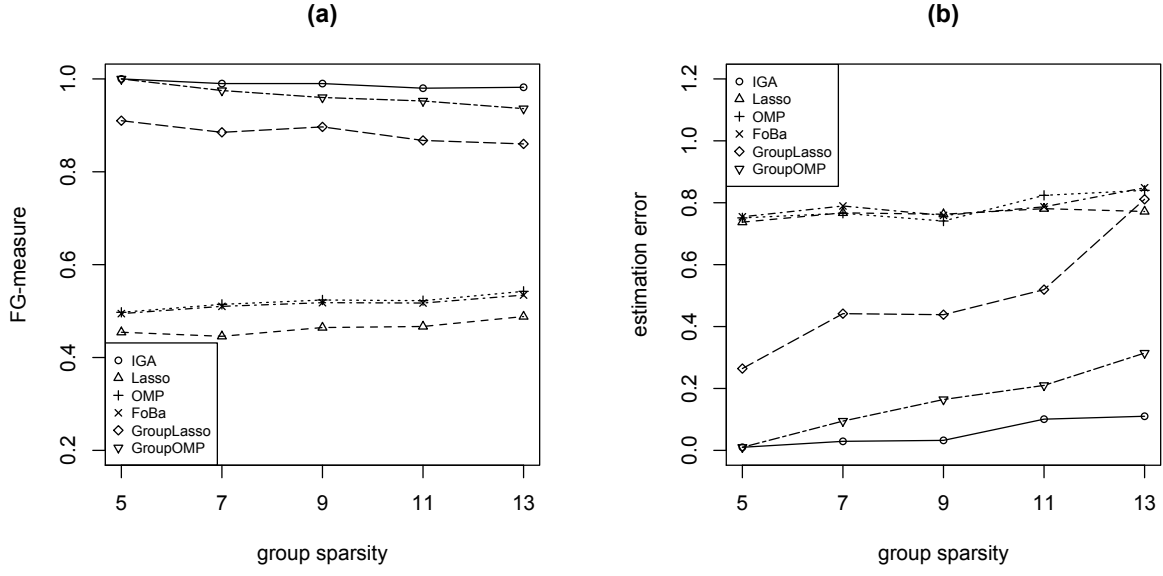

Figure 1: Performance comparison in Case 1. (a) averaged FG-measure; (b) averaged estimation error.

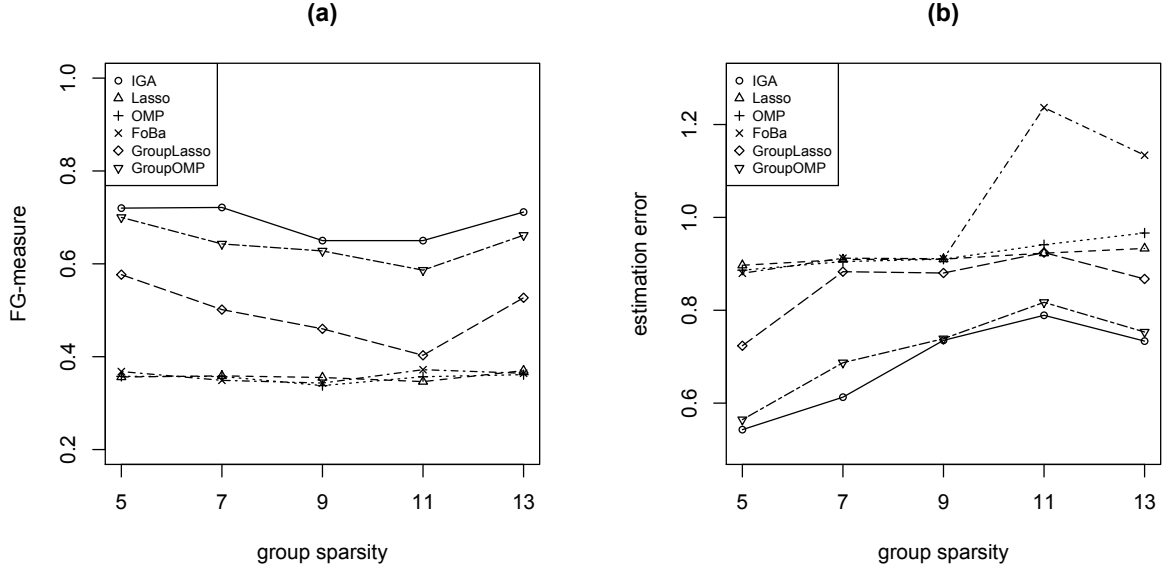

Figure 2: Performance comparison in Case 2. (a) averaged FG-measure; (b) averaged estimation error.

corresponding coefficients were generated by the same procedures as that of Case 1. We ran 50 trials in each setting, and for each considered method, we obtained the averaged values for both FG-measure and estimation error. The results of Case 1 and Case 2 are summarized in Figure 1 and

Figure 2, respectively.

We can see from both simulation cases that methods specifically designed for group sparsity (IGA, GroupLasso and GroupOMP) largely outperformed methods designed for standard sparsity (Lasso, OMP and FoBa). In particular, the IGA algorithm had largest FG-measure and smallest estimation error across all considered group sparsity levels (i.e., number of nonzero groups). These empirical results support that IGA enjoys very competitive performance in both group selection and coefficient estimation.

6 Sensor Selection for Human Activity Recognition

One important industrial application of group sparsity learning is in sensor selection problems. In particular, we are interested in a sensor selection problem for recognizing human activity at homes, and our study aims to reduce the number of deployed sensors while maintaining high activity recognition accuracy.

In the real experiment, we deployed 40 sensors with 14 considered activity categories. We used the pyroelectric infrared sensors, which return binary signals in reaction to human motion. Figure 3 shows our experimental room layout and sensor locations. The number stands for sensor ID and the circle approximately represents the area covered by the corresponding sensor. As can be seen, 40 sensors have been deployed, which returned 40-dimensional binary time series data. We have the pre-determined 14 categories summarized in Table 2.

Two types of features were created: activity-signal features ($40 \times 14 = 560$) and activity-activity features ($14 \times 14 = 196$). Given the aim of sensor number reduction, enforcement of sparseness to individual features can be rather inefficient. Accordingly, we created 40 groups on activity-signal features and each group contained features related to one sensor. We used a linear-chain conditional random field (CRF, Lafferty et al., 2001), which gives a smooth and convex loss function for time series data. We compared three sensor selection methods: IGA, gradient FoBa (FoBa, Liu et al., 2013) and Group L1 CRF (GroupLasso).

The overall classification error rates on testing sample with varying number of sensors are summarized in Figure 4(a). We discovered that

- When the number of sensors was relatively small (5-9), IGA outperformed the other methods. With the sufficient number of sensors, FoBa also performed competitively. We observed big accuracy improvement for FoBa around 10-11 sensors. The lists of selected sensors in Table 3, in together with the corresponding classification results in Figures 4(a), seemed to suggest that the features related to Sensor 28 were important (for a justification, see also

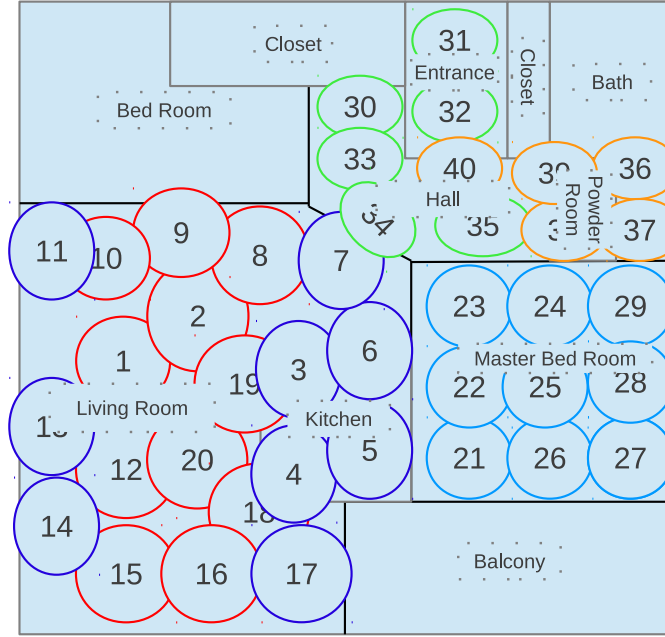

Figure 3: Room layout and sensor locations

Table 2: Activities in the sensor data set

ID	Activity	train / test samples
1	Sleeping	81K / 87K
2	Out of Home (OH)	66K / 42K
3	Using Computer	64K / 46K
4	Relaxing	25K / 65K
5	Eating	6.4K / 6.0K
6	Cooking	5.2K / 4.6K
7	Showering (Bathing)	3.9K / 45.0K
8	No Event	3.4K / 3.5K
9	Using Toilet	2.5K / 2.6K
10	Hygiene (brushing teeth, etc)	1.6K / 1.6K
11	Dishwashing	1.5K / 1.8K
12	Beverage Preparation	1.4K / 1.4K
13	Bath Cleaning / Preparation	0.5K / 0.3K
14	Others	6.5K / 2.1K
Total	-	270K / 270K

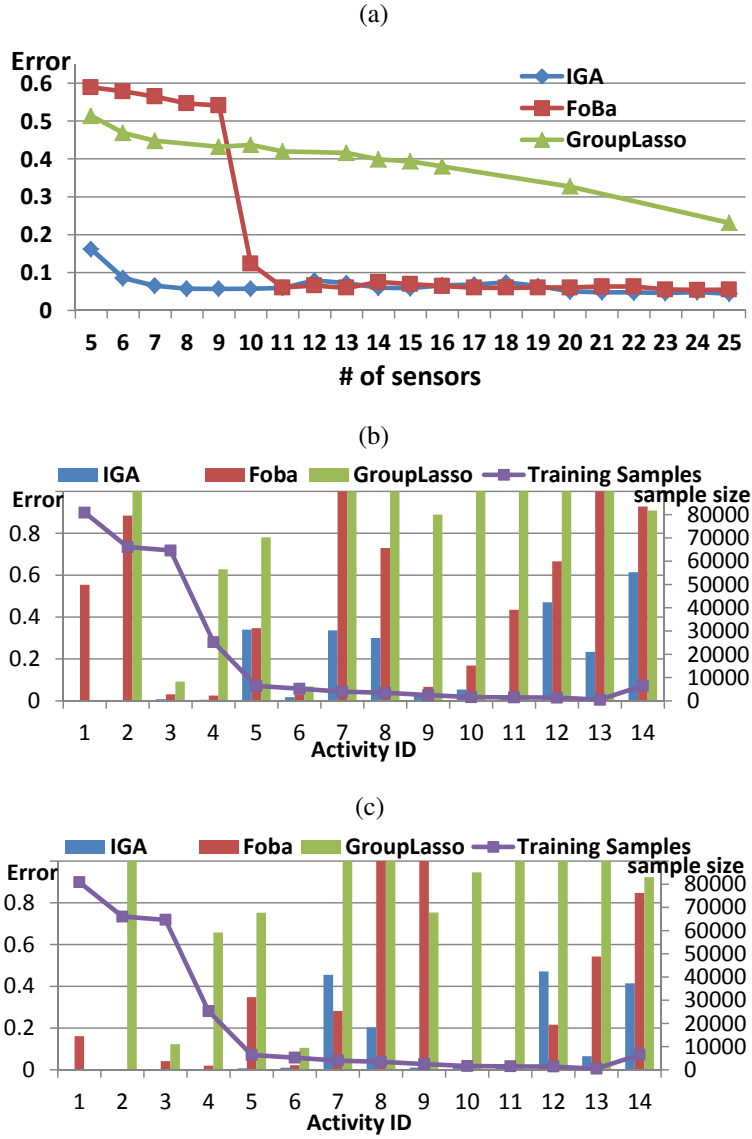

Figure 4: Comparison among FoBa, GroupLasso, and IGA. (a) Test classification errors; (b) Activity-wise classification errors with 7 sensors; (c) Activity-wise classification errors with 10 sensors.

discussion below on individual activities). The IGA successfully chose this sensor in early iterations while FoBa need longer iterations.

- IGA required only 7-8 sensors to achieve nearly best performance though FoBa required 11-12 sensors. Therefore, we can reduce 4-5 sensors by using IGA in practice. GroupLasso gradually reduced the classification error with increasing number of sensors, but its classification performance was not ideal in this study when compared to the considered greedy methods.

Table 3: Selected sensors

Method	7 sensors	10 sensors
IGA	{5, 8, 10, 19, 28, 39, 40}	{7 sensors} \cup {1, 31, 35}
FoBa	{1, 5, 9, 10, 19, 39, 40}	{7 sensors} \cup {8, 28, 35}
GroupLasso	{1, 5, 9, 10, 19, 39, 40}	{7 sensors} \cup {2, 36, 37}

The classification errors for individual activities with 7 sensors and 10 sensors are shown in Figure 4(b) and Figure 4(c), respectively. We can see that for most of the activities, with either 7 or 10 sensors, IGA performed generally better than the other two alternatives. Interestingly, recognition errors of FoBa for the activities, *Sleeping* (Activity ID=1) and *Out of Home* (Activity ID=2), were quite poor with 7 sensors, but the errors were drastically reduced with 10 sensors. Since both the *Sleeping* and *Out of Home* activities have “quiet” movements and generate little sensor signals, they are expected to be difficult to distinguish from each other. Our experiment results above showed that FoBa added Sensor 28 at “the number of sensor = 10” and its recognition error dramatically improved. This observation made practical sense as Sensor 28 was located near the bed (shown in Figure 3) and therefore played a key role to distinguish these two activities. This reaffirms our discussion above from Figure 4(a) and Table 3 that the Sensor 28 is an important one to achieve good overall classification results; with noisy signals from the “quiet” movements, IGA can discover this sensor at earlier steps than that of FoBa.

Overall, in comparison with standard greedy approach and the grouped shrinkage-based approach, this real-world experiment confirms the successful industrial application of the proposed IGA algorithm in sensor selection problems for human activity recognition.

7 Conclusion

In this paper, we propose a new interactive greedy algorithm designed to exploit known grouping structure for improved estimation and feature recovery performance. Motivated under a general

setting applicable to a broad range of applications such as sensor selection for human activity recognition, we provide the theoretical and empirical investigations on the proposed algorithm. This study establishes explicit estimation error bounds and group selection consistency results in high-dimensional linear models, and supports that the new algorithm is a promising and flexible group sparsity learning tool.

In the future, it is of interest to conduct further study under the general setting and give explicit performance guarantee beyond linear models. In particular, the explicit estimation convergence rate for GLM models are yet to be established. In addition, it is worth studying whether our model assumption can be further relaxed to handle non-smooth objective functions. The estimation and group selection performance of the proposed algorithm on high-dimensional quantile regressions as well as models with heterogeneous errors remain to be challenging but important open questions.

Supplementary Materials

In the supplementary file (supplement.pdf), Supplement A contains additional technical lemmas, theorems and proofs; Supplement B contains the GIGA algorithm and its technical details.

References

- Ben-Haim, Z. and Eldar, Y. C. (2011), ‘Near-oracle performance of greedy block-sparse estimation techniques from noisy measurements’, *IEEE Journal of Selected Topics in Signal Processing* **5**(5), 1032–1047.
- Bickel, P. J., Ritov, Y. and Tsybakov, A. B. (2009), ‘Simultaneous analysis of lasso and Dantzig selector’, *The Annals of Statistics* **37**(4), 1705–1732.
- Candes, E. J. and Tao, T. (2005), ‘Decoding by linear programming’, *IEEE Transactions on Information Theory* **51**(12), 4203–4215.
- Candes, E. J. and Tao, T. (2007), ‘The Dantzig selector: Statistical estimation when p is much larger than n ’, *The Annals of Statistics* **35**(6), 2313–2351.
- Fan, J. and Li, R. (2001), ‘Variable selection via nonconcave penalized likelihood and its oracle properties’, *Journal of the American statistical Association* **96**(456), 1348–1360.
- Hsu, D., Kakade, S. and Zhang, T. (2012), ‘A tail inequality for quadratic forms of subgaussian random vectors’, *Electronic Communications in Probability* **17**(52).
- Huang, J., Breheny, P. and Ma, S. (2012), ‘A selective review of group selection in high-dimensional models’, *Statistical Science* **27**(4).

- Huang, J. and Zhang, T. (2010), ‘The benefit of group sparsity’, *The Annals of Statistics* **38**(4), 1978–2004.
- Ing, C.-K. and Lai, T. L. (2011), ‘A stepwise regression method and consistent model selection for high-dimensional sparse linear models’, *Statistica Sinica* **21**(4), 1473–1513.
- Jenatton, R., Gramfort, A., Michel, V., Obozinski, G., Eger, E., Bach, F. and Thirion, B. (2012), ‘Multiscale mining of fmri data with hierarchical structured sparsity’, *SIAM Journal on Imaging Sciences* **5**(3), 835–856.
- Jiao, Y., Jin, B. and Lu, X. (2017), ‘Group sparse recovery via the l_0 (l_2) penalty: Theory and algorithm’, *IEEE Transactions on Signal Processing* **65**(4), 998–1012.
- Kim, Y., Kim, J. and Kim, Y. (2006), ‘Blockwise sparse regression’, *Statistica Sinica* **16**(2), 375.
- Lafferty, J., McCallum, A., Pereira, F. et al. (2001), Conditional random fields: Probabilistic models for segmenting and labeling sequence data, in ‘International Conference on Machine Learning’, pp. 282–289.
- Liu, J., Fujimaki, R. and Ye, J. (2013), ‘Forward-backward greedy algorithms for general convex smooth functions over a cardinality constraint’, *arXiv preprint arXiv:1401.0086*.
- Liu, J., Wonka, P. and Ye, J. (2010), Multi-stage dantzig selector, in ‘Advances in Neural Information Processing Systems’, pp. 1450–1458.
- Liu, J., Wonka, P. and Ye, J. (2012), ‘A multi-stage framework for dantzig selector and lasso’, *The Journal of Machine Learning Research* **13**(1), 1189–1219.
- Lounici, K., Pontil, M., Van De Geer, S. and Tsybakov, A. B. (2011), ‘Oracle inequalities and optimal inference under group sparsity’, *The Annals of Statistics* **39**(4), 2164–2204.
- Lozano, A. C., Swirszcz, G. and Abe, N. (2011), Group orthogonal matching pursuit for logistic regression, in ‘International Conference on Artificial Intelligence and Statistics’, pp. 452–460.
- Mallat, S. G. and Zhang, Z. (1993), ‘Matching pursuits with time-frequency dictionaries’, *IEEE Transactions on Signal Processing* **41**(12), 3397–3415.
- McCullagh, P. and Nelder, J. A. (1989), *Generalized Linear Models*, Chapman and Hall.
- Meier, L., Van De Geer, S. and Bühlmann, P. (2008), ‘The group lasso for logistic regression’, *Journal of the Royal Statistical Society, Series B* **70**(1), 53–71.
- Mitra, R., Zhang, C.-H. et al. (2016), ‘The benefit of group sparsity in group inference with de-biased scaled group lasso’, *Electronic Journal of Statistics* **10**(2), 1829–1873.
- Nardi, Y. and Rinaldo, A. (2008), ‘On the asymptotic properties of the group lasso estimator for linear models’, *Electronic Journal of Statistics* **2**, 605–633.
- Qian, W., Yang, Y. and Zou, H. (2016), ‘Tweedie’s compound poisson model with grouped elastic net’, *Journal of Computational and Graphical Statistics* **25**(2), 606–625.

- Rudelson, M., Vershynin, R. et al. (2013), ‘Hanson-wright inequality and sub-gaussian concentration’, *Electronic Communications in Probability* **18**(82), 1–9.
- Swirszcz, G., Abe, N. and Lozano, A. C. (2009), Grouped orthogonal matching pursuit for variable selection and prediction, in ‘Advances in Neural Information Processing Systems’, pp. 1150–1158.
- Tibshirani, R. (1996), ‘Regression shrinkage and selection via the lasso’, *Journal of the Royal Statistical Society. Series B (Methodological)* pp. 267–288.
- Tropp, J. A. (2004), ‘Greed is good: Algorithmic results for sparse approximation’, *IEEE Transactions on Information Theory* **50**(10), 2231–2242.
- van de Geer, S., Bühlmann, P. and Zhou, S. (2011), ‘The adaptive and the thresholded lasso for potentially misspecified models (and a lower bound for the lasso)’, *Electronic Journal of Statistics* **5**, 688–749.
- Vershynin, R. (2010), ‘Introduction to the non-asymptotic analysis of random matrices’, *arXiv preprint arXiv:1011.3027*.
- Wei, F. and Huang, J. (2010), ‘Consistent group selection in high-dimensional linear regression’, *Bernoulli* **16**(4), 1369.
- Yuan, M. and Lin, Y. (2006), ‘Model selection and estimation in regression with grouped variables’, *Journal of the Royal Statistical Society: Series B (Statistical Methodology)* **68**(1), 49–67.
- Zhang, C.-H. et al. (2010), ‘Nearly unbiased variable selection under minimax concave penalty’, *The Annals of Statistics* **38**(2), 894–942.
- Zhang, T. (2009), ‘On the consistency of feature selection using greedy least squares regression’, *Journal of Machine Learning Research* **10**, 555–568.
- Zhang, T. (2011a), ‘Adaptive forward-backward greedy algorithm for learning sparse representations’, *IEEE Transactions on Information Theory* **57**(7), 4689–4708.
- Zhang, T. (2011b), ‘Sparse recovery with orthogonal matching pursuit under rip’, *IEEE Transactions on Information Theory* **57**(9), 6215–6221.
- Zhao, P. and Yu, B. (2006), ‘On model selection consistency of lasso’, *Journal of Machine learning research* **7**(Nov), 2541–2563.
- Zhao, T., Liu, H. and Zhang, T. (2017), ‘Pathwise coordinate optimization for sparse learning: Algorithm and theory’, *The Annals of statistics*. to appear.
- Zhou, H., Sehl, M. E., Sinsheimer, J. S. and Lange, K. (2010), ‘Association screening of common and rare genetic variants by penalized regression’, *Bioinformatics* **26**(19), 2375–2382.
- Zou, H. (2006), ‘The adaptive lasso and its oracle properties’, *Journal of the American Statistical Association* **101**(476), 1418–1429.

Supplement to “An Interactive Greedy Approach to Group Sparsity in High Dimension”

A Supplement: Lemmas, Theorems and Proofs

A.1 A Lemma on Assumption 1

The following Lemma confirms our examples satisfy Assumption 1.

Lemma A.1. *Let $Q(\mathbf{w}) = \frac{1}{n} \sum_{i=1}^n f_i(\mathbf{x}_i^\top \mathbf{w})$. All data points \mathbf{x}_i 's follow from i.i.d. isotropic sub-Gaussian distribution with enough samples $n \geq \Omega(k_{\bar{k}} + \bar{k} \log m)$. Let $L := \sup_{z \in \mathcal{Z}} \lambda_{\max}(\nabla^2 f_i(z))$ and $l = \inf_{z \in \mathcal{Z}} \lambda_{\min}(\nabla^2 f_i(z))$ where $\mathcal{Z} := \{\mathbf{x}_i^\top \mathbf{w} : \mathbf{w} \in \mathcal{D}, \forall i = 1, 2, \dots\}$. The condition number τ is defined as $\tau := \frac{L}{l}$. If the condition number τ is bounded, then with high probability there exists an s satisfying the first part of Assumption 1.*

Proof. Let the upper bound of the maximal eigenvalue and the lower bound of the minimal eigenvalue of $\nabla^2 f(z)$ be L and l respectively. The condition number τ is defined as $\tau = L/l$. From the definition of $\rho_+(g)$ in (4) and the convexity of $f_i(\cdot)$, we have

$$\begin{aligned} n\rho_+(g) &= \lambda_{\max} \left(\sum_{i=1}^n (\mathbf{x}_i)_g (\mathbf{x}_i)_g^\top \nabla^2 f_i(\mathbf{x}_i^\top \mathbf{w}) \right) \\ &\leq \max_{z,i} \nabla^2 f_i(z) \lambda_{\max} \left(\sum_{i=1}^n (\mathbf{x}_i)_g (\mathbf{x}_i)_g^\top \right) \\ &\leq L \lambda_{\max} \left(\sum_{i=1}^n (\mathbf{x}_i)_g (\mathbf{x}_i)_g^\top \right). \end{aligned} \tag{A.1}$$

Similarly, for $\rho_-(g)$, we have

$$n\rho_-(g) \geq l \lambda_{\min} \left(\sum_{i=1}^n (\mathbf{x}_i)_g (\mathbf{x}_i)_g^\top \right).$$

Let T_s be a super set: $T_s = \{F_S \mid |S| \leq s, S \subset G\}$ and $k_s := \max_{g \in T_s} |g|$. From the random matrix theory (Vershynin, 2010, Theorem 5.39), for any $g \in T_s$ we have

$$\sqrt{\lambda_{\max} \left(\sum_{i=1}^n (\mathbf{x}_i)_g (\mathbf{x}_i)_g^\top \right)} \geq \sqrt{n} + \Omega(\sqrt{|g|}) + \Omega(t) \tag{A.2}$$

holds with probability at most $\exp\{-t^2\}$. From the definition of $\varphi_+(s)$ in (6), we have

$$\varphi_+(s) := \max_{g \in T_s} \rho_+(g).$$

Then we use the union bound to provide an upper (probability) bound for $\varphi_+(s)$

$$\begin{aligned} & \Pr \left(\sqrt{n\varphi_+(s)/L} \geq \sqrt{n} + \Omega(\sqrt{k_s}) + \Omega(t) \right) \\ & \leq \sum_{g \in T_s} \Pr \left(\sqrt{n\varphi_+(s)/L} \geq \sqrt{n} + \Omega(\sqrt{k_s}) + \Omega(t) \right) \\ & \leq \sum_{g \in T_s} \Pr \left(\sqrt{n\varphi_+(s)/L} \geq \sqrt{n} + \Omega(\sqrt{|g|}) + \Omega(t) \right) \\ & \leq \binom{m}{s} \exp\{-t^2\} \quad (\text{from (A.1) and (A.2)}) \\ & \leq \exp\{s \log(m) - t^2\}. \end{aligned}$$

Taking $t = \Omega(\sqrt{s \log m})$, it follows

$$\Pr \left(\sqrt{n\varphi_+(s)/L} \geq \sqrt{n} + \Omega(\sqrt{k_s} + \sqrt{s \log m}) \right) \leq \exp\{-\Omega(s \log m)\}. \quad (\text{A.3})$$

Similarly, we have

$$\Pr \left(\sqrt{n\varphi_-(s)/l} \geq \sqrt{n} - \Omega(\sqrt{k_s} + \sqrt{s \log m}) \right) \leq \exp\{-\Omega(s \log m)\}. \quad (\text{A.4})$$

Now we are ready to bound $\tau(s)$. We can choose the value of n large enough such that \sqrt{n} is greater than $3\Omega(\sqrt{k_s} + \sqrt{s \log m})$, which indicates

$$\Pr \left(\sqrt{n\varphi_+(s)/L} \leq \frac{4}{3}\sqrt{n} \right) \geq 1 - \exp\{-\Omega(s \log m)\}$$

and

$$\Pr \left(\sqrt{n\varphi_-(s)/l} \geq \frac{2}{3}\sqrt{n} \right) \geq 1 - \exp\{-\Omega(s \log m)\}$$

It follows that

$$\Pr(\kappa(s) \leq 2\tau) = \Pr \left(\frac{\sqrt{n\varphi_+(s)/L}}{\sqrt{n\varphi_-(s)/l}} \leq \sqrt{2} \right) \geq 1 - 2 \exp\{-\Omega(s \log m)\}. \quad (\text{A.5})$$

Since τ is bounded, there exists an $s = \Omega(\bar{k})$ satisfying Assumption 1. The required number of samples is $n \geq \Omega(k_s + s \log m) = \Omega(k_{\Omega(\bar{k})} + \Omega(\bar{k}) \log m) = \Omega(k_{\bar{k}} + \bar{k} \log m)$. It completes the proof. \square

A.2 Analysis for the Objection Function Algorithm

Our analysis and proofs follow the scheme in (Liu et al., 2013). But the group structure of the data makes the proof much harder. In short, we have to filter the group information into the individual features in a seamless way.

First, we have to transform the difference of functions into the norms of the partial derivatives of Q .

Lemma A.2. *For any group $g \in G$ and $\mathbf{w} \in \mathcal{D}$, if*

$$Q(\mathbf{w}) - \min_{\alpha \in \mathbb{R}^{|g|}} Q(\mathbf{w} + \mathbf{E}_g \alpha) \geq \lambda \delta,$$

then

$$\|\nabla_g Q(\mathbf{w})\| \geq \sqrt{2\varphi_-(1)\lambda\delta}.$$

Proof. Note that we specify the dimension of α explicitly here, but it is quite trivial to find the correct dimension and hence we will ignore the specific dimension from now on for the simplicity of calculation. Taking the parameter λ into considerations, we have

$$\begin{aligned} -\lambda\delta &\geq \min_{\alpha} Q(\mathbf{w} + \mathbf{E}_g \alpha) - Q(\mathbf{w}) \\ &\geq \min_{\alpha} \langle \nabla Q(\mathbf{w}), \mathbf{E}_g \alpha \rangle + \frac{\varphi_-(1)}{2} \|\mathbf{E}_g \alpha\|^2 \quad (\text{from the definition of } \varphi_-(1)) \\ &= \min_{\alpha} \langle \nabla_g Q(\mathbf{w}), \alpha \rangle + \frac{\varphi_-(1)}{2} \|\alpha\|^2 \\ &= -\frac{\|\nabla_g Q(\mathbf{w})\|^2}{2\varphi_-(1)}. \end{aligned}$$

Hence we have $\|\nabla_g Q(\mathbf{w})\| \geq \sqrt{2\varphi_-(1)\lambda\delta}$ and this completes the proof of the lemma. \square

Similarly, we can have a similar conclusion in the other direction.

Lemma A.3. *For any $\mathbf{w} \in \mathcal{D}$, if $Q(\mathbf{w}) - \min_{g \in G, \alpha} Q(\mathbf{w} + \mathbf{E}_g \alpha) \leq \delta$, then*

$$\|\nabla Q(\mathbf{w})\|_{G, \infty} \leq \sqrt{2\varphi_+(1)\delta}.$$

Proof. In our backward algorithm, there is no tolerance of sub-prime groups. So we do not have λ in the following calculation.

$$\begin{aligned}
\delta &\geq Q(\mathbf{w}) - \min_{g \in G, \alpha} Q(\mathbf{w} + \mathbf{E}_g \alpha) \\
&= \max_{g \in G, \alpha} - (Q(\mathbf{w} + \mathbf{E}_g \alpha) - Q(\mathbf{w})) \\
&\geq \max_{g \in G, \alpha} - \langle \nabla Q(\mathbf{w}), \mathbf{E}_g \alpha \rangle - \frac{\varphi_+(1)}{2} \|\mathbf{E}_g \alpha\|^2 \quad (\text{from the definition of } \varphi_+(1)) \\
&= \max_{g \in G, \alpha} - \langle \nabla_g Q(\mathbf{w}), \alpha \rangle - \frac{\varphi_+(1)}{2} \|\alpha\|^2 \\
&= \max_{g \in G} \frac{\|\nabla_g Q(\mathbf{w})\|^2}{2\varphi_+(1)} \\
&= \frac{\|\nabla Q(\mathbf{w})\|_{G, \infty}^2}{2\varphi_+(1)}.
\end{aligned}$$

Taking square roots on both sides, we can find the relation in the lemma. And it completes the proof. \square

Due to the stop condition in our algorithm, we have the following relations between the group selections and parameter estimations.

Lemma A.4. *At the end of each backward step and hence when our algorithm stops, we have the following connections of our selected parameters and groups:*

$$\begin{aligned}
\|\mathbf{w}_{G^{(k)} \setminus \bar{G}}^{(k)}\|^2 &= \|(\mathbf{w}^{(k)} - \bar{\mathbf{w}})_{G^{(k)} \setminus \bar{G}}\|^2 = \|\mathbf{w}^{(k)} - \bar{\mathbf{w}}\|^2 \\
&\geq \frac{\delta^{(k)}}{\varphi_+(1)} |G^{(k)} \setminus \bar{G}| \geq \frac{\lambda \delta}{\varphi_+(1)} |G^{(k)} \setminus \bar{G}|
\end{aligned}$$

Proof. Let's consider all candidates of removal groups in the backward step, and we have

$$\begin{aligned}
& |G^{(k)} \setminus \bar{G}| \min_{g \in G^{(k)} \setminus \bar{G}} Q(\mathbf{w}^{(k)} - \mathbf{w}_g^{(k)}) \\
& \leq \sum_{g \in G^{(k)} \setminus \bar{G}} Q(\mathbf{w}^{(k)} - \mathbf{w}_g^{(k)}) \\
& \leq \sum_{g \in G^{(k)} \setminus \bar{G}} (Q(\mathbf{w}^{(k)}) - \langle \nabla Q(\mathbf{w}^{(k)}), \mathbf{w}_g^{(k)} \rangle) + \sum_{g \in G^{(k)} \setminus \bar{G}} \frac{\varphi_+(1)}{2} \|\mathbf{w}_g^{(k)}\|^2 \\
& = |G^{(k)} \setminus \bar{G}| Q(\mathbf{w}^{(k)}) + \frac{\varphi_+(1)}{2} \|\mathbf{w}_{G^{(k)} \setminus \bar{G}}^{(k)}\|^2. \quad (\mathbf{w}^{(k)} \text{ is the optimal on } G^{(k)})
\end{aligned}$$

Hence, we have

$$|G^{(k)} \setminus \bar{G}| \min_{g \in G^{(k)} \setminus \bar{G}} Q(\mathbf{w}^{(k)} - \mathbf{w}_g^{(k)}) - Q(\mathbf{w}^{(k)}) \leq \frac{\varphi_+(1)}{2} \|\mathbf{w}_{G^{(k)} \setminus \bar{G}}^{(k)}\|^2.$$

Recall the fact that, in the backward algorithm, we will stop at the point where the left hand side is no less than $\frac{\delta^{(k)}}{2}$. Hence, we have $\|\mathbf{w}_{G^{(k)} \setminus \bar{G}}^{(k)}\|^2 \geq \frac{|G^{(k)} \setminus \bar{G}| \delta^{(k)}}{\varphi_+(1)}$. The first two equalities in the lemma are trivial observations, and the last inequality is due to the requirement that $\delta^{(k)} > \lambda \delta$ in our Algorithm 1.

It completes the proof of the lemma. \square

The above Lemma A.4 will help us in transforming the sparsity condition into estimating the errors of the parameters.

Moreover, using this idea, we can just concentrate on the case where our selection of groups is no better than optimal sparse solution we assumed. To be precise, we have

Lemma A.5. *For any integer s larger than $|G^{(k)} \setminus \bar{G}|$, and if*

$$\delta > \frac{4\varphi_+(1)}{\lambda\varphi_-^2(s)} \|\nabla Q(\bar{\mathbf{w}})\|_{G,\infty}^2,$$

then at the end of each backward step k , we have

$$Q(\mathbf{w}^{(k)}) \geq Q(\bar{\mathbf{w}}). \quad (\text{A.6})$$

Proof. Considering the difference of the two values, we have

$$\begin{aligned}
& Q(\mathbf{w}^{(k)}) - Q(\bar{\mathbf{w}}) \\
& \geq \langle \nabla Q(\bar{\mathbf{w}}), \mathbf{w}^{(k)} - \bar{\mathbf{w}} \rangle + \frac{\varphi_-(s)}{2} \|\mathbf{w}^{(k)} - \bar{\mathbf{w}}\|^2 \\
& \geq \langle \nabla Q(\bar{\mathbf{w}}), (\mathbf{w}^{(k)} - \bar{\mathbf{w}})_{G^{(k)} \setminus \bar{G}} \rangle + \frac{\varphi_-(s)}{2} \|\mathbf{w}^{(k)} - \bar{\mathbf{w}}\|^2 \\
& \geq -\|\nabla Q(\bar{\mathbf{w}})\|_{G,\infty} \|\mathbf{w}^{(k)} - \bar{\mathbf{w}}\|_{G,1} + \frac{\varphi_-(s)}{2} \|\mathbf{w}^{(k)} - \bar{\mathbf{w}}\|^2 \\
& \geq -\|\nabla Q(\bar{\mathbf{w}})\|_{G,\infty} \|\mathbf{w}^{(k)} - \bar{\mathbf{w}}\| \sqrt{|G^{(k)} \setminus \bar{G}|} + \frac{\varphi_-(s)}{2} \|\mathbf{w}^{(k)} - \bar{\mathbf{w}}\|^2 \quad (\text{Cauchy-Schwartz}) \\
& \geq -\|\nabla Q(\bar{\mathbf{w}})\|_{G,\infty} \|\mathbf{w}^{(k)} - \bar{\mathbf{w}}\|^2 \sqrt{\frac{\varphi_+(1)}{\delta^{(k)}}} + \frac{\varphi_-(s)}{2} \|\mathbf{w}^{(k)} - \bar{\mathbf{w}}\|^2.
\end{aligned}$$

Note that the last line is due to Lemma A.4. Finally, from our choice of δ and the fact that $\delta^{(k)} > \lambda\delta$, we can then conclude that the last line is bigger than 0.

Hence we will have general assumption $Q(\mathbf{w}^{(k)}) \geq Q(\bar{\mathbf{w}})$ if $\delta > \frac{4\varphi_+(1)}{\varphi_-^2(s)} \|\nabla Q(\bar{\mathbf{w}})\|_{G,\infty}^2$.

This completes the proof of the lemma. \square

One key part of the proof idea is to compare the difference of the convex function at different optimal values supported on different groups with some other quantities. To this end we have the following theorem.

Lemma A.6. Suppose that \hat{G} is a subset of the super set G and we set $\hat{\mathbf{w}} = \underset{\text{supp}(\mathbf{w}) \subset F_{\hat{G}}}{\text{argmin}} Q(\mathbf{w})$. For any \mathbf{w}' with supporting groups G' and corresponding features $F' = F_{G'}$, if

$$g \in \{g \in G' \setminus \hat{G} \mid Q(\hat{\mathbf{w}}) - \min_{\alpha} Q(\hat{\mathbf{w}} + \mathbf{E}_g \alpha) \geq \lambda(Q(\hat{\mathbf{w}}) - \min_{g \in G' \setminus \hat{G}, \alpha} Q(\hat{\mathbf{w}} + \mathbf{E}_g \alpha))\},$$

then we will have

$$Q(\hat{\mathbf{w}}) - Q(\mathbf{w}') \leq \frac{\varphi_+(1)|G' \setminus \hat{G}|(Q(\hat{\mathbf{w}}) - \min_{\alpha} Q(\hat{\mathbf{w}} + \mathbf{E}_g \alpha))}{\lambda\varphi_-(s)}.$$

Proof. We are comparing the differences of the convex function and its value along the following special directions.

$$\begin{aligned}
& |G' \setminus \hat{G}| \min_{g \in G' \setminus \hat{G}, \eta} Q(\hat{\mathbf{w}} + \eta(\mathbf{w}'_g - \hat{\mathbf{w}}_g)) \\
& \leq \sum_{g \in G' \setminus \hat{G}} Q(\hat{\mathbf{w}} + \eta(\mathbf{w}'_g - \hat{\mathbf{w}}_g)) \quad (\text{any } \eta) \\
& \leq \sum_{g \in G' \setminus \hat{G}} \left(Q(\hat{\mathbf{w}}) + \langle \eta(\mathbf{w}'_g - \hat{\mathbf{w}}_g), \nabla Q(\hat{\mathbf{w}}) \rangle + \frac{\varphi_+(1)}{2} \|\eta(\mathbf{w}'_g - \hat{\mathbf{w}}_g)\|^2 \right) \quad (\text{definition of } \varphi_+(1)) \\
& \leq |G' \setminus \hat{G}| Q(\hat{\mathbf{w}}) + \langle \eta(\mathbf{w}' - \hat{\mathbf{w}})_{G' \setminus \hat{G}}, \nabla Q(\hat{\mathbf{w}}) \rangle + \frac{\varphi_+(1)}{2} \|\eta(\mathbf{w}' - \hat{\mathbf{w}})\|^2 \quad (\text{non-intersection property}) \\
& = |G' \setminus \hat{G}| Q(\hat{\mathbf{w}}) + \langle \eta(\mathbf{w}' - \hat{\mathbf{w}}), (\nabla Q(\hat{\mathbf{w}}))_{G' \setminus \hat{G}} \rangle + \frac{\varphi_+(1)}{2} \|\eta(\mathbf{w}' - \hat{\mathbf{w}})\|^2 \\
& = |G' \setminus \hat{G}| Q(\hat{\mathbf{w}}) + \langle \eta(\mathbf{w}' - \hat{\mathbf{w}}), (\nabla Q(\hat{\mathbf{w}}))_{G' \cup \hat{G}} \rangle + \frac{\varphi_+(1)}{2} \|\eta(\mathbf{w}' - \hat{\mathbf{w}})\|^2 \quad (\text{optimal solution on } \hat{G}) \\
& \leq |G' \setminus \hat{G}| Q(\hat{\mathbf{w}}) + \eta \left(Q(\mathbf{w}') - Q(\hat{\mathbf{w}}) - \frac{\varphi_-(s)}{2} \|\mathbf{w}' - \hat{\mathbf{w}}\|^2 \right) \\
& \quad + \frac{\varphi_+(1)}{2} \|\eta(\mathbf{w}' - \hat{\mathbf{w}})\|^2.
\end{aligned}$$

And the special direction indeed gives us some bounds as follows:

$$\begin{aligned}
& |G' \setminus \hat{G}| \left(\min_{g \in G' \setminus \hat{G}, \eta} Q(\hat{\mathbf{w}} + \eta(\mathbf{w}'_g - \hat{\mathbf{w}}_g)) - Q(\hat{\mathbf{w}}) \right) \\
& \leq \min_{\eta} \eta \left(Q(\mathbf{w}') - Q(\hat{\mathbf{w}}) - \frac{\varphi_-(s)}{2} \|\mathbf{w}' - \hat{\mathbf{w}}\|^2 \right) + \frac{\varphi_+(1)}{2} \|\eta(\mathbf{w}' - \hat{\mathbf{w}})\|^2 \\
& = - \frac{\left(Q(\mathbf{w}') - Q(\hat{\mathbf{w}}) - \frac{\varphi_-(s)}{2} \|\mathbf{w}' - \hat{\mathbf{w}}\|^2 \right)^2}{2\varphi_+(1) \|\mathbf{w}' - \hat{\mathbf{w}}\|^2} \\
& \leq \frac{4(Q(\mathbf{w}') - Q(\hat{\mathbf{w}})) \frac{\varphi_-(s)}{2} \|\mathbf{w}' - \hat{\mathbf{w}}\|^2}{2\varphi_+(1) \|\mathbf{w}' - \hat{\mathbf{w}}\|^2} \\
& = - \frac{\varphi_-(s)(Q(\hat{\mathbf{w}}) - Q(\mathbf{w}'))}{\varphi_+(1)}.
\end{aligned}$$

Hence, by rearranging the above inequality, we have

$$\begin{aligned}
& |G' \setminus \hat{G}| \left(Q(\hat{\mathbf{w}}) - \min_{\boldsymbol{\alpha}} Q(\hat{\mathbf{w}} + \mathbf{E}_g \boldsymbol{\alpha}) \right) \\
& \geq |G' \setminus \hat{G}| \left(Q(\hat{\mathbf{w}}) - \min_{g \in G' \setminus \hat{G}, \boldsymbol{\alpha}} Q(\hat{\mathbf{w}} + \mathbf{E}_g \boldsymbol{\alpha}) \right) \lambda \\
& \geq |G' \setminus \hat{G}| \left(Q(\hat{\mathbf{w}}) - \min_{g \in G' \setminus \hat{G}, \eta} Q(\hat{\mathbf{w}} + \eta(\hat{\mathbf{w}}_g - \mathbf{w}'_g)) \right) \lambda \quad (\text{special direction of } \boldsymbol{\alpha}) \\
& \geq \frac{\varphi_-(s)(Q(\hat{\mathbf{w}}) - Q(\mathbf{w}'))\lambda}{\varphi_+(1)}.
\end{aligned}$$

It completes the proof. \square

Theorem A.7. Let δ in our algorithm satisfy $\delta > \frac{4\varphi_+(1)}{\lambda\varphi_-^2(s)} \|\nabla Q(\bar{\mathbf{w}})\|_{G,\infty}^2$. Suppose our algorithm stops at k , and the supporting group is $G^{(k)}$ with supporting features as $F^{(k)} = F_{G^{(k)}}$. Then our algorithm will have the following estimations:

$$\|\bar{\mathbf{w}} - \mathbf{w}^{(k)}\| \leq \frac{4\sqrt{\varphi_+(1)\delta}}{\varphi_-(s)} \sqrt{|\bar{\Delta}|} \quad (\text{A.7})$$

$$Q(\mathbf{w}^{(k)}) - Q(\bar{\mathbf{w}}) \leq \frac{2\varphi_+(1)\delta}{\varphi_-(s)} |\bar{\Delta}| \quad (\text{A.8})$$

$$|\bar{G} \setminus G^{(k)}| \leq 2|\bar{\Delta}| \quad (\text{A.9})$$

$$|G^{(k)} \setminus \bar{G}| \leq \frac{16\varphi_+^2(1)|\bar{\Delta}|}{\lambda\varphi_-^2(s)} \quad (\text{A.10})$$

where $\bar{\Delta} = \{g \in \bar{G} : \|\bar{\mathbf{w}}_g\| < \gamma\}$ and $\gamma = \sqrt{\frac{16\varphi_+(1)\delta}{\varphi_-^2(s)}}$.

Proof. After our algorithm terminates, suppose that we have k group selected.

From Lemma A.5, we can just assume $Q(\mathbf{w}^{(k)}) \geq Q(\bar{\mathbf{w}})$ and hence we have:

$$\begin{aligned}
0 & \geq Q(\bar{\mathbf{w}}) - Q(\mathbf{w}^{(k)}) \\
& \geq \langle \nabla Q(\mathbf{w}^{(k)}), \bar{\mathbf{w}} - \mathbf{w}^{(k)} \rangle + \frac{\varphi_-(s)}{2} \|\bar{\mathbf{w}} - \mathbf{w}^{(k)}\|^2
\end{aligned}$$

After rearranging the above inequality and taking advantage of regrouping, we have

$$\begin{aligned}
& \frac{\varphi_-(s)}{2} \|\bar{\mathbf{w}} - \mathbf{w}^{(k)}\|^2 \\
& \leq -\langle \nabla Q(\mathbf{w}^{(k)}), \bar{\mathbf{w}} - \mathbf{w}^{(k)} \rangle \\
& = -\langle \nabla Q(\mathbf{w}^{(k)}), (\bar{\mathbf{w}} - \mathbf{w}^{(k)})_{\bar{G} \cup G^{(k)}} \rangle \\
& = -\langle (\nabla Q(\mathbf{w}^{(k)}))_{\bar{G} \cup G^{(k)}}, (\bar{\mathbf{w}} - \mathbf{w}^{(k)}) \rangle \\
& = -\langle (\nabla Q(\mathbf{w}^{(k)}))_{\bar{G} \setminus G^{(k)}}, (\bar{\mathbf{w}} - \mathbf{w}^{(k)}) \rangle \quad (\bar{\mathbf{w}} - \mathbf{w}^{(k)} \text{ is supported on } \bar{G} \setminus G^{(k)}) \\
& = -\langle \nabla Q(\mathbf{w}^{(k)}), (\bar{\mathbf{w}} - \mathbf{w}^{(k)})_{\bar{G} \setminus G^{(k)}} \rangle \\
& \leq \|\nabla Q(\mathbf{w}^{(k)})\|_{G, \infty} \|(\bar{\mathbf{w}} - \mathbf{w}^{(k)})_{\bar{G} \setminus G^{(k)}}\|_{G, 1} \\
& \leq \sqrt{2\varphi_+(1)\delta} \sqrt{|\bar{G} \setminus G^{(k)}|} \|\bar{\mathbf{w}} - \mathbf{w}^{(k)}\|. \quad (\text{from Lemma A.3})
\end{aligned}$$

Simplifying the above inequality, we have the following:

$$\|\bar{\mathbf{w}} - \mathbf{w}^{(k)}\| \leq \frac{2\sqrt{2\varphi_+(1)\delta}}{\varphi_-(s)} \sqrt{|\bar{G} \setminus G^{(k)}|}. \quad (\text{A.11})$$

We are interested in estimating errors from certain weak channels of our signals, and mathematically we consider a threshold of coefficients so that we can use the Chebyshev inequality to get new bounds below:

$$\begin{aligned}
\frac{8\varphi_+(1)\delta}{\varphi_-^2(s)} |\bar{G} \setminus G^{(k)}| & \geq \|\bar{\mathbf{w}} - \mathbf{w}^{(k)}\|^2 \\
& \geq \|(\bar{\mathbf{w}} - \mathbf{w}^{(k)})_{\bar{G} \setminus G^{(k)}}\|^2 \\
& = \|\bar{\mathbf{w}}_{\bar{G} \setminus G^{(k)}}\|^2 \quad (\mathbf{w}^{(k)} \text{ is supported outside of } \bar{G} \setminus G^{(k)}) \\
& \geq \gamma^2 |\{g \in \bar{G} \setminus G^{(k)} \mid \|\bar{\mathbf{w}}_g\|^2 \geq \gamma\}| \\
& \geq \frac{16\varphi_+(1)\delta}{\varphi_-^2(s)} |\{g \in \bar{G} \setminus G^{(k)} \mid \|\bar{\mathbf{w}}_g\| \geq \gamma\}|.
\end{aligned}$$

We take $\gamma^2 = \frac{16\varphi_+(1)\delta}{\varphi_-^2(s)}$ in the last inequality and hence we can almost get rid of the coefficients:

$$\begin{aligned}
|\bar{G} \setminus G^{(k)}| & \geq 2|\{g \in \bar{G} \setminus G^{(k)} \mid \|\bar{\mathbf{w}}_g\| \geq \gamma\}| \\
& = 2(|\bar{G} \setminus G^{(k)}| - |\{g \in \bar{G} \setminus G^{(k)} \mid \|\bar{\mathbf{w}}_g\| < \gamma\}|).
\end{aligned}$$

Obviously, this tells a better estimation that we will use often:

$$\begin{aligned} |\bar{G} \setminus G^{(k)}| &\leq 2|\{g \in \bar{G} \setminus G^{(k)} \mid \|\bar{\mathbf{w}}_g\| < \gamma\}| \\ &\leq 2|\{g \in \bar{G} \mid \|\bar{\mathbf{w}}_g\| < \gamma\}|, \end{aligned}$$

which proves the third inequality.

Then we can continue our estimation of errors using these new notations.

First, we put it in (A.11) we have coefficient error bound

$$\|\bar{\mathbf{w}} - \mathbf{w}^{(k)}\| \leq \frac{2\sqrt{2\varphi_+(1)\delta}}{\varphi_-(s)} \sqrt{|\bar{G} \setminus G^{(k)}|} \leq \frac{4\sqrt{\varphi_+(1)\delta}}{\varphi_-(s)} \sqrt{|\{g \in \bar{G} \setminus G^{(k)} \mid \|\bar{\mathbf{w}}_g\| < \gamma\}|}.$$

Second, we bound the loss function error:

$$\begin{aligned} &Q(\bar{\mathbf{w}}) - Q(\mathbf{w}^{(k)}) \\ &\geq \langle \nabla Q(\mathbf{w}^{(k)}), \bar{\mathbf{w}} - \mathbf{w}^{(k)} \rangle + \frac{\varphi_-(s)}{2} \|\bar{\mathbf{w}} - \mathbf{w}^{(k)}\|^2 \\ &= \langle \nabla Q(\mathbf{w}^{(k)})_{\bar{G} \cup G^{(k)}}, (\bar{\mathbf{w}} - \mathbf{w}^{(k)})_{\bar{G} \cup G^{(k)}} \rangle + \frac{\varphi_-(s)}{2} \|\bar{\mathbf{w}} - \mathbf{w}^{(k)}\|^2 \quad (\bar{\mathbf{w}} - \mathbf{w}^{(k)} \text{ is supported on } \bar{G} \cup G^{(k)}) \\ &= \langle \nabla Q(\mathbf{w}^{(k)})_{\bar{G} \setminus G^{(k)}}, (\bar{\mathbf{w}} - \mathbf{w}^{(k)})_{\bar{G} \setminus G^{(k)}} \rangle + \frac{\varphi_-(s)}{2} \|\bar{\mathbf{w}} - \mathbf{w}^{(k)}\|^2 \quad (\mathbf{w}^{(k)} \text{ is optimal on } G^{(k)}) \\ &\geq -\|\nabla Q(\mathbf{w}^{(k)})\|_{G,\infty} \|\bar{\mathbf{w}} - \mathbf{w}^{(k)}\|_{G,1} + \frac{\varphi_-(s)}{2} \|\bar{\mathbf{w}} - \mathbf{w}^{(k)}\|^2 \\ &\geq -\sqrt{2\varphi_+(1)\delta|\bar{G} \setminus G^{(k)}|} \|\bar{\mathbf{w}} - \mathbf{w}^{(k)}\| + \frac{\varphi_-(s)}{2} \|\bar{\mathbf{w}} - \mathbf{w}^{(k)}\|^2 \quad (\text{due to Cauchy-Schwartz inequality}) \\ &\geq -\frac{\varphi_+(1)\delta|\bar{G} \setminus G^{(k)}|}{\varphi_-(s)} \\ &\geq -\frac{2\varphi_+(1)\delta}{\varphi_-(s)} |\{g \in \bar{G} \setminus G^{(k)} \mid \|\bar{\mathbf{w}}_g\| < \gamma\}|. \end{aligned}$$

Lastly, we bound the error on selection groups. And this is quite easy if we use Lemma A.4 and the first error bound:

$$\begin{aligned} \frac{\delta^{(k)}}{\varphi_+(1)} |G^{(k)} \setminus \bar{G}| &\leq \|(\mathbf{w}^{(k)} - \bar{\mathbf{w}})_{G^{(k)} \setminus \bar{G}}\|^2 \\ &\leq \|\mathbf{w}^{(k)} - \bar{\mathbf{w}}\|^2 \\ &\leq \frac{16\varphi_+(1)\delta}{\varphi_-^2(s)} |\{g \in \bar{G} \setminus G^{(k)} \mid \|\bar{\mathbf{w}}_g\| < \gamma\}|. \end{aligned}$$

Again, due to our requirement in the algorithm, $\delta^{(k)} \geq \lambda\delta$, we then have the bound on the error of group selection as in the lemma. This completes the proof of the lemma. \square

Theorem A.8. *If we take $\delta > \frac{4\varphi_+(1)}{\lambda\varphi_-^2(s)} \|\nabla Q(\mathbf{w})\|_{G,\infty}^2$ and require s to a number such that $s > \bar{k} + (\bar{k} + 1)(\sqrt{\kappa(s)} + 1)^2(\sqrt{2}\kappa(s))^{\frac{1}{\lambda}}$, where \bar{k} is the number of groups corresponding to the global optimal sparse solution, then our algorithm will terminate at some $k \leq s - \bar{k}$.*

Proof. Suppose our algorithm terminates at some number larger than $s - \bar{k}$, then we may just assume the first time k such that $k = s - \bar{k}$. Again, we denote the supporting groups to be $G^{(k)}$ with the optimal point as $\mathbf{w}^{(k)}$. Then we combine \bar{G} and $G^{(k)}$ together to get $G' = \bar{G} \cup G^{(k)}$. We also denote $\mathbf{w}' = \underset{\text{supp}(\mathbf{w}) \subset F'}{\text{argmin}} Q(\mathbf{w})$, where $F' = F_{G'}$. Recall our requirement of s , we have $|G'| \leq s$.

Next, we consider the last step to get k and we have

$$\begin{aligned}
\delta^{(k)} &\geq \lambda Q(\mathbf{w}^{(k-1)}) - \min_{g \notin G^{(k-1)}, \alpha} Q(\mathbf{w}^{(k-1)} + \mathbf{E}_g \alpha) \\
&\geq \frac{\varphi_-(s)(Q(\mathbf{w}^{(k-1)}) - Q(\mathbf{w}'))\lambda^2}{\varphi_+(1)|G' \setminus G^{(k-1)}|\lambda} && \text{(Lemma A.6 with } \hat{G} = G^{(k-1)}) \\
&\geq \frac{\varphi_-(s)(Q(\mathbf{w}^{(k)}) - Q(\mathbf{w}'))\lambda}{\varphi_+(1)|G' \setminus G^{(k-1)}|} && \text{(assumption based on} \\
&&& \text{algorithm and Lemma A.5)} \\
&\geq \frac{\varphi_-(s) \left(\langle \nabla Q(\mathbf{w}'), \mathbf{w}^{(k)} - \mathbf{w}' \rangle + \frac{\varphi_-(s)}{2} \|\mathbf{w}^{(k)} - \mathbf{w}'\|^2 \right) \lambda}{\varphi_+(1)|G' \setminus G^{(k-1)}|} && \text{(definition of } \varphi_-(s)) \\
&\geq \frac{\varphi_-^2(s) \|\mathbf{w}^{(k)} - \mathbf{w}'\|^2 \lambda}{2\varphi_+(1)|G' \setminus G^{(k-1)}|}. && \text{(}\mathbf{w}' \text{ is optimal on } F')
\end{aligned}$$

Now using the result in Lemma A.4 ($\delta^{(k)} \leq \frac{\|\mathbf{w}^{(k)} - \bar{\mathbf{w}}\|^2 \varphi_+(1)}{|G^{(k)} \setminus \bar{G}|}$) and the fact that $|G' \setminus \bar{G}| = |G^{(k)} \setminus \bar{G}|$, we have the following relation between the two estimations

$$\|\mathbf{w}^{(k)} - \bar{\mathbf{w}}\|^2 \geq \left(\frac{\varphi_-(s)}{\sqrt{2}\varphi_+(1)} \right)^2 \left(\frac{\lambda|G' \setminus \bar{G}|}{|G' \setminus G^{(k-1)}|} \right) \|\mathbf{w}^{(k)} - \mathbf{w}'\|^2.$$

To simplify our notation we introduce a constant $c = \left(\frac{\varphi_-(s)}{\sqrt{2}\varphi_+(1)} \right) \left(\sqrt{\frac{\lambda|G' \setminus \bar{G}|}{|G' \setminus G^{(k-1)}|}} \right)$.

A finer calculation and our requirement for the number s give us the following relation

$$\begin{aligned}
c &= \left(\frac{\varphi_-(s)}{\sqrt{2}\varphi_+(1)} \right) \left(\sqrt{\frac{\lambda|G^{(k)} \setminus G^{(k)} \cap \bar{G}|}{|G' \setminus G^{(k)}| + 1}} \right) \\
&= \left(\frac{\varphi_-(s)}{\sqrt{2}\varphi_+(1)} \right) \left(\sqrt{\frac{\lambda|G^{(k)} \setminus G^{(k)} \cap \bar{G}|}{|\bar{G} \setminus G^{(k)} \cap \bar{G}| + 1}} \right) \\
&= \left(\frac{\varphi_-(s)}{\sqrt{2}\varphi_+(1)} \right) \left(\sqrt{\lambda \frac{|G^k| - |G^{(k)} \cap \bar{G}|}{|\bar{G}| - |G^{(k)} \cap \bar{G}| + 1}} \right) \\
&= \left(\frac{\varphi_-(s)}{\sqrt{2}\varphi_+(1)} \right) \left(\sqrt{\lambda \frac{k - |G^{(k)} \cap \bar{G}|}{\bar{k} - |G^{(k)} \cap \bar{G}| + 1}} \right) & (k = s - \bar{k}) \\
&\geq \left(\frac{\varphi_-(s)}{\sqrt{2}\varphi_+(1)} \right) \left(\sqrt{\lambda \frac{s - \bar{k}}{\bar{k} + 1}} \right) & (s \geq 2\bar{k} + 1) \\
&\geq \sqrt{\kappa(s)} + 1. & (\text{due to our definition of } s)
\end{aligned}$$

So we have

$$c\|\mathbf{w}^{(k)} - \mathbf{w}'\| \leq \|\mathbf{w}^{(k)} - \bar{\mathbf{w}}\| \leq \|\mathbf{w}^{(k)} - \mathbf{w}'\| + \|\mathbf{w}' - \bar{\mathbf{w}}\|. \quad (\text{A.12})$$

Consequently we have

$$(c - 1)\|\mathbf{w}^{(k)} - \mathbf{w}'\| \leq \|\mathbf{w}' - \bar{\mathbf{w}}\|.$$

The following calculation, together with (A.12), shows that $Q(\mathbf{w}^{(k+1)}) \leq Q(\bar{\mathbf{w}})$:

$$\begin{aligned}
Q(\mathbf{w}^{(k)}) - Q(\bar{\mathbf{w}}) &= Q(\mathbf{w}^{(k)}) - Q(\mathbf{w}') - (Q(\bar{\mathbf{w}}) - Q(\mathbf{w}')) \\
&\leq \frac{\varphi_+(s)}{2} \|\mathbf{w}^{(k)} - \mathbf{w}'\|^2 - \frac{\varphi_-(s)}{2} \|\mathbf{w}' - \bar{\mathbf{w}}\|^2 \\
&\leq \left(\frac{\varphi_+(s)}{2(c-1)^2} - \frac{\varphi_-(s)}{2} \right) \|\mathbf{w}' - \bar{\mathbf{w}}\|^2 \\
&\leq 0.
\end{aligned}$$

However, this contradicts (A.6) under the suitable choice for δ . So the assumption is incorrect. It

completes the proof of the theorem. \square

Proof to Theorem 4.1

Proof. This theorem is simply implied by Theorem A.7 and Theorem A.8. \square

In least square regression, we have the following estimations about the gradient under high probability.

Theorem A.9. *If we divide all features into m groups, and assume the noise of observations follow i.i.d. Gaussian $\mathcal{N}(0, 1)$ and the columns of our data are normalized to \sqrt{n} , then with high probability, the true solution \mathbf{w}^* satisfies*

$$\|\nabla Q(\mathbf{w}^*)\|_{G,\infty} \leq \frac{1}{\sqrt{n}} \left(\sqrt{\max_{g \in G} |g|} + \sqrt{2\varphi_+(1) \log(m)} \right).$$

The above is also true for our optimal solution $\bar{\mathbf{w}}$ supported on a subset S of the super set G with $|S| \leq \bar{k}$. That is, we have

$$\|\nabla Q(\bar{\mathbf{w}})\|_{G,\infty} \leq \frac{1}{\sqrt{n}} \left(\sqrt{\max_{g \in G} |g|} + \sqrt{2\varphi_+(1) \log(m)} \right)$$

with high probability.

Proof of Theorem A.9

Proof. We introduce the following notation for matrix and it is different from the vector notation. For a matrix X in $\mathbb{R}^{n \times p}$, X_g will be a $\mathbb{R}^{n \times |g|}$ matrix that only keep the columns corresponding to g . We denote $\Sigma_g = X_g^\top X_g$. For the theorem, we can first show that $\|X_g^\top \varepsilon\| \leq \sqrt{n} \left(\sqrt{|g|} + \sqrt{2\varphi_+^2(1) \log(\frac{1}{\eta})} \right)$ with probability $1 - \eta$. To this end, we have to point out that our columns of X are normalized to \sqrt{n} and hence $X_g^\top \varepsilon$ will be a $\frac{p}{m}$ -variate Gaussian random variable with n on the diagonal of covariance matrix. We further use λ_i as the eigenvalues of Σ_g with decreasing order, i.e., λ_1 being the largest, or equivalently, $\lambda_1 = \|\Sigma_g\|_{\text{spec}}$.

Also, using the trick that $\text{tr}(\Sigma_g^2) = \lambda_1^2 + \lambda_2^2 + \dots + \lambda_{|g|}^2$ and Proposition 1.1 from (Hsu et al.,

2012), we have

$$\begin{aligned}
e^{-t} &\geq \Pr \left(\|X_g^\top \varepsilon\|^2 > \sum_{i=1}^{|g|} \lambda_i + 2\sqrt{\sum_{i=1}^{|g|} \lambda_i^2 t + 2\lambda_1 t} \right) \\
&\geq \Pr \left(\|X_g^\top \varepsilon\|^2 > \sum_{i=1}^{|g|} \lambda_i + 2\sqrt{2 \sum_{i=1}^{|g|} \lambda_i \lambda_1 t + 2\lambda_1 t} \right) \\
&\geq \Pr \left(\|X_g^\top \varepsilon\| \geq \sqrt{\sum_{i=1}^{|g|} \lambda_i} + \sqrt{2\lambda_1 t} \right).
\end{aligned}$$

Substitute t with $\log(\frac{1}{\eta})$ and the facts that $\sum_{i=1}^{|g|} \lambda_i = |g|n$ and $\lambda_1 = \|\Sigma\|_{spec} \leq n\varphi_+(1)$, we have

$$\|X_g^\top \varepsilon\| \leq \sqrt{n} \left(\sqrt{|g|} + \sqrt{2\varphi_+(1) \log(\frac{1}{\eta})} \right)$$

with probability $1 - \eta$.

If we replace η as $\frac{\eta}{m}$ for each group g and take the maximal of all group norms, we extend the result to the general case:

$$\max_{g \in G} \|X_g^\top \varepsilon\| \leq \sqrt{n} \left(\sqrt{\max_{g \in G} |g|} + \sqrt{2\varphi_+(1) \log(\frac{m}{\eta})} \right)$$

with probability $1 - \eta$.

Recall our general convex function has a factor of $\frac{1}{2n}$, we have

$$\|\nabla Q(\mathbf{w}^*)\|_{G, \infty} \leq \frac{1}{\sqrt{n}} \left(\sqrt{\max_{g \in G} |g|} + \sqrt{2\varphi_+(1) \log(\frac{m}{\eta})} \right)$$

with high probability.

The major difference between the true solution and optimal solution supported on S with $|S| \leq \bar{k}$ is that we need to estimate $X_g^\top (X_S(X_S^\top X_S)^{-1} X_S^\top - I_n) \varepsilon$ instead of $X_g^\top \varepsilon$ for each group g . In fact, we are considering $I_n - X_S(X_S^\top X_S)^{-1} X_S^\top$ since the noise itself makes this negative sign not important. Note, we can decompose $I_n - X_S(X_S^\top X_S)^{-1} X_S^\top = P_g P_g^\top$, where P_g has dimension $n \times (n - |F_S|)$ and $P_g^\top P_g = I_{n-|F_S|}$, due to the property of the projection matrix $X_S(X_S^\top X_S)^{-1} X_S^\top$.

In other words, we transform our question into estimating $X_g^\top P_g \varepsilon'$, where ε' is a vector of i.i.d.

$\mathcal{N}(0, 1)$ random variables of dimension $n - |F_S|$. We denote the largest eigenvalue of $X_g^\top P_g P_g^\top X_g$ as λ' and it's easy to observe that $\lambda' \leq \lambda$. Also the trace of $X_g^\top P_g P_g^\top X_g$ is no big than the trace of $X_g^\top X_g$, so we easily extend the above result to the optimal value and we have

$$\|\nabla Q(\bar{\mathbf{w}})\|_{G, \infty} \leq \frac{1}{\sqrt{n}} \left(\sqrt{\max_{g \in G} |g|} + \sqrt{2\varphi_+(1) \log(m)} \right)$$

with high probability.

It completes the proof of the theorem. \square

Proof to Theorem 4.3

Proof. We first give an error bound for $\|\mathbf{w}^* - \bar{\mathbf{w}}\|$. Note that

$$\begin{aligned} & \|X\mathbf{w}^* - X\bar{\mathbf{w}}\|^2 \\ &= \|\mathbf{y} - X\bar{\mathbf{w}}\|^2 - \varepsilon^T \varepsilon - 2\varepsilon^T X(\mathbf{w}^* - \bar{\mathbf{w}}) \\ &\leq \|\mathbf{y} - X\mathbf{w}^*\|^2 - \varepsilon^T \varepsilon - 2\varepsilon^T X(\mathbf{w}^* - \bar{\mathbf{w}}) \\ &\leq 2\|\varepsilon^T X_{\tilde{S}}\| \|\mathbf{w}^* - \bar{\mathbf{w}}\|, \end{aligned}$$

where the first inequality holds by definition of $\bar{\mathbf{w}}$ and $\tilde{S} := G^* \cup \bar{G}$ with $|\tilde{S}| \leq 2\bar{k}$. Also, by (5),

$$\|X\mathbf{w}^* - X\bar{\mathbf{w}}\|^2 \geq n\varphi_-(2\bar{k}) \|\mathbf{w}^* - \bar{\mathbf{w}}\|^2.$$

The two displays above implies that

$$\|\mathbf{w}^* - \bar{\mathbf{w}}\| \leq 2\varphi_-^{-1}(2\bar{k}) \|\varepsilon^T X_{\tilde{S}}/n\|. \quad (\text{A.13})$$

By Hanson-Wright inequality (Rudelson et al., 2013), with probability converges to 1, $\|\varepsilon^T X_{\tilde{S}}/n\| \leq 3\sqrt{\varphi_+(2\bar{k})k_*/n}$. Consequently, in together with (A.13) and Assumption 1,

$$\|\mathbf{w}^* - \bar{\mathbf{w}}\| = O_p(k_*/n). \quad (\text{A.14})$$

Next, we show that G^* matches \bar{G} with high probability. Given group set S , define P_S be the

projection matrix on X_S , and let $\hat{\mathbf{y}}_S = P_S \mathbf{y}$. Define $f_n = X \mathbf{w}^*$. Define

$$\begin{aligned} m(S) &:= \|\mathbf{y} - \hat{\mathbf{y}}_S\|^2 \\ &= \varepsilon^T (I - P_S) \varepsilon_n + 2\varepsilon^T (I - P_S) f_n + \|f_n - P_S f_n\|^2 \\ &=: R_0(S) + R_1(S), \end{aligned}$$

with $R_1(S) = \|f_n - P_S f_n\|^2$. Then

$$m(\bar{G}) - m(G^*) = R_0(\bar{G}) - R_0(G^*) + R_1(\bar{G}) - R_1(G^*). \quad (\text{A.15})$$

Note that $R_0(G) - R_0(G^*)$ has a relatively small absolute value (can be proved to be upper bounded by $\sqrt{q + \log m}$ with high probability). So we only need to focus on $R_1(S) - R_1(S^*)$ in (A.15). Accordingly, suppose \bar{G} misses some relevant groups in G^* (denoted by $S_1^- := G^* \setminus \bar{G}$). Define $\tilde{G} = J_1 \cup \bar{G}$, that includes all large important coefficients in addition to \bar{G} . Then

$$\begin{aligned} & R_1(G) - R_1(G^*) \\ & \geq R_1(G) - R_1(\tilde{G}) \\ & = \|f_n - P_{\tilde{G}} f_n\|^2 - \|f_n - P_{\bar{G}} f_n\|^2 \\ & = f_n^T (P_{\tilde{G}} - P_{\bar{G}}) f_n \\ & = (P_{\tilde{G}} f_n)^T (I - P_{\bar{G}}) (P_{\tilde{G}} f_n) \\ & = \min_{\alpha \in \mathbb{R}^{k_*}} \|P_{\tilde{G}} f_n - X_{\bar{G}} \alpha\|^2. \end{aligned}$$

Then from above and the condition that $\min_{g \in G^*} \|\mathbf{w}_g^*\|$ lower bounded with $\tilde{C} \sqrt{\frac{q + \log(m)}{n}}$ and $\tilde{C} \geq \varphi_-^{-1/2}(2\bar{k})$, we have that

$$\begin{aligned} & R_1(\bar{G}) - R_1(G^*) \\ & \geq \min_{\alpha} \|X_{S_1^-} \mathbf{w}_{S_1^-} - X_{\bar{G}} \alpha\|^2 \\ & \geq n \varphi_-(2\bar{k}) \|\mathbf{w}_{S_1^-}\|^2 \\ & \geq q + \log m, \end{aligned}$$

Consequently, in together with (A.15), with high probability, $m(\bar{G}) - m(G^*) \geq 0$, which implies that

$$\bar{G} = G^*. \quad (\text{A.16})$$

Lastly, it remains to show $\bar{\Delta} \leq \Delta_{\text{IGA}}$ when two constants “ Ω ’s” are appropriately chosen. It suffices to show that if $\|\bar{\mathbf{w}}_g\| < \Omega(\|\nabla Q(\bar{\mathbf{w}})\|_{G,\infty}) = \Omega\left(\sqrt{\frac{p}{mn} + \frac{\log(m)}{n}}\right)$ implies that $\|\mathbf{w}_g^*\| \leq \Omega\left(\sqrt{\frac{p}{mn} + \frac{\log(m)}{n}}\right)$. It can be proven by

$$\begin{aligned} \|\mathbf{w}_g^*\| &\leq \|\bar{\mathbf{w}}_g\| + \|(\bar{\mathbf{w}} - \mathbf{w}^*)_g\| \\ &\leq \Omega\left(\sqrt{\frac{p}{m} + \log m} + \sqrt{\frac{p}{m} + \log m}\right) \\ &= \Omega\left(\sqrt{\frac{p}{m} + \log m}\right). \end{aligned}$$

Then, combining the second claim in Theorem 4.1, $\bar{\Delta} \leq \Delta_{\text{IGA}}$ and (A.14) gives the first claim, and combining the last claim in Theorem 4.1, $\bar{\Delta} \leq \Delta_{\text{IGA}}$ and (A.16) implies the second claim. \square

B Supplement: a Gradient-Based IGA Algorithm

In the following, we show the GIGA algorithm in Algorithm 2.

Lemma B.1. *If for any $\mathbf{w} \in \mathcal{D}$ we have $\|\nabla Q(\mathbf{w})\|_{G,\infty} \geq \lambda\varepsilon$, then for any $g \in G$, we have*

$$Q(\mathbf{w}) - \min_{\boldsymbol{\alpha}} Q(\mathbf{w} + \mathbf{E}_g \boldsymbol{\alpha}) \geq \frac{\lambda^2 \varepsilon^2}{2\varphi_+(1)}.$$

Algorithm 2 GIGA algorithm

Require: $\delta > 0, 0 < \lambda \leq 1$ **Ensure:** $\mathbf{w}^{(k)}$

```
1:  $k = 0, \mathbf{w}^{(k)} = 0, F^{(0)} = \emptyset, G^{(0)} = \emptyset$ 
2: while TRUE do
3:   if  $\|\nabla Q(\mathbf{w})\|_{G, \infty} < \varepsilon$  then
4:     Break
5:   end if
6:   select any  $g^{(k)}$  in  $\{g \notin G^{(k)} \mid \|\nabla_g Q(\mathbf{w})\| \geq \lambda \max_{g \notin G^{(k)}} \|\nabla_g Q(\mathbf{w})\|\}$ 
7:    $G^{(k+1)} = G^{(k)} \cup \{g^{(k)}\}$ 
8:    $\mathbf{w}^{(k+1)} = \underset{\text{supp}(\mathbf{w}) \subset F_{G^{(k)}}}{\text{argmin}} \quad Q(\mathbf{w})$ 
9:    $\delta^{(k+1)} = Q(\mathbf{w}^{(k)}) - Q(\mathbf{w}^{(k+1)})$ 
10:   $k = k + 1$ 
11:  while TRUE do
12:    if  $\min_{g \in G^{(k)}} Q(\mathbf{w}^{(k)} - \mathbf{E}_g \mathbf{w}_g^{(k)}) - Q(\mathbf{w}^{(k)}) \geq \frac{\delta^{(k)}}{2}$  then
13:      Break
14:    end if
15:     $g^{(k)} = \underset{g \in G^{(k)}}{\text{argmin}} \quad Q(\mathbf{w}^{(k)} - \mathbf{E}_g \mathbf{w}_g^{(k)})$ 
16:     $k = k - 1$ 
17:     $G^{(k)} = G^{(k+1)} \setminus \{g^{(k+1)}\}$ 
18:     $\mathbf{w}^{(k)} = \underset{\text{supp}(\mathbf{w}) \subset F_{G^{(k)}}}{\text{argmin}} \quad Q(\mathbf{w})$ 
19:  end while
20: end while
```

Proof. Since $\mathbf{w} \in D$, we can use the definition of φ_+ as follows:

$$\begin{aligned}
& Q(\mathbf{w}) - \min_{\boldsymbol{\alpha}} Q(\mathbf{w} + \mathbf{E}_g \boldsymbol{\alpha}) \\
& \geq \max_{\boldsymbol{\alpha}} (Q(\mathbf{w}) - Q(\mathbf{w} + \mathbf{E}_g \boldsymbol{\alpha})) \\
& \geq \max_{\boldsymbol{\alpha}} \left(-\langle \nabla Q(\mathbf{w}), \mathbf{E}_g \boldsymbol{\alpha} \rangle - \frac{\varphi_+(1)}{2} \|\mathbf{E}_g \boldsymbol{\alpha}\|^2 \right) \\
& \geq \max_{\boldsymbol{\alpha}} \left(-\|(\nabla Q(\mathbf{w}))_g\| \|\mathbf{E}_g \boldsymbol{\alpha}\| - \frac{\varphi_+(1)}{2} \|\boldsymbol{\alpha}\|^2 \right) \\
& \geq \max_{\boldsymbol{\alpha}} \left(-\|\nabla Q(\mathbf{w})\|_{G,\infty} \|\boldsymbol{\alpha}\| - \frac{\varphi_+(1)}{2} \|\boldsymbol{\alpha}\|^2 \right) \\
& = \frac{\|\nabla Q(\mathbf{w})\|_{G,\infty}^2}{2\varphi_+(1)} \\
& \geq \frac{\lambda^2 \varepsilon^2}{2\varphi_+(1)}.
\end{aligned}$$

Here we just move forward to the maximal group normal and get a more simplified result. Also, the calculation tells us that in our algorithm,

$$Q(\mathbf{w}^{(k)}) - \min_{\boldsymbol{\alpha}} Q(\mathbf{w}^{(k)} + \mathbf{E}_g \boldsymbol{\alpha}) \geq \delta^{(k)} \geq \frac{\lambda^2 \varepsilon^2}{2\varphi_+(1)}. \quad (\text{A.17})$$

It completes the proof of the lemma. \square

Lemma B.2. Consider $\mathbf{w}^{(k)}$ with the support $G^{(k)}$ at the end of our backward elimination process in our algorithm. Then we have $\|\mathbf{w}_{G^{(k)} \setminus \bar{G}}^{(k)}\|^2 = \|(\mathbf{w}^{(k)} - \bar{\mathbf{w}})\|^2 = \|(\mathbf{w}^{(k)} - \bar{\mathbf{w}})_{G^{(k)} \setminus \bar{G}}\|^2 \geq \frac{\delta^{(k)} |G^{(k)} \setminus \bar{G}|}{\varphi_+(1)}$.

Proof. Similar to the objection function case, we derive such relations by regrouping and the proof is almost identical to Lemma A.4 since we have the same backward method for different algorithms. \square

Lemma B.3. The optimal value of Q we get from $G^{(k)}$ is bigger than the global optimal sparse value.

Proof. A direct way to compare these values is taking the difference of the two:

$$\begin{aligned}
& Q(\mathbf{w}^{(k)}) - Q(\bar{\mathbf{w}}) \\
& \geq \langle \nabla Q(\bar{\mathbf{w}}), \mathbf{w}^{(k)} - \bar{\mathbf{w}} \rangle + \frac{\varphi_-(s) \|\mathbf{w}^{(k)} - \bar{\mathbf{w}}\|^2}{2} \\
& \geq -\|\nabla Q(\bar{\mathbf{w}})\|_{G,\infty} \|\mathbf{w}^{(k)} - \bar{\mathbf{w}}\|_{G,1} + \frac{\varphi_-(s) \|\mathbf{w}^{(k)} - \bar{\mathbf{w}}\|^2}{2} \\
& \geq -\|\nabla Q(\bar{\mathbf{w}})\|_{G,\infty} \sqrt{|G^{(k)} \setminus \bar{G}|} \|\mathbf{w}^{(k)} - \bar{\mathbf{w}}\|_{G,2} + \frac{\varphi_-(s) \|\mathbf{w}^{(k)} - \bar{\mathbf{w}}\|^2}{2} \quad (\text{Cauchy-Schwartz}) \\
& \geq -\frac{\|\nabla Q(\bar{\mathbf{w}})\|_{G,\infty} \sqrt{\varphi_+(1)} \|\mathbf{w}^{(k)} - \bar{\mathbf{w}}\|^2}{\sqrt{\delta^{(k)}}} + \frac{\varphi_-(s) \|\mathbf{w}^{(k)} - \bar{\mathbf{w}}\|^2}{2} \\
& \geq \left(\frac{\varphi_-(s)}{2} - \frac{\|\nabla Q(\bar{\mathbf{w}})\|_{G,\infty} \sqrt{2} \varphi_+(1)}{\lambda \varepsilon} \right) \|\mathbf{w}^{(k)} - \bar{\mathbf{w}}\|^2.
\end{aligned}$$

Note we have the bound for the threshold $\delta^{(k)}$ as in (A.17). And if we take $\varepsilon \geq \frac{2\sqrt{2}\varphi_+(1)\|\nabla Q(\bar{\mathbf{w}})\|_{G,\infty}}{\lambda\varphi_-(s)}$, then we can show that the expression above is no less than 0.

And it completes the proof of the lemma. \square

Theorem B.4. Let ε in our algorithm satisfy $\varepsilon \geq \frac{2\sqrt{2}\varphi_+(1)\|\nabla Q(\bar{\mathbf{w}})\|_{G,\infty}}{\lambda\varphi_-(s)}$. Suppose our algorithm stops at k , and the supporting group is $G^{(k)}$ with supporting features as $F^{(k)} = F_{G^{(k)}}$. Then the estimations will be

$$\|\bar{\mathbf{w}} - \mathbf{w}^{(k)}\| \leq \sqrt{\frac{8\varepsilon^2 |\bar{\Delta}|}{\varphi_-^2(s)}} \quad (\text{A.18})$$

$$Q(\mathbf{w}^{(k)}) - Q(\bar{\mathbf{w}}) \leq \frac{|\bar{\Delta}| \varepsilon^2}{\varphi_-(s)} \quad (\text{A.19})$$

$$|\bar{G} \setminus G^{(k)}| \leq 2\bar{\Delta} \quad (\text{A.20})$$

$$|G^{(k)} \setminus \bar{G}| \leq \frac{16\varphi_+^2(1) |\bar{\Delta}|}{\lambda^2 \varphi_-^2(s)}. \quad (\text{A.21})$$

where $\bar{\Delta} = |\{g \in \bar{G} \setminus G^{(k)} \mid \|\bar{\mathbf{w}}_g\| < \gamma\}|$ and $\gamma^2 = \frac{8\varepsilon^2 |\bar{G} \setminus G^{(k)}|}{\varphi_-^2(s)}$.

Proof. By our previous lemmas, if $\varepsilon \geq \frac{2\sqrt{2}\varphi_+(1)\|\nabla Q(\bar{\mathbf{w}})\|_{G,\infty}}{\lambda\varphi_-(s)}$, we will have

$$\begin{aligned} 0 &\geq Q(\bar{\mathbf{w}}) - Q(\mathbf{w}^{(k)}) \\ &\geq \langle \nabla Q(\mathbf{w}^{(k)}), \bar{\mathbf{w}} - \mathbf{w}^{(k)} \rangle + \frac{\varphi_-(s)\|\bar{\mathbf{w}} - \mathbf{w}^{(k)}\|^2}{2}. \end{aligned}$$

A simple calculation gives the following relations:

$$\begin{aligned} \frac{\varphi_-(s)\|\bar{\mathbf{w}} - \mathbf{w}^{(k)}\|^2}{2} &\leq -\langle \nabla Q(\mathbf{w}^{(k)}), \bar{\mathbf{w}} - \mathbf{w}^{(k)} \rangle \\ &\leq \|\nabla Q(\mathbf{w}^{(k)})\|_{G,\infty} \sqrt{|\bar{G} \setminus G^{(k)}|} \|\bar{\mathbf{w}} - \mathbf{w}^{(k)}\| \\ &\leq \varepsilon \sqrt{|\bar{G} \setminus G^{(k)}|} \|\bar{\mathbf{w}} - \mathbf{w}^{(k)}\|. \end{aligned}$$

I.e., we have

$$\|\bar{\mathbf{w}} - \mathbf{w}^{(k)}\| \leq \frac{2\varepsilon \sqrt{|\bar{G} \setminus G^{(k)}|}}{\varphi_-(s)}. \quad (\text{A.22})$$

Here we point out that when the algorithm terminates, the $\ell_{G,\infty}$ norm is less than ε not $\lambda\varepsilon$ according to our algorithm.

Writing in another form, we have

$$\begin{aligned} \frac{4\varepsilon^2|\bar{G} \setminus G^{(k)}|}{\varphi_-^2(s)} &\geq \|\bar{\mathbf{w}} - \mathbf{w}^{(k)}\|^2 \\ &\geq \|(\bar{\mathbf{w}} - \mathbf{w}^{(k)})_{\bar{G} \setminus G^{(k)}}\|^2 = \|\bar{\mathbf{w}}_{\bar{G} \setminus G^{(k)}}\|^2 \\ &\geq \gamma^2 |\{g \in \bar{G} \setminus G^{(k)} \mid \|\bar{\mathbf{w}}_g\| \geq \gamma\}|. \end{aligned}$$

If we let $\gamma^2 = \frac{8\varepsilon^2|\bar{G} \setminus G^{(k)}|}{\varphi_-^2(s)}$, we can get a new estimation using the same trick in the objection function case:

$$|\bar{G} \setminus G^{(k)}| \leq 2|\{g \in \bar{G} \setminus G^{(k)} \mid \|\bar{\mathbf{w}}_g\| < \gamma\}| = 2\bar{\Delta}.$$

From above, we have

$$\begin{aligned}
& Q(\bar{\mathbf{w}}) - Q(\mathbf{w}^{(k)}) \\
& \geq \langle \nabla Q(\mathbf{w}^{(k)}), \bar{\mathbf{w}} - \mathbf{w}^{(k)} \rangle + \frac{\varphi_-(s) \|\bar{\mathbf{w}} - \mathbf{w}^{(k)}\|^2}{2} \\
& = \langle \nabla Q(\mathbf{w}^{(k)})_{\bar{G} \setminus G^{(k)}}, \bar{\mathbf{w}} - \mathbf{w}^{(k)}_{\bar{G} \setminus G^{(k)}} \rangle + \frac{\varphi_-(s) \|\bar{\mathbf{w}} - \mathbf{w}^{(k)}\|^2}{2} \\
& \geq -\|\nabla Q(\mathbf{w}^{(k)})\|_{G,\infty} \|\bar{\mathbf{w}} - \mathbf{w}^{(k)}\|_{G,1} + \frac{\varphi_-(s) \|\bar{\mathbf{w}} - \mathbf{w}^{(k)}\|^2}{2} \\
& \geq -\|\nabla Q(\mathbf{w}^{(k)})\|_{G,\infty} \sqrt{|\bar{G} \setminus G^{(k)}|} \|\bar{\mathbf{w}} - \mathbf{w}^{(k)}\|_{G,2} + \frac{\varphi_-(s) \|\bar{\mathbf{w}} - \mathbf{w}^{(k)}\|^2}{2} \quad (\text{Cauchy-Schwartz}) \\
& \geq -\varepsilon \sqrt{|\bar{G} \setminus G^{(k)}|} \|\bar{\mathbf{w}} - \mathbf{w}^{(k)}\| + \frac{\varphi_-(s) \|\bar{\mathbf{w}} - \mathbf{w}^{(k)}\|^2}{2} \\
& \geq -\frac{|\bar{G} \setminus G^{(k)}| \varepsilon^2}{2\varphi_-(s)}.
\end{aligned}$$

So we can bound the difference of Q as

$$Q(\mathbf{w}^{(k)}) - Q(\bar{\mathbf{w}}) \leq \frac{|\bar{G} \setminus G^{(k)}| \varepsilon^2}{2\varphi_-(s)} \leq \frac{|\bar{\Delta}| \varepsilon^2}{\varphi_-(s)}.$$

And the error of parameter estimation (A.22) can be simplified to

$$\|\bar{\mathbf{w}} - \mathbf{w}^{(k)}\| \leq \sqrt{\frac{4\varepsilon^2 |\bar{G} \setminus G^{(k)}|}{\varphi_-^2(s)}} \leq \sqrt{\frac{8\varepsilon^2 |\bar{\Delta}|}{\varphi_-^2(s)}}.$$

For the group selection, we have the following relation due to Lemma B.2 and (A.17)

$$|G^{(k)} \setminus \bar{G}| \leq \frac{2\varphi_+^2(1) \|\bar{\mathbf{w}} - \mathbf{w}^{(k)}\|^2}{\lambda^2 \varepsilon^2} \leq \frac{16\varphi_+^2(1) \bar{\Delta}}{\lambda^2 \varphi_-^2(s)}.$$

It completes the proof of the theorem. \square

As before, the key part of analysis is to compare the relation of difference of loss functions in our selection process and current optimal at various states.

We define a set M as $\{g \in G' \setminus \bar{G} : \|(\nabla Q(\bar{\mathbf{w}}))_g\| \geq \lambda \|\nabla Q(\bar{\mathbf{w}})\|_{G,\infty}\}$. Recall that $\bar{\mathbf{w}} = \underset{\text{supp}(\mathbf{w}) \subset F_{\bar{G}}}{\text{argmin}} Q(\mathbf{w})$ and

for any \mathbf{w}' with support group G' . In this paper, we will just use G' as $G^{(k)} \cup \bar{G}$.

Lemma B.5. *If we take any $g \in M$, we will have the following*

$$|G' \setminus \bar{G}| \left(Q(\bar{\mathbf{w}}) - \min_{\alpha} Q(\bar{\mathbf{w}} + \mathbf{E}_g \alpha) \right) \geq \frac{\varphi_-(s) \lambda^2}{\varphi_+(1)} (Q(\bar{\mathbf{w}}) - Q(\mathbf{w}'))$$

We want to point out that the following proof is different from Lemma A.6. This is due to the fact that we use different algorithms in the forward steps.

Proof. Let \mathcal{W}_g be the subspace of \mathbb{R}^p spanned by column vectors of \mathbf{E}_g where $g \in G$. For any $f_g \in \mathcal{W}_g$, we define

$$P_{f_g}(\eta) = \langle \nabla Q(\bar{\mathbf{w}}), \eta f_g \rangle + \frac{\varphi_+(1)}{2} \eta^2 \|f_g\|^2.$$

In fact, we just replace $\mathbf{E}_g \alpha$ by ηf_g . But this further separation of \mathbf{E}_g *alpha* in terms of direction f_g and length η will provide more freedom for our calculation. We further define

$$P_g(\eta) = \min_{f_g \in \mathcal{W}_g, \|f_g\|=1} P_{f_g}(\eta). \quad (\text{A.23})$$

So this new function is searching a direction such that P_{f_g} can get a minimum value of a fixed length.

One can observe that

$$\min_{\eta} P_g(\eta) = -\frac{\|\nabla_g Q(\bar{\mathbf{w}})\|^2}{2\varphi_+(1)}.$$

Taking $u = \|\mathbf{w}'_{G' \setminus \bar{G}}\|_{G,1} = \|(\mathbf{w}' - \bar{\mathbf{w}})_{G' \setminus \bar{G}}\|_{G,1}$, we will have

$$\begin{aligned}
& u \min_{g \in G' \setminus \bar{G}} P_g(\eta) \\
& \leq \sum_{g \in G' \setminus \bar{G}} \|\mathbf{w}'_g\| P_g(\eta) \\
& \leq \sum_{g \in G' \setminus \bar{G}} \|\mathbf{w}'_g\| P_{\frac{\mathbf{w}'_g}{\|\mathbf{w}'_g\|}}(\eta) \quad (\text{due to (A.23)}) \\
& = \sum_{g \in G' \setminus \bar{G}} \left(\eta \langle \nabla Q(\bar{\mathbf{w}}), \frac{\mathbf{w}'_g}{\|\mathbf{w}'_g\|} \|\mathbf{w}'_g\| \rangle \right) + \frac{u\varphi_+(1)\eta^2}{2} \\
& = \langle \nabla Q(\bar{\mathbf{w}}), \mathbf{w}'_{G' \setminus \bar{G}} \rangle \eta + \frac{u\varphi_+(1)\eta^2}{2} \\
& = \langle \nabla Q(\bar{\mathbf{w}}), (\mathbf{w}' - \bar{\mathbf{w}})_{G' \setminus \bar{G}} \rangle \eta + \frac{u\varphi_+(1)\eta^2}{2} \\
& = \langle \nabla Q(\bar{\mathbf{w}}), \mathbf{w}' - \bar{\mathbf{w}} \rangle \eta + \frac{u\varphi_+(1)\eta^2}{2} \\
& \leq \eta \left(Q(\mathbf{w}') - Q(\bar{\mathbf{w}}) - \frac{\varphi_-(s)}{2} \|\mathbf{w}' - \bar{\mathbf{w}}\|^2 \right) + \frac{u\varphi_+(1)\eta^2}{2}.
\end{aligned}$$

Now we take a special value $\eta_0 = -\frac{(Q(\mathbf{w}') - Q(\bar{\mathbf{w}}) - \frac{\varphi_-(s)}{2} \|\mathbf{w}' - \bar{\mathbf{w}}\|^2)}{u\varphi_+(1)}$ on the above inequality and move the left u to the right, then we will have

$$\begin{aligned}
& \min_{g \in G' \setminus \bar{G}} P_g(\eta_0) \\
& = -\frac{\left(Q(\mathbf{w}') - Q(\bar{\mathbf{w}}) - \frac{\varphi_-(s)}{2} \|\mathbf{w}' - \bar{\mathbf{w}}\|^2 \right)^2}{2u^2\varphi_+(1)} \\
& \leq -\frac{4 \left(Q(\mathbf{w}') - Q(\bar{\mathbf{w}}) \right) \frac{\varphi_-(s)}{2} \|\mathbf{w}' - \bar{\mathbf{w}}\|^2}{2u^2\varphi_+(1)} \quad (\text{due to } (a-b)^2 \geq -4ab) \\
& \leq -\frac{(Q(\mathbf{w}') - Q(\bar{\mathbf{w}})) \varphi_-(s)}{|G' \setminus \bar{G}| \varphi_+(1)}.
\end{aligned}$$

Notice that in the last line we take advantage of $\|\bar{\mathbf{w}} - \mathbf{w}'\|_{G,1} \leq \sqrt{|G' \setminus \bar{G}|} \|\bar{\mathbf{w}} - \mathbf{w}'\|$. And in

short the above inequalities give us

$$\min_{g \in G' \setminus \bar{G}} P_g(\eta_0) \leq - \frac{(Q(\mathbf{w}') - Q(\bar{\mathbf{w}})) \varphi_-(s)}{|G' \setminus \bar{G}| \varphi_+(1)}, \quad (\text{A.24})$$

which will be used in the following calculations.

Combining all the above inequalities, for any $g \in M$, we have the following:

$$\begin{aligned} & \min_{\alpha} Q(\bar{\mathbf{w}} + \mathbf{E}_g \alpha) - Q(\bar{\mathbf{w}}) \\ &= \min_{\eta, f_g \in W_g, \|f_g\|=1} Q(\bar{\mathbf{w}} + \eta f_g) - Q(\bar{\mathbf{w}}) \\ &\leq \min_{\eta, f_g \in W_g, \|f_g\|=1} \langle \nabla Q(\bar{\mathbf{w}}), \eta f_g \rangle + \frac{\varphi_+(1)}{2} \eta^2 \\ &= \min_{\eta} P_g(\eta) \\ &= - \frac{\|\nabla_g Q(\bar{\mathbf{w}})\|^2}{2\varphi_+(1)} \\ &\leq \lambda^2 \min_{g' \in G' \setminus \bar{G}, \eta} P_{g'}(\eta) \\ &\leq \min_{g' \in G' \setminus \bar{G}} P_{g'}(\eta_0) \lambda^2 \\ &\leq - \frac{(Q(\bar{\mathbf{w}}) - Q(\mathbf{w}')) \varphi_-(s) \|\bar{\mathbf{w}} - \mathbf{w}'\|^2 \lambda^2}{\varphi_+(1) u^2} \quad (\text{due to (A.24)}) \\ &\leq - \frac{(Q(\bar{\mathbf{w}}) - Q(\mathbf{w}')) \varphi_-(s) \lambda^2}{\varphi_+(1) |G' \setminus \bar{G}|} \end{aligned}$$

It completes the proof of the lemma. \square

We need our algorithm to be terminated in as few steps as possible. If we denote k as the iteration that the algorithm stops, then we will show this $k \leq s - \bar{k}$. Here, s is the group sparsity and \bar{k} is the number of supporting groups for the optimal solution.

Theorem B.6. *If $\varepsilon \geq \frac{2\sqrt{2}\varphi_+(1)\|\nabla Q(\bar{\mathbf{w}})\|_{G,\infty}}{\lambda\varphi_-(s)}$ and we require s to a number such that $s > \bar{k} + (\bar{k} + 1)(\sqrt{\kappa(s)} + 1)^2(2\kappa(s))^2 \frac{1}{\lambda}$, where \bar{k} is the number of groups corresponding to the global optimal sparse solution. Then our algorithm will terminate at some $k \leq s - \bar{k}$.*

Proof. Please refer to the proof for Theorem A.8. \square