

A medium-finesse optical cavity for the stabilization of Rydberg lasers

JULIUS DE HOND^{1,*}, NATALY CISTERNAS¹, GRAHAM LOCHEAD^{1,◦}, AND N.J. VAN DRUTEN¹

¹ Van der Waals – Zeeman Institute, Institute of Physics, University of Amsterdam, Science Park 904, 1098XH Amsterdam, The Netherlands

[◦] Present address: Physikalisches Institut, Universität Heidelberg, Im Neuenheimer Feld 226, 69120 Heidelberg, Germany

* Corresponding author: j.j.m.dehond@uva.nl

Compiled May 16, 2017

We describe the design, construction, and characterization of a medium-finesse Fabry–Pérot cavity for simultaneous frequency stabilization of two lasers operating at 960 and 780 nm wavelengths, respectively. The lasers are applied in experiments with ultracold rubidium Rydberg atoms, for which a combined laser linewidth similar to the natural Rydberg linewidth (≈ 10 kHz) is desired. The cavity, with a finesse of ≈ 1500 , is used to reduce the linewidth of the lasers to below this level. By using a spacer made of ultra low expansion (ULE[®]) glass with active temperature stabilization, the residual frequency drift is limited to $\lesssim 1$ MHz/day. The design optimizes for ease of construction, robustness, and affordability. © 2017

Optical Society of America

OCIS codes: (020.5780) Rydberg states; (120.2230) Fabry-Perot; (140.3425) Laser stabilization; (300.3700) Linewidth; (300.6310) Spectroscopy, heterodyne

1. INTRODUCTION

Ever since the original experiments by Fabry and Pérot, optical cavities [1, 2] have been useful tools for accurately measuring distances and creating frequency-specific light sources [3]. Nowadays their uses are versatile, and they can be found in numerous places where stable and/or narrow wavelength lasers are required. This includes but is not limited to their use in the LIGO facilities for the detection of gravitational waves [4]; their relevance as a source for stabilizing lasers with sub-Hz linewidths [5–8]; and their use as frequency-selective elements for wavelength multiplexing in optical communication networks [9]. Cavities are popular in the field of atomic physics, too, as a source for stabilization of lasers, and as a platform for exploring strong light–matter couplings, for example, in cavity QED [10, 11].

In the 1960’s cavities were predominantly used for stabilizing gas and dye lasers [12–14], but since the advent of semiconductor lasers they have proven to be a reliable source for stabilizing them, too. Because of a diode’s sensitivity to optical feedback, it is for instance possible to stabilize it by feeding the reflected signal of the cavity directly back into the diode [15]. Nowadays, however, with the advent of cheap and high-bandwidth feedback electronics, it is more common to generate an error signal which is fed back into the diode electronically [16, 17]. Although there exist several schemes for generating an electronic error signal, the most common technique is that of Pound–Drever–Hall (PDH) stabilization, where the phase of the laser is modulated with an RF signal [18, 19].

Cavities prove to be an excellent source for stabilization signals in a wide range of atomic physics experiments, for instance that of Rydberg physics. Rydberg atoms [20] have lifetimes in the 100 μ s range (depending on principle quantum number), and therefore their optical transition linewidths are typically in the kHz regime. Several proposals, for instance Rydberg dressing [21, 22], require narrowed lasers with linewidths on the order of 10 kHz. Cavities are convenient in this context, because through the choice of mirrors the width of the reference feature can be engineered [1, 2]—as opposed to Doppler-free saturation spectroscopy in vapor cells, typically used for laser cooling applications, where the linewidth is limited by the natural linewidth of the relevant atomic species (for rubidium this is several MHz [23]). In a two-photon excitation scheme vapor cells can in principle also be used for locking the upper transition’s laser, e.g. using a method based on electromagnetically induced transparency, for instance [24]. This requires a large amount of laser power, and it also means the laser frequency cannot be scanned without additional steps. Finally, a cavity is advantageous compared to atomic transitions because it does not saturate.

A disadvantage of a locking scheme based on a cavity is that the resonance frequencies are arbitrary and are not in any way related to atomic transitions. This is a problem that can be mitigated by a locking scheme that relies on a stable fixed-length cavity combined with movable sidebands [25].

Here we describe the design, construction, and characterization of a medium-finesse cavity setup and its use for linewidth

narrowing and stabilizing two diode lasers that are used for (two-photon) Rydberg excitation of ultracold rubidium gases.

Our linewidth requirements are at the kHz level where a medium-finesse cavity suffices. Our design was optimized for affordability, ease of construction, and robustness. It is intended for two-photon excitation of high-lying Rydberg states ($n \geq 20$) from the ground state of ^{87}Rb using lasers operating at 780 nm (near the $5s_{1/2}$ – $5p_{3/2}$ transition) and at 480 nm (near the transition from the $5p_{3/2}$ level to ns or nd Rydberg levels). The cavity that is described here was designed to operate at wavelengths of 780 and 960 nm (the 480 nm light that was used for Rydberg excitation was derived from the latter using second harmonic generation). This is similar to the setup described in Ref. [26] by Naber *et al.* where they employed a commercial cavity from Stable Laser Systems [27] for a similar purpose. Our experiment also bears resemblance to that of Löw *et al.* described in Ref. [28]. Here a Zerodur[®] spacer block with two separate bores—one for each wavelength—was used. The length of each cavity was independently controllable with a special piezo stack that is insensitive to thermal fluctuations [28]. Their cavity effectively consists of two cavities, and is more complicated to assemble than ours. The design presented here is inspired by that of Stellmer as described in Ref. [29] and that of Boddy from Ref. [30].

2. DESIGN CONSIDERATIONS

The design principle of most cavities is to attach two highly-reflective mirrors to a spacer block made of material that has a stable length. Often this is a material with a low thermal expansion coefficient, but the length can also be actively stabilized. This spacer, then, is placed in a stable mount which is put in a vacuum chamber. Our design incorporates some improvements over Stellmer's design, some of which were suggested in Ref. [29], which will be elaborated below.

For the design of our cavity several considerations were taken into account. First of all, to prevent air currents and short-term thermal fluctuations from changing the alignment or the spacer length, the cavity is mounted in a vacuum system. This is pumped by an ion pump to avoid mechanical vibrations. Because we wanted to implement a dual laser-locking scheme with the same cavity, a piezo-based design was less suitable. That is because it is not possible to independently control the resonance positions of two different lasers this way. Additionally, a piezo can cause mechanical instabilities and requires feeding through wires through the vacuum system, which makes a sideband-locking scheme all the more attractive [25].

Our cavity is non-hemispherical, and the mirrors are in a plano-concave configuration; the reason for which is threefold: i) The alignment of the mirrors' optical axes in a plano-concave cavity is not crucial, making the assembly easier, ii) a confocal configuration puts stringent constraints on the spacer length, and iii) in a realistic confocal system the higher order modes will not perfectly overlap with the principal mode due to small misalignments, leading to artificial broadening [1].

The reflectivity of the mirrors we need is set by requirements on the finesse \mathcal{F} of the cavity: this is the ratio of the free spectral range ($f_{\text{FSR}} = c/2L$) and the full width at half maximum (FWHM) δf of the principal cavity resonances.

Fixing the finesse and the cavity length L thus fixes the width of the resonances, which in turn determines the possible linewidths that can be achieved by locking to it. Using a typical PDH setup it is possible to reduce the laser linewidth to

a fraction of the cavity linewidth [18, 19]. Reduction by factors of 10^{-4} is typical, and it is even possible to achieve a factor of 10^{-6} [31]. For our experiments, we aim for a factor better than 10^{-2} . Since the lasers have to be narrowed to ~ 10 kHz this requires a cavity linewidth of ~ 1 MHz. Furthermore, the cavity should not be too long, since this will make it more sensitive to vibrations [5, 6]. It must also not be too short, for then the free spectral range becomes so large it cannot be spanned by the movable sidebands. We choose a length $L = 100$ mm, which puts the required finesse at $(c/2L) / \delta f \approx 1500$.

Last but not least there is the price of the system. Commercial cavities of a similar design made by Stable Laser Systems are used elsewhere in the field (see e.g. Ref. [26]). By using a design that combines two low-expansion glasses (ZERODUR[®] and ULE[®] [27]), the typical finesses and long-term drifts of their cavities are better than the design we are describing presently. There is a price tag attached, though; our complete setup costs less than €7,000. This includes the vacuum system with pump, and the production of the spacer and mirrors; the fabrication of the latter is the most expensive, since the mirrors have to be highly reflective for both 780 and 960 nm. A fully assembled cavity from Stable Laser Systems (SLS) costs several times that [27].

3. THE CAVITY DESIGN

The cavity itself consists of a spacer of ultra-low expansion (ULE[®]) glass (measuring $(30 \pm 0.1) \times (30 \pm 0.1) \times (100 \pm 0.2)$ mm³), which was custom made by Hellma Optik. The reason for choosing ULE[®] was that it has an extremely low coefficient of thermal expansion ($0 \pm 30 \times 10^{-9}/^\circ\text{C}$), which has a zero crossing close to room temperature [32]. Alternatives such as ZERODUR[®] have slightly higher expansion coefficients but may be better at other temperatures [33]. The spacer has a main bore centered along the long axis ($\varnothing 10$ mm) and an additional bore ($\varnothing 3$ mm) in one of the sides which is intended for venting.

The cavity mirrors were custom made by Layertec GmbH. The radii of curvature were chosen as $R_1 = 500$ mm and $R_2 = \infty$, making this a plano-concave cavity well within the stability region [1, 2], given by the criterion

$$0 \leq g_1 g_2 \leq 1, \quad (1)$$

with

$$g_i = 1 - \frac{L}{R_i},$$

where L is the length of the cavity.

Additionally, for these values the resonance frequencies of the first few higher-order transverse modes are different from those of the principal modes.

The transverse mode spacing is a fraction $\arccos(\sqrt{g_1 g_2}) / \pi \approx 0.15$ of the free spectral range [1], so that the first few transverse modes will be clearly distinguishable from the principal ones.

The mirrors are specified to have a reflectivity of $99.8 \pm 0.1\%$ at wavelengths of 780 nm and 958–970 nm, leading to a finesse [1]

$$\mathcal{F} = \frac{\pi\sqrt{R}}{1-R} \approx 2000. \quad (2)$$

The mirrors were glued onto the spacer using EPO-TEK[®] 353ND epoxy [34]. This was chosen for its low outgassing rates such that it is suitable for use in a vacuum system.

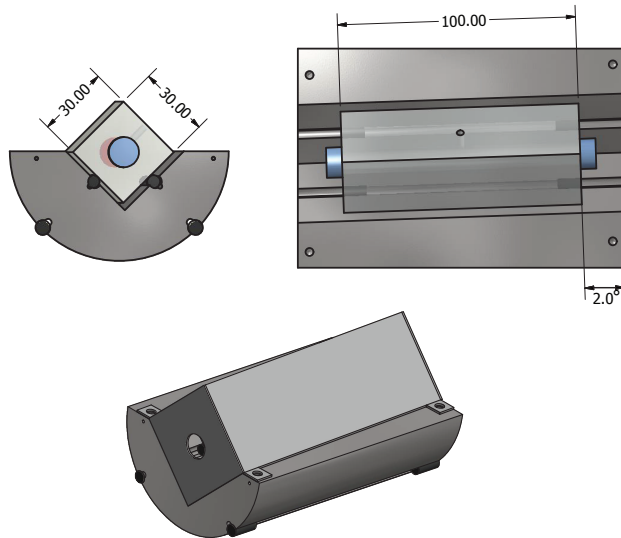

Fig. 1. Drawings of the cavity design. Top: Exposed view from front (left) and top (right) with relevant dimensions in mm or degrees. Bottom: View with the cover included.

The assembly of the spacer and the mirrors is placed in a hemicylindrical block of stainless steel with a gutter to accommodate the spacer. This gutter was designed to have a 2° angle with respect to the long axis of the block to prevent any problems with back reflections from the windows of the vacuum assembly in which it is placed. The spacer is supported by four short Viton® rods (with a length and diameter of approximately 20 and 5 mm, respectively).

A cover was designed to protect the exposed part of the spacer from black-body radiation and hazards such as debris coming from the ion pump (to which there is a direct line-of-sight otherwise). This cover has two holes on either side for optical access to the cavity. Figure 1 includes some renderings of the full design. In Stellmer's original cavity, the spacer was enclosed, and clamped in tight by a cylinder of stainless steel and thereby protected [29]. Despite this being more rigid, it does cause stresses on the spacer that are not desirable.

4. THE VACUUM SYSTEM

The stainless steel block was placed in a vacuum system to reduce temperature and air fluctuations. It was also supported by short Viton® rods (of similar dimensions as those mentioned above) so that it does not contact the vacuum chamber directly. A diagram of the assembly can be seen in Fig. 2.

The system consists of standard vacuum parts: two reducing tees (DN100 to DN40 and DN40 to DN16); the mount is placed in the larger tee, and the smaller one is used to attach an ion pump and a valve. There are viewports on either side of the larger tee, allowing us to monitor both the reflection and the transmission signals. The flatness of standard viewports can be a problem, however, viewports that are suitable for laser applications are expensive. Therefore we chose to equip the chamber with two different viewports: one made from standard Kodial® glass, and one made from UV grade fused silica. They were used on the transmission and reflection sides of the cavity, respectively, because it is the reflection signal we are interested in for locking.

The system has a small, dedicated ion pump (Agilent, 2 l/s) for maintaining vacuum conditions. There is also a valve which

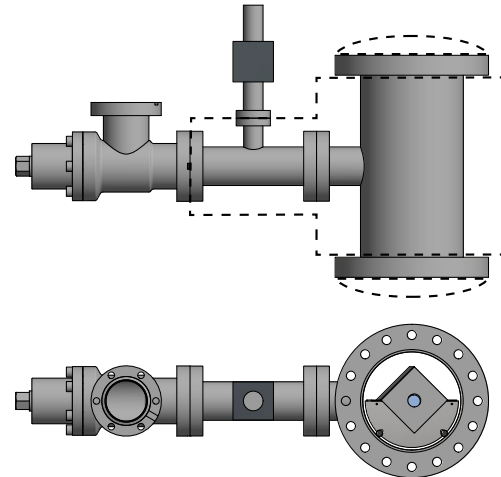

Fig. 2. Drawings of the vacuum system with the cavity mounted inside. Top: top view of the system. The dashed lines indicate the areas that are wrapped in Superwool®. Bottom: side view of the system. In both drawings the ion pump is in the center (represented by the black square) and the valve is on the left.

shuts off a flange that can be used for connecting a turbo pump; this is only used for initially evacuating the system, and not part of the day-to-day operation. After the system was assembled, it was evacuated using a turbo pump, and baked at a modest temperature of 50 °C for one week.

Subsequently the valve was closed and the turbo pump was disconnected, leading to a final pressure of about 3×10^{-7} mbar (as derived from the ion pump current).

5. TEMPERATURE STABILIZATION

Despite our best efforts to insulate the cavity from the environment by placing it in a vacuum system, temperature fluctuations are bound to couple into it. Small changes on the order of 100 mK will affect the length of the cavity slightly and thereby change the resonance positions. We will now estimate the size of this effect. Any principal cavity mode satisfies $f_n = nc/2L$, with n the mode index. If the length L of the spacer changes by an amount ΔL , this means that the resonance frequency will shift by

$$\Delta f_n = \frac{nc}{2L} - \frac{nc}{2(L + \Delta L)}. \quad (3)$$

The change in length is determined by the coefficient of thermal expansion α_T through $\Delta L = \alpha_T L \Delta T$. Using this, and setting $f_n = c/\lambda$ (where λ is the wavelength of the light) we get

$$\Delta f_n = \frac{c}{\lambda} \frac{\alpha_T \Delta T}{1 + \alpha \Delta T} \approx \frac{c \alpha \Delta T}{\lambda}, \quad (4)$$

where in the last step we used $\alpha \Delta T \ll 1$.

For $\lambda = 780$ nm and $\alpha = 30 \cdot 10^{-9}$ K⁻¹ (the upper limit to the thermal expansion coefficient of ULE® [32]) this means that a temperature change of 100 mK will result in a length change of

0.30 nm, corresponding to a frequency shift of 1.15 MHz. Without any additional stabilization, such fluctuations are likely to find their way into the system, because the laboratory temperature is only regulated at the level of 1 K.

In order to stabilize the temperature and thereby stabilize the cavity itself, a resistive heating pad¹ was stuck to the DN100 part of the large reducing tee. Three temperature sensors (LM35, Texas Instruments, Inc.) and two thermistors (10 k Ω , NTC, Epcos AG) were attached as well in order to monitor and regulate

the temperature, respectively. For further insulation, the assembly was wrapped in a Superwool[®] blanket [35] which, in turn, was covered using aluminium foil.

To regulate the temperature we used a PTC5K-CH controller (Wavelength Electronics, Inc.) which is compatible with several temperature sensors including our 10 k Ω thermistor [36]. It sends 100 μ A through the thermistor, and uses the output voltage as an error signal in a PI-circuit. For stable regulation, it was necessary to increase the time constant of the integrator by replacing the default 3.3 μ F capacitor by a 10 μ F capacitor.

To reduce the coupling in of thermal fluctuations from the environment, we added a second temperature controller with heating foil that regulates the temperature of the mounts of the vacuum system enclosing the cavity. The foil² for this circuit was glued on the breadboard between the mounts, and the thermistor was placed on one of them.

The controller was optimized such that the temperature is stable and there is no crosstalk between the two controllers.

A change in temperature of the vacuum chamber will not result in an instantaneous equivalent temperature change of the steel mounting block and the cavity spacer. The heat flow between the components is resistively coupled via the Viton[®] rods, and can be thought of as the thermal equivalent of an electrical RC-circuit. Here the Viton[®] acts as thermal resistor, and the mount and spacer are both thermal capacitors. The parameters of interest are the heat conductivity and capacity of the different materials. First we will consider the heat flow between the vacuum housing and the steel mounting block.

The specific heat of steel is 0.483 J/gK [37]; with our mounting block weighing approximately 2 kg, this means that its heat capacity is ~ 1 kJ/K. The precise thermal conductivity of Viton[®] is unknown, it is a fluoroelastomer, which is a type of synthetic rubber. For our estimate we will use the conductivity of natural rubber, which is approximately 0.2 W/Km [37]. Under the assumption that the rods are cuboids this puts the thermal resistance at about 250 K/W. Since there are four rods connected in parallel, the total thermal resistance is a quarter of this number, so about 60 K/W. For the coupling of environmental fluctuations into the steel mount we thus find an RC-time of approximately 60 K/W \cdot 1 kJ/K \approx 17 hrs.

Similarly, the ULE[®] spacer has a specific heat of 1.31 J/gK [32] and a mass of 200 g, resulting in a heat capacity of 153 J/K. Assuming the same thermal resistance for the support rods this yields an RC-time of \approx 3 hrs. This timescale is shorter than that of the steel mount, so heat transport into the mount will be the rate limiting step for heating of the whole assembly.

6. RF GENERATION

In order to control the frequency of the lasers and stabilize them in a spectroscopically relevant place, RF signals were needed

¹Thermo Flächenheizungs GmbH, measuring 230 mm \times 130 mm and specified to provide 20 W at 24 V_{AC/DC}.

²Thermo Flächenheizungs GmbH, measuring 170 mm \times 70 mm and specified to provide 30 W at 24 V_{AC/DC}.

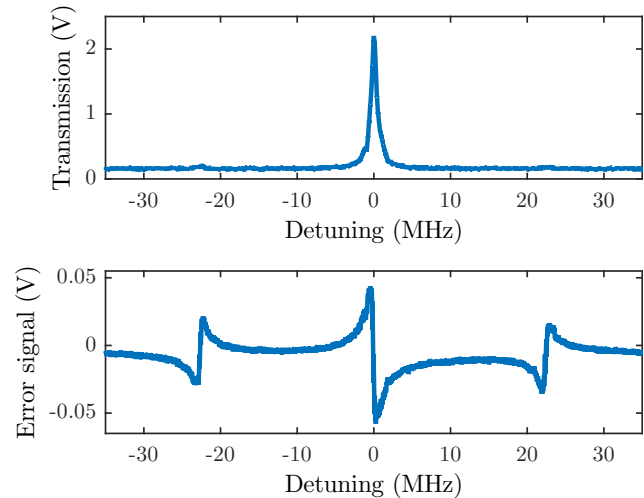

Fig. 3. Top: Transmission spectrum of a principal mode of the 960 nm beam with weak phase modulation sidebands at ~ 25 MHz. Bottom: Error signal derived from the reflection of the same mode. The frequency axes were determined using the position of the sidebands that are required to generate the PDH signal.

for sideband generation. The sidebands were applied using fiber-based electro-optic modulators (EOMs) (PM785 and PM940 for the 780 and 960 nm light, respectively) from Jenoptik AG. For each laser, two RF signals were required: one to generate movable sidebands (in the 100–1500 MHz range) to which the lasers could be locked, and one to generate sidebands at ~ 25 MHz for the Pound–Drever–Hall locking scheme [18, 19].

The 25 MHz signals were taken from the Toptica PDD110 modules of the respective lasers. The movable sidebands were generated using a controllable RF source. We used a SynthUSBII from WindFreak Technologies, LLC., which is an implementation of the ADF4351 chip from Analog Devices, Inc. It has a tuning range from 34 MHz–4.4 GHz and features an integrated microcontroller which makes it easy to incorporate in the existing laboratory software.

7. CAVITY ANALYSIS

Using the 960 nm light, spectra of the cavity were obtained. Using a scan over a full free spectral range we found this to equal $f_{\text{FSR}} = 1495 \pm 2$ MHz. This frequency was calibrated by overlapping the movable sidebands of two adjacent modes. This free spectral range corresponds to $L = 100.2 \pm 0.1$ mm, which is close to the specified length of the spacer.

Theoretically we expect $f_{\text{FSR}} \approx 1500$ MHz for our case. The slight discrepancy between this and what we measure can (partially) be explained by the fact that one of the two mirrors is curved, effectively increasing the length of the cavity. Along the central axis the increase in length equals

$$\Delta L = \frac{d^2}{4R_1} \frac{1}{\sqrt{1 - (d/2R_1)^2}} = 80.7 \mu\text{m}, \quad (5)$$

(with $d = 12.7$ mm being the mirror's diameter and $R_1 = 500$ mm its radius of curvature). This means that now $f_{\text{FSR}} = 1498$ MHz. This is still not equal to what we measured, but it does put the length of the spacer within its specified margin.

A more detailed transmission spectrum around a principal resonance is shown in Fig. 3. The corresponding error signal that we obtained can be seen in the same figure.

Due to the finite rise time of our relatively slow photodiode (Thorlabs DET100A, 43 ns) it is difficult to get an accurate linewidth from this. First of all this means that the photodiode will keep showing a signal for a (short) while after the cavity has stopped doing so. Additionally, the cavity ‘bleeds’ light for a while after the laser is scanned across resonance due to the buildup of light in it. We can make a crude estimate of the width of the cavity features, though: from Fig. 3 we estimate the FWHM to be around one MHz; dividing f_{FSR} by the FWHM, we find that $\mathcal{F} \sim 1500$. This is sufficient for our present purposes, which is to lock the lasers and reduce their linewidth to $\ll 1$ MHz.

8. LINEWIDTHS & STABILITY

The final verdict of the performance of our cavity design is based on two indicators: the linewidth of the lasers that are locked to it, and the overall stability of the positions of the resonances. Both these values can be obtained using a heterodyning setup. The measurement of the long-term drift is discussed in Subsection B, but first we will focus on measuring the short-term laser linewidths. This can be achieved using a technique called ‘self heterodyning,’ which involves splitting the light in to two arms, one of which is delayed for a time on the order of the laser coherence time τ_c or longer [38]. The resulting two beams can be considered as independent, and when they are overlapped on a photo diode they will produce a beating signal. The self-heterodyne technique measures the phase diffusion of the laser (on the timescale of the optical delay, see below), which is the dominant source of the laser linewidth for our lasers.

A. Self-heterodyning

To analyze the linewidths of our lasers, we used a self-heterodyning setup with a 12.4 km long fiber. We used an AOM in double-pass configuration³ to shift the other beam by 160 MHz. The beams are recombined on a fast photo diode (New Focus, 1601FS-AC), which is connected to a spectrum analyzer to measure the beat signal.

The fiber has a refractive index n_f of approximately 1.5 [39], which means that the delay time τ_{del} is approximately 60 μs . Note that the refractive index depends on wavelength, so this is just an estimate. The delay time sets an upper bound for the linewidth that can be measured accurately, since $\delta f \propto 1/\tau_c$. If $\tau_c \gtrsim \tau_{\text{del}}$ the beams will still be (partially) coherent, meaning some interference will result.

If the two beams are fully incoherent the beating spectrum can be thought of as a convolution of the laser with itself. This means that the laser linewidth will be between a factor $1/\sqrt{2}$ and $1/2$ of the measured linewidth [38], depending on whether we assume a Lorentzian or Gaussian lineshape.

A Voigt function is the most complete description [1]; this is a convolution of a Gaussian and Lorentzian profile, and will result in a combined linewidth that is within the bounds set by its constituent distributions. It is suitable for situations in which two or more broadening sources with Lorentzian and Gaussian characters (e.g. the natural laser linewidth and technical phase noise) play a significant role.

³By using it in a double-pass configuration it is easier to switch between a 780 and 960 nm beam since the AOM then does not need realigning.

Under the assumption of a white (frequency) noise distribution it is still possible to obtain a linewidth from a measurement in which some coherence remains. These measurements, however, are notoriously difficult to interpret accurately [40, 41]. In those cases it is possible to fit an expression to the power spectrum of the form [40–42]

$$S(f) \propto \frac{\delta f}{(f - f_0)^2 + (\delta f)^2} \times \left(1 - e^{-2\pi\delta f \tau_{\text{del}}} \left\{ \cos [2\pi\tau_{\text{del}} (f - f_0)] + \frac{\delta f}{f - f_0} \sin [2\pi\tau_{\text{del}} (f - f_0)] \right\} \right). \quad (6)$$

In the fully incoherent limit ($\delta f \tau \gg 1$) the exponent will go to zero, resulting in a purely Lorentzian lineshape. This expression also shows that, in the case of some remaining coherence, the fringes will have a period of τ_{del} , which we can compare to what we expect based on the length and refractive index of the fiber. Even though analyzing these fringes can be tricky, at the very least their presence provides a characteristic scale for the linewidth. The key is the suppression factor $\exp(-2\pi\delta f \tau_{\text{del}})$ which is non-negligible for $\delta f \lesssim 1/2\pi\tau_{\text{del}}$; for us this last factor is approximately 3 kHz.

A.1. 960 nm laser

In a self-heterodyning measurement we measure both the free-running laser spectrum, and the stabilized laser linewidth. For the latter the laser is locked to the cavity using a high-bandwidth PID controller (Toptica, FALC 110) which has a bandwidth of about 45 MHz [43]. This is an absolute prerequisite if one is to narrow a diode laser, which typically has frequency noise above the MHz level [44]. We used the linewidth measurement to optimize the settings of the PID controllers by looking at how the profiles narrowed and developed fringes as we changed the settings of the several integrators that are in the controllers. What we present here are the results obtained using optimized settings.

The beat signal was analyzed using a Rigol DSA815 spectrum analyzer. Each measurement consists of about 30 averages to increase the signal-to-noise ratio. Figure 4 contains both the locked and unlocked spectra of the 960 nm laser. To obtain quantitative information from these results we fitted several functions to them, the fits are included in Fig. 4 as well. For the unlocked laser spectrum we used a pseudo-Voigt profile, which is a weighted sum of a Lorentzian and a Gaussian function [45, 46]. From this we obtained a Lorentzian (FWHM) linewidth of 70 kHz and a Gaussian (FWHM) linewidth of 160 kHz. The fitted pseudo-Voigt was 18% Lorentzian, and 82% Gaussian. The -3 dB points are 320 kHz apart, which means that the laser’s linewidth is between 160 and 230 kHz, depending on its spectral character (see above, also Ref. [38]). There exists an empirical expression to obtain the FWHM of a Voigt profile (γ_V) from its constituent Lorentzian and Gaussian profiles’ widths (γ_L and γ_G , respectively) [47]. It is given by

$$\gamma_V = 0.5346\gamma_L + \sqrt{0.2166\gamma_L^2 + \gamma_G^2}. \quad (7)$$

With our fit parameters this results in a Voigt linewidth of 200 kHz which is in accordance with what we expect based on the distance between the -3 dB points.

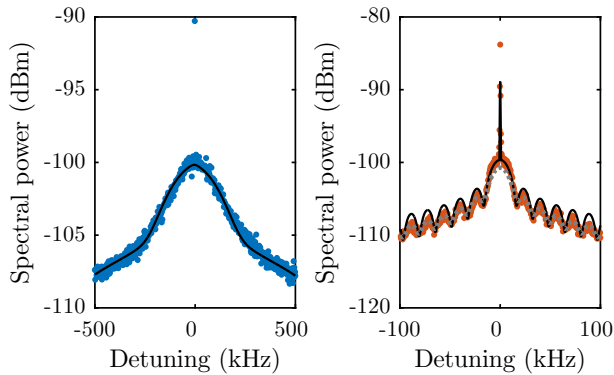

Fig. 4. Self-heterodyned interferometric spectra of the unlocked (left) and locked (right) 960 nm laser (measured with resolution bandwidths of 1 kHz and 100 Hz, respectively). To fit the unlocked spectrum we used a pseudo-Voigt lineshape, yielding a laser linewidth of around 200 kHz. The fits in the locked spectrum are to Eq. (6), and are optimized for two different regimes: they fit to either the central region for absolute detunings $\lesssim 10$ kHz (black, solid) or to the fringes, absolute detunings $\gtrsim 50$ kHz (grey, dashed), and lead to laser linewidths δf of 4 and 20 kHz, respectively.

The locked laser spectra were fitted using Eq. (6). As is pointed out in Ref. [41], it is difficult to get this function to fit both the fringes and the central part; we follow an approach similar to that taken in said reference where they fit two functions (each with the same total spectral intensity): one that matches the modulation depth of the fringes, and one that matches the power level of the wings. The reason that it is not possible to make a single good fit is that that the phase noise is not white, as is assumed in Eq. (6), but has some additional low-frequency components which are not accounted for [41]. For the 960 nm laser we chose to fit the central peak and fringes separately.

The delta-peak in all these measurements is caused by the AOM being aligned imperfectly. An unshifted portion of light is still present in the path that is not delayed, leading to a sharp peak at the AOM frequency regardless of whether the delayed light is present or not. The peak is very narrow, but in practice it is broadened by the finite resolution bandwidth of the spectrum analyzer. We account for it by adding a delta peak at zero frequency to the fitting function, but this is only done to prevent our fitting routine from attempting to fit Eq. (6) to the narrow feature.

We obtain linewidths δf of 4 and 20 kHz when fitting to the central part and the wings, respectively. Both fits result in a similar value for the fringe spacing, corresponding to a delay time of $61.9 \mu\text{s}$, which is in accordance with what we expect based on the fiber specifications.

A.2. 780 nm laser

To measure the linewidth of the 780 nm laser we largely followed the same procedure as for the 960 nm laser. The difference between the locked and unlocked laser is shown in Fig. 5. These data were fitted as well (see Fig. 5); for the unlocked laser a simple Gaussian profile fitted sufficiently well, and we obtained a FWHM laser linewidth of 300 kHz. For the locked laser we found a δf of 3 kHz, and a delay time of $62.2 \mu\text{s}$ (a single function fit the profile sufficiently well). The difference between the delay times between the two lasers (as far as it is outside of the measurement error) can be explained by a wavelength-

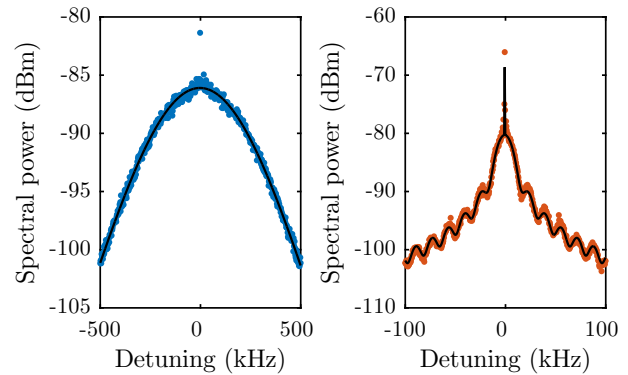

Fig. 5. Self-heterodyned interferometric spectra of the unlocked (left) and locked (right) 780 nm laser (measured with resolution bandwidths of 1 kHz and 100 Hz, respectively). We used a Gaussian lineshape to fit the unlocked spectrum; this led to a laser linewidth of 300 kHz. To fit the locked spectrum we used Eq. (6) again, this yielded a linewidth of δf of 3 kHz.

dependence in the index of refraction of the fiber. This last result for δf should certainly be taken with a grain of salt for reasons mentioned above (i.e. the assumption of the noise character), although it should be pointed out that for this measurement it is possible to fit Eq. (6) to both the central region and the fringes. (This was difficult for the 960 nm laser, cf. Fig. 4.)

B. The cavity drift

In our experiments involving Rydberg excitation we have noticed an apparent drift in the resonance frequency over time. This is caused by a drift in the frequency of the cavity feature to which the lasers are referenced.

To measure the cavity drift we used our 780 nm Rydberg laser, which was heterodyned with a beam derived from another 780 nm laser in our laboratory, which is locked to a rubidium vapor cell via Doppler-free saturated absorption spectroscopy. We used the same heterodyning setup as we used for the linewidth measurements described above, but without the delay fiber. This means that one of the two lasers is shifted by an additional 160 MHz by the AOM that is still on the board.

The reference laser is locked to a rubidium vapor cell, so it is relatively broad but stable over time. We measured its linewidth to be 360 kHz (full-width at half maximum).

This linewidth is good enough to monitor frequency drifts on the order of MHz. The reference laser is locked to the $F = 2 \rightarrow F' = 1, 3$ crossover, and the Rydberg 780 nm laser is blue-detuned⁴ by 300 MHz from the $F = 2 \rightarrow F' = 3$ transition. Therefore the frequency difference between the lasers is $(211.8 + 300) \text{ MHz} = 511.8 \text{ MHz}$ [23]. The AOM still in the setup shifts the Rydberg laser by an additional 160 MHz. This means that the frequency difference between the two lasers is approximately 670 MHz.

We measured the drift by reading out the peak beat frequency from the spectrum analyzer every ten seconds. Using this and our relatively stable laser locks we were able to do measurements over multiple days.

Figure 6 shows a combination of such measurements taken over the course of a month.

When the system reached equilibrium after having switched

⁴This seemingly arbitrary number was set by the cold-atom Rydberg experiments we were running in parallel.

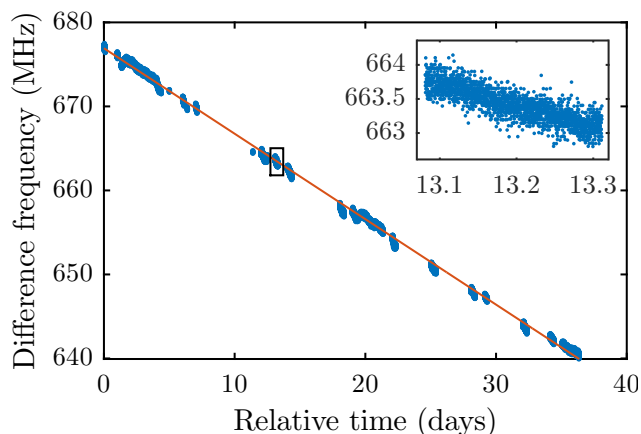

Fig. 6. Characterization of the long-term drift of the cavity through measurements of the difference frequency between two lasers over the course of a month. The linear fit has a slope of -1.02 MHz/day. Inset: data from a single day (covering ≈ 5 hours) indicated by the rectangle.

on the stabilization circuit for the mounts's temperature as well, an overall drift was left; see Fig. 6. This was about 1 MHz/day.

We can estimate how much the cavity has to expand by to achieve a frequency shift of 1 MHz. For a wavelength of 780 nm this is 0.26 nm.

This apparent expansion may be related to our mirrors being glued rather than optically contacted; this is an important difference between this design and those presented elsewhere [5–8, 27]. A possible mechanism for this slow expansion could be that the glue crept between the spacer and the mirrors, and is still curing, resulting in the length changes we appear to be seeing.

The effect of temperature changes on the spacer was measured by disabling the circuit that regulates the temperature of the cavity and its mounts. This led to an instantaneous increase of coupling in of laboratory temperature fluctuations. Specifically, we noticed that an sudden increase of 1 K in laboratory temperature (i.e. as happens after turning on all laboratory equipment) led to a gradual drift of ~ 5 MHz in resonance frequency over a period of 10 hours. Using these data in conjunction with Eq. (4) and the estimated thermal RC time of 17 hours leads to an expansion coefficient α of $23 \cdot 10^{-9} \text{ K}^{-1}$, which is inside the specified range [32].

9. DISCUSSION

The cavity and the laser system locked to it are now being successfully applied to excite Rydberg atoms and perform Rydberg spectroscopy of ultracold rubidium atoms in our laboratory [48].

For a next-generation design it would be commendable to assess the thermal coupling between the vacuum system surrounding the cavity and the surface on which it is mounted in greater detail. In our case the interface is that of stainless steel against stainless steel, which has an excellent thermal conductivity. One of the advantages is that this does make the system mechanically stable, and that the alignment of the laser beams into the cavity only rarely needs to be adjusted. The timescale of the observed thermal fluctuations is also important, because if they are slow and persistent enough they will couple into the system at some point anyway, regardless of any shielding between mounts and mounting surface. This means active thermal

feedback is essential; it might be very beneficial to add this to the inside of the vacuum system, although this would involve designing a vacuum-compatible regulating circuit. By adding thermal regulation to the vacuum system's exterior as well one should be able to achieve a very stable system. In that case the only drift that will remain is the one that seems to be inherent to the assembly of spacer and mirrors. For this to be minimized, it would also be highly recommended to optically contact the mirrors to the spacer.

If one is to use this design as a template for a cavity of a higher finesse, this can be done (up to a point) by increasing the reflectivity of the mirrors. One should also bear in mind that the performance of high-finesse cavities is in part limited by their sensitivity to vibrations; our design was not optimized in this regard, and it may be necessary to perform such an optimization if higher stability is desired.

10. CONCLUSION

We have demonstrated an economical design for a medium-finesse, dichroic, optical cavity ($\mathcal{F} \sim 1500$). Using a heterodyning setup, we measured laser linewidths of $\delta f \lesssim 10$ kHz for both of our Rydberg lasers, and a long term drift of about 1 MHz/day for our 780 nm laser. The cavity was protected from thermal fluctuations of the environment using two independent temperature regulation circuits. The resulting system is now in active use to stabilize lasers for the excitation of ultracold rubidium atoms to Rydberg states.

ACKNOWLEDGMENTS

We thank Alex Bayerle and Florian Schreck for stimulating discussions concerning our design, and H.B. van Linden van den Heuvell for a critical reading of the manuscript.

This work is financially supported by the Foundation for Fundamental Research on Matter (FOM), which is part of the Netherlands Organisation for Scientific Research (NWO). We also acknowledge financial support by the EU H2020 FET Proactive project RySQ (640378).

REFERENCES

1. A. E. Siegman, *Lasers* (University Science Books, Mill Valley, California, 1986).
2. H. Kogelnik and T. Li, "Laser beams and resonators," *Proceedings of the IEEE* **54**, 1312–1329 (1966).
3. A. Perot and C. Fabry, "On the application of interference phenomena to the solution of various problems of spectroscopy and metrology," *Astrophysical Journal* **9**, 87–115 (1899).
4. C. L. Mueller, M. A. Arain, G. Ciani, R. T. DeRosa, A. Effler, D. Feldbaum, V. V. Frolov, P. Fulda, J. Gleason, M. Heintze, K. Kawabe, E. J. King, K. Kokeyama, W. Z. Korth, R. M. Martin, A. Mullavey, J. Peold, V. Quetschke, D. H. Reitze, D. B. Tanner, C. Vorvick, L. F. Williams, and G. Mueller, "The advanced LIGO input optics," *Review of Scientific Instruments* **87** (2016).
5. J. Alnis, A. Mateev, N. Kolachevsky, T. Udem, and T. Hänsch, "Subhertz linewidth diode lasers by stabilization to vibrationally and thermally compensated ultralow-expansion glass Fabry-Pérot cavities," *Physical Review A* **77**, 053809 (2008).
6. A. Ludlow, X. Huang, M. Notcutt, T. Zanon-Willette, S. Foreman, M. Boyd, S. Blatt, and J. Ye, "Compact, thermal-noise-limited optical cavity for diode laser stabilization at 1×10^{-15} ," *Optics Letters* **32**, 641–643 (2007).
7. J. Zhang, L. Yingxin, B. Ouyang, K. Deng, Z. Lu, and J. Luo, "Design of an optical reference cavity with low thermal noise limit and flexible

- thermal expansion properties," *European Physical Journal D* **67**, 46 (2013).
8. L. Wu, Y. Jiang, C. Ma, W. Qi, H. Yu, Z. Bi, and L. Ma, "0.26-Hz-linewidth ultrastable lasers at 1557 nm," *Scientific Reports* **6**, 24969 (2016).
 9. C. A. Brackett, "Dense wavelength division multiplexing networks: Principles and applications," *IEEE Journal on Selected Areas in Communications* **8**, 948–964 (1990).
 10. M. Fox, *Quantum Optics* (Oxford University Press, 2006), 1st ed.
 11. S. Haroche, "Nobel lecture: Controlling photons in a box and exploring the quantum to classical boundary," *Reviews of Modern Physics* **85**, 1083–1102 (2013).
 12. A. White, "Frequency stabilization of gas lasers," *IEEE Journal of Quantum Electronics* **1**, 349–357 (1965).
 13. R. Barger, M. Sorem, and J. Hall, "Frequency stabilization of a cw dye laser," *Applied Physics Letters* **22**, 573–575 (1973).
 14. R. Drever, J. Hall, F. Kowalski, J. Hough, G. Ford, A. Munley, and H. Ward, "Laser phase and frequency stabilization using an optical resonator," *Applied Physics B* **31**, 97–105 (1983).
 15. B. Dahmani, L. Hollberg, and R. Drullinger, "Frequency stabilization of semiconductor lasers by resonant optical feedback," *Optics Letters* **12**, 876–878 (1987).
 16. Y. Yamamoto, O. Nilsson, and S. Saito, "Theory of a negative frequency feedback semiconductor laser," *IEEE Journal of Quantum Electronics* **21**, 1919–1928 (1985).
 17. M. Ohtsu and S. Kotajima, "Linewidth reduction of a semiconductor laser by electrical feedback," *IEEE Journal of Quantum Electronics* **21**, 1905–1912 (1985).
 18. G. Bjorklund, M. Levenson, W. Lenth, and C. Ortiz, "Frequency modulation (FM) spectroscopy," *Applied Physics B* **32**, 145–152 (1983).
 19. E. D. Black, "An introduction to Pound–Drever–Hall laser frequency stabilization," *American Journal of Physics* **69**, 79–87 (2001).
 20. T. F. Gallagher, *Rydberg atoms* (Cambridge University Press, 1994).
 21. J. Balewski, A. Krupp, A. Gaj, S. Hofferbeth, R. Löw, and T. Pfau, "Rydberg dressing: understanding of collective many-body effects and implications for experiments," *New Journal of Physics* **16**, 063012 (2013).
 22. J. Johnson and S. Rolston, "Interactions between Rydberg-dressed atoms," *Physical Review A* **82**, 033412 (2010).
 23. D. A. Steck, "Rubidium 87 D line data," (2008). Available online at <http://steck.us/alkalidata>.
 24. R. Abel, A. Mohapatra, M. Bason, J. Pritchard, K. Weatherill, and U. Raitzsch, "Laser frequency stabilization to excited state transitions using electromagnetically induced transparency in a cascade system," *Applied Physics Letters* **94**, 071107 (2009).
 25. J. Thorpe, K. Numata, and J. Livas, "Laser frequency stabilization and control through offset sideband locking to optical cavities," *Optics Express* **16**, 15980–15990 (2008).
 26. J. Naber, J. Vos, R. Rengelink, R. Nusselder, and D. Davtyan, "Optical techniques for Rydberg physics in lattice geometries," *The European Physical Journal Special Topics* **225**, 2785–2816 (2017).
 27. Stable Laser Systems, "Vacuum Housing 6010/6020," (2015). Available online at http://www.stablelasers.com/spec-sheets/6010_20_R1.pdf.
 28. R. Löw, H. Weimer, J. Nipper, J. B. Balewski, B. Butscher, H. P. Büchler, and T. Pfau, "An experimental and theoretical guide to strongly interacting Rydberg gases," *Journal of Physics B: Atomic, Molecular and Optical Physics* **45**, 113001 (2012).
 29. S. Stellmer, "Degenerate quantum gases of strontium," Ph.D. thesis, University of Innsbruck (2013). Available online at http://www.ultracold.at/theses/thesis_simon_stellmer/thesis_simon_stellmer.pdf.
 30. D. Boddy, "First observations of rydberg blockade in a frozen gas of divalent atoms," Ph.D. thesis, Durham University (2014). Available online at <http://etheses.dur.ac.uk/10740/>.
 31. W. Zhang, M. Martin, C. Benko, J. Hall, J. Ye, C. Hagemann, T. Legero, U. Sterr, F. Riehle, G. Cole, and M. Aspelmeyer, "Reduction of residual amplitude modulation to 1×10^{-6} for frequency modulation and laser stabilization," *Optics Letters* **39**, 1980–1983 (2014).
 32. Corning Incorporated, "ULE® Corning Code 7972," (2006). Available online at <http://www.corning.com/media/worldwide/csm/documents/7972%20ULE%20Product%20Information%20Jan%202016.pdf>.
 33. Schott AG, "ZERODUR® zero expansion glass ceramic," (2011). Available online at http://www.schott.com/advanced_optics/english/download/schott_zerodur_katalog_july_2011_en.pdf.
 34. C. E. Powers, *Outgassing Data for Selected Spacecraft Materials*, NASA (2014). Available online at <http://outgassing.nasa.gov/>.
 35. Morgan Advanced Materials, "Superwool® blanket datasheet," (2016). Available online at http://www.morganthermalceramics.com/media/1814/sw_blanket_data_sheet_english_1.pdf.
 36. Wavelength Electronics, "Datasheet and operating guide PTCxK-CH series," (2013). Available online at <http://www.teamwavelength.com/downloads/datasheets/ptcxk-ch.pdf>.
 37. W. M. Haynes, ed., *CRC Handbook of Chemistry and Physics* (CRC Press, 2014), 95th ed.
 38. T. Okoshi, K. Kikuchi, and A. Nakayama, "Novel method for high resolution measurement of laser output spectrum," *Electronics Letters* **16**, 630–631 (1980).
 39. B. Rengelink, "Laserlocking to an external reference cavity and EIT spectroscopy of ^{87}Rb Rydberg states in a room temperature vapour cell," Master's thesis, Universiteit van Amsterdam (2013).
 40. S. Bennetts, G. D. McDonald, K. S. Hardmann, J. E. Debs, C. C. Kuhn, J. D. Close, and N. P. Robins, "External cavity diode lasers with 5kHz linewidth and 200nm tuning range at $1.55\mu\text{m}$ and methods for linewidth measurement," *Optics Express* **22**, 10642–10654 (2014).
 41. M. van Exter, S. Kuppens, and J. Woerdman, "Excess phase noise in self-heterodyne detection," *IEEE Journal of Quantum Electronics* **28**, 580–584 (1992).
 42. P. Horak and W. H. Loh, "On the delayed self-heterodyne interferometric technique for determining the linewidth of fiber lasers," *Optics Express* **14**, 3923–3928 (2006).
 43. Toptica Photonics AG, "Scientific lasers: Quantum optics & spectroscopy," (2016). Available online at http://www.toptica.com/fileadmin/Editors_English/11_brochures_datasheets/toptica_BR_Scientific_Lasers.pdf.
 44. Y. Zhao, J. Zhang, J. Stuhler, G. Schuricht, F. Lison, Z. Lu, and L. Wang, "Sub-Hertz frequency stabilization of a commercial diode laser," *Optics Communications* **283**, 4696–4700 (2010).
 45. G. Wertheim, M. Butler, K. West, and D. Buchanan, "Determination of the Gaussian and Lorentzian content of experimental line shapes," *Review of Scientific Instruments* **45**, 1369–1371 (1974).
 46. Y. Liu, J. Lin, G. Huang, Y. Guo, and C. Duan, "Simple empirical analytical approximation to the Voigt profile," *Journal of the Optical Society of America B* **18**, 666–672 (2001).
 47. J. Olivero and R. Longbothum, "Empirical fits to the Voigt line width: A brief review," *Journal of Quantitative Spectroscopy and Radiative Transfer* **17**, 233–236 (1977).
 48. N. Cisternas, J. de Hond, G. Lochead, R. Spreeuw, H. van Linden van den Heuvell, and N. van Druuten, "Characterizing the vectorial electric field on an atom chip using Rydberg state spectroscopy," Manuscript in preparation .