

Prepared for submission to JINST

# THGEM gain calculations using Garfield: Solving discrepancies between the simulation and experimental data

---

**C.D.R. Azevedo,<sup>1</sup> P.M. Correia, L.F.N.D. Carramate A.L.M. Silva, and J.F.C.A. Veloso**

I3N - Physics Department, University of Aveiro  
Campus Universitário de Santiago 3810-193 Aveiro, Portugal

E-mail: [cdazevedo@ua.pt](mailto:cdazevedo@ua.pt)

Abstract:

Discrepancies between the measured and simulated gain in Thick Micropatterned gaseous detectors (MPGD), namely THGEM, have been observed by several groups. In order to simulate the gas gain avalanche the community relies in the calculations performed in Garfield++ that was known to produce differences of 2 orders of magnitude relatively to the experimental data for thick MPGDs.

In this work, simulations performed for Ne/5%CH<sub>4</sub>, Ar/5%CH<sub>4</sub> and Ar/30%CO<sub>2</sub> mixtures shown that Garfield++ is able to perfectly describe the experimental data if Penning effect is included in the simulation. The comparison between the number of excitations, which may lead to a Penning transfer, in THGEM and GEM is also shown, explaining the less pronounced gain discrepancies observed in GEM.

Keywords: Micropattern gaseous detectors (MSGC, GEM, THGEM, RETHGEM, MHSP, MICROPIC, MICROMEGAS, InGrid, etc); Electron multipliers (gas); Charge transport and multiplication in gas; Ionization and excitation processes; Detector modelling and simulations II (electric fields, charge transport, multiplication and induction, pulse formation, electron emission, etc)

---

<sup>1</sup>Corresponding author.

---

## Contents

1	Introduction	1
2	Method	2
3	Results and discussion	2
4	Conclusions	4

---

## 1 Introduction

The main software tool used for the gas gain simulation in Micropatterned Gaseous Detectors (MPGDs) is Garfield++ [1], a powerful toolkit for the detailed simulation of gaseous detectors and the physical processes occurring on it. It uses Monte Carlo microscopic technique to track electrons in gases at molecular level retrieving information about each excited atom: the (x,y,z) position, the time of production and the excitation level [2]. So far, the main drawback of using Garfield++ for gain simulations in Thick Gas Electron Multiplier (THGEM) [3] was the lower gain values obtained when compared with the experimental data, reaching up to 2 orders of magnitude less for measured gains of about  $10^5$  (see Figure 1). Such discrepancies were generally pointed to be related with the electric field calculation by the finite-elements software or the charging-up of the insulator foils. However, recent results in simulations [4, 5] and experimental data [6] of charging-up in GEM and THGEM shown that the gain variation due to the insulator charging-up is in the order of a few tens of %, not explaining the 2 orders of magnitude difference. In this work and due to the long calculation time and complexity, charging-up effects were not considered.

One of the input parameters allowed by Garfield++ is the Penning fractions for the gas mixtures, an option which is not often used by users since the data in Penning fractions is sparse and not reliable. The Penning effect occurs in gas mixtures when the energy of an excited atom is higher than the ionization potential of the admixture gas (quencher). If a collision between them occurs, energy transfers are possible resulting in an extra electron [7]. Recently, very detailed and exhaustive studies have been carried out in Penning transfer namely in Argon and Neon mixtures [7–9].

Our hypothesis is that the Garfield++ gains deficit is due to the not inclusion of Penning effect in the calculations performed by the users. In this work we will evaluate the Garfield++'s performance in the thick MPGDs gain calculations by including/excluding the Penning effect and comparing them to experimental data.

## 2 Method

In this work a 0.4 mm thickness ( $t$ ) THGEM was simulated. The hole diameter ( $d$ ) was set to 3 mm with a 0.1 mm rim ( $r$ ) and a 0.7 mm pitch ( $p$ ) being the unitary cell shown in Figure 1. The Garfield++'s input electric fields were calculated by using Gmsh [10, 11] and Elmer [12], both open-source finite elements electrostatics calculation software.

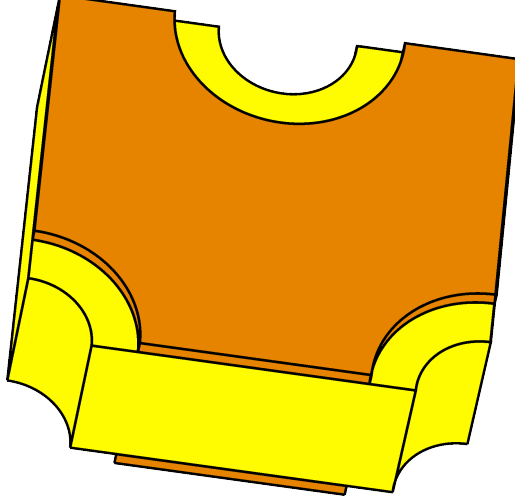

Figure 1. Unitary cell used for the THGEM gain calculations.  $t = 0.4$  mm,  $p = 0.7$  mm,  $d = 0.3$  mm,  $r = 0.1$  mm.

Calculations in Ne/5%CH<sub>4</sub>, Ar/5%CH<sub>4</sub> and Ar/30%CO<sub>2</sub> were performed with and without the inclusion of Penning transfers. Every time the Penning transfers were considered, its rates were set to  $\alpha = 0.4$ ,  $\alpha = 0.18$  [8] and  $\alpha = 0.57$  [7] respectively to the above listed mixtures.

Also, two others MPGD were simulated: the Thick WELL (THWELL) [13, 14] (thickness = 0.4 mm, hole diameter = 0.5 mm, rim = 0.1 mm and pitch = 1.0 mm) in Ne/5%CH<sub>4</sub> and a regular GEM (thickness = 0.05 mm, biconical hole diameter = 0.07/0.05 mm, rim = 0.08 mm and pitch = 0.140 mm) in Ar/30%CO<sub>2</sub>. In this case, the Garfield++'s input electric fields were calculated by Ansys[15].

For all the cases, the drift and induction regions were set to 5 mm and 2 mm, with electric fields set to 500 V/cm and 2000 V/cm, respectively.

Gas pressure and temperature were considered to be at 760 Torr and 20 °C. For each condition 1000 events were calculated. The gain was assumed to be the average number of electrons produced in the gas per drift electron, i.e., the absolute gain.

## 3 Results and discussion

Figure 2(a) shows the results of Garfield++'s gain calculations for a 0.4 mm THGEM operating in Ne/5%CH<sub>4</sub> and Ar/5%CH<sub>4</sub> and Ar/30%CO<sub>2</sub> when the Penning transfers are not considered. For comparison, experimental data for the same THGEM geometry is also shown.

The previous described effect, i.e., the lower calculated gain relative to the experimental data is clearly observed. The discrepancies increase with the gain, reaching 2 orders of magnitude when the experimental gains approach  $10^5$ .

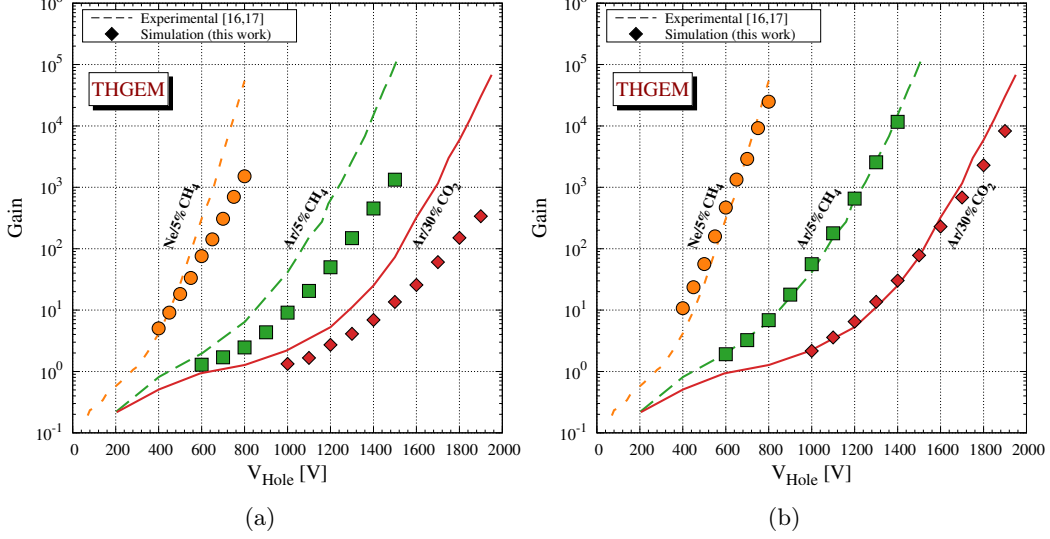

Figure 2. THGEM gain for Ne and Ar based mixtures with  $\text{CH}_4$  and  $\text{CO}_2$ . Lines are experimental data adapted from [16, 17] while dots are the simulated data. (a) Penning transfers not considered. (b) Penning transfers considered.

Calculations for the same gas mixtures were also performed considering Penning transfers. For  $\text{Ar}/5\%\text{CH}_4$  a transfer rate  $\alpha = 0.18$  taken from [8] was used while for  $\text{Ar}/30\%\text{CO}_2$  a value of  $\alpha = 0.57$  was set [7]. The value used for  $\text{Ne}/5\%\text{CH}_4$  is empirical due to the lack of data and was chosen by performing preliminary tests. The results are plotted in Figure 2(b).

Comparing the data of Figure 2(a) with that of Figure 2(b) we can observe an effective improvement between the agreement of experimental and simulated data. For  $\text{Ne}/5\%\text{CH}_4$  and  $\text{Ar}/5\%\text{CH}_4$  cases we can observe a perfect match showing that Garfield++ is able to fully describe the THGEM gain in such mixtures. For  $\text{Ar}/30\%\text{CO}_2$  the mixture is well described until the gain reaches 500. After that value the simulation results slightly diverges from the experimental data presenting a deviation by a factor of 2 when the gain reaches  $2 \times 10^4$ . Such difference is explained in [7] as being due to photon feedback (electrons extracted from the cathode or  $\text{CO}_2$  ionization by the scintillation photons) which was not included in the simulation.

In order to confirm if the gain dependence is not caused also by the choice of finite element software or by the chosen multiplier it was decided to make the same calculations for a THWELL multiplier by using Ansys software. The results are presented in Figure 3 for a  $\text{Ne}/5\%\text{CH}_4$  mixture with and without considering Penning transfers. The difference between the experimental and calculated data when no Penning transfers are considered is clearly observed. However, when a Penning transfer rate of  $\alpha = 0.4$  is included the experimental data is well described by the simulation, showing that Garfield++ is able to

perform gain calculations in thick multipliers describing the experimental results.

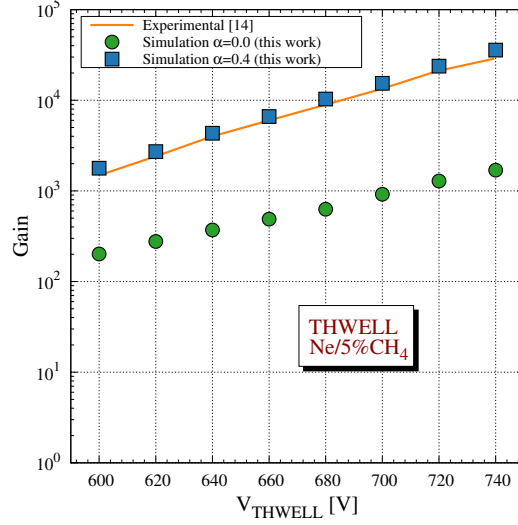

Figure 3. THWELL gain in Ne/5%CH<sub>4</sub>. Line is experimental data adapted from [14]. Dots are the simulated data.

Figure 4(a) shows Garfield++ gain calculations for GEM and THGEM in a mixture of Ar/30%CO<sub>2</sub>, excluding (closed dots) and including the Penning transfers (open dots). As can be observed, in GEMs the Penning effect in the gain discrepancies are less pronounced. In order to understand this effect we have to look to Garfield++ results keeping in mind that the extra ionization in the gas comes from the excited Argon atoms that transfer the energy to CO<sub>2</sub> ionizing it. The result is shown in Figure 4(b) where we have observed a higher number of excitations in THGEM than in GEM. It means that the number of excitations relatively to the ionizations is much higher in THGEM than in GEM resulting in a higher difference in gain calculations when Penning transfers are not considered.

## 4 Conclusions

Experimental gain measurements in THGEM and THWELL were successfully described by using Garfield++, when considering the Penning transfer rates in the simulation. There was not observed significant differences in the results by using different finite elements software in the electric fields calculation, excluding this cause for the mismatch between experimental and simulated data.

A Penning transfer rate of  $\alpha = 0.4$  was estimated for a Ne/5%CH<sub>4</sub>, although, for this case a more detailed studied should be performed.

We have also observed a stronger effect of the Penning transfers in THGEM than in GEM. This fact is due to the higher ratio of excitations over ionizations in THGEM than in GEM. However for correct assessemnt of the MPGD gains, penning tranfere rates shold always be considered.

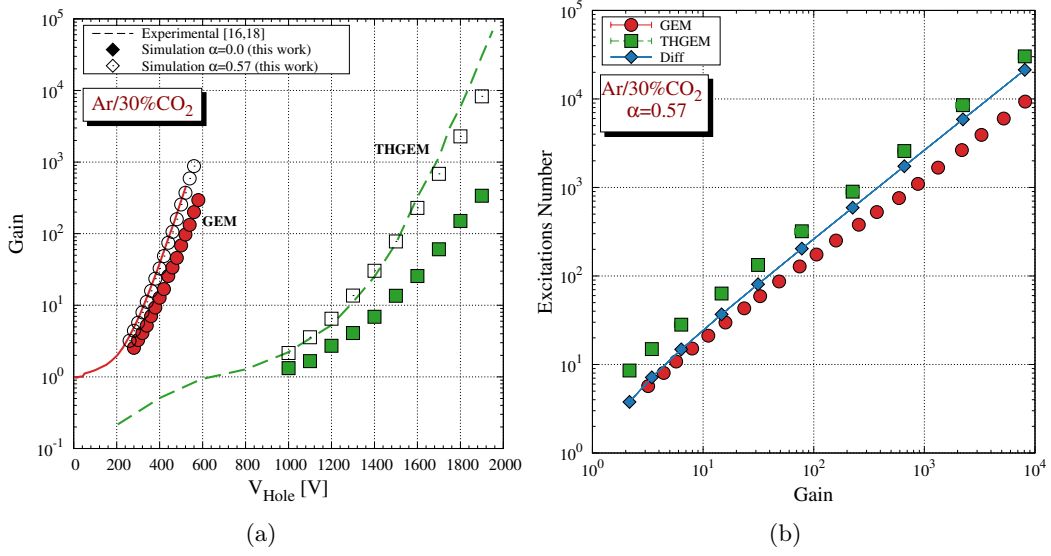

Figure 4. (a) GEM and THGEM gain calculations in Ar/30%CO<sub>2</sub> by including and excluding Penning transfers in the simulation - Lines are experimental data adapted from [16, 18]. (b) Number of excitation in GEM and THGEM for the previous mixture. The solid line is the difference on the number of excitations between THGEM and GEM.

## Acknowledgments

C.D.R. Azevedo and A.L.M. Silva were supported by Postdoctoral grants from FCT (Lisbon) SFRH/BPD/79163/2011 and SFRH/BPD/109744/2015, respectively. P.M.M. Correia was supported by the FCT (Lisbon) scholarships BD/52330/2013.

This work was partially support by project PTDC/FIS-NUC/2525/2014 through COMPETE, FEDER and FCT (Lisbon) programs and pursued within the framework of the CERN RD51 collaboration.

## References

- [1] R. Veenhof, Garfield++. <http://garfieldpp.web.cern.ch/garfieldpp/>, Last Access: 15-06-2016.
- [2] C.A.B. Oliveira et al., A simulation toolkit for electroluminescence assessment in rare event experiments, PLB 703 (2011) 217.
- [3] R. Chechik et al., Thick GEM-like hole multipliers: properties and possible applications, NIMA 535 (2004) 303.
- [4] P.M.M. Correia et al., A dynamic method for charging-up calculations: the case of GEM, JINST 9 (2014) P07025.
- [5] M. Alfonsi et al., Simulation of the dielectric charging-up effect in a GEM detector, NIMA 671 (2012) 6.
- [6] M. Alexeev et al., The gain in Thick GEM multipliers and its time-evolution, JINST 10 (2015) P03026.

- [7] Ö. Şahin et al., High-precision gas gain and energy transfer measurements in Ar-CO<sub>2</sub> mixtures, NIMA 768 (2014) 104.
- [8] Ö. Şahin et al., Penning transfer in argon-based gas mixtures, JINST 5 (2010) P05002.
- [9] Ö. Şahin et al., Systematic gas gain measurements and Penning energy transfer rates in Ne-CO<sub>2</sub> mixtures, JINST 11 (2016) P01003.
- [10] C. Geuzaine and J. Remacle, Gmsh. <http://gmsh.info/>, Last Access: 15-06-2016.
- [11] C. Geuzaine and J. Remacle, Gmsh: A 3-D finite element mesh generator with built-in pre- and post-processing facilities, IJNME 79 (2009) 1309.
- [12] Elmer. <https://www.csc.fi/web/elmer/elmer>, Last Access: 15-06-2016.
- [13] L. Arazi et al., THGEM-based detectors for sampling elements in DHCAL: laboratory and beam evaluation, JINTS 7 (2012) C05011.
- [14] L. Arazi et al., Laboratory studies of THGEM-based WELL structures with resistive anode, JINST 9 (2014) P04011.
- [15] ANSYS - Simulation Driven Product Development. <http://www.ansys.com/>, Last Access: 15-06-2016.
- [16] C. Shalem et al., Advances in Thick GEM-like gaseous electron multipliers - Part I: atmospheric pressure operation, NIMA 558 (2006) 475.
- [17] C.D.R. Azevedo et al., Towards THGEM UV photon detectors for RICH on single photon detection efficiency in Ne/CH<sub>4</sub> and Ne/CF<sub>4</sub>, JINST 5 (2010) P01002.
- [18] G. Bencivenni et al., The micro-Resistive WELL detector: a compact spark-protected single amplification-stage MPGD, JINST 10 (2015) P02008.