

**Lagrangian Coherent Structures (LCS) may describe  
evolvable frontiers in natural populations**

**Bradly Alicea**

**Department of Animal Science, Michigan State University**

**[bradly.alicea@ieee.org](mailto:bradly.alicea@ieee.org)**

**Keywords: Lagrangian Coherent Structures, Evolutionary Systems**

### **Abstract**

The evolution of organismal populations is not typically thought of in terms of classical mechanics. However, many of the models used to approximate evolutionary trajectories have implicit parallels to dynamical physical systems. Therefore, it stands to reason that dynamical physical models can be adapted to model less explored aspects of evolutionary (biological) systems. In this paper, I will present the parallels between currently-used evolutionary models and a class of physical system known as a Hamiltonian. By comparing currently-used evolutionary modeling approaches with Hamiltonian systems, both of which use similar sets of underlying assumptions, it becomes clear that new approaches may be needed for approximating emergent phenomena. Using what is learned from this exercise, I will then introduce a new model for characterizing evolvability in living (biological) systems based on the Lagrangian Coherent Structures (LCS) approach. It is my contention that the limits of evolvability in a population can be treated in a way analogous to fronts, waves, and other aggregate formation in collective animal behavior. Ultimately, this application of the LCS approach may be able to provide insight into adaptation in a broad range of biological and social systems.

### **Introduction**

Evolutionary processes and their major features have commonalities with a diverse range of physical phenomena. Models of fitness or adaptation currently used in theoretical biology are similar to physical dynamical models known as Hamiltonian systems in terms of inspiration and major assumptions. In this paper, the limits of evolvability (see Alberch, 1991) for a given population will be treated as an emergent phenomenon that can be conceptualized in a manner similar to fronts, waves, and other aggregate formations observed in collective animal behavior (Escudero et.al, 2010). Idealized populations exhibit similar dynamics in genotype/phenotype spaces, and thus can be better conceptualized using a mathematical tool called Lagrangian Coherent Structures (LCS). The first section of this report will give a quick overview of how fitness landscapes and hypercubes are used to approximate the relationships between genotypes/phenotypes, fitness, and evolvability for evolving populations. An underlying theme of this section involves the implicit relationship between these models and Hamiltonian dynamics. In the second section, an alternative for modeling the limits of evolvability based on a LCS-inspired approach will be proposed. Basic measurements, features of the model, and

comparisons to Hamiltonian-like models will be discussed, along with a quick summary of future applications.

### **Fitness Landscapes, Hypercubes, and (Hamiltonian) Evolutionary Modeling**

Fitness landscapes have a rich history, but their connections to Hamiltonian systems have not always been appreciated. Biologists in the early 20<sup>th</sup> century such as Wright (1932) and Waddington (1952) used such landscapes as a purely qualitative tool. The theory of fitness landscapes has been advanced in recent times by people such as Kauffman (1993) and Gavrillets (2008). A more recent alternate approach is the hypercube (see Wagner, 2005), which normalizes the distance between discrete genotype/phenotype configurations. Formulations of fitness landscapes and hypercube models have relied heavily on population genetics and dealt with the relationship between genotype and phenotype in various ways. One of these is the characterization of many potential routes to fitness maxima (Kauffman, 1993). Placing a constraint on pathway number and diversity over time is how the limits of evolvability, or the collective capacity of individuals in a population to respond to environmental challenges (Wagner, 2005), is characterized in these evolutionary representations.

### **Evolutionary representations as Dynamical (Hamiltonian) Systems**

Fitness landscape and hypercube representations share two other properties with Hamiltonian systems: accessibility with respect to initial condition, and the optimization of outcomes over time (Kogenaru et.al, 2009; Tavares et.al, 2008). Hamiltonian particle populations evolve from an ergodic distribution, or a space where every portion of the space is equally probable, to a heterogeneous spatial configuration characterized by the minimization of energy (Meyer and Hall, 1992). Protein-folding simulations illustrate these parallels by providing an intermediary between fitness landscapes and purely physical Hamiltonian systems. In molecular dynamics, a certain amount of energy is required to enable the random movement of particles.

The resulting kinetic profile shows an optimal point in the distribution, one in which the greatest amount of free energy is conserved (Schlick, 2002). This profile can be extended to multiple dimensions, each of which has an optimum. While fitness landscapes in particular are organized around the idea of fitness optima, the energy function itself is shaped by changes in fitness. In this way, current evolutionary representations tend to emphasize optimal properties rather than boundary conditions (Alberch, 1991; Pigliucci, 2010). Given these shared properties of both fitness landscapes and Hamiltonian systems, a phenomenon such as the limits of evolvability may be hard to interpret.

### **Evolvability as Instance of Hamiltonian Optimization**

Accessibility with respect to initial condition also becomes important in the context of Hamiltonian graph theory to understand the limits of evolvability (Wagner, 2005). Hamiltonian graphs are a subset of optimization problems in which the shortest path between a series of connected points is desired. Hypercube structures have been applied to RNA phenotypes for purposes of visualizing the fewest number of steps required between one phenotypic state (e.g. 0,0,0) and another (e.g. 0,1,0). In this case, the data structure being used to represent the evolutionary system is a discrete topological space where the transition from one phenotypic state to another is based on minimizing the number of steps from the initial condition to optimal states. The limitation of this approach to optimal locations in the network provides further motivation for the development of a new model based on Lagrangian dynamics.

### **Lagrangian systems: an alternative model for evolutionary systems**

Lagrangian systems, while also based on classical mechanics, differ from Hamiltonian systems in two ways. The first involves evaluating the kinematic profile of a dynamic process while holding its kinetic properties constant. Representing evolutionary systems in this way does not require energy minimization, and allows for particles representing individuals to be

monitored in an evolutionary space. In Lagrangian systems, the path of a particle is inferred from observations of the initial condition, observations of discrete measurements, and a constant energy function that represents diffusion. The other difference is that higher-order movements can be represented in a manner that might reduce the computational complexity of a high-dimensional evolutionary space.

### **Variables and Topology for Lagrangian Evolution**

Using a Lagrangian approach requires us to reformulate how evolutionary dynamics are represented computationally. One change is that a multidimensional volume through which entities traverse during the process of evolution is used in lieu of a landscape. Instead of being concerned with the path an organism takes and whether it leads to higher fitness, the focus is now on trends that might lead to evolutionary change. There are two variables that matter in a hypothetical Lagrangian evolutionary system. The first of these is rate of change, which relates to how fast entities are evolving. The second of these is direction of change, which corresponds to the direction in which things are evolving and how many members of a population are headed in that direction. Both of these variables suggest that “movement” can be used as an effective metaphor for evolutionary dynamics. Using Lagrangian methods as the basis for an evolutionary model becomes more plausible. An emerging, second-order formulation of Lagrangian dynamics called Lagrangian Coherent Structures (LCS) might provide a suitable framework for investigating these properties.

### **Lagrangian Coherent Structures for Evolutionary Representation**

Lagrangian Coherent Structures (see Haller, 2007) have been applied to mechanical (Nawroth et.al, 2010) and ecological (Tew Kai et.al, 2009) problems in biology that explicitly involve movement. However, models based on Lagrangian dynamics allow us to examine some

of the more subtle features of evolutionary systems. I will now provide a rough sketch of what these representations might look like.

### **LCS and FTLEs as Applied to Evolvability**

There exists a wide range of ways in which FTLEs (and LCS techniques in general) can be applied to studying the limits of evolvability. Major features of evolvability's limits can be studied in two ways. A static approach involves models of morphological variants as Green, Rowley, and Smits (2010) did to study the interaction between hydrodynamics and caudal fin shape. The other way is to model the diffusion of particles representing an evolving population. In this case, contemporary work on disentangling particle trajectories (Thiffeault, 2010), understanding the effects of geometrical constraints on FTLEs (Thiffeault and Boozer, 2001), and advanced algorithmic solutions to real-time ridge tracking (Lipinski and Mohseni, 2010) offer much potential for solving difficult evolutionary problems.

### **LCS Model for Evolutionary Systems**

Our model begins with a population of evolutionary entities that diffuse across a three-dimensional volume at a fixed rate. A given evolutionary trajectory requires a fixed amount of energy, so that selection acts to perturb diffusion. In second-order Lagrangian systems, diffusion of particles in a liquid can be perturbed by a systematic force field. The most likely candidate for this force field in an evolutionary context is an advection-diffusion model, such as those currently applied to the study of morphogenesis (Dan et.al, 2005). Once an initial condition is assumed, an evolutionary trajectory will be defined by two factors: the constraints on this trajectory, and trajectory dynamics measured at discrete points in time.

The constraints on an evolutionary trajectory in a LCS-inspired evolutionary model can also be represented using physical analogues. One specific example is that of forces acting against a subset of potential trajectories, so that certain trajectories are preferred over others. These inertial

forces act as dynamic fields, constraining the evolutionary entity as it evolves. In a LCS-inspired model, this imposes a stochastic mechanism for evolutionary constraint.

The evolutionary trajectory of individual particles, each representing individuals in a population, can be measured at discrete points in time using an aggregate parameter. In this context, a formulation of the Lyapunov exponent called the finite-time Lyapunov exponent (FTLE) can be used with respect to evolutionary processes. In general, Lyapunov exponents ( $\gamma$ ) are used in biological dynamical systems to assess the trajectory of a system's state through phase space (Alexiou et.al, 2010). In this case of LCS-inspired representations, the FTLE may provide information about the length of a particular evolutionary trajectory.

#### **Structure/Function of the LCS-derived (evolvable volume) approach**

LCS-inspired evolutionary models can describe the frontiers of evolvability rather than fitness peaks *per se*. For example, Kauffman's *nk* landscape (Kauffman, 1993) approximates fitness differences for  $k$  genes across a population of  $n$  individuals. In cases where the corresponding landscape is exceedingly rugged, it can be hard to evolve new phenotypes, even if they require small changes to a single parameter. In the process, however, the question of evolvability tends to become an epiphenomenon. To demonstrate this, we will show how populations can be theoretically tracked in a way that parameterizes evolvability instead of approximating a route to maximum fitness.

In Figure 1, a five-step process shown in frames A-E demonstrates how the LCS-based evolvable volume representation operates. In frames A and B, we can see that force fields are used to represent environmental conditions. Each particle is a replicator that can die, survive, or double at every generation ( $g$ ). When particles double, the offspring diverge from the parent from the generation of replication. In frame C, diffusive processes drive particles throughout the

volume. These diffusive processes resemble neutral processes in evolution (Kimura, 1982), which may result in neutral processes dominating the LCS representation. This is to be expected, as the particles have no intrinsic genome. In frames D and E, the evolution of ridges and other structures become apparent. These are truly frontiers of evolvability in the sense that given neutral processes and a set of environmental challenges, the diffusion of particles along a set of trajectories acts to partition a finite subspace of the evolvable volume.

**Figure 1. Cartoon depicting evolvable volume over time.**

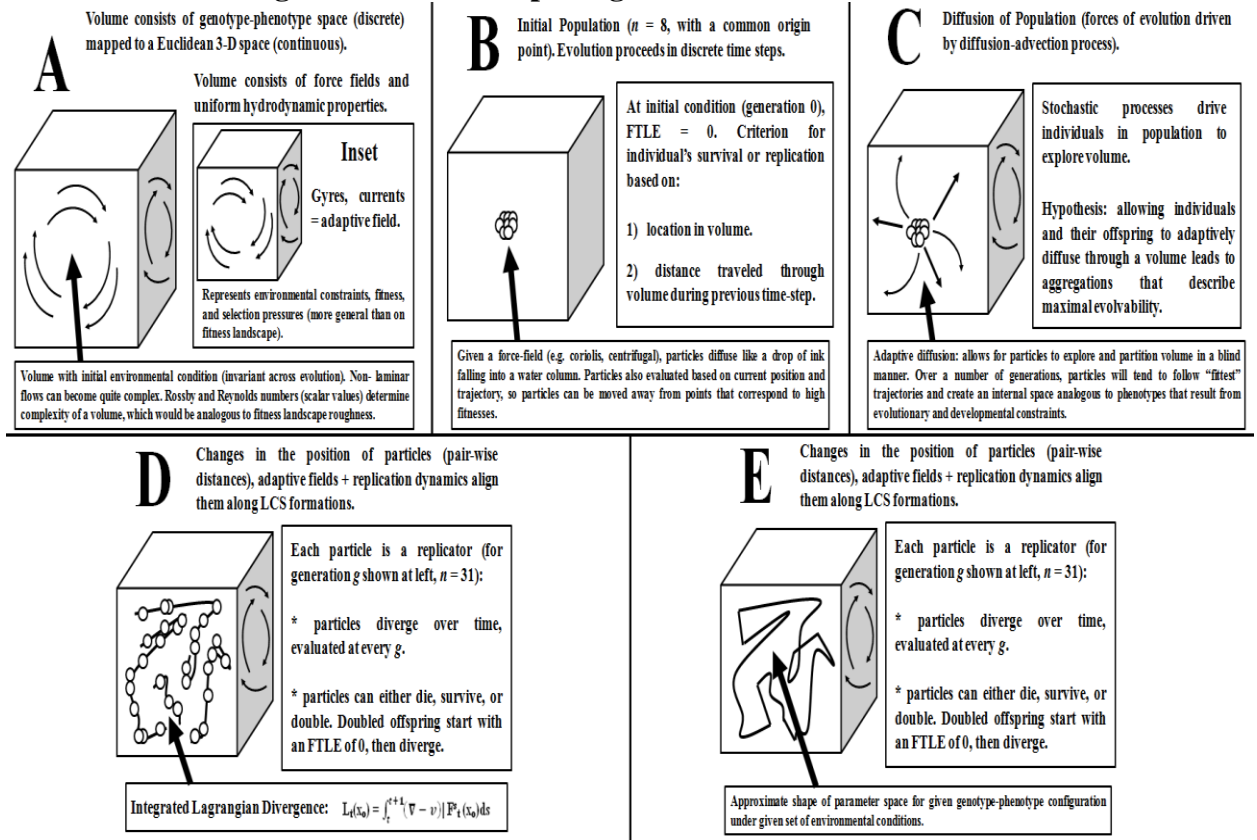

In Table 1, the distinction is made between fitness landscapes characterized by Hamiltonian-based models, and evolvable volumes characterized by our Lagrangian-based model. This can be done by comparing the  $x$  and  $y$  axis,  $z$  axis, and characteristics of population diffusion for each model. It is for this last property that the models truly diverge. While fitness landscape models emphasize topology with regard to maximizing fitness, evolvable volumes



emphasize the limits of particle diffusion in a given environment. In this context, individual particles explore the volume and provide a practical limit for evolution.

**Table 1. Comparison between major features of a fitness landscape (Hamiltonian approach) and an evolvable volume (LCS approach).**

	<b>Fitness Landscapes</b>	<b>Evolvable Volume</b>
<b><math>x</math> and <math>y</math> dimensions</b>	coordinates of reduced genotype/phenotype space	coordinates of reduced genotype/phenotype space
<b><math>z</math> dimension</b>	direct approximation of fitness (evaluation criterion).	indirect approximation of fitness (additional dimension of genotype/phenotype space).
<b>Population diffusion</b>	more fit members of population "climb" fitness peaks, cross valleys (unpopulated regions assumed to be inaccessible).	most evolvable embers of population form boundaries that correspond to the limits of evolvability (delimit inaccessible regions).

### Interpretation of LCS model

As conceptualized, the LCS model allows for a population to evolve over time and solutions to aggregate based on the constraints of a given context. As such, evolution over time can result in a dynamically interacting subspace that does not assess fitness *per se*, but does give a direct relationship between the effects of evolutionary processes and the evolvability of the population in the predetermined environment.

### Conclusion

Modeling methods that resemble a Hamiltonian, while useful, may be an incomplete description of evolutionary systems and processes. LCS-inspired models may complete the picture, particularly in terms of modeling evolvability and the role of neutral processes. Both Riedl (1978) and Schwenk (1995) have suggested that evolutionary constraints play a significant role in shaping natural variation. Therefore, the message of this paper is not to suggest that Hamiltonian-like methods be replaced, but rather that Lagrangian systems can be used for a different class of evolutionary problems. Applying an LCS-inspired approach to evolutionary

systems may open up new avenues of exploration, particularly in the study of evolutionary innovation, robustness, and cultural systems.

### References

- Alberch, P. (1991). From genes to phenotype: dynamical systems and evolvability. *Genetica*, 84, 5–11.
- Alexiou, T.S. and Payatakes, A.C. (2010). Theoretical modeling of fluid flow in cellular biological media: an overview. *Mathematical Biosciences*, 225(2), 83-93.
- Dan, D., Mueller, C., Chen, K., and Glazier, J.A. (2005). Solving the advection-diffusion equations in biological contexts using the cellular Potts model. *Physical Review E: Statistical, Nonlinear, and Soft Matter Physics*, 72(4 Pt 1), 041909.
- Escudero, C., Yates, C.A., Buhl, J., Couzin, I.D., Erban, R., Kevrekidis, I.G., and Maini, P.K. (2010). Ergodic directional switching in mobile insect groups. *Physical Review E*, 82, 011926.
- Gavrilets, S. (2004). *Fitness Landscapes and the Origin of Species*. Princeton University Press, Princeton, NJ.
- Green, M.A., Rowley, C.W., and Smits, A.J. (2010). Using Hyperbolic Lagrangian Coherent Structures to Investigate Vortices in Bioinspired Fluid Flows. *Chaos*, 20, 017510.
- Haller, G. (2007). Uncovering the Lagrangian Skeleton of Turbulence. *Physical Review Letters*, 98, 144502.
- Kauffman, S. (1993). *Origins of Order*. Oxford University Press, Oxford, UK.
- Kimura, M. (1982). *The Neutral Theory of Molecular Evolution*. Cambridge University Press, Cambridge, UK.
- Kogenaru, M., deVos, M.G., and Tans, S.J. (2009). Revealing evolutionary pathways by fitness landscape reconstruction. *Critical Reviews of Biochemistry and Molecular Biology*, 44(4), 169-174.
- Lipinski, D. and Mohseni, K. (2010). A ridge tracking algorithm and error estimate for efficient computation of Lagrangian coherent structures. *Chaos*, 20, 017504.
- Meyer, K.R. and Hall, G.R. (1992). *Introduction to the Theory of Hamiltonian Systems*. Springer-Verlag, New York.
- Nawroth, J.C., Feitl, K.E., Colin, S.P., Costello, J.H., and Dabiri, J.O. (2010). Phenotypic plasticity in juvenile jellyfish medusae facilitates effective animal-fluid interaction. *Biology Letters*, 6(3), 389-393.
- Pigliucci, M. (2010). Genotype–phenotype mapping and the end of the ‘genes as blueprint’ metaphor. *Philosophical Transactions of the Royal Society B*, 365, 557-566.
- Riedl, R. (1978). *Order in Living Organisms: a systems analysis of evolution*. Wiley, New York.
- Schlick, T. (2002). *Molecular Modeling and Simulation*. Springer-Verlag, New York.
- Schwenk, K. (1995). A utilitarian approach to evolutionary constraint. *Zoology*, 98, 251-262.
- Tavares, J. Pereira, F.B., and Costa, E. (2008). Multidimensional Knapsack Problem: A Fitness Landscape Analysis. *IEEE Transactions on Systems, Man, and Cybernetics, Part B: Cybernetics*, 38(3), 604-616.

Tew Kai, E., Rossi, V., Sudre, J., Weimerskirch, H., Lopez, C., Hernandez-Garcia, E., Marsac, F., and Garcon, V. (2009). Top marine predators track Lagrangian coherent structures. *Proceedings of the National Academy of Sciences USA*, 106(20), 8245–8250.

Thiffeault, J-L. (2010). Braids of entangled particle trajectories. *Chaos*, 20, 017516.

Thiffeault, J-L. and Boozer, A.H. (2001). Geometrical constraints on finite-time Lyapunov exponents in two and three dimensions. *Chaos*, 11(1), 16-28.

Wright S (1932). The roles of mutation, inbreeding, crossbreeding and selection in evolution. *Proceedings of the Sixth International Congress of Genetics*, 356–366.

Waddington, C.H. (1953). Genetic assimilation of an acquired character. *Evolution*, 7, 118-126.

Wagner, A. (2005). *Robustness and Evolvability in Living Systems*. Princeton University Press, Princeton, NJ.