

Text2CAD: Text to 3D CAD Generation via Technical Drawings

Mohsen Yavartanoo¹ Sangmin Hong² Reyhaneh Neshatavar¹ Kyoung Mu Lee^{1,2}

¹Dept. of ECE & ASRI, ²IPAI, Seoul National University, Seoul, Korea

{myavartanoo, mchiash2, reyhanehneshat, kyoungmu}@snu.ac.kr

Abstract

The generation of industrial Computer-Aided Design (CAD) models from user requests and specifications is crucial to enhancing efficiency in modern manufacturing. Traditional methods of CAD generation rely heavily on manual inputs and struggle with complex or non-standard designs, making them less suited for dynamic industrial needs. To overcome these challenges, we introduce Text2CAD, a novel framework that employs stable diffusion models tailored to automate the generation process and efficiently bridge the gap between user specifications in text and functional CAD models. This approach directly translates the user’s textual descriptions into detailed isometric images, which are then precisely converted into orthographic views, *e.g.*, top, front, and side, providing sufficient information to reconstruct 3D CAD models. This process not only streamlines the creation of CAD models from textual descriptions but also ensures that the resulting models uphold physical and dimensional consistency essential for practical engineering applications. Our experimental results show that Text2CAD effectively generates technical drawings that are accurately translated into high-quality 3D CAD models, showing substantial potential to revolutionize CAD automation in response to user demands.

Introduction

Industrial Computer-Aided Design (CAD) models are essential tools in modern manufacturing. They serve as detailed blueprints for a wide range of products, from simple tools to complex machinery. CAD software enables engineers and designers to create precise geometric representations of products, facilitating visualization, simulation, and manufacturing. Automating the generation of these models from conceptual descriptions not only enhances productivity and reduces time-to-market but also fosters innovation. This aligns with broader industry trends toward digital transformation and smart manufacturing.

Despite progress, automating the generation of CAD from user requests poses challenges (Kasik, Buxton, and Ferguson 2005). Traditional methods, often manual and time-consuming, struggle with complex designs and fail to handle the nuances required by modern specifications.

Recent advances in diffusion models have shown the potential to generate detailed images from textual prompts (Zhao et al. 2023; Chen et al. 2024; Ruiz et al. 2023;

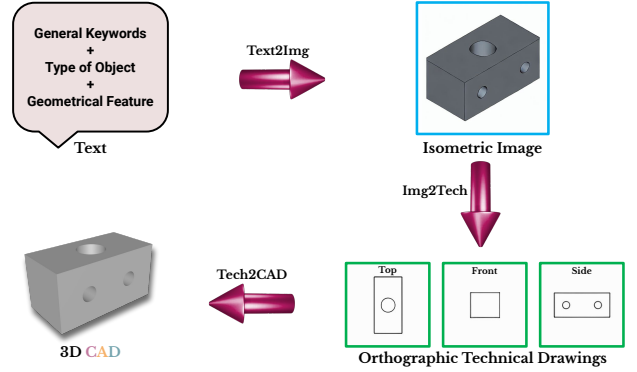

Figure 1: Overview of our method. Our method converts textual descriptions into a 3D CAD model through a multi-step process. First, the text is transformed into an isometric image representing the described features. This image is then mapped into orthographic technical drawings, which serve as the foundation for generating the 3D CAD model.

Chefer et al. 2023; Zhang, Rao, and Agrawala 2023). However, these models typically do not grasp three-dimensional constraints, leading to outputs that, while visually impressive, fall short in practical engineering applications. CAD models, on the other hand, can be effectively represented through technical drawings, which are 2D projections of the 3D model to orthographic views (Governi et al. 2013). Although diffusion models excel at generating these 2D images, they often do not maintain the necessary physical and dimensional consistency required for these drawings to be directly usable in manufacturing. This inconsistency is a significant limitation, as each drawing must accurately reflect the physical properties of the CAD model across multiple orthographic views to be useful in practical applications.

In response to these automation challenges, we develop Text2CAD, a framework that leverages isometric drawings and stable diffusion models to bridge the gap between textual descriptions and precise CAD models, as shown in Figure 1. Given a user’s textual description of a 3D object, our method starts by generating an isometric image that effectively captures the geometric features of the 3D object across various perspectives. Accordingly, a novel view generation diffusion model takes the isometric image as input

and transforms it into detailed orthographic views. This approach not only streamlines the CAD generation process, but also ensures the accuracy and consistency needed for practical manufacturing applications. By enabling the direct conversion of text descriptions into comprehensive technical drawings, Text2CAD significantly enhances the efficiency and accessibility of CAD model creation, aligning with the demands of modern industry.

To facilitate robust training and evaluation of our model, we introduce a new dataset comprising detailed descriptions and corresponding technical drawings of CAD models. This dataset serves as a foundation for training and benchmarking the Text2CAD framework. Our experimental results confirm that the Text2CAD framework reliably produces technical drawings that are accurately translated into practical 3D CAD models. This reveals the capability of our framework to bridge the gap between textual descriptions and functional engineering output, effectively streamlining the CAD model generation. Our main contributions are threefold:

- We introduce Text2CAD, a novel framework that uses stable diffusion models to automate the creation of CAD models from textual descriptions.
- Our method streamlines the process by generating a detailed isometric drawing and transforming it into consistent orthographic views, *e.g.*, top, front, and side.
- Experimental results demonstrate that Text2CAD reliably produces technical drawings that translate into high-quality 3D CAD models, effectively bridging the gap between textual prompts and practical engineering outputs.

Related work

In this section, we review prior studies pertinent to our method, divided into CAD generation and diffusion models. Each category is critical to understanding the advancements in our field and the niche that our research aims to fill.

CAD generation

Traditionally, CAD systems largely relied on manual drawing techniques, which required extensive user input and expertise (Tovey 1989; McLaren 2008; Ibrahim and Rahimian 2010; Amadori et al. 2012). These early systems were primarily vector-based drawing tools that facilitated the design of 2D and basic 3D models. As technology advanced, CAD software saw significant enhancements, evolving into more sophisticated platforms capable of detailed 3D modeling and simulation (Ibrahim and Rahimian 2010). These advancements transformed how professionals in engineering, architecture, and manufacturing approached the design process. With the advent of deep learning, the capability of CAD systems expanded further, leading to the exploration of automated algorithms for generating complex 3D models (Lee et al. 2022). Deep learning-based methods in CAD generation have effectively utilized diverse observations such as point clouds, voxels, and images to create corresponding 3D CAD models. These techniques have revolutionized the CAD design process, enabling automated and precise model generation from straightforward observations

of objects, whether through images or other 3D representations (Yu et al. 2022; Ren et al. 2022, 2021). However, despite these advancements, the challenge of simplifying the manufacturing process remains. To address this, our research aims to innovate further by enabling the generation of CAD models directly from text prompts provided by users. This would streamline the design-to-production pipeline and make CAD generation more accessible to non-experts.

Diffusion models

The concept of a diffusion process in data science is derived from the statistical mechanics principle (Schmittmann and Zia 1998), in which particles move from areas of higher concentration to lower concentration until equilibrium is reached. In machine learning, diffusion models (Cao et al. 2024) have been developed as a class of generative models that learn to reverse this process. These models start with a random noise distribution and gradually learn to subtract this noise to recreate data samples from the learned distribution. One of the groundbreaking advancements in this area is the development of Stable Diffusion (Rombach et al. 2022), a model that has made it feasible to generate detailed images from textual prompts. This capability stems from the model’s deep understanding of the data’s latent space, allowing it to generate highly detailed and specific images based on simple text descriptions. Applications of diffusion models have been particularly impressive in areas requiring high-fidelity visual outputs. In novel view generation, these models provide new perspectives of objects or scenes from minimal initial viewpoints (Liu et al. 2023), significantly enhancing virtual reality and 3D animation processes. Another vital application is 3D shape reconstruction, where diffusion models interpret various data inputs to recreate complex three-dimensional shapes, proving essential in automated design and manufacturing processes. Leveraging the generative capabilities of diffusion models, our research utilizes these models to create precise technical drawings from textual descriptions. By harnessing this technology, we aim to bridge the gap between text-based inputs and detailed 3D CAD models, making the process of generating CAD designs both more accessible and efficient.

Method

In this section, we present our method for generating CAD models from textual descriptions, as shown in Figure 2. We begin with an overview of CAD models and technical drawings and their role in engineering and manufacturing. Next, we describe the process of creating our dataset as a key step in generating 3D CAD models. We then discuss our model training approaches to improve drawing accuracy and consistency, followed by an explanation of the tools and techniques used to transform 2D drawings into 3D CAD models.

Technical drawings

A Computer-Aided Design (CAD) model is a digital representation used in engineering, architecture, and manufacturing for precise visualization and analysis. Created with CAD software, these models improve design accuracy and

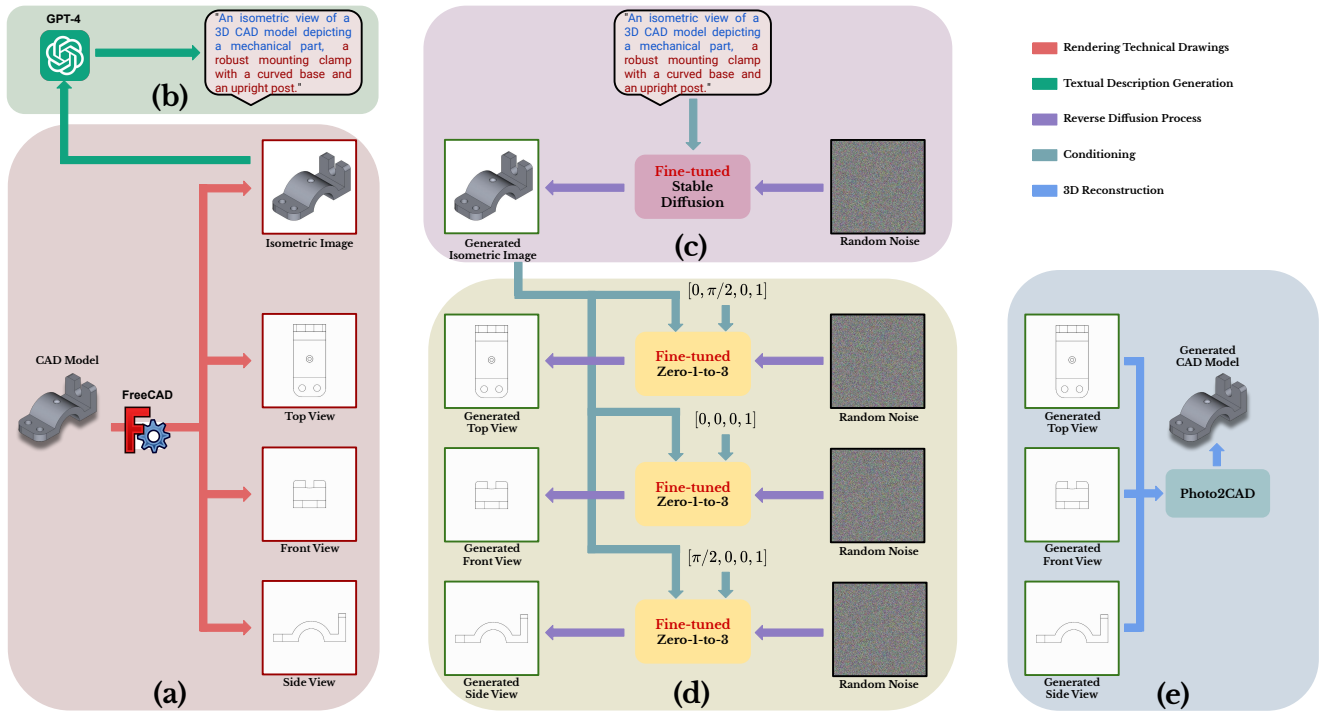

Figure 2: **Overall view of our Text2CAD framework.** The dataset creation process involves (a) generating technical drawings from a CAD model and (b) producing textual descriptions of the CAD model using GPT-4. The CAD generation process includes (c) generating isometric images based on the textual descriptions, (d) deriving orthographic technical drawings from the generated isometric images, and finally, (e) reconstructing the CAD model from the generated orthographic technical drawings.

production efficiency by detailing an object’s geometry and features in 3D formats or 2D technical drawings.

Technical drawings are crucial in engineering, as they specify component designs, dimensions, and manufacturing requirements. They follow standards like ANSI Y14.5 and ISO 8015 for precision, using orthogonal projections (ISO 128, ASME Y14.3) and universal symbols (ISO 1302) to ensure clarity and accuracy. CAD software such as AutoCAD, SolidWorks, CATIA, and FreeCAD integrates these standards to maintain consistency and facilitate effective communication in manufacturing.

Dataset

We detail our creation of a unique dataset consisting of technical drawings and corresponding textual descriptions for 3D CAD models. This comprehensive dataset is designed to support the development and testing of machine learning models, particularly in automating the generation and interpretation of CAD designs.

Rendering technical drawing We utilize FreeCAD to automate the rendering of both isometric images and orthographic technical drawings *e.g.*, front, top, and side, that are necessary for comprehensive technical documentation. The process begins with importing STEP files, which are standardized 3D model formats widely used in the industry. These models are scaled and manipulated to align with the standard drawing templates provided by the TechDraw

workbench in FreeCAD. Figure 3 shows the rendered isometric image and orthographic technical drawings samples.

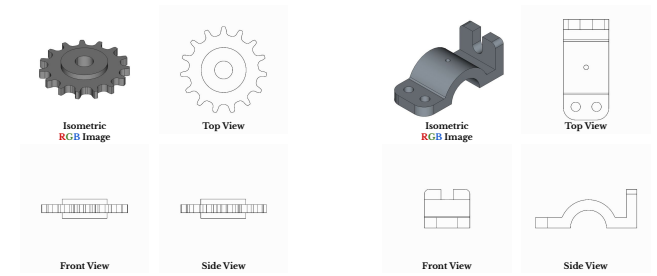

Figure 3: **Rendered technical drawings.** Isometric images and the orthographic technical drawings of the CAD models.

Textual description generation Accurate textual descriptions are crucial for effective text-to-CAD generation, yet manually labeling CAD models is difficult due to their complexity and specialized terminology. Each CAD model requires precise descriptions that capture its intricate details and functionality. To address this, we use GPT-4, an advanced language model adept at interpreting complex visuals and generating contextually relevant text, making it ideal for describing CAD models as shown in Figure 4. We develop a template to guide GPT-4 in generating descriptions

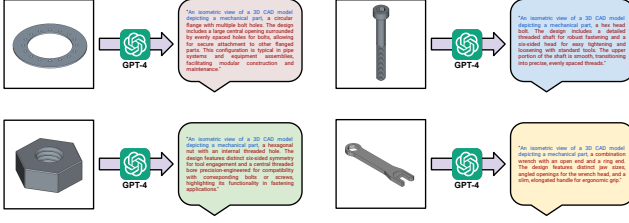

Figure 4: **Generated descriptions.** GPT-4 receives isometric images and provides descriptions within a template.

starting with "An isometric view of a 3D CAD model depicting a mechanical part," and including details on the object's type and key features. By inputting the isometric image into GPT-4, we ensure the descriptions align closely with the visual data. Using GPT-4, we efficiently produce detailed and accurate descriptions essential for our text-to-CAD applications, enhancing our dataset and improving the scalability and effectiveness of our CAD generation pipeline.

Text to isometric image

Stable diffusion models have shown notable proficiency in generating images from textual prompts, effectively producing technical drawings of industrial components as demonstrated in Figure 5. However, these models often struggle with maintaining physical consistency across multiple perspectives of the same object, leading to discrepancies and misalignments between different views *e.g.*, top, front, and side, which are critical for a holistic understanding and manufacturing of industrial components.

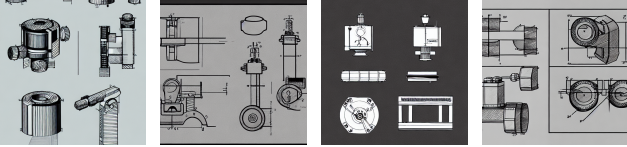

Figure 5: **Technical drawings by a stable diffusion model.** The images are generated by Stable Diffusion v1-5.

To address this limitation, we adopt an alternative approach by initially generating an isometric view from text prompts using diffusion models. This isometric view combines all three critical perspectives *e.g.*, top, front, and side, providing a comprehensive representation of the object. Such a view is highly useful in CAD modeling, effectively conveying intricate details of the object. This isometric image then serves as a precursor to generate orthographic images, laying a versatile and informative foundation for further technical illustration. Despite their effectiveness in generating contextually relevant images, as depicted in Figure 6, pre-trained diffusion models often lack the precision necessary to depict intricate details, precise edges, and surfaces needed for accurate orthographic drawings. Accordingly, we fine-tune a stable diffusion (Rombach et al. 2022) model to learn the process of generating rendered images I from an

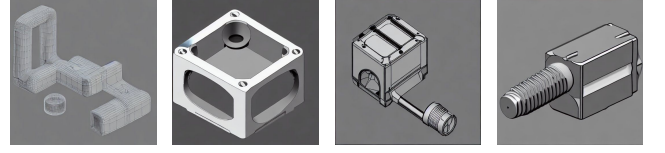

Figure 6: **Isometric image by a stable diffusion.** The images are generated by Stable Diffusion v1-5 given text prompt "An isometric view of a 3D CAD model depicting a mechanical part".

isometric view, given a generated text prompt P describing the target object by minimizing the following objective:

$$\mathcal{L}_{iso} = \min_{\theta_1} \mathbb{E}_{z \sim \mathcal{E}(I), t} \|\epsilon - \epsilon_{\theta_1}(z_t, t, c(P))\|_2^2, \quad (1)$$

where the parameters of the U-Net module ϵ_{θ_1} are trainable, while the text encoder c is considered with frozen parameters. After the model is fine-tuned, during the inference, we can generate images from the isometric view of CAD models by performing iterative denoising from a Gaussian noise image conditioned on text prompt P .

Isometric to orthographic technical drawings

After generating an isometric drawing using the fine-tuned stable diffusion model conditioned on a specified prompt, the subsequent step involves producing orthographic drawings essential for reconstructing a 3D CAD model. Utilizing the isometric drawing as a foundational representation, we facilitate the generation of technical drawings from various perspectives such as top, front, and side views. This method ensures geometric and physical consistency across views, providing accurate modeling and analysis.

Humans can intuitively convert an isometric image into corresponding orthographic technical drawings using their understanding of perspective and geometric principles. However, automating this process requires embedding a comparable level of understanding into a model. We achieve this by training the model on paired data consisting of isometric images and their corresponding orthographic technical drawings. Through this training, the model discerns geometric relationships between different views and projects the isometric representation onto the orthographic plane efficiently. Leveraging advanced machine learning techniques enables us to bridge the gap between human intuition and automated processing, enhancing the generation of accurate orthographic technical drawings from isometric images.

Diffusion models are particularly adept at tasks involving novel view generation and are capable of generating realistic and diverse images from specified input conditions. Our task centers around novel view generation conditioned by an isometric image, making diffusion models ideal for our purposes. We utilize zero-1-to-3 (Liu et al. 2023), a diffusion-based method tailored for novel view generation tasks. This method excels at generating novel view images given a single image as the condition, along with the relative camera pose, making it well-suited for our task of producing orthographic technical drawings from isometric views.

However, directly applying this method without fine-tuning might not fully meet our requirements, as it typically produces colored rendered images rather than the technical drawings needed for CAD. Therefore, we fine-tune this model on our generated dataset to adapt it for generating technical drawings, which have distinct characteristics from rendered images. During the fine-tuning process, we maintain the isometric images as the condition of the diffusion model, with the target being the orthographic technical drawings. The fine-tuning objective is defined as follows:

$$\mathcal{L}_{tech} = \min_{\theta_2} \mathbb{E}_{z \sim \mathcal{E}(I), t, \epsilon \sim \mathcal{N}(0,1)} \|\epsilon - \epsilon_{\theta_2}(z_t, t, c(I, R, T))\|_2^2, \quad (2)$$

where c is CLIP (Radford et al. 2021), encoding the input isometric image I concatenated with the camera pose parameters (R, T) . Once the model ϵ_{θ_2} is fine-tuned, we can generate the desired orthographic technical drawings given a single isometric image and the corresponding camera pose parameters (R, T) , ensuring that all generated views are consistent and accurately represent the same CAD object.

Orthographic technical drawings to 3D CAD

Orthographic technical drawings contain the essential information for reconstructing 3D CAD models, but extracting accurate paths from these images is challenging without an SVG representation. Accordingly, we use Photo2CAD (Harish and Prasad 2021), a straightforward, non-learnable tool built on OpenCV (Bradski, Kaehler et al. 2000). Despite its simplicity, it effectively extracts paths from orthographic images, enabling accurate CAD model reconstruction while preserving the integrity of the original designs.

Experiments

In this section, we outline our experimental setup, detailing the procedures for generating CAD models from textual prompts. We start by describing the dataset preparation for training our deep learning models. Then, we cover the technical aspects of our implementation, including the fine-tuned diffusion models and CAD reconstruction. We present experiments to test the effectiveness of our approach in producing accurate technical drawings and CAD models from text, followed by ablation studies to assess the robustness and performance of our method.

Implementation details

We employ the ABC dataset (Koch et al. 2019), a large-scale collection of one million CAD models including an extensive range of mechanical and industrial shapes, for our experiments. Focusing on single-component objects, we select a subset from the last chunk of the dataset, comprising 100,000 samples in ".step" format.

To render isometric images, the viewpoint is set at a 45-degree angle above the horizontal plane combined with a 45-degree rotation around the vertical axis. This perspective provides a clear and comprehensive view of the three-dimensional structure of the object without distortion.

In creating these technical drawings, a uniform scaling approach is used to ensure consistency across all objects.

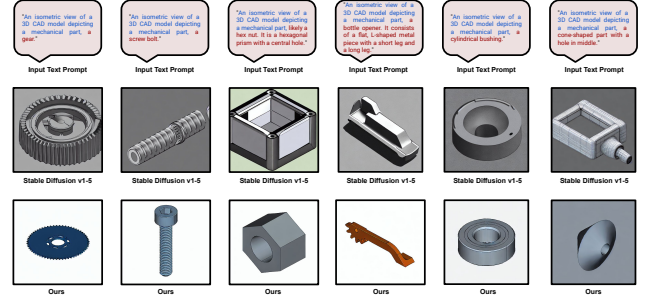

Figure 7: **Generated isometric view image given a text prompt.** The images are generated by the fine-tuned Stable Diffusion v1-5 (ours) and its original version.

Each object is scaled so that its longest edge measures precisely 2 units. This standardization facilitates easier comparison and comprehension, enhancing the understanding of the depicted elements. The technical drawings are initially formatted as ".svg" files, which represent vector paths and their attributes. However, directly using these files presents challenges, so they are rendered into images. All images are then cropped to a uniform size of 512×512 pixels. To generate textual descriptions, 1000 random samples were input into GPT-4, and their corresponding descriptions were collected.

We fine-tune the Stable Diffusion v1-5 on the labeled isometric images generated by GPT-4 for 50,000 training iterations. We use a batch size of 10 and a resolution of 512×512 , with a fixed learning rate of 1×10^{-5} . Additionally, we fine-tune the Zero-1-to-3 (Liu et al. 2023) model on the generated pairs of isometric images and their corresponding orthographic technical drawings, along with their relative camera poses. At each iteration, one of the top, front, or side technical drawings is randomly selected as the target image. This fine-tuning process is carried out for 10,000 training iterations, using a batch size of 32 and a resolution of 256×256 . We maintain a fixed learning rate of 1×10^{-5} . All fine-tuning processes are conducted on 4 Quadro RTX 8000 GPUs to accelerate training and computation. We will make the code and dataset publicly available upon the acceptance of the paper.

Text to isometric image

We qualitatively evaluate the fine-tuned Stable Diffusion model on our dataset compared to the pre-trained version using identical text prompts, as shown in Figure 7. By visually inspecting the generated isometric images, we assess improvements in quality, detail, and fidelity to the prompts achieved through fine-tuning.

We also demonstrate how the fine-tuned model accurately generates images with specified features, as detailed in Table 1. Generating 100 samples with and without the specified features, we found that the model significantly increases the presence of desired features when prompted. Figure 8 visually confirms this capability.

To quantitatively assess the fine-tuned model, we first have human evaluators rate the images based on their align-

Part	bevel gear	cylindrical flange	bracket	cylindrical pin	mounting plate
Feature 1	hexagonal bore	multiple holes	T-shaped	flanged head	rounded edges
✗	9%	0%	18%	0%	0%
✓	94%	100%	68%	90%	100%
Feature 2	angled teeth on a conical surface	a central hole	triangular	concentric through hole	central aperture
✗	8%	5%	0%	0%	0%
✓	100%	100%	100%	100%	50%

Table 1: **Quantitative effects of including features.** The values are obtained by counting the part samples having the specific feature among 100 generated samples of the corresponding part.

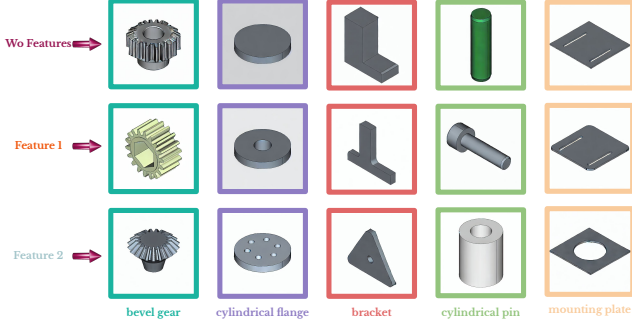

Figure 8: **Qualitative effects of including features.**

ment with the descriptions, as shown in Figure 9a. Given the difficulty of recruiting expert evaluators, we also use GPT-4 for comparison, as illustrated in Figure 9b. Figure 10a reveals a strong correlation between human and GPT-4 evaluations, validating GPT-4’s effectiveness in this role.

Furthermore, we task GPT-4 with generating textual descriptions for 100 randomly selected objects following a predefined template. Subsequently, the fine-tuned Stable Diffusion model creates four images per prompt. Then, GPT-4 assesses the alignment between the generated images and their text descriptions. As shown in Figure 10b, most images received perfect ratings, with an overall average of 8.375, demonstrating the robustness of our approach.

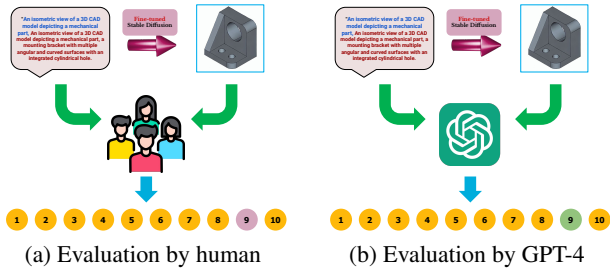

Figure 9: **Quantitative evaluation approaches.**

Isometric to orthographic technical drawings

We also visually evaluate the top, front, and side views of the technical drawings generated by the fine-tuned Zero-1-to-3 (Liu et al. 2023) model against their ground truths, as

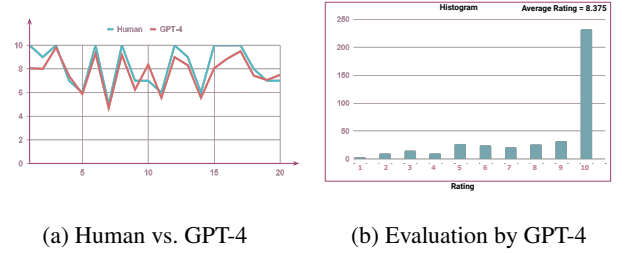

Figure 10: **Quantitative evaluations of isometric images.** The generated isometric images are evaluated by both human reviewers and GPT-4 for their accuracy in representing the given descriptions.

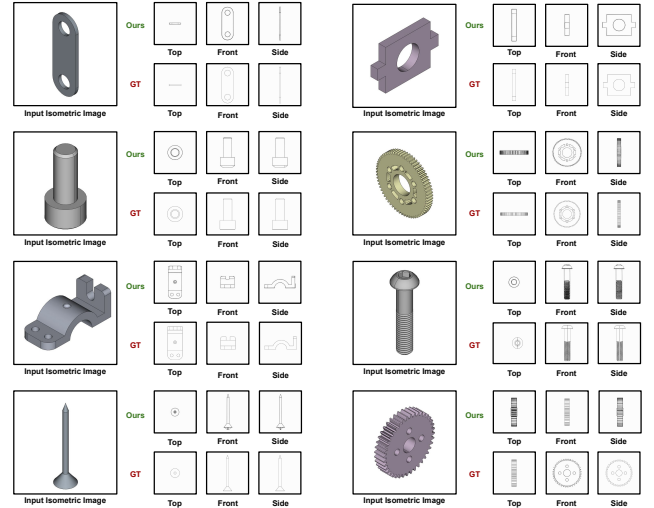

Figure 11: **Orthographic technical drawings generation.**

shown in Figure 11. The results indicate that the model generates drawings with satisfactory detail. To further assess accuracy, we measured the Chamfer distance (CD) between the generated orthographic images and the ground truths. Table 2 shows the average, standard deviation, maximum, and minimum CD. Although direct comparisons with other methods aren’t possible due to our approach’s pioneering nature, the low average CD suggests high accuracy.

View	Avg↓	STD↓	Max↓	Min↓
Top	3.185	6.069	44.457	0.070
Front	2.863	4.057	37.488	0.063
Side	2.510	3.790	29.657	0.100
Mean	2.853	4.639	37.200	0.078

Table 2: Chamfer distance of technical drawings.

Text to CAD

Figure 12 illustrates our entire pipeline, including the final generated CAD model and intermediate steps like isometric images and orthographic technical drawings. This visualization highlights the effectiveness of our method in converting textual descriptions into detailed CAD models, demonstrating its potential to streamline the CAD design process in real-world applications.

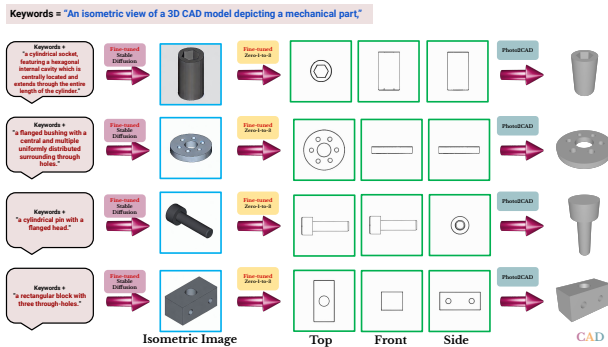

Figure 12: CAD generation from textual description.

Ablation study

In this section, we analyze our method through experiments and comparisons to assess the contributions of individual components to overall performance and effectiveness.

Diversity. We evaluate the diversity of generated results for specific general prompts in Figure 13. Our analysis reveals that despite fine-tuning the stable diffusion model on only a few samples from our dataset, it can generate a diverse set of images depicting various objects. This observation highlights the capability of our model to generalize to unseen data well and produce a wide range of outputs.

Figure 13: **Diversity of generated shapes.**

Figure 14: Effect of object orientation.

Orientation. In this study, we assess how object orientation affects the generation of orthographic technical drawings from isometric images. Although the isometric viewpoint is fixed, varying the object’s orientation impacts the resulting projections. We mirrored the isometric image to create different orientations and generated corresponding orthographic drawings for each. As shown in Figure 14, our method consistently maps isometric images to the correct projections, regardless of orientation, with the side view of the original aligning with the front view of the mirrored images. This demonstrates the robustness of our approach.

Keywords. As discussed in the dataset section, we consistently initiate all text prompts with the phrase “*An isometric view of a 3D CAD model depicting a mechanical part*” during the fine-tuning process. To evaluate the impact of these keywords on the generated results, we provide text prompts with and without these keywords and display the outcomes in Figure 15. The findings underscore the significance of including these keywords to accurately generate isometric images of CAD objects, which are crucial for the subsequent isometric to orthographic transformation phase.

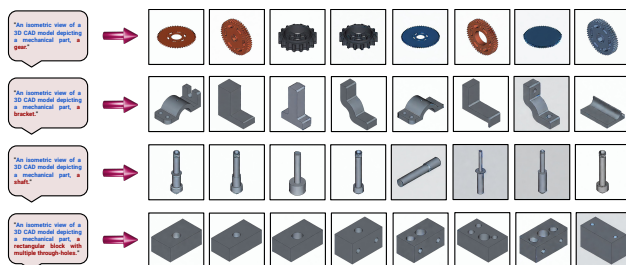
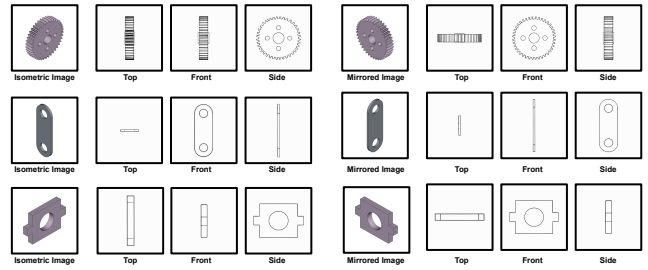
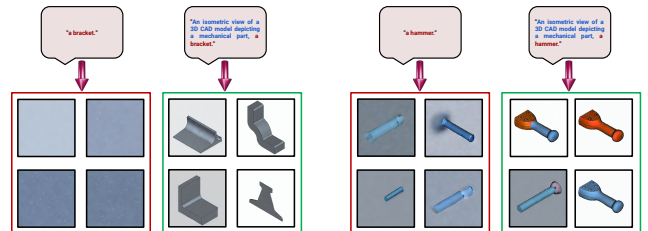

Figure 15: **Effect of keywords.**

Conclusion

In conclusion, our paper demonstrates an effective method for generating CAD models from text prompts. We first use a fine-tuned stable diffusion model to create detailed images from isometric views. Then, we fine-tune a novel view generation model to produce orthographic technical drawings, which are used to create the CAD models. Our experiments highlight the success of this approach in generating detailed CAD models from text. This advancement promises to accelerate design workflows, boost productivity, and enhance innovation in CAD modeling, making the design process more accessible and precise.

References

- Amadori, K.; Tarkian, M.; Ölvander, J.; and Krus, P. 2012. Flexible and robust CAD models for design automation. *Adv. Eng. Inform.*
- Bradski, G.; Kaehler, A.; et al. 2000. OpenCV. *Dr. Dobb's journal of software tools*.
- Cao, H.; Tan, C.; Gao, Z.; Xu, Y.; Chen, G.; Heng, P.-A.; and Li, S. Z. 2024. A survey on generative diffusion models. *IEEE Trans. Knowl. Data Eng.*
- Chefer, H.; Alaluf, Y.; Vinker, Y.; Wolf, L.; and Cohen-Or, D. 2023. Attend-and-excite: Attention-based semantic guidance for text-to-image diffusion models. *ACM Trans.*
- Chen, J.; Huang, Y.; Lv, T.; Cui, L.; Chen, Q.; and Wei, F. 2024. Textdiffuser: Diffusion models as text painters. *NeurIPS*.
- Governi, L.; Furferi, R.; Palai, M.; and Volpe, Y. 2013. 3D geometry reconstruction from orthographic views: A method based on 3D image processing and data fitting. *COMPUT IND.*
- Harish, A. B.; and Prasad, A. R. 2021. Photo2CAD: Automated 3D solid reconstruction from 2D drawings using OpenCV. *arXiv*.
- Ibrahim, R.; and Rahimian, F. P. 2010. Comparison of CAD and manual sketching tools for teaching architectural design. *Autom. Constr.*
- Kasik, D. J.; Buxton, W.; and Ferguson, D. R. 2005. Ten CAD challenges. *IEEE Comput. Graph. Appl.*
- Koch, S.; Matveev, A.; Jiang, Z.; Williams, F.; Artemov, A.; Burnaev, E.; Alexa, M.; Zorin, D.; and Panozzo, D. 2019. Abc: A big cad model dataset for geometric deep learning. In *CVPR*.
- Lee, H.; Lee, J.; Kim, H.; and Mun, D. 2022. Dataset and method for deep learning-based reconstruction of 3D CAD models containing machining features for mechanical parts. *JCDE*.
- Liu, R.; Wu, R.; Van Hoorick, B.; Tokmakov, P.; Zakharov, S.; and Vondrick, C. 2023. Zero-1-to-3: Zero-shot one image to 3d object. In *ICCV*.
- McLaren, S. V. 2008. Exploring perceptions and attitudes towards teaching and learning manual technical drawing in a digital age. *Int. J. Technol. Des. Educ.*
- Radford, A.; Kim, J. W.; Hallacy, C.; Ramesh, A.; Goh, G.; Agarwal, S.; Sastry, G.; Askell, A.; Mishkin, P.; Clark, J.; et al. 2021. Learning transferable visual models from natural language supervision. In *ICML*.
- Ren, D.; Zheng, J.; Cai, J.; Li, J.; Jiang, H.; Cai, Z.; Zhang, J.; Pan, L.; Zhang, M.; Zhao, H.; et al. 2021. Csg-stump: A learning friendly csg-like representation for interpretable shape parsing. In *ICCV*.
- Ren, D.; Zheng, J.; Cai, J.; Li, J.; and Zhang, J. 2022. Extrudenet: Unsupervised inverse sketch-and-extrude for shape parsing. In *ECCV*.
- Rombach, R.; Blattmann, A.; Lorenz, D.; Esser, P.; and Ommer, B. 2022. High-resolution image synthesis with latent diffusion models. In *CVPR*.
- Ruiz, N.; Li, Y.; Jampani, V.; Pritch, Y.; Rubinstein, M.; and Aberman, K. 2023. Dreambooth: Fine tuning text-to-image diffusion models for subject-driven generation. In *CVPR*.
- Schmittmann, B.; and Zia, R. 1998. Driven diffusive systems. An introduction and recent developments. *Phys. Rep.*
- Tovey, M. 1989. Drawing and CAD in industrial design. *Des. Stud.*
- Yu, F.; Chen, Z.; Li, M.; Sanghi, A.; Shayani, H.; Mahdavi-Amiri, A.; and Zhang, H. 2022. Capri-net: Learning compact cad shapes with adaptive primitive assembly. In *CVPR*.
- Zhang, L.; Rao, A.; and Agrawala, M. 2023. Adding conditional control to text-to-image diffusion models. In *ICCV*.
- Zhao, W.; Rao, Y.; Liu, Z.; Liu, B.; Zhou, J.; and Lu, J. 2023. Unleashing text-to-image diffusion models for visual perception. In *ICCV*.