

# SEED: Customize Large Language Models with Sample-Efficient Adaptation for Code Generation

Xue Jiang, Yihong Dong, Zhi Jin, and Ge Li

Key Laboratory of High Confidence Software Technologies (Peking University),  
Ministry of Education; School of Computer Science, Peking University, Beijing, China  
{jiangxue, dongyh}@stu.pku.edu.cn, {zhijin, lige}@pku.edu.cn

## Abstract

Although Large Language Models (LLMs) have made significant progress in code generation, they still struggle with code generation tasks in specific scenarios. These scenarios usually necessitate the adaptation of LLMs to fulfill specific needs, but the limited training data available in practice leads to poor code generation performance. How to effectively adapt LLMs to new scenarios with fewer training samples is a major challenge for current code generation. In this paper, we propose a novel adaptation approach named SEED, which stands for **S**ample-**E**fficient adaptation with **E**rror-**D**riven learning for code generation. SEED leverages the errors made by LLMs as learning opportunities, using error revision to overcome its own shortcomings, thus achieving efficient learning. Specifically, SEED involves identifying error code generated by LLMs, employing SELF-REVISE for code revision, optimizing the model with revised code, and iteratively adapting the process for continuous improvement. Experimental results show that, compared to traditional fine-tuning approaches, SEED achieves superior performance with fewer training samples, showing a relative improvement of 27.2%-325.0% in Pass@1. We also validate the effectiveness of SELF-REVISE, which generates revised code that optimizes the model more efficiently compared to the code samples from datasets. Moreover, SEED consistently demonstrates strong performance across various LLMs, underscoring its generalizability.

## 1 Introduction

Code generation is an important technology that can improve the efficiency and quality of software development. Given the human requirement expressed in natural language, code generation allows machines to generate executable programs that satisfy this requirement. Therefore, code generation has been a research hot topic in the fields of arti-

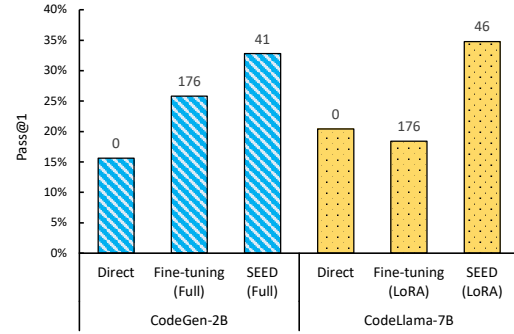

Figure 1: The performance of direct generation, fine-tuning, and our proposed SEED on MBPP dataset with few training samples. The numbers on the bars indicate the training samples used by different approaches.

cial intelligence, software engineering, and natural language processing. Recently, code generation technologies have made significant advancements in both academia and industry (Chen et al., 2021; Shen et al., 2022; Li et al., 2022). In particular, large language models (LLMs) demonstrate great potential in code generation tasks (Zheng et al., 2023; Nijkamp et al., 2023; Fried et al., 2022). However, LLMs still face significant challenges in code generation for some specific scenarios or domains.

For specific code generation scenarios, fine-tuning LLMs is essential to ensure they accurately fulfill particular needs. However, due to common reasons such as industry secrecy and scarcity of resources, it is difficult to obtain sufficient training samples for fine-tuning LLMs. Under the circumstance of limited data, traditional fine-tuning approaches might not enable LLMs to achieve the desired code generation performance and may even lead to a degradation in model performance (Zhang et al., 2022; Ding et al., 2023; Kumar et al., 2022). As shown in the right side of Figure 1, the performance of Fine-tuning (fine-tuned with few samples)

is inferior to that of Direct (the original unfine-tuned model) for CodeLlama on MBPP dataset. Consequently, how to effectively adapt LLMs to specific scenarios with limited data available is a major challenge for code generation in practice.

Traditional fine-tuning approaches use a large number of samples gathered under specific scenarios for training. They enable model to exhaustively learn the features present in these samples and thus adapt to the specific scenarios. However, they have two disadvantages. First, compelling LLMs to re-learn the entire code data of these new scenarios is inefficient. Considering that LLMs are pre-trained on large-scale and diverse data, it’s reasonably assumed that they possess a certain level of general knowledge, lacking only particular information for application in specific scenarios. Second, when faced with insufficient data volume or data drift, model may learn certain undesirable features (such as inaccurate or irrelevant programming knowledge and patterns), thereby affecting its learning efficiency and negatively impacting its final performance.

To overcome the disadvantages of traditional fine-tuning approaches, we take inspiration from the error-driven learning observed in humans. First, error-driven learning requires learners to identify their errors through testing. It helps learners to identify what they have mastered and what they still need to learn, allowing them to narrow the scope of learning and avoid wasting efforts on irrelevancies. Second, through error revision, learners can understand their deficiencies and make targeted improvements, thus enhancing learning efficiency and effectiveness. This motivates us to explore approaches to achieve sample-efficient adaptation of LLMs for code generation guided by error-driven learning.

In this paper, we propose SEED, a **Sample-Efficient** adaptation based on **Error-Driven** learning for code generation. SEED aims to alleviate the problem of poor code generation performance of fine-tuning LLMs in scenarios with few training samples. Following the error-driven learning, our approach proceeds in four steps, i.e., Error Code Collection, Automatic Code Revision, Model Optimization, and Iterative Adaptation. Extensive experimental results demonstrate the superiority and generalizability of SEED in the sample-efficient adaptation of LLMs for specific code generation scenarios.

To summarize, the main contributions of this

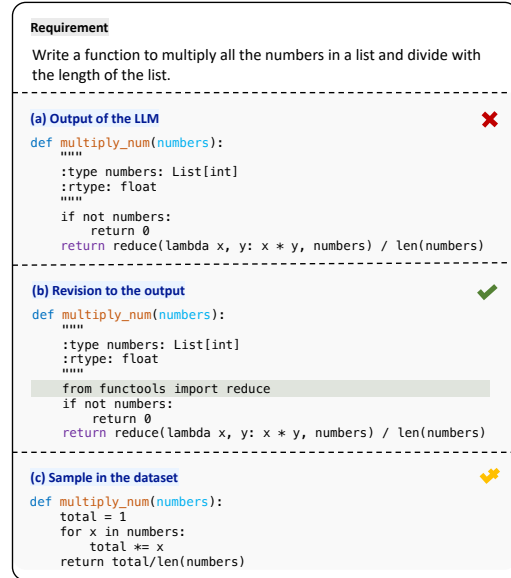

Figure 2: A motivation example of SEED.

paper are: 1) We introduce error-driven learning for LLMs. It utilizes revisions of model’s erroneous outputs for training and has higher training efficiency compared to using samples from the dataset. 2) We propose a sample-efficient adaptation approach of LLMs for code generation, named SEED. Based on the principle of error-driven learning, SEED continuously optimizes model by identifying and revising error codes generated by LLMs, enabling effective adaptation to code generation scenarios with fewer training samples. 3) SEED outperforms traditional fine-tuning approaches on two public benchmarks across various LLMs, which achieve better performance with fewer training samples.

## 2 Motivation Example

We present a motivation example in Figure 2 to clarify the advantages of using error-driven learning in the LLMs adaptation process of code generation.

We can see that the LLM can generate a basically correct code (a) that adopts a commonly-used function ‘reduce’ (Dean et al., 2008). However, the code still fails due to a critical error: it does not take dependencies into account, i.e., without importing the correct libraries and functions. It means LLM has most of the capabilities to solve the problem, but also reveals a shortcoming in dealing with dependencies, which is related to a code generation scenario. This shortcoming can be overcome just by bootstrapping LLMs to import the correct dependencies, as shown in revision (b). However,

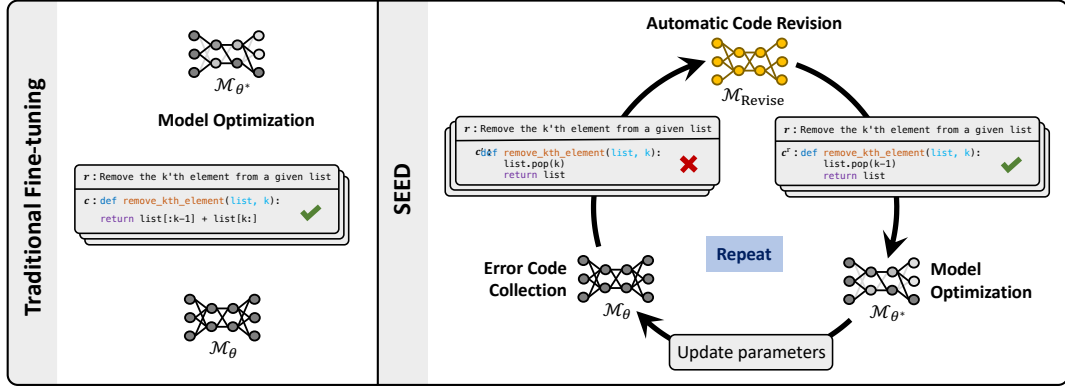

Figure 3: The difference between SEED and traditional fine-tuning.

in traditional fine-tuning approaches, it is challenging to overcome the shortcoming through learning samples in the dataset. Because sample (c) in the dataset proposed a different solution from (a), it did not use the ‘reduce’ function. LLM needs to put in more effort to learn the new solution from scratch and also misses the opportunity to overcome its shortcomings. Furthermore, there is a potential risk when training LLMs with (c): LLMs may incorrectly infer that (c) is the optimal solution for this requirement, resulting in the omission of the Guard Clause “if not numbers\n return 0” in (a). Omitting the Guard Clause is an incorrect programming pattern, which is undesirable to learn. Due to the absence of the Guard Clause as a safeguard for handling edge cases, an error occurs in the edge case where the input list is empty. Therefore, using revision (b) to train LLMs is a better choice, which allows LLMs to focus on and learn to solve the critical error, while simultaneously maintaining the advantages of LLM’s original output.

Further, we explore the effectiveness of adopting error-driven learning from the perspective of model optimization. We consider the potential significant discrepancy between the model-generated output and the sample in the dataset. By learning the revisions of the model’s erroneous outputs, we can find more effective navigation in the optimization process. This might provide a shorter, smoother path to a good local minimum compared to learning from samples in the dataset, rather than attempting to direct it toward a distant area that may not align well with its existing knowledge or biases. We conduct the statistical analysis of the discrepancies in the model’s latent representations<sup>1</sup>. The findings reveal that the average distance between

the model’s erroneous outputs and the dataset’s samples is 12.35, whereas the average distance between the erroneous outputs and their revisions is significantly lower, at 6.39. These experimental results suggest that within the model’s representation space, revised codes are closer and similar to the erroneous output codes than the original code samples. This evidence lends support to our hypothesis of why the error-driven learning method is more efficient.

Therefore, our work is determined to explore the use of error-driven learning to achieve a sample-efficient adaptive approach, aimed at enhancing the performance of LLMs in specific code generation scenarios.

### 3 Methodology

Given a code generation scenario/domain with a few-sample dataset  $\mathcal{D}_{train} = \{(r, c)\}$ , where each sample pair  $(r, c)$  consists of an input requirement  $r$  and an associated example of the desired output code  $c$ . For a pre-trained LLM  $\mathcal{M}_\theta$  with parameter  $\theta$ , we aim to adapt  $\mathcal{M}_\theta$  to the specific scenario of  $\mathcal{D}_{train}$ .

SEED achieves sample-efficient adaptation of LLMs through four steps: Error Code Collection (§3.1), Automatic Code Revision (§3.2), Model Optimization (§3.3), and Iterative Adaptation (§3.4). The process of SEED is demonstrated in Figure 3.

#### 3.1 Error Code Collection

In this section, we elaborate on our approach for systematically identifying and collecting erroneous generation results of  $\mathcal{M}_\theta$ , which is crucial for understanding the model’s weaknesses and facilitating targeted improvements.

We employ rejection sampling (Casella et al., 2004) to draw samples from the distribution pro-

<sup>1</sup>Experimental details can be found in Appendix A

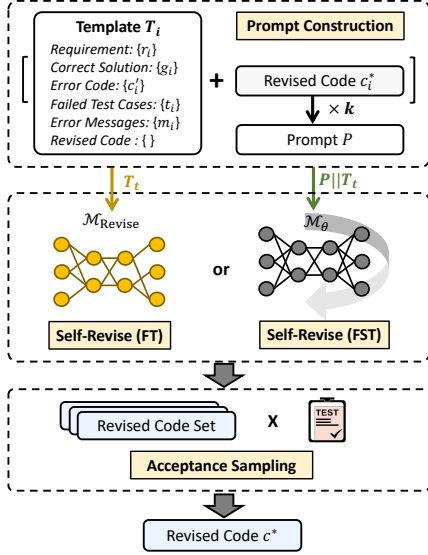

Figure 4: Illustration of automatic code revision

duced by  $\mathcal{M}_\theta$ . For each requirement  $r \in \mathcal{D}_{train}$ , we sample

$$c' \sim \mathcal{M}_\theta(r) \mid \neg f, \quad (1)$$

where we employ the criterion function  $f$  to determine the retention of the sample. Specifically, the sample  $c'$  is retained when  $f(r, c') = 0$ , where  $f(r, c') = 0$  if the rejection condition is satisfied, otherwise 1.

We define  $f$  as a test evaluation function, since testing is the criterion for judging the correctness of code in practice:

$$\text{TESTEVAL}(r, c') := \begin{cases} 0, & \text{if } c' \text{ fails } S_r, \\ 1, & \text{otherwise,} \end{cases} \quad (2)$$

where  $S_r$  is test cases under the requirement  $r$ . When collecting the error codes for test failures, we can keep the failed test cases and error messages for further error diagnosis.

To gain insights into the propensity of  $\mathcal{M}_\theta$  to make certain errors, it is advisable to select samples  $c'$  for which the model demonstrates relatively high confidence. Therefore, in the error code collection step, we adopt temperature sampling (Holtzman et al., 2020; Ackley et al., 1985) to sample multiple times and select the error code with the highest probability.

### 3.2 Automatic Code Revision

In this section, we describe our approach for automatic code revision, called SELF-REVISE. Based on  $\mathcal{M}_\theta$  itself, SELF-REVISE revises the error code by pointing out the error and providing the correct

solution for reference<sup>2</sup>. Specifically, based on the original data and collected data, we leverage four parts as input to achieve automatic code revision: requirement ( $r$ ), correct Solution ( $g$ ), error code ( $c'$ ), failed test cases ( $t$ ) and error messages ( $m$ ), where we use  $g$  for reference to reduce the difficulty of revision. The pipeline of automatic code revision is shown in Figure 4.

Following previous work (Zhang et al., 2023; Dong et al., 2023c), we use two settings for SELF-REVISE, i.e., few-shot prompting (FSP) and fine-tune (FT), to revise error codes generated by  $\mathcal{M}_\theta$  using  $\mathcal{M}_{\text{Revise}}$ . Details can be found in Appendix B.

In contrast to the previous step, we use acceptance sampling to obtain the revised code  $c^*$  in this step:

$$c^* \sim \mathcal{M}_{\text{Revise}}(T_t) \mid f. \quad (3)$$

where  $c^*$  is retained if  $\text{TESTEVAL}(r, c^*) = 1$  in Eq. (2), i.e., the revised code  $c^*$  passes its test suite. We sample multiple times through temperature sampling, and it is sufficient if the model  $\mathcal{M}_{\text{Revise}}$  could correctly revise the code once. To prevent  $\mathcal{M}_{\text{Revise}}$  from simply replicating the provided correct solution  $g$ , we exclude the output identical to  $g$ . Subsequently, for each requirement  $r$ , we select the version that is most similar to the error code among the remaining revised code versions.

### 3.3 Model Optimization

In this step, we employ pairs of the requirement  $r$  and its revised code  $c^*$  to further fine-tune the initial model  $\mathcal{M}_\theta$ . This process leads to the enhanced version of  $\mathcal{M}_\theta$ , referred to as  $\mathcal{M}_{\theta^*}$ , in the specific scenario of dataset  $\mathcal{D}_{train}$ .

We employ Low-Rank Adaptation (LoRA) (Hu et al., 2022) to fine-tune LLMs when the computational resources are insufficient. For a weight matrix  $W \in \mathbb{R}^{d \times k}$ , LoRA represents its update with a low-rank decomposition:

$$W + \Delta W = W + \Delta \alpha W_{\text{down}} W_{\text{up}}, \quad (4)$$

where  $\alpha$  is a tunable scalar hyperparameter,  $W_{\text{down}} \in \mathbb{R}^{d \times r}$ ,  $W_{\text{up}} \in \mathbb{R}^{r \times k}$ , and  $r \ll \min(r, k)$ . Compared to full fine-tuning (Radford et al., 2018), which updates the entire parameter  $\theta$

<sup>2</sup>The correct solution exists in dataset may differ significantly from the error code, as there are usually many correct solutions that satisfy the requirement.



as

$$\theta^* = \arg \min_{\theta} \sum_{(r, c^*)} l_{ce}(\mathcal{M}_{\theta}(r), c^*), \quad (5)$$

we employ LoRA to update parameter  $\theta^*$  as

$$\theta^* = \theta + \Delta\theta, \quad (6)$$

$$\Delta\theta = \arg \min_{\Delta\theta} \sum_{(r, c^*)} l_{ce}(\mathcal{M}_{\theta+\Delta\theta}(r), c^*). \quad (7)$$

In this way, we can use a small amount of computing resources fine-tuning to obtain the enhanced model  $\mathcal{M}_{\theta^*}$ .

### 3.4 Iterative Adaptation

The preceding three steps can go through multiple iterations until a certain number of rounds is reached or the performance no longer improves.

For  $l$ -th iteration that  $l > 1$ , we initialize its initial model  $\mathcal{M}_{\theta_l}$  as the enhanced model of the previous iteration  $\mathcal{M}_{\theta_{l-1}^*}$ . Based on  $\mathcal{M}_{\theta_l}$ , we repeat the process in steps of error code collection and automatic code revision to sample error codes  $\{c'\}_l$  and revised codes  $\{c^*\}_l$ , respectively. We use the union of  $\{(r, c^*)\}_{1:l}$ , that is

$$\{(r, c^*)\}_1 \cup \dots \cup \{(r, c^*)\}_i \dots \cup \{(r, c^*)\}_l, \quad (8)$$

to update parameters in the model optimization step, thereby yielding the enhanced model of the  $l$ -th iteration  $\mathcal{M}_{\theta_l^*}$ .

This iteration is a step-by-step optimization designed to continuously improve the model’s adaptability to the specific scenario. The pseudocode of SEED is shown in Appendix C.

## 4 Evaluation

We present extensive experiments that span two representative datasets and five different LLMs with varying numbers of parameters. We aim to investigate five research questions: 1) How does SEED perform compared to the baselines (§ 4.3), 2) What is the impact of implementing the automatic code revision component of SEED in conjunction with alternative LLMs (§ 4.4), 3) How does the number of iterations affect the effectiveness of SEED (§ 4.5), 4) How does SEED perform when applied to various LLMs (§ 4.6), 5) What kind of training sample has the better training effect (§ F in Appendix).

### 4.1 Datasets

**MBPP** (Austin et al., 2021) contains crowd-sourced Python programming problems, covering programming fundamentals. We selected the version in the work (Chen et al., 2023a), which consists of 276 problems and some generated error codes alongside their human-revised counterparts, thus facilitating subsequent experiments. We use it to evaluate the model’s ability to generate standalone code functions.

**DS-pandas** (Lai et al., 2023) comprises 291 data science problems utilizing Pandas Python libraries, sourced from real-world problems posted by developers on StackOverflow. We use it to evaluate the model’s ability to utilize data analysis libraries for code generation.

Due to the scarcity and privacy of domain data, it becomes difficult to obtain these data, and there are no available datasets. Therefore, we utilize the MBPP and DS-pandas to simulate this situation with limited samples. We choose the first 100 samples from all datasets as test dataset  $\mathcal{D}_{test}$ . The remaining samples (up to 200 samples) serve as training dataset  $\mathcal{D}_{train}$ . The statistics of all datasets are presented in Table 1.

Table 1: Statistics of MBPP and DS-pandas.

Dataset	Num of Samples		Avg Length		Avg Num
	$\mathcal{D}_{train}$	$\mathcal{D}_{test}$	Requirement	Code	Test Case
MBPP	176	100	15.7	32.5	3
DS-pandas	191	100	184.8	26.2	2

### 4.2 Model Details

We use a single A6000 GPU to conduct all experiments. We select CodeGen-2B (Nijkamp et al., 2023) as our base model by default, which is a well-known open-source LLM for code and is suitable for full fine-tuning within our computational resource constraints.  $\mathcal{M}_{\theta}$  is initiated with our base model, and  $\mathcal{M}_{\text{Revise}}$  is derived from  $\mathcal{M}_{\theta}$  though SELF-REVISE (§ 3.2).

In the error code collection step (§ 3.1) and the automatic code revision step (§ 3.2), we utilize temperature sampling to generate multiple samples: 5 samples in the former and 30 in the latter, with the temperature parameter set at 0.8. For the final revised code in automatic code revision step, we choose the sample exhibiting the minimum Levenshtein distance to the altered error code from the set of samples. The number of iterative adaptations

is set to 2. The maximum generation length is uniformly limited to 300 tokens. Following the practice of real software development which utilizes testing for evaluation, we utilize Pass@k (Li et al., 2022) metric to measure the functional correctness of the generated code by executing test cases. Additional experimental settings can be found in the Appendix D

### 4.3 Comparison with Baselines

**Baselines.** We mainly compared four baselines to validate the effect of SEED: 1) **Direct**: We evaluate the model directly to show the performance of the original model. 2) **Fine-tuning (Full)**: We employ full-parameter fine-tuning using  $\mathcal{D}_{train}$ . 3) **Fine-tuning (LoRA)**: We fine-tune the model on  $\mathcal{D}_{train}$  using LoRA. 4) **Prompting**: We utilize 4-shot prompt to align the model with the input-output format of  $\mathcal{D}_{train}$ . The 4 examples in the prompt are randomly selected from  $\mathcal{D}_{train}$ . Given the involvement of full-parameter fine-tuning, CodeGen-2B is uniformly selected as our base model. For SEED, we use 30% data of  $\mathcal{D}_{train}$  and label human revision for SELF-REVISE, while the remaining 70% data of  $\mathcal{D}_{train}$  is employed for model fine-tuning.

Table 2: Pass@k (%) of SEED and baselines on MBPP and DS-pandas benchmarks, and the teal number after  $\uparrow$  denotes the relative improvement of SEED over Fine-tuning (Full).

Benchmark	Approach	Pass@1	Pass@5	Pass@10
MBPP	Direct	15.6%	31.4%	40.2%
	Fine-tuning (Full)	25.8%	46.2%	57.6%
	Fine-tuning (LoRA)	19.8%	39.8%	55.2%
	Prompting	24.4%	38.0%	49.4%
	SEED	32.8% $\uparrow 27.2\%$	46.8% $\uparrow 1.2\%$	64.0% $\uparrow 10.6\%$
DS-pandas	Direct	0.2%	0.6%	1.2%
	Fine-tuning (Full)	0.8%	2.0%	3.2%
	Fine-tuning (LoRA)	0.4%	1.0%	1.6%
	Prompting	0.2%	0.8%	1.2%
	SEED	3.4% $\uparrow 325.0\%$	5.6% $\uparrow 280.0\%$	8.2% $\uparrow 156.2\%$

**Results.** We conducted experiments on two public benchmarks, i.e., MBPP and DS-pandas. The experimental results are summarized in Table 2. This comparison yielded three insightful observations: 1) **Significant superiority of SEED**: Our proposed SEED performs significantly better than the other four baselines on the two benchmarks. Notably, SEED exhibits significant relative improvements of 27.2% and 325.0%, respectively, when compared to the best-performing baseline Fine-tuning (Full). 2) **Fine-tuning (LoRA) is less effective than Fine-tuning (Full)**: Although

Fine-tuning (LoRA) offers the advantage of reduced computational resource requirements for fine-tuning LLMs, it trades off performance. 3) **Less improvement of Prompting**: Prompting generally underperforms compared to the Fine-tuning approaches. It only outperforms Fine-tuning (LoRA) in the MBPP benchmark’s Pass@1 metric. This could be attributed to the MBPP’s requirement for format alignment, which might be more amenable to Prompting. However, in more challenging datasets like DS-pandas or broader samplings such as Pass@5 and Pass@10, the efficacy of Prompting is the least effective, with the exception of Direct.

### 4.4 Automatic Code Revision Based on Other Models

**Baselines.** We evaluate the performance of automatic code revision and the impact on the final model  $\mathcal{M}_{\theta^*}$  obtained through the SEED approach when using alternative LLMs as  $\mathcal{M}_{Revise}$  to substitute the base model. The LLMs used include: 1) **Base Model**: We use the same model as the base model (CodeGen-2B) for automatic code revision, i.e., SELF-REVISE. 2) **CodeGen-6B** (Nijkamp et al., 2023): A variant in the same series as our base model but with a substantially larger parameter count. 3) **Llama-7B** (Touvron et al., 2023b): A LLM with different training data and architectures of the base model. 4) **CodeLlama-7B** (Rozière et al., 2023): A code LLM with different training data and architectures of the base model. 5) **ChatGPT** (OpenAI, 2022): We employ the powerful ChatGPT for SELF-REVISE (FSP). We obtain  $\mathcal{M}_{Revise}$  in both fine-tuning and few-shot prompting settings for comparison.

**Results.** We conducted this experiment on MBPP benchmark, as illustrated in Table 3. Based on the experimental results, it is observed that: 1) **SELF-REVISE (FT) employing the same model as the base model yields the most favorable outcomes**. For baselines using other LLMs, CodeLlama exhibits superior performance in terms of Pass@k in  $\mathcal{M}_{Revise}$ , but its final effectiveness is somewhat compromised. This limitation is attributed to the divergence in training data and architectural frameworks between CodeLlama and the base model, leading to inconsistencies in the revised code with the base model’s expectations. In contrast, CodeGen-6B, which is the same series of the base model with a large parameter, demonstrates

Table 3: Comparison of automatic code revision base on different LLMs in both fine-tuning and few-shot prompting settings. Where  $\mathcal{M}_{\text{Revise}}$  is taken as the result of the first iteration and  $\mathcal{M}_{\theta^*}$  is taken as the result of the final iteration.

Approach	$\mathcal{M}_{\text{Revise}}$			$\mathcal{M}_{\theta^*}$	
	Pass@1	Pass@10	Pass@any	Pass@1	Pass@10
<b>Few-shot Prompting</b>					
CodeGen-6B	19.4%	60.1%	70.8%	26.8%	59.0%
Llama-7B	23.5%	67.7%	81.9%	20.8%	54.2%
CodeLlama-7B	20.2%	64.9%	75.0%	25.2%	59.6%
ChatGPT	61.4%	87.3%	92.1%	27.0%	62.4%
Base Model	18.9%	57.1%	69.4%	26.2%	58.2%
(SELF-REVISE (FSP))					
<b>Fine-tuning</b>					
CodeGen-6B	5.0%	20.3%	26.6%	29.4%	64.2%
Llama-7B	2.7%	8.5%	12.6%	23.2%	58.4%
CodeLlama-7B	5.1%	21.0%	34.6%	24.0%	60.2%
Base Model	3.9%	18.9%	24.2%	<b>32.8%</b>	<b>64.0%</b>
(SELF-REVISE (FT))					

slightly lower Pass@k in  $\mathcal{M}_{\text{Revise}}$  than CodeLlama but still achieves commendable results for  $\mathcal{M}_{\theta^*}$ . **2) although the Pass@k of SELF-REVISE (FSP) is higher than SELF-REVISE (FT) in  $\mathcal{M}_{\text{Revise}}$ , it does not perform as well on the ultimate  $\mathcal{M}_{\theta^*}$ .** We qualitatively assess SELF-REVISE (FT) and SELF-REVISE (FSP) in Appendix G. We find this discrepancy may be due to the SELF-REVISE (FSP)’s tendency to learn superficial forms; it often resorts to directly copying code samples from  $\mathcal{D}_{\text{train}}$ , even when explicitly instructed not to in the prompt. Using ChatGPT as  $\mathcal{M}_{\text{Revise}}$  results in substantially higher Pass@k compared to using the base model, does not significantly enhance the final  $\mathcal{M}_{\theta^*}$ .

#### 4.5 The Effect of Iterations

**Baselines.** We study the effect of iterations on SEED. We analyze the progression of SEED’s effectiveness across different iterations, starting from 0 iterations (i.e., generated directly with LLMs) and extending to one, and up to four iterations.

Table 4: Performance of SEED with the different number of iterations.

Iterations	Pass@1	Pass@10	Num of Revised Code
0	15.6%	40.2%	-
1	31.6%	60.6%	31 (+31)
2	32.8%	64.0%	41 (+10)
3	33.0%	62.6%	43 (+2)
4	33.2%	64.0%	44 (+1)

**Results.** We conduct this experiment on MBPP dataset and its results are displayed in Table 4. From the results we can observe a trend: as the

number of iteration rounds increases, the performance of SEED first shows an increasing trend and then gradually stabilizes. This phenomenon is closely related to the number of revised codes made to the model  $\mathcal{M}_{\text{Revise}}$  in each iteration round. Further, if we can continue to enhance  $\mathcal{M}_{\text{Revise}}$ , SEED will have even stronger performance gains through iterative adaptation.

#### 4.6 SEED with Different Base Models

**Baselines.** We use four types of well-known LLMs to perform SEED, including **CodeGen-2B and 6B**, **Llama-7B**, and **CodeLlama-7B**. Among them, CodeGen-2B uses full fine-tuning, and the remaining LLMs use parameter-efficient fine-tuning with LoRA.

Table 5: Pass@k (%) of SEED and baselines with different base models, and the teal number after  $\uparrow$  denotes the relative improvement of SEED over Fine-tuning.

Model	Approach	Pass@1	Pass@5	Pass@10
CodeGen-2B	Direct	15.6%	31.4%	40.2%
	Fine-tuning (Full)	25.8%	46.2%	57.6%
	Prompting	24.4%	38.0%	49.4%
	SEED (Full)	<b>32.8%</b>	<b>46.8%</b>	<b>64.0%</b>
CodeGen-6B	Direct	19.6%	40.2%	60.8%
	Fine-tuning (LoRA)	26.6%	46.8%	63.0%
	Prompting	26.2%	45.2%	60.2%
	SEED (LoRA)	<b>33.4%</b>	<b>47.4%</b>	<b>67.6%</b>
Llama-7B	Direct	13.4%	29.8%	37.4%
	Fine-tuning (LoRA)	15.2%	27.4%	34.0%
	Prompting	16.6%	26.2%	33.8%
	SEED (LoRA)	<b>22.0%</b>	<b>30.4%</b>	<b>40.8%</b>
CodeLlama-7B	Direct	20.4%	43.8%	52.8%
	Fine-tuning (LoRA)	18.4%	42.4%	53.2%
	Prompting	27.8%	46.6%	64.8%
	SEED (LoRA)	<b>34.8%</b>	<b>49.2%</b>	<b>65.8%</b>

**Results.** The results from applying SEED to various base models are detailed in Table 5. These results demonstrate that SEED consistently achieves significant improvements across all base models, outperforming the Direct, Fine-tuning, and Prompting baselines. For these four LLMs, Code LLMs are better than pure LLMs, and there is a clear trend indicating that as the number of parameters in the LLMs increases, the efficacy of the Direct and Prompting approaches also increases steadily. In contrast, the effectiveness of SEED on these LLMs is also continuously improving.

### 5 Related Work

**Adaption of LLMs** Since LLMs contain a large number of model parameters and performing full parameter tuning would be very expensive, a number of parameter-efficient fine-tuning approaches

have been developed, including Adapter Tuning (Houlsby et al., 2019; Hu et al., 2023), Prompt Tuning (Lester et al., 2021; Liu et al., 2021b), Prefix Tuning (Li et al., 2021; Liu et al., 2021a), and Low-rank adaptation (Hu et al., 2022). These lightweight tuning approaches typically achieve near-full fine-tuning performance while reducing the number of parameters required for training. They primarily optimize the efficiency of training the model parameters but are not directly targeted at improving the efficiency of data sample usage.

Another approach of adaptation that does not require training is prompting (Liu et al., 2023), which depends on in-context learning (Dong et al., 2023a; Brown et al., 2020). By utilizing natural language instructions and a few examples of a task, this approach enables LLMs to recognize and execute new tasks without explicit gradient updates. However, a limitation of this approach is that the models often merely mimic the surface form of the prompt, struggling to deeply understand or adapt to complex and abstract task requirements.

Our approach is orthogonal to the aforementioned adaptation techniques, allowing for its concurrent application with these approaches to enhance overall effectiveness.

**Code Generation** The rise of pre-training techniques has brought new momentum to the field of code generation. Against this backdrop, LLMs such as Codex (Chen et al., 2021), InCoder (Fried et al., 2022), CodeGen (Nijkamp et al., 2023), AlphaCode (Li et al., 2022), and CodeGeeX (Zheng et al., 2023) have emerged, greatly enhancing the performance of code generation.

For LLMs-based code generation, there are some approaches to correct the LLMs’ errors, such as Self-edit (Zhang et al., 2023), Self-debug (Chen et al., 2023c), and Self-collaboration (Dong et al., 2023c), which use error correction to improve the predictions of the LLM without making any improvement to the model itself. Recently, Chen et al. (Chen et al., 2023a) propose an ILF approach focused on using human feedback to refine model results. However, this approach necessitates continuous human involvement and the provision of feedback throughout the model’s training phase, which incurs significant costs in practical applications. Further, Chen et al. (Chen et al., 2023b) propose a distillation approach that employs ChatGPT (OpenAI, 2022) to generate a large amount of refinement to train small models. However, this

approach presents two primary limitations. Firstly, it necessitates a highly performant “teacher” model, significantly surpassing the capabilities of the “student” model. Secondly, commercial constraints and other factors likely prohibit its implementation.

In contrast, our work is an adaption approach, focusing on obtaining a better model adapted to specific domains with limited data. By exploiting the inherent potential of LLMs to achieve error-driven learning, we significantly improve the learning efficiency of LLMs.

## 6 Conclusion

We have proposed SEED, a Sample-Efficient adaptation with Error-Driven learning for code generation, improving the code generation performance of LLMs in specific scenarios with limited data. SEED implements error-driven learning for LLMs through steps of error code collection, automatic code revision, model optimization, and iterative adaptation. Our evaluation indicates the effectiveness of SEED, evidencing that with significantly fewer training samples, it surpasses the performance of traditional fine-tuning and LORA.

## References

- David H. Ackley, Geoffrey E. Hinton, and Terrence J. Sejnowski. 1985. A learning algorithm for boltzmann machines. *Cogn. Sci.*, 9(1):147–169.
- Jacob Austin, Augustus Odena, Maxwell I. Nye, Maarten Bosma, Henryk Michalewski, David Dohan, Ellen Jiang, Carrie J. Cai, Michael Terry, Quoc V. Le, and Charles Sutton. 2021. Program synthesis with large language models. *CoRR*, abs/2108.07732.
- Tom B. Brown, Benjamin Mann, Nick Ryder, Melanie Subbiah, Jared Kaplan, Prafulla Dhariwal, Arvind Neelakantan, Pranav Shyam, Girish Sastry, Amanda Askell, Sandhini Agarwal, Ariel Herbert-Voss, Gretchen Krueger, Tom Henighan, Rewon Child, Aditya Ramesh, Daniel M. Ziegler, Jeffrey Wu, Clemens Winter, Christopher Hesse, Mark Chen, Eric Sigler, Mateusz Litwin, Scott Gray, Benjamin Chess, Jack Clark, Christopher Berner, Sam McCandlish, Alec Radford, Ilya Sutskever, and Dario Amodei. 2020. Language models are few-shot learners. In *NeurIPS*.
- George Casella, Christian P Robert, and Martin T Wells. 2004. Generalized accept-reject sampling schemes. *Lecture Notes-Monograph Series*, pages 342–347.
- Angelica Chen, Jérémy Scheurer, Tomasz Korbak, Jon Ander Campos, Jun Shern Chan, Samuel R. Bowman, Kyunghyun Cho, and Ethan Perez. 2023a. Improving code generation by training with natural language feedback. *CoRR*, abs/2303.16749.



- Hailin Chen, Amrita Saha, Steven C. H. Hoi, and Shafiq Joty. 2023b. Personalised distillation: Empowering open-sourced llms with adaptive learning for code generation. *CoRR*, abs/2310.18628.
- Mark Chen, Jerry Tworek, Heewoo Jun, Qiming Yuan, Henrique Pondé de Oliveira Pinto, Jared Kaplan, Harrison Edwards, Yuri Burda, Nicholas Joseph, Greg Brockman, Alex Ray, Raul Puri, Gretchen Krueger, Michael Petrov, Heidy Khlaaf, Girish Sastry, Pamela Mishkin, Brooke Chan, Scott Gray, Nick Ryder, Mikhail Pavlov, Alethea Power, Lukasz Kaiser, Mohammad Bavarian, Clemens Winter, Philippe Tillet, Felipe Petroski Such, Dave Cummings, Matthias Plappert, Fotios Chantzis, Elizabeth Barnes, Ariel Herbert-Voss, William Hebgen Guss, Alex Nichol, Alex Paino, Nikolas Tezak, Jie Tang, Igor Babuschkin, Suchir Balaji, Shantanu Jain, William Saunders, Christopher Hesse, Andrew N. Carr, Jan Leike, Joshua Achiam, Vedant Misra, Evan Morikawa, Alec Radford, Matthew Knight, Miles Brundage, Mira Murati, Katie Mayer, Peter Welinder, Bob McGrew, Dario Amodei, Sam McCandlish, Ilya Sutskever, and Wojciech Zaremba. 2021. [Evaluating large language models trained on code](#). *CoRR*.
- Xinyun Chen, Maxwell Lin, Nathanael Schärli, and Denny Zhou. 2023c. Teaching large language models to self-debug. *CoRR*, abs/2304.05128.
- Jeffrey Dean and Sanjay Ghemawat. 2008. Mapreduce: simplified data processing on large clusters. *Commun. ACM*, 51(1):107–113.
- Ning Ding, Yujia Qin, Guang Yang, Fuchao Wei, Zonghan Yang, Yusheng Su, Shengding Hu, Yulin Chen, Chi-Min Chan, Weize Chen, Jing Yi, Weilin Zhao, Xiaozhi Wang, Zhiyuan Liu, Hai-Tao Zheng, Jianfei Chen, Yang Liu, Jie Tang, Juanzi Li, and Maosong Sun. 2023. Parameter-efficient fine-tuning of large-scale pre-trained language models. *Nat. Mac. Intell.*, 5(3):220–235.
- Qingxiu Dong, Lei Li, Damai Dai, Ce Zheng, Zhiyong Wu, Baobao Chang, Xu Sun, Jingjing Xu, Lei Li, and Zhifang Sui. 2023a. A survey for in-context learning. *CoRR*, abs/2301.00234.
- Yihong Dong, Jiazheng Ding, Xue Jiang, Zhuo Li, Ge Li, and Zhi Jin. 2023b. Codescore: Evaluating code generation by learning code execution. *CoRR*, abs/2301.09043.
- Yihong Dong, Xue Jiang, Zhi Jin, and Ge Li. 2023c. Self-collaboration code generation via chatgpt. *CoRR*, abs/2304.07590.
- Yihong Dong, Xue Jiang, Huanyu Liu, Ge Li, and Zhi Jin. 2024. Generalization or memorization: Data contamination and trustworthy evaluation for large language models. *CoRR*, abs/2402.15938.
- Yihong Dong, Ge Li, and Zhi Jin. 2023d. CODEP: grammatical seq2seq model for general-purpose code generation. In *ISSTA*, pages 188–198. ACM.
- Daniel Fried, Armen Aghajanyan, Jessy Lin, Sida Wang, Eric Wallace, Freda Shi, Ruiqi Zhong, Wen-tau Yih, Luke Zettlemoyer, and Mike Lewis. 2022. Incoder: A generative model for code infilling and synthesis. *CoRR*, abs/2204.05999.
- Ari Holtzman, Jan Buys, Li Du, Maxwell Forbes, and Yejin Choi. 2020. The curious case of neural text degeneration. In *ICLR*. OpenReview.net.
- Neil Houlsby, Andrei Giurgiu, Stanislaw Jastrzebski, Bruna Morrone, Quentin de Laroussilhe, Andrea Gesmundo, Mona Attariyan, and Sylvain Gelly. 2019. Parameter-efficient transfer learning for NLP. In *ICML*, volume 97 of *Proceedings of Machine Learning Research*, pages 2790–2799. PMLR.
- Edward J. Hu, Yelong Shen, Phillip Wallis, Zeyuan Allen-Zhu, Yuanzhi Li, Shean Wang, Lu Wang, and Weizhu Chen. 2022. Lora: Low-rank adaptation of large language models. In *ICLR*. OpenReview.net.
- Zhiqiang Hu, Lei Wang, Yihuai Lan, Wanyu Xu, Ee-Peng Lim, Lidong Bing, Xing Xu, Soujanya Poria, and Roy Ka-Wei Lee. 2023. Llm-adapters: An adapter family for parameter-efficient fine-tuning of large language models. In *EMNLP*, pages 5254–5276. Association for Computational Linguistics.
- Ananya Kumar, Aditi Raghunathan, Robbie Matthew Jones, Tengyu Ma, and Percy Liang. 2022. Fine-tuning can distort pretrained features and underperform out-of-distribution. In *ICLR*. OpenReview.net.
- Yuhang Lai, Chengxi Li, Yiming Wang, Tianyi Zhang, Ruiqi Zhong, Luke Zettlemoyer, Wen-Tau Yih, Daniel Fried, Sida I. Wang, and Tao Yu. 2023. DS-1000: A natural and reliable benchmark for data science code generation. In *ICML*, volume 202 of *Proceedings of Machine Learning Research*, pages 18319–18345. PMLR.
- Brian Lester, Rami Al-Rfou, and Noah Constant. 2021. The power of scale for parameter-efficient prompt tuning. In *EMNLP (1)*, pages 3045–3059. Association for Computational Linguistics.
- Raymond Li, Loubna Ben Allal, Yangtian Zi, Niklas Muennighoff, Denis Kocetkov, Chenghao Mou, Marc Marone, Christopher Akiki, Jia Li, Jenny Chim, Qian Liu, Evgenii Zheltonozhskii, Terry Yue Zhuo, Thomas Wang, Olivier Dehaene, Mishig Davaadorj, Joel Lamy-Poirier, João Monteiro, Oleh Shliazhko, Nicolas Gontier, Nicholas Meade, Armel Zebaze, Ming-Ho Yee, Logesh Kumar Umapathi, Jian Zhu, Benjamin Lipkin, Muhtasham Oblokulov, Zhiruo Wang, Rudra Murthy V, Jason Stillerman, Siva Sankalp Patel, Dmitry Abulkhanov, Marco Zocca, Manan Dey, Zhihan Zhang, Nour Moustafa-Fahmy, Urvashi Bhattacharyya, Wenhao Yu, Swayam Singh, Sasha Luccioni, Paulo Villegas, Maxim Kunakov, Fedor Zhdanov, Manuel Romero, Tony Lee, Nadav Timor, Jennifer Ding, Claire Schlesinger, Hailey Schoelkopf, Jan Ebert, Tri Dao, Mayank Mishra, Alex Gu, Jennifer Robinson, Carolyn Jane Anderson, Brendan Dolan-Gavitt, Danish Contractor, Siva

- Reddy, Daniel Fried, Dzmitry Bahdanau, Yacine Jernite, Carlos Muñoz Ferrandis, Sean Hughes, Thomas Wolf, Arjun Guha, Leandro von Werra, and Harm de Vries. 2023. Starcoder: may the source be with you! *CoRR*, abs/2305.06161.
- Xiang Lisa Li and Percy Liang. 2021. Prefix-tuning: Optimizing continuous prompts for generation. In *ACL/IJCNLP (1)*, pages 4582–4597. Association for Computational Linguistics.
- Yujia Li, David Choi, Junyoung Chung, Nate Kushman, Julian Schrittwieser, Rémi Leblond, Tom Eccles, James Keeling, Felix Gimeno, Agustin Dal Lago, et al. 2022. Competition-level code generation with alphacode. *Science*, 378(6624):1092–1097.
- Pengfei Liu, Weizhe Yuan, Jinlan Fu, Zhengbao Jiang, Hiroaki Hayashi, and Graham Neubig. 2023. Pre-train, prompt, and predict: A systematic survey of prompting methods in natural language processing. *ACM Comput. Surv.*, 55(9):195:1–195:35.
- Xiao Liu, Kaixuan Ji, Yicheng Fu, Zhengxiao Du, Zhilin Yang, and Jie Tang. 2021a. P-tuning v2: Prompt tuning can be comparable to fine-tuning universally across scales and tasks. *CoRR*, abs/2110.07602.
- Xiao Liu, Yanan Zheng, Zhengxiao Du, Ming Ding, Yujie Qian, Zhilin Yang, and Jie Tang. 2021b. GPT understands, too. *CoRR*, abs/2103.10385.
- Ilya Loshchilov and Frank Hutter. 2017. Fixing weight decay regularization in adam. *CoRR*, abs/1711.05101.
- Ziyang Luo, Can Xu, Pu Zhao, Qingfeng Sun, Xubo Geng, Wenxiang Hu, Chongyang Tao, Jing Ma, Qingwei Lin, and Daxin Jiang. 2023. Wizardcoder: Empowering code large language models with evol-instruct. *CoRR*, abs/2306.08568.
- Erik Nijkamp, Bo Pang, Hiroaki Hayashi, Lifu Tu, Huan Wang, Yingbo Zhou, Silvio Savarese, and Caiming Xiong. 2023. Codegen: An open large language model for code with multi-turn program synthesis. In *ICLR*. OpenReview.net.
- OpenAI. 2022. [ChatGPT](#).
- Alec Radford, Karthik Narasimhan, Tim Salimans, Ilya Sutskever, et al. 2018. Improving language understanding by generative pre-training.
- Baptiste Rozière, Jonas Gehring, Fabian Gloeckle, Sten Sootla, Itai Gat, Xiaoqing Ellen Tan, Yossi Adi, Jingyu Liu, Tal Remez, Jérémy Rapin, Artyom Kozhevnikov, Ivan Evtimov, Joanna Bitton, Manish Bhatt, Cristian Canton-Ferrer, Aaron Grattafiori, Wenhan Xiong, Alexandre Défossez, Jade Copet, Faisal Azhar, Hugo Touvron, Louis Martin, Nicolas Usunier, Thomas Scialom, and Gabriel Synnaeve. 2023. Code llama: Open foundation models for code. *CoRR*, abs/2308.12950.
- Sijie Shen, Xiang Zhu, Yihong Dong, Qizhi Guo, Yankun Zhen, and Ge Li. 2022. Incorporating domain knowledge through task augmentation for frontend javascript code generation. In *ESEC/SIGSOFT FSE*, pages 1533–1543. ACM.
- Hugo Touvron, Thibaut Lavril, Gautier Izacard, Xavier Martinet, Marie-Anne Lachaux, Timothée Lacroix, Baptiste Rozière, Naman Goyal, Eric Hambro, Faisal Azhar, Aurélien Rodriguez, Armand Joulin, Edouard Grave, and Guillaume Lample. 2023a. Llama: Open and efficient foundation language models. *CoRR*, abs/2302.13971.
- Hugo Touvron, Louis Martin, Kevin Stone, Peter Albert, Amjad Almahairi, Yasmine Babaei, Nikolay Bashlykov, Soumya Batra, Prajjwal Bhargava, Shruti Bhosale, Dan Bikel, Lukas Blecher, Cristian Canton-Ferrer, Moya Chen, Guillem Cucurull, David Esiobu, Jude Fernandes, Jeremy Fu, Wenyin Fu, Brian Fuller, Cynthia Gao, Vedanuj Goswami, Naman Goyal, Anthony Hartshorn, Saghar Hosseini, Rui Hou, Hakan Inan, Marcin Kardas, Viktor Kerkez, Madian Khabsa, Isabel Kloumann, Artem Korenev, Punit Singh Koura, Marie-Anne Lachaux, Thibaut Lavril, Jenya Lee, Diana Liskovich, Yinghai Lu, Yuning Mao, Xavier Martinet, Todor Mihaylov, Pushkar Mishra, Igor Molybog, Yixin Nie, Andrew Poulton, Jeremy Reizenstein, Rashi Rungta, Kalyan Saladi, Alan Schelten, Ruan Silva, Eric Michael Smith, Ranjan Subramanian, Xiaoqing Ellen Tan, Binh Tang, Ross Taylor, Adina Williams, Jian Xiang Kuan, Puxin Xu, Zheng Yan, Iliyan Zarov, Yuchen Zhang, Angela Fan, Melanie Kambadur, Sharan Narang, Aurélien Rodriguez, Robert Stojnic, Sergey Edunov, and Thomas Scialom. 2023b. Llama 2: Open foundation and fine-tuned chat models. *CoRR*, abs/2307.09288.
- Haojie Zhang, Ge Li, Jia Li, Zhongjin Zhang, Yuqi Zhu, and Zhi Jin. 2022. Fine-tuning pre-trained language models effectively by optimizing subnetworks adaptively. In *NeurIPS*.
- Kechi Zhang, Zhuo Li, Jia Li, Ge Li, and Zhi Jin. 2023. Self-edit: Fault-aware code editor for code generation. In *ACL (1)*, pages 769–787. Association for Computational Linguistics.
- Qinkai Zheng, Xiao Xia, Xu Zou, Yuxiao Dong, Shan Wang, Yufei Xue, Zihan Wang, Lei Shen, Andi Wang, Yang Li, Teng Su, Zhilin Yang, and Jie Tang. 2023. Codegex: A pre-trained model for code generation with multilingual evaluations on humaneval-x. *CoRR*, abs/2303.17568.

## A Motivation Experimental Details

On the MBPP dataset, we obtain erroneous outputs of CodeGen-2B, revisions of the outputs, and samples in MBPP. We concatenate the requirements with their code, input them into CodeGen-2B, and extract the hidden representations from the model’s final layer. Then, we compute the Euclidean distances within the model’s representational space to quantify the disparities between these three elements.

## B Details of SELF-REVISE

**SELF-REVISE (FSP)** adopts the few-shot prompting technique, which leverages several examples to construct a prompt for aligning  $\mathcal{M}_\theta$  with the task of automatic code revision without additional training. We randomly select  $k$  examples from the dataset  $\mathcal{D}_{train}$  to construct the prompt

$$P = p_1 \parallel \dots \parallel p_i \parallel \dots \parallel p_k, \quad p_i = T_i \parallel c_i^* \quad (9)$$

$$T_i = \text{Template}(r_i, g_i, c_i', t_i, m_i) \quad (10)$$

where  $\parallel$  denotes the concatenation operation and  $\text{Template}$  is a function that combines the input parameters according to the template, as shown in Figure 4. In **SELF-REVISE (FSP)**,  $\mathcal{M}_{\text{Revise}}(T_t)$  is defined as  $\mathcal{M}_\theta(P \parallel T_t)$ . While **SELF-REVISE (FSP)** offers greater efficiency and obviates the need for additional training, it imposes certain prerequisites on model performance and necessitates the capability for code revision.

**SELF-REVISE (FT)** entails the process of fine-tuning a specific model based on  $\mathcal{M}_\theta$  with a small number of data for the purpose of automatic code revision. The training objective is to minimize the following loss function:

$$L(\theta) = \sum_i l_{ce}(\mathcal{M}_\theta(T_i), c_i^*) \quad (11)$$

where  $l_{ce}$  represents the standard cross-entropy loss, and we update parameters based on the initial model  $\mathcal{M}_\theta$  to obtain the model  $\mathcal{M}_{\text{Revise}}$  in **SELF-REVISE (FT)**.

## C Pseudocode of SEED.

## D Additional Experimental Settings

For full parameter fine-tuning, i.e., Fine-tuning (Full) (Brown et al., 2020), we utilize the AdamW optimizer (Loshchilov et al., 2017), with parameters  $\beta_1 = 0.9$  and  $\beta_2 = 0.9$ , accompanied by a

linear learning rate schedule. The initial learning rate is set to  $5e-6$ , with a batch size of 1 and gradient accumulation of 32 steps for training across 10 epochs. For parameter-efficient fine-tuning, i.e., Fine-tuning (LoRA) (Hu et al., 2022), the learning rate is set to  $2e-4$ . Additionally, the rank  $r$  is adjusted to 128, and the scaling factor  $\alpha$  is set at 8. All other parameters remain aligned with Fine-tuning (Full). For few-shot prompting, we set the number of examples in prompt to 4. Consistent parameter settings are used for all baselines.

## E Metrics

We use the unbiased version (Chen et al., 2021) of Pass@k, where  $n \geq k$  samples are generated for each problem, count the number of correct samples  $c \leq n$  which pass test cases and calculate the following estimator,

$$\text{Pass@k} = \mathbb{E}_{\text{Problems}} \left[ 1 - \frac{\binom{n-c}{k}}{\binom{n}{k}} \right]. \quad (12)$$

In the final evaluation of this paper, we set the temperature to 0.8 and employ temperature sampling to generate  $n = 50$  samples, which are then used to calculate unbiased Pass@k (Chen et al., 2021) via Eq. (12) in all experiments. All evaluation results are averaged over five test runs.

## F The Effect of Training Sample Variants

**Baselines** In this section, we compare SEED with different variants of training samples. 1) **W/o Training**: Direct generation without training. 2) **Raw  $\mathcal{D}_{train}$** : All samples in  $\mathcal{D}_{train}$ . 3) **Same Sample of SEED in  $\mathcal{D}_{train}$** : The sample of the same problem as SEED in  $\mathcal{D}_{train}$ . 3) **Human-revised  $\mathcal{D}_{train}$** : The Human-revised samples of  $\mathcal{D}_{train}$  provided in the work (Chen et al., 2023a). 4) **SEED  $\cup \mathcal{D}_{train}$** : The union of samples in SEED and  $\mathcal{D}_{train}$ .

We utilize the aforementioned variants to fine-tune the base model, CodeGen-2B (Nijkamp et al., 2023), in order to measure the influence of different variants of training samples.

**Results** As demonstrated in Table 6, we can find that: 1) **SEED exceeds Raw  $\mathcal{D}_{train}$ , despite it having more training samples**. This proves that training using revisions produced by  $\mathcal{M}_{\text{Revise}}$  is more efficient compared to using samples from dataset. 2) **The effect of Same Sample of SEED**

---

**Algorithm 1** Pseudocode of SEED.

---

**Require:** Few-sample Dataset  $\mathcal{D}_{train} = \{(r, c)\}$  and initial LLM  $\mathcal{M}_\theta$ .

**Ensure:** Output  $\mathcal{M}_{\theta^*}$ .

```
1: Initial iteration index  $l = 1$  and  $\mathcal{M}_{\theta_l} = \mathcal{M}_\theta$ .
2: repeat
3:   # Error Code Collection (§ 3.1)
4:   Perform rejection sampling to collect error codes  $\{c'\}_l$  based on  $\mathcal{M}_{\theta_l}$  via Eq. (1) and (2).
5:   # Automatic Code Revision (§ 3.2)
6:   Perform acceptance sampling to collect revised codes  $\{c^*\}_l$  based on  $\mathcal{M}_{\theta_l}$  and SELF-REVISE via Eq. (2), (10), and (3).
7:   Calculate the union of  $\{(r, c^*)\}_{1:l}$  via Eq. (8).
8:   # Model Optimization (§ 3.3)
9:   Fine-tune  $\mathcal{M}_{\theta_l}$  to yield  $\mathcal{M}_{\theta_l}^*$  via Eq. (5) if the computational resources are sufficient, otherwise via Eq. (4), (6), and (7).
10:  Update  $\mathcal{M}_{\theta^*} = \mathcal{M}_{\theta_l}^*$  and  $\mathcal{M}_{\theta_{l+1}} = \mathcal{M}_{\theta_l}^*$ .
11:  Update  $l = l + 1$ .
12: until End condition is satisfied
13: return  $\mathcal{M}_{\theta^*}$ 
```

---

Table 6: Comparison of different training sample variants.

Variants	Pass@1	Pass@5	Pass@10
W/o Training	15.6%	31.4%	40.2%
Raw $\mathcal{D}_{train}$	25.8%	46.2%	57.6%
Same Sample of SEED in $\mathcal{D}_{train}$	22.4%	33.8%	42.8%
Human-revised $\mathcal{D}_{train}$	28.0%	46.2%	59.8%
SEED $\cup \mathcal{D}_{train}$	29.2%	44.2%	58.0%
SEED	32.8%	46.8%	64.0%

in  $\mathcal{D}_{train}$  is comparatively weaker, which shows that SEED is not improved by selecting specific samples. **3) SEED  $\cup \mathcal{D}_{train}$  is not as effective as SEED**, which shows that some samples in  $\mathcal{D}_{train}$  have negative effects with limited data. **4) The performance of SEED surpasses that of the human-revised  $\mathcal{D}_{train}$** . This finding may be attributed to a disconnect between the modifications made by human experts and the model’s learning expectations. While human revisions are applied to all code samples in  $\mathcal{D}_{train}$ , some samples may inherently be challenging for the current model. As such, forced learning from these samples may have counterproductive effects, highlighting a potential limitation in human-revised  $\mathcal{D}_{train}$ .

## G Qualitative Examples

Upon manual inspection of the outcomes produced by SELF-REVISE (FSP), two prevalent modification patterns are identified. First, the removal of redundant code is a common alteration. This includes the deletion of unnecessary blocks such as "if name == 'main'" and other test codes, which are often extraneous in the context of the desired output. Second, SELF-REVISE (FSP) exhibits a tendency to directly copy correct code samples from the prompt. SELF-REVISE (FT) is capable of making minimal yet effective modifications to the model’s initial error code outputs, thereby gener-

ating the correct code. Based on the observations, SELF-REVISE (FT) is recommended as the more preferable approach for automatic code revision within SEED.

## H Threats to Validity

There are three major threats to the validity of our work.

**1) Threats to external validity** concern the quality of experimental datasets and the generalizability of our results. First, we simulate two specific code generation scenarios with two public code generation datasets, which are mainstream benchmarks and have been used in many related works (Chen et al., 2021; Lai et al., 2023; Dong et al., 2023d; Luo et al., 2023; Li et al., 2023; Nijkamp et al., 2023). Second, SEED can be applied to any LLMs, and we choose four well-known LLMs of different sizes, training data, and architectures for our experiments.

**2) Threats to internal validity** involve the impact of hyperparameters. Deep learning models are known to be sensitive to hyperparameters. For the baselines, we work with the source code supplied by their original papers and ensure that the performance of the mode is comparable with their reported results. For our proposed SEED, we do a small-range grid search on hyperparameter learning rates, leaving other hyper-parameters the same as those in previous studies (Hu et al., 2022; Brown et al., 2020; Nijkamp et al., 2023; Touvron et al., 2023a,b; Rozière et al., 2023), which has explored effective settings of the hyperparameters through extensive experiments. Therefore, there may be room to tune more hyperparameters for additional improvements.

**3) Threats to construct validity** pertain to the



Self-Revise (FSP)	<div>Case I</div> <div>Requirement</div> <p>Write a function to perform index wise addition of tuple elements in the given two nested tuples.</p> <div>Revision of error code</div> <pre> def add_nested_tuples(test_tup1, test_tup2): -   return tuple(map(lambda x, y: (x[0] + y[0], x[1] + y[1]), test_tup1, -       test_tup2)) - - if __name__ == "__main__": -     import doctest -     doctest.testmod() +   return tuple(tuple(map(sum, zip(tup1, tup2))) for tup1, tup2 in +       zip(test_tup1, test_tup2)) </pre> <div>Sample code from dataset</div> <pre> def add_nested_tuples(test_tup1, test_tup2):     res = tuple(tuple(a + b for a, b in zip(tup1, tup2)) for     tup1, tup2 in zip(test_tup1, test_tup2))     return (res) </pre>	<div>Case II</div> <div>Requirement</div> <p>Write a function to check if the common elements between two given lists are in the same order or not.</p> <div>Revision of error code</div> <pre> def same_order(l1, l2): -   if len(l1) != len(l2): -       return False -   for i in range(len(l1)): -       if l1[i] != l2[i]: -           return False -   return True +   common_elements = set(l1) &amp; set(l2) +   l1 = [e for e in l1 if e in common_elements] +   l2 = [e for e in l2 if e in common_elements] +   return l1 == l2 </pre> <div>Sample code from dataset</div> <pre> def same_order(l1, l2):     common_elements = set(l1) &amp; set(l2)     l1 = [e for e in l1 if e in common_elements]     l2 = [e for e in l2 if e in common_elements]     return l1 == l2 </pre>
	<div>Case I</div> <div>Requirement</div> <p>Write a function to extract all the pairs which are symmetric in the given tuple list.</p> <div>Revision of error code</div> <pre> def extract_symmetric(test_list):     symmetric_pairs = set()     for i in range(len(test_list)): -       for j in range(i+1, len(test_list)): -           if test_list[i] == test_list[j]: -               symmetric_pairs.add((test_list[i], test_list[j])) +       if test_list[i][::-1] in test_list: +           symmetric_pairs.add(tuple(sorted(test_list[i])))     return symmetric_pairs </pre> <div>Sample code from dataset</div> <pre> def extract_symmetric(test_list):     temp = set(test_list) &amp; {(b, a) for a, b in test_list}     res = {(a, b) for a, b in temp if a &lt; b}     return (res) </pre>	<div>Case II</div> <div>Requirement</div> <p>Write a function to remove odd characters in a string.</p> <div>Revision of error code</div> <pre> def remove_odd(str1):     new_str = ""     for i in range(len(str1)): -       if i % 2 == 0: +       if not i % 2 == 0:             new_str += str1[i]     return new_str </pre> <div>Sample code from dataset</div> <pre> def remove_odd(str1):     str2 = ""     for i in range(1, len(str1) + 1):         if(i % 2 == 0):             str2 = str2 + str1[i - 1]     return str2 </pre>

Figure 5: Cases for two settings of self-revise. In revision, the "+" represents a new line of code that was added, while the "-" indicates a line of code that was deleted.

reliability of our evaluation metrics. To address this threat, we employ Pass@k (Li et al., 2022) as the evaluation metric, which leverages test cases to gauge the functional correctness of code. Additionally, we utilized the unbiased version of Pass@k (Chen et al., 2021) to diminish evaluation errors that arise from sampling. Pass@k (Li et al., 2022; Chen et al., 2021) is the mainstream metric for code generation and is used in most previous studies (Li et al., 2022; Chen et al., 2021; Zheng et al., 2023; Nijkamp et al., 2023; Dong et al., 2023b; Luo et al., 2023; Li et al., 2023; Dong et al., 2024). Based on the above metrics, each experiment is run five times, and its average result is reported.