

A Learning-based Declarative Privacy-Preserving Framework for Federated Data Management

Hong Guan, Summer Gautier, Rajan Hari Ambrish, Yancheng Wang, Chaowei Xiao, Yingzhen Yang, Jia Zou

Arizona State University
United States

(hguan6,srgautie,rhariamb,ywan1053,cxiao17,yingzhen.yang,jia.zou)@asu.edu

ABSTRACT

It is challenging to select the right privacy-preserving mechanism for federated query processing over multiple private data silos. There exist numerous privacy-preserving mechanisms, such as secure multi-party computing (SMC), approximate query processing with differential privacy (DP), combined SMC and DP, DP-based data obfuscation, and federated learning. These mechanisms make different trade-offs among accuracy, privacy, execution efficiency, and storage efficiency. In this work, we first introduce a new privacy-preserving technique that uses a deep learning model trained using the Differentially-Private Stochastic Gradient Descent (DP-SGD) algorithm to replace portions of actual data to answer a query. We then demonstrate a novel declarative privacy-preserving workflow that allows users to specify *"what private information to protect"* rather than *"how to protect"*. Under the hood, the system relies on a cost model to automatically choose privacy-preserving mechanisms as well as hyper-parameters. At the same time, the proposed workflow also allows human experts to review and tune the selected privacy-preserving mechanism for audit/compliance, and optimization purposes.

CCS CONCEPTS

• Security and privacy → Information accountability and usage control.

KEYWORDS

differential privacy, federated data management, neural networks

ACM Reference Format:

Hong Guan, Summer Gautier, Rajan Hari Ambrish, Yancheng Wang, Chaowei Xiao, Yingzhen Yang, Jia Zou. 2018. A Learning-based Declarative Privacy-Preserving Framework for Federated Data Management. In *Proceedings of* . ACM, New York, NY, USA, 7 pages. <https://doi.org/XXXXXXXX.XXXXXXX>

1 INTRODUCTION

Data silos, which do not share data with each other, widely exist inside and across various organizations and businesses. For example,

Permission to make digital or hard copies of all or part of this work for personal or classroom use is granted without fee provided that copies are not made or distributed for profit or commercial advantage and that copies bear this notice and the full citation on the first page. Copyrights for components of this work owned by others than ACM must be honored. Abstracting with credit is permitted. To copy otherwise, or republish, to post on servers or to redistribute to lists, requires prior specific permission and/or a fee. Request permissions from permissions@acm.org.

© 2018 Association for Computing Machinery.
ACM ISBN 978-1-4503-XXXX-X/18/06...\$15.00
<https://doi.org/XXXXXXXX.XXXXXXX>

a recent study published in Science [7] showed that in most universities, the learning management systems for teaching classrooms, registrar systems, library systems, university portfolios for faculty, etc., cannot access each other's data. Such data blindness hinders the improvement of operational efficiency and the advancement of fields of study. Data silos also widely exist across organizations. For example, in women's health, patients meet with their obstetrics/gynecology, who refers externally to a lactation consultant, who refers externally to a therapist, and the chain continues [19]. However, existing data platforms do not support efficient data sharing among these practitioners [19]. Privacy is one of the biggest concerns that prevent these data silos from being broken down.

To address the issue, various privacy-preserving mechanisms are proposed for federated data management. These approaches strike different trade-offs among accuracy, privacy, efficiency, and usability. CryptDB [29] stores data on remote servers using homomorphic encryption. SMCQL [3] applies secure multi-party computation over private data federation. These approaches are expensive and introduce significant overheads. Differential privacy [13, 14] becomes a promising approach because it can provide a formal guarantee of the privacy. However, SQL queries with differential privacy [21] are mostly applicable to queries that report aggregation values, e.g., COUNT, AVG, SUM, etc. Shrinkwrap [4] combines differential privacy with secure multi-party computation to relax the accuracy and privacy requirements for the optimization of query performance. SAQE [5] generalizes on Shrinkwrap to add less noise to the query's results by exploiting the inherent noise in approximate query processing. However, these federated query processing techniques are also limited to a few types of queries such as aggregation queries.

Federated learning [27] allows data silos to collaboratively train machine learning (ML) models while keeping the raw training data on each silo. However, it is unclear how to apply the approach to federated query processing.

Another learning-based approach [32] is to use a generative adversarial network to learn how to add noises to the private datasets with differential privacy guarantees so that the private information gets protected and the accuracy for predicting non-private information is maximized. However, such an approach relies on the users to manually specify the learning tasks.

In this work, we strive to provide differential privacy guarantees to a broader class of query types over data leveraging the new advancement in AI/ML. We propose a novel learning-based privacy-preserving mechanism, which uses deep learning models trained using differentially-private stochastic gradient descent (DP-SGD) [2] to replace the data and answer queries that involve

sensitive/private attributes. At runtime, The privacy-preserving model takes the input parameters of the query as features and predicts the query results. The model is trained over the training samples extracted from the private dataset to be protected. Because the training process is protected by DP-SGD, the approach is robust against membership inference attacks [35]. Intuitively, it indicates that the attacks cannot accurately infer whether a particular data point was part of the training dataset. We can thus leverage the advances in AI/ML and DP-SGD to balance the privacy, accuracy, and efficiency of query processing. For example, with increased accuracy of diversified AI/ML model architectures (e.g., foundation models) for image recognition tasks and natural language processing, we can fine-tune such models over private data to achieve high accuracy with a small privacy budget. Our approach can be applied to various types of queries over structured, semi-structured, and unstructured data, including images and texts. Our approach is more flexible than traditional SQL/federated queries with differential privacy (DP). One way to achieve DP is to perturb the data by adding Gaussian noise [15]. In Sec. 3, we show that our approach outperforms data perturbation using DP.

Motivating Example. In a border security check scenario, the officer in one airport wants to query the surveillance camera images from all US airports, trying to find out whether a passenger named Peter Derr has shown up in any airport(s) in the most recent week. Due to the data protection policy of the department of homeland security (DHS), each airport stores its own camera image datasets locally. The virtual collection of the datasets from all airports are called `virtual_surveillance_imgs_current_date`. The officer issues a query like "SELECT `img.location` FROM `virtual_surveillance_imgs_current_date` `img` JOIN `passengers` ON `match(passengers.pic, img) = True` WHERE `passengers.name` Like '%Peter Derr%' AND `passengers.datebirth`= '1982-06-05' AND `passengers.country` = 'UK' ". However, each airport is a separate data silo, and they do not directly share data because of data privacy concerns. Also, we could not simply push down query on the federated dataset `virtual_surveillance_imgs_current_date` to each airport data silo, because the officer does not want to disclose this query to any airport. To solve the problem, using the technology proposed in this paper, we will train a privacy-preserving deep learning model on each airport's local data using DP-SGD [2]. Given a photo of a passenger, the model predicts all locations of camera images that contain faces matching the photo. This way, each local data silo, which is used to train the model, is protected under the differential privacy guarantee by DP-SGD. It means no attacker can accurately infer whether a passenger exists in the dataset that is used to train the model. The model can be shared with the officer for querying information such as location, gender, sentiment, and activity, without disclosing the query to the airport.

Significant challenges lie in the complexity of identifying the sensitive part of the query to be replaced, the model architecture for replacing the sensitive sub-query, and the hyper-parameters for training the model. It would require a lot of human resources to manually figure out the optimal scheme and configurations for each query. The lack of declarative and automated tooling poses significant challenges for federated data management. To address this

problem, we further advocate for a novel privacy-preserving workflow. The workflow uses taint analysis to automatically identify sensitive sub-queries (Sec. 2.1). It uses a cost model to understand whether the proposed query-model transformation technique is better than baseline approaches such as directly perturbing the input data with a DP guarantee (Sec. 2.3). If the proposed technique is selected by the cost model, an AutoML model search process will be invoked to efficiently identify the optimal model search architecture (Sec. 2.5) that would strike a desired balance among privacy budget, utility (i.e., accuracy), and efficiency. The workflow further allows human experts to review and refine the selected plans.

(1) Privacy Information Specification. Users are allowed to label the attributes and tuples to specify private information that needs to be protected. In addition, the view-based access control policies as supported in most relational database management systems (RDBMSs), can also be used as input for the proposed system to understand the privacy requirements of the relations.

(2) Query Intermediate Representation (IR) and Taint Analysis. The queries over federated data silos will be automatically lowered to an IR that enhances relational algebra to efficiently identify sub-queries that involve sensitive attributes or tuples through taint analysis [9].

(3) Privacy-preserving Transformation Enumeration. The system will automatically enumerate possible privacy-preserving schemes based on the proposed model-query transformation technique. Those schemes can be applied to the sensitive sub-query as a transformation to the IR.

(4) Multi-Objective Cost-based Optimization. For each transformation, we use a multi-objective cost model that consists of a collection of surrogate models trained using contrastive learning [23] to evaluate its privacy, accuracy, and efficiency costs. The optimization process will search for Pareto-optimal schemes using a multi-objective evolutionary algorithm [10].

(5) Efficient Model Search based on Transfer Learning and Neural Architecture Search. Given a query-model transformation request (e.g., as recommended by the cost model), the system will first search for a pre-trained model that can be reused to implement the transformation through transfer learning [34]. Then it will search for the adaptive layer(s) [16, 17] to be inserted into the pre-trained model to meet the accuracy, privacy, and latency requirements. If there are no existing pre-trained models that match the task, then we use differential neural architecture search (DNAS) [25] to obtain a deep learning architecture and then train the model from scratch.

(6) Feedback. Finally, the human can review and modify the selected privacy-preserving mechanism for audit/compliance and optimization purposes. The final query execution latency and accuracy will also be recorded and used to refine the cost model.

We will demonstrate an end-to-end declarative privacy-preserving workflow for federated queries based on the proposed techniques from the data owner's and the data scientist's perspectives. We will also demonstrate how the proposed framework achieves flexible trade-offs among privacy, accuracy, and efficiency.

2 SYSTEM ARCHITECTURE

The proposed declarative privacy-preserving framework is illustrated in Figure 1. We describe the core components as follows:

2.1 Query IR and Taint Analysis

We enhanced the database catalog to have private attributes tainted. These information is directly specified by the data owners or extracted from the view-based access control policy specified by the data owners. Then once a data scientist issues a query, the query will be lowered to a graph-based IR based on the nested relational algebra, where each node represents a relational operator, and each edge represents a dataset, which could be a relation/view or a collection of objects, such as images, video, text files. The tainted sources will propagate the taint through the IR, so that the sensitive sub-queries that access private information are identified.

2.2 Privacy-Preserving Transformation

Theoretically, our proposed learning-based privacy-preserving mechanism based on the query-model transformation is applicable to various types of queries, whose input parameters and output can be closely captured by machine learning or deep learning models. For example, `SELECT Location FROM Arrival WHERE Name = $var1 AND Timestamp=$var2`, can be learnt as a model that maps $(\$var1, \$var2)$ to the location. After applying these query-model transformations, we only need to share the model and do not need to share the data anymore. To integrate with the federated query optimizer, we will abstract the process of learning a model to replace a sensitive query as a special type of query transformation rules, denoted as following:

(1) $\pi_A(\sigma_p(R)) \stackrel{R, \Delta_{auc}, \epsilon}{=} \lambda_f(A, p)$. π_A represents the projection operator that only keeps attributes in A in the output. $\sigma_p(R)$ represents a selection operator that selects tuples from dataset R based on the predicate p . The learnt model is abstracted into a model inference operator, denoted as $\lambda_f(A, p)$, which applies a model that takes A and p as input, and outputs the query results. Using this transformation rule, the query $\pi_A(\sigma_p(R))$ is transformed into $\lambda_f(A, p)$ with the privacy budget on the relation R , denoted as ϵ , and certain accuracy drop, denoted by Δ_{auc} .

(2) $\Sigma \pi_A(\sigma_p(R)) \stackrel{R, \Delta_{auc}, \epsilon}{=} \lambda_f(A, p)$. Aggregation represented by Σ is added to the output of the query $\pi_A(\sigma_p(R))$, $\lambda_f(A, p)$ is a model that takes A and p as input, and outputs the aggregation result.

(3) $\pi_{R.U}(R \bowtie_{R.a=S.b} S) \stackrel{R, \Delta_{auc}, \epsilon}{=} \lambda_f(S)$. Here, $R \bowtie_{R.a=S.b} S$ represents an equi-join of datasets R and S on the predicate $R.a = S.b$ (a is an attribute of R , and b is an attribute of S). The expression is transformed into a model $\lambda_f(S)$ that takes each tuple in S as input and outputs the projected attributes (i.e., $R.U$) of the corresponding tuple(s) in R . The privacy of relation R has thus been protected by using the model to replace it.

The query optimizer pushes down projections and selections to reduce the cardinality and arity of the sensitive (sub)queries to search for opportunities for applying these transformations.

2.3 Multi-Objective Cost-based Optimization

It is challenging to estimate the accuracy, privacy budget, and the latency for the proposed approach and decide whether it can meet

the service level agreement (SLA). Usually, we can only obtain these metrics through evaluation after the model training component returns the privacy-preserving model(s) for each transformation, which is time-consuming. To address the challenge, we leverage lightweight surrogate models to predict the costs for a privacy-preserving transformation without applying the model search and training process.

For simplicity, we train one surrogate model for each objective in a way resembling contrastive learning [23]. Given a pair of two query transformations $\langle t_i, t_j \rangle$, we label it as $y = 1$, if the cost of t_i is lower than t_j ; and $y = 0$, if otherwise. The surrogate model f_θ , which is a shallow neural network, predicts a cost for t_i and t_j respectively, and the contrastive loss is designed as $L(t_i, t_j, \theta) = y \times (\max(0, (f_\theta(t_i) - f_\theta(t_j))))^2 + (1 - y) \times (\max(0, f_\theta(t_j) - f_\theta(t_i)))^2$. The loss function penalizes the positive difference between $f_\theta(t_i)$ and $f_\theta(t_j)$ when $y = 1$, and penalizes the negative difference if otherwise.

The cost of a query transformation is estimated based on heuristics such as: (1) the smaller of the cardinality of the input features and output label space for a query model to be searched, the better accuracy and the smaller size for the trained model; (2) given similar accuracy, the privacy budget is proportional to the sizes of the model and the training dataset; (3) the inference latency is proportional to the size of the model; (4) the training latency is minimal if a pre-trained model (e.g., foundation model) can be reused; and so on. At runtime, the query optimizer will efficiently evaluate candidate plans using the surrogate models and output the optimal candidate plan. Then the privacy-preserving transformation(s) involved in the optimal candidate plan will be implemented using the approach. To continuously update the surrogate model, we select a subset of representative candidate privacy-preserving transformations to implement and evaluate their actual accuracy, privacy budget, and the inference latency at an offline stage utilizing idle system resources.

Given the costs predicted by each surrogate model for each objective, we formulate a multi-objective cost representation for each query transformation plan to search for Pareto-optimal plans using an evolutionary algorithm [10]. Motivated by the observation that a lot of Pareto-optimal plans are like each other in the costs for all objectives, we further reduce the query optimization time by only returning representative Pareto-optimal logical plans. Then for each specific service level agreement (SLA) provided by the user, the optimizer will efficiently return a Pareto-optimal plan that represents the most similar trade-off.

2.4 Parameter-Efficient Privacy-Preserving Training based on Public Foundation Models

When searching for query-model transformation schemes, we consider to reuse pre-trained models to reduce the training time [41]. Particularly, in order to improve the trade-off between accuracy and the privacy budget, our main idea is to search for one or more lightweight adaptive layers [16, 17, 24, 26] to connect to some foundation model [6] that is trained on large-scale public datasets, e.g. DeepFace [36] and FaceNet [33] for facial recognition, GPT-3 [8], BERT [12] for natural language processing, TabTransformer [18] for tabular data, ALIGN [20], CLIP [30], and DALL-E-2 [31] for multi-modal data.

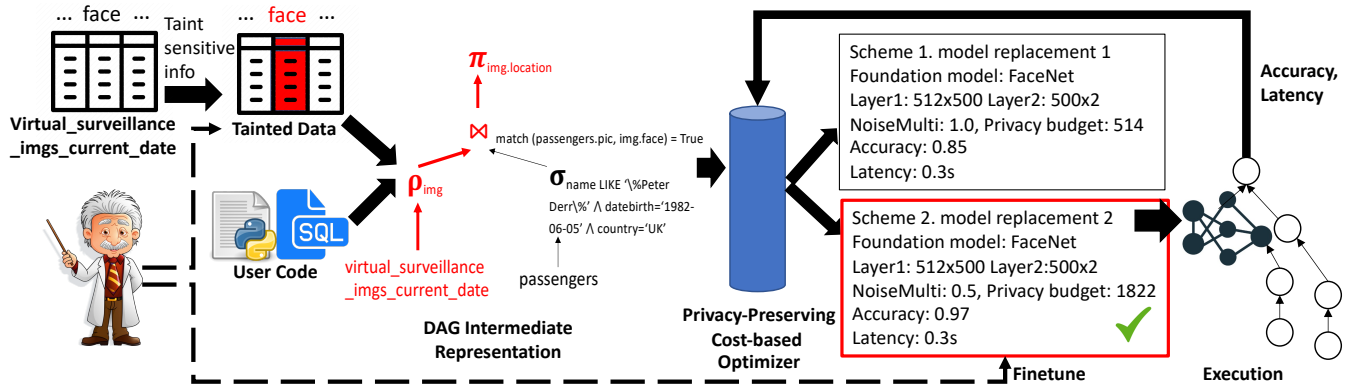

Figure 1: Overview of the proposed privacy-preserving workflow based on transforming query to model.

When training the model on the private dataset, the parameters of the foundation model are all frozen, and only the parameters of the adaptive layers will be trained using DP-SGD [40].

This has several benefits: (1) we can leverage the foundation model to achieve good accuracy while using only a small private training dataset and a few epochs; (2) the fewer number of training epochs further leads to smaller privacy budget [2].

2.5 Differentiable Neural Architecture Search

To find the optimal architecture of the neural network model with minimal human effort, we adopt a Differentiable Neural Architecture Search (DNAS) algorithm [38]. When a foundation model is found, DNAS will be used to search for the size of the adaptive layers; otherwise, DNAS will search for the architecture of a new model based on the modality of the data. In DNAS, the choices of various neural operations are characterized by a set of architecture parameters defined in a supergraph. DNAS searches for the optimal network architecture through gradient descent by optimizing both the prediction loss and the computation cost of the neural networks with respect to the architecture parameters and the network weights. In this demo paper, we specifically search for the optimal number of hidden layers and hidden units. In the search process, the network weights and the architecture parameters of the supergraph are iteratively optimized by SGD on the private data. Once the search is complete, we define the architecture of the neural network based on the optimized architecture parameters. Next, we reset the weights of the searched neural network to the initial random state and train it on the private data with privacy-preserving methods. Note that although DNAS is conducted on private data, it does not increase the privacy budget as the network weights of the supergraph will not be released. In our experiment, the range of hidden units is from 100 to 1000 with a step size of 10. Compared to a grid search over the whole search space that took 263 seconds, DNAS reduced the search time to 24 seconds.

3 DEMONSTRATION PROPOSAL

We will demonstrate a declarative privacy-preserving workflow for federated data management using the motivating scenario, as well as other use cases including social media queries. The steps are:

Step 1. Data Owners Annotate Sensitive Information. The data owners will label the attributes and tuples that contain private information for different user roles. Such information can also be automatically extracted from the traditional RDBMS view-based access control policies that are defined by the data owners. As illustrated in Figure 2 (1), under the view of another user, such as "DHS officer", the sensitive and insensitive information are listed, and a preview of the insensitive data is shown. The data owner can also specify the privacy-budget requirements for each private attribute/tuple.

Step 2. Query Request and Analysis. As illustrated in Figure 2 (2), after the data scientist will issue queries over federated datasets, an intermediate representation of the query is visualized and the sensitive sub-queries that involve private attributes is highlighted.

Step 3. Parameter Specification. The system recommends training and test parameters, such as accuracy and latency. The data scientist can change these default settings and choose to interactively tune the parameters, as illustrated in Figure 2 (3).

Step 4. Privacy-Preserving Recommendation. As illustrated in Figure 2 (4), the system will visualize the top k privacy-preserving schemes that are recommended by the system. These recommended schemes are sampled from the Pareto-optimal plans. For each privacy-preserving scheme, it will list the path to the pre-trained model, or the model architecture and hyper-parameters for training a new model, as well as the estimated accuracy, privacy budget, model size, and prediction latency, etc. The data scientist can modify some privacy parameters and some recommended model hyper-parameters according to the task requirement.

Step 5. Query Execution. Once the data scientist confirms the settings in the previous step, the system proceeds to apply DNAS to obtain adaptive layers or a full new model, and then train the adaptive layers or model using some training data. Then it runs the query with visualized query results and statistics such as training accuracy, privacy budget, model search time, training latency, and query latency, as shown in Figure 2 (5). This information will also be used to update the cost model for better cost estimation.

The above steps outline the process for developing privacy-preserving mechanisms for an analytics query.

We further demonstrate the advantages of the proposed approach based on query-model transformation. For example, as illustrated

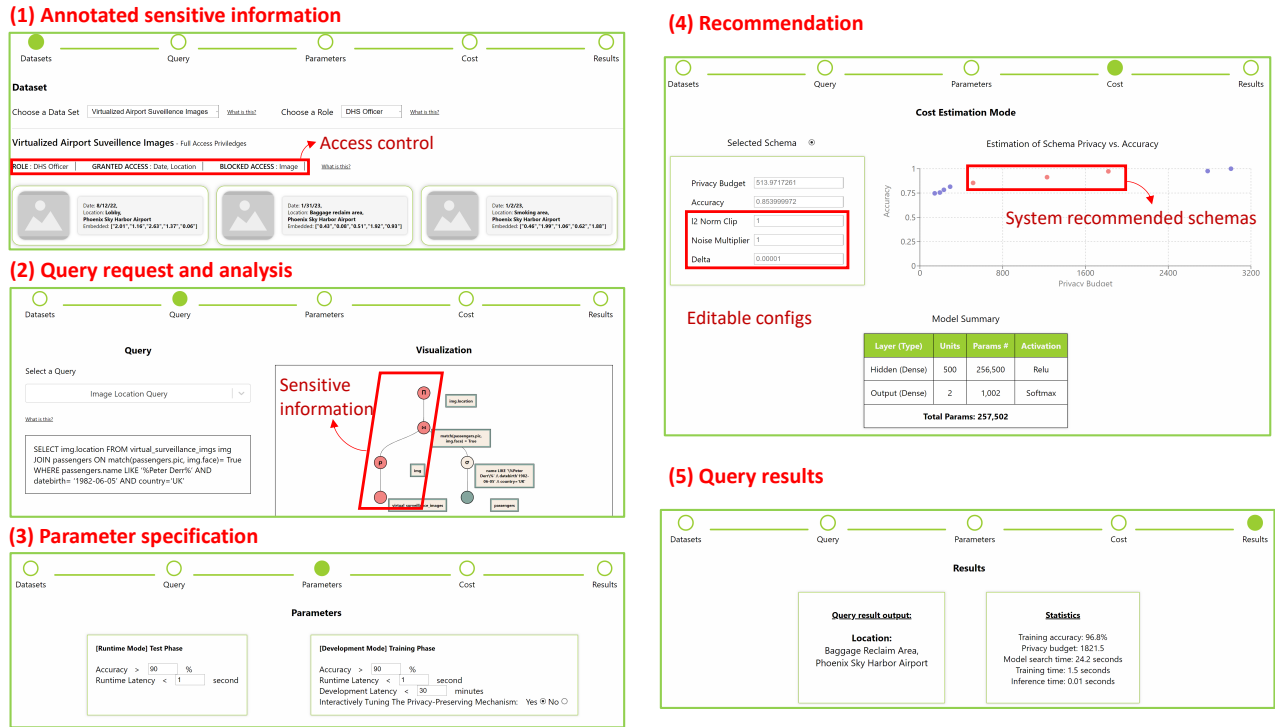

Figure 2: Illustration of the Demo and User Interfaces

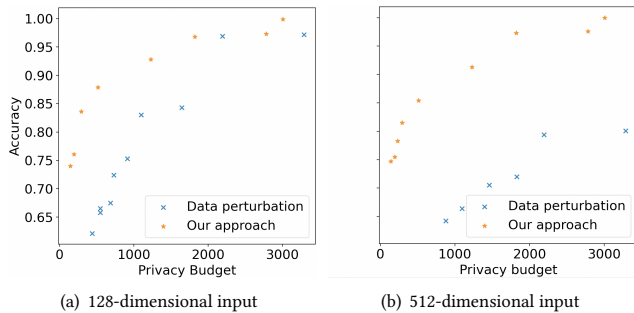

Figure 3: Privacy budget vs. Accuracy

In Figure 3, our approach can achieve better privacy-accuracy trade-off than perturbing input data using differential privacy (DP). The privacy budget for data perturbation is proportional to the data dimension, so with the same level of privacy budget, higher dimensional input achieved lower accuracy. In the demo, we show more detailed comparison of accuracy, privacy-budget, and the query execution latency of our proposed approach compared to various baseline approaches, such as encryption, secure multi-party computation, and approximate query processing based on differential privacy.

4 FUTURE WORKS

In the future, we will investigate how to extend the declarative privacy-preserving framework to deep learning workloads.

RDBMS supports fine-grained access control over logical views. Therefore, given a query, the database will automatically check whether the query issuer has the corresponding privileges to access the data involved in the query. In addition, recent research provides differential privacy (DP) guarantees to SQL queries [21] and is able to automatically add noise to the query results to meet a privacy budget. However, it remains a significant challenge to extend RDBMS security and privacy functionalities to the deep learning training and inference processes that rely on relational data managed in RDBMS.

While a lot of RDBMS systems are able to offload inference computations to deep learning frameworks. For example, Amazon Redshift offloads the inference to SageMaker, Microsoft Raven [22, 28] offloads the inference from Microsoft SQLServer to the ONNX runtime [11], and Google BigQuery offloads the inference to TensorFlow [1]. In addition, PostgresML offloads the inference of language models to HuggingFace Transformers [39]. None of the systems can extend RDBMS' fine-grained access control and differential privacy functionalities to the computations and data running in the deep learning runtimes.

To address the challenge, we argue that the model management platform should be carefully designed to expose sufficient information to the RDBMS to provide robust security and privacy protection against various DL model attacks [35, 37]. For example, if the model has been trained with differential privacy (e.g., using DP-SGD [2]), it should notify RDBMS about the DP parameters such as the privacy budget. If the model has been trained using the relations managed by the RDBMS, the RDBMS should also be able

to associate the model with its training datasets so that the access control policies defined over the training datasets can be passed to the model. In addition, the DB privileges may be extended to consider Train/Predict with a certain privacy guarantee in addition to Read/Write.

ACKNOWLEDGEMENT

This material is based upon work supported by the U.S. Department of Homeland Security under Grant Award Number 17STQAC00001-07-00.

DISCLAIMER

The views and conclusions contained in this document are those of the authors and should not be interpreted as necessarily representing the official policies, either expressed or implied, of the U.S. Department of Homeland Security.

REFERENCES

- Martin Abadi, Paul Barham, Jianmin Chen, Zhifeng Chen, Andy Davis, Jeffrey Dean, Matthieu Devin, Sanjay Ghemawat, Geoffrey Irving, Michael Isard, et al. 2016. Tensorflow: A system for large-scale machine learning. In *12th {USENIX} Symposium on Operating Systems Design and Implementation ({OSDI} 16)*. 265–283.
- Martin Abadi, Andy Chu, Ian Goodfellow, H Brendan McMahan, Ilya Mironov, Kunal Talwar, and Li Zhang. 2016. Deep learning with differential privacy. In *Proceedings of the 2016 ACM SIGSAC conference on computer and communications security*. 308–318.
- Johes Bater, Gregory Elliott, Craig Eggen, Satyender Goel, Abel Kho, and Jennie Rogers. 2017. SMCQL: secure querying for federated databases. *Proceedings of the VLDB Endowment* 10, 6 (2017), 673–684.
- Johes Bater, Xi He, William Ehrich, Ashwin Machanavajjhala, and Jennie Rogers. 2018. Shrinkwrap: efficient sql query processing in differentially private data federations. *Proceedings of the VLDB Endowment* 12, 3 (2018).
- Johes Bater, Yongjoo Park, Xi He, Xiao Wang, and Jennie Rogers. 2020. Saq: practical privacy-preserving approximate query processing for data federations. *Proceedings of the VLDB Endowment* 13, 12 (2020), 2691–2705.
- Rishi Bommasani, Drew A Hudson, Ehsan Adeli, Russ Altman, Simran Arora, Sydney von Arx, Michael S Bernstein, Jeannette Bohg, Antoine Bosselut, Emma Brunskill, et al. 2021. On the opportunities and risks of foundation models. *arXiv preprint arXiv:2108.07258* (2021).
- Christine L Borgman and Amy Brand. 2022. Data blind: Universities lag in capturing and exploiting data. *Science* 378, 6626 (2022), 1278–1281.
- Tom Brown, Benjamin Mann, Nick Ryder, Melanie Subbiah, Jared D Kaplan, Prafulla Dhariwal, Arvind Neelakantan, Pranav Shyam, Girish Sastry, Amanda Askell, et al. 2020. Language models are few-shot learners. *Advances in neural information processing systems* 33 (2020), 1877–1901.
- James Clause, Wanchun Li, and Alessandro Orso. 2007. Dytan: a generic dynamic taint analysis framework. In *Proceedings of the 2007 international symposium on Software testing and analysis*. 196–206.
- Carlos A Coello Coello and Gary B Lamont. 2004. *Applications of multi-objective evolutionary algorithms*. Vol. 1. World Scientific.
- ONNX Runtime developers. 2021. ONNX Runtime. <https://onnxruntime.ai/>. Version: x.y.z.
- Jacob Devlin, Ming-Wei Chang, Kenton Lee, and Kristina Toutanova. 2018. Bert: Pre-training of deep bidirectional transformers for language understanding. *arXiv preprint arXiv:1810.04805* (2018).
- Bolin Ding, Janardhan Kulkarni, and Sergey Yekhanin. 2017. Collecting telemetry data privately. *Advances in Neural Information Processing Systems* 30 (2017).
- John C Duchi, Michael I Jordan, and Martin J Wainwright. 2013. Local privacy and statistical minimax rates. In *2013 IEEE 54th Annual Symposium on Foundations of Computer Science*. IEEE, 429–438.
- Cynthia Dwork, Aaron Roth, et al. 2014. The algorithmic foundations of differential privacy. *Foundations and Trends® in Theoretical Computer Science* 9, 3–4 (2014), 211–407.
- Neil Houlsby, Andrei Giurgiu, Stanislaw Jastrzebski, Bruna Morrone, Quentin De Laroussilhe, Andrea Gesmundo, Mona Attariyan, and Sylvain Gelly. 2019. Parameter-efficient transfer learning for NLP. In *International Conference on Machine Learning*. PMLR, 2790–2799.
- Edward J Hu, Yelong Shen, Phillip Wallis, Zeyuan Allen-Zhu, Yuanzhi Li, Shean Wang, Lu Wang, and Weizhu Chen. 2021. Lora: Low-rank adaptation of large language models. *arXiv preprint arXiv:2106.09685* (2021).
- Xin Huang, Ashish Kheta, Milan Cvitkovic, and Zohar Karmin. 2020. Tabtransformer: Tabular data modeling using contextual embeddings. *arXiv preprint arXiv:2012.06678* (2020).
- Erica Jain. 2022. Evolving Consumer Expectations Are Driving Healthcare Innovation—For The Better. *Forbes* (2022). <https://www.forbes.com/sites/forbesbusinesscouncil/2023/02/17/evolving-consumer-expectations-are-driving-healthcare-innovation-for-the-better/?sh=4dda9c283891>
- Chao Jia, Yinfei Yang, Ye Xia, Yi-Ting Chen, Zarana Parekh, Hieu Pham, Quoc Le, Yun-Hsuan Sung, Zhen Li, and Tom Duerig. 2021. Scaling up visual and vision-language representation learning with noisy text supervision. In *International Conference on Machine Learning*. PMLR, 4904–4916.
- Noah Johnson, Joseph P Near, and Dawn Song. 2018. Towards practical differential privacy for SQL queries. *Proceedings of the VLDB Endowment* 11, 5 (2018), 526–539.
- Konstantinos Karanasos, Matteo Interlandi, Doris Xin, Fotis Psallidas, Rathijit Sen, Kwanghyun Park, Ivan Popivanov, Supun Nakandala, Subru Krishnan, Markus Weimer, et al. 2019. Extending relational query processing with ML inference. *arXiv preprint arXiv:1911.00231* (2019).
- Pramnay Khosla, Piotr Teterwak, Chen Wang, Aaron Sarna, Yonglong Tian, Phillip Isola, Aaron Maschiot, Ce Liu, and Dilip Krishnan. 2020. Supervised contrastive learning. *Advances in neural information processing systems* 33 (2020), 18661–18673.
- Xiang Lisa Li and Percy Liang. 2021. Prefix-tuning: Optimizing continuous prompts for generation. *arXiv preprint arXiv:2101.00190* (2021).
- Hanxiao Liu, Karen Simonyan, and Yiming Yang. 2018. Darts: Differentiable architecture search. *arXiv preprint arXiv:1806.09055* (2018).
- Yuning Mao, Lambert Mathias, Rui Hou, Amjad Almahairi, Hao Ma, Jiawei Han, Wen-tau Yih, and Madian Khabza. 2021. Unipelt: A unified framework for parameter-efficient language model tuning. *arXiv preprint arXiv:2110.07577* (2021).
- Brendan McMahan and Daniel Ramage. 2017. Federated learning: Collaborative machine learning without centralized training data. *Google Research Blog* 3 (2017).
- Kwanghyun Park, Karla Saur, Dalitsa Banda, Rathijit Sen, Matteo Interlandi, and Konstantinos Karanasos. 2022. End-to-end optimization of machine learning prediction queries. In *Proceedings of the 2022 International Conference on Management of Data*. 587–601.
- Raluca Ada Popa, Catherine MS Redfield, Nikolai Zeldovich, and Hari Balakrishnan. 2011. CryptDB: Protecting confidentiality with encrypted query processing. In *Proceedings of the twenty-third ACM symposium on operating systems principles*. 85–100.
- Alec Radford, Jong Wook Kim, Chris Hallacy, Aditya Ramesh, Gabriel Goh, Sandhini Agarwal, Girish Sastry, Amanda Askell, Pamela Mishkin, Jack Clark, et al. 2021. Learning transferable visual models from natural language supervision. In *International conference on machine learning*. PMLR, 8748–8763.
- Aditya Ramesh, Prafulla Dhariwal, Alex Nichol, Casey Chu, and Mark Chen. 2022. Hierarchical text-conditional image generation with clip latents. *arXiv preprint arXiv:2204.06125* (2022).
- Aria Rezaei, Chaowei Xiao, Jie Gao, Bo Li, and Sirajum Munir. 2018. Application-driven privacy-preserving data publishing with correlated attributes. *arXiv preprint arXiv:1812.10193* (2018).
- Florian Schroff, Dmitry Kalenichenko, and James Philbin. 2015. Facenet: A unified embedding for face recognition and clustering. In *Proceedings of the IEEE conference on computer vision and pattern recognition*. 815–823.
- Yongliang Shen, Kaitao Song, Xu Tan, Dongsheng Li, Weiming Lu, and Yueting Zhuang. 2023. Hugginggpt: Solving ai tasks with chatgpt and its friends in huggingface. *arXiv preprint arXiv:2303.17580* (2023).
- Reza Shokri, Marco Stronati, Congzheng Song, and Vitaly Shmatikov. 2017. Membership inference attacks against machine learning models. In *2017 IEEE symposium on security and privacy (SP)*. IEEE, 3–18.
- Yaniv Taigman, Ming Yang, Marc Aurelio Ranzato, and Lior Wolf. 2014. Deepface: Closing the gap to human-level performance in face verification. In *Proceedings of the IEEE conference on computer vision and pattern recognition*. 1701–1708.
- Florian Tramèr, Fan Zhang, Ari Juels, Michael K Reiter, and Thomas Ristenpart. 2016. Stealing machine learning models via prediction { APIs }. In *25th USENIX security symposium (USENIX Security 16)*. 601–618.
- Alvin Wan, Xiaoliang Dai, Peizhao Zhang, Zijian He, Yuandong Tian, Saining Xie, Bichen Wu, Matthew Yu, Tao Xu, Kan Chen, et al. 2020. Fbnetv2: Differentiable neural architecture search for spatial and channel dimensions. In *CVPR*.
- Thomas Wolf, Lysandre Debut, Victor Sanh, Julien Chaumond, Clement Delangue, Anthony Moi, Pierric Cistac, Tim Rault, Rémi Louf, Morgan Funtowicz, et al. 2019. Huggingface’s transformers: State-of-the-art natural language processing. *arXiv preprint arXiv:1910.03771* (2019).
- Da Yu, Saurabh Naik, Arturs Backurs, Sivakanth Gopi, Huseyin A Inan, Gautam Kamath, Janardhan Kulkarni, Yin Tat Lee, Andre Manoel, Lukas Wutschitz, et al. 2021. Differentially private fine-tuning of language models. *arXiv preprint arXiv:2110.06500* (2021).

- [41] Lixi Zhou, Arindam Jain, Zijie Wang, Amitabh Das, Yingzhen Yang, and Jia Zou. 2022. Benchmark of DNN Model Search at Deployment Time. In *Proceedings of the*

34th International Conference on Scientific and Statistical Database Management.