

Designing Data: Proactive Data Collection and Iteration for Machine Learning

Aspen Hopkins*
dataspen@mit.edu
Massachusetts Institute of
Technology
Cambridge, MA, USA

Fred Hohman
fredhohman@apple.com
Apple
Seattle, WA, USA

Luca Zappella
lzappella@apple.com
Apple
Barcelona, Spain

Xavier Suau Cuadros
xsuaucudros@apple.com
Apple
Barcelona, Spain

Dominik Moritz
domoritz@apple.com
Apple
Pittsburgh, PA, USA

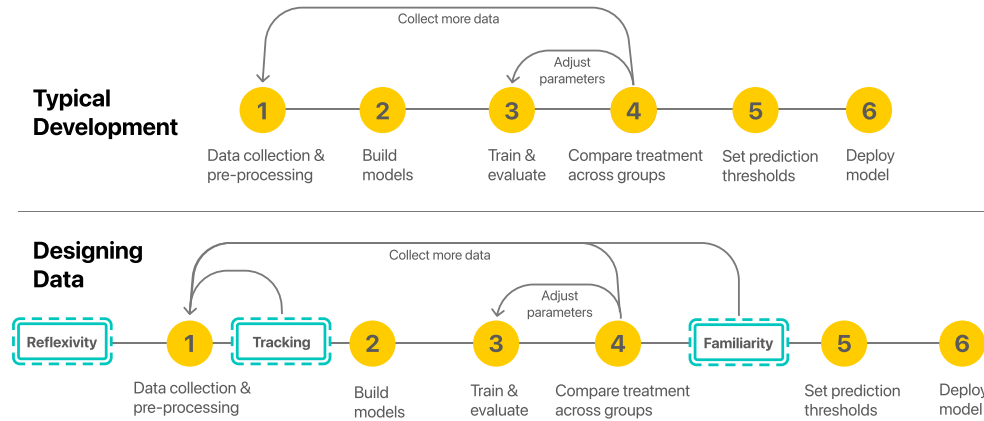

Figure 1: Designing data process compared to conventional machine learning development. *Reflexivity* ensures appropriate consideration of positionality and expectations is given before prior to collection. *Tracking* provides insight into unexpected trends during collection. *Familiarity* facilitates debugging and highlights potentially noisy or underrepresented subpopulations to direct iteration. This figure represents a simplification of the data collection process. The results of *Familiarity* can also be incorporated into training (after cleaning the dataset) and tracking (after training an initial model).

ABSTRACT

Lack of diversity in data collection has caused significant failures in machine learning (ML) applications. While ML developers perform post-collection interventions, these are time intensive and rarely comprehensive. Thus, new methods to track & manage data collection, iteration, and model training are necessary for evaluating whether datasets reflect real world variability. We present *designing data*, an iterative, bias mitigating approach to data collection connecting HCI concepts with ML techniques. Our process includes (1) Pre-Collection Planning, to reflexively prompt and document expected data distributions; (2) Collection Monitoring, to systematically encourage sampling diversity; and (3) Data Familiarity, to identify samples that are unfamiliar to a model through Out-of-Distribution (OOD) methods. We instantiate designing data through our own data collection and applied ML case study. We find models trained on “designed” datasets generalize better across intersectional groups than those trained on similarly sized but less

targeted datasets, and that data familiarity is effective for debugging datasets.

1 INTRODUCTION

Curating representative training and testing datasets is fundamental to developing robust, generalizable machine learning (ML) models. However, understanding what is representative for a specific task is an iterative process. ML practitioners need to change data, models, and their associated processes as they become more familiar with their modeling task, as the state of the world evolves, and as ML products are updated or maintained. Iteration directed by this evolving understanding seeks to improve model performance, often editing datasets to ensure desired outcomes. Failure to effectively recognize data quality and coverage needs can lead to biased ML models [53]. Such failures are responsible for the perpetuation—even exacerbation—of systemic power and access differentials and the deployment of inaccessible or defective product experiences. Yet building representative datasets is an arduous undertaking [68, 78] that relies on the efficacy of human-specified data requirements.

*Work done at Apple.

To ensure a dataset covers all, or as many, characteristics as possible, specifications must be the result of a comprehensive enumeration of possible categories—an open and hard problem that few have practically grappled with in the context of ML. Further contributing to this difficulty is the realization that it is not enough for the training datasets to be aligned with expected distributions: they must also include enough examples from conceptually harder or less common categories if said categories are to be learned [8]. Failure to sufficiently consider both the critical dimensions of data and their relative complexity can have troubling consequences. Instances of such missteps span issues of justice, healthcare, hiring practices, voice and face recognition, and loan qualifications, wherein biases of data and algorithms limit technological use and cause harm [6, 8, 15, 56, 59]. Yet understanding these data requirements even after training is difficult; knowing them *a priori* is exceptionally so. Enumerating critical axes along which data must be collected is at the discretion of teams responsible for collection; data coverage is ultimately influenced by the awareness of the collectors [36]. Prior work has shown that it is a significant challenge for data collection teams to do this enumeration, lacking effective tools for data planning [38], and as a result iteratively patch and recollect data as issues surface—a reactive and often expensive, time consuming process. Rather than emphasize tools that enable better collection and data iteration practices—that *design better data*—research in fairness and machine learning has largely focused on prescriptive “how-to” frameworks, definitions of fairness, and post-collection analysis techniques [5, 84]. While there are exceptions to this [35], the hidden technical debt [73] accumulated from poor data design remains an under explored space. To reduce this technical debt and encourage diverse datasets, methods of externalizing¹ data collection, iteration, and training are necessary checks for ensuring datasets reflect diverse experiences and are robust when deployed in real-world models.

We present *designing data*, an iterative, bias mitigating approach to data planning, collection, and ML development; we implement this approach in an interactive dashboard that scaffolds each step for practitioner use. Motivated by the thematic analysis of 24 semi-structured interviews with ML practitioners, designing data is a structured, holistic parallel to the current standards for developing production-quality datasets [35]. Each step (shown in Figure 1) proactively introduces interventions to improve models prior to deployment: (1) **Pre-Collection Planning** prioritizes reflexive consideration for domain and data needs prior to modeling, documents expected distributions of attributes, and highlights potential biases through questions related to class or characteristic representation within data. (2) **Collection Monitoring** communicates insight into dataset evolution, allowing users to make targeted adjustments to collection processes based on new insight or disparities between expected distributions and existing data. (3) **Data Familiarity** identifies data that an ML model, e.g., a neural network, perceives as unfamiliar, creating new directives for data and model iteration. We centralize the naturally disparate, iterative processes of data collection and model development through our *ML Collect* dashboard, encompassing each designing data step. Through *Pre-Collection*

Planning, axes of meta-information (such as demographics, behavioral specifics, or environmental factors) are documented along with their expected distributions. This documentation informs future data collection steps, and encourages reflexive thinking [76]. The metadata is used for evaluating evolving datasets and later for contextualizing familiarity scoring. *Collection Monitoring* describes data as it evolves, a response to prior work showing that externalizing data evolution enables process verification and discovering data missteps [35]. Finally, *Data Familiarity* highlights discrepancies between model performance and our expectations. Our familiarity metric incorporates density estimation, borrowing from Out-of-Distribution (OOD) work to characterize a model’s layer responses to a given sample. While density estimation for OOD detection is well studied [24], our use of density estimation to direct data work (e.g. collection and annotation) is unique. By gaining insight on how a partially trained model perceives data, we can focus efforts on the most useful subsets. In our experiments we use Gaussian Mixture Models (GMMs).² The log-likelihood of these densities is used to score how “familiar” samples are to the complex model: data that is unfamiliar to the model—falling within a region of low density—suggests the data are not as comparatively well-known to the model, highlighting a potential mismatch between the data composition and task requirements. These scores act as general tool to capture both uncommon and/or noisy data—user response is determined by the state of the dataset and model performance.

We demonstrate designing data’s effectiveness by auditing our own data collection and modeling task: a human activity recognition (HAR) task using inertial measurement units (IMU) data—time series data representing X, Y, and Z positioning—to classify hand position while texting, similar to a prior experiment by Goel et al. [26]. We collected IMU data from participants using our iOS data collection app, along with rich metadata describing behavior and participant characteristics. We reflect on our use of the ML Collect dashboard for our task in section 6, including multiple instances of retargeted data collection *before* modeling. Our task selection was inspired by the unique challenges faced in encouraging data diversity in IMU data [3, 67], but as designing data considers both pre- and post-training needs for building diverse datasets, it generalizes well across many data types; we chose a notably human-specific task in response to the myriad fairness issues faced when deploying ML, however each step can be treated as domain-agnostic.

Our experimental evaluation mimics a data collection and modeling task—first, we collected data iteratively, using our dashboard to build a more diverse set of data. We then trained convolutional neural networks (CNNs) using a leave-*P*-groups-out cross-validation. We find models trained on highly diverse data outperform models trained on less diverse data. Then, we evaluate models trained with data curated in response to familiarity scoring to those without. This includes two experimental comparisons: first, models trained on data wherein familiarity scores were used to highlight and replace noisy data compared to those without this intervention. Finally, we evaluate the models trained on data designed with and without data familiarity compared to randomly selected datasets.

¹For example, documenting design decisions and communicating the evolving state of the data.

²There are multiple approaches to density estimation. For simplicity’s sake, we only describe GMMs, but suggest [72, 81] for exploring alternatives.

In general, we find that models trained on more diverse data and with familiarity-based interventions outperform others.

Through our work, we argue that data cannot simply be collected but must be *designed*, intentionally curated for the sake of better models and technology. Designing data does this by optimizing for diversity early in data collection to ground designed data as fundamental to less biased, generalizable technology. It considers both pre- and post-training needs for building diverse, representative datasets for better models.

2 RELATED WORK

2.1 Reflexivity and Self-Reflection

Outside computer science, qualitative research and statistics communities have managed representative data collection in a variety of ways, from expert panels to standards in population survey techniques, yet these methods face their own complications and do not necessarily translate to the needs of machine learning teams. However, several methodologies remain underexplored by ML and ML-adjacent communities. Of these, *reflexivity* is particularly relevant to bias mitigation. Social scientists practice reflexivity to externalize implicit subjectivity present in data collection and interpretation [20, 23]. Reflexivity entails deliberately examining practitioners’ own assumptions, practices, and belief systems, then *contrasting* them with alternative perspectives. This acknowledges positionality—how differences in social position and power shape identities and access in society. While reflexivity is typically practiced retrospectively, Soedirgo and Glas [76] outlined how reflexivity could be an active process through “*ongoing reflection about our own social location and [...] our assumptions regarding others’ perceptions.*” This approach includes recording assumptions of positionality; routinizing reflexivity; including other actors in the process; and communicating reflexive outcomes with data.

Separate from yet related to reflexivity is recent data visualization work prompting viewers to reflect on their individual beliefs of data [33, 46]. Examples of this include The New York Times “You Draw It” visualizations, where readers draw a projected trendline of what they think the data looks like and then compare that projection with the real data [2, 14, 43], and an MIT Tech Review article illustrating the complexity of building fair recidivism models wherein readers change different hyperparameters then contrast their outcomes to existing models [30, 77]. Such visualizations act as powerful tools ensuring self-reflection—an important factor in building representative datasets.

When building datasets for ML, it is difficult to know what a population or phenomena looks like before collection. But because models learn what is encoded in data, data must be *designed* to reflect what a practitioner wants a model or user experience to be, not simply what is currently reflected in the world today. Our work leverages active reflexivity and visual prompts described above to force practitioners to consider not only what dimension of data they want to collect, but also what they want (or expect) their distributions to look like. These are represented in our ML Collect dashboard, the details of which are described in Section 4. Asking these questions upfront requires practitioners to consider concerns in their data instead of having them be an after-the-fact problem.

2.2 ML Documentation

Perhaps the closest alternative to *designing data* is model and dataset documentation, such as Model Cards [54] or Datasheets for Datasets [25]. Universally, such work details what to include within said documentation for transparency in downstream model and dataset use [7, 12, 48]. While important, these guidelines are not integrated within development tools and typically do not provide steps to improve model fairness. Further, the resulting documentation must be manually authored and updated separately from development. Model Cards, for example, are a retrospective documentation of a model’s intended use. The simplicity of the prompts has led to widespread adoption [38], a response to the lack of best practices in ML development. Model Cards do not encourage reconciliation of model weaknesses nor actively direct iteration for increased fairness—they are intended for transparency. Despite these limitations, the Model Cards framework has been used as a corrective measure in pursuit of fair ML. While Model Cards advocate for evaluation of model performance across different subpopulations, including demographic or cultural groups, we extend this key contribution to intersectional groups and embed it within our designing data process and dashboard. Through reflexivity and distribution prompts, we require users to actively surface and engage with their priors—and later guide evaluation for specific subpopulations and intersectional groups.

2.3 Bias Mitigation and Diversity Metrics

While examples of algorithmic bias are often highlighted by media outlets, this frequency belies the difficulty of initial discovery—failures are hard to uncover during development. Bias mitigation strategies can be divided into three stages of a ML model development: pre-training (e.g., sample weighting or dataset balancing), in-training (e.g., adding specific constraints in the function that is being optimized) and post-training (e.g., by tweaking the prediction to meet some fairness metric) [21]. Pre-training can be further divided into collection and post-collection. Despite the fundamental nature of data collection, technical approaches to bias mitigation typically focus on post-collection efforts—e.g., modification of the dataset, reweighting and fine-tuning of hyperparameters, filtering output, or some combination therein—which act largely as stopgaps, are sensitive to underlying data [83], and ultimately may not resolve underlying issues at hand.

For example, diversity metrics have been used to direct bias mitigation efforts post-collection [16]. While several methods of measuring diversity exist (e.g., distance-based, combinatorial, utility and ranking, and coverage metrics), the overall intention is to measure nuance of data based on variability of their constituent elements. Instances of this can be found in subset selection, where declarations of “diversity constraints” define expected frequencies for sensitive values that the data must satisfy [16, 17, 52], or to measure relative coverage within a dataset [8, 53, 85]. Uniformly, these methods act as stopgaps to biased and/or homogeneous data [17].

Producing diverse subsets using diversity metrics does not guarantee fairness across samples in the form of appropriate representation of sensitive attributes [17]. Partially, this is because their effectiveness relies on the extent of the dataset. But it is also because fairness has multiple measures [53]. Fair treatment across

social groups may also require *different things for different contexts*. For instance, consider a dataset in which each data point has a gender. One notion of group fairness, useful for ensuring that the ground truth is not distorted, is proportional representation, i.e., the distribution of sensitive characteristics in the output set should be identical to that of the input dataset. Another notion of fairness, argued necessary for reversing the effects of historical biases, could be equal representation where the representation of sensitive characteristics should be equal independent of the ratio in the input dataset. Mitchell et al. [53] described diversity and fairness as related but distinct concepts; diversity refers to the inherent variability of a dataset, while fairness describes equitable treatment across various attributes—aligning most closely with *group fairness* definitions. When working with data about people, we note that that it is exceptionally difficult to recognize what confers an “unfair” biasing effect, and that the consequences for ineffectively representing features within a dataset are generally negative. Thus, *designing data* adopts a diversity framing in pursuit of overall improvement when evaluating collected data.

2.4 Learnability and Familiarity

Diversity metrics largely consider what data is used in training and evaluation, but miss a fundamental element of ML behavior: *what concepts a model actually learns*. Having diverse characteristics with sample size parity in data is one step towards mitigating bias but does not ensure equitable learning across classes (or demographics). Additional complications arise when working with data acquired independently, possibly through a process in which the data scientist has little or no control. This “found data” [66] introduces unique challenges to ensuring data coverage for scientists and engineers. For both found and big data contexts, post-collection approaches such as subset selection with diversity constraints and class imbalance corrections are introduced to counter bias and skew [40] yet can obfuscate information about appearance frequency in a dataset: if there are limited examples of X and thus we oversample, those oversampled instances of X may cause the model to infer incorrect characteristics of a class, affecting accuracy metrics as well as production performance. Such approaches are useful but limited; for example, when improving a model without access to the original training dataset, balancing in the traditional sense is impossible. Regardless of the context, these data balancing approaches ignore data learnability: having an equal number of samples per class neglects the fact that some classes are inherently easier to learn than others [11, 47, 70].

Some concepts present increased complexity to a given model, requiring more samples to be appropriately learned. Unfortunately, this complexity might not become apparent until after deployment. In order to build better systems for deployment, discovering what has and has not been learned by a model is critical. In the past, testing data acted as a proxy for this evaluation—but while test datasets offer excellent thresholds for performance expectations, these are not the same measurements: testing accuracy measures whether a model was correct in its classification, without consideration for why a model reached its conclusion. For this reason, models are often poorly calibrated in their outcome confidence (e.g. when a model is incorrect yet overly confident in its classification).

Determining the learnability of a class or concept—whether it can be learned given a distribution of samples—is a space of ongoing research [11, 31]. Klawonn et al. [47] sought to exploit class learnability to increase generalizability. Using supervised training, they avoided harder classes, guiding their model to spend time on a class proportional to its learnability [47]. While useful in some contexts, avoiding difficult classes may harmfully bias models.

An alternative to such interventions is to incorporate the model itself as a guide for future iterations of data planning and collection. This can be accomplished by understanding the structure of a neural network, where each hidden layer within creates a new representation of the input data [58]. These concepts semantically vary based on the type of data—images, for example, are roughly learned by early layers detecting edges whereas later layers learn more sophisticated shapes and objects. How a layer (or layers) in a model responds to a given data point can be measured, then used to estimate densities across an embedding space. These embeddings are vectorized representations of data, meaning similar points are closer in distance than others, according to a specific model. Points that fall into a densely populated region (meaning many similar samples were been learned in training) as *familiar* to a model. Conversely, points that fall into scarcely populated areas are unfamiliar, or uncommon [75].

This approach holds methodological similarities to detecting samples that are Out-of-Distribution (OOD) to the training dataset [24, 49]. Our implementation of density estimation—described at length in Section 9—is most similar to Lee et al. [49], who use density estimation for detecting anomalous samples *post*-training (e.g., adversarial attacks), as is common with OOD applications. These methods are typically used to highlight cases when a model will likely fail (such as to determine when to return control to drivers of autonomous vehicles). In contrast, we detect interesting data samples to contribute to our training optimization. We note that it is our application of density estimation (not the technique itself) which is the contribution of note, as it has not previously been incorporated into directing data work.

Our use of density estimation is a response to two drawbacks we note from work incorporating diversity metrics to improve data representation and model performance: (1) diversity metrics require *prior awareness* of what facets of the data are variable—for data that people are unaccustomed to, this might be impossible—and (2) measuring diversity within a given dataset does not account for what the model actually *learns* or is robust to [37, 71]. Because it is *model* outputs that we are ultimately concerned for, these are important weaknesses to counter.

3 FORMATIVE INTERVIEWS AND DATA COLLECTION THEMES

To understand ML practitioners’ data collection needs, we conducted 24 semi-structured exploratory interviews with individuals possessing extensive machine learning and data collection experience within a large technology company. The interviewees ranged from ML research scientists and designers focused on ML experiences to engineering product managers. Interviews lasted on



Figure 2: (A) Jupyter notebook dashboard guides practitioners interactively through designing their datasets. **(B)** Before collection, the dashboard prompts documentation of expected data distribution. **(C)** These expectations are visualized as histograms in an interactive dashboard. **(D)** As data is collected, data distributions (pink) overlay expected distributions (blue), highlighting divergent patterns.

average one hour. As interviews progressed, common themes surfaced that directed our attention to issues of data coverage and representation. We describe those themes (T1-T3) below.

3.0.1 Critical dimensions of data are hard to know a priori (T1). A proactive approach to data collection requires knowing what axes are important for observation, particularly when focused on a given task. As one interviewee put it, “*how do we know who and what is missing?*”. While it is typically impossible to have a complete understanding of such critical dimensions of the data before starting data collection, there are some common characteristics for

human-centric data collection based on existing knowledge of population statistics and power imbalances. This was a shared difficulty described in nearly all interviews. How useful that information is depends on the context of how the data is used—for example, a person’s accent, language patterns, speech pathology, and history are all important factors in speech recognition, but not for creating a personalized wine recommendation. Unlike summary statistics, surfacing individual sample failures and uncovering what is missing in data subsets, essentially “debugging” data, requires significant effort. As another interviewee said, “*fairness analysis is useful to a point*”. Generic tools and dashboards for surfacing these nuanced

limitations of data do not exist, but there is both a clear need and a desire from ML practitioners for them [36].

3.0.2 Difficulty of collection leads to compromises (T2). Data collection is a difficult process to launch, requiring significant tooling and systems building. This difficulty contributes to issues of representation in data, as the emphasis in early data collection is on *how* to collect and structure data rather than building a complete picture of *what* to collect for. Further, early data collection efforts tend to prototypes, making convenience sampling canon. In cases of human-centric data, such as speech or movement, such requirements can encumber coverage of diverse participants across many axes (e.g., age, race, gender, and education). These circumstances have the potential to inhibit generalizing machine learning systems—while there is a natural iteration in datasets stemming from dataset shift—as the world changes and training data is no longer relevant [64]—and collectors’ evolving understanding, it is a cycle full of (in some cases unnecessary) forking paths [35, 42] and dead-ends.

3.0.3 Model failures are invisible without participation and iteration (T3). Real world failures are only visible when communicated. But that communication only comes from those invested enough in the tool, system, or research agenda to make the effort to bridge the communication gap. To quote an interviewee that described this dilemma: “*The people who had issues were invisible to the system because they didn’t like using it*”. While typical marketing and product development practices incorporate focus groups, product ratings, reviews, and surveys, and customer service departments to direct decision making, software development tools like issue trackers are relied on to flag problems engineers and developers encounter (a particularly important function as a body of code grows with time). Similar methods of closely engaging people with creators exist in a variety of environments such as polling and design methodologies. However, there are no tools that address the gap between a deployed ML product (let alone its early prototype) and a user. Such gaps are widened by language and knowledge barriers, and the products themselves are inaccessible to many that do not align with the priors on which the system is built, an effect that arises from missing critical dimensions of data. As these limitations can have substantial downstream impacts, we sought to introduce early, comprehensive data & model checks to facilitate agile pivoting in our development of designing data.

4 DESIGNING DATA

Existing bias mitigation and model evaluation approaches attempt to address the themes uncovered in our formative interviews but are not comprehensive to data collection *and* machine learning pipelines. In response to this disparity, we propose an iterative, bias mitigating approach to data collection and machine learning that we call *designing data*. Designing data responds to our themes by introducing interventions before, during, and after collection and training. Shown in Figure 1, each step ensures datasets are intentionally curated from both a bottom-up and top-down perspective—meaning from both the data and the model view. These steps are intended to complement existing bias mitigation strategies rather than replace them. Designing data incorporates interdisciplinary

strategies drawn from ethnography, data visualization, and ML domains. We developed designing data for cases where data is collected from scratch (a common scenario outside academia), but individual steps are easily adapted to other contexts. We describe the steps below before instantiating them in a human activity recognition (HAR) task (Section 5).

4.1 Pre-Collection Planning

To facilitate broader consideration of potentially critical facets of data, data design requires explicit documentation of *what* will be collected—including expected dimensions and distributions of data—*before* collection begins. Our documentation process ensures developers pay close attention to data diversity and coverage early in an ML pipeline and creates reference points for reflection when new information is uncovered. This process aligns with prior work in heuristics, implicit bias, cognition, and fake news susceptibility: deliberation—*reflection*—can correct and expose intuitive mistakes, such as those seen in data collection decision making [9, 62, 69, 79].

Our dashboard ensures close attention to data diversity through a series of open-text prompts, drop-down selections, and simple declarations for the users to complete. When the data relates to a human subject (i.e., images of faces, movement data, or voice recordings), the dashboard prompts self-reported demographic information about teams or individual users involved in developing the dataset. These answers are used to prompt consideration for communities not represented within the team—in explicitly referencing, for example, gender or age-related discrepancies, teams are encouraged to consult with individuals from these communities. While we focused our efforts on a human-centered task, this approach can be extended to other contexts. For example, when collecting mineralogical data, a geologist might be asked to document assumptions about a particular geographical and temporal region. Following this period of self-reflection, users are asked what data distributions they expect. Further descriptions of the dashboard can be found under Section 5.3. An example of the dimensions and related distributions set by users is shown in Figure 2.

This reflexive process is simple yet uncommon to the ML community at large. In the case of inertial measurement unit (IMU) data, it appears relatively straightforward to collect data for an activity such as texting: simply record the movement that occurs during that activity. But a common pitfall in data collection is the absence of descriptive information on the recorded subject—in general, demographic information, contexts, and other potentially impactful factors are rarely considered until arguably too late in model development—after initial deployment, and even publication of datasets [19]. This extends to IMU data as well. The absence of such meta-information has major implications for if a model generalizes well: how do you know broad applicability of a model if you have not articulated rudimentary limitations of underlying data? While it is difficult to enumerate all critical factors, the first step in our designing data process provides scaffolding to start, responding to concerns listed in our first and second themes: *critical dimensions of data are hard to know a priori (T1)*, and *difficulty of collection leads to compromises (T2)*.

4.2 Collection Monitoring

By stating expected distributions prior to collection, auditing the data against those distributions is straightforward, allowing readjustments to be made quickly when necessary. Our dashboard includes graphs highlighting distribution disparities that were perpetuated or introduced as the data was collected, as shown in Figure 2 (D). These charts benefit users by noting when the data collection process is either skewed (for example, through convenience sampling) or when previously stated expectations did not align with reality. The iterative nature of this step—collecting data, checking, then adapting data collection—shortens the response time to correct fundamental errors in data. It highlights limitations that might previously have remained unnoticed, as previously described in our third theme: *Model failures are invisible without participation and iteration* (T3).

4.3 Data Familiarity

The purpose of designing data is not to replace existing tools, but rather to encourage a holistic approach that incorporates existing ML techniques for bias mitigation. As such, for interventions *during training*, we refer to existing literature [40, 55]. After a model has been trained, however, understanding how well the model has learned the data (and the data that it has not) is critical prior to deployment. The value in this form of model auditing is significant: some data may prove more difficult to learn due to their inherent complexity, or from not having enough similar examples. Despite increased rigor in data collection, expected and actual distributions might not match the learning needs for the model, thus requiring a stop gap such as under or oversampling, generating synthetic data, or continued data collection. We incorporate *data familiarity* values as a measure of how familiar, or well learned, our model is to individual data points. We describe familiarity scoring in detail in Section 5. In this way, we ensure that low familiarity data points or “edge cases”—those that either do not have enough representation in the dataset or are particularly difficult for a model to learn—are caught early and responded to by reweighting or replacing data (as is the case when the data is mislabeled). Data familiarity offers a final check on the model and data, since critical axes in data are difficult to know a priori. While we use familiarity scores to uncover cases the model does not understand as well, this is useless if the dataset itself has insufficient coverage. Thus collecting better data that encompasses natural variability and checking how a model responds to said data are both critical. In this way, we again respond to our second (T2) and third themes (T3).

METHODOLOGY

5.1 Task Selection

We instantiated our designing data approach through a human activity recognition (HAR) task using *inertial measurement unit* (IMU) data—time series data representing motion along X, Y, and Z axes. While designing data generally applies to all data collection and machine learning processes, our selection of data type and task were motivated by the unique challenges IMU data presents to building data diversity.

First, IMU data inherently lacks the closeness of mapping [13] that image and audio data have to human mental models of the world, making it more difficult to audit. Recognizing when IMU data coverage is incomplete can be difficult when compared to image data as levels of abstraction act to obfuscate fundamental problems in a dataset [10, 66]). Second, IMU data requires contextualization to create meaning—real-time labeling, or additional information from audio and video—and is harder to collect in real world scenarios, unlike images and audio clips which are now ubiquitous [66]. Yet IMU data still has the potential to bias ML models in key contexts. Thus, applying designing data in this context provides great added value and proves its merit under a typically challenging context.

Our experimental task resembles work by Goel et al. [26], who improved mobile text entry by categorizing different hand positions when users typed. We simplified the task to binary handedness (typing with the left or right hand), but introduced a source of natural variability by prompting users to perform a series of actions in parallel while typing. This contrasts Goel et al. [26], who collected data while users sat in a lab environment. Data was collected using an iOS app developed in Swift. Collected data from our participants was saved to an encrypted database. Throughout the case study, we used this data to populate our dashboard, train and evaluate our IMU classifiers, then refine our dataset according to familiarity evaluations. We describe each step in detail below.

5.2 Data Collection

We built a custom iOS app for data collection using the Swift programming language with public frameworks including SwiftUI, CommonCrypto, and CoreMotion. The app collects right and left-handed texting data across different contexts people may type in, such as texting while walking or laying down. Example views of the app are shown in Figure 3. All data were collected with informed consent. We introduced 6 typing scenarios (walking, sitting, standing, lying on your back, lying on your side, and lying on your front) to represent a selection of possible contexts users might normally experience typing. Participants were then asked to type an English phrase from MacKenzie and Soukoreff’s phrase set [51] using their left or right hand for a total of $6 \text{ (positions)} \times 4 \text{ (typing sessions)} \times 2 \text{ (hands)} = 72 \text{ trials}$. Entered phrases were recorded as a trial. The app disabled keyboard auto-complete and autocorrect. Beginning when people pressed “start”, we collected data at a sampling rate of 200 Hz. When the task is finished, metadata, IMU data, and trial metadata (including scenario, phrase, keyboard recording, and session time) were pushed to our database. In total, we collected > 3.88 million measurements from 1455 sessions.

Before collecting IMU data, participants were asked to sign an informed consent letter and provide demographic information and metadata. This information included race (as defined by the 2020 US Census), ethnicity, gender, sex, age, hand length (measured in millimeters) and nail length (measured in millimeters), hand dominance, phone version and phone size. Participants were automatically redirected to the iOS *Measure* app to determine hand and nail length.

We collected data from 33 participants recruited over three separate periods in response to data disparities highlighted by our ML

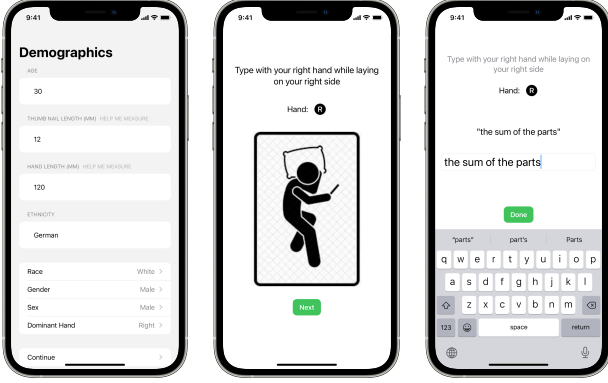

Figure 3: Our IMU Data Collection App showing the primary screens of the study. Participants entered their demographic information such as hand dominance, hand and nail length, sex and gender, and age (left). The app instructs a participant to type on their phone using either their right or left hand in a physical configuration (middle). Participants then type the presented phrase (right).

Collect dashboard. Self-reported gender was 36% female, 64% male (with reported sex the same). Participants identified their race as Black or African American, Asian, Multiple/Other, and White. Ages ranged from 24–62. We later bin these ages in the following ranges: 18–24, 25–34, 35–44, 45–54, and 55–64.³

5.3 Dashboard

We built our dashboard in JupyterLab using Altair [80], a declarative visualization library for Python, and Ipywidgets [27]. As shown in Figure 2 (A), the dashboard asks a series of questions to prompt reflexive consideration for the team or individuals personal biases. Using drop-down selections, they are asked to describe their team’s representational make-up—including race, accessibility needs, age, sex and gender identities. After filling out this information, users are told: *“The following groups and their subsequent intersections are not participating in your project development. To ensure an optimal result, take steps to consider how their experiences and views might differ from the currently represented ones.”* This notice is followed by a list of demographic information not identified by the users. This is an important step: prior work has shown that simply recognizing such information [23, 45], and introducing design frictions [28, 61], can increase the quality and consideration that goes into data work.

One limitation to this procedural approach is how scoped our questions are—they are not all-encompassing, but intended to start the process of reflection and inquiry early on. As a final step in this reflexive process, and to minimize this limitation, a series of open-ended questions that take in free-form text asks, “What’s missing, in the context of your project?” followed by some examples

³We recognize our data is limited to a subset of the broader population. This work is intended as a proof of concept rather than a production quality system, and thus perfectly encapsulates the very concerns we describe in developing early machine learning prototypes. By emphasizing data diversity *even in this setting*, we intend to validate the use of interventional measures to simultaneously highlight next steps in data collection, and improve the data one can collect.

that expand on axes of diversity teams might need to consider. Users are then asked to enter expected dimensions and distributions of data before collecting data (Figure 2 B,C). When distributions have incorrect values (i.e., do not add up to 100%), the dashboard normalizes. This active expression of expected data encourages users to acknowledge and document the specific limitations of their data, setting a precedent of conscious decision making from the beginning. It creates a simple provenance for early assumptions and a baseline to evaluate against during data collection.

From these inputted dimensions, audits of population statistics, missing data, and undersampled subsets are presented to users, reflecting *During Collection*. New dimensions can be added as needed. Different categories of the data, including demographic information and metadata (described in the participant subsection), task specifics, and class representation are then shown in visualizations Figure 2. Similarly, intersectional categories (such as age *and* hand size) are shown. This view reflects the data evolution as more data is collected, allowing real-time insight into what additional collection might be required. Following collection, the dashboard allows users to use a pre-trained model or train their own. Following training, saved states of a neural network and model architecture are loaded into our familiarity functions. Data is inputted to build out familiarity scores, the final step in our designing data process.

5.4 Familiarity

To measure the familiarity of the data, we incorporate density estimates of layer activations across a neural network (NN). Different layers of NN capture different features of the input data [58]. Familiarity scores can therefore be extracted from any layer. Earlier layers capture fundamental structure found in the input data, while deeper layers capture semantic content. In this paper we focus on the penultimate layer, the layer before the prediction softmax, as it is the final feature representation used to make a prediction. Passing N inputs through the network produces an activation matrix $A(N) \in \mathbb{R}^{N \times M}$ for all M neurons in subset of selected layers $L' \subseteq L$. We learn a Gaussian Mixture model on the activations of a layer as a representation of the whole training set, given by the following:

$$p(x|\lambda) = \sum_{i=1}^M w_i g(x | \mu_i, \Sigma_i) \quad (1)$$

where x is a matrix of layer activations, $w_i, i = 1, \dots, M$ are the mixture weights, and $g(x|\mu_i, \Sigma_i), i = 1, \dots, M$ are the component Gaussian densities. Note, this mode of density estimation is interchangeable with other density estimation or out-of-distribution methods such as [49, 81]. For each data point sample in the current training set, we obtain the activations from layer l and compute a dimensionality reduction from the original space using PCA. This projection step serves two purposes: it reduces the “dispersion” of points that is typical of high dimensional spaces (a NN activation can easily have thousands of dimensions, hence, each point is likely to be isolated), and it makes the remainder of the computation more tractable. In the projected space we then perform a Variational Bayesian estimation of a Gaussian mixture [86]. The fitted GMM is the tool that allows us to give a familiarity score to each new sample. Given a sample, we can then extract the activation from the same layer l , apply the same dimensionality reduction and then

evaluate the log-likelihood provided by the fitted GMM—our familiarity score. If the sample falls into a densely populated area, its log-likelihood will be high: from the perspective of the features extracted by the current state of layer l , this sample appears as common or *familiar*. Conversely, if the sample falls into a scarcely populated area, its GMM log-likelihood will be low and we infer that the sample is rare in relationship to the features extracted by layer l . This familiarity measurement can be applied to new samples previously unseen by the model or on existing training samples.

Unfamiliar samples are “edge cases”—those that either do not have enough representation in the dataset, are particularly difficult for a model to learn, or erroneous collected data (e.g., noise). In early dataset development, familiarity scores act as useful checks for data with little signal—samples where we expect the model to perform well yet *may* be noisy and thus require human inspection. Note that the same data shown to a different model is likely to obtain a different familiarity score. That is, each sample is tightly coupled to how a specific model perceives it. This analysis cannot be done on the dataset without the guidance of a trained model. Familiarity scores are presented in the dashboard through a series of graphs depicting their range and frequency, providing users insight on how familiar individual samples are to a given model.

5.5 Modeling

We followed the generic *Activity Recognition Chain*, which includes pre-processing, segmentation, feature extraction, and classification steps [18]. Instead of explicitly extracting features, we used 1D convolutional neural nets (CNN) for sequence classification. The CNN’s architecture performs feature extraction through the convolution of the input signal with a kernel (or filter). Our architecture included: two 1D convolutional layers (standard for time series data), max-pooling layers, a dropout layer, a fully connected dense layer with ReLU activations, and a fully connected dense layer with softmax activations. To pre-process data, each session was segmented into 200ms windows, with 40ms overlap between segments. Session timing varied by how long it took participants to finish typing a given phrase. We corrected our IMU dataset to account for gravitational acceleration effects, then normalized (using a direct current blocker) and segmented IMU data in series to ensure all windows were of equal length. We discarded windows containing data from multiple sessions.

Training batch sizes were 256 (batch)×200 (ms)×3 (IMU), where *ms* is the window of time, *batch* is the batch size, and IMU represents the three accelerometer data sources.

6 CASE STUDY: REFLECTING ON OUR DATA COLLECTION PROCESS

It was unclear how diverse IMU data would influence our modeling experiments, or if the categories developed through our reflexive prompts would meaningfully align with variation within the data. Prior work on human gestures has shown age [50], emotion [57], and health [60] influence movement and gesture presentation. Hand position during typing is similarly distinguishable [26], yet IMU data collection rarely includes meta information about participants. Similarly, context is often not documented for image data (e.g. the proverbial question of *what’s outside the frame?*).

We incorporated our dashboard’s *Pre-Collection* suite of prompts in our own IMU data collection to determine what characteristics to collect for. It was through these prompts that we realized a need to measure additional information as typical demographics did not capture how people held their phones. We noted that Phone Size, Hand Size, Handedness, and Nail Length (particularly in the case of acrylic nails) may play a role in how people text, despite not being variables typically considered in such tasks. It was also through this process of reflecting on impactful features that we realized the advantages of asking participants to act out various behaviors during their typing tasks. This meaningfully shaped our task. Other measurements that were noted during this process would have added substantial complexity to our collection procedure. Most prominent of these was hand strength and dexterity. These features are impactful to how individuals type—a person with carpal tunnel or arthritis will type differently compared to someone without these conditions—but required additional tooling to accurately capture. Instead, we noted strength and dexterity for future evaluation, to be completed prior to public deployment.

The results of *Collection Monitoring* led to three instances of additional, retargeted data collection efforts based on unexpected or previously unnoticed skew. During our initial data collection, there were multiple categories which did not match our previously described expected distributions. We call out several in Figure 4 to demonstrate the outcomes of our data collection re-targeting. While all participants were employees from a large tech company, we did not anticipate our initial wave of data collection to be so skewed towards individuals between the ages of 21 and 40. In truth, we initially had no participants over the age of 38 and were concerned that this absence would limit representation within the dataset of alternative typing patterns seen in older populations. As a result, we emphasized diversity in participant age moving forward, with some success—each consecutive wave improved the data coverage. Similarly, we noted that the majority of our participants self-described as White, but that there were no Black or Indigenous participants whatsoever. Despite our best attempts, this was only partially amended; in optimizing across intersectional groups, we were not able to perfectly match our expected or updated distributions (at least within the context of this set of iterations). In contrast, our initially collected Handedness distribution perfectly matched our expectations. This prompted a discussion of whether this distribution was actually reasonable—despite matching the ratio of left versus right handedness in US populations, we believed that right and left handed individuals would type in dramatically different ways, thus may require sample size parity to be appropriately learned by the model.

Collection Monitoring also provided us with the impetus to explore intersectional groups early on. We noted there was no representation of Black and Female with Small phone sizes (or people who identified as female or non-binary in general). Finally, we noted an unexpected flaw in our data collection methodology through Collection Monitoring. Initial scene data *should* have been equally represented across all scenes, however there were slightly fewer instances of `standing_right` compared to other scenes. We realized this was due to a small error in how the scenes were randomly presented participants and fixed this moving forward. Because we were tracking our distributions *while* collecting data, we were able

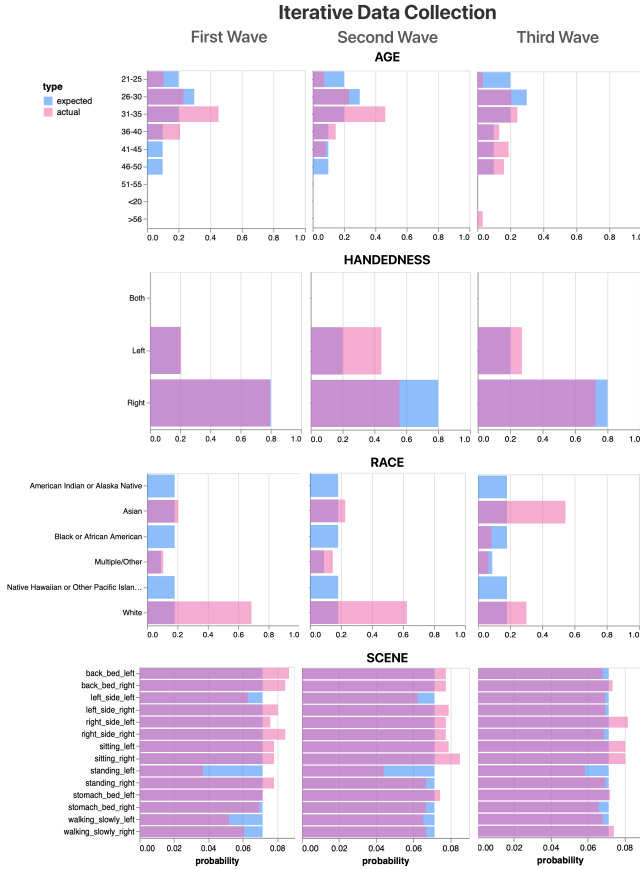

Figure 4: Selected views of data distributions across three different waves of data collection. Each new iteration of data collection was the result of evolving understanding about the data. For *Age*, initially there were no participants over the age of 38. *Handedness* initially met expected distributions, however these did not match downstream needs. In *Race*, there was substantial skew for White participants. An error in data collection led to a skew in which scenes were presented to participants.

to ameliorate data coverage and capture unexpected bugs early without slowing downstream development.

Finally, while we discuss our evaluation of familiarity at length in Section 9, we note that familiarity redirected our collection efforts in several instances. For one, it led us to seek out additional data for an intersectional subset for Female participants with Large phones and Small hands, as several of these samples were counted among the least familiar. We later realized that a number of data points were noisy, thus the additional data replaced noisy data in the intersectional subset rather than augmenting it.

7 MODELING EXPERIMENTS

The ability to produce diverse subsets using diversity metrics does not guarantee appropriate representation of sensitive attributes.

Partially, this is because fairness has multiple measures. Fair treatment across social groups may require different things for different contexts. Consider a dataset in which each data point has a gender. One notion of group fairness is proportional representation, i.e., the distribution of sensitive characteristics in the output set should be identical to that of the input dataset. While useful for ensuring ground truth is not distorted, it may not preclude biased outcomes. Another notion of fairness (argued as necessary for reversing the effects of historical inequality) argues that truly equitable representation within datasets requires sensitive characteristics (e.g., gender or race) be equal, independent of the true ratio present in the input dataset. Increasingly, fairness research has considered not the dataset distributions themselves but rather a model’s error rates across demographics (e.g., [41]). In this paper, our approach to encouraging fair outcomes considers the amalgamation of both data and model. The following experiments adapt the former definition of fairness—rather than seek a high *average* accuracy across classes, we look at nuanced performance—accuracy, loss, and misclassification—between intersectional groups. To this end, we consider several questions as part of our designing data evaluation:

Q1. Does auditing across our documented categories to increase data diversity improve model generalizability?

This has two-fold implications. We do not know if the categories developed during our Pre-Collection step describe context that is *meaningful* to a model. These are not features explicitly learned by the model but rather metadata describing the contexts of the time series data. We anticipate datasets audited for diversity will perform better across intersectional groups.

Q2. Is data familiarity useful in auditing model + data?

Similar to the prior question, there are two motivations here. First, familiarity can be used to *debug* a dataset—to uncover noisy examples and remove or replace them. Second, familiarity can be used to *direct* data iteration—to recognize what samples are out of distribution (unfamiliar) to the model, therefore highlighting what additional collection must be taken before a model is deployed. We expect using data familiarity measures to audit or restructure our training datasets will improve overall model accuracy or ensure similar performance across groups (the form of fairness we are adopting here).

We approach our evaluations as if we were attempting to *deploy a model*, as that is our intended application. We evaluate our designing data interventions through a series of modeling experiments, described below. First, we show that diverse data *does* lead to better performance. Then, we use familiarity scores to uncover noisy data failures within the dataset and describe how removing these samples impacts performance. Finally, we show that supplementing the dataset with unfamiliar samples improves model accuracy and calibrates confidence scores.

8 DIVERSE DATA

We sought to answer Q1 through our first set of experiments. We compare “diverse” models to what we expect to be “less diverse” models. We do so for two reasons: first, it may not be clear to



Figure 5: The performance of every model on the same test set, split across categories. For each category, a model’s label indicates which subgroup was held out from its training set. To ensure fair comparison, within each category each model was trained on the same number of instances. Notice for each category that the “diverse” model (highlighted with a darker color), i.e., the model with no subgroup held out, almost exclusively performs the best, despite having the same number of data instances as the other models. Note that each model was trained 10 x 10 times, keeping the random seed stable for r times, then repeating with a different seed. Weights from the models with highest accuracy across the trials were kept for later experiments.

practitioners that collecting diverse data early in development is critical to building functional tools. Second, despite best efforts to curate a list of meaningful characteristics, we did not know if these additional data dimensions had any true effect on the classification task. For example, did hand size actually increase the difficulty the model faced classifying left and right handed typing?

Both diverse and less diverse models are trained using the same number of training samples and are evaluated on the same test data. Less diverse models are trained on data where one group (e.g. small handed) was left out. In this way, we perform leave-one-out cross-validation *and* consider the specific effects of a given demographic group. Paying close attention to intersectional groups, we expect to see greater performance stratification in less diverse models; less diverse models will not perform as well generally as diverse models. We describe our experimental protocols below.

First, shuffle then randomly select train and test datasets such that no typing trials are split across datasets. We save the test dataset to evaluate every model trained with the current train/test split. Then, we compare the full dataset and train/test distributions using a visual check and earth mover’s distance (EMD). If the difference in distributions are significant, repeat the first step. We group the data by category (e.g., *Sex*) then by type (e.g., *Female*). For each category, we compare the number of samples within a group and record the smallest size. Next, randomly downsample each group such that each subset is of equal size to one another.

We then compare the distribution of data sampled out to the downsampled group data, and repeat sampling in the case of skew and save the sampled data. Lastly, we repeat the prior step but do so from the complete training set: this is the “diverse” dataset for the category. For each group within a category, we append all other groups together and then leave the current group out such that new training groups were $Female \cup Intersex$ (for example). For each set within a category, train a new model using our previously described 1D CNN. We monitor for overfitting by setting early stopping based on loss with a patience of 4. We save every model, their weights, training accuracy and loss curves, and training dataset, keeping track of model version. We then generate predictions from the original test set. We repeat $r = 10$ times for each set, keeping the random seed the same. We repeat r times again, changing the random seed for downsampling to ensure our results are stable. We compare models across overall, group-specific, and intersectional accuracies. We hypothesize that some categories are more meaningful to performance than others. Performance disparity—such as lower accuracy—across the categories *despite* equal numbers of examples would highlight support this hypothesis.

8.1 Evaluation

When compared to models trained on less diverse data, we found that models with diverse data had an overall higher accuracy (Figure 5) and performed better across intersectional groups, as shown

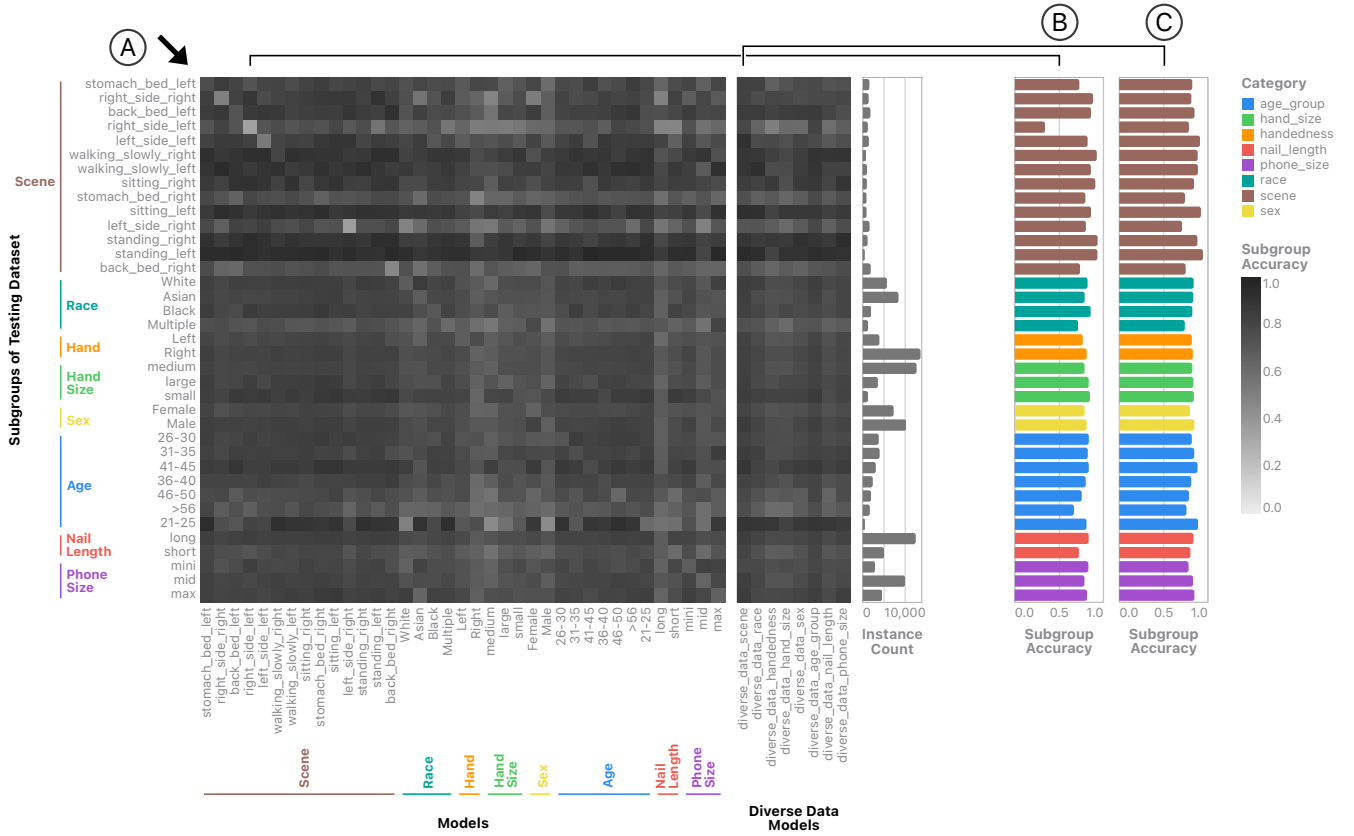

Figure 6: Performance for each subgroup on the same testing dataset (y-axis) per model (x-axis), split across categories. The large square matrix (left) shows accuracy per subgroup of models where a subgroup was left out of their training set, whereas the rectangular matrix (right) shows performance for models trained on diverse data. The small gray bar chart to the right of the rectangular matrix indicates how many instances in the test set belong to each subgroup of data. (A) The arrow highlights the diagonal of the matrix: subgroups of data that perform worse than others since this corresponds to a model trained without this particular subgroup. (B) For example, taking the `left_side_right` model from the matrix (a model whose dataset is missing people typing with their right hand while laying on their left side), we see it performs poorly on the `left_side_right` subgroup. (C) In comparison, models trained on a more diverse, same sized dataset show no large dip in subgroup accuracy.

in Figure 6. For example, Figure 6 B shows a significant dip in performance for the model trained without data from the **right-side-left** condition compared to diverse model (Figure 6 C). This is as we anticipated, and we see that for data where participants were typing in the **right-side-left** condition, the less-diverse model actually performs *worse* than random chance. This pattern is repeatable—across k models where we intentionally left out one group (Figure 6 A), we see a correlated diagonal of lighter color indicating lower testing accuracy, supporting our hypothesis that the extensive characteristics we collected data for *do* effect IMU performance. In contrast, diverse models show less variation in performance, instead performing better across different demographics—matching a measure of fairness called Equality of Odds, where negative and false positive rates across groups are similar. Finally, the influence of these demographics on performance varied. In general, removing activity and age group subsets was more harmful to models than hand size,

gender, or race subsets, but there were exceptions. For example, all models performed well on **standing-left** and **standing-right** test data even when subsets were left out of training, while performance on **21-25** testing data varied dramatically. Critically, we found that some intersectional subgroups performed drastically different compared to their overall group performance, yet we would not have caught these instances if not for careful evaluation and visualizations across these subgroups.

In the case of IMU data, which we have argued lacks the semantic meaning necessary to contextualize data, we found that having descriptive information is necessary for evaluating model robustness. This information lays the foundation for debugging which retrospective documentation—such as what is described for datasheets—does not necessarily inform nor direct data collection as it occurs. While these records hold substantial value, they are disjoint from data collection *processes*.

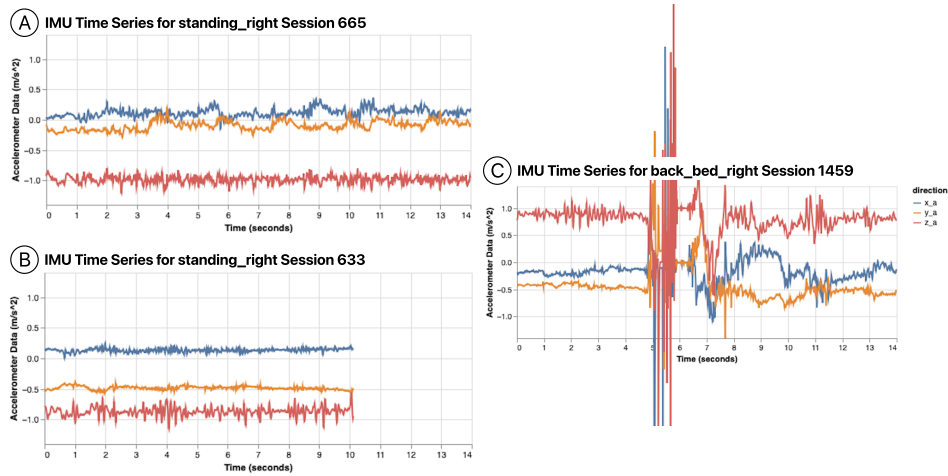

Figure 7: Distinct examples of data characterized as most “unfamiliar” to a model. (A) is an example of data we would consider out of distribution, (B) presents a case of sensor failure—the sensor stopped recording part way through the task—and (C) shows a particularly noisy sample, likely where someone dropped their phone mid-typing.

9 FAMILIARITY

We evaluate familiarity’s efficacy in directing dataset iteration (Q2) through a simple series of experiments. First, we look to improve our best IMU classifier from the prior experiment through directly modifying the training data. We do this using only “self familiarity” scores (i.e., the familiarity of the training data themselves)—measuring only what the model has been exposed in training so as to not overfit.

9.1 Familiarity for Debugging

Our dataset was collected “in the wild” without additional annotation from participants. While participants were given clear instructions, we still anticipated that a small number of samples would show significant noise or distortion—participants might drop their phones as they type, or switch hands part way through a session. This is often the case for any data collection process, but left uncaught such samples may introduce unwanted effects downstream. Thus, a method to surface potentially noisy samples was necessary. Inspecting time series plots for each session was untenable due to the size of data collected. Familiarity offers a possible solution to uncovering these noisy samples. To use familiarity in this way, we must at least partially train a model on the current dataset, then find the most unfamiliar samples, as described in Section 5. This approach does not discriminate between noise and conceptually difficult samples, requiring human overview to determine whether said samples should be removed; however, it *greatly* reduces the number of samples to check instead of the entire dataset.

In this way, data familiarity offers an alternative to other work such as [63, 74], which incorporate loss as a metric for capturing noisy samples. We hypothesize that the least familiar samples within a noisy dataset will include instances of noisy data which may pose the greatest harm to the model.

We explored how to incorporate familiarity as a tool for debugging first through an automated approach to removing data, then

by incorporating human review. In initial experiments, we replaced familiar data with noisy data, rather than the OOD data we had expected. As a result, we discovered our dataset was far noisier than modeling and review initially indicated. Our protocol is as follows: first, we train an initial model on all available training data. We apply self-familiarity to the training and testing set, selecting only 0.1% of the data, which corresponds to least familiar samples.

This data is either removed from the dataset, or visualized and manually reviewed per sample to evaluate if they are truly noisy or simply uncommon. We removed the same number of samples with manual review of truly noisy data as with the automated removal, using the sampling methods described in Section 9.2. We compared outcomes of both automated removal and removal through human review, but found that the deleted portion of least familiar data included both noisy data and critical outliers. In the following experiments, we evaluate the results of these interventions to a baseline case where no data is removed. In all cases, models are trained following Section 8’s protocol.

9.1.1 Evaluation. In practice, we found that familiarity worked well as a tool to encourage diversity *and* for debugging. Before removing noisy data from the complete dataset, we found that a large percentage of the least familiar samples showed significant distortion, despite our efforts to normalize the data. Because of the presence of these noisy data, running our familiarity experiments with data that was not cleaned did not show the same levels of general improvement. In this context, matching metadata to noisy samples was not the correct comparison—these samples were not exemplars of the subpopulation.

In manually evaluating our unfamiliar data before removal, we found there were cases where unfamiliar samples were not noisy, but rather underrepresented intersectional groups. For instance, a person identifying as an **Asian Female** with **Small** hands and

Large phone was as unfamiliar to the model as incredibly noisy examples⁴. Noisy data—such as from someone dropping their phone—has different implications for the model than a sample that’s simply unusual because the angle a phone was held is different. We found there were relatively few instances of these characteristics presented together within the dataset (from only a few individuals). For this reason, simply removing 0.1% of the least familiar data prior to experiments did not improve performance to the extent we see when manual review was implemented. That is to say, familiarity cannot distinguish between distorted noise and underrepresented or out of distribution data. Therefore for datasets where significant noise may be present, *human review* is necessary to evaluate the quality of the data.

9.2 Familiarity for Diverse Data Coverage

Then, we compare familiarity scores across the different descriptive groups, as described in Section 8. These scores can be used to determine next steps for additional data collection, augmentation, or modified (over/under) sampling. Here, we sample *out* a percentage of the *most* familiar data, and *add* data that matches the intersectional characteristics for the same percentage of *least* familiar data. Substituted data was held out from training in Section 8, thus is new to the models. We match samples based on the metadata characteristics, using combinatorial optimization to find the most similar instances to unfamiliar data.

For each experiment, we look exclusively at familiarity for the final dense layer of our model—a common choice for research exploring model embeddings as it is as “most aligned” with what’s human recognizable. Using PCA, we project down to 50 dimensions, then fit 5 GMMs to last dense layer for each 1D CNN trained in Section 8. We call this model M_1 . Scoring our training data, we save familiarity scores and model weights. We vary the range of familiarity scores to sample from, percentage of data, and two sampling in methods—top k and random selection from a least familiar data range—compared to a random baseline, and compare model performance across each. We then select a window range from the data distribution to sample the most familiar data from. To determine the optimal sampling sizes developing our experimental protocol was what sampling method to incorporate. Given that our intention was to *encourage* diversity in our dataset, an ineffective sampling strategy might exacerbate edge case failures. Thus we explored three general approaches: (1) Replace k most familiar samples with k least familiar samples; (2) Distributed sampling across a window of $k + i$ most familiar samples with k least familiar samples, where i represents a percentage of the overall training set; and (3) Distributed sampling across a window of $k + i$ most familiar samples with $k + i$ least familiar samples, where i represents a percentage of the overall training set.

Each sampling mechanism was compared across multiple k and $k + i$ values to determine the relative “sweet spot” for our sampling strategy given a particular training dataset. We randomly select X percent of best and worst scores, varying percentage between 0.5%–0.01%. We train model(s) on each variation of window size and sampling percentage.

We repeat the previous steps k times to ensure a multifold validation, then compare the intersectional performances of M_1 to the new model M_i trained on the familiarity-informed dataset. This is repeated per data cleaning scenario described in Section 9.1. We structure these experiments—varying window size and sampling percentage—to uncover a sweet spot: too much data removed may harm performance of currently familiar groups, and too large a window might impinge on less familiar data.

9.2.1 Evaluation. Self-familiarity scores create a distinct curve, with unfamiliar data falling into the long-tail.

We find accuracy scores are far more striated prior to familiarity interventions, showing some concepts are learned better than others, and that following familiarity interventions, models do show targeted improvement. Models performed more poorly in regions with high numbers of low familiarity data (an example of which is shown in Figure 9). Of note, the models did not necessarily improve overall—although this was frequently the case—but instead showed improvement in areas of low performance and regression in those with high performance. This aligns with a working definition of fairness we described previously.

In Figure 9, we show two model performances on intersectional groups: (A) is our highest performing model trained on the **diverse-data-scene** dataset with no familiarity intervention. We can see lower accuracies in **back-bed-left** and **right-side-left** compared to other subgroups. In contrast, **sitting-left** and **back-bed-right** had much higher accuracy compared to other subgroups. Figure 9 (B) shows the difference between this model and a model trained on the same data with familiarity interventions. Here, regions that previously showed a relative poor performance showed dramatic improvement, while those with higher relative accuracy showed some regression. Finally, we found that incorporating selecting 0.1% least familiar data was the optimal for our experiments. This percentage will depend on the distribution and shape of the underlying dataset, and when incorporating familiarity in future experiments a similar exploratory set of experiments should be conducted initially. Overall, we noted *Familiarity captured what samples needed increased representation within the dataset*. So long as the data was cleaned, we found this trend was consistent across all models.

10 DISCUSSION AND FUTURE WORK

It is clear that we need processes which integrate data *and* models in systematic, transparent ways. Instances of unrepresentative data remain unidentified in research and product development [65], impacting user experiences. Our goal for *designing data* is to support more equitable and inclusive machine learning data collection and modeling development. Data will always be shaped by the perspective of the observer; our work highlights how reflection and systematic processes may curtail harmful biasing effects earlier in development, before they are difficult to detangle from the dataset. *Designing data* assures intentional and critical reflection is given to the what and how of data collection, even when there is only a small number of people influencing it. While we do not suggest *designing data* replaces valuable tools such as expert panels and focus groups, these resources are often inaccessible or prohibitively expensive, and offer only small portion of the solution to bias mitigation. It was developed in response to existing challenges

⁴We show examples of distinct, least familiar samples to an example model in Figure 7.

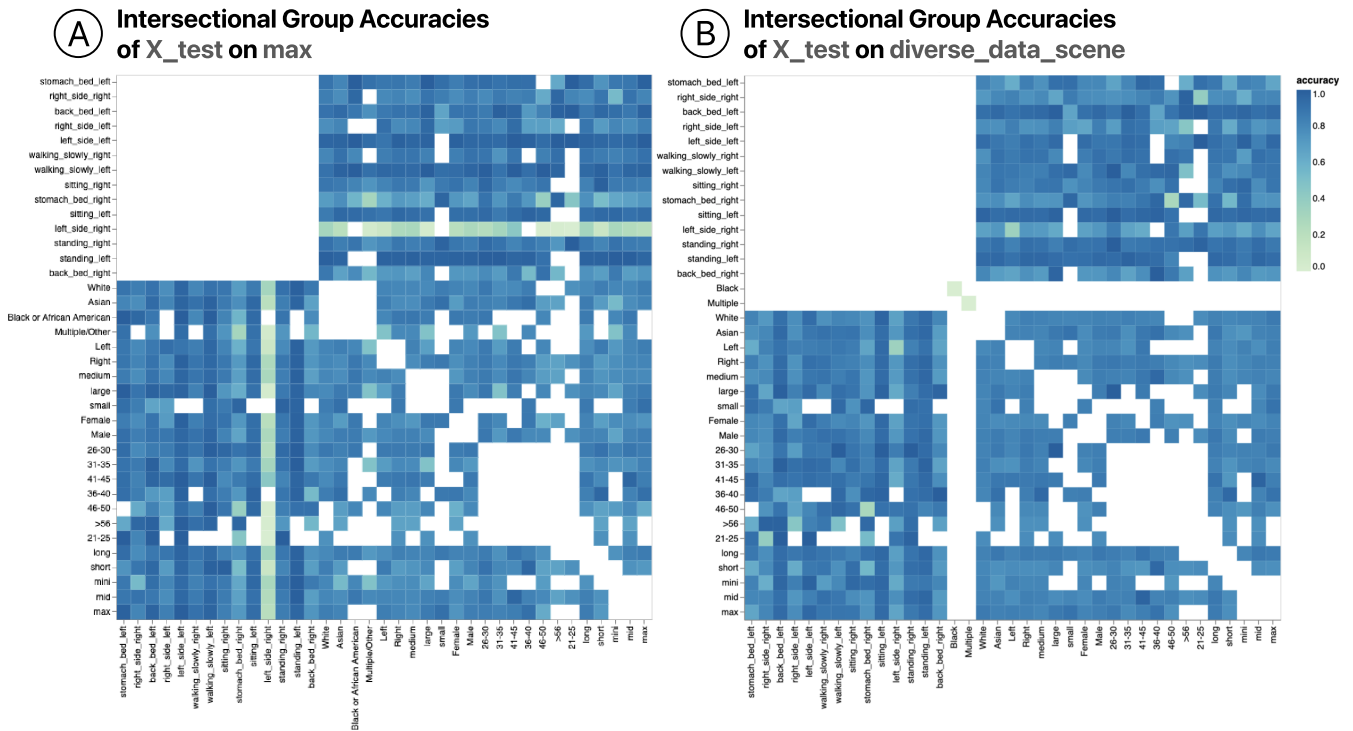

Figure 8: Comparison of intersectional groups of a less diverse model (A) to a diverse model (B). Striated accuracy across populations—as described by the metadata descriptions—performed worse when groups were left out, indicating that these characteristics were aligned with meaningful diversity in the data.

in data collection and model deployment that are currently unmet holistically (see Section 3). While each step can be incorporated in isolation, the interventions are complimentary, compensating for the cascading effects of both upstream and downstream missteps. While broadly applicable, we believe our approach is particularly useful for software engineers and data scientists building tools for real world applications.

10.1 Limitations and Future Extensions of Familiarity

Distinguishing between rare and noisy data. A weakness of familiarity is that we have no current method of distinguishing noisy samples from out of distribution data. While an unfamiliar sample might stand out to the model, in many cases, human review is necessary to evaluate its implications. For this reason, *in very noisy datasets*, familiarity may be a tool best used for debugging. Future research might seek to incorporate algorithmic methods of distinguishing sources of uncertainty, however there is currently little work on the topic. Existing research either relies on the learning rate as a proxy for discriminating types of uncertainty as aleatoric or epistemic [22], for example, or builds on Bayesian networks [44]. Both face various weaknesses, and there remains great need for additional techniques and evaluations.

Familiarity for new data. While we explored familiarity largely from the perspective of “self-familiarity”—that is, what the model has already been exposed to, it also introduces a mechanism by which we can understand how a model responds to data it’s previously not seen. This may offer a mechanism of transparency through which future users could evaluate how a model responds to new data. In this work, we computed familiarity from a single layer. In future work, we will explore how familiarity computed at different layers can be leveraged. Given that each layer captures distinct features within the data, aggregating information across depths of the model may lead to more holistic identification of unfamiliar data *and* what features are more specifically so to the model. One way to do this is through a Product of Experts (PoE) paradigm [32] where each layer is considered an “expert”.

Comparisons against active learning. On the surface, familiarity appears similar to active-learning (AL). AL requires practitioners to choose which data to use given a large collection. In our scenario, we must understand which data to *collect* or gather when there is no additional data readily available to run the AL algorithm on. One way to circumvent this difference is to apply AL to the training set, and then extract statistics on the metadata that the AL algorithm indicates as most useful. For example, one could use the entropy of the logits: high entropy on a data point might be an indication that the model is still uncertain about such type of data. An issue

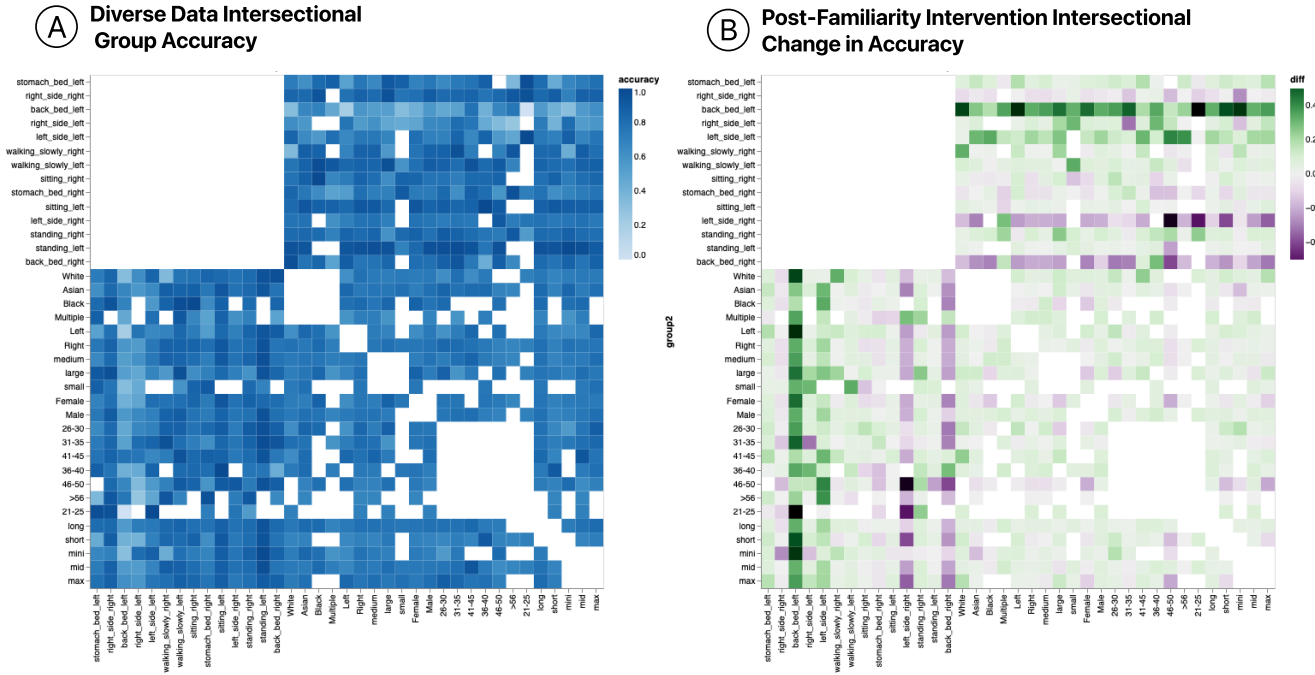

Figure 9: (A) The accuracy for all intersectional subgroups of data of the diverse data model. (B) The difference in accuracy for all intersectional subgroups before and after familiarity interventions. Green marks positive change, and purple marks negative.

with such approach is that it implicitly assumes models are well calibrated, which is not always the case.

Interactive systems for designing data. Designing data advances how we account for the interplay between data and model [37], considering both within the deployment cycle to compensate for missteps in either. In our case study, we use data visualizations (e.g., Figure 2) to compare practitioners’ expectations against collected data distributions, then visualize familiarity to explore rare or noisy samples. The visualizations and interfaces used in this work are largely static; however, we see a great opportunity to build the designing data process into future interactive systems and tools for better data work and model evaluation. From the HCI and visualization communities, there are a number of interactive systems that have helped ML practitioners explore their data [1, 35, 39] and evaluate their models [4, 29, 82]; for an in-depth survey on visual analytics for ML see [34]. Directions for future interactive systems might include tools to help practitioners reflect on their data collection practices (e.g., digging into their expectations, as discussed in Section 6), or tools to direct familiarity analyses (shown in Section 9).

10.2 Conclusion

Through an interdisciplinary meeting of human-centered interventions and algorithmic evaluation, designing data emphasizes planning over rapid implementation to ensure prototype datasets are conscientiously designed before deployment. We argue that the earlier data designers think about diversity, the greater they can

reduce future technical debt. Much like in refactoring code, prototype data must be refactored regularly prior to production, else early data design decisions may lead to unforeseen downstream effects.

ACKNOWLEDGMENTS

We thank our colleagues at Apple for their time and effort participating in our research. We especially thank Kayur Patel, Donghao Ren, and Halden Lin for their help and guidance.

REFERENCES

- [1] 2017. Facets. Google PAIR (2017). <https://pair-code.github.io/facets/>
- [2] Gregor Aisch, Amanda Cox, and Kevin Quealy. 2015. You draw it: How family income predicts children’s college chances. *The New York Times* 28 (2015).
- [3] Bashar Altakroui, Daniel Burmeister, Dennis Boldt, and Andreas Schrader. 2016. Insights on the Impact of physical impairments in full-body motion gesture elicitation studies. In *Proceedings of the 9th Nordic Conference on Human-Computer Interaction* (Gothenburg, Sweden) (NordiCHI ’16). Association for Computing Machinery, New York, NY, USA, Article 5, 10 pages. <https://doi.org/10.1145/2971485.2971502>
- [4] Saleema Amershi, Max Chickering, Steven M Drucker, Bongshin Lee, Patrice Simard, and Jina Suh. 2015. Modeltracker: Redesigning performance analysis tools for machine learning. In *Proceedings of the 33rd Annual ACM Conference on Human Factors in Computing Systems*. 337–346.
- [5] Saleema Amershi, Dan Weld, Mihaela Vorvoreanu, Adam Fourney, Besmira Nushi, Penny Collisson, Jina Suh, Shamsi Iqbal, Paul N Bennett, Kori Inkpen, et al. 2019. Guidelines for human-AI interaction. In *Proceedings of the 2019 CHI Conference on Human Factors in Computing Systems*. 1–13.
- [6] Julia Angwin, Jeff Larson, Surya Mattu, and Lauren Kirchner. 2016. Machine bias. *ProPublica* 23 (2016).
- [7] Matthew Arnold, Rachel KE Bellamy, Michael Hind, Stephanie Houde, Sameep Mehta, Aleksandra Mojsilović, Ravi Nair, K Natesan Ramamurthy, Alexandra Olteanu, David Piorkowski, et al. 2019. FactSheets: Increasing trust in AI services

- through supplier's declarations of conformity. *IBM Journal of Research and Development* 63, 4/5 (2019), 6–1.
- [8] Abolfazl Asudeh, Zhongjun Jin, and HV Jagadish. 2019. Assessing and remedying coverage for a given dataset. In *2019 IEEE 35th International Conference on Data Engineering*. IEEE, 554–565.
 - [9] Bence Bago, David G Rand, and Gordon Pennycook. 2020. Fake news, fast and slow: Deliberation reduces belief in false (but not true) news headlines. *Journal of Experimental Psychology: General* (2020).
 - [10] Lyn Bartram, Michael Correll, and Melanie Tory. 2021. Untidy data: The unreasonable effectiveness of tables. *arXiv preprint arXiv:2106.15005* (2021).
 - [11] Shai Ben-David, Pavel Hruběš, Shay Moran, Amir Shpilka, and Amir Yehudayoff. 2019. Learnability can be undecidable. *Nature Machine Intelligence* 1, 1 (2019), 44.
 - [12] Emily M Bender and Batya Friedman. 2018. Data statements for natural language processing: Toward mitigating system bias and enabling better science. *Transactions of the Association for Computational Linguistics* 6 (2018), 587–604.
 - [13] Alan F Blackwell, Carol Britton, A Cox, Thomas RG Green, Corin Gurr, Gada Kadoda, MS Kutar, Martin Loomes, Chrystopher L Nehaniv, Marian Petre, et al. 2001. Cognitive dimensions of notations: Design tools for cognitive technology. In *International Conference on Cognitive Technology*. Springer, 325–341.
 - [14] Larry Buchanan, Haeyoun Park, and Adam Pearce. 2017. You draw it: What got better or worse during Obama's presidency. *The New York Times* 15 (2017).
 - [15] Joy Buolamwini and Timnit Gebru. 2018. Gender shades: Intersectional accuracy disparities in commercial gender classification. In *ACM Conference on Fairness, Accountability and Transparency*. 77–91.
 - [16] L Elisa Celis, Amit Deshpande, Tarun Kathuria, and Nisheeth K Vishnoi. 2016. How to be fair and diverse? *arXiv preprint arXiv:1610.07183* (2016).
 - [17] L Elisa Celis, Vijay Keswani, Damian Straszak, Amit Deshpande, Tarun Kathuria, and Nisheeth K Vishnoi. 2018. Fair and diverse DPP-based data summarization. *arXiv preprint arXiv:1802.04023* (2018).
 - [18] Federico Cruciani, Anastasios Vafeiadis, Chris Nugent, Ian Cleland, Paul McCullagh, Konstantinos Votis, Dimitrios Giakoumis, Dimitrios Tzovaras, Liming Chen, and Raouf Hamzaoui. 2020. Feature learning for human activity recognition using convolutional neural networks. *CCF Transactions on Pervasive Computing and Interaction* 2, 1 (2020), 18–32.
 - [19] Emily Denton, Alex Hanna, Razvan Amironesei, Andrew Smart, and Hilary Nicole. 2021. On the genealogy of machine learning datasets: A critical history of ImageNet. *Big Data & Society* 8, 2 (2021), 20539517211035955.
 - [20] Joan E Dodgson. 2019. Reflexivity in qualitative research. *Journal of Human Lactation* 35, 2 (2019), 220–222.
 - [21] Michele Donini, Luca Oneto, Shai Ben-David, John S Shawe-Taylor, and Massimiliano Pontil. 2018. Empirical risk minimization under fairness constraints. In *Advances in Neural Information Processing Systems*. 2791–2801.
 - [22] Daniel D'souza, Zach Nussbaum, Chirag Agarwal, and Sara Hooker. 2021. A tale of two long tails. *arXiv preprint arXiv:2107.13098* (2021).
 - [23] Benjamin Fish and Luke Stark. 2021. Reflexive design for fairness and other human values in formal models. In *Proceedings of the 2021 AAAI/ACM Conference on AI, Ethics, and Society*. 89–99.
 - [24] Jakob Gawlikowski, Cedrique Rovile Njiteucheu Tassi, Mohsin Ali, Jongseok Lee, Matthias Humt, Jianxiang Feng, Anna Kruspe, Rudolph Triebel, Peter Jung, Ribana Roscher, et al. 2021. A survey of uncertainty in deep neural networks. *arXiv preprint arXiv:2107.03342* (2021).
 - [25] Timnit Gebru, Jamie Morgenstern, Briana Vecchione, Jennifer Wortman Vaughan, Hanna Wallach, Hal Daumé III, and Kate Crawford. 2021. Datasheets for datasets. *Commun. ACM* 64, 12 (2021), 86–92.
 - [26] Mayank Goel, Alex Jansen, Travis Mandel, Shwetank N Patel, and Jacob O Wobbrock. 2013. ContextType: Using hand posture information to improve mobile touch screen text entry. In *Proceedings of the SIGCHI Conference on Human Factors in Computing Systems*. 2795–2798.
 - [27] J Grout, J Frederic, S Corlay, and M Ragan-Kelley. 2019. *Ipywidgets Jupyter widgets*. <https://github.com/jupyter-widgets/ipywidgets>
 - [28] Charlie Gullström. 2012. Design frictions. *AI & Society* 27, 1 (2012), 91–110.
 - [29] Jochen Görtler, Fred Hohman, Dominik Moritz, Kanit Wongsuphasawat, Donghao Ren, Rahul Nair, Marc Kirchner, and Kayur Patel. 2022. Neo: Generalizing confusion matrix visualization to hierarchical and multi-output labels. In *Proceedings of the SIGCHI Conference on Human Factors in Computing Systems*. ACM. <https://doi.org/10.1145/3491102.3501823>
 - [30] Karen Hao and Jonathan Stray. 2019. Can you make AI fairer than a judge? Play our courtroom algorithm game. *MIT Technology Review* (2019).
 - [31] David Haussler. 1990. *Probably approximately correct learning*. University of California, Santa Cruz, Computer Research Laboratory.
 - [32] Geoffrey E Hinton. 2002. Training products of experts by minimizing contrastive divergence. *Neural Computation* 14, 8 (2002), 1771–1800.
 - [33] Fred Hohman, Matthew Conlen, Jeffrey Heer, and Duen Horng Polo Chau. 2020. Communicating with interactive articles. *Distill* 5, 9 (2020), e28.
 - [34] Fred Hohman, Minsuk Kahng, Robert Pienta, and Duen Horng Chau. 2018. Visual analytics in deep learning: An interrogative survey for the next frontiers. *IEEE Transactions on Visualization and Computer Graphics* (2018). <https://doi.org/10.1109/TVCG.2018.2843369>
 - [35] Fred Hohman, Kanit Wongsuphasawat, Mary Beth Kery, and Kayur Patel. 2020. Understanding and visualizing data iteration in machine learning. In *Proceedings of the 2020 CHI Conference on Human Factors in Computing Systems*. 1–13.
 - [36] Kenneth Holstein, Jennifer Wortman Vaughan, Hal Daumé III, Miro Dudik, and Hanna Wallach. 2019. Improving fairness in machine learning systems: What do industry practitioners need?. In *Proceedings of the 2019 CHI Conference on Human Factors in Computing Systems*. 1–16.
 - [37] Sara Hooker. 2021. Moving beyond “algorithmic bias is a data problem”. *Patterns* 2, 4 (2021), 100241.
 - [38] Aspen Hopkins and Serena Booth. 2021. Machine learning practices outside big tech: How resource constraints challenge responsible development. In *Proceedings of the 2021 AAAI/ACM Conference on AI, Ethics, and Society* (Virtual Event, USA) (AIES '21). Association for Computing Machinery, New York, NY, USA, 134–145. <https://doi.org/10.1145/3461702.3462527>
 - [39] Google Inc. 2021. *Know Your Data*. <https://knowyourdata.withgoogle.com/>
 - [40] Nathalie Japkowicz and Shaju Stephen. 2002. The class imbalance problem: A systematic study. *Intelligent Data Analysis* 6, 5 (2002), 429–449.
 - [41] Aparna R Joshi, Xavier Suau Cuadros, Nivedha Sivakumar, Luca Zappella, and Nicholas Apostoloff. 2022. Fair SA: Sensitivity analysis for fairness in face recognition. In *Algorithmic Fairness through the Lens of Causality and Robustness Workshop*. PMLR, 40–58.
 - [42] Alex Kale, Matthew Kay, and Jessica Hullman. 2019. Decision-making under uncertainty in research synthesis: Designing for the garden of forking paths. In *Proceedings of the 2019 CHI Conference on Human Factors in Computing Systems*. 1–14.
 - [43] Josh Katz. 2017. You draw it: Just how bad is the drug overdose epidemic. *The New York Times* (2017).
 - [44] Alex Kendall and Yarin Gal. 2017. What uncertainties do we need in bayesian deep learning for computer vision? *Advances in Neural Information Processing Systems* 30 (2017).
 - [45] Yea-Seul Kim, Katharina Reinecke, and Jessica Hullman. 2017. Explaining the gap: Visualizing one's predictions improves recall and comprehension of data. In *Proceedings of the 2017 CHI Conference on Human Factors in Computing Systems*. 1375–1386.
 - [46] Yea-Seul Kim, Katharina Reinecke, and Jessica Hullman. 2018. Data through others' eyes: The impact of visualizing others' expectations on visualization interpretation. *IEEE Transactions on Visualization and Computer Graphics* 24, 1 (2018), 760–769. <https://doi.org/10.1109/TVCG.2017.2745240>
 - [47] Matthew Klawonn, Eric Heim, and James Hendler. 2019. Exploiting class learnability in noisy data. In *Proceedings of the AAAI Conference on Artificial Intelligence*, Vol. 33. 4082–4089.
 - [48] Laura Koesten, Emilia Kacprzak, Jeni Tennison, and Elena Simperl. 2019. Collaborative practices with structured data: Do tools support what users need?. In *Proceedings of the 2019 CHI Conference on Human Factors in Computing Systems*. 1–14.
 - [49] Kimin Lee, Kibok Lee, Honglak Lee, and Jinwoo Shin. 2018. A simple unified framework for detecting out-of-distribution samples and adversarial attacks. *Advances in Neural Information Processing Systems* 31 (2018).
 - [50] Seungjae Lee, Hyejeong Lee, Jongshill Lee, Hokyung Ryu, In Young Kim, and Jeun Kim. 2020. Clip-On IMU system for assessing age-related changes in hand functions. *Sensors* 20, 21 (2020), 6313.
 - [51] I Scott MacKenzie and R William Soukoreff. 2003. Phrase sets for evaluating text entry techniques. In *CHI'03 Extended Abstracts on Human Factors in Computing Systems*. 754–755.
 - [52] Mostafa Milani, Yu Huang, and Fei Chiang. 2020. Diversifying anonymized data with diversity constraints. *arXiv preprint arXiv:2007.09141* (2020).
 - [53] Margaret Mitchell, Dylan Baker, Nyalleng Moorosi, Emily Denton, Ben Hutchinson, Alex Hanna, Timnit Gebru, and Jamie Morgenstern. 2020. Diversity and inclusion metrics in subset selection. In *Proceedings of the AAAI/ACM Conference on AI, Ethics, and Society*. 117–123.
 - [54] Margaret Mitchell, Simone Wu, Andrew Zaldivar, Parker Barnes, Lucy Vasserman, Ben Hutchinson, Elena Spitzer, Inioluwa Deborah Raji, and Timnit Gebru. 2019. Model cards for model reporting. In *Proceedings of the Conference on Fairness, Accountability, and Transparency*. 220–229.
 - [55] Kevin P Murphy. 2012. *Machine learning: A probabilistic perspective*. MIT press.
 - [56] Safiya Umoja Noble. 2018. *Algorithms of oppression: How search engines reinforce racism*. NYU Press.
 - [57] Fatemeh Noroozi, Dorota Kaminska, Ciprian Corneanu, Tomasz Sapinski, Sergio Escalera, and Gholamreza Anbarjafari. 2018. Survey on emotional body gesture recognition. *IEEE Transactions on Affective Computing* (2018).
 - [58] Chris Olah, Arvind Satyanarayan, Ian Johnson, Shan Carter, Ludwig Schubert, Katherine Ye, and Alexander Mordvintsev. 2018. The building blocks of interpretability. *Distill* 3, 3 (2018), e10.
 - [59] Adam Palanica, Anirudh Thommandram, Andrew Lee, Michael Li, and Yan Fossat. 2019. Do you understand the words that are comin outta my mouth? Voice assistant comprehension of medication names. *NPJ Digital Medicine* 2, 1 (2019), 1–6.

- [60] Alexandros Papadopoulos, Konstantinos Kyritsis, Lisa Klingelhoefer, Sevasti Bostanjopoulou, K. Ray Chaudhuri, and Anastasios Delopoulos. 2020. Detecting Parkinsonian tremor from IMU data collected in-the-wild using deep multiple-instance learning. *IEEE Journal of Biomedical and Health Informatics* 24, 9 (2020), 2559–2569. <https://doi.org/10.1109/JBHI.2019.2961748>
- [61] Gordon Pennycook, Jonathon McPhetres, Yunhao Zhang, Jackson G Lu, and David G Rand. 2020. Fighting COVID-19 misinformation on social media: Experimental evidence for a scalable accuracy-nudge intervention. *Psychological Science* 31, 7 (2020), 770–780.
- [62] Gordon Pennycook and David G Rand. 2019. Lazy, not biased: Susceptibility to partisan fake news is better explained by lack of reasoning than by motivated reasoning. *Cognition* 188 (2019), 39–50.
- [63] Geoff Pleiss, Tianyi Zhang, Ethan R Elenberg, and Kilian Q Weinberger. 2020. Identifying mislabeled data using the area under the margin ranking. *arXiv preprint arXiv:2001.10528* (2020).
- [64] Joaquin Quinero-Candela, Masashi Sugiyama, Anton Schwaighofer, and Neil D Lawrence. 2009. *Dataset shift in machine learning*. The MIT Press.
- [65] Alvin Rajkomar, Michaela Hardt, Michael D Howell, Greg Corrado, and Marshall H Chin. 2018. Ensuring fairness in machine learning to advance health equity. *Annals of Internal Medicine* 169, 12 (2018), 866–872.
- [66] Sreenivasan Ramasamy Ramamurthy and Nirmalya Roy. 2018. Recent trends in machine learning for human activity recognition—A survey. *Wiley Interdisciplinary Reviews: Data Mining and Knowledge Discovery* 8, 4 (2018), e1254.
- [67] Jaime Ruiz and Daniel Vogel. 2015. *Soft-constraints to reduce legacy and performance bias to elicit whole-body gestures with low arm fatigue*. Association for Computing Machinery, New York, NY, USA, 3347–3350. <https://doi.org/10.1145/2702123.2702583>
- [68] Nithya Sambasivan, Shivani Kapania, Hannah Highfill, Diana Akrong, Praveen Paritosh, and Lora M Aroyo. 2021. “Everyone wants to do the model work, not the data work”: Data cascades in high-stakes AI. In *Proceedings of the 2021 CHI Conference on Human Factors in Computing Systems*. 1–15.
- [69] Jennifer Saul. 2013. Scepticism and implicit bias. *Disputatio* 5, 37 (2013), 243–263.
- [70] Robert E Schapire. 1990. The strength of weak learnability. *Machine Learning* 5, 2 (1990), 197–227.
- [71] Ludwig Schmidt, Shibani Santurkar, Dimitris Tsipras, Kunal Talwar, and Aleksander Madry. 2018. Adversarially robust generalization requires more data. In *Advances in Neural Information Processing Systems*. 5014–5026.
- [72] David W Scott and Stephan R Sain. 2005. Multidimensional density estimation. *Handbook of statistics* 24 (2005), 229–261.
- [73] David Sculley, Gary Holt, Daniel Golovin, Eugene Davydov, Todd Phillips, Dietmar Ebner, Vinay Chaudhary, Michael Young, Jean-Francois Crespo, and Dan Dennison. 2015. Hidden technical debt in machine learning systems. In *Advances in Neural Information Processing Systems*. 2503–2511.
- [74] Yanyao Shen and Sujay Sanghavi. 2019. Learning with bad training data via iterative trimmed loss minimization. In *International Conference on Machine Learning*. PMLR, 5739–5748.
- [75] Bernard W Silverman. 1986. *Density estimation for statistics and data analysis*. Vol. 26. CRC Press.
- [76] Jessica Soedirgo and Aarie Glas. 2020. Toward active reflexivity: Positionality and practice in the production of knowledge. *PS: Political Science & Politics* 53, 3 (2020), 527–531.
- [77] Jonathan Stray and Karen Hao. 2020. Interactive visualization of fairness tradeoffs. *Computation + Journalism Symposium* (2020).
- [78] Giri Kumar Tayi and Donald P Ballou. 1998. Examining data quality. *Commun. ACM* 41, 2 (1998), 54–57.
- [79] Maggie E Toplak, Richard F West, and Keith E Stanovich. 2011. The cognitive reflection test as a predictor of performance on heuristics-and-biases tasks. *Memory & Cognition* 39, 7 (2011), 1275.
- [80] Jacob VanderPlas, Brian Granger, Jeffrey Heer, Dominik Moritz, Kanit Wongsuphasawat, Arvind Satyanarayan, Eitan Lees, Ilia Timofeev, Ben Welsh, and Scott Sievert. 2018. Altair: Interactive statistical visualizations for python. *Journal of Open Source Software* 3, 32 (2018), 1057. <https://doi.org/10.21105/joss.01057>
- [81] Stanisław Węglarczyk. 2018. Kernel density estimation and its application. In *ITM Web of Conferences*, Vol. 23. EDP Sciences, 00037.
- [82] James Wexler, Mahima Pushkarna, Tolga Bolukbasi, Martin Wattenberg, Fernanda Viegas, and Jimbo Wilson. 2019. The What-If Tool: Interactive probing of machine learning models. *IEEE TVCG* 26 (2019). <https://doi.org/10.1109/tvcg.2019.2934619>
- [83] Maranke Wieringa. 2020. What to account for when accounting for algorithms: A systematic literature review on algorithmic accountability. In *Proceedings of the 2020 Conference on Fairness, Accountability, and Transparency*. 1–18.
- [84] Kaiyu Yang, Klint Qinami, Li Fei-Fei, Jia Deng, and Olga Russakovsky. 2020. Towards fairer datasets: Filtering and balancing the distribution of the people subtree in the imagenet hierarchy. In *Proceedings of the 2020 Conference on Fairness, Accountability, and Transparency*. 547–558.
- [85] Wei Zheng, Xuanhui Wang, Hui Fang, and Hong Cheng. 2012. Coverage-based search result diversification. *Information Retrieval* 15, 5 (2012), 433–457.
- [86] O. Zoby. 2014. Variational Bayesian inference with Gaussian-mixture approximations. *Electronic Journal of Statistics* 8, 1 (2014), 355 – 389.