

# Towards Semi-automatic Detection and Localization of Indoor Accessibility Issues using Mobile Depth Scanning and Computer Vision

Xia Su, Allen School of Computer Science, University of Washington

Kaiming Cheng, Allen School of Computer Science, University of Washington

Han Zhang, Allen School of Computer Science, University of Washington

Jaewook Lee, Allen School of Computer Science, University of Washington

Yueqian Zhang, Allen School of Computer Science, University of Washington

Jon E. Froehlich, Allen School of Computer Science, University of Washington

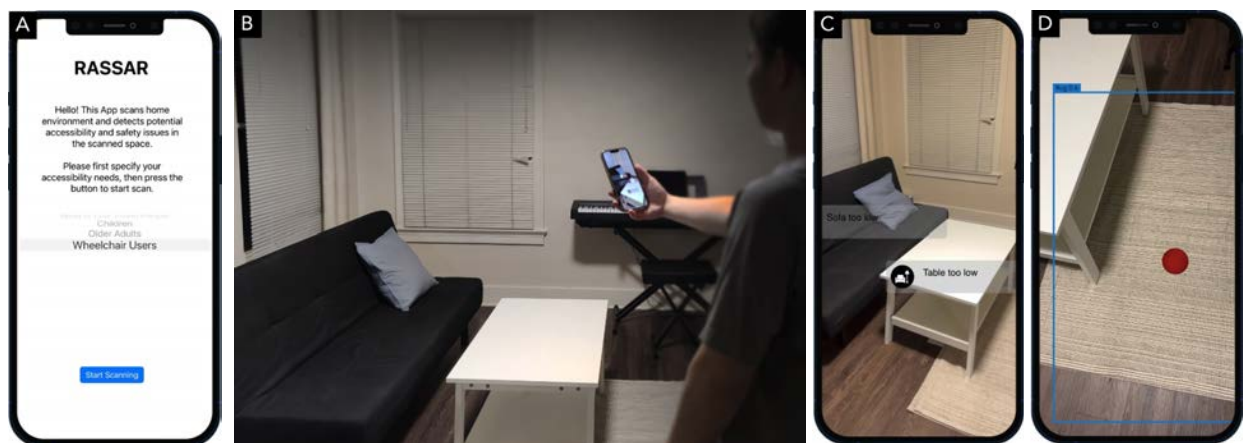

**Figure 1.** In this workshop paper, we present a proof-of-concept prototype called RASSAR (*Room Accessibility and Safety Scanning in Augmented Reality*) for *identifying, categorizing, and localizing* indoor accessibility and safety issues using LiDAR + camera data, real-time machine learning, and AR. With RASSAR, the user first selects the target community (a), scans the indoor space with their mobile phone (b), and receives real-time feedback about problematic items, dimensions, and positions. The feedback is anchored on the object’s location in real-world coordinate space (c and d).

## Abstract

To help improve the safety and accessibility of indoor spaces, researchers and health professionals have created assessment instruments that enable homeowners and trained experts to audit and improve homes. With advances in computer vision, augmented reality (AR), and mobile sensors, new approaches are now possible. We introduce RASSAR (*Room Accessibility and Safety Scanning in Augmented Reality*), a new proof-of-concept prototype for semi-automatically *identifying, categorizing, and localizing* indoor accessibility and safety issues using LiDAR + camera data, machine learning, and AR. We present an overview of the current RASSAR prototype and a preliminary evaluation in a single home.

## Introduction

Safe, accessible housing is a fundamental human right [47]. Indeed, the UN’s *Convention on the Rights of Persons with Disabilities* states that governments should identify and eliminate accessibility barriers not just in public facilities and transportation but in schools, workplaces, and

homes [51]. To help improve the safety and accessibility of domestic spaces, researchers and health professionals have created pre-formatted checklists (assessment instruments) that enable homeowners and trained professionals to audit and improve indoor spaces [13,19,20,22,37,40,42]. Often, these instruments are designed for particular target groups, such as older adults [13,19,36,37], children [27,40], and/or people with specific disabilities [10,22]. Some instruments, including *SAFER HOME* [17] and the *WeHSA* [11], were created for professionally trained occupational therapists to conduct in conjunction with home visits. Others have explored self-assessment tools such as the *Home Safety Self-Assessment Tool* (HSSAT) [19,42] and *Remote Home Safety Protocol* [37], which reduce cost, eliminate the need for professional intervention, and improve homeowner education. HSSAT, for example, contains a safety and accessibility checklist for nine areas of the home, including entrances, kitchens, bathrooms, and bedrooms, and includes issues such as a lack of wheelchair ramp, uneven flooring, cluttered areas, presence of throw rugs, electric cords across the floor, and inaccessible light switches.

With advances in computer vision, augmented reality (AR), and mobile sensors, new approaches for assessing indoor accessibility and safety are now possible. In this paper, we introduce *RASSAR* (*Room Accessibility and Safety Scanning in Augmented Reality*), a novel smartphone-based prototype for semi-automatically *identifying, categorizing, and localizing* indoor accessibility and safety issues using LiDAR + camera data, real-time machine learning, and AR. With *RASSAR*, the user holds out their phone and slowly scans a space—the tool constructs a real-time parametric model of the 3D scene, attempts to identify and classify known accessibility and safety issues, and visualizes potential problems overlaid in AR—see Figure 1. We envision *RASSAR* as a tool to help build and validate new construction, for homeowners planning renovations or updating their homes due to life change (e.g., illness, birth), or for rental services like Airbnb to help vet and validate access and safety.

As initial work, *RASSAR* currently detects 18 objects and examines issues such as *object dimension* (e.g., table too low), *position* (e.g., cabinet too high), and *existence* (e.g., throw rug). These supported features are informed by ADA standards for accessible design [43,52] and the health and safety literature [33]. We present an overview of the *RASSAR* prototype, its custom-trained machine learning model, and an initial evaluation in a single home. Our work contributes a new approach to assess indoor access/safety issues using emerging technology.

## Background and Related Work

*RASSAR* automatically constructs 3D models of the indoor environment using the iPhone Pro's built-in LiDAR scanner and classifies potential access and safety problems using LiDAR and RGB camera data. We cover work related to both below.

In architecture and construction fields, LiDAR is increasingly used to semi-automatically generate 2D blueprints and create interactive 3D models of buildings, often to track construction progress or examine a building post-construction (e.g., compare “as-designed” blueprints to “as-built” results) [23,34,45]. Here, the primary focus is on generating accurate 2D/3D blueprints of rooms, including room geometry, wall locations and orientations, and the position and size of windows

and doors. Interior objects like furniture are deemed “visual clutter,” which occlude laser scans and negatively impact building model generation [18,23]. In our research, we are interested in both the geometry and layout of space as well as the furniture and other objects within it and how each may pose an accessibility or safety issue.

In computer vision, combining LiDAR and camera data for scene reconstruction and object identification is an active area of research [29,35], particularly for autonomous vehicles [28,49]. A key challenge is how to leverage both RGB and depth sensor streams to improve detection results [3]. Others have examined purely 3D-detection approaches that classify objects directly from point cloud information [2,8]. In our case, we use both LiDAR and camera data.

Most relevant to our work are applications of sensing and computer vision to support indoor accessibility and safety. In this space, most work focuses on real-time navigation for blind or low-vision users, such as navigating hallways [25] or stairs [50], supporting pedestrian position estimations [24], or general wayfinding through localization and landmark detection [12,15,48]. While nascent, this work is already emerging in commercial tools. In May 2022, Apple introduced *Door Detection*, which fuses real-time LiDAR+camera data with on-device machine learning to help blind and low-vision users locate doors, understand distances to doorways, and describe door attributes—including open/closed state [53].

While there is a large body of active research in automated approaches to audit and document the accessibility of outdoor pedestrian environments [1,21,26,32,38,39,46], surprisingly few works focus specifically on indoor accessibility/safety issues. Notable exceptions include Balado *et al.*'s research on automatically detecting building entrance stairs from 3D point clouds [5,6] and Ayala-Alfaro's recent work in using mobile indoor robots to scan and classify objects that may impede access for people with mobility disabilities [4]. We could find no prior work that attempts to scan, identify, and localize both accessibility and safety issues using computer vision, AR, and machine learning—which is our focus.

## The RASSAR System

RASSAR identifies, categorizes, and localizes indoor accessibility and safety issues in real-time using LiDAR + RGB camera data, computer vision, and AR (Figure 2). Specifically, we employ Apple's *RoomPlan API*<sup>1</sup> to create a 3D room floor plan with furniture and dimension information along with a custom-trained deep learning model (YOLOv4 [9]) for safety/accessibility object detection using the RGB camera stream. We envision RASSAR as either a self-assessment tool for homeowners and caregivers or as a complementary tool for occupational therapists. We are currently targeting four communities of interest: children caregivers, wheelchair users, older adults, and people who are blind or low vision.

Table 1 below and Table 7 (in the Appendix) provides an overview of the 18 currently supported access/safety issues in RASSAR across three high-level categories: inaccessible or unsafe **object dimensions** (e.g., door too narrow, table too low), **object positions** (e.g., lightswitch position too high), and **object existence** (e.g., presence of a throw rug or medication).

---

<sup>1</sup> <https://developer.apple.com/augmented-reality/roomplan/>

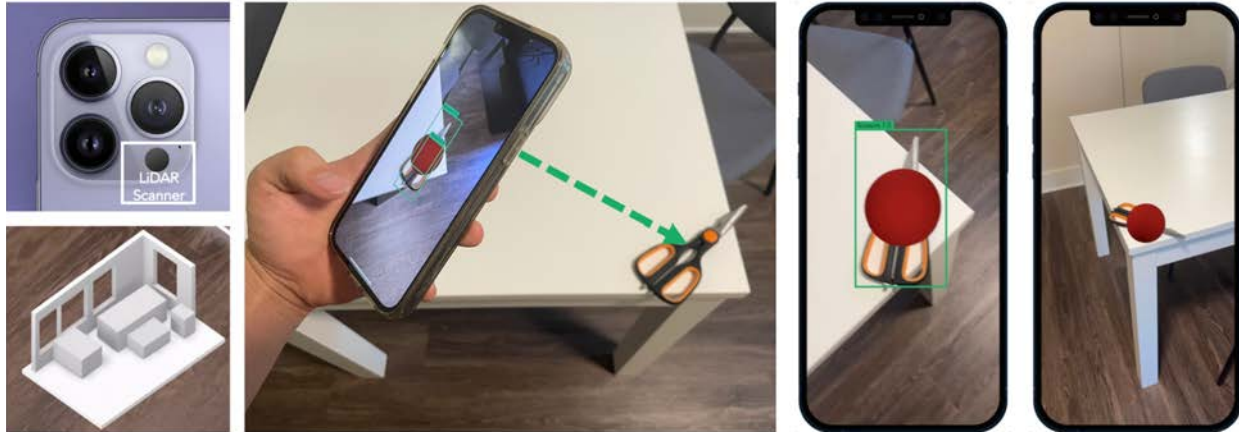

**Figure 2.** An overview of the RASSAR prototype, which uses the iPhone Pro’s built-in LiDAR and RGB cameras to build a real-time model of indoor space and a custom-trained machine learning model (YOLOv4) to identify potential safety and accessibility issues. In this case, RASSAR has detected scissors. The green bounding box is from Yolo, which shows the detection confidence. We also triangulate the location of the object and insert a red sphere displayed in AR.

The RASSAR prototype is composed of three primary components:

**1. Specifying access/safety issues.** To support a variety of access/safety issues, we developed a custom input specification format in JSON. The file specifies what objects to detect (e.g., table, door, knife), what problems to analyze (e.g., table height, door width, sharp object existence), and who is potentially impacted (e.g., wheelchair user, older adult). The full JSON description is in Table 1 along with two examples in Figure 3.

**Table 1.** The JSON elements and their values in our input specification file.

JSON Element	Description	Values
Object of interest	The object to automatically identify. We currently support 18 objects.	Cabinet, chair, counter, door, door handle, electric socket, grab bar, knives, knob, light switch, medication, rug, sink, scissors, smoke alarm, sofa, table, toilet
Community	The impacted target group(s)	Children, older adults, blind or low vision, wheelchair user. Can select one or more.
Dependency	Relational dependence (if any)	Can specify any <i>Object of interest</i> .
Dimension	Specifies dimensional requirements and conditional logic (e.g., a door must be a minimum of 32" wide)	Comparator operators include <, ==, and >. We also support a between range check.
Existence	Does the object pose a problem by its sheer existence at the location?	Can be null, true, or false. If null, then this <i>Object of interest</i> is not about existence but about <i>dimension</i> or <i>position</i> .
Description	A human-readable description of the problem, which is drawn from existing ADA standards and assessment checklists	Plain text

```

"Door-Opening": {
  "Radius": {
    "Community": ["Wheelchair User"],
    "Dependency": ["Door"],
    "Dimension": {
      "Comparison":
        ">",
      "Value": [32]
    },
    "Existence": null,
    "Description": "According to ADA
    compliance, door openings shall provide
    a clear width of 32 inches minimum."
  }
}

"Knives": {
  "Radius": {
    "Community": ["Children"],
    "Dependency": ["Table", "Sofa",
    "Counter", "Floor", "Bed", "Chair"],
    "Dimension": {
      "Comparison": null,
      "Value": null
    },
    "Existence": false,
    "Description": "For safety, no knives
    should be present on the reachable
    surfaces."
  }
}

```

**Figure 3.** Two example JSON objects: (a) a doorway opening with a required width specification and (b) a check for the existence of a knife.

**2. Detecting and locating access and safety issues.** RASSAR reads in the JSON specification to initialize its problem detection engine, which relies on two core techniques: first, we employ Apple’s *RoomPlan API* to build up a parametric 3D model of indoor space and use its robust built-in object recognition<sup>2</sup> to identify doors, walls, and windows as well as objects such as chairs, sofas, tables. For each element, we receive a 3D bounding box representing dimensional information (width, length, height) as well as a confidence score for the object classification. Currently, Apple’s built-in object recognizer is limited to 16 objects: *bathtub, bed, chair, dishwasher, fireplace, oven, refrigerator, sink, sofa, stairs, storage, stove, table, television, toilet, and washer/dryer*.

Thus, for our second technique, we use a state-of-the-art computer vision (CV) algorithm called YOLOv4 [9]. We chose the latest YOLOv4-tiny detector as the baseline model and trained on nine additional access/safety objects using more than 2,500 images found via *Bing Image Search* and Krasin *et al.’s Open Images* [54]—see Table 2. After obtaining the weights from training, we transferred them to the AR-supported Apple *CoreML*<sup>3</sup> model, which is integrated into RASSAR. While YOLO does not provide 3D dimension or localization information, we *localize* recognized objects using Apple’s raycast function in RealityKit<sup>4</sup>. Specifically, we take the center of the identified object’s 2D bounding box in each video frame’s image from the RGB camera and use raycasting to localize the pixel in 3D space. To reduce noise, we take the average raycast value over multiple frames (using a sliding window of  $N=5$  frames).

<sup>2</sup> Specifically, we use the RoomPlan’s [CapturedRoom](#) object, which includes an array of doors, openings, walls, windows as well as an [inferred objects](#) array.

<sup>3</sup> <https://developer.apple.com/documentation/coreml>

<sup>4</sup> <https://developer.apple.com/documentation/realitykit/arview>

**Table 2.** The custom YOLO training set for additional access/safety objects beyond those recognized by the Apple RoomPlan API. For ground truth (GT) labeling, we used *Label Studio* (<https://labelstud.io/>). For each image, we drew a 2D bounding box and provided a GT label. Some images contained multiple issues.

<b>Object</b>	<b>GT Annotation</b>	<b>Image Count</b>
Door handle	530	370
Electric socket	370	181
Light switch	299	138
Grab bar	503	395
Scissors	270	226
Knife	622	451
Medication	688	325
Rug	470	377
Smoke alarm	191	176
<b>Total</b>	<b>3,943</b>	<b>2,533</b>

**3. Visualizing identified issues.** Finally, to visualize the identified issues, RASSAR currently draws a small, red sphere in AR localized in 3D space (on the object itself) and also provides a 2D pop-up that describes the problem and allows the user to confirm or disagree with the assessment. These visualizations are preliminary. We plan on providing more detail via interactive pop-ups and a full *post hoc* report when the scan is completed.

## Preliminary Evaluation

As an initial exploration of technical feasibility and performance, we conducted a controlled evaluation of RASSAR in a one-bedroom apartment. We embedded 21 access/safety problems and 10 “non-issues” in three rooms—the entrance, living room, and kitchen—see Figures 4 and 5. We then examined three factors that may impact RASSAR performance: *lighting condition*, *scanning speed*, and *room tidiness* (Table 3). Given the number of factors, it was not feasible to exhaustively test all combinations. Instead, we investigated selected combinations. For each combination, we conducted five full scans. In total, a single researcher set up and conducted tests for six combinations of factors for a total of 30 scans (Table 6). Each scan included all 21 access/safety problems and all 10 “non-issues”.

For our performance measures, we use standard metrics including *true positives*: successfully detecting an issue; *true negatives*: successfully avoiding a non-issue; *false positives*: misclassifying an issue or identifying a non-issue as a problem; and *false negatives*: not identifying an actual problem—see Table 4 for more details. As is common in machine learning research, we combine these individual metrics into aggregate measures *precision*, *recall*,  $F_1$  score, and *accuracy* (Table 5).

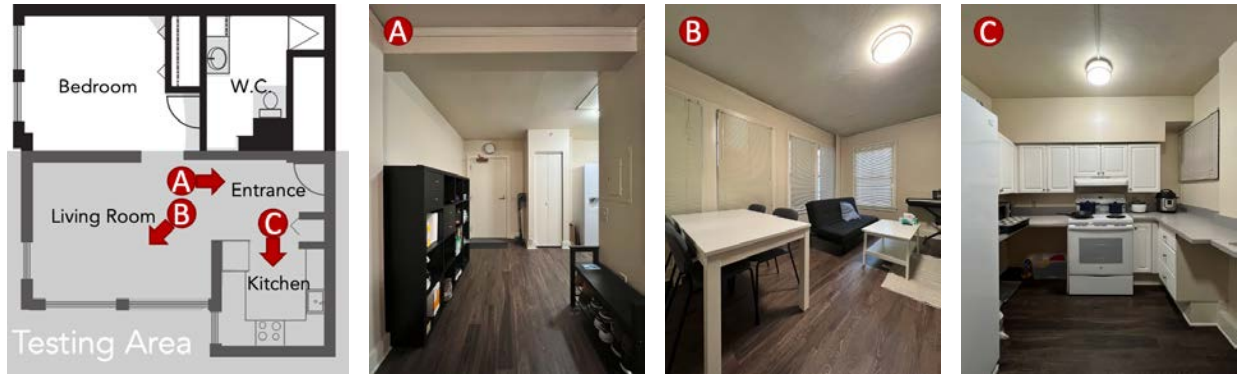

**Figure 4.** We performed an initial evaluation of RASSAR in a single apartment across three rooms: (a) the apartment entrance, (b) living room, and (c) kitchen. The red arrows in the blueprint (left image) indicate camera capture position. Note: these images are not from the RASSAR tool but, instead, are taken to illustrate the study setup.



**Figure 5.** The location and example images of the 21 access/safety issues and 10 non-issues (to examine true negatives). Dimensional issues (D) refer to furniture with inaccessible sizes (e.g., a table that is too short or too tall); Positional issues (P) refer to items placed at an inaccessible height (e.g., a light switch that is out of reach). Existence issues (E) refers to the presence of risky or unsafe items (e.g., a scissors or knife).

**Table 3.** The three scanning factors used in our preliminary evaluation.

Scanning Factor	Easy	Moderate	Hard
Lighting Condition	Well lit (> 30 lux)	Partially lit (~5 lux)	Very dark (< 1 lux)
Scanning speed	Slow (scan in ≤ 2 mins; sustained hover over objects)	Medium (scan in ≤ 2 mins; sustained hover over objects)	Fast (scan in ≤ 1 min; no sustained hover over objects)
Tidiness	Clean	Moderately messy	Very messy

**Table 4.** Specific measures used to evaluate RASSAR performance.

Performance Measure	Abbr.	Description
<b>True positive</b>	TP	Successfully identifying an access/safety issue
<b>True negative</b>	TN	Successfully avoiding a non-issue
<b>False positives</b>		
Misclassifications	FP-MISC	Misclassifying an object or reporting the wrong issue for a problem (e.g., classifying a <i>table</i> as a <i>chair</i> )
Extra detection	FP-E	Classifying a non-issue as a problem
Dimension/position error	FP-DP	Object identified correctly but <i>dimension</i> or <i>position</i> is incorrect, leading to a false positive (e.g., a table with an accessible height being inferred as too low or high).
<b>False negatives</b>		
Missed	FN-M	Missed classifying an object
Dimension/position error	FN-DP	The object has an access/safety issue related to <i>dimension</i> or <i>position</i> but the system failed to detect it.

**Table 5.** Aggregate performance measures. FP is a summation of FP-MISC, FP-E, and FP-F while FN sums FN-M and FN-F. All measures return a value between 0-1 where 1 is best.

Measure	Calculation	Description
<b>Precision</b>	$\frac{TP}{TP + FP}$	The fraction of <i>true positives</i> over all made classifications (i.e., when RASSAR makes a classification, how likely is it to be correct?)
<b>Recall</b>	$\frac{TP}{TP + FN}$	The fraction of <i>true positives</i> over all possible correct classifications (i.e., how good is RASSAR at finding all possible problems?)
<b>F<sub>1</sub> Score</b>	$2 \frac{Precision * Recall}{Precision + Recall}$	A standard technique to combine both precision and recall together and is generally described as the harmonic mean of the two.
<b>Accuracy</b>	$\frac{TP + TF}{All\ possible\ cases}$	Describes the number of correct classifications over all possible classifications (31 in this case).



Across the six experimental conditions, our accuracy ranged from 48.4-89.7%—see Table 6. Unsurprisingly, the *well lit, clean, and medium scan speed* performed best with a precision and recall of 87.4% and 92.8% respectively while the *low light* trials performed worst, primarily affecting recall: *precision*=78.8%; *recall*=26.3%. The second-worst performing trials were the *fast scan speed* condition, which resulted in 91.5% precision, 41.7% recall, and 60% overall accuracy. The amount of clutter did reduce performance from 89.7% to 82.6% (for *messy*) and 72.3% (for *very messy*) but its impact was more limited than lighting and scan speed.

To complement this quantitative analysis, we also provide example identifications and classification errors in Figures 6 and 7. For example, we show true positive examples in Figure 6 (left) as well as examples where RASSAR reported no issues for actual problems (false negatives; Figure 7 right).

**Table 6.** Our evaluation results. Each row specifies three tested factors, which are averaged over 5 scans. TP, FP, TN, and FN are counts. Precision, recall,  $F_1$  score, and accuracy are percentages.

Factors			Ground Truth		Result Cnts				Result Stats (%)			
Light	Tidy	Speed	TP	TN	TP	FP	TN	FN	Prec.	Rec.	$F_1$	Acc.
1 Well lit	Clean	Med.	21	10	18	2.6	9.8	1.4	87.4	92.8	90	89.7
2 Partial	Clean	Med.	21	10	16.2	3.6	10	2.8	81.8	85.3	83.5	84.5
3 Poorly lit	Clean	Med.	21	10	5.2	1.4	9.8	14.6	78.8	26.3	39.4	48.4
4 Well lit	Messy	Med.	21	10	15.6	2.6	10	4.8	85.7	76.5	80.8	82.6
5 Well lit	V. messy	Med.	21	10	12.4	4.4	10	7.4	73.8	62.6	67.8	72.3
6 Well lit	Clean	Fast	21	10	8.6	0.8	10	12	91.5	41.7	57.3	60

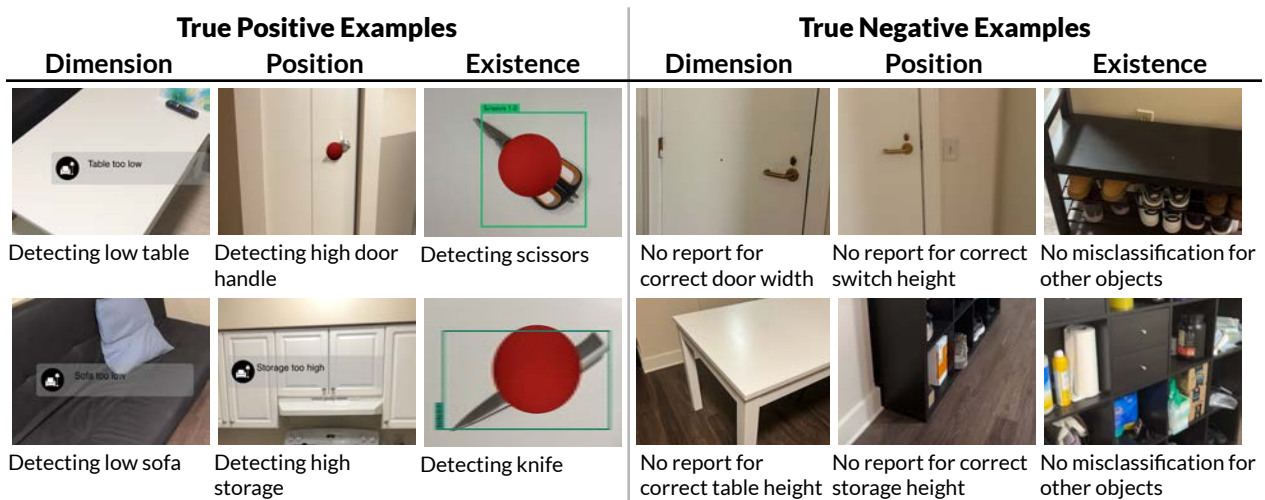

**Figure 6.** Example true positives and true negatives from our evaluation. The red sphere is a preliminary indicator used to indicate the presence of a problem anchored in 3D space and projected in AR.







False Positive Examples		False Negative Examples	
Misclassifications	Extra Detections	Missed Problem	Dimn/Pstn Error
			
Misclassified switch as socket	Detect counter edge as knife	Failed to detect rug due to clutter on it	Failed to report high counter
			
Misclassified knife as door handle	Detect pot as door handle	Failed to detect medication	Failed to report high socket

Figure 7. Example false positive and false negative detections.

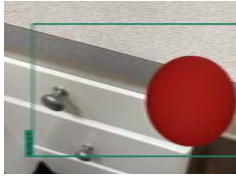
## Discussion and Conclusion

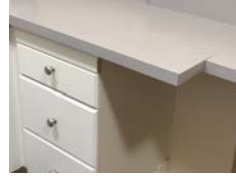
In this workshop paper, we introduced RASSAR, an initial prototype for semi-automatically identifying accessibility and safety issues of indoor spaces using LiDAR depth scanning and computer vision. While preliminary, RASSAR demonstrates a new potential approach for mapping and assessing the accessibility and safety of buildings—both public and private. Such a tool could be used to help plan infrastructural renovations (e.g., to add grab bars or ramps) or simply to inform the placement or type of furniture and the reduction of clutter (e.g., electrical cords as tripping hazards) in living spaces (e.g., homes, hotels).

**Study limitations.** Our study helped identify and characterize ideal scanning conditions; however, it was limited both in scope and size. First, only one apartment and a single set of objects were evaluated—future work should examine multiple homes, rooms, and additional object types. Second, a single researcher performed the scan—future studies should examine the effect of different human scanners. Third, and finally, a more thorough evaluation of the custom-trained YOLOv4 detection model should be performed.

**What is semi-automatic?** Recent AI-based companies like *AccessiBe* and *AudioEye* have faced significant criticism for overclaiming how well their tools automatically identify web accessibility problems and provide supposed WCAG-compliant solutions [14,31]. Tools like RASSAR may be subject to similar criticism, albeit for the physical rather than the virtual world. However, our envisioned goal with RASSAR is to create a human+AI system that enables both to work better together. For example, allowing users to actively correct false positives, add new training data for false negatives, and educate them about potential problems. Still, we must confront ethical questions about using imperfect tools to identify problems and must strive for rigorous evaluation and transparency [41]. The ways in which RASSAR actively combines human insights with AI is an active area of future work.

**Future work.** Finally, with our initial proof-of-concept prototype created, we would now like to recruit and solicit feedback from key stakeholder groups to refine and update our prototype. We would also like to prototype and examine new functionality for indoor public spaces (e.g., stores, restaurants, government buildings), experiment with AR-based head-mounted displays that could continuously track and update accessibility/safety states by passersby, and examine methods for users to share training data and new JSON specifications. We also plan to improve our deep learning model to improve recognition accuracy and efficiency (e.g., minimize gaze time).

## Acknowledgements

This work is funded in part by the NSF under grant #1652339 and UW CREATE (Center for Research and Education on Accessible Technology and Experiences)

## References

- [1] Chengbo Ai and Yichang (James) Tsai. 2016. Automated Sidewalk Assessment Method for Americans with Disabilities Act Compliance Using Three-Dimensional Mobile Lidar. *Transp. Res. Rec.* 2542, 1 (January 2016), 25–32. DOI:<https://doi.org/10.3141/2542-04>
- [2] Waleed Ali, Sherif Abdelkarim, Mahmoud Zidan, Mohamed Zahran, and Ahmad El Sallab. 2018. YOLO3D: End-to-end real-time 3D Oriented Object Bounding Box Detection from LiDAR Point Cloud. 0–0. Retrieved September 9, 2022 from [https://openaccess.thecvf.com/content\\_eccv\\_2018\\_workshops/w18/html/Ali\\_YOLO3D\\_End-to-end\\_real-time\\_3D\\_Oriented\\_Object\\_Bounding\\_Box\\_Detection\\_from\\_ECCVW\\_2018\\_paper.html?ref=https://githubhelp.com](https://openaccess.thecvf.com/content_eccv_2018_workshops/w18/html/Ali_YOLO3D_End-to-end_real-time_3D_Oriented_Object_Bounding_Box_Detection_from_ECCVW_2018_paper.html?ref=https://githubhelp.com)
- [3] Pei An, Junxiong Liang, Kun Yu, Bin Fang, and Jie Ma. 2022. Deep structural information fusion for 3D object detection on LiDAR–camera system. *Comput. Vis. Image Underst.* 214, (January 2022), 103295. DOI:<https://doi.org/10.1016/j.cviu.2021.103295>
- [4] V. Ayala-Alfaro, J. A. Vilchis-Mar, F. E. Correa-Tome, and J. P. Ramirez-Paredes. 2021. Automatic Mapping with Obstacle Identification for Indoor Human Mobility Assessment. Retrieved September 9, 2022 from <http://arxiv.org/abs/2111.12690>
- [5] J. Balado, L. Díaz-Vilariño, P. Arias, and I. Garrido. 2017. Point Clouds to Indoor/Outdoor Accessibility Diagnosis. *ISPRS Ann. Photogramm. Remote Sens. Spat. Inf. Sci.* IV-2/W4, (September 2017), 287–293. DOI:<https://doi.org/10.5194/isprs-annals-IV-2-W4-287-2017>
- [6] J. Balado, L. Díaz-Vilariño, P. Arias, and M. Soilán. 2017. Automatic building accessibility diagnosis from point clouds. *Autom. Constr.* 82, (October 2017), 103–111. DOI:<https://doi.org/10.1016/j.autcon.2017.06.026>
- [7] Basement Guides. 2019. Home Safety for People With Disabilities. Retrieved September 29, 2022 from <https://www.basementguides.com/home-safety-for-people-with-disabilities/>
- [8] Jorge Beltrán, Carlos Guindel, Francisco Miguel Moreno, Daniel Cruzado, Fernando García, and Arturo De La Escalera. 2018. BirdNet: A 3D Object Detection Framework from LiDAR Information. In *2018 21st International Conference on Intelligent Transportation Systems (ITSC)*, 3517–3523. DOI:<https://doi.org/10.1109/ITSC.2018.8569311>
- [9] Alexey Bochkovskiy, Chien-Yao Wang, and Hong-Yuan Mark Liao. 2020. YOLOv4: Optimal Speed and Accuracy of Object Detection. DOI:<https://doi.org/10.48550/arXiv.2004.10934>
- [10] Erin D. Bouldin, Elena M. Andresen, Sarah E. Bauer, Chelsea Whitney, Claudia C. Tamayo, Jessica R. Schumacher, and Allyson G. Hall. 2015. Visitability surveillance, prevalence, and correlates in Florida. *Disabil. Health J.* 8, 1 (January 2015), 140–145. DOI:<https://doi.org/10.1016/j.dhjo.2014.07.006>

- [11] Lindy Clemson. 1997. *Home Fall Hazards: A Guide to Identifying Fall Hazards in the Homes of Elderly People and an Accompaniment to the Assessment Tool, The Westmead Home Safety Assessment (WeHSA)*. Co-ordinates Publications.
- [12] L. Díaz-Vilariño, P. Boguslawski, K. Khoshelham, H. Lorenzo, and L. Mahdjoubi. 2016. Indoor Navigation from Point Clouds: 3D Modelling and Obstacle Detection. *ISPRS - Int. Arch. Photogramm. Remote Sens. Spat. Inf. Sci.* XLI-B4, (June 2016), 275–281. DOI:<https://doi.org/10.5194/isprsarchives-XLI-B4-275-2016>
- [13] Agneta Fänge and Susanne Iwarsson. 1999. Physical Housing Environment: Development of a Self-Assessment Instrument. *Can. J. Occup. Ther.* 66, 5 (December 1999), 250–260. DOI:<https://doi.org/10.1177/000841749906600507>
- [14] Todd Feathers. 2021. People With Disabilities Say This AI Tool Is Making the Web Worse for Them. *Vice*. Retrieved September 12, 2022 from <https://www.vice.com/en/article/m7az74/people-with-disabilities-say-this-ai-tool-is-making-the-web-worse-for-them>
- [15] Hwei-Shin Harriman, Dragan Ahmetovic, Sergio Mascetti, Darren Moyle, Michael Evans, and Paul Ruvolo. 2021. Clew3D: Automated Generation of O&M Instructions Using LIDAR-Equipped Smartphones. In *The 23rd International ACM SIGACCESS Conference on Computers and Accessibility (ASSETS '21)*, Association for Computing Machinery, New York, NY, USA, 1–3. DOI:<https://doi.org/10.1145/3441852.3476564>
- [16] Health Information Translations. *Child Safety Checklist*. Retrieved from <https://www.healthinfotranslations.org/pdfDocs/ChildSafetyChecklist.pdf>
- [17] VHA Home HealthCare, Teresa Chiu, Rosemary Oliver, Patti Ascott, Lin Ch'un Choo, Thelma Davis, Arvinder Gaya, Pam Goldsilver, Margot McWhirter, and Lori Letts. 2021. *SAFER HOME Manual (EN): Safety Assessment of Function & the Environment for Rehabilitation. Health Outcome Measurement and Evaluation*. Independently published.
- [18] Sungchul Hong, Jaehoon Jung, Sangmin Kim, Hyoungsig Cho, Jeongho Lee, and Joon Heo. 2015. Semi-automated approach to indoor mapping for 3D as-built building information modeling. *Comput. Environ. Urban Syst.* 51, (May 2015), 34–46. DOI:<https://doi.org/10.1016/j.compenvurbsys.2015.01.005>
- [19] Beverly P. Horowitz, Tiffany Almonte, and Andrea Vasil. 2016. Use of the Home Safety Self-Assessment Tool (HSSAT) within Community Health Education to Improve Home Safety. *Occup. Ther. Health Care* 30, 4 (October 2016), 356–372. DOI:<https://doi.org/10.1080/07380577.2016.1191695>
- [20] Kathy J. Horvath, Scott A. Trudeau, James L. Rudolph, Paulette A. Trudeau, Mary E. Duffy, and Dan Berlowitz. 2013. Clinical Trial of a Home Safety Toolkit for Alzheimer's Disease. *Int. J. Alzheimers Dis.* 2013, (2013), 1–11. DOI:<https://doi.org/10.1155/2013/913606>
- [21] Maryam Hosseini, Mikey Saugstad, Fabio Miranda, Andres Sevtsuk, Claudio T. Silva, and Jon E. Froehlich. 2022. Towards Global-Scale Crowd+AI Techniques to Map and Assess Sidewalks for People with Disabilities. (2022). DOI:<https://doi.org/10.48550/ARXIV.2206.13677>
- [22] Susanne Iwarsson. 1999. The Housing Enabler: An Objective Tool for Assessing Accessibility. *Br. J. Occup. Ther.* 62, 11 (November 1999), 491–497. DOI:<https://doi.org/10.1177/030802269906201104>
- [23] Jaehoon Jung, Cyrill Stachniss, Sungha Ju, and Joon Heo. 2018. Automated 3D volumetric reconstruction of multiple-room building interiors for as-built BIM. *Adv. Eng. Inform.* 38, (October 2018), 811–825. DOI:<https://doi.org/10.1016/j.aei.2018.10.007>
- [24] Masaki Kuribayashi, Seita Kayukawa, Hironobu Takagi, Chieko Asakawa, and Shigeo Morishima. 2021. LineChaser: A Smartphone-Based Navigation System for Blind People to Stand in Lines. In *Proceedings of the 2021 CHI Conference on Human Factors in Computing*

- Systems* (CHI '21), Association for Computing Machinery, New York, NY, USA, 1–13.  
DOI:<https://doi.org/10.1145/3411764.3445451>
- [25] Masaki Kuribayashi, Seita Kayukawa, Jayakorn Vongkulbhisal, Chieko Asakawa, Daisuke Sato, Hironobu Takagi, and Shigeo Morishima. 2022. Corridor-Walker: Mobile Indoor Walking Assistance for Blind People to Avoid Obstacles and Recognize Intersections. *Proc. ACM Hum.-Comput. Interact.* (August 2022). DOI:<https://doi.org/10.1145/3546714>
- [26] Marvin Lange, Reuben Kirkham, and Benjamin Tannert. 2021. Strategically Using Applied Machine Learning for Accessibility Documentation in the Built Environment. In *Human-Computer Interaction - INTERACT 2021* (Lecture Notes in Computer Science), Springer International Publishing, Cham, 426–448.  
DOI:[https://doi.org/10.1007/978-3-030-85616-8\\_25](https://doi.org/10.1007/978-3-030-85616-8_25)
- [27] John C. LeBlanc, I. Barry Pless, W. James King, Harry Bawden, Anne-Claude Bernard-Bonnin, Terry Klassen, and Milton Tenenbein. 2006. Home safety measures and the risk of unintentional injury among young children: a multicentre case-control study. *CMAJ* 175, 8 (October 2006), 883–887. DOI:<https://doi.org/10.1503/cmaj.050592>
- [28] Yingwei Li, Adams Wei Yu, Tianjian Meng, Ben Caine, Jiquan Ngiam, Daiyi Peng, Junyang Shen, Yifeng Lu, Denny Zhou, Quoc V. Le, Alan Yuille, and Mingxing Tan. 2022. DeepFusion: Lidar-Camera Deep Fusion for Multi-Modal 3D Object Detection. 17182–17191. Retrieved September 9, 2022 from [https://openaccess.thecvf.com/content/CVPR2022/html/Li\\_DeepFusion\\_Lidar-Camera\\_Deep\\_Fusion\\_for\\_Multi-Modal\\_3D\\_Object\\_Detection\\_CVPR\\_2022\\_paper.html](https://openaccess.thecvf.com/content/CVPR2022/html/Li_DeepFusion_Lidar-Camera_Deep_Fusion_for_Multi-Modal_3D_Object_Detection_CVPR_2022_paper.html)
- [29] Oliver Mattausch, Daniele Panozzo, Claudio Mura, Olga Sorkine-Hornung, and Renato Pajarola. 2014. Object detection and classification from large-scale cluttered indoor scans. *Comput. Graph. Forum* 33, 2 (2014), 11–21. DOI:<https://doi.org/10.1111/cgf.12286>
- [30] Modernize.com. 2021. Home Accessibility Considerations for Your Living Room. *Modernize*. Retrieved September 29, 2022 from <https://modernize.com/homeowner-resources/home-accessibility/accessible-living-room>
- [31] Amanda Morris. 2022. For Blind Internet Users, the Fix Can Be Worse Than the Flaws. *The New York Times*. Retrieved September 12, 2022 from <https://www.nytimes.com/2022/07/13/technology/ai-web-accessibility.html>
- [32] Ladan Najafzadeh and Jon E. Froehlich. 2018. A Feasibility Study of Using Google Street View and Computer Vision to Track the Evolution of Urban Accessibility. In *Proceedings of the 20th International ACM SIGACCESS Conference on Computers and Accessibility (ASSETS '18)*, Association for Computing Machinery, New York, NY, USA, 340–342.  
DOI:<https://doi.org/10.1145/3234695.3240999>
- [33] Occupational Therapy Geriatric Group, Department of Rehabilitation Science, University at Buffalo. *Home Safety Self Assessment Tool (HSSAT) v.3*. Retrieved September 11, 2022 from [https://www.tompkinscountyny.gov/files2/cofa/documents/hssat\\_v3.pdf](https://www.tompkinscountyny.gov/files2/cofa/documents/hssat_v3.pdf)
- [34] Brian Okorn, Xuehan Xiong, Burcu Akinci, and Daniel Huber. Toward automated modeling of floor plans. In *Proceedings of the Symposium on 3D Data Processing, Visualization and Transmission*.
- [35] Su Pang, Daniel Morris, and Hayder Radha. 2020. CLOCs: Camera-LiDAR Object Candidates Fusion for 3D Object Detection. In *2020 IEEE/RSJ International Conference on Intelligent Robots and Systems (IROS)*, 10386–10393.  
DOI:<https://doi.org/10.1109/IROS45743.2020.9341791>
- [36] Regula H. Robnett, Victoria Hopkins, and Judith G. Kimball. 2002. The SAFE AT HOME: A Quick Home Safety Assessment. *Phys. Occup. Ther. Geriatr.* 20, 3–4 (April 2002), 77–101.  
DOI:[https://doi.org/10.1080/J148v20n03\\_06](https://doi.org/10.1080/J148v20n03_06)
- [37] Sergio Romero, Mi Jung Lee, Ivana Simic, Charles Levy, and Jon Sanford. 2018. Development

- and validation of a remote home safety protocol. *Disabil. Rehabil. Assist. Technol.* 13, 2 (February 2018), 166–172. DOI:<https://doi.org/10.1080/17483107.2017.1300345>
- [38] Andrés Serna and Beatriz Marcotegui. 2013. Urban accessibility diagnosis from mobile laser scanning data. *ISPRS J. Photogramm. Remote Sens.* 84, (October 2013), 23–32. DOI:<https://doi.org/10.1016/j.isprsjprs.2013.07.001>
- [39] Ather Sharif, Paari Gopal, Michael Saugstad, Shiven Bhatt, Raymond Fok, Galen Weld, Kavi Asher Mankoff Dey, and Jon E. Froehlich. 2021. Experimental Crowd+AI Approaches to Track Accessibility Features in Sidewalk Intersections Over Time. In *The 23rd International ACM SIGACCESS Conference on Computers and Accessibility (ASSETS '21)*, Association for Computing Machinery, New York, NY, USA, 1–5. DOI:<https://doi.org/10.1145/3441852.3476549>
- [40] Wendy C. Shields, Andrea C. Gielen, Shannon Frattaroli, Rashelle J. Musci, Eileen M. McDonald, E. F. Van Beeck, and David M. Bishai. 2020. Child Housing Assessment for a Safe Environment (CHASE): a new tool for injury prevention inside the home. *Inj. Prev.* 26, 3 (June 2020), 215–220. DOI:<https://doi.org/10.1136/injuryprev-2018-043054>
- [41] Peter Smith and Laura Smith. 2021. Artificial intelligence and disability: too much promise, yet too little substance? *AI Ethics* 1, 1 (February 2021), 81–86. DOI:<https://doi.org/10.1007/s43681-020-00004-5>
- [42] Machiko R. Tomita, Sumandeep Saharan, Sheela Rajendran, Susan M. Nochajski, and Jo A. Schweitzer. 2014. Psychometrics of the Home Safety Self-Assessment Tool (HSSAT) to Prevent Falls in Community-Dwelling Older Adults. *Am. J. Occup. Ther.* 68, 6 (November 2014), 711–718. DOI:<https://doi.org/10.5014/ajot.2014.010801>
- [43] US Department of Housing and Urban Development, Office of Fair Housing and Equal Opportunity and the Office of Housing. 1996. *Fair Housing Act Design Manual: A Manual to Assist Designers and Builders in Meeting the Accessibility Requirements of the Fair Housing Act*. Retrieved from <https://www.huduser.gov/portal/publications/pdf/fairhousing/fairch5.pdf>
- [44] Visionaware.org. Safety in the Home. *VisionAware*. Retrieved September 29, 2022 from <https://visionaware.org/everyday-living/home-modification/safety-in-the-home/>
- [45] Qian Wang and Min-Koo Kim. 2019. Applications of 3D point cloud data in the construction industry: A fifteen-year review from 2004 to 2018. *Adv. Eng. Inform.* 39, (January 2019), 306–319. DOI:<https://doi.org/10.1016/j.aei.2019.02.007>
- [46] Galen Weld, Esther Jang, Anthony Li, Aileen Zeng, Kurtis Heimerl, and Jon E. Froehlich. 2019. Deep Learning for Automatically Detecting Sidewalk Accessibility Problems Using Streetscape Imagery. In *The 21st International ACM SIGACCESS Conference on Computers and Accessibility (ASSETS '19)*, Association for Computing Machinery, New York, NY, USA, 196–209. DOI:<https://doi.org/10.1145/3308561.3353798>
- [47] World Health Organization. 2018. *WHO Housing and Health Guidelines*.
- [48] Chris Yoon, Ryan Louie, Jeremy Ryan, MinhKhang Vu, Hyegi Bang, William Derksen, and Paul Ruvolo. 2019. Leveraging Augmented Reality to Create Apps for People with Visual Disabilities: A Case Study in Indoor Navigation. In *The 21st International ACM SIGACCESS Conference on Computers and Accessibility (ASSETS '19)*, Association for Computing Machinery, New York, NY, USA, 210–221. DOI:<https://doi.org/10.1145/3308561.3353788>
- [49] Xiangmo Zhao, Pengpeng Sun, Zhigang Xu, Haigen Min, and Hongkai Yu. 2020. Fusion of 3D LIDAR and Camera Data for Object Detection in Autonomous Vehicle Applications. *IEEE Sens. J.* 20, 9 (May 2020), 4901–4913. DOI:<https://doi.org/10.1109/JSEN.2020.2966034>
- [50] Yuhang Zhao, Elizabeth Kupferstein, Brenda Veronica Castro, Steven Feiner, and Shiri Azenkot. 2019. Designing AR Visualizations to Facilitate Stair Navigation for People with Low Vision. In *Proceedings of the 32nd Annual ACM Symposium on User Interface Software and Technology (UIST '19)*, Association for Computing Machinery, New York, NY, USA, 387–402.

DOI:<https://doi.org/10.1145/3332165.3347906>

- [51] Convention on the Rights of Persons with Disabilities. *OHCHR*. Retrieved September 9, 2022 from <https://www.ohchr.org/en/instruments-mechanisms/instruments/convention-rights-persons-disabilities>
- [52] 2010 ADA Standards for Accessible Design. Retrieved September 11, 2022 from <https://www.ada.gov/regs2010/2010ADAStandards/2010ADAstandards.htm>
- [53] Apple previews innovative accessibility features. *Apple Newsroom*. Retrieved September 9, 2022 from <https://www.apple.com/newsroom/2022/05/apple-previews-innovative-accessibility-features/>
- [54] Open Images V6. Retrieved September 12, 2022 from <https://storage.googleapis.com/openimages/web/index.html>

## Author Bios

**Xia Su** is a PhD student in Computer Science at UW interested in creativity support and accessibility. His research explores the intersection of AR, CV, accessibility and design, trying to make indoor spaces a better medium for easier and more creative lives. He has a BS and a MS in Architecture from Tsinghua University.

**Kaiming Cheng** is a PhD student in Computer Science at UW interested in the security and privacy of Augmented Reality/Virtual Reality (AR/VR). More specifically, he is interested in AR/VR systems, identifying the security and privacy flaws, and understanding end-user safety and privacy needs.

**Han Zhang** is a PhD student in Computer Science at UW interested in human behavior modeling and the design of computer-aided methods to improve human well-being. She is also interested in fairness in machine learning (ML) and building explainable ML to better understand human behaviors.

**Jaewook Lee** is an incoming PhD student in Computer Science at UW interested in augmented reality, mobile computing, and accessibility. His research primarily focuses on designing mobile solutions that can facilitate everyday tasks. He is supported by an NSF Graduate Fellowship.

**Yueqian Zhang** is a Master's student in Computer Science at UW with a focus on computer graphics and human-computer interaction. She is interested in human-centered design and developing creative applications and visualizations that spark creativity and empower communities.

**Jon E. Froehlich** is an Associate Professor in Computer Science at UW, the Director of the Makeability Lab, and the Associate Director of the Center for Research and Education on Accessible Technology and Experiences (CREATE). He is interested in applying Human+AI methods to transform how we study and analyze urban accessibility—both indoor and outdoor spaces.

## Rationale for Attendance

Our paper positions the *home* as central to the future of urban accessibility—a place for comfort, for family, and for access and safety. In doing so, our submission moves beyond public infrastructure and transit as core focal points and broadly relates to at least two of the ten key workshop questions: *how is urban accessibility data collected* and *what is the role of AI in assessing accessibility?* Of our six authors, five are students and all are junior scholars who would benefit from the discussions and networking that the workshop would provide—all which could likely shape their dissertation directions.



## Appendix

**Table 7.** A table of the 18 currently supported access/safety issues in RASSAR. RASSAR currently asks the user to select a primary target community but, of course, disabilities and identities can intersect; future versions of the tool will enable multiple selections. Acronyms of literature sources: ADA: ADA Standards for accessible design [52]; HSPD: Home Safety for People With Disabilities [7]; HAC: Home Accessibility Considerations for Your Living Room [30]; FHADM: Fair Housing Act Design Manual [43]; VA: Vision Aware [44]; HSSAT: Home Safety Self-Assessment Tool [33]; Child Safety Checklist [16].

Issue Category	Object Category	Measurement	Dimension (in inches)	Literature Sources	Primary Community			
					Older Adults	BLV	Wheelchair Users	Children
Object Dimension	Table	Height	>=28 & <=34	ADA			✓	
	Counter	Height	>=28 & <=34	HSPD			✓	
	Toilet	Height	>=17 & <=19				✓	
	Sofa	Height						
	Sink	Height	<=17				✓	
	Chair	Depth						
	Door	Radius	>=32	ADA			✓	
Object Position	Cabinet	Height	<=27	ADA			✓	
	Knob	Height	>=34 & <=48	ADA			✓	
	Door Handle	Height	>=34 & <=48	ADA			✓	
	Light Switch	Height	>=15 & <=48	FHADM			✓	
	Grab Bar	Height	>=18 & <=27 for child >=33 & <=36 for adults	ADA	✓	✓	✓	✓
	Electric Socket	Height	>=15 & <=48	VA, HSSAT, FHADM	✓	✓	✓	✓
Object Existence	Rug	Presence	null	VA, HSSAT	✓	✓	✓	✓
	Scissors	Presence	null	CSC				✓
	Knives	Presence	null	CSC				✓
	Medication	Presence	null	CSC				✓
	Smoke Alarm	Absence	null	VA, HSPD	✓	✓	✓	✓

