

Timor Python: A Toolbox for Industrial Modular Robotics

Jonathan Külz, Matthias Mayer, and Matthias Althoff

Abstract—Development of controllers, novel robot kinematics, and learning-based applications of robotics today happens almost exclusively in simulation first before being implemented in the real world. In particular, Modular Reconfigurable Robots (MRRs) are an exciting innovation in industrial robotics, promising greater flexibility, improved maintainability, and cost-efficiency compared to traditional manipulators. However, there is no tool or standardized way to simulate and model assemblies of modules in the same way it has been done for robotic manipulators for decades. We introduce the Toolbox for Industrial Modular Robotics (Timor), a python toolbox to bridge this gap and integrate modular robotics in existing simulation and optimization pipelines. Our open-source library comes with various examples as well as tutorials and can easily be integrated with existing simulation tools – not least by offering URDF export of arbitrary modular robot assemblies, enabling rapid model generation.

I. INTRODUCTION

Modular Reconfigurable Robots (MRRs) offer a promising extension to conventional robotic manipulators. Assembled from a combination of individual modules, they pose unprecedented flexibility, easy maintainability, and transportability by design [1], [2]. However, the vast amount of possible robot morphologies given a set of modules comes with challenges. Every configuration of modules leads to a new dynamic and kinematic model, which needs to be generated to apply control and planning procedures developed and used for traditional manipulators. In recent years, multiple approaches to guide the design search for module configurations, as well as control parameters, have been presented [3], [4], [5]. While these approaches share a common robot design principle, they are based on individual model building and evaluation, lacking the use of a common model generation procedure or simulation suite. There are multiple, well-established frameworks for conventional robot manipulators enabling physical simulation, but none of them can be used to the same extent in a scenario where the robot model is subject to change. The **Toolbox for Industrial Modular Robotics (Timor)** bridges this gap, offering modeling and simulation capabilities for modular robots, starting from a standardized module description. Furthermore, Timor provides URDF¹ exports for assembled configurations for easy integration in existing pipelines.

A. Contributions

Our open-source tool Timor provides effortless model generation and simulation for modular robot applications.

The authors are with the Cyber-Physical Systems Group, Department of Informatics, Technical University of Munich, 85748 Garching, Germany [jonathan.kuelz, matthias.mayer, althoff]@tum.de

¹<http://wiki.ros.org/urdf>

User-defined as well as provided module libraries can easily be assembled to robots with the possibility to automatically generate dynamic, kinematic, and collision models. Furthermore, any module combination – also referred to as assembly – comes with visualization capabilities including browser-based video generation for arbitrary trajectories. Timor is fully implemented in Python ≥ 3.6 and hosted on <https://gitlab.lrz.de/tum-cps/timor-python>. Code coverage, unittest, documentation, and a moderated issue board are publicly available. The toolbox and all dependencies can be installed with

```
$ pip install timor-python
```

B. Related Work

Timor enables modeling and simulating arbitrary combinations of robot modules, bridging the gap to traditional manipulators. This makes progress in the development of robotics simulation suites from recent decades available to MRRs.

a) Modular Reconfigurable Robots (MRRs): An MRR consists of multiple independent modules, that can be reconfigured either externally or by the robot itself (self-reconfiguring modular robots). The separation of module-level and system-level design enables rapid change-over, expansion, and robustness [1], [6]. Early publications on the concept of MRRs, such as the CEBOT [7] and the RMMS [8] in 1988, already established a distinction between joint and link modules with the possible extension of functional (i.e. end-effector) modules, a classification that is frequently used until today. Over the last decades, a multitude of modular robot systems has been proposed [2]. However, it is only recently that modular robots have finally left research laboratories.

The advantages of MRRs are especially significant if multiple tasks, potentially not known at the stage of hardware design, have to be solved using one robot or one set of modules only [1]. In many cases, however, the use of modular robots in changing configurations still required professional and experienced programmers – a limitation that made industrial use impractical and has since been resolved by the introduction of self-programming capabilities for modular robots [3]. In recent years, multiple industrial solutions for modular robots entered the market^{2,3} or have been announced for a future release⁴. Despite the increased

²<https://www.hebirobotics.com/>

³<https://www.robco.de/en>

⁴<https://www.beckhoff.com/en-en/products/motion/atro-automation-technology-for-robotics/>

supply in MRR hardware, distinct modeling and simulation libraries for MRRs are not yet available and development and research departments have to fall back to tools designed for traditional robotics, requiring use-case-specific implementations of model generation.

Theoretical groundwork for MRR model generation have been published in recent years: The CoBRA benchmark suite [9] provides a standardized module description format and tasks to compare MRRs. A general modular robot modeling language has been proposed in [10] – however both offer no builtin capability of simulating MRRs or integrating arbitrary third-party software via automated URDF export. In [11], modular robot URDF files are automatically created using a SolidWorks plugin. However, due to its dependency on third-party software and the requirement of pre-defining CAD models of the modules, use cases of this approach are limited. The authors of [12] developed a modeling approach of a more theoretical nature, proposing a procedure for automatic robot model description generation based on unidirectional modules. Both works, however, are limited to serially connected and asymmetric modules, lacking support for tree-structured configurations. Timor not only extends these works by offering support of non-serial kinematics and a unified module description format, but also implements this approach, making it accessible for future research.

b) *Robotics Simulation*: Simulation tools offer a great potential for the development of control, morphology, and motion planning in robotics [13]. There is a wide range of sophisticated physics engines like Bullet [14], MuJoCo [15], DART [15], or the Gazebo Simulator [16] that can be used to develop and fine-tune model-based controllers and precisely simulate robot and contact dynamics. On the other side of the spectrum are toolboxes with a more narrow focus on kinematic and dynamic modeling in robotics, such as the Robotics Toolbox [17] or Pinocchio [18]. These tools are often used for tasks like rapid prototyping of robot morphologies or path planning, benefitting from a higher level of abstraction that enables fast computation and a high-level application programming interface (API). While there is a great choice of tools available for robot modeling, none of them comes with built-in-support for MRRs.

There have been approaches to bridge the gap between disassembled robot modules and traditional robotics libraries for specified sets of robot modules such as the HEBI HRDF format [19]. Timor aims to provide a standardized interface to enable the modeling of arbitrary module assemblies, allowing the use of established simulation and modeling tools for MRRs.

II. LIBRARY MODULES AND FEATURES

Timor offers two main features: The automatic model generation for module configurations, including a URDF export and built-in simulation capabilities for robot kinematics and dynamics.

A. Graph Representations

Timor can compute four graph representations for robot modules and the relations between them. They are generated

automatically without any additional user input and serve as an abstract and domain-independent view on the elementary building blocks of a modular robot. A short overview of the terminology is given in the following list – details on definition and generation of the graphs are provided in the referenced sections.

- The directed *module graph* G_m (Sec. II-B) represents a single module and contains information about the relative transformations between the reference frames of the module’s joints, bodies, and connectors in its edges.
- The undirected *connectivity graph* G_c (Sec. II-D) for a set of modules indicates whether a valid connection exists between any two modules within the set.
- The assembly’s undirected *graph of modules* $G_{modules}$ (Sec. II-E) contains a node for every module instance in an assembled robot – its edges represent connections between them.
- The directed *assembly graph* G_a (Sec. II-F) is a combination of multiple module graphs and is used to represent the relative placement of every joint, body, and connector reference frame within an assembly of modules.

B. Module Definition

Modules are the atomic building blocks of robots. Their implementation in Timor follows the definition introduced for the CoBRA suite [9]. They are composed of rigid bodies and joints. Bodies can have an arbitrary number of connectors, defining interfaces to attach them to bodies in other modules. Every body, joint, and connector is assigned a reference frame F and we define the relative roto-translation between two reference frames (F_i, F_j) as the homogeneous (4×4) transformation matrix $T(F_i, F_j)$. By definition, $T(F_i, F_j)$ is anticommutative, so $T(F_i, F_j)T(F_j, F_i) = \mathbb{I}_4$, where \mathbb{I}_4 is the (4×4) identity matrix. Fig. 1a shows a so-called powerball module⁵, consisting of three bodies, two connectors, two revolute joints, and the according reference frames.

For any module, we define the directed *module graph* G_m , where the nodes are the connectors, bodies, and joints of the module. For every child-parent relation between bodies and {connectors, joints} within the module, there are two antiparallel (in opposing direction) edges. An edge e connecting nodes (u, v) with reference frames (F_u, F_v) has the transition property $T_e = T(F_u, F_v)$. Fig. 1b shows the module graph for the powerball module displayed in Fig. 1a.

While a module can be composed of an arbitrary number of these base elements, it usually represents one piece of hardware as produced by a robot manufacturer. Due to the possible multiplicity of bodies and joints, even complex hardware modules with arbitrary geometries, such as fully integrated multiple degrees-of-freedom joints can easily be described as a single atomic building block of a robot.

Modules can not contain (sub)modules. This atomic design ensures multiple modules can be parsed in any order and

⁵<https://schunk.com/fileadmin/pim/docs/IM0019885.PDF>, accessed on September 12th, 2022

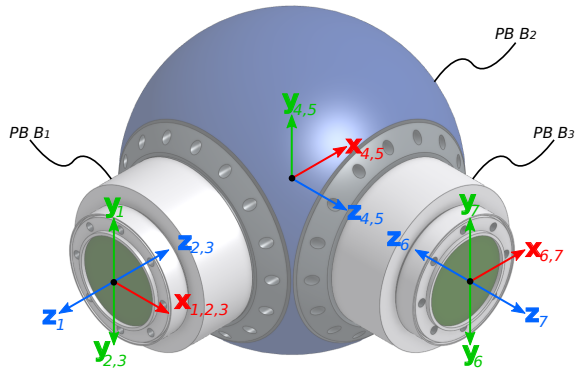

(a) Powerball module with reference frames F for connectors (F_1 and F_7), bodies (F_2 , F_4 , and F_6), and revolute joints (F_3 and F_5).

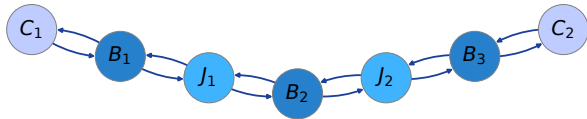

(b) Module graph G_m for the powerball module.

```

<robot name="IMPROV">
  <link name="PB B1">
    <!-- Link Details -->
  </link>
  <link name="PB B2">
    <!-- Link Details -->
  </link>
  <link name="PB B3">
    <!-- Link Details -->
  </link>

  <!-- Data from other modules -->

  <joint name="PB_connector_in" type="fixed">
    <parent link="base body"/>
    <!-- Joint Details -->
  </joint>
  <joint name="PB_joint_1" type="revolute">
    <parent link="PB B1"/>
    <child link="PB B2"/>
    <!-- Joint Details -->
  </joint>
  <joint name="PB_joint_2" type="revolute">
    <parent link="PB B2"/>
    <child link="PB B3"/>
    <!-- Joint Details -->
  </joint>
</robot>

```

(c) The URDF excerpt shows the structure for links and joints modeling the powerball module in an assembly, assuming it is attached to a "base body".

Fig. 1: Relative placements of bodies, connectors and joints in a module are defined by the positioning of their reference frames. The relative translations between reference frames are stored in the module graph G_A that also captures parent-child relations. This information can be used to auto-generate URDF models for assemblies.

independent of each other, enabling straightforward recombination of modules in arbitrary sets and a holistic module serialization within a single JSON object.

C. Connections

As introduced by CoBRA[9] and similar to [20], Timor defines connectors as body interfaces within a module that can be used to attach another module. A connection σ between two modules is defined by a pair of connectors that – based on their *size*, *gender* $\in \{\text{male, female, hermaphroditic}\}$ and *type* – can be attached to one another. The possibility to assign an arbitrary number of connectors to a body and the introduction of hermaphroditic connectors allows modeling non-serial kinematics and bidirectional modules – however, this requires a specific definition of coordinate frame alignment: The coordinate frames in a connection between connectors (i, j) with reference frames (F_i, F_j) are arranged such that the x-axes are aligned and the z-axes are pointing away from the module. Therefore, $T(F_i, F_j) = R_x(\pi)$ where $R_x(\pi)$ is a homogeneous transformation performing a rotation of 180° around the x-axis⁶.

There are two special connector types, *eef* and *base*, that define end-effector frame(s) and the base reference frame(s) to the world. Apart from these reserved keywords, other types can be chosen freely by users to reflect the connector hardware (e.g. flange, clamp).

⁶for more details, see: <https://cobra.cps.cit.tum.de/documentation/robot/>

D. Sets of Modules

We denote a set of modules as \mathcal{R} . For any set of modules, we define the *connectivity graph* G_c that consists of nodes representing the modules within the set and undirected edges between any two nodes (u, v) iff there exists at least one possible connection between the modules represented by u and v . Module sets can be stored and loaded from an intuitive JSON format, which allows effortless data transfer and manual inspection. The module sets used to generate the examples in this paper are provided together with the Timor source code⁷.

E. Assemblies of Modules

A configuration of connected modules defines a robot and is called assembly. We enumerate all modules used in an assembly and describe a connection $\sigma = (u, c_u, v, c_v)$ by providing two module indices (u, v) and the IDs of the regarding connectors used to attach them to each other (c_u, c_v) . Following that definition, an assembly can be provided by giving

- a set of connections $\Sigma = \{\sigma_0, \sigma_1, \dots\}$ and
- a tuple of IDs, defining the types of the enumerated assembly modules $M = (m_1, m_2, \dots)$.

To generate the graph of modules $G_{modules}$ for an assembly, the connections Σ are interpreted as a list of edges with

⁷https://gitlab.lrz.de/tum-cps/timor-python/-/tree/main/src/timor_sample_robots

properties (which connectors are used) connecting nodes representing the modules in M . As a further constraint, Timor requires all modules in M to be in a common module set \mathcal{R} , such that providing the unique module IDs is sufficient to define their types. If there are multiple connectors of type *base* in the assembly, additional information about base connectors and their absolute placement in world coordinates can be provided. Recognising that many MRR configurations are chains and do not require the flexibility of the introduced definition, Timor allows specifying an assembly as a tuple of modules $M = (m_1, m_2, \dots)$ as long as the first and last module contain a *base* and *ef* connector, respectively, and there is exactly one possible connection between any two neighboring modules (m_i, m_{i+1}) .

F. Building the Kinematic Model

For deriving the kinematic model of an assembly, we first generate the directed *assembly graph* G_a by taking the module graphs G_m for every module within the assembly and connecting them by inserting two directed, antiparallel edges with the transition property $T_e = T_e^{-1} = R_x(\pi)$ between any two attached connectors.

For any given sequence $E(u, v) = (a, b, \dots, z)$ of edges on a path between two nodes (u, v) in G_a , we introduce the short notation

$$\prod^{E(u,v)} T_i = T_a T_b \dots T_z.$$

If the sequence is empty, the identity matrix is returned. By traversing the nodes in G_a , the relative orientation and position between any two reference frames $T(F_u, F_v)$ can be defined as

$$T(F_u, F_v) = \prod^{E(u,v)} T_i.$$

Obviously, any sequence E works; we usually determine the shortest one using breadth-first search. We define the relative transformation between the *base* connector's reference frame and any frame F as the frame placement T_F .

By performing a breadth-first iteration over G_a , starting at the base reference frame, Timor allows generating URDF descriptions for arbitrary module arrangements as long as G_a composes a tree (closed-chain kinematics are not natively supported by URDF). The process is described in Algorithm 1. Relative transformations from parent joints to URDF elements are stored in the transformations map T . All further required information to write an according URDF element⁸⁹ such as inertia or joint limits are stored within the modules. Fig. 1c shows the resulting structure for a partial URDF, generated for the module shown in Fig. 1a.

G. Robot Kinematics, Dynamics, and Collision Model

Timor uses Pinocchio [18] to represent kinematic and dynamic robot models, an open-source library for rigid body dynamics. It integrates the FCL library [21] that we use for efficient collision checking. Using Pinocchio, arbitrary

⁸URDF links: <https://wiki.ros.org/urdf/XML/link>

⁹URDF joints: <https://wiki.ros.org/urdf/XML/joint>

Algorithm 1: Generate URDF

```

1: function GENERATE_URDF(Assembly, name)
2:    $G \leftarrow$  Assembly graph  $G_a$ 
3:    $c_b \leftarrow$  Assembly base connector
4:    $urdf \leftarrow$  initialize URDF(name)
5:   Transformations  $T \leftarrow \{C_b.frame : \mathbb{I}_4\}$ 
6:   for (node  $n$ , edge  $e$ , successor  $s$ )  $\leftarrow$  bfs( $G, c_b$ ) do
7:      $F_n, F_s \leftarrow n.frame, s.frame$ 
8:      $T_s \leftarrow T[F_n] \cdot e.T$ 
9:      $T[F_s] \leftarrow T_s$ 
10:    if is body( $s$ ) then
11:       $link \leftarrow$  make URDF link ( $s, T_s$ )
12:       $urdf \leftarrow$  append( $urdf, link$ )
13:    else if is joint( $s$ ) then
14:       $joint \leftarrow$  make URDF joint ( $s, T_s$ )
15:       $urdf \leftarrow$  append( $urdf, joint$ )
16:       $T[F_s] \leftarrow \{F_b : \mathbb{I}_4\}$ 
17:    else if is connector( $s$ ) then
18:       $joint \leftarrow$  make URDF fixed joint ( $s, T_s$ )
19:       $urdf \leftarrow$  append( $urdf, joint$ )
20:       $T[F_s] \leftarrow \{F_b : \mathbb{I}_4\}$ 
21:    end if
22:  end for
23: end function

```

robot models in the URDF format can be imported to Timor. For efficient conversion of serial modular manipulators and experimental use of closed-chain dynamics, we provide a direct conversion from any assembly to Pinocchio, also based on a breadth-first iteration over G_a .

H. Task Definition

Timor also offers a standardized implementation to describe tasks as introduced in [9]. Tasks contain goals which can be end-effector poses to reach or trajectories to follow. Furthermore, obstacles and constraints can be specified and visualized, allowing for a wide range of applications to be specified. This can either be done via the built-in API or by writing JSON files following the CoBRA definition.

I. Visualization

We extend the meshcat¹⁰ visualizer capabilities that are integrated in Pinocchio to enable browser-based visualization not only for robots, but also obstacles and modules. Furthermore, Timor provides the possibility to generate videos for robot trajectories and export them as a file. Fig. 2 shows a code sample for loading a set of modules, defining an assembly, generating the corresponding robot model, and visualizing a random trajectory. Sample videos and notebooks with this code sample and many more are included in the Timor repository for easy exploration of the toolboxes capabilities¹¹.

¹⁰<https://github.com/rdeits/meshcat-python>

¹¹<https://gitlab.lrz.de/tum-cps/timor-python/-/tree/main/tutorials>

```

import numpy as np
from timor.Module import *
from timor.utilities.visualization import animation

db = ModulesDB.from_file(modules_file, assets_dir)
modules = ('base', 'J2', 'i_45', 'J2', 'J2', 'eef')
A = ModuleAssembly.from_serial_modules(db, modules)
robot = A.to_pin_robot()
q0 = robot.random_configuration()
q1 = robot.random_configuration()
trajectory = np.linspace(q0, q1)
animation(robot, trajectory, dt=.1)

```

Fig. 2: Code sample to generate an animation.

III. NUMERICAL EXPERIMENTS

To demonstrate how Timor can be used in the development process of MRR configurations, we perform two experiments. In our first experiment, we use a module set that was published in previous work to generate URDF models for arbitrary combinations of modules, showing how Timor can be leveraged to extend and unify existing work on MRRs. In our second experiment, we evaluate a set of exemplary modules built from geometric primitives on a simple pick and place task by brute-force searching for a simple configuration solving the task. Notebooks to reproduce both experiments are provided together with the tutorials in the official repository.

A. Model Generation for an Existing Module Set

For this experiment, we use the IMPROV module set as introduced in [3], which contains modules of the Schunk LWA 4P¹² and additional designed modules. It contains two so-called powerballs (shown in Fig. 1a), ten static links of varying size and shape, and a base module. The work in [3] iterates over a pre-selected set of module combinations to find the most suitable one for a specific task. For this experiment, we migrated the module data from a previous publication to the Timor-compliant JSON format. The module set is provided together with the source code of the experiment and can be used to generate arbitrary assemblies. Adapting the guided search implemented in the IMPROV publication, there are 32,768 possible configurations of modules for a 6 degrees-of-freedom robot. Leveraging Timor to generate URDF files for all configurations takes 17 minutes on a desktop PC with an Intel i7-11700KF processor (3.2ms on average). Directly transforming an assembly to a Pinocchio-based robot model is equally computationally expensive.

B. Performing a task with a Modular Robot

In a simulated environment, we evaluate the usability of a MRR given a realistic task. A manipulator shall perform a simple pick-and-place operation. We abstract the task by specifying an environment with a desk and two goal poses indicating the initial and the desired object placement. The module set is composed of ten modules as shown in Fig. 3,

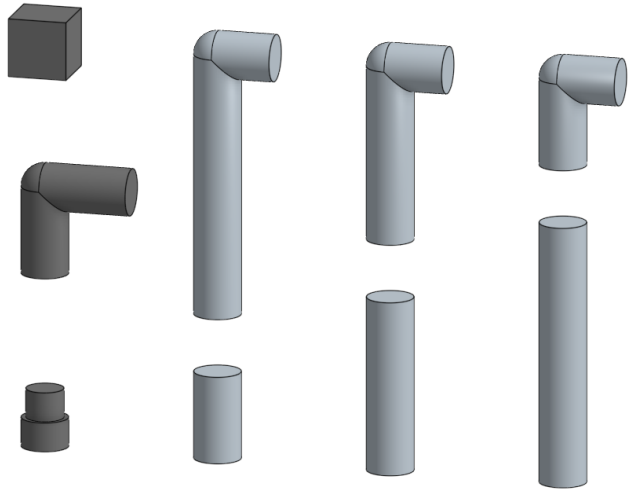

Fig. 3: Exemplary modules built from geometric primitives: The sample module set contains three I-shaped and three L-shaped links (light grey), a prismatic and a revolute joint (dark grey), a cubic base (dark grey), and an end-effector (not shown).

reassembling common features of industrially available modules.

Given an assembly with exactly one base and one end-effector, each attached to a joint, and assuming there is at most one static link between two successive joints, there are

$$\sum_{n=1}^{dof-1} |J| \cdot (|L| + 1) \cdot |J|^n = \sum_{n=1}^5 2 \cdot 14^n = 1,158,388$$

possible assemblies with up to six degrees of freedom. Only a fraction of possible assemblies might be of interest given a certain task, but even then it is infeasible to hand-craft every robot model. Timor offers model generation for any assembly in milliseconds, enabling researchers to evaluate an unprecedented amount of module configurations without having to hand-craft module-specific parsers.

To demonstrate the efficiency of Timor, we evaluate the exemplary module set on the introduced environment by brute force, calculating for each assembly the inverse kinematics for the desired goal positions and, if a solution is found, applying a path planner to generate a valid trajectory between the initial and desired object position. While this simplification fails to capture the full complexity of the task, completely omitting robot control, the results suffice to make an informed decision about the best possible configuration of modules for the task at hand. By generating a solution trajectory for each valid assembly, performance criteria like robot complexity or cycle time can be estimated and control laws need to be fine-tuned only for the best performing configurations.

We compare all valid modular robots based on the number of modules and joints necessary – following the idea that assemblies composed of a small number of modules will be cheaper to acquire. The best module configuration, based

¹²See footnote 5

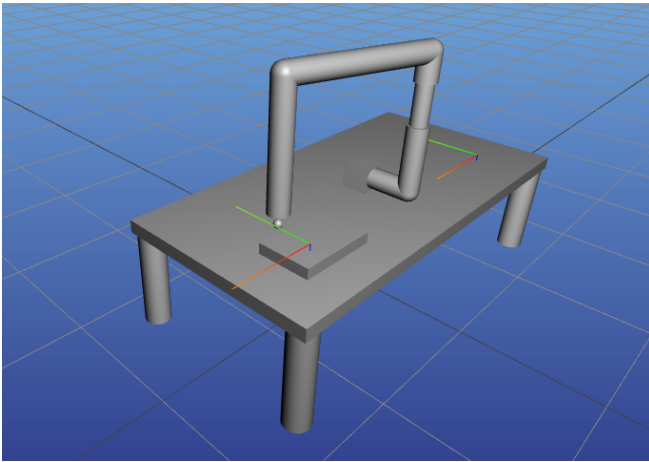

Fig. 4: Optimal Module Configuration: The figure shows the smallest possible configuration of modules for the task of moving between a "pick" and a "place" end-effector pose. It consists of one revolute and one prismatic joint, two static links, a base and an end-effector module.

on the number of modules in the assembly, is shown in Fig. 4. For the simple task, a two-degrees-of-freedom robot built from six modules only suffices to reach all goals desired. While being artificially crafted, this experiment already shows the potential of Timor – due to its efficient model generation capabilities, it can easily be integrated in optimization pipelines, offering a unified approach to model generation for all kinds of modular robot sets.

IV. CONCLUSION

We introduced and showcased Timor, the first python toolbox to model and simulate modular reconfigurable robots. Our open-source library is published under the MIT license and based on readily available components, offering easy integration in any pipeline without the need for commercial software. The code examples and introductory tutorials are provided with the toolbox repository. Bridging the simulation gap between conventional and modular robots, it provides many features necessary for configuration optimization and model identification of MRRs.

ACKNOWLEDGMENT

The authors gratefully acknowledge financial support by the Horizon 2020 EU Framework Project CONCERT under grant 101016007 and by the ZiM project on energy- and wear-efficient trajectory generation (ZF4086011PO8).

REFERENCES

- [1] M. Yim *et al.*, "Modular self-reconfigurable robot systems [grand challenges of robotics]," *IEEE Robotics and Automation Magazine*, vol. 14, no. 1, pp. 43–52, 2007.
- [2] J. Liu, X. Zhang, and G. Hao, "Survey on research and development of reconfigurable modular robots," *Advances in Mechanical Engineering*, vol. 8, no. 8, 2016.
- [3] M. Althoff, A. Giusti, S. B. Liu, and A. Pereira, "Effortless Creation of Safe Robots from Modules Through Self-Programming and Self-Verification," *Science Robotics*, vol. 4, no. 31, 2019.

- [4] J. Whitman, R. Bhirangi, M. Travers, and H. Choset, "Modular robot design synthesis with deep reinforcement learning," in *The Thirty-Fourth AAAI Conference on Artificial Intelligence*, vol. 34, no. 06, 2020, pp. 10418–10425.
- [5] S. Ha, S. Coros, A. Alspach, J. Kim, and K. Yamane, "Joint optimization of robot design and motion parameters using the implicit function theorem," in *Robotics: Science and Systems*, 2017.
- [6] G. Yang and I.-M. Chen, *Modular Robots: Theory and Practice*. Springer Singapore, 2022, vol. 1, ch. 1, pp. 1–12, Introduction.
- [7] T. Fukuda, S. Nakagawa, Y. Kawauchi, and M. Buss, "Self Organizing Robots Based on Cell Structures – CEBOT," in *IEEE International Workshop on Intelligent Robots*. IEEE, 1988, pp. 145–150.
- [8] D. Schmitz, P. Khosla, and T. Kanade, "The CMU Reconfigurable Modular Manipulator System," Tech. Rep., 1988.
- [9] M. Mayer, J. Külz, and M. Althoff, "CoBRA: A Composable Benchmark for Robotics Applications," arXiv:2203.09337 [cs.RO], 2022.
- [10] M. Bordignon, U. Schultz, and K. Stoy, "Model-based kinematics generation for modular mechatronic toolkits," in *Proceedings of the Ninth International Conference on Generative Programming and Component Engineering*, 2010, pp. 157–166.
- [11] M. Feder, A. Giusti, and R. Vidoni, "An approach for automatic generation of the URDF file of modular robots from modules designed using SolidWorks," *Procedia Computer Science*, vol. 200, pp. 858–864, 2022, 3rd International Conference on Industry 4.0 and Smart Manufacturing.
- [12] C. Nainer, M. Feder, and A. Giusti, "Automatic Generation of Kinematics and Dynamics Model Descriptions for Modular Reconfigurable Robot Manipulators," in *17th International Conference on Automation Science and Engineering*. IEEE, 2021, pp. 45–52.
- [13] H. Choi *et al.*, "On the use of simulation in robotics: Opportunities, challenges, and suggestions for moving forward," *Proceedings of the National Academy of Sciences*, vol. 118, no. 1, 2021.
- [14] E. Coumans and Y. Bai, "Pybullet, a python module for physics simulation for games, robotics and machine learning," <http://pybullet.org>, 2021.
- [15] E. Todorov, T. Erez, and Y. Tassa, "MuJoCo: A physics engine for model-based control," in *IEEE/RSJ International Conference on Intelligent Robots and Systems*. IEEE, 2012, pp. 5026–5033.
- [16] N. Koenig and A. Howard, "Design and use paradigms for Gazebo, an open-source multi-robot simulator," in *International Conference on Intelligent Robots and Systems*. IEEE, 2004, pp. 2149–2154.
- [17] P. Corke and J. Haviland, "Not your grandmother's toolbox – the Robotics Toolbox reinvented for Python," in *IEEE International Conference on Robotics and Automation*. IEEE, 2021, pp. 11357–11363.
- [18] J. Carpentier *et al.*, "The Pinocchio C++ Library: A Fast and Flexible Implementation of Rigid Body Dynamics Algorithms and Their Analytical Derivatives," in *IEEE/SICE International Symposium on System Integration*. IEEE, 2019, pp. 614–619.
- [19] Hebi Robotics, "hebi-hrdf," <https://github.com/HebiRobotics/hebi-hrdf>, 2020.
- [20] M. Bordignon, K. Stoy, and U. Pagh Schultz, "Generalized Programming of Modular Robots through Kinematic Configurations," in *IEEE/RSJ International Conference on Intelligent Robots and Systems September*. IEEE, 2011, pp. 3659–3666.
- [21] J. Pan, S. Chitta, and D. Manocha, "Fcl: A general purpose library for collision and proximity queries," in *IEEE International Conference on Robotics and Automation*. IEEE, 2012, pp. 3859–3866.