

# Reverse-Engineering Information Presentations: Recovering Hierarchical Grouping from Layouts of Visual Elements

DANQING SHI, Tongji University, China

WEIWEI CUI, Microsoft Research Asia, China

DANQING HUANG, Microsoft Research Asia, China

HAIDONG ZHANG, Microsoft Research Asia, China

NAN CAO, Tongji University, China

Visual elements in an information presentation are often spatially and semantically grouped hierarchically for effective message delivery. Studying the hierarchical grouping information can help researchers and designers better explore layout structures and understand design demographics. However, recovering hierarchical grouping is challenging due to a large number of possibilities for compositing visual elements into a single-page design. This paper introduces an automatic approach that takes the layout of visual elements as input and returns the hierarchical grouping as output. To understand information presentations, we first contribute a dataset of 23,072 information presentations with diverse layouts to the community. Next, we propose our technique with a Transformer-based model to predict relatedness between visual elements and a bottom-up algorithm to produce the hierarchical grouping. Finally, we evaluate our technique through a technical experiment and a user study with thirty designers. Results show that the proposed technique is promising.

CCS Concepts: • **Human-centered computing** → **Visualization design and evaluation methods**.

Additional Key Words and Phrases: Layout Design, Datasets, Deep Learning, Information Presentations, Infographics

## ACM Reference Format:

Danqing Shi, Weiwei Cui, Danqing Huang, Haidong Zhang, and Nan Cao. 2025. Reverse-Engineering Information Presentations: Recovering Hierarchical Grouping from Layouts of Visual Elements. 1, 1 (March 2025), 21 pages. <https://doi.org/10.1145/nnnnnnn.nnnnnnn>

## 1 INTRODUCTION

Information presentations (e.g., presentation slides, business reports, advertising posters) are widely used in daily life as an essential medium of visual communication. In an information presentation, the **layout** refers to the 2D spatial structure which is determined by the sizes and positions of the visual elements [23]. To ensure effective message delivery, the layout is usually arranged by a set of design guidelines or principles. For example, Williams Robin provided practical design guidelines (e.g., proximity, alignment, repetition, and contrast) to suggest the layout when creating an information presentation [40]. More theoretically, the Gestalt laws provide the fundamental theory to explain the mechanisms of how human beings perceive and understand visual information [8]. In a word, a well-designed layout structure enables the quick and easy perception of the information [32, 41].

Authors' addresses: Danqing Shi, Tongji University, China, [sdq@tongji.edu.cn](mailto:sdq@tongji.edu.cn); Weiwei Cui, Microsoft Research Asia, China, [weiwei.cui@microsoft.com](mailto:weiwei.cui@microsoft.com); Danqing Huang, Microsoft Research Asia, China, [danqing.huang@microsoft.com](mailto:danqing.huang@microsoft.com); Haidong Zhang, Microsoft Research Asia, China, [haidong.zhang@microsoft.com](mailto:haidong.zhang@microsoft.com); Nan Cao, Tongji University, China, [nan.cao@gmail.com](mailto:nan.cao@gmail.com).

Permission to make digital or hard copies of all or part of this work for personal or classroom use is granted without fee provided that copies are not made or distributed for profit or commercial advantage and that copies bear this notice and the full citation on the first page. Copyrights for components of this work owned by others than ACM must be honored. Abstracting with credit is permitted. To copy otherwise, or republish, to post on servers or to redistribute to lists, requires prior specific permission and/or a fee. Request permissions from [permissions@acm.org](mailto:permissions@acm.org).

© 2025 Association for Computing Machinery.

XXXX-XXXX/2025/3-ART \$15.00

<https://doi.org/10.1145/nnnnnnn.nnnnnnn>

Hierarchical grouping is a popular approach to explain the perceptual structure of the layout, which is commonly used in professional graphic design tools (see Fig 1 for an example). Here, a **group** is defined as a set of related visual elements that are associated together, and the **hierarchical grouping** is the collection of groups that are organized in a hierarchical structure. A proper hierarchical grouping can benefit many downstream use cases in visual design. A primary and direct use case is assisting graphic design: if the visual elements of an information presentation are grouped into a meaningful hierarchical structure, users can conveniently move/resize/rotate/transform/delete a group of related elements. It can also help to apply animation effects to the elements [37]. Furthermore, other potential use cases that rely on understanding the grouping structure include design assessment [43], visual search [14], information extraction [29], information seeking [13], and design space exploration [24].

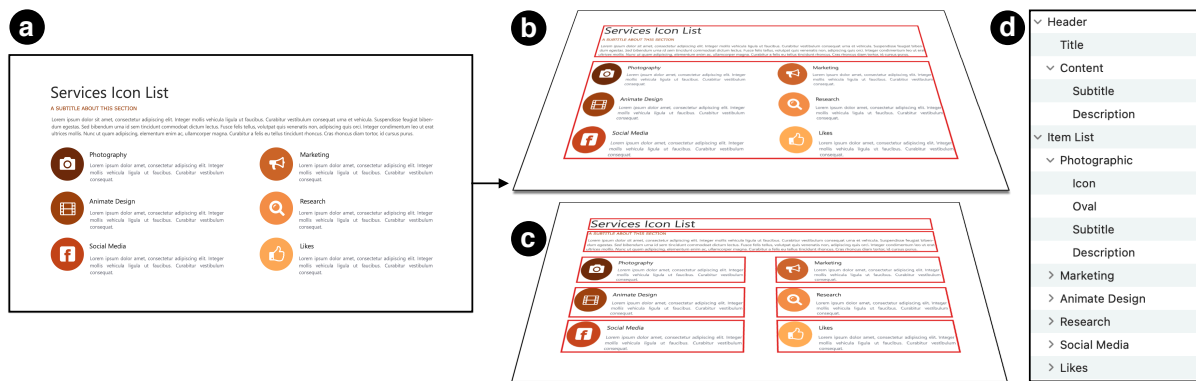

Fig. 1. Example to show the grouping of information presented in two hierarchies: original design in (a), large grouping granularity in (b), and smaller groups in (c). High-level groups consist of low-level groups, which consist of visual elements. In each grouping hierarchy, visual elements in the same red box are in the same group. (d) The pane to view the hierarchical grouping in PowerPoint.

Although useful for downstream applications, most information presentations in the wild do not explicitly annotate the hierarchical grouping. To address this problem, we aim at automatically recovering hierarchical grouping from layouts of visual elements in information presentations. It is a challenging task for two major reasons. First, unlike the spatial relationships between elements in the layout such as direction and distance, which can be computed by using predefined rules [19], the grouping structure is the implicit knowledge hidden in the layout. Second, there are many factors that may affect the grouping structure, which is hard for researchers to enumerate all the rules and principles. Several existing works have already paid attention to recover grouping from arbitrary images [32] and visualizations [38], but not from layouts of visual elements in information presentations. A most related work [18] implements four Gestalt laws to produce grouping in web page design which performs well in their test cases. However, it still requires extensive human efforts for researchers to figure out better design rules to improve accuracy. Therefore, our emphasis in this paper is to incorporate a learning-based approach to a more intelligent grouping technique.

The large collection of information presentations available online serves as a great resource for our research. Therefore, we first constructed a large-scale dataset of information presentations. Specifically, as PowerPoint (denoted as PPT) is one of the most commonly used formats for information presentation in daily life, we have collected about 1,000 PPT files from online public websites, which finally gave us 23,072 well-designed information presentations. Each information presentation contains about 27 visual elements on average. By parsing visual

elements from these slides, we extracted typical types of elements, such as shape, text, picture, and chart. To assist in understanding the layout, we also parsed all spatial features of each visual element.

Next, we propose an automatic approach to produce a hierarchical grouping of visual elements from information presentations. To address the problem by not enumerating all possible factors, we first incorporate a learning-based approach to model the relatedness between visual elements in information presentations. Specifically, we introduce a Transformer-based model, which can capture the contextual layout information to predict relatedness between visual elements by learning from human-labeled information presentations. In addition, we improve the original Transformer-based model by integrating the spatial-aware attention mechanism to involve the relative spatial information among elements. Second, our technique hierarchically groups all the elements from bottom to up according to the predicted relatedness. In detail, we define a graph model of the information presentation layout, in which nodes are visual elements and edges are the adjacent connections between elements. Then we build a graph-based algorithm to group the visual elements hierarchically.

To evaluate the technique, we conduct a technical evaluation to compare the accuracy results of our models with a baseline method. We find that our technique can correctly predict pairwise relatedness with high accuracy. Furthermore, we conduct a user study with thirty designers to evaluate the final hierarchical grouping results. The result shows that our technique has comparable quality with the slides manually grouped by designers.

To summarize, we make the following three key contributions in this paper:

- **Dataset.** We contribute a large-scale design dataset to the community. It includes 23,072 information presentations with 620,878 visual elements collected from the Internet. The dataset is freely available for academic purposes <sup>1</sup>.
- **Technique.** We present an automatic approach for recovering hierarchical grouping in information presentations. It consists of two major modules: a Transformer-based model for predicting relatedness between visual elements and a bottom-up algorithm for grouping the visual elements hierarchically.
- **Evaluation.** We conduct a technical evaluation and a user study with thirty designers to evaluate our proposed technique. The results show that our technique provides high prediction accuracy, and it can produce hierarchical grouping comparable to designer's work.

## 2 BACKGROUND AND RELATED WORK

This section provides three categories of related work in the community, including graphic design layout, grouping of information, and data construction for graphic design.

### 2.1 Graphic Design Layout

To create effective and aesthetic information presentations, designers need to put significant effort into designing the layout [41]. Therefore, an extensive range of techniques has been proposed to assist layout design. Some studies in the community developed automatic layout algorithms that can place graphical and textual elements in proper positions based on certain design rules [23]. For example, DesignScape [26] is an interactive system that aids the design process by interactively generating layout suggestions, such as position, size, and alignment. SketchPlore [34] uses a real-time layout optimizer which automatically infers the designer's task to search for both local design improvements and global layout alternatives. As the design of information presentation also commonly uses grid layouts to define spatial structures using grid lines [25], a more recent work GRIDS [6] uses a mixed-integer linear programming model for grid layout generation that optimizes packing, alignment, grouping, and preferential positioning of elements. However, these rule-based methods typically aim to optimize certain objectives, which may ignore other aspects of the design. Recent advances in deep learning enable advanced techniques to generate graphic layouts by learning existing works. Zheng *et al.* [48] propose a deep

<sup>1</sup><https://github.com/sdq/reip>

generative model to synthesize layouts based on the semantics of visual elements. Vinci [12] uses a sequence-to-sequence generative model to match the visual elements and layouts for generating an aesthetic advertising poster. LayoutGAN [21] synthesizes layouts from different types of 2D visual elements by using a Generative Adversarial Network architecture. While these techniques are powerful in generating information presentation, they usually ignore the stage of understanding the layouts exactly.

Another part of works in the community focus on understanding the layout in the graphic design. For instance, Bylinskii *et al.* [3] present a machine learning model that predicts the relative importance of different visual elements in graphic designs. As inferring spatial relationships among elements plays a vital role in layout suggestion, Xu *et al.* [45] presents an interactive user interface for visualizing two types of spatial relationships: edge alignment and equal spacing. O'Donovan *et al.* [27] propose an energy-based method to learn three hidden variables in single-page layouts, including alignment, the importance of each element, and grid-based segmentation. These works are relevant to our work, which also extract the layout-related information from the design of information presentations. However, unlike these previous works, we aim to focus on the hierarchical grouping, which is the implicit knowledge hidden in the layout of visual elements. In this work, we take advantage of a deep-learning-based approach to reverse-engineer information presentations, especially recovering the hierarchical grouping from layouts of visual elements.

## 2.2 Grouping of Visual Information

Though layouts might vary specific to different document types, such as presentation slides, web pages, advertising posters, the grouping of information is general to organize the content of information presentations. A proper grouping can improve the readability and highlight relatedness between the information [16]. In practice, the *Proximity* guideline proposed by [40] states "Group related items together". Designers can move visual elements spatially close to make them a cohesive group rather than unrelated items. In other words, spatial closeness usually implies a high relatedness between the elements. In addition, the Gestalt principle states that human beings generally organize information using a top-down approach [16, 39]. This principle suggests a designer should organize visual information in a clear hierarchical grouping structure.

Automatic grouping methods are extensively utilized in image processing. Ren *et al.* [31] used the features derived from the classical Gestalt cues to group pixels into regions. Wattenberg *et al.* [38] utilizes machine vision techniques for analyzing an image at multiple resolutions to describe the hierarchical segmentation of an image. Several bottom-up approaches were proposed for hierarchical grouping pixels in image or video [1, 30, 44]. Recently, advanced deep learning methods also propose a range of end-to-end solutions for pixel-level grouping [10, 15, 22]. However, these grouping techniques in image processing are all based on pixels. In contrast, grouping in information presentation focuses on the visual elements in a 2D view, which have more diverse spatial features.

There are several relevant grouping techniques for graphic design. Rosenholtz *et al.* [32] utilized Gestalt laws to create a simple model for perceptual grouping for arbitrary images. Zhen *et al.* [47] proposed a model to merge Web page content into semantic blocks by simulating human perception. Yu *et al.* [5] proposed a process to analyze the structure of a web page and organize the web elements into a two-level hierarchy. However, these web-oriented grouping techniques commonly require a formal HTML structure. Recently in infographic design, InfoVIF [24] analyzes the presentation flow of static infographics and extracts the visual groups using Gestalt principles of proximity and similarity. InfoMotion [37] extends InfoVIF to reconstruct visual groups using a clustering algorithm. However, these two recent techniques use carefully designed rules to pick elements into a visual group, which may ignore other design aspects. In addition, they both focus on the flow structure extraction but not the hierarchy in the grouping of information. One similar work propose a computational way to group DOM elements in web pages [18]. However, they manually defined four objective functions which

is hard to extend and improve. Another similar work is proposed by O'Donovan *et al.* [27], who proposed a region-based hierarchical segmentation. The algorithm takes graphic layouts as input and then cuts the region into two sub-regions iteratively. This approach requires the design following a grids layout, and there should be non-overlapping among visual elements. When compared to these works, our approach does not have the constraints for manually-defined rules or strict requirements for the layout.

### 2.3 Data Collection for Layout Design

To support the research for layout design in information presentations, a range of works construct datasets by collecting designs from public online websites. In the data visualization community, Chen *et al.* [4] build a dataset containing 360 images of multiple visualizations collected from academic publications and make annotations of layouts. InfoVIF provides a large dataset of 13,245 infographics in image format created to explore visual information structure in infographics. Deka *et al.* [7] presents Rico, the largest repository of mobile app designs by crowdsourcing, created to support data-driven applications like UI layout generation. Webzeitgeist [20] is another design repository of over 100,000 Web pages with the statistical description of layouts. To support layout generation, Zheng *et al.* [48] collected a corpus of 3,919 online magazine pages with rich annotations, including categories, semantic layouts, and textual summaries. Compared with these studies, we aim to construct a large-scale layout dataset that contains rich spatial features to understand the layout structure. Therefore, we collected 23,072 well-designed information presentations from public websites. We parsed all the related spatial features of each visual element.

## 3 INTERVIEWING EXPERTS

To help us know the hierarchical grouping used in the design, we conducted a preliminary interview with ten graphic designers (eight females, aged 23-34). These designers have 6.3 years of design experience on average (from 2 to 16 years) and have professional training in design schools. They are all familiar with designing information presentations. During the interview, we guided them to explain their design experience with questions under two primary topics: benefits from hierarchical grouping and criteria for hierarchical grouping. We summarize their feedback as follows:

**Benefits from hierarchical grouping.** As most professional graphic design software (i.e., Adobe Illustrator, Sketch) support the hierarchical grouping, all the interviewees are familiar with this function. According to our interviewees, there are two reasons why they use hierarchical grouping in their information presentation files. The first major reason (mentioned by eight interviewees) is efficiently supporting layout design. For example, if a designer wants to align two groups of items, he can easily select one group at the proper level of hierarchy and then align it to another group. Otherwise, he has to operate each item in the group, which can absolutely reduce the efficiency. Another example, one expert in the interview said: *“I often need to create Web UI designs with various sizes to accommodate to different screen sizes, such as mobile, tablet, and laptop. A proper hierarchical grouping can save me lots of time to revise the layout”*. Second, four interviewees state that hierarchical grouping can clearly segment a graphic design, assisting collaboration with other designers on the same document. On the other hand, all the designers agreed that a design without a proper hierarchical grouping may cause trouble. Specifically, one designer commented that *“Without proper grouping, it is more possible to make mistakes when adjusting the layout and have to undo the operation.”* The designers also state that when reusing the design files in the wild, they have to manually adjust the hierarchical grouping of the visual elements before editing, which may burden their design process.

**Criteria for hierarchical grouping.** When discussing the best practice of grouping, designers mentioned three major criteria. First, the items in a cohesive unit should have a high probability of being grouped together. For the example of Fig 1-a, the item in the list, which consists of an icon, a title, and a description to convey a

single message, should be grouped together because these elements form a high cohesive unit. Second, designers thought that spatial distance matters a lot when grouping elements. Elements relating to each other should be grouped close together. Designers also agreed that they only consider grouping elements in the neighborhood in most situations. Last, the grouping should follow a strict hierarchical tree structure, making the exact group can be easily accessed from its parent group.

Based on the feedback gathered from the interviews with designers, our goal is to propose an automatic approach to recovering hierarchical grouping from information presentations. To achieve the goal, our grouping technique is designed based on the following three design requirements:

- R1 Capturing relatedness between visual elements.** The first and foremost requirement is to capture relatedness between visual elements, which can be affected by many factors. Therefore, the technique should be intelligent enough to take as much knowledge as possible into consideration.
- R2 Considering spatial distances.** According to the expert interview, spatial distance is the frequently mentioned consideration during the design process. They prefer to search for elements in the neighborhood when composing a group. The grouping technique should give priority to the visual elements that are in the neighborhood and placed close.
- R3 Constructing a hierarchical tree structure.** The hierarchical grouping result should be a tree structure. A parent group can contain multiple sub-groups. However, a sub-group cannot be across multiple parent groups.

To fulfill these requirements, the design of our technique consists of two major modules (1) a deep learning model for predicting pairwise relatedness (Section 5) and (2) a graph-based algorithm for grouping (Section 6). In the first module, the deep learning model can understand the relatedness between visual elements by learning from labeled training data (**R1**). In the second module, we model the layout as a graph model to represent the adjacent connection (**R2**). Then we propose a graph-based algorithm to group the visual elements from bottom to up hierarchically (**R3**).

## 4 COLLECTING INFORMATION PRESENTATIONS

To understand information presentations, we construct a large-scale dataset of information presentations with diverse layouts from the Internet. First, we describe the procedure to collect the data. Then, we analyze the statistical results and extract the spatial features.

### 4.1 Collection Procedure

We choose PowerPoint files as the target file format to construct our dataset. Because PPTs are the most commonly used information presentations in our daily life. Each slide in the PPT file is an information presentation that consists of a set of graphical and textual elements with corresponding features. Furthermore, PPT files contain the actual spatial information for each visual element, which can be parsed by the open-source tool<sup>2</sup>. Therefore we do not need to use any computer-vision methods to detect visual elements from information presentations like InfoVIF [24], which can also give us more accurate results.

To ensure the design quality and diversity, we collect the PPTs through the two key steps: (1) searching a large of candidates in the wild, and (2) selecting proper slides to include in our dataset.

In the first step, we searched for public websites like SlideShare<sup>3</sup> that are used for sharing slides. We also searched related keywords such as “slides template”, “marketing slides” and “presentation design” in popular search engines to collect open-source PPT files. We include as many slides as possible in this step. At the end of this step, we downloaded about 1,000 PPTs in total, including more than 40,000 information presentations.

<sup>2</sup><https://pypi.org/project/python-pptx>

<sup>3</sup><https://www.slideshare.net>



In the second step, we select the proper information presentations from these candidates to construct our dataset. To ensure the layouts of slides are diverse and qualified, we define the following four criteria to filter the slides:

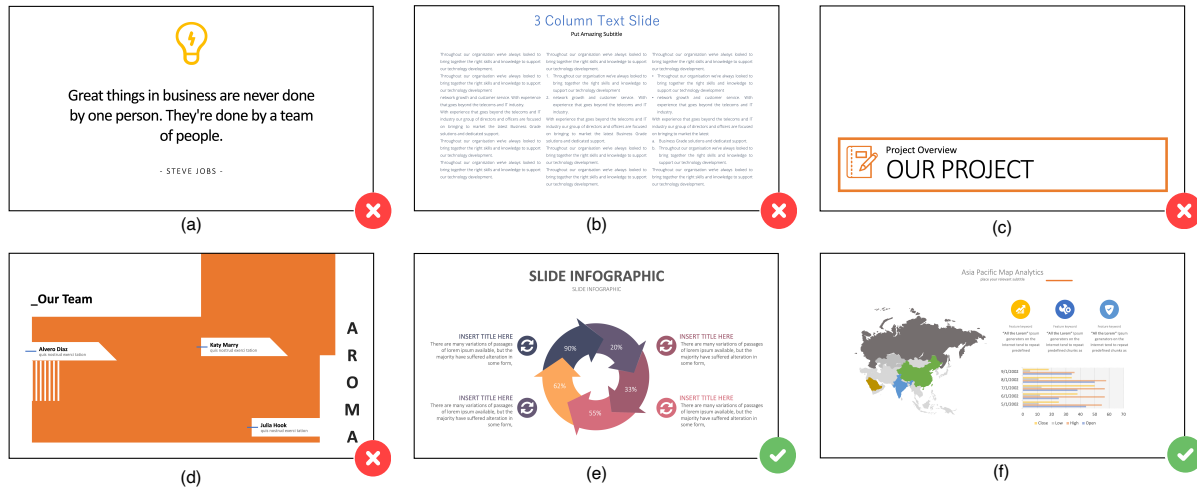

Fig. 2. This figure illustrates four negative cases that we removed from the dataset: (a) includes only three visual elements (one icon and two textual objects); (b) has no graphical elements; (c) just contains one visual group; (d) has a disorder layout. (e) and (f) are two positive cases involved in our dataset.

- C1** The slide should have more than three visual elements. As the counterexample is shown in Fig 2-a, it only includes an icon shape and two textual objects. Too few elements are not valuable to be grouped.
- C2** The slide should not only have graphical elements or textual elements. The counterexample in Fig 2-b presents a slide with only text information.
- C3** The slide should contain at least two visual groups. As we can see the counterexample in Fig 2-c), which is a title page, the four elements (a rectangle, an icon shape, and two textual objects) form a coherent group to show a single message. This criterion is more subjective than C1 and C2. Thus, we involve the human effort to assess it.
- C4** The elements in the slide should be arranged in a well-organized structure. It also means the elements should form an intuitively regular pattern [24]. In Fig 2-d, a counterexample shows a layout whose elements are disorder to some extent. As this criterion is also highly related to subjective judgment, human effort should be involved to decide whether a slide is qualified or not for this criterion.

Two co-authors of this paper manually filtered these slides. One of them has studied in a design school for three years. Each slide takes one author about 5 seconds to decide whether to keep it or remove it. They kept the cases they are unsure about and met every three days to discuss these unsure cases and achieve consensus. The whole process spent seven days (about 6 hours per day) in total looking through all the slides. Fig 3-e and Fig 3-f are two typical information presentations included in our dataset. They both have diverse visual elements and a clear layout structure.

## 4.2 Results

We finally collect a total of 23,072 slides with 620,878 visual elements. The average number in each slide is 26.9. Fig 3-a presents the distribution of the number of elements in our data collection. The majority of the slides (83.7%) contain less than 40 elements. More than half of the slides have 10 to 30 visual elements (57.3%).

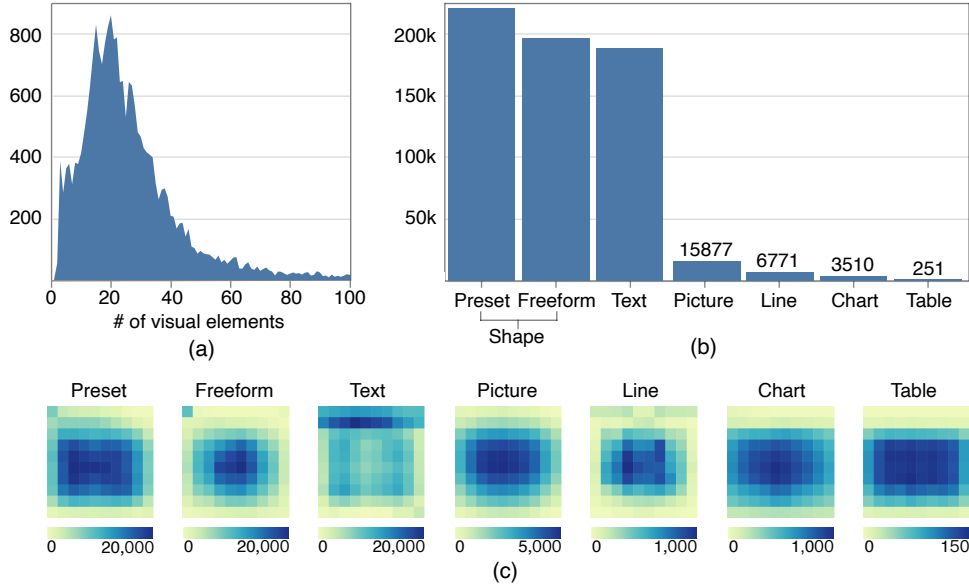

Fig. 3. Statistical results: (a) The distribution of element count per slide; (b) The distribution of types in the dataset; (c) Spatial distribution of the seven element types on the normalized space. The color of a region indicates the count of the element type appearing at the corresponding region.

We encode the layout structure of each slide with different *types* of visual elements. In total, there are seven major *types* we extracted from our collection, including *preset geometry*, *freeform shape*, *text*, *picture*, *line*, *chart*, and *table*. The distribution of element type is shown in Fig 3-b. Let's look at the meaning of all the element types. A *preset geometry* (216,300) is a type of typical shapes provided by general design tools, such as a rectangle, a circle or a star. In detail, the most used *preset geometry* is rectangle (119,818) and the second is oval (56,560). A *freeform shape* (192,673) is a user-defined shape which is composed of multiple paths. This kind of elements usually are icons or embellishments in the design, which might have a related semantic meaning for the design. A *text* (185,259) is a text box which enable users to input text information. It is the most important component which is responsible for conveying message in information presentations. The other four types are not the majority of the visual elements, including *picture* (15,887), *line* (6,771), *chart* (3,510) and *table* (251). Fig 3-c shows the spatial distributions of these seven element types on the normalized space. This demonstrates the diversity of our data collection in terms of layouts of visual elements. From these statistical results, we can see that the information presentations in our data collection have rich visual elements and diverse layout structures.

Then, we extract related spatial features from each visual element. Specifically, we record the element type and the spatial features, including z-index, position, size, rotation. For the textual elements, we also extract the alignment of the text. The reason to pick these features is because all of them are highly relevant to the spatial structure. We describe these spatial features as follow:



- *Z-index*. Z-index feature indicates the order of element in the z-axis. An element with higher z-index is on the top of another element with lower z-index. We represent the z-index using a natural number.
- *Position*. Position feature indicates the position of the element. We use the bounding box  $(x_1, y_1, x_2, y_2)$  to represent the position of the element, where  $(x_1, y_1)$  denotes the top left of the bounding box and  $(x_2, y_2)$  denotes the bottom right. We adopt the normalized parameters by scaling  $(x_1, y_1, x_2, y_2)$  to the range of  $[0, 1]$ .
- *Size*. Size feature  $(w, h)$  is the normalized width and height of a visual element. Although this feature can be computed by the position feature, we explicitly represent this feature to help the computer understand this relationship more easily.
- *Rotation*. Rotation feature indicates the degrees of clockwise rotation of the element ranged from 0 to 360.
- *Alignment*. Alignment feature is a text-specific feature as a text can be aligned in vertical and horizontal direction. It includes two attributes for vertical alignment (top, middle, bottom, and mixed aligned) and horizontal alignment (left, right, center, and mixed aligned).

To protect data privacy, we remove all the content-related information, such as text and images. The final dataset only keeps the features of each visual element mentioned before, which is enough for the study of layout structure. We open-source the dataset at [url omitted for anonymity]. We discuss more about the usage of the dataset in Section 8.2.

## 5 PREDICTING PAIRWISE RELATEDNESS

Before we group visual elements in an information presentation, we first consider the relatedness between elements, which also implies the probability of grouping two elements together (**R1**). This section introduces a deep learning model to solve this problem. We first introduce the basic model architecture and the working mechanism. After that, we introduce an improvement to enhance the performance. At last, we briefly describe the training process and model implementation.

### 5.1 Model Architecture

To predict the relatedness between any two visual elements in an information presentation, we propose a **Transformer**-based [35] model for pairwise prediction. There are two main reasons to use a Transformer-based model. First, as an information presentation could be formalized as a design sequence [12], it is reasonable to adopt a sequence model in our task. Compared with traditional sequence models like recurrent neural networks, the self-attention mechanism [35] in Transformer models can capture long-range contextual information in the whole layout design. Specifically, understanding the spatial information of all visual elements in the design as global context is helpful when predicting the relatedness between two visual elements. Second, the language model on the Transformer architecture has been widely used. It would be easy to adapt the pre-training to have a promising improvement with the growth of data collection.

The model architecture is shown in Fig 4. It relies on supervised training based on human-labeled information presentations (Fig 4-a). The input of the model is a series of visual elements parsed from the information presentation (Fig 4-b), and the output is an association matrix of predicted relatedness between elements. The core model is based on the Transformer backbone, which is similar to the latest work for learning layout representation [42]. It consists of three components: (1) an embedding layer to represent visual elements with heterogeneous features (Fig 4-c), (2) a Transformer encoder for contextualized representation (Fig 4-d), and (3) a prediction layer to predict pairwise relatedness (Fig 4-e). The model is trained to minimize the cross-entropy loss between the output and the ground truth (Fig 4-f).

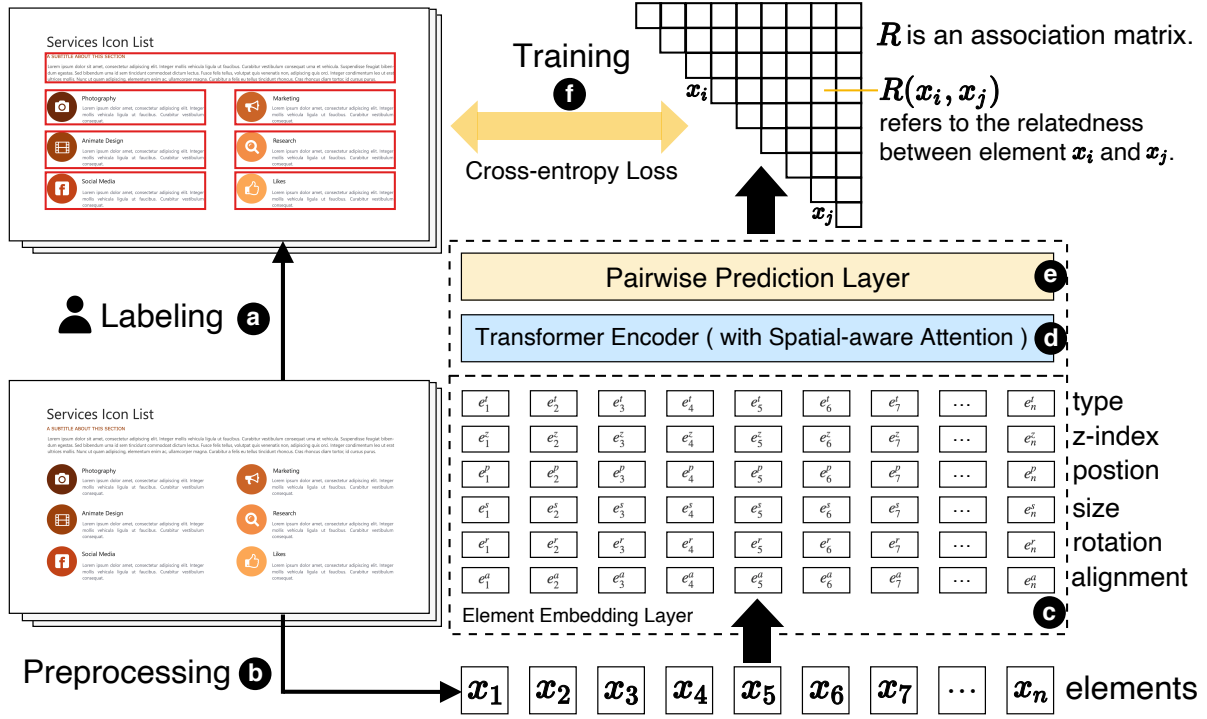

Fig. 4. The model architecture and mechanism for predicting relatedness between visual elements.

## 5.2 Working Mechanism

**Preprocessing.** Consider the example layout design in Fig 4-a. The preprocessing module (Fig 4-b) first parses the design file to extract all visual elements in the design and then orders it into a sequence of visual elements according to the z-index. We represent the design sequence as:  $[x_1, x_2, \dots, x_n]$ , where  $x_i$  indicates the  $i$ -th element in the sequence. According to the statistics in Section 4.2, we set the maximum sequence length to 128 as most of the slides in our dataset contain 128 elements or fewer. For efficient batch training, we fill the design sequence to this maximum length with special padding tokens.

**Embedding.** To abstract visual elements into a data format that is understandable to the Transformer model, we convert each visual element  $x_i$  into a set of feature embedding vectors. For the numerical features, including *z-index*, *position*, *size*, and *rotation*, we embed them using the positional encoding method [35]. For the rest two categorical features *type* and *alignment*, we embed them using a learnable embedding table. The final representation of a visual element is a single embedding vector  $e_i$  by concatenating all the feature embedding vectors as:

$$e_i = \Theta(e_i^t \oplus e_i^z \oplus e_i^p \oplus e_i^s \oplus e_i^r \oplus e_i^a) \quad (1)$$

where  $e_i^t$  to  $e_i^a$  denote the feature embedding vectors for *type*, *z-index*, *position*, *size*, *rotation*, and *alignment* respectively.  $\Theta$  is a non-linear transform function. In this way, the output of the embedding layer is a sequence of visual element embeddings:  $[e_1, e_2, \dots, e_n]$ , which will serve as the input to the Transformer encoder.

**Encoding.** The Transformer encoder (Fig 4-d) updates the element embeddings into contextualized vectors  $[h_1, h_2, \dots, h_n]$ . According to the query-key-value attention mechanism in Transformer, the model will involve

three learnable weight matrices: query weight matrix  $\mathbf{W}_Q$ , key weight matrix  $\mathbf{W}_K$ , and value weight matrix  $\mathbf{W}_V$ . The self-attention mechanism computes the attention score between the query of element embedding  $e_i$  and the key of element embedding  $e_j$  as follow:

$$\alpha_{ij} = \frac{1}{\sqrt{d_k}} (\mathbf{e}_i \mathbf{W}_Q) (\mathbf{e}_j \mathbf{W}_K)^\top \quad (2)$$

where  $\sqrt{d_k}$  is the scaling factor to stabilize gradients during training. Finally, the output of the Transformer encoder is the weighted average of the value vectors of each element embedding  $e_j$  with normalized attention scores.

$$\mathbf{h}_i = \sum_j \frac{\exp(\alpha_{ij})}{\sum_k \exp(\alpha_{ik})} \mathbf{e}_j \mathbf{W}_V \quad (3)$$

**Predicting.** In the prediction layer (Fig 4-e), we predict the pairwise relatedness between every two elements. We use an association matrix  $\mathbf{R}$  with size  $(n \times n)$  to denote the prediction result. In the matrix, each item  $\mathbf{R}(x_i, x_j)$  represents the relatedness between element  $x_i$  and  $x_j$  range from 0 to 1, where 1 means the model is confident that the two elements should be assigned in the same group and 0 means there is no possibility to group them. The predicted relatedness  $\mathbf{R}(x_i, x_j)$  is the average value of two related attention scores  $r_{ij}$  and  $r_{ji}$ :

$$r_{ij} = \frac{\exp \mathbf{W}_Q^r \mathbf{h}_i \cdot \mathbf{W}_M^r \mathbf{h}_j}{\sum_j \exp \mathbf{W}_Q^r \mathbf{h}_i \cdot \mathbf{W}_M^r \mathbf{h}_j} \quad (4)$$

where  $\mathbf{W}_Q^r$  and  $\mathbf{W}_M^r$  are two learnable matrices for query and memory according to the query-memory attention mechanism [36]. The  $r_{ij}$  denotes the attention score between the query of  $\mathbf{h}_i$  and the memory of  $\mathbf{h}_j$ ; vice versa for  $r_{ji}$ .

### 5.3 Improvement

The spatial relations between elements, including relative *z-index* and relative *position* in both the x-axis and y-axis, are informative for measuring the relatedness between elements. However, the basic attention mechanism in the current Transformer encoder only considers the absolute position of visual elements, while the relative information is not explicitly modeled.

To better utilize this information, we improve the model by incorporating the spatial-aware attention mechanism[33, 46]. Specifically, we compute a new attention score  $\alpha'_{ij}$  by adding three learnable biases (relative *position* biases  $\mathbf{b}^X$  and  $\mathbf{b}^Y$ , relative *z-index* bias  $\mathbf{b}^Z$ ) to the original score as follow:

$$\alpha'_{ij} = \alpha_{ij} + \mathbf{b}^X + \mathbf{b}^Y + \mathbf{b}^Z \quad (5)$$

We have empirically verified that adding this spatial-aware attention mechanism can increase the accuracy of the model, which our technique will use by default. We present the evaluation of the improvement in Section 7.1.

### 5.4 Training

To train the prediction model, we should first label the relatedness between elements in the slides (Fig 4-a). The labeling process here is simple: grouping the related items together. It is worth noting that this labeling process only needs grouping information in a single hierarchy, so that general users without a design background can easily label the slides based on their perception and cognition. In practice, users use PowerPoint software to group the related elements. The ground truth is a binary matrix, in which relatedness is set to one if two elements are in the same group, or set to zero if not. As the task is easy to perform, we could expand the size of labeled training

data by crowdsourcing. The training objective is to minimize the cross-entropy loss between the association matrix from the model and the ground truth matrix (Fig 4-f).

### 5.5 Implementation Details

The model was implemented in PyTorch [28]. All the trainable parameters are randomly initialized and updated via the Adam optimizer [17], with a learning rate of 0.0001. The training process enables a 0.3 dropout rate to avoid over-fitting. The maximum length of the input design sequence is 128 elements. The batch size is set to 16. The model was trained on an Nvidia Tesla-V100 (16GB) GPU.

## 6 GROUPING VISUAL ELEMENTS

This section introduces a bottom-up approach to recover the hierarchical grouping from layouts of visual elements. We first define a graph model of the layout based on the connections of adjacent elements (**R2**) and then propose a graph-based algorithm to group the visual elements hierarchically (**R3**).

### 6.1 Graph Modeling

According to the expert interviews, designers generally follow the principle of proximity to organize the layout and place related elements adjacently. Therefore, we only consider grouping elements in the neighborhood in our implementation. Thus, we can explicitly form a graph model to represent the layout using the spatial features of the visual elements (Illustrated in Fig 5). Formally, we define the graph model  $G$  of the information presentation, where nodes are visual elements  $[x_1, x_2, \dots, x_n]$  and edges are connections between the neighborhood elements, where we denote the edge that connects elements  $x_i$  and  $x_j$  as  $(x_i, x_j)$ . The edge includes a weight of proximity that can be computed by the spatial distance between two elements (denoted as  $d(x_i, x_j)$ ) [24].

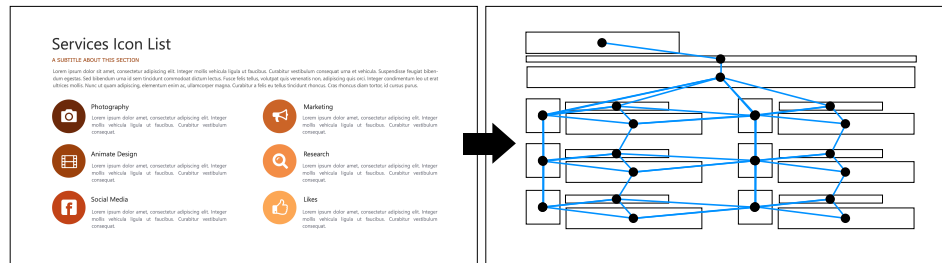

Fig. 5. This is the illustration of the graph modeling for an information presentation, where nodes are visual elements (denoted as black circles), and edges are connections between two adjacent elements (denoted as blue lines).

### 6.2 Hierarchical Grouping Algorithm

Next, we use the bottom-up approach to group visual elements hierarchically. Our hierarchical grouping algorithm is inspired by the previous graph-based algorithm for image segmentation [9, 11]. Their objective is to group pixels or regions that have a similar visual appearance. Instead, our objective is to group visual elements relatedly and spatially. The basic idea of the algorithm is merging small groups into a larger one iteratively by considering relatedness and spatial distances between visual elements in different groups. The algorithm works as follows (Algorithm 1):

The input of the algorithm is the graph model with visual elements  $[x_1, x_2, \dots, x_n]$  as nodes and all connections as edges  $[(x_1, x_2), \dots, (x_i, x_j), \dots]$ . The output is a series of hierarchies  $\mathcal{H} = [H_1, H_2, \dots, H_l]$  from bottom to up, where  $H_i$  contains the groups at the  $i$ th level of hierarchy. We start with the initial grouping  $H_0$ , where each visual element is assigned to an individual group (line 1). Next, we sort edges by non-decreasing spatial distance

**Algorithm 1:** Hierarchical Grouping Algorithm

---

**Input** : graph model  $G$ , association matrix  $R$   
**Output**: hierarchies of grouping  $\mathcal{H} = [H_0, H_1, \dots]$

```

1  $H_0 \leftarrow [x_1, x_2, \dots, x_n] \in G; \mathcal{H} \leftarrow [H_0];$ 
2  $edges \leftarrow \text{sortByWeight}(edges \in G);$ 
3  $\tau \leftarrow \tau_{initial}; T \leftarrow T_{initial};$ 
4 while  $|H_q| > 1$  do
5    $q \leftarrow q + 1; H_q \leftarrow H_{q-1};$ 
6   for  $(x_i, x_j) \in edges$  do
7     if  $x_i$  and  $x_j$  in two different groups  $\mathcal{G}_a$  and  $\mathcal{G}_b$  then
8        $C_1 \leftarrow R(x_i, x_j) \geq T$ 
9        $C_2 \leftarrow d(x_i, x_j) \leq \text{MID}(\mathcal{G}_a, \mathcal{G}_b, \tau);$ 
10      if  $C_1 \wedge C_2$  then
11         $H_q \leftarrow \text{merge}(\mathcal{G}_a, \mathcal{G}_b)$ 
12      end
13    end
14  end
15  if  $|H_q| < |H_{q-1}|$  then
16     $\mathcal{H} \leftarrow H_q;$ 
17  end
18   $T \leftarrow \alpha \times T; \tau \leftarrow \beta \times \tau;$ 
19 end
20 return  $\mathcal{H};$ 

```

---

(line 2) and initialize two parameters  $\tau$  and  $T$ .  $\tau$  is the threshold parameter that controls the degree to which the distance between two groups must be greater than their internal distances in order for there to be evidence of a boundary between them [9].  $T$  is the threshold parameter for the relatedness (line 3). These two parameters influence the granularity of the grouping. A larger  $\tau$  and a smaller  $T$  leading to a higher level of hierarchy with larger groups. After the initialization, the algorithm begins to merge small groups into a larger one iteratively until all the elements are in the one group (line 4-18). In each iteration, we enumerate all edges by order (line 6). If two elements in an edge (e.g.  $x_i$  and  $x_j$ ) are belong to two different groups (line 7), it will consider whether to merge these two groups based on two following conditions:

- **Relatedness (R1).** The first condition is whether the predicted relatedness  $R(x_i, x_j)$  between  $x_i$  and  $x_j$  is larger than the threshold  $T$  (line 9).  $R(x_i, x_j)$  can be accessed from the association matrix  $R$  from our model.
- **Spatial distance (R2).** The second condition is whether the spatial distance between  $x_i$  and  $x_j$  is smaller than the minimal internal distance of both groups (line 8). The minimal internal distance MID is defined as:

$$\text{MID}(\mathcal{G}_a, \mathcal{G}_b) = \min \left( \text{Int}(\mathcal{G}_a) + \frac{\tau}{\text{size}(\mathcal{G}_a)}, \text{Int}(\mathcal{G}_b) + \frac{\tau}{\text{size}(\mathcal{G}_b)} \right) \quad (6)$$

where  $\text{size}(\mathcal{G})$  computes the area size of the group, and  $\text{Int}(\mathcal{G})$  computes the largest distance in the minimum spanning tree MST of the group  $\mathcal{G}$ :

$$\text{Int}(\mathcal{G}) = \max_{(x_i, x_j) \in \text{MST}(\mathcal{G})} d(x_i, x_j) \quad (7)$$

If both conditions are true (*line 10*), the two groups will be merged into a larger one (*line 11*). After each iteration, if the count of groups decreases, it means the algorithm constructs a higher-level grouping  $H_q$  given the previous one  $H_{q-1}$  (*line 15 - 17*). We will update the constant parameters by decreasing  $T$  and increasing  $\tau$  before go into the next iteration (*line 18*). In our implementation, we set  $\alpha = 0.9$  and  $\beta = 1.1$ . Finally, the algorithm outputs all hierarchies  $\mathcal{H}$  (*line 19*) that allows selection of the desired grouping at any desired granularity (**R3**).

## 7 EVALUATION

In this section, we evaluate our technique, applied to hierarchical grouping of information presentations, through a technical experiment and a user study.

### 7.1 Technical Experiment

We first present quantitative assessments of the prediction model. In the experiment, we manually labeled 1,008 slides from our data collection. The labeled slides include 27,151 visual elements, which composite 519,415 element pairs in total. We divide the labeled data as 80/20 for training and testing.

We use *accuracy* as the evaluation metric. Given a pair of visual elements in an information presentation, the *accuracy* measures whether the result of pairwise prediction matches the human-labeled ground truth. Formally, we define the *accuracy* =  $M/N$ , where  $M$  is the number of the output relatedness predictions that are consistent with the ground truth, and  $N$  is the total number of testing pairs.

We compared the performances of the following three machine learning models on the testing dataset. Note that we did not involve other layout-based machine learning models here, because most of the works focus on layout generation [2, 21], which is not applicable in the grouping task.

- *Neural Network Baseline*. We implemented a three-layer neural network as the baseline, which uses the same input feature embedding vectors of the visual elements and outputs the results of pairwise classification.
- *Our Transformer Model without Spatial-aware Attention*. We implemented a basic version of our model without the spatial-aware attention mechanism. It shows the power of the original Transformer architecture.
- *Our Transformer Model with Spatial-aware Attention*. We implemented the final version of our model by adding the spatial-aware attention mechanism, which can leverage the relative position information.

We summarize the performances of these three models in Table 1. The neural network baseline approach achieves 77.49% accuracy, while our approaches outperform it significantly by 8.23% and 8.83%, respectively. The result is expected, because our models leverage the Transformer architecture to capture the contextual information from the whole layout structure. Next, let us look at the performance difference between our model with and without spatial-aware attention mechanism. The accuracy of our final model (86.32%) is slightly higher than the one without spatial-aware attention (85.72%), which indicates that using relative position information can improve the relatedness prediction in the 2D layout to some extent. The experiment shows the ability of our prediction model to capture the relatedness between visual elements in information presentations.

Model	Accuracy
Neural Network Baseline	77.49%
Ours w/o Spatial-aware Attention	85.72%
Ours with Spatial-aware Attention	86.32%

Table 1. Accuracy of the models for predicting relatedness between visual elements

### 7.2 User Study

We conduct a user study to test whether the outputs of our automatic grouping approach are comparable to the results grouped by human designers. The experiment for evaluating the quality of the hierarchical grouping



consists of two major phases: a design process with ten designers to hierarchically group visual elements in information presentations for the study data, followed by a comparative study with another 20 designers to compare the grouping results from the designers and our technique.

**Study Data.** To prepare the study data, we first randomly collected 50 slides from our dataset. We invited ten designers from our preliminary interview to manually group visual elements hierarchically in the slides. Before they started, we briefly introduced the grouping task and the basic usage of PowerPoint. During the task, each designer was given a PowerPoint file with ten different slides. They were asked to hierarchically group the elements in each slide. We record the completion time for each designer. Finally, each designer completed ten hierarchical grouping results, which gave us a total number of 100 labeled slides (one slide had two labeled versions from two random designers, respectively). An interesting finding is that designers may have different grouping solutions for the same information presentation. On the other hand, we used our technique to recover hierarchical grouping from these slides automatically. To compare the automatic results with the manually labeled results, we constructed 100 comparison pairs. Each pair includes one result from a designer and one result from our technique for the same slide. We ensure the generated grouping result has the same number of hierarchies for a fair comparison by deleting excess hierarchies.

**Participants.** We recruited 20 participants (14 females, aged from 22 to 31) from a design school. All the participants are familiar with design software such as Adobe Illustrator and Microsoft PowerPoint. They all confirmed having experience in making information presentations using Microsoft PowerPoint.

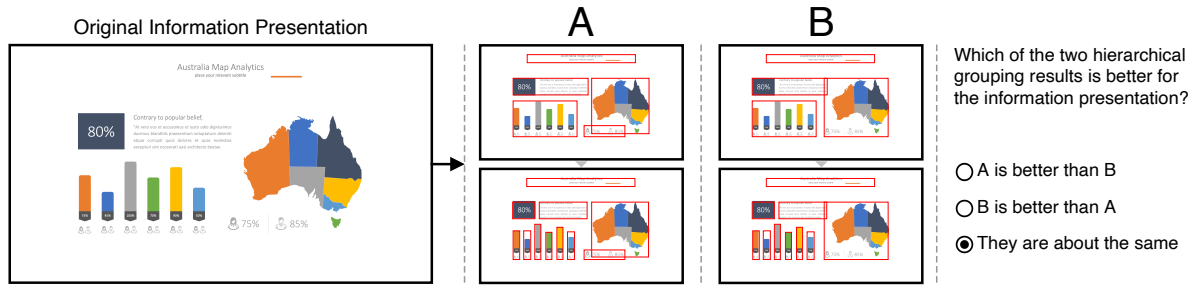

Fig. 6. A snapshot of a side-by-side comparison pair used in the evaluation. (A) is manually grouped by a designer, and (B) is automatically recovered from our technique.

**Task and Procedure.** The experiment began with a brief introduction. Each participant was asked to complete 25 comparison tasks. In each comparison task, the participants were given two hierarchical grouping results and were asked to provide an answer from three choices (“A is better than B”, “B is better than A”, or “A and B are about same”). This setting is fairer and easier for participants to evaluate the relative quality of two grouping results than scoring a single result. The order of the grouping results for comparison was randomized. Fig 6 shows a snapshot of a side-by-side comparison used in one comparison task, where A is manually grouped by a designer and B is automatically recovered from our technique. As a result, we collected  $25 \text{ comparisons} \times 20 \text{ participants} = 500 \text{ responses}$ . It takes about 30 minutes on average (range from 25 to 40) for each participant to complete all tasks. After they completed the tasks, we asked them to leave comments for the result of their preferences.

**Quantitative Results** We analyzed the comparison results to investigate the preferences in terms of grouping quality. In general, the preferences for both sides are balanced, as shown in Fig. 7-a. Specifically, 39% of the responses (195/500) think the grouping results from our technique are better, and 42.4% of the responses (212/500) indicated a preference for the results grouped by designers. The rest of the responses (18.6%, 93/500) thought

both results are about the same. Then, we further investigated the preferences of each participant. The mean of preferences per participant and 95% confident intervals indicate that the preference for the designer's grouping results is only slightly higher than our technique's (Fig. 7-b). According to the statistical test ( $t(19) = 0.45, p = 0.66$ ), there was no significant difference between the preferences for both two sides. On the other hand, our technique can save the extra time of manual grouping, which takes about thirty minutes ( $M = 30.1, SD = 6.69$ ) for designers to group elements in a ten-page slide in our user study. As a result, our technique can significantly improve efficiency and produce hierarchical grouping results comparable to human work.

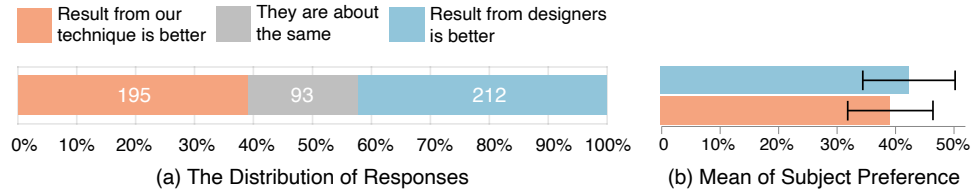

Fig. 7. Comparison results: (a) The chart presents the distribution of responses in the comparison experiment; (b) The chart shows mean preference per participant and 95% confidence intervals.

**Qualitative Results** During the study, participants were not informed that one in each testing pair is generated by an algorithm. After the study, we asked their opinions about the two results. All participants commented that they did not notice the grouping is completed by machine. Participants thought most of the grouping results are about the same, but they might select one of them according to their personal preferences. For example, **P4** commented: “Generally, there are no big differences between the two sides. However, when I look at a graphic design, I will think about how to refine the layout. Therefore I would love to choose the proper grouping that may make my design process more convenient.” **P12** said: “Most differences are very slight for me to give a choice. I think it is reasonable because designers may have different opinions when grouping the elements”. After we told them that one side was from an automatic approach, we asked them to comment about the effectiveness and usefulness of the technique. Eighteen participants appreciated the technique that might significantly improve the design efficiency. Furthermore, some of them give some suggestions for future works. For example, **P9** commented that it would be more convenient if each group could be automatically given a proper group name. **P7** said: “I hope the technique can give personalized suggestions by learning from my grouping behaviors. For example, I can demonstrate operations in one design file. Then I want all my downloaded public design resources to be processed as I demonstrated.” Although most participants gave positive feedback, two participants worried that the automatic grouping of elements might limit the creativity of the design to some extent. One of them (**P10**) said that the grouping structure may affect the designer's strategy to the downstream tasks of layout design.

### 7.3 Sample Grouping Results

The gallery in Fig 8 demonstrates eight hierarchical grouping results recovered by the automatic approach. (a) and (b) have three hierarchies, and other (c)-(h) have two hierarchies. We can see that our automatic approach has the ability to group visual elements properly at each level of granularity.

## 8 DISCUSSION

### 8.1 Failure Cases and Limitations

We observe some failure cases during the evaluation. We summarize two main causes of the failure. One typical failure is that the current approach cannot understand the semantic meaning of a user-defined shape. For example, Fig 9-a shows a user-defined shape in the left that is composed of multiple *freeform shapes*. Our technique favors

grouping them all into a single group at each hierarchical level. However, the designers in our user studies prefer to split it into two parts as a “computer” and a “phone” at the lowest level of grouping hierarchy. Although it is easy



Fig. 8. Eight examples of hierarchical groupings recovered by our technique.

for human beings, our current technique cannot understand the semantic meaning of these shape compositions. Another primary cause of failure is that some complex connectors may affect the grouping accuracy. Simple connectors are lines or arrows to connect visual elements and express their relations. However, the complex one might be composed of multiple elements. For the example in Fig 9-b, the connectors among three head portraits is a composition of a dashed line (*line*), a circle (*preset shape*), and an icon (*freeform shape*). Designers can recognize these connectors and group the head portraits with the corresponding text below. However, our current technique groups all the above visual elements as a whole by mistake. We believe that feeding more training data can mitigate this problem if the model can see more examples grouped by designers.

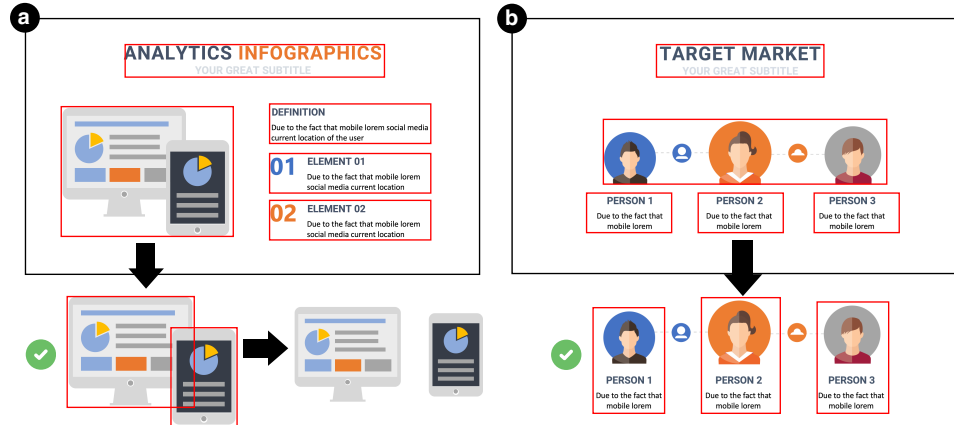

Fig. 9. Failure cases: (a) our technique failed to segment two semantic groups of *freeform shapes*; (b) it was affected by connectors.

In addition, our technique also has some limitations in terms of our research scope. The first limitation is that our current approach does not involve the content of each visual element, including text, picture, and shape. Understanding the semantic meaning of the content may assist in understanding the layout structure, which is a promising future work. In addition, we could involve more semantic features, such as role labels (e.g., title, subtitle, body). The second limitation is related to user preferences. As we found in the user study, there are multiple ways to group visual elements. Even two professional designers may have different strategies to do the element grouping task. Our technique can provide the grouping results at different granularities but fails to adjust the strategy according to the user preference. As a participant in the user study mentioned, a potential future work might be learning from the user's design behaviors. Third, this paper does not attempt to build a complete perceptual model of visual grouping. Instead, we propose a learning-based method for hierarchical grouping as a design aid within the domain of information presentations. To understand how designers group the visual elements, more theoretical research, such as the dimensions of visual perception, should be studied further.

## 8.2 Usage Scenarios

**Usage of the Dataset.** We see our dataset of information presentations as a useful starting point for exploring layout structures in graphic design. Besides our grouping research, this dataset is also helpful for researchers in other tasks. For instance, it can help researchers understanding the design demographics of information presentations as the collected information presentations are created by various designers. In addition, it can enable a series of research for design-based machine learning, such as layout classification, layout recommendation, and layout generation. On the other hand, this dataset can also serve as a rich design resource to inspire designers when designing layouts.

**Automatic Grouping for Public Design Resources.** The technique of automatic hierarchical grouping can be applied to the design resources in the wild. Although professional graphic design tools (e.g., PowerPoint,

Adobe Illustrator) provide the grouping function for users to organize the grouping structure, the given grouping information in the existing information presentations can be very noisy as designers might only care about the final presentation during the design process. Some unintentional actions or mistakes may also affect the incorrectness of the grouping results. Our technique can fix this problem by producing hierarchical groupings for a large batch of information presentations in a short time.

## 9 CONCLUSION

In this paper, we present an automatic approach for reverse-engineering information presentations. We first collected a large-scale dataset with 23,072 well-designed slides as our research resource. Based on the dataset, we propose the technique to recover hierarchical grouping from layouts of visual elements. Our technique incorporates the advanced deep learning model to understand the relatedness between visual elements. It also includes a bottom-up graph-based algorithm to produce the hierarchical grouping by considering the relatedness and spatial distances. A technical experiment and a user study evaluate the power of the technique, which shows the comparable ability with human designers. We believe that future applications can benefit from our contributed dataset and technique.

## REFERENCES

- [1] Pablo Arbeláez, Jordi Pont-Tuset, Jonathan T Barron, Ferran Marques, and Jitendra Malik. 2014. Multiscale combinatorial grouping. In *Proceedings of the IEEE Conference on Computer Vision and Pattern Recognition*. 328–335.
- [2] Diego Martin Arroyo, Janis Postels, and Federico Tombari. 2021. Variational Transformer Networks for Layout Generation. In *Proceedings of the IEEE Conference on Computer Vision and Pattern Recognition*. 13642–13652.
- [3] Zoya Bylinskii, Nam Wook Kim, Peter O'Donovan, Sami Alsheikh, Spandan Madan, Hanspeter Pfister, Fredo Durand, Bryan Russell, and Aaron Hertzmann. 2017. Learning visual importance for graphic designs and data visualizations. In *Proceedings of the 30th Annual ACM Symposium on User Interface Software and Technology*. 57–69.
- [4] Xi Chen, Wei Zeng, Yanna Lin, Hayder Mahdi Ai-Maneaa, Jonathan Roberts, and Remco Chang. 2020. Composition and configuration patterns in multiple-view visualizations. *IEEE Transactions on Visualization and Computer Graphics* 27, 2 (2020), 1514–1524.
- [5] Yu Chen, Wei-Ying Ma, and Hong-Jiang Zhang. 2003. Detecting web page structure for adaptive viewing on small form factor devices. In *Proceedings of the 12th International Conference on World Wide Web*. 225–233.
- [6] Niraj Ramesh Dayama, Kashyap Todi, Taru Saarelainen, and Antti Oulasvirta. 2020. Grids: Interactive layout design with integer programming. In *Proceedings of the SIGCHI Conference on Human Factors in Computing Systems*. 1–13.
- [7] Biplab Deka, Zifeng Huang, Chad Franzen, Joshua Hibschan, Daniel Afegan, Yang Li, Jeffrey Nichols, and Ranjitha Kumar. 2017. Rico: A mobile app dataset for building data-driven design applications. In *Proceedings of the 30th Annual ACM Symposium on User Interface Software and Technology*. 845–854.
- [8] Agne Desolneux, Lionel Moisan, and Jean-Michel Morel. 2004. Gestalt theory and computer vision. In *Seeing, Thinking and Knowing*. Springer, 71–101.
- [9] Pedro F Felzenszwalb and Daniel P Huttenlocher. 2004. Efficient graph-based image segmentation. *International Journal of Computer Vision* 59, 2 (2004), 167–181.
- [10] Raghudeep Gadde, Varun Jampani, Martin Kiefel, Daniel Kappler, and Peter V Gehler. 2016. Superpixel convolutional networks using bilateral inceptions. In *Proceedings of the European Conference on Computer Vision*. Springer, 597–613.
- [11] Matthias Grundmann, Vivek Kwatra, Mei Han, and Irfan Essa. 2010. Efficient hierarchical graph-based video segmentation. In *Proceedings of the IEEE Conference on Computer Vision and Pattern Recognition*. IEEE, 2141–2148.
- [12] Shunan Guo, Zhuochen Jin, Fuling Sun, Jingwen Li, Zhaorui Li, Yang Shi, and Nan Cao. 2021. Vinci: An Intelligent Graphic Design System for Generating Advertising Posters. In *Proceedings of the SIGCHI Conference on Human Factors in Computing Systems*. 1–17.
- [13] Enamul Hoque and Maneesh Agrawala. 2019. Searching the visual style and structure of d3 visualizations. *IEEE Transactions on Visualization and Computer Graphics* 26, 1 (2019), 1236–1245.
- [14] Anthony J Hornof. 2001. Visual search and mouse-pointing in labeled versus unlabeled two-dimensional visual hierarchies. *ACM Transactions on Computer-Human Interaction* 8, 3 (2001), 171–197.
- [15] Varun Jampani, Deqing Sun, Ming-Yu Liu, Ming-Hsuan Yang, and Jan Kautz. 2018. Superpixel sampling networks. In *Proceedings of the European Conference on Computer Vision*. 352–368.
- [16] Bernard J Jansen. 1998. The graphical user interface. *ACM SIGCHI Bulletin* 30, 2 (1998), 22–26.

- [17] Diederik P. Kingma and Jimmy Lei Ba. 2015. Adam: A Method for Stochastic Optimization. In *International Conference on Learning Representations*.
- [18] Janin Koch and Antti Oulasvirta. 2016. Computational layout perception using gestalt laws. In *Proceedings of the CHI Conference Extended Abstracts on Human Factors in Computing Systems*. 1423–1429.
- [19] Jun Kong, Kang Zhang, and Xiaoqin Zeng. 2006. Spatial graph grammars for graphical user interfaces. *ACM Transactions on Computer-Human Interaction* 13, 2 (2006), 268–307.
- [20] Ranjitha Kumar, Arvind Satyanarayan, Cesar Torres, Maxine Lim, Salman Ahmad, Scott R Klemmer, and Jerry O Talton. 2013. Webzeitgeist: design mining the web. In *Proceedings of the SIGCHI Conference on Human Factors in Computing Systems*. 3083–3092.
- [21] Jianan Li, Jimei Yang, Aaron Hertzmann, Jianming Zhang, and Tingfa Xu. 2020. Layoutgan: Synthesizing graphic layouts with vector-wireframe adversarial networks. *IEEE Transactions on Pattern Analysis and Machine Intelligence* (2020).
- [22] Zhiheng Li, Wenxuan Bao, Jiayang Zheng, and Chenliang Xu. 2020. Deep Grouping Model for Unified Perceptual Parsing. In *Proceedings of the IEEE Conference on Computer Vision and Pattern Recognition*. 4053–4063.
- [23] Simon Lok and Steven Feiner. 2001. A survey of automated layout techniques for information presentations. *Proceedings of SmartGraphics 2001* (2001), 61–68.
- [24] Min Lu, Chufeng Wang, Joel Lanir, Nanxuan Zhao, Hanspeter Pfister, Daniel Cohen-Or, and Hui Huang. 2020. Exploring visual information flows in infographics. In *Proceedings of the SIGCHI Conference on Human Factors in Computing Systems*. 1–12.
- [25] Ellen Lupton. 2014. *Thinking with type: A critical guide for designers, writers, editors, & students*. Chronicle Books.
- [26] Peter O'Donovan, Aseem Agarwala, and Aaron Hertzmann. 2015. Designscape: Design with interactive layout suggestions. In *Proceedings of the SIGCHI Conference on Human Factors in Computing Systems*. 1221–1224.
- [27] Peter O'Donovan, Aseem Agarwala, and Aaron Hertzmann. 2014. Learning layouts for single-pagegraphic designs. *IEEE Transactions on Visualization and Computer Graphics* 20, 8 (2014), 1200–1213.
- [28] Adam Paszke, Sam Gross, Francisco Massa, Adam Lerer, James Bradbury, Gregory Chanan, Trevor Killeen, Zeming Lin, Natalia Gimelshein, Luca Antiga, et al. 2019. Pytorch: An imperative style, high-performance deep learning library. *Proceedings of the International Conference on Neural Information Processing Systems* (2019), 8026–8037.
- [29] Jorge Poco and Jeffrey Heer. 2017. Reverse-engineering visualizations: Recovering visual encodings from chart images. In *Computer Graphics Forum*, Vol. 36. Wiley Online Library, 353–363.
- [30] Jordi Pont-Tuset, Pablo Arbelaez, Jonathan T Barron, Ferran Marques, and Jitendra Malik. 2016. Multiscale combinatorial grouping for image segmentation and object proposal generation. *IEEE Transactions on Pattern Analysis and Machine Intelligence* 39, 1 (2016), 128–140.
- [31] Xiaofeng Ren and Jitendra Malik. 2003. Learning a classification model for segmentation. In *IEEE International Conference on Computer Vision*, Vol. 2. IEEE Computer Society, 10–10.
- [32] Ruth Rosenholtz, Nathaniel R Twarog, Nadja Schinkel-Bielefeld, and Martin Wattenberg. 2009. An intuitive model of perceptual grouping for HCI design. In *Proceedings of the SIGCHI Conference on Human Factors in Computing Systems*. 1331–1340.
- [33] Peter Shaw, Jakob Uszkoreit, and Ashish Vaswani. 2018. Self-Attention with Relative Position Representations. In *Proceedings of the 2018 Conference of the North American Chapter of the Association for Computational Linguistics*, Vol. 2. 464–468.
- [34] Kashyap Todi, Daryl Weir, and Antti Oulasvirta. 2016. Sketchplore: Sketch and explore with a layout optimiser. In *Proceedings of the ACM Conference on Designing Interactive Systems*. 543–555.
- [35] Ashish Vaswani, Noam Shazeer, Niki Parmar, Jakob Uszkoreit, Llion Jones, Aidan N Gomez, Łukasz Kaiser, and Illia Polosukhin. 2017. Attention is all you need. In *Advances in Neural Information Processing Systems*. 5998–6008.
- [36] Wenhui Wang, Nan Yang, Furu Wei, Baobao Chang, and Ming Zhou. 2017. Gated self-matching networks for reading comprehension and question answering. In *Proceedings of the 55th Annual Meeting of the Association for Computational Linguistics*. 189–198.
- [37] Yun Wang, Yi Gao, Ray Huang, Weiwei Cui, Haidong Zhang, and Dongmei Zhang. 2021. Animated Presentation of Static Infographics with InfoMotion. In *Computer Graphics Forum*, Vol. 40. Wiley Online Library, 507–518.
- [38] Martin Wattenberg and Danyel Fisher. 2004. A Model of Multi-Scale Perceptual Organization in Information Graphics. *Information Visualization* (2004).
- [39] Christopher D Wickens, Justin G Hollands, Simon Banbury, and Raja Parasuraman. 2015. *Engineering psychology and human performance*. Psychology Press.
- [40] Robin Williams. 2015. *The non-designer's design book: Design and typographic principles for the visual novice*. Pearson Education.
- [41] Patricia Wright. 1999. Proceedings of the AAAI Conference on Artificial Intelligence. *American Association for Artificial Intelligence Technical Report FS-99-04* (1999), 1–9.
- [42] Yuxi Xie, Danqing Huang, Jinpeng Wang, and Chin-Yew Lin. 2021. CANVASEMB: Learning Layout Representation with Large-scale Pre-training for Graphic Design. In *Proceedings of the 29th ACM International Conference on Multimedia*. Association for Computing Machinery.
- [43] Anbang Xu, Shih-Wen Huang, and Brian Bailey. 2014. Voyant: generating structured feedback on visual designs using a crowd of non-experts. In *Proceedings of the 17th ACM conference on Computer Supported Cooperative Work & Social Computing*. 1433–1444.



- [44] Chenliang Xu and Jason J Corso. 2016. Actor-action semantic segmentation with grouping process models. In *Proceedings of the IEEE Conference on Computer Vision and Pattern Recognition*. 3083–3092.
- [45] Pengfei Xu, Hongbo Fu, Takeo Igarashi, and Chiew-Lan Tai. 2014. Global beautification of layouts with interactive ambiguity resolution. In *Proceedings of the 27th Annual ACM Symposium on User Interface Software and Technology*. 243–252.
- [46] Yang Xu, Yiheng Xu, Tengchao Lv, Lei Cui, Furu Wei, Guoxin Wang, Yijuan Lu, Dinei Florencio, Cha Zhang, Wanxiang Che, Min Zhang, and Lidong Zhou. 2021. LayoutLMv2: Multi-modal Pre-training for Visually-Rich Document Understanding. In *Proceedings of the 59th Annual Meeting of the Association for Computational Linguistics (ACL) 2021*.
- [47] Zhen Xu and James Miller. 2016. Identifying semantic blocks in Web pages using Gestalt laws of grouping. *World Wide Web* 19, 5 (2016), 957–978.
- [48] Xinru Zheng, Xiaotian Qiao, Ying Cao, and Rynson WH Lau. 2019. Content-aware generative modeling of graphic design layouts. *ACM Transactions on Graphics* 38, 4 (2019), 1–15.