

Visual Goal-Step Inference using wikiHow

Yue Yang¹

Artemis Panagopoulou¹

Qing Lyu¹

Li Zhang¹

Mark Yatskar¹

Chris Callison-Burch¹

University of Pennsylvania¹

{yueyang1, artemisp, lyuqing, zharry,
myatskar, ccb@seas.upenn.edu}

Abstract

Procedural events can often be thought of as a high level goal composed of a sequence of steps. Inferring the sub-sequence of steps of a goal can help artificial intelligence systems reason about human activities. Past work in NLP has examined the task of goal-step inference for text. We introduce the visual analogue. We propose the Visual Goal-Step Inference (VGSI) task where a model is given a textual goal and must choose a plausible step towards that goal from among four candidate images. Our task is challenging for state-of-the-art multimodal models. We introduce a novel dataset harvested from wikiHow that consists of 772,294 images representing human actions. We show that the knowledge learned from our data can effectively transfer to other datasets like HowTo100M, increasing the multiple-choice accuracy by 15% to 20%. Our task will facilitate multi-modal reasoning about procedural events.

1 Introduction

Recently, there has been increasing attention on the representation of complex events, with renewed interest in script learning and commonsense reasoning (Park and Motahari Nezhad, 2018; Mujtaba and Mahapatra, 2019; Li et al., 2020). One aspect of event representation is the relationship between high-level goals and the steps involved (Zhang et al., 2020b,a). Given a goal (such as “change a tire”), an intelligent system should be able to infer some of its steps (such as “raise the jack”). In all previous work, these events are represented as texts.

Learning such goal-step relations in a multi-modal fashion is an interesting challenge, since it requires reasoning that goes beyond simple image captioning. We contend that multimodal event representation learning will have interesting implications for downstream tasks such as schema

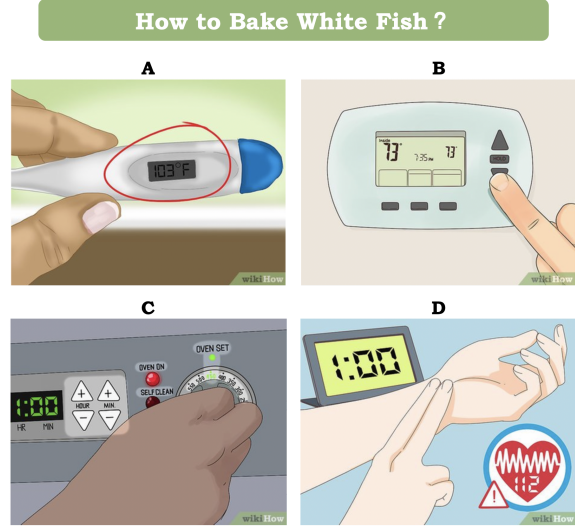

Figure 1: An example Visual Goal-Step Inference Task: given a text goal (*bake white fish*), select the image (C) that represents a step towards that goal.

learning¹ or dialog systems.²

We propose a new task called Visual Goal-Step Inference (VGSI). A model is given a textual goal and multiple images representing events, and needs to choose one image whose event is a reasonable step of the given goal. For example, in Figure 1, a model must recognize not only that the correct image represents “turning the oven”, but also that this action constitutes a step towards “baking fish.”

We collect data from wikiHow³ articles, where most steps are illustrated with images. We construct the VGSI training set using three sampling strategies, and evaluate the model performance via multiple-choice and image retrieval formats. We compare four state-of-the-art multimodal models, DeVISE (Frome et al., 2013), Similarity Network (Wang et al., 2018), Triplet Network (Hoffer and Ailon, 2015) and LEXMERT (Tan and Bansal, 2019) with human performance and observe SOTA

¹KAIROS

²Alexa Prize Taskbot Challenge

³wikihow.com

designed for caption-based multimodal tasks struggle on VGSI with a gap of 29 % in accuracy with a challenging sampling strategy.

One limitation of wikiHow is that most of its images are drawings rather than photos (which are more typically used in computer vision research). The knowledge learned from wikiHow is nevertheless useful. We demonstrate this by pre-training a triplet-network on our wikiHow VGSI task and then conducting transfer learning on out-of-domain datasets. Our experiments show that pretrained models can effectively transfer the goal-step knowledge to task-oriented video datasets, such as COIN (Tang et al., 2019) and Howto100m (Miech et al., 2019). In addition, we design an aggregation model on top of SOTA models which treats wikiHow as a knowledge base and takes advantage of the hierarchical structure of wikiHow articles (see Figure 2), further increasing the transfer learning performance.

We make three key contributions: (1) We propose the VGSI task, which is more challenging than traditional caption-based image-text matching tasks and requires the model to have the intermediate reasoning process about goal-step relations. (2) Through transfer-learning, we show that the knowledge learned from our dataset can be readily applied to out-of-domain datasets, with an accuracy improvement of 15% to 20% in the multiple-choice task. (3) We designed a step-aggregation model which proves a promising way to improve the performance of current baselines on VGSI by 1.6 - 5.1 % in accuracy.

2 wikiHow as Multimodal Resource

We exploit WikiHow as the data source for VGSI because it has been successfully adopted in prior work for procedural learning (Zhou et al., 2019) and intent detection (Zhang et al., 2020a) in language domain. Each WikiHow article contains a high-level *goal* and one or more different *methods* to achieve it. Each method then includes a series of specific *steps*, typically accompanied with an image each⁴.

The format of wikihow articles provides a hierarchical multi-modal relationship between images and sentences. Shown in Figure 2, we could obtain three types of image-text pairs from wikiHow: goal-image, method-image and step-image, and their relationships are from far to close. The sys-

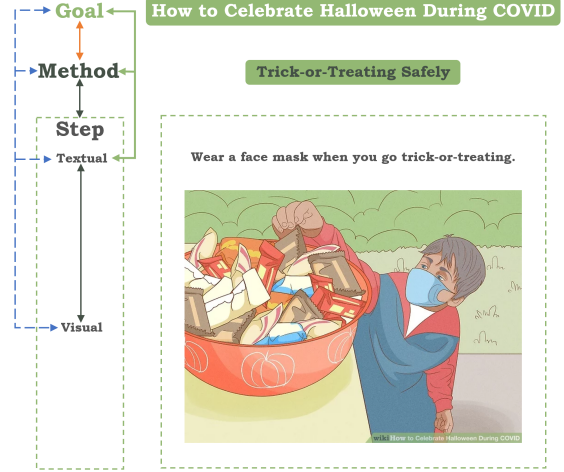

Figure 2: Hierarchical Cross-modality of wikiHow

tem needs to have the background knowledge that “Trick-or-Treat” and “candies” are the traditions of Halloween to make correct prediction. The model also has to sense that “mask” is required during “COVID-19”.

In total, the corpus consists of 53189 WikiHow articles, 155,265 methods, and 772,294 steps with corresponding images.

3 Methods

3.1 Problem Formulation

Given a high-level goal G which is a sequence of words and an image $I \in \mathbb{R}^{3 \times h \times w}$, the model outputs the matching score:

$$match(G, I) = F(X_G, X_I) \quad (1)$$

in which, $X_G \in \mathbb{R}^{d_G}$ and $X_I \in \mathbb{R}^{d_I}$ are the feature representations of goal and image. F is the scoring function to model the interactions between these two modalities.

3.2 Models

DeViSE intakes the pretrained embedding vectors from two modalities and map the source vector into the span of target vector. DeViSE is trained on the positive pairs (G, I) only and projects image embedding into the same dimension as goal with L2 normalization. Then compute the cosine similarity of two normalized vectors as the matching score.

Similarity Network Each branch of the similarity network maps one modality to the joint span and executes pointwise multiplication to construct a joint vector. The last layer is fully-connected with softmax activation and outputs an array of size two to denote the weights for each class as binary

⁴How to Prevent Coronavirus

classification. We compute the matching score by dot product $[1, -1]$ with the output.

Triplet Network requires the input to be the format of triplet (G, I_{pos}, I_{neg}) . Three branches in the network map the three embeddings to the same joint span, the branches of positive and negative images share the same weight. The network learns the cross-modality by minimizing the positive pair distance and maximizing the negative pair distance. We choose cosine distance as the metric which is also used as the matching score.

LXMERT is a multimodal encoder aims to ground text to images through attention layers. The image input is represented as a sequence of objects and sentence input is a sequence of words. LXMERT utilizes two single-modality transformer encoders (language and object relationship encoder) and a cross-modality transformer encoder to achieve the attention mechanism. Same as similarity network, LXMERT is trained as binary classifier.

4 Experimental Setup

4.1 Multiple-Choice Sampling

We formulate the task as 4-way multiple choice question, which is easy to evaluate the image-text mapping performance and is feasible for human annotation. Specifically, a model is given a textual goal and four image candidates, and predicts the most reasonable step towards the goal. We utilize three sampling strategies to obtain negative candidates.

Random Strategy We randomly pick three different articles and select one image by chance from each article as the negative samples.

Similarity Strategy We greedily select the most similar images based on the feature vectors and use FAISS (Johnson et al., 2017) to retrieve the top-3 most similar images.

Category Strategy The three negative samples are randomly selected from articles within the same wikiHow-category as the prompt goal.

In addition to the multiple-choice format, we also evaluate VGSI in a more practical goal-image retrieval format (see Appendix B).

4.2 Human Annotation

Considering VGSI is a novel task, we also evaluate how difficult it is for humans. All of our six human annotators are graduate students with sufficient English proficiency. For each annotation test, we select 100 samples from the testing set.

Model	Sampling Strategy		
	Random	Similarity	Category
Random	0.2500	0.2500	0.2500
DeViSE	0.6719	0.3364	0.4558
Similarity Net	0.6895	0.6226	0.4983
Triplet Net (GloVe)	0.7251	0.7450	0.5307
Triplet Net (BERT)	0.7280	0.7494	0.5360
LXMERT	0.7175	0.4259	0.2886
Human	0.8450	0.8214	0.7550

Table 1: Accuracy of SOTA models on the wikiHow VGSI test set.

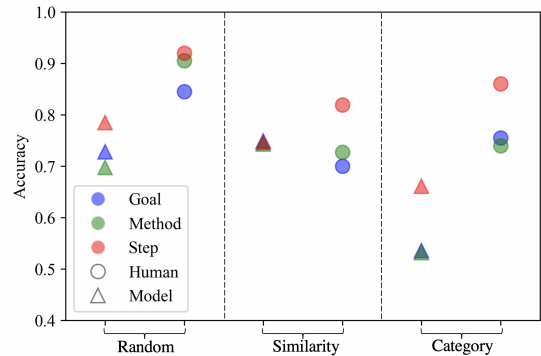

Figure 3: Accuracy on the modified wikiHow VGSI test set with different textual input (the *goal* replaced by *method* or *step headline*)

Then we ask two annotators to complete the test and report their average performance.

4.3 Evaluation Metrics

We report the accuracy of both model and human for the multiple choice task. For retrieval task, we adopt recall at K (recall@K) and median rank (Med r) to measure the performance (see Appendix B).

5 Results

5.1 In-Domain Results

Table 1 shows the models and human performance on wikiHow dataset. The Triplet Network with BERT embedding has the best performance. However, there is still a big gap between human and machine performance which indicates VGSI is a challenging task for SOTA models. LXMERT performs badly for similarity and category strategies because LXMERT is heavily dependent on grounding objects, while negative samples generated by these two strategies could share similar objects but refer to completely different goals. Figure 3 demonstrates that both human and model have better performance when using a more detailed text as the prompt.

5.2 Transfer Learning

To get robust results to show wikiHow is superior than current caption-based image datasets in VGSI task, we choose Flickr30K (Plummer et al., 2015) and MSCOCO (Vinyals et al., 2016) both are caption-based datasets for comparison. We use the official train/val split and pretrain two models separately on Flickr and COCO using the same set-up as wikiHow.

5.2.1 Target Dataset & Key frame Extraction

We select two large-scale datasets of instructional videos, COIN and Howto100m. The videos in these two dataset are retrieved by high-level goal and the frames in the videos could be considered as the step, thus they have the same goal-step structure as our VGSI task and therefore become suitable candidate for transfer learning. We select: (1) Howto100m: one video for each high-level goal, 1,000 videos in total; (2) COIN: 5 videos for each goal, 900 videos in all.

Considering these two dataset are video-based, while our task is image-based, we applied a key frame extraction heuristic to get critical frames from each video. We use Katna⁵ package to select the key frames. Then we use these frames to construct the multiple-choice sample in the same way as wikiHow. The samples from Howto100m are split into train/val/test set for fine-tuning. COIN samples are also used as pre-trained data to compare with wikiHow for transfer on Howto100m.

5.2.2 wiki-Step Aggregation Model

We’ve seen SOTA models do not perform well in VGSI because of the implicit vision-language relation. We come up with a step aggregation model which takes the advantage of the existed goal-step knowledge from wikiHow. The main idea is given a unseen textual goal, we use k -nearest neighbors to find the most related article title from wikiHow, then extract the n steps from this article as $S = \{s_1, s_2, \dots, s_n\}$. Instead of directly using the given goal to match the images (goal score - Score_g), we could use the sequence of steps to improve the matching (step score - Score_s). Then use a linear interpolation to summarize these two scores as our final matching score.

$$\begin{aligned} \text{Score}_g &= \text{match}(G, I) \\ \text{Score}_s &= \max_{i=1:n}(\text{match}(s_i, I)) \\ \text{Score}_{\text{final}} &= \lambda \cdot \text{Score}_g + (1 - \lambda) \cdot \text{Score}_s \end{aligned} \quad (2)$$

⁵Katna

PT Data	Sampling Strategy		
	Random	Similarity	Category
Flickr30K	0.4903	0.4159	0.3919
MSCOCO	0.5349	0.4745	0.4071
wikiHow	0.6245	0.6309	0.4586
wikiHow ^{Agg}	0.6538	0.6409	0.4821

Table 2: Zero-shot Performance on COIN (PT stands for pre-training, *Agg* represents aggregation model)

		Sampling Strategy		
PT-Data	FT?	Random	Similarity	Category
-	✓	0.6005	0.6096	0.4434
Flickr30K	✗	0.4837	0.5398	0.3856
	✓	0.6207	0.6408	0.4740
MSCOCO	✗	0.5099	0.5715	0.3958
	✓	0.6340	0.6640	0.4794
COIN	✗	0.5067	0.6585	0.3978
	✓	0.6170	0.7100	0.4638
wikiHow	✗	0.6556	0.6754	0.4750
	✓	0.6855	0.7249	0.5143
wikiHow ^{Agg}	✓	0.6947	0.7392	0.5245
Human	-	0.8300	0.7858	0.7550

Table 3: Transfer Performance on Howto100m (FT for fine-tuning)

in which, λ adjusts the weight of step and goal scores, here we choose $\lambda = 0.5$.

5.2.3 Zero & Few-shot Performance

Table 2, 3 both indicate pretraining on wikiHow could improve the performance in VGSI on out-of-domain datasets. Especially for Howto100M results, the model pretrained on wikiHow without fine-tuning even outperforms other caption-based dataset with fine-tuning. This is a strong evidence that our dataset can serve as a useful knowledge resource, where the learned multimodal representation can be directly applied to other datasets. In addition, our aggregation model further improves the accuracy by a significant margin.

6 Conclusion

In this paper, we propose a novel visual goal-step inference task (VGSI), a multimodal challenge for reasoning procedural events. We construct a dataset from wikiHow, and show that SOTA multimodal models struggle on it. Based on the transfer learning results on Howto100M and COIN, we validate that the knowledge learned from our dataset could transfer to other domains. Knowledge learned from our task has strong potential to be applied to NLP applications such as multimodal dialog systems.

References

- Peter Anderson, Xiaodong He, Chris Buehler, Damien Teney, Mark Johnson, Stephen Gould, and Lei Zhang. 2018. Bottom-up and top-down attention for image captioning and visual question answering. In *CVPR*.
- Jia Deng, Wei Dong, Richard Socher, Li-Jia Li, Kai Li, and Li Fei-Fei. 2009. Imagenet: A large-scale hierarchical image database. In *2009 IEEE conference on computer vision and pattern recognition*, pages 248–255. Ieee.
- Andrea Frome, Greg S Corrado, Jon Shlens, Samy Bengio, Jeff Dean, Marc’Aurelio Ranzato, and Tomas Mikolov. 2013. Devise: A deep visual-semantic embedding model. In *Advances in neural information processing systems*, pages 2121–2129.
- Dan Hendrycks and Kevin Gimpel. 2016. Gaussian error linear units (gelus). *arXiv preprint arXiv:1606.08415*.
- Elad Hoffer and Nir Ailon. 2015. Deep metric learning using triplet network. In *International Workshop on Similarity-Based Pattern Recognition*, pages 84–92. Springer.
- Jeff Johnson, Matthijs Douze, and Hervé Jégou. 2017. Billion-scale similarity search with gpus. *arXiv preprint arXiv:1702.08734*.
- Diederik P Kingma and Jimmy Ba. 2014. Adam: A method for stochastic optimization. *arXiv preprint arXiv:1412.6980*.
- Manling Li, Qi Zeng, Ying Lin, Kyunghyun Cho, Heng Ji, Jonathan May, Nathanael Chambers, and Clare Voss. 2020. [Connecting the dots: Event graph schema induction with path language modeling](#). In *Proceedings of the 2020 Conference on Empirical Methods in Natural Language Processing (EMNLP)*, pages 684–695, Online. Association for Computational Linguistics.
- Antoine Miech, Dimitri Zhukov, Jean-Baptiste Alayrac, Makarand Tapaswi, Ivan Laptev, and Josef Sivic. 2019. Howto100m: Learning a text-video embedding by watching hundred million narrated video clips. In *Proceedings of the IEEE international conference on computer vision*, pages 2630–2640.
- Dena Mujtaba and Nihar Mahapatra. 2019. Recent trends in natural language understanding for procedural knowledge. In *2019 International Conference on Computational Science and Computational Intelligence (CSCI)*, pages 420–424. IEEE.
- Hogun Park and Hamid Reza Motahari Nezhad. 2018. Learning procedures from text: Codifying how-to procedures in deep neural networks. In *Companion Proceedings of the The Web Conference 2018*, pages 351–358.
- Bryan A. Plummer, Liwei Wang, Chris M. Cervantes, Juan C. Caicedo, Julia Hockenmaier, and Svetlana Lazebnik. 2015. Flickr30k entities: Collecting region-to-phrase correspondences for richer image-to-sentence models. In *Proceedings of the IEEE International Conference on Computer Vision (ICCV)*.
- Nils Reimers and Iryna Gurevych. 2019. [Sentencebert: Sentence embeddings using siamese bert-networks](#). In *Proceedings of the 2019 Conference on Empirical Methods in Natural Language Processing*. Association for Computational Linguistics.
- Christian Szegedy, Vincent Vanhoucke, Sergey Ioffe, Jonathon Shlens, and Zbigniew Wojna. 2015. [Rethinking the inception architecture for computer vision](#). *CoRR*, abs/1512.00567.
- Hao Tan and Mohit Bansal. 2019. Lxmert: Learning cross-modality encoder representations from transformers. *arXiv preprint arXiv:1908.07490*.
- Yansong Tang, Dajun Ding, Yongming Rao, Yu Zheng, Danyang Zhang, Lili Zhao, Jiwen Lu, and Jie Zhou. 2019. Coin: A large-scale dataset for comprehensive instructional video analysis. In *Proceedings of the IEEE/CVF Conference on Computer Vision and Pattern Recognition (CVPR)*.
- Oriol Vinyals, Alexander Toshev, Samy Bengio, and Dumitru Erhan. 2016. Show and tell: Lessons learned from the 2015 mscoco image captioning challenge. *IEEE transactions on pattern analysis and machine intelligence*, 39(4):652–663.
- Liwei Wang, Yin Li, Jing Huang, and Svetlana Lazebnik. 2018. Learning two-branch neural networks for image-text matching tasks. *IEEE Transactions on Pattern Analysis and Machine Intelligence*, 41(2):394–407.
- Yonghui Wu, Mike Schuster, Zhifeng Chen, Quoc V Le, Mohammad Norouzi, Wolfgang Macherey, Maxim Krikun, Yuan Cao, Qin Gao, Klaus Macherey, et al. 2016. Google’s neural machine translation system: Bridging the gap between human and machine translation. *arXiv preprint arXiv:1609.08144*.
- Li Zhang, Qing Lyu, and Chris Callison-Burch. 2020a. [Intent detection with WikiHow](#). In *Proceedings of the 1st Conference of the Asia-Pacific Chapter of the Association for Computational Linguistics and the 10th International Joint Conference on Natural Language Processing*, pages 328–333, Suzhou, China. Association for Computational Linguistics.
- Li Zhang, Qing Lyu, and Chris Callison-Burch. 2020b. Reasoning about goals, steps, and temporal ordering with WikiHow. In *Proceedings of the 2020 Conference on Empirical Methods in Natural Language Processing (EMNLP)*, pages 4630–4639, Online. Association for Computational Linguistics.
- Yilun Zhou, Julie A Shah, and Steven Schockaert. 2019. Learning household task knowledge from wikihow descriptions. *arXiv preprint arXiv:1909.06414*.

A Model Implementation Details

A.1 Architecture and Loss Function

A.1.1 DeViSE

The deep-visual semantic embedding (DeViSE) model takes in the pretrained embedding vectors from two modalities and map the source vector into the span of target vector representation. The DeViSE model is trained on the related (positive) pairs (G, I) only, and we consider map image to goal $(I \rightarrow G)$. The model projects image embedding into the same dimension as goal and applies L2 normalization to obtain unit vectors:

$$\begin{aligned}\hat{X}_I &= L_2N(X_I W_{I \rightarrow G}) \\ \hat{X}_G &= L_2N(X_G)\end{aligned}\quad (3)$$

where, L_2N stands for L2 normalization and $W_{I \rightarrow G} \in \mathbb{R}^{d_I \times d_G}$ is the weight.

Then the DeViSE model uses a similarity function (here we select cosine distance) to compute the distance between \hat{X}_I and \hat{X}_G as the loss:

$$\begin{aligned}\mathcal{L}_{DeViSE} &= \cos(\hat{X}_I, \hat{X}_G) \\ match(G, I)_{DeViSE} &= 1 - \cos(\hat{X}_I, \hat{X}_G)\end{aligned}\quad (4)$$

in which \cos means the cosine distance. For DeViSE, the matching score is the cosine similarity of two unit vectors.

A.1.2 Similarity Network

Similarity network is one type of the two-branch networks for matching image and text. It is a supervised model which takes in (G_i, I_i, y_i) and $y_i \in \{0, 1\}$ is the binary label indicates whether G_i and I_i are related or not.

Each branch of the network maps one modality to the cross-modality span and executes pointwise multiplication to construct a joint vector:

$$\begin{aligned}\hat{X}_I &= L_2N(X_I W_{I \rightarrow J}) \\ \hat{X}_G &= L_2N(X_G W_{G \rightarrow J}) \\ X_J &= \hat{X}_I \odot \hat{X}_G\end{aligned}\quad (5)$$

in which, $W_{I \rightarrow J} \in \mathbb{R}^{d_I \times d_J}$ and $W_{G \rightarrow J} \in \mathbb{R}^{d_G \times d_J}$ are the weights and \odot represents for elementwise product.

The similarity network can be viewed as binary classifier and therefore we could use binary cross entropy as the loss function:

$$\mathcal{L}_{sim} = -\sum_i^N y_i \cdot \log p(y_i) + (1 - y_i) \cdot \log(1 - p(y_i)) \quad (6)$$

The last layer of similarity network is a fully-connected layer with softmax activation function and the output is an array of size two in which the elements denote the weight for each class. We compute the matching score by multiplying +1 (matched) and -1 (unmatched) on these two elements:

$$\begin{aligned}\alpha &= \text{softmax}(\text{fc}(X_J)) \\ match(G, I)_{sim} &= 1 \cdot \alpha[0] + (-1) \cdot \alpha[1]\end{aligned}\quad (7)$$

where fc stands for fully-connected layer.

A.1.3 Triplet Network

Triplet network requires the input to be the format of triplet (G, I_{pos}, I_{neg}) . There will be three branches in the network which map the three embeddings to the same joint span:

$$\begin{aligned}\hat{X}_G &= L_2N(X_G W_{G \rightarrow J}) \\ \hat{X}_{I_{pos}} &= L_2N(X_{I_{pos}} W_{I \rightarrow J}) \\ \hat{X}_{I_{neg}} &= L_2N(X_{I_{neg}} W_{I \rightarrow J})\end{aligned}\quad (8)$$

in which, $W_{G \rightarrow J} \in \mathbb{R}^{d_G \times d_J}$ and $W_{I \rightarrow J} \in \mathbb{R}^{d_I \times d_J}$ are weights and the branches of positive and negative images share the same weight.

The network learns the cross-modality by minimizing the distance between positive pairs and maximizing the distance between negative pairs. We choose cosine distance as the distance function which will also be used to compute the matching score:

$$\begin{aligned}\mathcal{L}_{trip} &= \max(0, \cos(\hat{X}_G, \hat{X}_{I_{pos}}) - \cos(\hat{X}_G, \hat{X}_{I_{neg}}) \\ &\quad + m) \\ match(G, I)_{trip} &= \cos(\hat{X}_G, \hat{X}_I)\end{aligned}\quad (9)$$

where m is the margin which is set to 0.2 in the experiment.

A.1.4 LXMERT

LXMERT (Tan and Bansal, 2019) is a multimodal encoder that aims to ground text to images. It takes as an input an image I and a related sentence $G = \{w_1, w_2, \dots, w_n\}$. The image objects are embedded using a feature extractor (Anderson et al., 2018) pretrained on ImageNet (Deng et al., 2009). Given I the detector finds m objects $\{o_1, o_2, \dots, o_m\}$ where: $o_i = \{p_i, f_i\}$, s.t. p_i is its bounding box and f_i is its 2048-dimensional region

of interest (RoI). LXMERT learns a position-aware embedding as follows:

$$f'_i = L_2N(W_F f_i + b_F) \quad (10)$$

$$p'_i = L_2N(W_P p_i + b_P) \quad (11)$$

$$v_i = (f'_i + p'_i)/2 \quad (12)$$

The text tokens are embedded through tokenizer (Wu et al., 2016) and converted to index-aware embeddings s.t. w_i and i are projected into embedding spaces w'_i, u'_i , to get a common embedding

$$h_i = L_2N(w'_i + u'_i) \quad (13)$$

Those inputs are then passed through a language encoder E_G , an object relationship encoder E_I , and a cross-modality transformer encoder E_J . Let $X_I = \{v_1, v_2, \dots, v_n\}$ and $X_G = \{h_1, h_2, \dots, h_n\}$.

$$\hat{X}_G = E_G(X_G) \quad (14)$$

$$\hat{X}_I = E_I(X_I) \quad (15)$$

$$X_{G_J}, X_{G_I} = E_J(\hat{X}_G, \hat{X}_I) \quad (16)$$

Then the cross modality output X_J is extracted from the output embedding X_{G_J} that corresponds to the special token [CLS] appended to each input text.

Similarly to A.1.2 we use BCE loss

$$\mathcal{L}_{lxmert} = -\sum_i^N y_i \cdot \log p(y_i) + (1 - y_i) \cdot \log(1 - p(y_i)) \quad (17)$$

and compute the matching score:

$$\begin{aligned} \alpha &= \text{softmax}(\text{fc}_2 \text{fc}_1(X_J)) \\ \text{match}(G, I)_{lxmert} &= 1 \cdot \alpha[0] + (-1) \cdot \alpha[1] \end{aligned} \quad (18)$$

A.2 Features

A.2.1 Vision

We select InceptionV3 (Szegedy et al., 2015) as the feature extractor for the image. We’ve tried VGG19 and Resnet50, but InceptionV3 turns out to have the best performance. We use the second last hidden layer of InceptionV3 to obtain a vector of (2048,).

A.2.2 Language

We use pre-trained BERT sentence transformer (Reimers and Gurevych, 2019) and For the sentence transformer, we select the "bert-base-uncased" as our base model and use the max-pooling to get the feature vector which has a dimension of (768,).

A.3 Hyper Parameters

See Table 4.

	Optimizer	Learning Rate	Batch Size	n. of Parameters
DeViSE	RMSPProp	5e-6	1024	2,897,664
Similarity Net	RMSPProp	5e-6	1024	4,424,170
Triplet Net	Adam	1e-5	1024	4,984,832
LXMERT	Adam	5e-7	36	209,124,098

Table 4: Hyper Parameters of All Models

A.3.1 Training Details

The training of DeViSE, Similarity Network and Triplet network is on single NVIDIA RTX 2080 for 200 epochs with early stopping. The training takes less than 10 hours.

LXMERT We use a pretrained LXMERT model with 9 language layers, 5 cross-encoder layers, 5 vision encoder layers, and a 2 layer linear classification head, with $\text{GELU}()$ (Hendrycks and Gimpel, 2016) and $\text{ReLU}()$ activation, with a Sigmoid final layer and perform normalization in the first layer.

We finetune the model for 10 epochs while allowing the gradient to flow through the LXMERT pre-trained layers. We use a binary cross entropy loss from the PyTorch library and an Adam (Kingma and Ba, 2014) optimizer. Note that we deal with imbalanced datasets by repeating the positive samples and shuffling the data.

Parameter	Value
Batch Size	32
Learning Rate	$5e - 7$
Epochs	10
Adam b_1	0.9
Adam b_1	0.999
Adam ϵ	$1e - 6$
Adam weight decay	0.01

Table 5: LXMERT Training Parameters

B Goal-Image Retrieval Task

B.1 Sampling

Goal-Image Retrieval is a more practical format which is given a high-level goal and a pool of images and aims to rank these images based on their similarity with the goal query.

In this experiment, we randomly select 1,000 high level goals from the testing set of multiple-choice task and choose 5 images for each goal and thus build a pool of 5,000 images.

Model	5K Testing Images				
	R@10	R@25	R@50	R@100	Med r
Random	0.1	0.4	1.0	2.1	2519
DeViSE	5.2	9.8	15.2	23.8	429
Similarity Net	5.8	11.5	17.6	27.0	347
Triplet Net (GloVe)	5.9	12.2	19.9	31.2	264
Triplet Net (BERT)	6.9	13.8	21.9	32.7	249

Table 6: In-Domain Retrieval results with Different Models

Prompt	Token Length	Vocab Size	1K Testing Images				
			R@1	R@5	R@10	R@25	Med r
Goal	3.34	19,299	4.6	14.6	22.8	36.3	49
Method	3.11	24,180	2.5	11.4	18.9	33.3	57
Step	4.67	49,999	6.1	20.1	31.4	48.7	26

Table 7: Query on Different Prompts

B.2 Evaluation Metrics

We adopt recall at K (recall@K, higher the better) and median rank (Med r, lower the better) to measure the retrieval performance. For 5k image pool, $K \in \{10, 25, 50, 100\}$, while for 1k image pool, $K \in \{5, 10, 25, 50\}$.

B.3 In-Domain Performance

Shown in Table 6, the triplet network with BERT as the text embedding has the best performance.

B.4 Query on Different Prompts

As can be seen from Table 7, the model has higher performance when using the detailed step description as prompt. Through qualitative analysis () on some samples, we discovered that some method descriptions are very general and short abstract keywords and even more refined than the goal description. To quantify this finding, we calculate the average length of tokens (remove stop words) and the vocabulary size of the three types of prompts. It is apparently that the step description is more fruitful than method and goal with higher to-ken length and vocab size. The method description has lower average length of tokens which in line with our observation.

C Transfer Learning

C.1 Key Frame Selection

To adapt video dataset to image-based as our transfer target, we apply key frame extraction operation on the Howto100m and COIN.

We select 1,000 videos from Howto100M with the similar category distribution as our wikiHow image dataset. Then use the Katna package to select 10 frames for each video. After obtaining the key frames, we did human filtering on these frames

PT-Data	1k Test Images				
	R@1	R@5	R@10	R@25	Med r
-	0.0	0.5	1.2	2.5	517
Flickr	1.2	4.0	7.1	14.2	240
MSCOCO	0.9	5.5	9.3	19.0	170
wikiHow	1.4	7.6	12.6	23.8	102
wikiHow ^{Agg}	1.9	7.8	13.6	25.9	97

Table 8: Zero-shot Retrieval on COIN

PT-Data	FT?	1K test images				
		R@1	R@5	R@10	R@25	Med r
-	✓	1.1	4.4	9.5	17.4	129
Flickr30K	✗	0.9	3.9	6.9	11.7	213
	✓	1.2	5.4	10.5	20.9	122
MSCOCO	✗	0.5	4.1	7.3	13.8	202
	✓	1.7	6.8	11.9	22.4	98
COIN	✗	1.1	4.2	7.7	15.3	193
	✓	1.6	6.1	11.7	21.6	118
wikiHow	✗	1.6	7.3	13.5	25.1	88
	✓	2.0	7.9	14.7	26.7	84
wikiHow ^{Agg}	✓	2.1	8.3	15.8	27.7	80

Table 9: Retrieval Performance on Howto100m

because the outputs still contain some frames such as transition frames or people facing to the camera and explaining the steps.

COIN dataset has human-annotated clips, thus we apply key frame selection within each clip and pick one frame for every clip.

C.2 Step-Aggregation Model

We propose an aggregation model for the VGSI task. The main idea of the model is to break down the high-level goal into intermediate steps via schema. Then use the induced sequence of steps as the new query to improve the matching performance. For example in Figure 4, when we want to match the goal “Install License Plate” with two images, the model makes a wrong choice because the negative sample (right one) also involves the “install” action. However, we could fetch the intermediate steps from wikiHow and use these steps to match the images. The left image (correct choice) has higher Step-Image similarity score than the right one. Therefore, the model could improve its performance with the help of these step information. As we can see from the example steps, they contain some useful entities such as “screw”, “bracket”, “bumper”, etc which are closely related to the visual information in the image but do not show up in the goal sentence.

C.3 Transfer Performance on Retrieval

We also evaluate the transfer performance on retrieval task. For COIN, we choose 5-6 images for

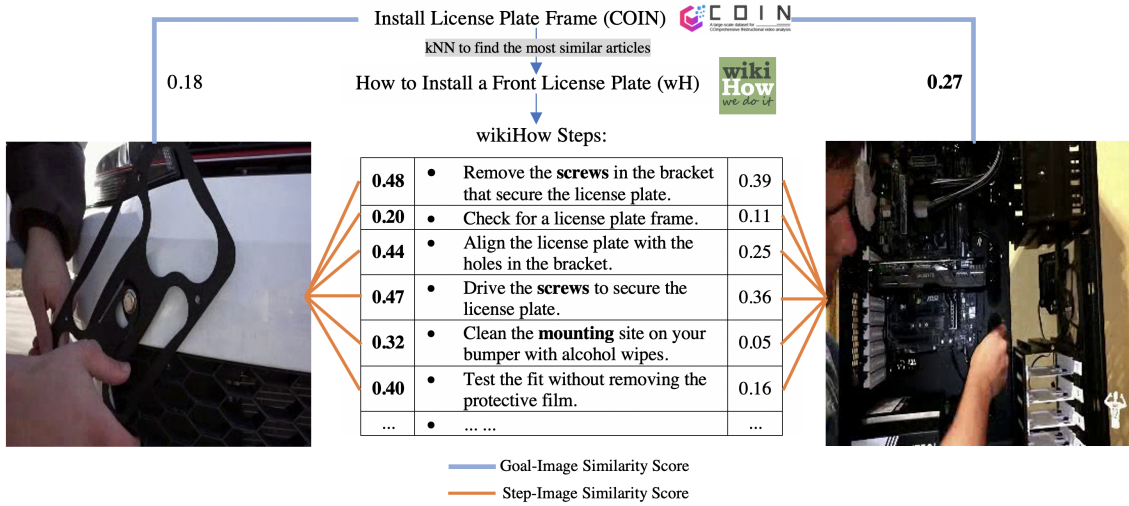

Figure 4: Architecture of Step-Aggregation Model

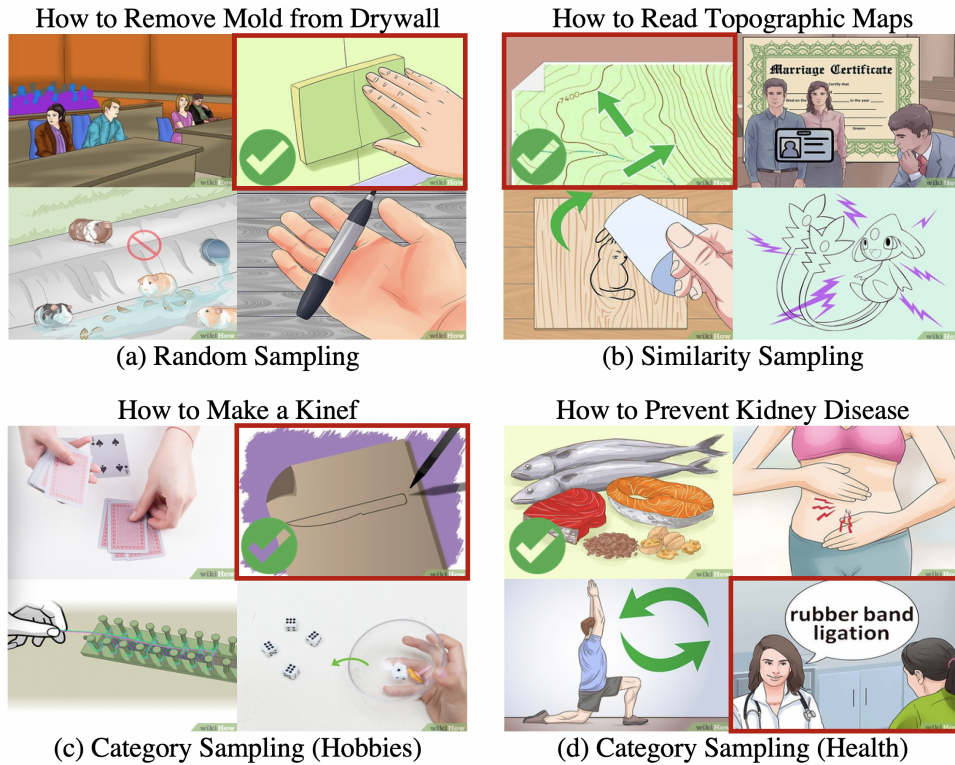

Figure 5: Qualitative Examples Using Different Sampling Strategies
(Red bounding box denotes the model’s prediction, green tick represents the ground truth.)

each video from the 180 goals and construct a pool of 1,000 images. For Howto100m, we randomly select 5 images from the 200 videos in the testing set and also form a pool of 1K images.

Table 8 and 9 indicates the model pre-trained on wikiHow outperforms the other dataset in the retrieval task and the aggregation model could further improve the performance.

D Qualitative Examples

See Figure 5, 6, 7.

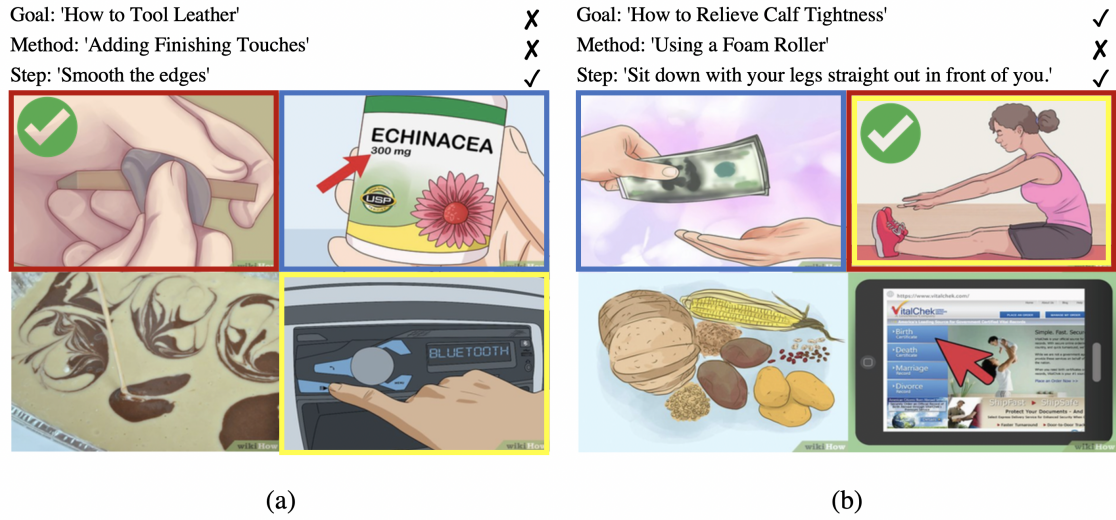

Figure 6: Qualitative Examples Using Different Query Prompts
(Yellow bounding box is the goal's prediction, blue bounding box denotes the method's prediction, red bounding box denotes the step's prediction, green tick represents the ground truth.)

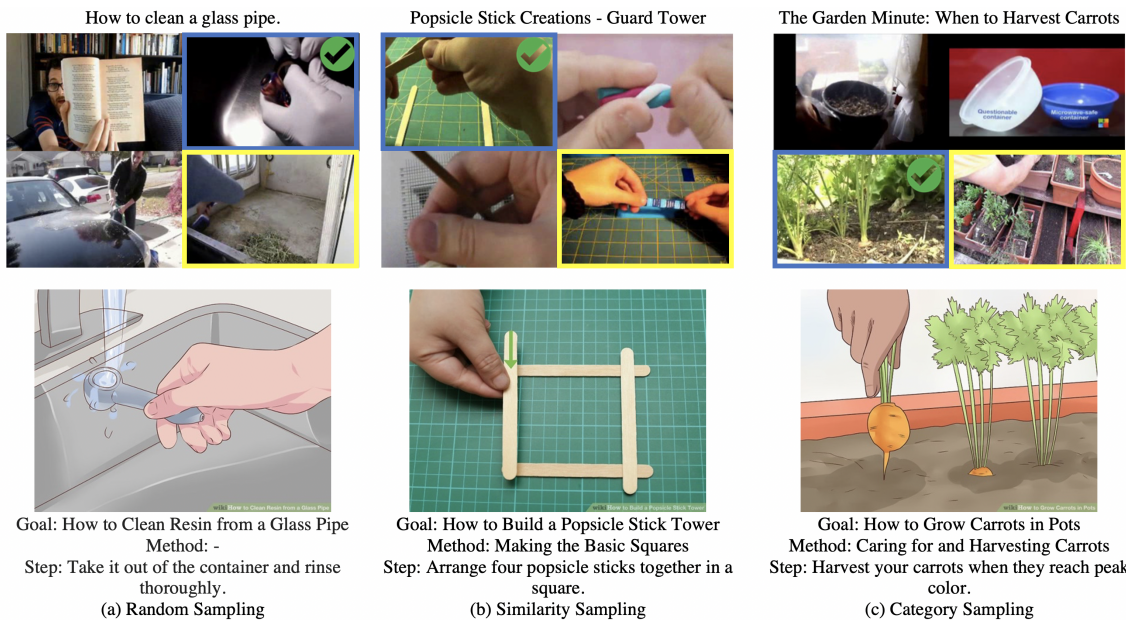

Figure 7: Qualitative Examples Using Different Query Prompts (First row shows the multiple-choice examples of Howto100M video frames, yellow bounding box is the prediction of the model without pretraining on wikiHow, blue bounding box denotes the prediction of pretrained model, green tick represents the ground truth. Second row shows the related images and descriptions we found in wikihow)