

Joint Positioning and Tracking via NR Sidelink in 5G-Empowered Industrial IoT

Yi Lu, *Student Member, IEEE*, Jukka Talvitie, Mike Koivisto, Elizaveta Rastorgueva-Foi, Toni Levanen, Elena Simona Lohan, *Senior Member, IEEE*, and Mikko Valkama, *Senior Member, IEEE*

Abstract—The fifth generation (5G) mobile networks with enhanced connectivity and positioning capabilities play an increasingly important role in the development of autonomous and other advanced industrial systems. In this article, we address the prospects of 5G New Radio (NR) sidelink based ad-hoc networks and their applicability for increasing the situational awareness, in terms of continuous tracking of moving connected machines and vehicles, in industrial systems. For increased system flexibility and fast deployments, we assume that the locations of the so-called anchor nodes are unknown, and describe an extended Kalman filter-based joint positioning and tracking framework in which the locations of both the anchor nodes and the target nodes can be estimated simultaneously. We assess and demonstrate the achievable 3D positioning and tracking performance in the context of a realistic industrial warehouse facility, through extensive ray-tracing based evaluations at the 26 GHz NR band. Our findings show that when both angle-based and time-based measurements are utilized, reaching sub-1 meter accuracy is realistic and that the system is also relatively robust against different node geometries. Finally, several research challenges towards achieving robust, high-performance and cost-efficient positioning solutions are outlined and discussed, identifying various potential directions for future work.

Index Terms—5G New Radio, mmWave, sidelink, device-to-device, positioning and tracking, industrial Internet, autonomous systems

I. INTRODUCTION

Positioning, navigation, and location-aided communications techniques are central technical enablers in the emerging autonomous systems and industrial Internet-of-Things (IIoT) [1]. On top of the advanced communications features, the fifth generation (5G) cellular systems can facilitate high-accuracy positioning service owing to the availability of the wide bandwidths and the beamforming capabilities [2]. However, deploying full-coverage 5G systems in versatile industrial environments may not be feasible, particularly at the millimeter wave (mmWave) bands with largely reduced cell sizes. As part of the 5G New Radio (NR) specifications, the so-called sidelink technology allows to establish ad-hoc networks between the

NR user equipment (UE) [2], [3]. This allows for improved network coverage in complex industrial environments while can also provide new opportunities for efficient localization and tracking – a topic that is addressed, discussed and demonstrated in this article.

In the considered NR sidelink based ad-hoc network, illustrated in Fig. 1, we differentiate between the so-called anchor nodes and the target nodes depending on the availability of the access link towards the NR base-station. Furthermore, for improved system flexibility and in order to cope with the challenging conditions of different industrial premises [4], we assume that the anchor nodes can be deployed dynamically, on an on-demand basis. This allows for flexible relocation and re-deployment of the anchors, such as aerial vehicles or high-end terminals as local hotspots, in order to optimize, e.g., the radio coverage and line-of-sight (LoS) conditions between the anchors and the target nodes in dynamic industrial environments. However, this also implies that the locations of such dynamically deployed anchors are not precisely known, which in turn complicates the positioning and tracking of the actual industrial target nodes. To address this challenge, an advanced joint positioning and tracking framework can be devised where the locations of both the anchor nodes and the target nodes are simultaneously estimated and tracked. Such approach allows for creating increased location awareness in advanced industrial IIoT systems, and thereon facilitates, e.g., efficient beam-forming, handover and radio resource management functionalities. Additionally, the high-accuracy tracking of the industrial vehicles and machines can significantly improve the overall situational awareness, thus enhancing the efficiency and safety of the industrial facility [4].

In this article, we describe, demonstrate and assess the performance of an advanced joint positioning and tracking framework in the above-described NR sidelink based industrial ad-hoc network context, operating at the 26 GHz mmWave band. The approach builds on a network-centric joint positioning and tracking engine, aggregating and processing the measurements obtained by the anchor nodes. Both time-based and angle-based measurements are considered, building on the 5G NR sidelink reference signal (SL-RS) transmissions between the target and the anchor nodes. For accurate modeling and performance assessments, extensive ray-tracing based evaluations are provided comprising an accurate digital map of a realistic industrial warehouse. Furthermore, the achievable positioning and tracking accuracy under different numbers of the involved anchor and target nodes as well as the impact of the node geometry and different involved measurements are studied and

This work was financially supported by the Academy of Finland, under the projects ULTRA (328226, 328214) and FUWIRI (319994), and by the Finnish Funding Agency for Innovation under the project 5G VIIMA.

Y. Lu, J. Talvitie, M. Koivisto, E. Rastorgueva-Foi, E.S. Lohan and M. Valkama are with Department of Electrical Engineering, Tampere University, Finland. E-mail: mikko.valkama@tuni.fi

T. Levanen is with Nokia Mobile Networks, Tampere, Finland.

This manuscript contains supplementary multimedia materials, available at the Manuscript Central and at:

https://research.tuni.fi/wireless/research/positioning/NR_sidelink_positioning/

This work has been submitted to the IEEE for possible publication. Copyright may be transferred without notice, after which this version may no longer be accessible.

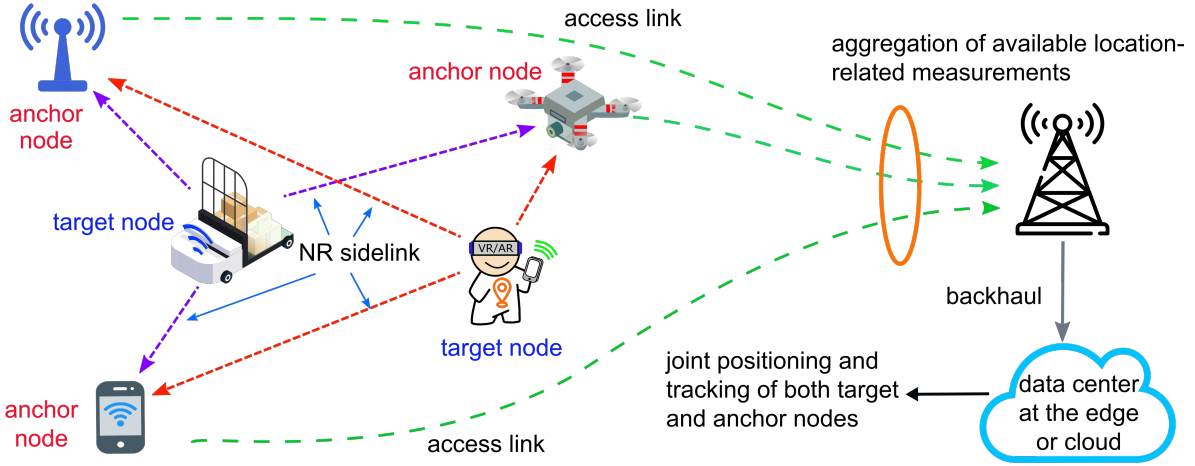

Fig. 1: A system-level overview of the NR sidelink based industrial ad-hoc network with dynamically deployed anchor nodes and actual industrial target nodes. The joint positioning and tracking of anchors and targets builds on the sidelink-based measurements, aggregated and processed on the network side.

demonstrated. Finally, we identify and discuss the potential open research challenges in achieving high-accuracy, cost-efficient and robust positioning solutions in 5G-empowered industrial systems.

II. NR SIDELINK BASED AD-HOC NETWORKS AND JOINT POSITIONING AND TRACKING

A. System Description and Assumptions

Following the 3rd generation partnership project (3GPP) standardization regarding the so-called proximity-based services [2], [5], an industrial IoT system capitalizing the 5G NR sidelink technology at mmWave frequencies is considered. As illustrated in Fig. 1, the overall network is hierarchical where the anchor nodes have direct radio access to the NR base-station while communicating with the target nodes through the NR sidelink. The target nodes are the actual industrial devices, such as robots, industrial vehicles or augmented/virtual reality glasses, while the anchor nodes can be, e.g., high-end smart phones or aerial vehicles allowing them to be deployed on an on-demand basis in a dynamical manner. Such dynamic anchors allow for providing coverage and capacity in the industrial facility in a versatile manner, as for example the interior structure of an industrial warehouse can change almost on a daily basis. In general, we note that while the majority of the examples and discussions in the article consider indoor scenarios, there are no technical limitations in applying similar technological approach also in outdoor scenarios.

In terms of the sidelink operations, a direct-device-discovery mechanism as specified in the context of NR vehicle-to-everything (V2X) in [6, Section 5.8] is assumed to be implemented among all the nodes within the device-to-device (D2D) coverage range to ensure a seamless connectivity. It is noted that the maximum D2D distance depends generally, e.g., on the transmit power, bandwidth, link center frequency and the receiver sensitivity. To this end, if a target node moves out of the D2D range with respect to any arbitrary anchor, the corresponding link will be ignored. Moreover, we assume that only the D2D links between the anchors and the target

nodes are established and utilized, as illustrated also in Fig. 1. Thus, no mutual connectivity among the target nodes nor among the anchor nodes is considered, in order to relax for example the interference challenges and overall to have a more implementation feasible system model. Thus, also the joint positioning and tracking solution, described in Section II-C, builds only on the measurements between targets and anchors, opposed to many existing works such as [7] where all involved nodes are assumed to cooperate.

In terms of the carrier frequency, we consider the system deployment at the mmWave bands, specifically the so-called 3GPP frequency range (FR) 2 [2]. This is motivated by the fact that the FR 2 facilitates a wide bandwidth for high throughputs as well as increased sub-carrier spacings which enable short slots and thereon reduced radio network latencies. More importantly, the FR 2 operation enables wide bandwidths and highly directional beamforming capabilities, which in turn allow for increased accuracies in time-based and angle-based measurements for high-performance positioning and tracking.

The location-related measurements, discussed further in Sub-section II-B, are performed by the anchor nodes, and communicated and aggregated at the central processing unit through the NR base-station. The joint positioning and tracking of the involved nodes, through the extended Kalman filter based solution described in Sub-section II-C, is then carried out in the network processing unit, allowing the estimated location information to be utilized directly in, e.g., optimized radio resource allocation, mobility management and scheduling functionalities.

B. Location-related Measurements

In general, the essence of radio positioning is to solve a collection of non-linear equations given the available location-related measurements dealing with, e.g., time of arrival (ToA) and angle of arrival (AoA) [8]. Therefore, the amount and the accuracy of the employed measurements directly affect the final positioning accuracy. In general, the number of available measurements depends on the number of deployed nodes in the network, whereas the attainable measurement accuracy varies

according to the available signals and their characteristics and the corresponding specific estimation approaches.

In the considered NR sidelink based mmWave ad-hoc network, beamformed measurements are one key technical ingredient. To this end, we consider a beam sweeping approach for ToA and AoA measurements stemming from the defined procedures for NR beam management [2]. Specifically, the industrial target nodes can periodically transmit 5G NR sidelink reference signals, such as sidelink synchronization signal block (SL SSB) or sidelink channel state information reference signal (SL CSI-RS) [3], [9], which the anchors are then receiving and measuring in a beam-based manner. The AoA measurements are determined by observing the power differences between the separate receive beams in the involved beam sweeping process, also known as the beam reference signal received power (B-RSRP) values. The ToAs, in turn, are estimated by calculating the phase differences between the different sub-carriers of the received orthogonal frequency division multiplexing (OFDM) signal.

There are generally certain known challenges related to reliable utilization of ToA and AoA measurements. In terms of ToA, there typically exists a time-varying clock offset between any two agents [8]. Without proper synchronization, ToA measurements do not provide good positioning accuracy. Such a problem can in general be overcome by performing time difference of arrival (TDoA)-based positioning with synchronized anchor nodes. Alternatively, a joint positioning and synchronization scheme can be applied to provide reliable positioning as well as to simultaneously estimate and track the involved synchronization errors [10]. As for AoA, one common problem stems from the uncertainty of the orientations [8] in the involved antenna arrays. Unlike the conventional base stations whose locations and array orientations can be typically assumed to be known at the network side, such information is not directly available with the envisioned anchor nodes, such as on-demand aerial vehicles. With proper formulation of the Bayesian estimation filters, both the target node locations and the anchor node orientation errors can be jointly estimated [11]. Alternatively, an inertial measurement unit (IMU) can be employed to provide an accurate orientation estimate.

C. Joint Positioning and Tracking of Nodes

As already noted, the on-demand nature of the anchors implies that no precise knowledge of the anchor nodes' locations is automatically available, hence a joint positioning and tracking solution is pursued where the locations of all involved nodes are estimated based on the above-described measurements. It is, however, also important to note that even when dynamic anchors are deployed whose locations can vary over time, the rate of change in their locations can be assumed largely different from that of the target nodes. The target nodes – say autonomous industrial vehicles and other moving robots – can basically move continuously, with potential occasional halts. The dynamic anchors, in turn, after being deployed at a certain location in order to provide the local coverage and capacity through the NR sidelink, can be considered static for a considerable amount of time.

With the NR sidelink SL-RS based measurements as the inputs, the actual joint positioning and tracking solution builds on an extended Kalman filter (EKF), motivated by its flexibility to deal with both linear and non-linear measurement models and by its relatively low computational complexity compared to other Bayesian filters, such as particle filters [8]. Moreover, via proper utilization and formulation of the system state-space that contains the kinematic parameters – particularly the locations, velocities and accelerations – of all the involved nodes, the joint positioning and tracking functionality can be realized relying purely on the described radio-based AoA and ToA measurements. The outputs of the positioning solution consist of the instantaneous location estimates of both the target nodes and the anchor nodes, conceptually similar to the cooperative vehicular positioning solution discussed in [12]. At each time instant, the state is first predicted through the state propagation model, which is then corrected using the available measurements and their statistics through a linearized observation model by executing the well-known EKF equations [8]. During joint positioning and tracking, we particularly focus on the moving target nodes and static anchor nodes, and thus the locations, velocities and accelerations of the target nodes are considered in the state vector, whereas for the anchor nodes, only the locations are considered. Nonetheless, positioning of dynamic anchor nodes can also be achieved by adding the corresponding velocities and accelerations in the state vector and the corresponding state transition model of the involved EKF.

It can also be noted that in addition to the considered NR sidelink based D2D scenario, the joint positioning and tracking framework can be applied in any other similar wireless positioning scenario where the locations of both the transmitting and measuring nodes are to be estimated and tracked. One concrete example could be, e.g., the positioning of the remote radio units (RRUs) in a distributed network structure where the coordinates of the RRUs are not necessarily accurately known – opposed to those of the macro base-stations in a classical network building on careful network planning and optimization. In such a scenario, UEs would be the target nodes and RRUs the anchor nodes while the central cell-site would then be aggregating the uplink sounding reference signal (SRS) based measurements for joint positioning and tracking of the RRUs and UEs.

III. PERFORMANCE EVALUATIONS AND ANALYSIS

A. System Scenario and Initialization

Our performance evaluation and assessment environment corresponds to an indoor industrial warehouse facility with an overall open space of $70\text{ m} \times 25\text{ m} \times 18\text{ m}$, as depicted in Fig. 2. For realistic propagation modeling of the SL-RS transmissions and their beam-based reception, full ray tracing calculations are carried out with Wireless Insite [13], incorporating an accurate digital map of the industrial facility and its different objects. Furthermore, each anchor node is assumed to be equipped with two 8×8 uniform rectangular array (URA) panels and they are assumed to be randomly located between 1 m and 9 m above the ground. The two panels are oriented with opposite azimuth

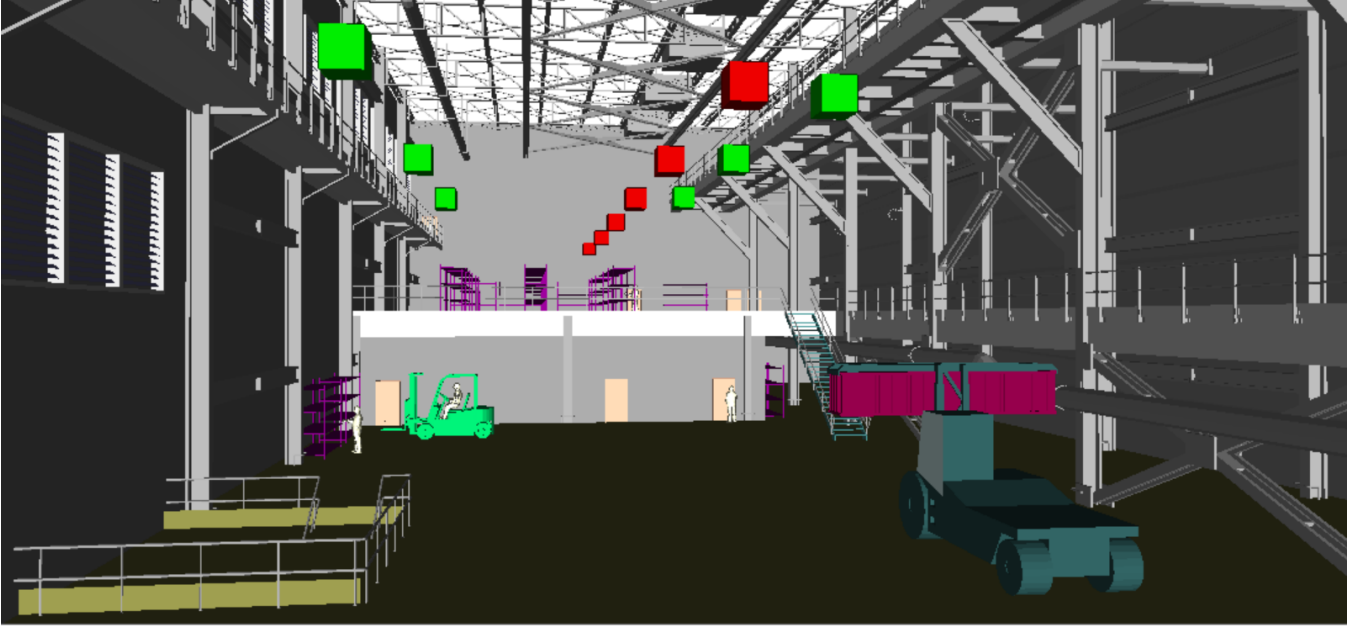

Fig. 2: A ray-tracing featured indoor industrial warehouse, from Wireless Insite [13], containing several moving target nodes and static anchor nodes. For illustration and comparison purposes, the red squares refer to a typical collinear anchor deployment that yields challenging geometric dilution of precision (GDoP), whereas the green squares represent the non-collinear anchor deployment with beneficial GDoP.

angles (back to back), such that each antenna panel in the antenna system covers a half of the sphere. The corresponding orientation is assumed to be estimated via the onboard IMU sensors and considered known at the network side.

Different industrial target nodes move along specific random waypoint based 3D trajectories [14] through the open space with velocities of 1.0-1.2 m/s. Furthermore, the overall length of target nodes' trajectories is set to 5 min, resulting in 5000-sample trajectories for a 100 ms EKF update interval. The location-related measurements at the anchor nodes build on the SL CSI-RS transmissions [9] of the target nodes, which are periodically and omni-directionally transmitted by the target nodes with 0 dBm power over 100 MHz bandwidth at the 26 GHz carrier frequency, while the NR network subcarrier spacing is assumed to be 60 kHz. When multiple target nodes exist, the reference signal transmissions can be multiplexed in time or frequency, or through orthogonal codes, such that anchors can measure them without mutual interference. Finally, the sidelink receiver sensitivity level is assumed to be -90 dBm, and if the received signal power is below this limit the corresponding D2D link is neglected.

The EKF update interval is 100 ms, allowing for realistic beam-based SL-RS measurement patterns as well as time to communicate and process the measurements. As discussed in Section II-C, the EKF state vector contains the 3D locations of the anchor nodes and the 3D locations, velocities and accelerations of the mobile target nodes. The system initialization builds on anchor location estimates, that can in practice be provided by the base-station through uplink SRS measurements. Furthermore, the initial locations of the targets can be estimated through the first time-based or angle-based measurements via, e.g., ordinary batch least-squares.

In general, despite the LoS paths between each pair of target

and anchor nodes typically exists in the considered industrial scenario, it can also happen that the LoS paths are blocked by different objects in the complex environment. In such cases, the location-related measurements of the non-line-of-sight (NLoS) anchor node are omitted in the estimation process of the target node location while the output of the EKF's prediction step is considered as the location estimates for the anchor nodes.

Stemming from the dynamic unplanned deployment of the anchor nodes, the resulting geometric dilution of precision (GDoP) can vary largely. In order to investigate the geometric impact, we consider two representative anchor setups with either beneficial or challenging GDoP – illustrated as the green and red squares, respectively, in Fig. 2. In particular, the collinear setup (illustrated in red) implies a challenging GDoP, whereas the non-collinear setup (illustrated in green) yields a beneficial GDoP. Such impact of the geometry on the positioning and tracking performance is assessed and demonstrated in the forthcoming numerical results.

B. Numerical Results and Analysis

Before the actual joint positioning and tracking experiments, we first explore the accuracy of the location-related measurements, namely ToA/TDoA and AoA, in the considered industrial environment illustrated in Fig. 2. The obtained results are shown in Fig. 3, with the accuracy of the time-based measurements being converted to corresponding distance/ranging accuracy.

As can be observed, the time-based measurements (ToA and TDoA) possess a very high accuracy, specifically roughly 95% of the errors are smaller than 0.2 m. This is stemming from the 100 MHz bandwidth that provides essentially sufficient resolution to distinguish the LoS from multipaths. In the angular domain, the estimation errors of both elevation and azimuth

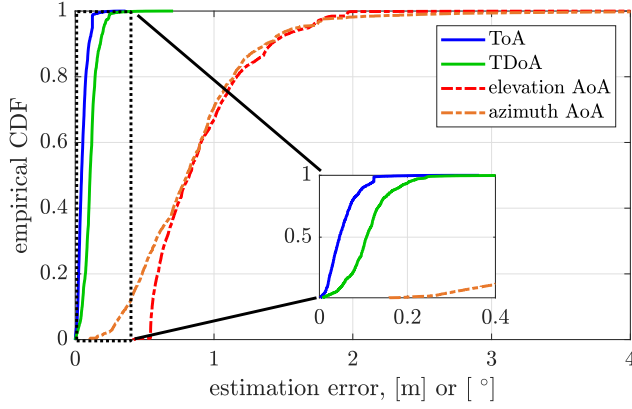

Fig. 3: The empirical cumulative density functions of the estimation errors of both the time-based (ToA/TDoA) and the angle-based (AoA) location-related measurements corresponding to the beam-based reception of the SL-RS.

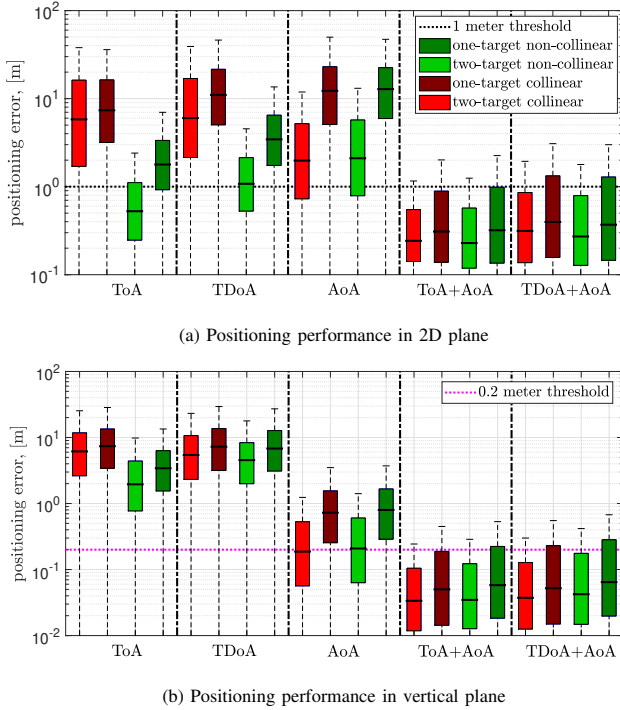

Fig. 4: Achieved positioning performance with the EKF based joint positioning and tracking solution under collinear and non-collinear deployments with six anchor nodes and one or two target nodes.

AoA undergo a similar level of accuracy with 95% of the errors being less than 2 degrees. This is due to the fact that the beamwidths, i.e., the spatial angular resolution, in the elevation and azimuth planes are nearly the same considering an 8×8 URA antenna panels in the anchor nodes.

Next, we assess and evaluate the actual joint positioning and tracking performance, considering different combinations of the available time-based and angle-based measurements under the two representative geometries, i.e., collinear and non-collinear deployments illustrated in Fig. 2. It is noted that in all the forth-coming results, the positioning performance is measured and quantified jointly for all the involved nodes – the anchors and the targets. It is further noted that the trends that can be

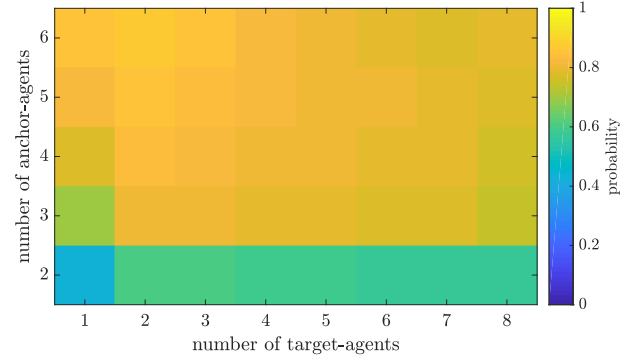

Fig. 5: Performance characterization in terms of probability of sub-1 meter 3D positioning accuracy when utilizing TDoA and AoA measurements in the EKF based joint positioning and tracking framework as a function of the numbers of target nodes and anchor nodes.

observed from such jointly quantified results are essentially identical to those that can be obtained when plotting, e.g., the target tracking performance separately.

The achieved performance results as well as the corresponding performance thresholds of 1 m for 2D and 0.2 m for vertical plane, noted in [15], are collected and shown in Fig. 4. The overall accuracy is characterized by the median value marked by the dark line around the center of each performance bar. Moreover, the sub-meter and sub-0.2 meter thresholds are plotted therein as a measure of positioning reliability.

The 2D performance with 6 anchor nodes and with different combinations of the available measurements are given in Fig. 4a. We see that both the median value of the positioning error and the probability of sub-1 meter accuracy when utilizing time-based measurements (ToA or TDoA) suffer largely from the collinear deployment (red and dark red boxes) and the resulting challenging GDoP. However, the performance of the system with time-based measurements improves substantially when the GDoP becomes more favorable through the non-collinear deployment (green and dark green boxes). In such case, the two-target ToA-based system achieves the median 2D accuracy of 0.5 m, which is already rather close to the positioning performance with ToA+AoA and TDoA+AoA.

The corresponding vertical domain positioning performance is illustrated in Fig. 4b. It can be observed that, even under non-collinear case, the time-based solutions perform rather poor, with the median positioning error ranging from 2 m to 8 m – i.e., substantially larger than the targeted 0.2 m threshold stated in [15]. On the contrary, however, the AoA-based system demonstrates an accuracy level close to the target threshold, reflecting also better vertical accuracy compared to that in 2D. Furthermore, when utilizing all the available location-related measurements, the vertical performance is at the similar excellent level as the corresponding 2D performance. In general, with the combined measurements, the sub-0.2 meter vertical accuracy and the sub-1 meter 2D accuracy are achieved in more than 85% and 90% of the cases, respectively.

Examining further the results in Fig. 4, one can observe that the performance in both 2D and vertical planes are in general better when there are two target nodes that are tracked,

compared to the single target node case. The performance gain is very significant when building the positioning and tracking only on a single measurement (ToA, TDoA or AoA), while the gain is less pronounced when multiple measurements are fused together.

Pursuing to further understand such impacts of the amount of the involved nodes, we explore the positioning performance as a function of the numbers of the targets and anchors. Aiming at achieving the best possible performance, we consider TDoA+AoA based joint positioning and tracking under the same industrial environment, shown in Fig. 2, while now assuming randomly dropped anchor locations in the considered 3D space. The corresponding performance results in terms of the probability of achieving sub-1 meter accuracy in 3D are shown in Fig. 5. As can be observed, with one target node only, the performance is gradually improving for increased numbers of the anchor nodes. The performance gain is significant when the number of anchor nodes changes from two (43% probability for sub-1 meter 3D positioning accuracy) to three (65%), and from three to four (78%). Thereafter, more anchor nodes do not anymore yield significant further improvements in terms of the sub-1 meter accuracy. Then, in cases with more than one target node, the performance becomes notably better when the number of anchors varies from two (60%) to three (80%), while further gains from additional anchors are already smaller. Furthermore, based on the shown results and the joint positioning and tracking point of view, we can conclude that six anchor nodes are sufficient to reach very high performance, independent of the number of target nodes, when deploying ToA/TDoA+AoA measurements.

Finally, for a given number of anchor nodes, the performance variation as a function of the number of targets can also be observed in Fig. 5. For reference, in Fig. 4, the performance involving one and two target nodes and an overall of six anchor nodes was assessed and shown, while a similar behavior can be observed in the top left corner of Fig. 5. With further increases in the number of the target nodes, the performance is generally very stable and good.

IV. CHALLENGES AND POTENTIAL RESEARCH TOPICS

We next identify and discuss selected challenges and potential future research topics to achieve high-accuracy, cost-efficient and robust positioning and tracking solutions in industrial systems.

Deploying both fixed and dynamic anchors: The deployment of unplanned and movable dynamic anchors discussed in the article comes with the expense of an increased system-level management complexity. Moreover, such dynamic anchors may suffer from short operational periods because of, e.g., a limited battery capacity of aerial vehicles. Additionally, the antenna systems are generally more limited in terms of, e.g., number of antenna elements, implying less accurate AoA estimation capabilities compared to actual base-stations. As a solution, the joint deployment of fixed and dynamic anchors may serve as an attractive solution in different industrial IoT scenarios, calling for further research in terms of system optimization.

Accurate vertical estimation with and without AoA: While 2D positioning can generally be sufficient for several

timely use cases, such as modern high-speed train and pedestrian navigation, the vertical accuracy is essential in various industrial verticals in which the vehicles/robots are moving along trajectories in 3D space. In this work, we have seen that the vertical positioning accuracy reaches sub-meter level when AoA measurements are utilized, either individually or fused with ToA measurements. However, to reliably measure the AoA one must solve and optimize several practical issues such as the array orientation and beam-resolution, while also be able to operate efficiently in NLoS scenarios. Therefore, dedicated research efforts are needed to ensure a high vertical accuracy in various industrial use cases, with and without AoA measurements, and possibly further complemented with IMU and other relevant onboard sensors.

Smart management and optimization of resources, system geometry and positioning accuracy: The positioning performance of any radio-based system depends primarily on the available radio resources, such as signal bandwidth and transmission power, with direct impact on the accuracy of the obtained location-related measurements and the corresponding positioning. However, with the relative geometrical relationships between the targets and the anchors being taken into account, smart resource management and geometry optimization schemes deserve further research, such that the accuracy of the time-based and angle-based measurements and the actual location estimates can be maximized.

Positioning and tracking in LoS-obstructed environments: With the growing complexity of indoor (e.g. multi-floor industrial warehouse) and outdoor (e.g. harbor or container port area) environments, the radio propagation between transmitting and receiving devices becomes increasingly complex. Furthermore, there is an increasing likelihood for the LoS path being completely obstructed, yielding challenging NLoS scenarios. Thus, novel positioning and tracking solutions employing the information in the received multipath components, including potentially also the positioning of the reflection and/or scattering points, are seen to form an intriguing open research space with large potential for high impact.

Hybrid positioning through fusion of 5G, global navigation satellite systems (GNSS) and inertial navigation system (INS): GNSS-based positioning is often not an option in indoor facilities or deep urban canyons, due to low received signal power, rich multipath and high receiver energy consumption. Therefore, hybrid positioning schemes based on the fusion of 5G and GNSS+INS can be studied and developed towards a universal solution for robust positioning in urban, rural and indoor scenarios – a topic that is broad and deserves substantial research efforts.

High-accuracy positioning with low power consumption and low latency: For a device-centric framework, high-accuracy positioning may easily infer high power consumption since both the measurements and their processing are carried out by the device. Alternatively, in the network-centric approach considered also in this article, the device power consumption is largely reduced through off-loading the processing of the location-related measurements to the network edge/fog or cloud servers. Such entities commonly possess at least an order of magnitude larger computational capabilities, however, at the

expense of clearly larger latencies. Hence, the investigation of the trade-offs between the power consumption and the latency for high-accuracy positioning is generally one viable research direction.

V. CONCLUSIONS

Aiming at unlocking the full potential of 5G-empowered industrial IoT for various industry verticals, we described, discussed and assessed a joint positioning and tracking framework employing the NR sidelink capabilities and the corresponding D2D ad-hoc networks. Building on beam-based measurements acquired via NR sidelink reference signals, a network-centric extended Kalman filter based solution was described to estimate and track the locations of both the anchor nodes and the actual industrial target nodes simultaneously. The achievable positioning performance was evaluated utilizing both time-based and angle-based measurements via extensive ray-tracing simulations at 26 GHz in a realistic industrial environment. The numerical results demonstrate, among others, that incorporating angle-based measurements into the positioning and tracking system, the positioning performance becomes robust to different anchor geometries and the corresponding GDoP. Additionally, the results indicate that sub-1 meter positioning can be reliably achieved, in 2D as well as in the vertical domain.

While utilizing both time-based and angle-based measurements, we also investigated the impact of varying numbers of the involved nodes on the positioning performance. The results indicate a clear performance gain when increasing the number of target nodes for low number of anchors – and vice versa – while for larger node densities the system performance is systematically good and stable. The results also indicate that in the considered industrial warehouse type of facility, high positioning and tracking performance can be obtained even with a relatively low number of anchor nodes, thus reflecting a cost-efficient yet flexible system.

Finally, several research challenges and potential further directions for high-accuracy, robust and cost-efficient positioning in wireless industrial IoT systems were discussed. Moreover, with proper combination of efficient positioning and sensing techniques, the obtained situational awareness of the node locations as well as the surroundings and environment can be employed to facilitate improved industrial efficiency and safety.

REFERENCES

- [1] E. S. Lohan *et al.*, “Benefits of Positioning-Aided Communication Technology in High-Frequency Industrial IoT,” *IEEE Communications Magazine*, vol. 56, no. 12, pp. 142–148, 2018.
- [2] H. Holma, A. Toskala, and T. Nakamura, *5G Technology: 3GPP New Radio*, 1st ed. Wiley, 2019.
- [3] 3GPP, TR 38.885 V16.0.0, “Study on NR Vehicle-to-Everything (V2X) (Release 16),” March 2019.
- [4] J. M. Batalla, C. X. Mavromoustakis, G. Mastorakis, N. N. Xiong, and J. Wozniak, “Adaptive Positioning Systems Based on Multiple Wireless Interfaces for Industrial IoT in Harsh Manufacturing Environments,” *IEEE Journal on Selected Areas in Communications*, vol. 38, no. 5, pp. 899–914, 2020.
- [5] 3GPP, TR 23.752 V0.5.0, “Study on system enhancement for Proximity based Services in the 5G System (5GS) (Release 17),” Sep. 2020.
- [6] 3GPP, TS 38.331 V16.2.0, “NR; Radio Resource Control (RRC); Protocol specification (Release 16),” Sep. 2020.

- [7] A. Dammann, R. Raulefs, and S. Zhang, “On prospects of positioning in 5G,” in *2015 IEEE International Conference on Communication Workshop (ICCW)*, 2015, pp. 1207–1213.
- [8] R. Zekavat and R. M. Buehrer, *Handbook of Position Location: Theory, Practice and Advances*, 2nd ed. Wiley-IEEE Press, 2019.
- [9] 3GPP, TS 38.211 V16.1.0, “NR; Physical channels and modulation (Release 16),” March 2020.
- [10] M. Koivisto *et al.*, “Joint Device Positioning and Clock Synchronization in 5G Ultra-Dense Networks,” *IEEE Transactions on Wireless Communications*, vol. 16, no. 5, pp. 2866–2881, 2017.
- [11] E. Rastorgueva-Foi *et al.*, “Networking and positioning co-design in multi-connectivity industrial mmw systems,” *IEEE Transactions on Vehicular Technology*, pp. 1–1, 2020.
- [12] N. Alam and A. G. Dempster, “Cooperative Positioning for Vehicular Networks: Facts and Future,” *IEEE Transactions on Intelligent Transportation Systems*, vol. 14, no. 4, pp. 1708–1717, 2013.
- [13] Wireless Insite, “<https://www.remcom.com/wireless-insite-em-propagation-software>,” Remcom Inc.
- [14] E. Hyttiä, H. Koskinen, P. Lassila, A. Penttinen, J. Virtamo, and J. Roszik, “Random Waypoint Model in Wireless Networks,” *Networks and Algorithms: Complexity in physics and Computer Science*, Jan. 2005.
- [15] 3GPP, TS 22.261 V17.3.0, “Service requirements for the 5G system; Stage 1 (Release 17),” July 2020.

BIOGRAPHIES

Yi Lu is a Researcher at Tampere University. His research interests include network-centric positioning system and positioning-aided communications in mmWave mobile networks.

Jukka Talvitie is a University Lecturer at Tampere University, Finland. His research interests include signal processing for wireless communications, and network-based positioning methods with particular focus on 5G networks.

Mike Koivisto is a Researcher at Tampere University. His research interests include positioning, with an emphasis on positioning and the utilization of location information in mobile networks.

Elizaveta Rastorgueva-Foi is a Researcher at Tampere University. Her research interests include positioning and location-aware communications in mmWave mobile networks with a focus on user mobility.

Toni Levanen is a SoC Specialist at Nokia Networks, Tampere, Finland. His research interests include physical layer design and SoC development for 5G NR and beyond mobile networks.

Elena Simona Lohan is a Full Professor at the Electrical Engineering unit, Tampere University, Finland and the coordinator of the MSCA EU A-WEAR network. Her current research interests include wireless location techniques, wearable computing, and privacy-aware positioning solutions.

Mikko Valkama is a Full Professor and Department Head of Electrical Engineering at Tampere University, Finland. His research interests include radio communications, radio systems and signal processing, with specific emphasis on 5G and beyond mobile networks.