

Data-Driven Variational Multiscale Reduced Order Models

Changhong Mou^a, Birgul Koc^a, Omer San^b, Traian Iliescu^{a,*}

^a*Department of Mathematics, Virginia Tech, Blacksburg, VA 24061, U.S.A.*

^b*Department of Mechanical and Aerospace Engineering, Oklahoma State University,
Stillwater, OK 74078, U.S.A.*

Abstract

We propose a new data-driven reduced order model (ROM) framework that centers around the hierarchical structure of the variational multiscale (VMS) methodology and utilizes data to increase the ROM accuracy at a modest computational cost. The VMS methodology is a natural fit for the hierarchical structure of the ROM basis: In the first step, we use the ROM projection to separate the scales into three categories: (i) resolved large scales, (ii) resolved small scales, and (iii) unresolved scales. In the second step, we explicitly identify the VMS-ROM closure terms, i.e., the terms representing the interactions among the three types of scales. In the third step, we use available data to model the VMS-ROM closure terms. Thus, instead of phenomenological models used in VMS for standard numerical discretizations (e.g., eddy viscosity models), we utilize available data to construct new structural VMS-ROM closure models. Specifically, we build ROM operators (vectors, matrices, and tensors) that are closest to the true ROM closure terms evaluated with the available data. We test the new data-driven VMS-ROM in the numerical simulation of the 1D Burgers equation and the 2D flow past a circular cylinder at Reynolds numbers $Re = 100$, $Re = 500$, and $Re = 1000$. The numerical results show that the data-driven VMS-ROM is

*corresponding author

Email addresses: cmou@vt.edu (Changhong Mou), birgul@vt.edu (Birgul Koc),
osan@okstate.edu (Omer San), iliescu@vt.edu (Traian Iliescu)

URL: <https://personal.math.vt.edu/people/cmou> (Changhong Mou),
<https://personal.math.vt.edu/people/birgul> (Birgul Koc),
<https://mae.okstate.edu/content/san-omer> (Omer San),
<https://personal.math.vt.edu/people/iliescu> (Traian Iliescu)

significantly more accurate than standard ROMs.

Keywords: Reduced order model, variational multiscale, data-driven model.

1. Introduction

For structure dominated systems, *reduced order models (ROMs)* [14, 22, 24, 26, 47, 54, 55, 67, 70, 71] can decrease the full order model (FOM) computational cost by orders of magnitude. ROMs are low-dimensional models that are constructed from available data: In an offline stage, the FOM is run for a small set of parameters to construct a low-dimensional ROM basis $\{\varphi_1, \dots, \varphi_r\}$, which is used to build the ROM:

$$\dot{\mathbf{a}} = \mathbf{F}(\mathbf{a}), \quad (1)$$

where \mathbf{a} is the vector of coefficients in the ROM approximation $\sum_{i=1}^r a_i(t) \varphi_i(\mathbf{x})$ of the variable of interest and \mathbf{F} comprises the ROM operators (e.g., vectors, matrices, and tensors) that are preassembled from the ROM basis in the offline stage. In the online stage, the low-dimensional ROM (1) is then used in a regime that is different from the training regime. Since the ROM (1) is low-dimensional, its computational cost is orders of magnitude lower than the FOM cost.

Unfortunately, current ROMs cannot be used in complex, realistic settings, since they require too many modes (degrees of freedom). For example, to capture all the relevant scales in practical engineering flows, hundreds [50, 68] and even thousands of ROM modes can be necessary [50, 76]. Thus, although ROMs decrease the FOM computational cost by orders of magnitude, they cannot be used in many important practical settings (e.g., digital twin applications, where a real-time control of physical assets might be required [23]).

One of the main roadblocks in the development of ROMs for complex practical settings is their notorious inaccuracy. The drastic ROM truncation is one of the most important reasons for the ROMs' numerical inaccuracy: Instead of using a sufficient number of ROM modes $\{\varphi_1, \dots, \varphi_R\}$ to capture the dynamics of the underlying system, current ROMs use only a handful of ROM modes $\{\varphi_1, \dots, \varphi_r\}$ to ensure a low computational cost. This drastic truncation yields acceptable results in simple, academic test problems, but yields inaccurate results in many practical settings [50], where the *ROM*

closure problem [3, 5, 6, 11, 17, 26, 40, 42, 41, 51, 59, 69, 73, 74] needs to be solved: One needs to model the effect of the discarded ROM modes $\{\varphi_{r+1}, \dots, \varphi_R\}$ on the ROM dynamics, i.e., on the time evolution of the resolved ROM modes $\{\varphi_1, \dots, \varphi_r\}$:

$$\dot{\mathbf{a}} = \mathbf{F}(\mathbf{a}) + \text{Closure}(\mathbf{a}), \quad (2)$$

where $\text{Closure}(\mathbf{a})$ is a low-dimensional term that models the effect of the discarded ROM modes $\{\varphi_{r+1}, \dots, \varphi_R\}$ on $\{\varphi_1, \dots, \varphi_r\}$.

The closure problem is ubiquitous in the numerical simulation of complex systems. For example, classical numerical discretization of turbulent flows (e.g., finite element or finite volume methods), inevitably takes place in the *under-resolved regime* (e.g., on coarse meshes) and requires closure modeling (i.e., modeling the sub-grid scale effects). In classical CFD, e.g., large eddy simulation (LES), there are hundreds (if not thousands) of closure models [63]. This is in stark contrast with ROM, where only relatively few ROM closure models have been investigated. The reason for the discrepancy between ROM closure and LES closure is that the latter has been entirely built around physical insight stemming from Kolmogorov’s statistical theory of turbulence (e.g., the concept of eddy viscosity), which is generally posed in the Fourier setting [63]. This physical insight is generally not available in a ROM setting. Thus, current ROM closure models have generally been deprived of many tools of this powerful methodology that represents the core of most LES closure models. Since physical insight cannot generally be used in the ROM setting, alternative ROM closure modeling strategies need to be developed. Our vision is that *data* represents a natural solution for ROM closure modeling.

In this paper, we put forth a new ROM framework that centers around the hierarchical structure of *variational multiscale (VMS)* methodology [27, 28, 29, 30], which naturally separates the scales into (i) resolved large, (ii) resolved small, and (iii) unresolved. We also construct new structural ROM closure models for the three scales by using available data. We believe that the VMS methodology is a natural fit for the hierarchical structure of the ROM basis: In the first step of the new VMS-ROM framework, we use the ROM projection to unambiguously separate the scales into three categories: (i) *resolved large* scales, (ii) *resolved small* scales, and (iii) *unresolved* scales. In the second step, we explicitly identify the *ROM closure* terms representing the interactions among the three types of scales by projecting the equations

onto the corresponding resolved large, resolved small, and unresolved spaces. In the third step, instead of phenomenological modeling techniques used in VMS for standard discretizations (e.g., finite element methods), we utilize *data-driven modeling* [8, 39, 53] to construct novel, robust, *structural* ROM closure models. Thus, instead of ad hoc, phenomenological models used in VMS for standard numerical discretizations (e.g., eddy viscosity models), we utilize available data to construct new structural models for the interaction among the three types of scales. Specifically, we use FOM data to develop VMS-ROM closure terms that account for the *under-resolved* numerical regime. We emphasize that, in the new *data-driven VMS-ROM (DD-VMS-ROM)* framework, we use data only to *complement* classical physical modeling (i.e., only for closure modeling) [43, 75], not to completely replace it [8, 56]. Thus, the resulting ROM framework combines the strengths of both physical and data-driven modeling.

Previous Relevant Work. The VMS methodology has been used in ROM settings [7, 16, 21, 31, 33, 62, 69, 74]. We emphasize, however, that the DD-VMS-ROM framework that we propose is different from the other VMS-ROMs.

The VMS-ROMs in [7, 31, 33, 69, 74] are *phenomenological* models in which the role of the VMS closure models is to *dissipate energy* from the ROM. In contrast, the new DD-VMS-ROM utilizes data to construct general structural VMS-ROM closure terms, which are *not required to be dissipative*. (Of course, if deemed appropriate, we may impose additional constraints to mimic the physical properties of the underlying system [44].)

The new DD-VMS-ROM is also different from the reduced-order subscales ROM proposed in [4] (see also [60, 61, 72]): The reduced-order subscales model in [4] minimizes the difference between the *solutions* of the FOM and ROM (see equations (18)–(19) in [6]), whereas the new DD-VMS-ROM minimizes the difference between the VMS-ROM *closure terms* and the “true” (i.e., high-resolution) closure terms. Furthermore, the reduced-order subscales model in [4] builds *linear* closure models (see also [49]), whereas the new DD-VMS-ROM constructs *nonlinear* closure models.

Another ROM closure strategy that is related to the VMS-ROM framework is the adjoint Petrov-Galerkin method [52] (see [9, 10, 20] for related work), which is based on the Mori-Zwanzig (MZ) formalism [19, 38]. In the MZ-ROM approach, the ROM closure model is represented by a memory term that depends on the temporal history of the resolved scales. The mem-

ory term is approximated to construct effective ROM closure models and, therefore, practical ROMs. The main difference between the adjoint Petrov-Galerkin method proposed in [52], and the new DD-VMS-ROM is the tool used to define the ROM closure term: The former uses a statistical tool (i.e., the MZ formalism), whereas the latter utilizes a spectral-like projection (i.e., the ROM projection).

Finally, we note that the VMS-ROM framework proposed herein belongs to the wider class of *hybrid physical/data-driven ROMs*, in which data-driven modeling is used to model only the missing information (i.e., the ROM closure term) in ROMs constructed from first principles (i.e., from a Galerkin projection of the underlying equations); see, e.g., [3, 11, 13, 18, 25, 40, 48, 52, 75].

The rest of the paper is organized as follows: In Section 2, we introduce the new DD-VMS-ROM. In Section 3, we test the DD-VMS-ROM in the numerical simulation of the 1D Burgers equation and 2D flow past a cylinder at Reynolds numbers $Re = 100$, $Re = 500$, and $Re = 1000$. Finally, in Section 4, we draw conclusions and outline future research directions.

2. Data-Driven Variational Multiscale Reduced Order Models (DD-VMS-ROMs)

In this section, we construct the new *data-driven VMS-ROM (DD-VMS-ROM)* framework, which can significantly increase the accuracy of under-resolved ROMs, i.e., ROMs whose dimension is too low to capture the complex dynamics of realistic applications. In Section 2.1 we briefly sketch the VMS methodology for general numerical discretizations (see, e.g., [2, 35] for more details), and in Section 2.2 we outline the standard Galerkin ROMs.

We construct the new DD-VMS-ROM in two stages: In Section 2.3, we construct the two-scale DD-VMS-ROM, which is the simplest DD-VMS-ROM. We note that the two-scale data-driven VMS-ROM was investigated in [75] under the name “data-driven filtered ROM” and in [44, 46] under the name “data-driven correction ROM.” However, we decided to outline the construction of the two-scale data-driven VMS-ROM since it is the most straightforward illustration of the DD-VMS-ROM framework.

In Section 2.4, we construct the novel three-scale DD-VMS-ROM. This new model separates the scales into three categories (instead of two, as in the two-scale DD-VMS-ROM), which allows more flexibility in constructing the ROM closure models. This, in turn, could lead to more accurate ROMs,

as is the case for VMS with standard numerical discretizations (e.g., finite elements) [35].

2.1. Classical VMS

The VMS methods are general numerical discretizations that increase the *accuracy* of classical Galerkin approximations in *under-resolved* simulations, e.g., on coarse meshes or when not enough basis functions are available. The VMS framework, which was proposed by Hughes and coworkers [27, 28, 29, 30], has made a profound impact in several areas of computational mathematics (see, e.g., [2, 35] for surveys). To illustrate the standard VMS methodology, we consider a general nonlinear system/PDE

$$\dot{\mathbf{u}} = \mathbf{f}(\mathbf{u}), \quad (3)$$

whose weak (variational) form is

$$(\dot{\mathbf{u}}, \mathbf{v}) = (\mathbf{f}(\mathbf{u}), \mathbf{v}), \quad \forall \mathbf{v} \in \mathbf{X}, \quad (4)$$

where \mathbf{f} is a general nonlinear function and \mathbf{X} is an appropriate infinite dimensional space. To build the VMS framework, we start with a sequence of *hierarchical spaces* of increasing resolutions: $\mathbf{X}_1, \mathbf{X}_1 \oplus \mathbf{X}_2, \mathbf{X}_1 \oplus \mathbf{X}_2 \oplus \mathbf{X}_3, \dots$. Next, we project system (3) onto *each* of the spaces $\mathbf{X}_1, \mathbf{X}_2, \mathbf{X}_3, \dots$, which yields a separate equation for each space. The goal is, of course, to solve for the \mathbf{u} component that lives in the coarsest space (i.e., \mathbf{X}_1), since this yields the lowest-dimensional system:

$$(\dot{\mathbf{u}}, \mathbf{v}_1) = (\mathbf{f}(\mathbf{u}), \mathbf{v}_1) \quad \forall \mathbf{v}_1 \in \mathbf{X}_1. \quad (5)$$

System (5), however, is *not* closed, since its right-hand side

$$(\mathbf{f}(\mathbf{u}), \mathbf{v}_1) = (\mathbf{f}(\mathbf{u}_1 + \mathbf{u}_2 + \mathbf{u}_3 + \dots), \mathbf{v}_1) \quad \forall \mathbf{v}_1 \in \mathbf{X}_1, \quad (6)$$

involves \mathbf{u} components that do *not* live in \mathbf{X}_1 (i.e., $\mathbf{u}_2 \in \mathbf{X}_2, \mathbf{u}_3 \in \mathbf{X}_3, \dots$). This coupling is mainly due to the *nonlinearity* of \mathbf{f} . Thus, the *VMS closure problem* needs to be solved, i.e., (6) needs to be approximated in \mathbf{X}_1 . The VMS (5) equipped with an appropriate closure model yields an accurate approximation of the large scale \mathbf{X}_1 component of \mathbf{u} .

The main reasons for the VMS framework's impressive success are its *utter simplicity* and its *generality* (it can be applied to *any* Galerkin based

numerical discretization). The classical VMS methodology, however, is facing several major challenges: (i) The *hierarchical spaces* can be difficult to construct in classical Galerkin methods (e.g., finite elements); and (ii) Developing *VMS closure* models for the coupling terms (i.e., the terms that model the interactions among scales) can be challenging.

In this paper, we propose a new data-driven VMS-ROM framework that overcomes two major challenges of standard VMS methodology: (i) The ROM setting allows a natural, straightforward construction of ROM hierarchical spaces. (ii) We use available data to construct data-driven VMS-ROM closure models. Thus, we avoid the ad hoc assumptions and phenomenological arguments that are often used in traditional VMS closures.

2.2. Galerkin ROM (G-ROM)

Before building the new VMS-ROM framework, we sketch the standard Galerkin ROM derivation: (i) Use available data (snapshots) for few parameter values to construct orthonormal modes $\{\boldsymbol{\varphi}_1, \dots, \boldsymbol{\varphi}_R\}$, $R = \mathcal{O}(10^3)$, which represent the recurrent spatial structures; (ii) Choose the dominant modes $\{\boldsymbol{\varphi}_1, \dots, \boldsymbol{\varphi}_r\}$, $r = \mathcal{O}(10)$, as basis functions for the ROM; (iii) Use a Galerkin truncation $\mathbf{u}_r(\mathbf{x}, t) = \sum_{j=1}^r a_j(t) \boldsymbol{\varphi}_j(\mathbf{x})$; (iv) Replace \mathbf{u} with \mathbf{u}_r in (3); (v) Use a Galerkin projection of the PDE obtained in step (iv) onto the ROM space $\mathbf{X}^r := \text{span}\{\boldsymbol{\varphi}_1, \dots, \boldsymbol{\varphi}_r\}$ to obtain an r -dimensional system, which is the *Galerkin ROM (G-ROM)*:

$$(\dot{\mathbf{u}}_r, \boldsymbol{\varphi}_i) = (\mathbf{f}(\mathbf{u}_r), \boldsymbol{\varphi}_i), \quad i = 1, \dots, r; \quad (7)$$

(vi) In an offline stage, compute the ROM operators; (vii) In an online stage, repeatedly use the G-ROM (7) (for parameters different from the training parameters and/or longer time intervals).

We illustrate the G-ROM for the Navier-Stokes equations (NSE):

$$\frac{\partial \mathbf{u}}{\partial t} - Re^{-1} \Delta \mathbf{u} + \mathbf{u} \cdot \nabla \mathbf{u} + \nabla p = \mathbf{0}, \quad (8)$$

$$\nabla \cdot \mathbf{u} = 0, \quad (9)$$

where \mathbf{u} is the velocity, p the pressure, and Re the Reynolds number. For clarity of presentation, we use homogeneous Dirichlet boundary conditions. The NSE (8)–(9) can be cast in the general form (3) by choosing $\mathbf{f} = Re^{-1} \Delta \mathbf{u} - \mathbf{u} \cdot \nabla \mathbf{u}$ and \mathbf{X} the space of weakly divergence-free functions in \mathbf{H}_0^1 . For the NSE, the G-ROM reads

$$\dot{\mathbf{a}} = A \mathbf{a} + \mathbf{a}^\top B \mathbf{a}, \quad (10)$$

where $\mathbf{a}(t)$ is the vector of unknown coefficients $a_j(t)$, $1 \leq j \leq r$, A is an $r \times r$ matrix with entries $A_{im} = -Re^{-1} (\nabla \varphi_m, \nabla \varphi_i)$, and B is an $r \times r \times r$ tensor with entries $B_{imn} = -(\varphi_m \cdot \nabla \varphi_n, \varphi_i)$, $1 \leq i, m, n \leq r$. The G-ROM (10) does not include a pressure approximation, since we assumed that the ROM modes are discretely divergence-free (which is the case if, e.g., the snapshots are discretely divergence-free). ROMs that provide a pressure approximation are discussed in, e.g., [15, 24, 55]. Once the matrix A and tensor B are assembled in the offline stage, the G-ROM (10) is a low-dimensional, efficient dynamical system that can be used in the online stage for numerous parameter values. We emphasize, however, that the G-ROM generally yields inaccurate results when used in *under-resolved*, realistic, complex flows [26, 47, 50, 74].

2.3. Two-Scale Data-Driven Variational Multiscale ROMs (2S-DD-VMS-ROM)

The first DD-VMS-ROM that we outline is the *two-scale data-driven VMS-ROM (2S-DD-VMS-ROM)*, which utilizes two orthogonal spaces, \mathbf{X}_1 and \mathbf{X}_2 . Since the ROM basis is orthonormal by construction, we can build the two orthogonal spaces in a natural way: $\mathbf{X}_1 := \text{span}\{\varphi_1, \dots, \varphi_r\}$, which represents the resolved ROM scales, and $\mathbf{X}_2 := \text{span}\{\varphi_{r+1}, \dots, \varphi_R\}$, which represents the unresolved ROM scales. We note that, in practical settings, we are forced to use *under-resolved* ROMs, i.e., ROMs whose dimension r is much lower than the dimension of the snapshot data set (i.e., R). Next, we use the best ROM approximation of \mathbf{u} in the space $\mathbf{X}_1 \oplus \mathbf{X}_2$, i.e., with $\mathbf{u}_R \in \mathbf{X}_1 \oplus \mathbf{X}_2$ defined as

$$\mathbf{u}_R = \sum_{j=1}^R a_j \varphi_j = \sum_{j=1}^r a_j \varphi_j + \sum_{j=r+1}^R a_j \varphi_j = \mathbf{u}_r + \mathbf{u}', \quad (11)$$

where $\mathbf{u}_r \in \mathbf{X}_1$ represents the resolved ROM component of \mathbf{u} , and $\mathbf{u}' \in \mathbf{X}_2$ represents the unresolved ROM component of \mathbf{u} . Plugging \mathbf{u}_R in (3), projecting the resulting equation onto \mathbf{X}_1 , and using the ROM basis orthogonality to show that $(\dot{\mathbf{u}}_R, \varphi_i) = (\dot{\mathbf{u}}_r, \varphi_i)$, $\forall i = 1, \dots, r$, we obtain

$$(\dot{\mathbf{u}}_r, \varphi_i) = (\mathbf{f}(\mathbf{u}_r), \varphi_i) + \underbrace{\left[(\mathbf{f}(\mathbf{u}_R), \varphi_i) - (\mathbf{f}(\mathbf{u}_r), \varphi_i) \right]}_{\text{VMS-ROM closure term}}, \quad \forall i = 1, \dots, r. \quad (12)$$

The boxed term in (12) is the *VMS-ROM closure term*, which models the interaction between the ROM modes $\{\varphi_1, \dots, \varphi_r\}$ and the discarded ROM modes $\{\varphi_{r+1}, \dots, \varphi_R\}$. The VMS-ROM closure term is essential for the

accuracy of (12): If we drop the VMS-ROM closure term, we are left with the G-ROM (7), which yields inaccurate results in the under-resolved regime. The VMS-ROM closure term is a *correction term* that ensures an accurate approximation of $\mathbf{u}_r \in \mathbf{X}_1$ in the higher-dimensional space $\mathbf{X}_1 \oplus \mathbf{X}_2$.

Next, we approximate the VMS-ROM closure term with $\mathbf{g}(\mathbf{u}_r)$, where \mathbf{g} is a *generic* function whose coefficients/parameters still need to be determined:

$$\text{VMS-ROM closure term} = [(\mathbf{f}(\mathbf{u}_R), \boldsymbol{\varphi}_i) - (\mathbf{f}(\mathbf{u}_r), \boldsymbol{\varphi}_i)] \approx (\mathbf{g}(\mathbf{u}_r), \boldsymbol{\varphi}_i). \quad (13)$$

To determine the coefficients/parameters in \mathbf{g} used in (13), in the offline stage, we solve the following low-dimensional *least squares problem*:

$$\min_{\mathbf{g} \text{ parameters}} \sum_{j=1}^M \left\| [(\mathbf{f}(\mathbf{u}_R^{FOM}(t_j)), \boldsymbol{\varphi}_i) - (\mathbf{f}(\mathbf{u}_r^{FOM}(t_j)), \boldsymbol{\varphi}_i)] - (\mathbf{g}(\mathbf{u}_r^{FOM}(t_j)), \boldsymbol{\varphi}_i) \right\|^2, \quad (14)$$

where \mathbf{u}_R^{FOM} and \mathbf{u}_r^{FOM} are obtained from the FOM data and M is the number of snapshots. Once \mathbf{g} is determined, the model (12) with the VMS-ROM closure term replaced by \mathbf{g} yields the *two-scale data-driven VMS-ROM (2S-DD-VMS-ROM)*:

$$(\dot{\mathbf{u}}_r, \boldsymbol{\varphi}_i) = (\mathbf{f}(\mathbf{u}_r), \boldsymbol{\varphi}_i) + (\mathbf{g}(\mathbf{u}_r), \boldsymbol{\varphi}_i), \quad i = 1, \dots, r. \quad (15)$$

We emphasize that, in contrast to the traditional VMS methodology, the 2S-DD-VMS-ROM framework allows *great flexibility* in choosing the *structure* of the closure term. For example, for the NSE, the approximation (13) becomes: $\forall i = 1, \dots, r$,

$$\begin{aligned} \text{VMS-ROM closure term} &= -[(\mathbf{u}_R \cdot \nabla) \mathbf{u}_R, \boldsymbol{\varphi}_i] - [(\mathbf{u}_r \cdot \nabla) \mathbf{u}_r, \boldsymbol{\varphi}_i] \\ &\approx (\mathbf{g}(\mathbf{u}_r), \boldsymbol{\varphi}_i) \\ &= (\tilde{A} \mathbf{a} + \mathbf{a}^\top \tilde{B} \mathbf{a})_i, \end{aligned}$$

where, for computational efficiency, we assume that the structures of \mathbf{g} and \mathbf{f} are similar. Thus, in the least squares problem (26), we solve for *all* the

entries in the $r \times r$ matrix \tilde{A} and the $r \times r \times r$ tensor \tilde{B} :

$$\min_{\tilde{A}, \tilde{B}} \sum_{j=1}^M \left\| - \left[\left((\mathbf{u}_R^{FOM}(t_j) \cdot \nabla) \mathbf{u}_R^{FOM}(t_j), \boldsymbol{\varphi}_i \right) \right. \right. \\ \left. \left. - \left((\mathbf{u}_r^{FOM}(t_j) \cdot \nabla) \mathbf{u}_r^{FOM}(t_j), \boldsymbol{\varphi}_i \right) \right] \right. \\ \left. - \left(\tilde{A} \mathbf{a}^{FOM}(t_j) + \mathbf{a}^{FOM}(t_j)^\top \tilde{B} \mathbf{a}^{FOM}(t_j) \right) \right\|^2, \quad (16)$$

where \mathbf{u}_R^{FOM} , \mathbf{u}_r^{FOM} , and \mathbf{a}^{FOM} are obtained from the available FOM data. Specifically, the values $\mathbf{a}^{FOM}(t_j)$, computed at snapshot time instances $t_j, j = 1, \dots, M$, are obtained by projecting the corresponding snapshots $\mathbf{u}(t_j)$ onto the ROM basis functions $\boldsymbol{\varphi}_i$ and using the orthogonality of the ROM basis functions: $\forall i = 1, \dots, R, \forall j = 1, \dots, M$,

$$a_i^{FOM}(t_j) = \left(\mathbf{u}(t_j), \boldsymbol{\varphi}_i \right). \quad (17)$$

In addition,

$$\mathbf{u}_R^{FOM}(t_j) = \sum_{k=1}^R a_k^{FOM}(t_j) \boldsymbol{\varphi}_k, \quad \mathbf{u}_r^{FOM}(t_j) = \sum_{k=1}^r a_k^{FOM}(t_j) \boldsymbol{\varphi}_k. \quad (18)$$

The least squares problem (16) is *low-dimensional* since, for a small r value, seeks the optimal $(r^2 + r^3)$ entries in \tilde{A} and \tilde{B} , respectively. Thus, (16) can be efficiently solved in the offline stage. For the NSE, the 2S-DD-VMS-ROM (15) takes the form

$$\dot{\mathbf{a}} = (A + \tilde{A})\mathbf{a} + \mathbf{a}^\top (B + \tilde{B})\mathbf{a}, \quad (19)$$

where A and B are the G-ROM operators in (10), and \tilde{A} and \tilde{B} are the VMS-ROM closure operators constructed in (16).

2.4. Three-Scale Data-Driven Variational Multiscale ROMs (3S-DD-VMS-ROM)

The 2S-DD-VMS-ROM (15) is based on the two-scale decomposition of $\mathbf{u}_R \in \mathbf{X}_1 \oplus \mathbf{X}_2$ into resolved and unresolved scales: $\mathbf{u}_R = \mathbf{u}_r + \mathbf{u}'$. The flexibility of the hierarchical structure of the ROM space allows a three-scale decomposition of \mathbf{u}_R , which yields a *three-scale data-driven VMS-ROM*

(3S-DD-VMS-ROM) that is more accurate than the 2S-DD-VMS-ROM (15). To construct the new 3S-DD-VMS-ROM, we first build three orthogonal spaces, \mathbf{X}_1 , \mathbf{X}_2 , and \mathbf{X}_3 : $\mathbf{X}_1 := \text{span}\{\boldsymbol{\varphi}_1, \dots, \boldsymbol{\varphi}_{r_1}\}$, which represents the *large resolved* ROM scales, $\mathbf{X}_2 := \text{span}\{\boldsymbol{\varphi}_{r_1+1}, \dots, \boldsymbol{\varphi}_r\}$, which represents the *small resolved* ROM scales, and $\mathbf{X}_3 := \text{span}\{\boldsymbol{\varphi}_{r+1}, \dots, \boldsymbol{\varphi}_R\}$, which represents the *unresolved* ROM scales. Next, we consider the best ROM approximation of \mathbf{u} in the space $\mathbf{X}_1 \oplus \mathbf{X}_2 \oplus \mathbf{X}_3$, i.e., $\mathbf{u}_R \in \mathbf{X}_1 \oplus \mathbf{X}_2 \oplus \mathbf{X}_3$ defined as

$$\begin{aligned} \mathbf{u}_R &= \sum_{j=1}^R a_j \boldsymbol{\varphi}_j \\ &= \sum_{j=1}^{r_1} a_j \boldsymbol{\varphi}_j + \sum_{j=r_1+1}^r a_j \boldsymbol{\varphi}_j + \sum_{j=r+1}^R a_j \boldsymbol{\varphi}_j \\ &= \mathbf{u}_L + \mathbf{u}_S + \mathbf{u}', \end{aligned} \tag{20}$$

where $\mathbf{u}_L \in \mathbf{X}_1$ represents the large resolved ROM component of \mathbf{u}_R , $\mathbf{u}_S \in \mathbf{X}_2$ represents the small resolved ROM component of \mathbf{u}_R , and $\mathbf{u}' \in \mathbf{X}_3$ represents the unresolved ROM component of \mathbf{u}_R . Thus, with the notation from Section 2.3, $\mathbf{u}_r = \mathbf{u}_L + \mathbf{u}_S$. We plug \mathbf{u}_R in (3), and project the resulting equation onto both \mathbf{X}_1 and \mathbf{X}_2 :

$$\begin{aligned} \left(\dot{\mathbf{u}}_L, \boldsymbol{\varphi}_i \right) &= \left(\mathbf{f}(\mathbf{u}_L + \mathbf{u}_S), \boldsymbol{\varphi}_i \right) + \boxed{\left[\left(\mathbf{f}(\mathbf{u}_R), \boldsymbol{\varphi}_i \right) - \left(\mathbf{f}(\mathbf{u}_L + \mathbf{u}_S), \boldsymbol{\varphi}_i \right) \right]}, \\ &\quad \forall i = 1, \dots, r_1, \end{aligned} \tag{21}$$

$$\begin{aligned} \left(\dot{\mathbf{u}}_S, \boldsymbol{\varphi}_i \right) &= \left(\mathbf{f}(\mathbf{u}_L + \mathbf{u}_S), \boldsymbol{\varphi}_i \right) + \boxed{\left[\left(\mathbf{f}(\mathbf{u}_R), \boldsymbol{\varphi}_i \right) - \left(\mathbf{f}(\mathbf{u}_L + \mathbf{u}_S), \boldsymbol{\varphi}_i \right) \right]}, \\ &\quad \forall i = r_1 + 1, \dots, r. \end{aligned} \tag{22}$$

The two boxed terms in (21)–(22) are the *VMS-ROM closure terms*, which have *fundamentally different roles*: The VMS-ROM closure term in (21) models the interaction between the large resolved ROM modes and the small resolved ROM modes; the VMS-ROM closure term in (22) models the interaction between the small resolved ROM modes and the unresolved ROM

modes. The new 3S-DD-VMS-ROM framework allows *great flexibility* in choosing the *structure* of the two VMS-ROM closure terms. For the NSE, we can use the following approximations:

$$\begin{aligned}
(\boldsymbol{\tau}_L)_i &:= -\left[\left((\mathbf{u}_R \cdot \nabla) \mathbf{u}_R, \boldsymbol{\varphi}_i\right) - \left((\mathbf{u}_L + \mathbf{u}_S) \cdot \nabla\right) (\mathbf{u}_L + \mathbf{u}_S), \boldsymbol{\varphi}_i\right] \\
&= \left(\tilde{A}_L \mathbf{a} + \mathbf{a}^\top \tilde{B}_L \mathbf{a}\right)_i, \quad \forall i = 1, \dots, r_1, \\
(\boldsymbol{\tau}_S)_i &:= -\left[\left((\mathbf{u}_R \cdot \nabla) \mathbf{u}_R, \boldsymbol{\varphi}_i\right) - \left((\mathbf{u}_L + \mathbf{u}_S) \cdot \nabla\right) (\mathbf{u}_L + \mathbf{u}_S), \boldsymbol{\varphi}_i\right] \\
&= \left(\tilde{A}_S \mathbf{a} + \mathbf{a}^\top \tilde{B}_S \mathbf{a}\right)_i \quad \forall i = r_1 + 1, \dots, r,
\end{aligned}$$

where $\tilde{A}_L \in \mathbb{R}^{r_1 \times r}$, $\tilde{A}_S \in \mathbb{R}^{(r-r_1) \times r}$, $\tilde{B}_L \in \mathbb{R}^{r_1 \times r \times r}$, and $\tilde{B}_S \in \mathbb{R}^{(r-r_1) \times r \times r}$. To determine the entries in \tilde{A}_L , \tilde{A}_S , \tilde{B}_L , and \tilde{B}_S , we solve two least squares problems:

$$\min_{\tilde{A}_L, \tilde{B}_L} \sum_{j=1}^M \left\| \boldsymbol{\tau}_L^{FOM} - \left(\tilde{A}_L \mathbf{a}^{FOM}(t_j) + \mathbf{a}^{FOM}(t_j)^\top \tilde{B}_L \mathbf{a}^{FOM}(t_j) \right) \right\|^2, \quad (23)$$

$$\min_{\tilde{A}_S, \tilde{B}_S} \sum_{j=1}^M \left\| \boldsymbol{\tau}_S^{FOM} - \left(\tilde{A}_S \mathbf{a}^{FOM}(t_j) + \mathbf{a}^{FOM}(t_j)^\top \tilde{B}_S \mathbf{a}^{FOM}(t_j) \right) \right\|^2, \quad (24)$$

where $\boldsymbol{\tau}_L^{FOM}$, $\boldsymbol{\tau}_S^{FOM}$, and \mathbf{a}^{FOM} are obtained from the available FOM data.

For the NSE, the *three-scale data-driven VMS-ROM (3S-DD-VMS-ROM)* is

$$\begin{bmatrix} \dot{\mathbf{a}}_L \\ \dot{\mathbf{a}}_S \end{bmatrix} = A \mathbf{a} + \mathbf{a}^\top B \mathbf{a} + \begin{bmatrix} \tilde{A}_L \mathbf{a} + \mathbf{a}^\top \tilde{B}_L \mathbf{a} \\ \tilde{A}_S \mathbf{a} + \mathbf{a}^\top \tilde{B}_S \mathbf{a} \end{bmatrix}, \quad (25)$$

where $\mathbf{a}^\top = [\mathbf{a}_L, \mathbf{a}_S]^\top$, A and B are the G-ROM operators in (10), and \tilde{A}_L , \tilde{A}_S , \tilde{B}_L , and \tilde{B}_S are the VMS-ROM closure operators constructed in (23)–(24). Compared to the 2S-DD-VMS-ROM, in the 3S-DD-VMS-ROM we have *more flexibility* in choosing the VMS-ROM closure operators \tilde{A}_L , \tilde{A}_S , \tilde{B}_L , and \tilde{B}_S in the least squares problems (23)–(24). For example, for \tilde{A}_L , \tilde{B}_L we can specify physical constraints, sparsity patterns, or regularization parameters, that are different from those for \tilde{A}_S , \tilde{B}_S . Because of this increased flexibility, we expect that the 3S-DD-VMS-ROM (25) is *more accurate* than the 2S-DD-VMS-ROM (19).

3. Numerical Results

In this section, we perform a numerical investigation of the new DD-VMS-ROM framework. As noted in Section 2, the 2S-DD-VMS-ROM (19) was investigated in [75] under the name “data-driven filtered ROM” and in [44, 46] under the name “data-driven correction ROM.” In [75], it was shown that the 2S-DD-VMS-ROM is more accurate than the standard G-ROM in the numerical simulation of 2D flow past a circular cylinder at Reynolds numbers $Re = 100$, $Re = 500$, and $Re = 1000$. Furthermore, the 2S-DD-VMS-ROM was more accurate and more efficient than other modern ROM closure models. In [46], it was shown that the 2S-DD-VMS-ROM is more accurate than the standard G-ROM in the numerical simulation of the quasi-geostrophic equations modeling the large scale ocean circulation.

Since the 2S-DD-VMS-ROM has already been shown to perform well, the focus of the current numerical investigation is on the new 3S-DD-VMS-ROM (25). Specifically, we investigate whether the 3S-DD-VMS-ROM is more accurate than the 2S-DDC-ROM. To this end, we consider two test cases: (i) the 1D viscous Burgers equation with viscosity coefficient $\nu = 10^{-3}$ (Section 3.2), and (ii) a 2D flow past a circular cylinder at Reynolds numbers $Re = 100$, $Re = 500$, and $Re = 1000$ (Section 3.3). For each test case, we investigate three ROMs: the 2S-DD-VMS-ROM (19), the new 3S-DD-VMS-ROM (25), and (for comparison purposes) the standard G-ROM (10). As a benchmark, we use the FOM results.

We test all the ROMs in three different regimes:

(i) *Reconstructive* regime: The ROM basis and ROM operators A and B are constructed from FOM data obtained on the time interval $[0, T_1]$, and then the resulting ROMs are tested on the *same* time interval $[0, T_1]$. To construct the DD-VMS-ROM operators \tilde{A} and \tilde{B} (for the 2S-DD-VMS-ROM) and $\tilde{A}_L, \tilde{A}_S, \tilde{B}_L$, and \tilde{B}_S (for the 3S-DD-VMS-ROM), we use different approaches for the two test cases: For the Burgers equation test case, we construct the DD-VMS-ROM operators by using FOM data from the entire time interval $[0, T_1]$. For the flow past a circular cylinder test case, for computational efficiency, we construct the DD-VMS-ROM operators from FOM data obtained on a shorter time interval, which does not significantly decrease the accuracy of the resulting DD-VMS-ROM. Specifically, we use FOM data for one period [75, 44], i.e., (i) from $t = 7$ to $t = 7.332$ for $Re = 100$, (ii) from $t = 7$ to $t = 7.442$ for $Re = 500$, and (iii) from $t = 13$ to $t = 13.268$ for $Re = 1000$.

(ii) *Cross-validation* regime: The ROM basis and ROM operators A and B are constructed from FOM data obtained on the time interval $[0, T_2]$, and then the resulting ROMs are tested on the time interval $[0, T_3]$, where $T_3 > T_2$. We note that the two time intervals are different, but they do overlap over $[0, T_2]$. To construct the DD-VMS-ROM operators, we use different approaches for the two test cases: For the Burgers equation test case, we construct the DD-VMS-ROM operators by using FOM data from the entire time interval $[0, T_2]$. For the flow past a circular cylinder test case, for computational efficiency, we construct the DD-VMS-ROM operators from FOM data for one period [75, 44].

(iii) *Predictive* regime: The ROM basis and ROM operators A and B are constructed from FOM data obtained on the time interval $[0, T_2]$, and then the resulting ROMs are tested on the time interval $[T_2, T_3]$, where $T_3 > T_2$. We emphasize that the two time intervals are completely different, without any overlap. To construct the DD-VMS-ROM operators, we use different approaches for the two test cases: For the Burgers equation test case, we construct the DD-VMS-ROM operators by using FOM data from the entire time interval $[0, T_2]$. For the flow past a circular cylinder test case, for computational efficiency, we construct the DD-VMS-ROM operators from FOM data for half a period [75, 44].

3.1. Computational Setting

In this section, we present the computational setting used in the numerical investigation.

First, as explained in detail on page B843 of [75], we rewrite the optimization problem (16) as the least squares problem

$$\min_{\mathbf{x} \in \mathbb{R}^{(r^2+r^3) \times 1}} \|\mathbf{f} - E\mathbf{x}\|^2, \quad (26)$$

where $\mathbf{x} \in \mathbb{R}^{(r^2+r^3) \times 1}$ contains all the entries of \tilde{A} and \tilde{B} , and the vector $\mathbf{f} \in \mathbb{R}^{(Mr) \times 1}$ and matrix $E \in \mathbb{R}^{(Mr) \times (r^2+r^3)}$ are computed from \mathbf{u}_R^{FOM} , \mathbf{u}_r^{FOM} , and \mathbf{a}^{FOM} (see (4.8) in [75]). The optimal \tilde{A} and \tilde{B} (i.e., the entries in \mathbf{x} that solves the linear least squares problem (26)) are used to build the 2S-DD-VMS-ROM (19).

Furthermore, as explained on page B843 of [75], the least squares problem (26) is ill-conditioned. This ill-conditioning is common in data-driven least squares problems (see, e.g., [53]). To alleviate this ill-conditioning, we use the truncated singular value decomposition (SVD) [44, 75].

The algorithm for the 2S-DD-VMS-ROM (19) is presented in Algorithm 1. In most of our numerical experiments, we choose the optimal tolerance tol in the truncated SVD step of Algorithm 1. Specifically, for each value $1 \leq m \leq R$ (where R is the dimension of the snapshot matrix), we consider the truncated SVD approximation of dimension m , construct the operators \tilde{A}_m and \tilde{B}_m , integrate the resulting 2S-DD-VMS-ROM in (30), and choose the \tilde{m} value yielding the lowest L^2 error. The only exception is in some of the numerical experiments for the Burgers equation (Section 3.2.1), where we fix $tol = tol_L$ or $tol = tol_S$ (see Tables 2–8).

Algorithm 1: 2S-DD-VMS-ROM

- 1: Use all the entries of \tilde{A} and \tilde{B} in (19) to define vector of unknowns, \mathbf{x} .
- 2: Use \mathbf{u}_R^{FOM} , \mathbf{u}_r^{FOM} , and \mathbf{a}^{FOM} to assemble the vector \mathbf{f} and matrix E in (26).
- 3: Use the truncated SVD algorithm to solve the linear least squares problem (26).

- (i) Calculate the SVD of E :

$$E = U \Sigma V^\top, \quad (27)$$

where the rank of matrix $E(\Sigma)$ is \mathcal{M} .

- (ii) Specify tolerance $tol = \sigma_i, i = 1, \dots, \mathcal{M}$.
- (iii) Construct matrix $\hat{\Sigma}^m$ from Σ as follows: $\hat{\sigma}_m = \sigma_m$ if $\sigma_m \geq tol$, $m = 1, \dots, \mathcal{M}$.
- (iv) Construct \hat{E}^m , the truncated SVD of E :

$$\hat{E}^m = \hat{U}^m \hat{\Sigma}^m (\hat{V}^m)^\top, \quad (28)$$

where \hat{U}^m and \hat{V}^m are the entries of U and V in (27) that correspond to $\hat{\Sigma}^m$.

- (v) The solution of the least squares problem (26) is

$$\mathbf{x} = \left(\hat{V}^m (\hat{\Sigma}^m)^{-1} (\hat{U}^m)^\top \right) \mathbf{f}. \quad (29)$$

- 4: The 2S-DD-VMS-ROM (19) has the following form:

$$\boxed{\dot{\mathbf{a}} = \left(A + \tilde{A}^m \right) \mathbf{a} + \mathbf{a}^\top \left(B + \tilde{B}^m \right) \mathbf{a}}, \quad (30)$$

where \tilde{A}^m and \tilde{B}^m are the appropriate entries of \mathbf{x} found in (29) with $tol = \sigma_m$.

- 5: Integrate the resulting 2S-DD-VMS-ROM in (19) over the given time domain and calculate the average L^2 error $\mathcal{E}^m(L^2)$ by using formula (36). The optimal \tilde{m} value (the optimal operators \tilde{A} and \tilde{B}) is found by solving the following minimization problem:

$$\mathcal{E}^{\tilde{m}}(L^2) = \min_{1 \leq m \leq R} \mathcal{E}^m(L^2). \quad (31)$$

The algorithm for the 3S-DD-VMS-ROM (25) is the same as Algorithm 1, except that we are using two different truncated SVDs to solve two different linear least squares problems, which correspond to the large and small resolved scales. Thus, we have two different control parameters, tol_L and tol_S . Similar to the 2S-DD-VMS-ROM, we rewrite the optimization problems (23) and (24) as the least squares problems

$$\min_{\mathbf{x}_L \in \mathbb{R}^{[r_1(r+r^2)] \times 1}} \|\mathbf{f}_L - E_L \mathbf{x}_L\|^2, \quad (32)$$

$$\min_{\mathbf{x} \in \mathbb{R}^{[(r-r_1)(r+r^2)] \times 1}} \|\mathbf{f}_S - E_S \mathbf{x}\|^2, \quad (33)$$

where $\mathbf{x}_L \in \mathbb{R}^{[r_1(r+r^2)] \times 1}$ contains all the entries of the operators \tilde{A}_L and \tilde{B}_L , $\mathbf{x}_S \in \mathbb{R}^{[(r-r_1)(r+r^2)] \times 1}$ contains all the entries of the operators \tilde{A}_S and \tilde{B}_S , and the vectors $\mathbf{f}_L \in \mathbb{R}^{(M r_1) \times 1}$, $\mathbf{f}_S \in \mathbb{R}^{(M(r-r_1)) \times 1}$ and the matrices $E_L \in \mathbb{R}^{(M r_1) \times (r_1(r+r^2))}$, $E_S \in \mathbb{R}^{(M(r-r_1)) \times ((r-r_1)(r+r^2))}$ are computed from \mathbf{u}_R^{FOM} , \mathbf{u}_r^{FOM} , and \mathbf{a}^{FOM} (see (4.8) in [75]). The optimal \tilde{A}_L , \tilde{B}_L and \tilde{A}_S , \tilde{B}_S (i.e., the entries in \mathbf{x}_L and \mathbf{x}_S that solve the linear least squares problems (32) and (33)) are used to build the 3S-DD-VMS-ROM (25). Again, to address the ill-conditioning of the least squares problems (32)–(33), we use the truncated SVD algorithm. The algorithm for the 3S-DD-VMS-ROM (25) is presented in Algorithm 2. We note that, if $tol_L = tol_S = tol$, the 2S-DD-VMS-ROM and 3S-DD-VMS-ROM yield the same results, since we solve the same minimization problem. Thus, the interesting case is when tol_L and/or tol_S are different from tol .

Algorithm 2: 3S-DD-VMS-ROM

- 1: Choose $r_1, 1 \leq r_1 < r$, and use all the entries of \tilde{A}_L and \tilde{B}_L as well as \tilde{A}_S and \tilde{B}_S in (25) to define vectors of unknowns, \mathbf{x}_L and \mathbf{x}_S , respectively.
- 2: Use $\mathbf{u}_R^{FOM}, \mathbf{u}_r^{FOM}$, and \mathbf{a}^{FOM} to assemble the vectors \mathbf{f}_L and \mathbf{f}_S , and the matrices E_L and E_S in (32) and (33).
- 3: Use the truncated SVD algorithm to solve the linear least squares problems (32) and (33).

(i) Calculate the SVD of E_L and E_S :

$$E_L = U_L \Sigma_L V_L^\top, \quad E_S = U_S \Sigma_S V_S^\top. \quad (34)$$

- (ii) Specify tolerances $tol_L = \sigma_{L,i}, i = 1, \dots, \mathcal{M}_L$, and $tol_S = \sigma_{S,j}, j = 1, \dots, \mathcal{M}_S$, where \mathcal{M}_L is the rank of Σ_L (E_L) and \mathcal{M}_S is the rank of Σ_S (E_S).
 - (iii) Construct matrix $\hat{\Sigma}_L^m$ from Σ_L as follows: $\hat{\sigma}_{L,m_L} = \sigma_{m_L}$ if $\sigma_{m_L} \geq tol_L, m_L = 1, \dots, \mathcal{M}_L$; construct matrix $\hat{\Sigma}_L^m$ from Σ_L as follows: $\hat{\sigma}_{S,m_L} = \sigma_{m_S}$ if $\sigma_{m_S} \geq tol_S, m_S = 1, \dots, \mathcal{M}_S$.
 - (iv) Construct $\hat{E}_L^{m_L}$ and $\hat{E}_S^{m_S}$ with the truncated SVD of E_L and E_S .
 - (v) Construct the operators $\tilde{A}_L^{m_L}$ and $\tilde{B}_L^{m_L}$ as well as $\tilde{A}_S^{m_S}$ and $\tilde{B}_S^{m_S}$.
 - (vi) Integrate the resulting 3S-DD-VMS-ROM in (25) over the given time domain and calculate the average L^2 error $\mathcal{E}^{r_1, m_L, m_S}(L^2)$ by using formula (36).
- 4: Find the optimal \tilde{r}_1, \tilde{m}_L and \tilde{m}_S values (i.e., the optimal operators \tilde{A}_L, \tilde{B}_L and \tilde{A}_S, \tilde{B}_S corresponding to the optimal r_1) by solving the following minimization problem:

$$\mathcal{E}^{\tilde{r}_1, \tilde{m}_L, \tilde{m}_S}(L^2) = \min_{\substack{1 \leq r_1 < r \\ 1 \leq m_L \leq \mathcal{M}_L \\ 1 \leq m_S \leq \mathcal{M}_S}} \mathcal{E}^{r_1, m_L, m_S}(L^2). \quad (35)$$

The focus of the current numerical investigation is on the numerical accuracy of the new DD-VMS-ROMs. Thus, we use all the available data to build the DD-VMS-ROM operators. We emphasize, however, that the computational cost of the construction of the DD-VMS-ROM operators can be

significantly decreased by using the approach proposed on page B848 in [75]. We intend to investigate this approach in a future study.

To compare the ROMs' performance, in both tests, we use the following error metric:

$$\text{average } L^2 \text{ norm: } \mathcal{E}(L^2) = \frac{1}{M} \sum_{j=1}^M \left\| \mathbf{u}_r(t_j) - \sum_{i=1}^r (\mathbf{u}^{\text{DNS}}(t_j), \varphi_i) \varphi_i \right\|_{L^2}. \quad (36)$$

In the flow past a circular cylinder test case, we also plot the time evolution of the ROM kinetic energy.

3.2. Burgers Equation

In this section, we investigate the 2S-DD-VMS-ROM (19) and the new 3S-DD-VMS-ROM (25) in the numerical simulation of the one-dimensional viscous Burgers equation:

$$\begin{cases} u_t - \nu u_{xx} + uu_x = 0, & x \in [0, 1], t \in [0, 1], \\ u(0, t) = u(1, t) = 0, & t \in [0, 1], \end{cases} \quad (37)$$

with the initial condition

$$u_0(x) = \begin{cases} 1, & x \in (0, 1/2], \\ 0, & x \in (1/2, 1], \end{cases} \quad (38)$$

and $\nu = 10^{-3}$. This test problem has been used in [1, 32, 37, 75].

Snapshot Generation. We generate the FOM results by using a linear FE spatial discretization with mesh size $h = 1/2048$ and a Crank-Nicolson time discretization with timestep size $\Delta t = 10^{-3}$.

ROM Construction. We run the FOM from $t = 0$ to $t = 1$. To generate the ROM basis functions, we collect a total of 1000 snapshots for the reconstructive regime, and 700 snapshots for the cross-validation and predictive regimes. These snapshots are the solutions from $t = 0$ to $t = 1$ for the reconstructive regime, and $t = 0$ to $t = 0.7$ for the cross-validation and predictive regimes. To train \tilde{A} , \tilde{B} (for the 2S-DD-VMS-ROM) and \tilde{A}_L , \tilde{B}_L and \tilde{A}_S , \tilde{B}_S (for the 3S-DD-VMS-ROM), we use FOM data on the time interval $[0, 1]$ for the reconstructive regime, and FOM data on the time interval $[0, 0.7]$ for the cross-validation and predictive regimes. We test all the ROMs on the time interval $[0, 1]$ for the reconstructive and cross-validation regimes, and $[0.7, 1]$ for the predictive regime.

Implementation Details. To implement the 2S-DD-VMS-ROM (30), we use Algorithm 1. To implement the 3S-DD-VMS-ROM (25), we use Algorithm 2. For a fair comparison of the 2S-DD-VMS-ROM with the 3S-DD-VMS-ROM, we choose optimal tolerances in the two algorithms, i.e., optimal tol in Algorithm 1 and optimal tol_L and tol_s in Algorithm 2. We also investigate whether there is any relationship between the 2S-DD-VMS-ROM tolerance and the 3S-DD-VMS-ROM tolerances. To this end, we perform two sets of numerical experiments: (a) In the first set of experiments, we fix tol in the 2S-DD-VMS-ROM, choose $tol_L = tol$ in the 3S-DD-VMS-ROM, and search the optimal tol_s in the 3S-DD-VMS-ROM. (b) In the second set of experiments, we fix tol in the 2S-DD-VMS-ROM, choose $tol_s = tol$ in the 3S-DD-VMS-ROM, and search the optimal tol_L in the 3S-DD-VMS-ROM.

3.2.1. Numerical Results

In this section, we present numerical results for the Burgers equation (37) with $\nu = 10^{-3}$ in the reconstructive, cross-validation, and predictive regimes. In all the tables, we list the average L^2 error (36) for the G-ROM, the 2S-DD-VMS-ROM, and the new 3S-DD-VMS-ROM. We also list the tolerances used in the truncated SVD algorithm for the 2S-DD-VMS-ROM and 3S-DD-VMS-ROM, as well as the r_1 values for the 3S-DD-VMS-ROM.

In Table 1, we list the ROMs errors for the reconstructive regime with optimal tol in Algorithm 1 and optimal tol_L and tol_s in Algorithm 2. These results show that, for all r values, the 2S-DD-VMS-ROM and 3S-DD-VMS-ROM are several times (sometimes one or even two orders of magnitude) more accurate than the standard G-ROM. Overall, the 3S-DD-VMS-ROM is more accurate than the 2S-DD-VMS-ROM. For example, for $r = 7$, the 3S-DD-VMS-ROM is more than twice more accurate than the 2S-DD-VMS-ROM. We also note that, for low r values, the ROM errors do not seem to converge monotonically. We emphasize, however, that for large r values, we recover the expected asymptotic convergence.

In Figure 1, we plot the time evolution of the solutions for the DNS projection, G-ROM, 2S-DD-VMS-ROM, and 3S-DD-VMS-ROM for the reconstructive regime. These plots show that both the 2S-DD-VMS-ROM and the 3S-DD-VMS-ROM are significantly more accurate than the standard G-ROM, as indicated by the results in Table 1.

| r | G-ROM | 2S-DD-VMS-ROM | | 3S-DD-VMS-ROM | | | |
|-----|--------------------|---------------|--------------------|---------------|---------|---------|--------------------|
| | $\mathcal{E}(L^2)$ | tol | $\mathcal{E}(L^2)$ | r_1 | tol_S | tol_L | $\mathcal{E}(L^2)$ |
| 3 | 1.181e-01 | 1e-02 | 1.548e-03 | 1 | 1e-02 | 1e-02 | 1.548e-03 |
| 7 | 1.828e-01 | 1e-04 | 3.542e-03 | 4 | 1e-02 | 1e-04 | 1.688e-03 |
| 11 | 1.258e-01 | 1e-02 | 2.213e-03 | 4 | 1e-02 | 1e-04 | 1.675e-03 |
| 17 | 6.551e-02 | 1e-02 | 2.312e-03 | 4 | 1e-02 | 1e-04 | 1.971e-03 |

Table 1: Burgers equation, $\nu = 10^{-3}$, reconstructive regime, optimal tol , tol_S , and tol_L . Average L^2 error for G-ROM, 2S-DD-VMS-ROM, and 3S-DD-VMS-ROM for different r values.

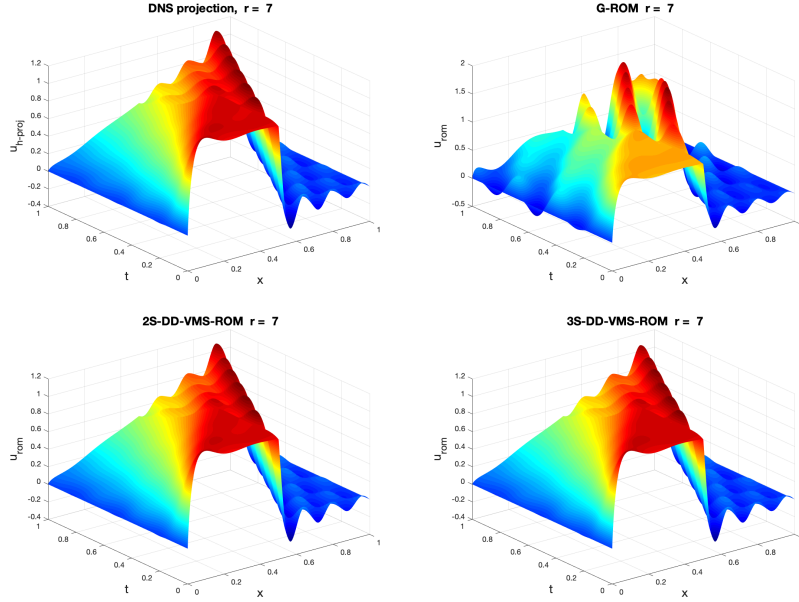

Figure 1: Burgers equation, $\nu = 10^{-3}$, reconstructive regime. DNS projection, G-ROM, 2S-DD-VMS-DDC-ROM, and 3S-DD-VMS-DDC-ROM plots for $r = 7$.

In Tables 2, 3, 4, and 5, we list the ROMs errors for the reconstructive regime with fixed tol in the 2S-DD-VMS-ROM, and $tol_L = tol$ and optimal tol_S in the 3S-DD-VMS-ROM. We also list the optimal value of tol_S . We consider the following values for $tol_L = tol$: 10^2 (Table 2), 10^1 (Table 3), 10^0 (Table 4), and 10^{-1} (Table 5). These results yield the following conclusions: For large $tol_L = tol$ values (i.e., 10^2 and 10^1), the 2S-DD-VMS-ROM is slightly more or as accurate as the G-ROM, whereas the 3S-DD-VMS-ROM is several times (and sometimes more than one order of magnitude) more accurate than the G-ROM and 2S-DD-VMS-ROM. For small $tol_L = tol$ values (i.e., 10^0 and 10^{-1}), the 2S-DD-VMS-ROM is several times (and sometimes more than one order of magnitude) more accurate than the G-ROM. Even in these cases, however, the 3S-DD-VMS-ROM is several times (and sometimes more than one order of magnitude) more accurate than the 2S-DD-VMS-ROM. Overall, the 3S-DD-VMS-ROM is by far the most accurate ROM.

| r | G-ROM | 2S-DD-VMS-ROM | 3S-DD-VMS-ROM | | |
|-----|--------------------|--------------------|---------------|---------|--------------------|
| | $\mathcal{E}(L^2)$ | $\mathcal{E}(L^2)$ | r_1 | tol_S | $\mathcal{E}(L^2)$ |
| 3 | 1.181e-01 | 1.181e-01 | 1 | 1e+00 | 1.609e-02 |
| 7 | 1.828e-01 | 1.828e-01 | 1 | 1e-01 | 6.241e-03 |
| 11 | 1.258e-01 | 1.258e-01 | 1 | 1e-01 | 4.955e-03 |
| 17 | 6.551e-02 | 6.551e-02 | 1 | 1e-02 | 2.826e-03 |

Table 2: Burgers equation, $\nu = 10^{-3}$, reconstructive regime, $tol = tol_L = 10^2$, and optimal tol_S . Average L^2 error for G-ROM, 2S-DD-VMS-ROM, and 3S-DD-VMS-ROM for different r values.

| r | G-ROM | 2S-DD-VMS-ROM | 3S-DD-VMS-ROM | | |
|-----|--------------------|--------------------|---------------|---------|--------------------|
| | $\mathcal{E}(L^2)$ | $\mathcal{E}(L^2)$ | r_1 | tol_S | $\mathcal{E}(L^2)$ |
| 3 | 1.181e-01 | 7.278e-02 | 1 | 1e+00 | 1.322e-02 |
| 7 | 1.828e-01 | 1.755e-01 | 2 | 1e-03 | 3.915e-03 |
| 11 | 1.258e-01 | 1.229e-01 | 1 | 1e-03 | 1.787e-03 |
| 17 | 6.551e-02 | 6.456e-02 | 1 | 1e-02 | 2.310e-03 |

Table 3: Burgers equation, $\nu = 10^{-3}$, reconstructive regime, $tol = tol_L = 10^1$, and optimal tol_S . Average L^2 error for G-ROM, 2S-DD-VMS-ROM, and 3S-DD-VMS-ROM for different r values.

| r | G-ROM | 2S-DD-VMS-ROM | 3S-DD-VMS-ROM | | |
|-----|--------------------|--------------------|---------------|---------|--------------------|
| | $\mathcal{E}(L^2)$ | $\mathcal{E}(L^2)$ | r_1 | tol_S | $\mathcal{E}(L^2)$ |
| 3 | 1.181e-01 | 1.333e-01 | 1 | 1e-02 | 5.292e-03 |
| 7 | 1.828e-01 | 2.590e-02 | 2 | 1e-03 | 3.549e-03 |
| 11 | 1.258e-01 | 3.607e-02 | 2 | 1e-02 | 2.045e-03 |
| 17 | 6.551e-02 | 5.029e-02 | 5 | 1e-02 | 2.237e-03 |

Table 4: Burgers equation, $\nu = 10^{-3}$, reconstructive regime, $tol = tol_L = 10^0$, and optimal tol_S . Average L^2 error for G-ROM, 2S-DD-VMS-ROM, and 3S-DD-VMS-ROM for different r values.

| r | G-ROM | 2S-DD-VMS-ROM | 3S-DD-VMS-ROM | | |
|-----|--------------------|--------------------|---------------|---------|--------------------|
| | $\mathcal{E}(L^2)$ | $\mathcal{E}(L^2)$ | r_1 | tol_S | $\mathcal{E}(L^2)$ |
| 3 | 1.181e-01 | 3.729e-03 | 1 | 1e-02 | 2.061e-03 |
| 7 | 1.828e-01 | 4.232e-03 | 4 | 1e-03 | 2.557e-03 |
| 11 | 1.258e-01 | 4.556e-03 | 2 | 1e-02 | 2.086e-03 |
| 17 | 6.551e-02 | 5.962e-03 | 5 | 1e-02 | 2.255e-03 |

Table 5: Burgers equation, $\nu = 10^{-3}$, reconstructive regime $tol = tol_L = 10^{-1}$, and optimal tol_S . Average L^2 error for G-ROM, 2S-DD-VMS-ROM, and 3S-DD-VMS-ROM for different r values.

In Tables 6, 7, and 8, we list the ROMs errors for the reconstructive regime with fixed tol in the 2S-DD-VMS-ROM, and $tol_S = tol$ and optimal tol_L in the 3S-DD-VMS-ROM. We also list the optimal value of tol_L . We consider the following values for $tol_S = tol$: 10^0 (Table 6), 10^{-1} (Table 7), and 10^{-2} (Table 8). These results yield the following conclusions: For all $tol_L = tol$ values and all r values, the 2S-DD-VMS-ROM is several times (and sometimes more than one order of magnitude) more accurate than the G-ROM. Furthermore, the 3S-DD-VMS-ROM is significantly (and sometimes several times) more accurate than the 2S-DD-VMS-ROM. Overall, the 3S-DD-VMS-ROM is the most accurate ROM.

The results in Tables 2–8 suggest that there is no apparent relationship between the 2S-DD-VMS-ROM tolerance tol and the 3S-DD-VMS-ROM tolerances tol_L and tol_S . We intend to perform a more thorough investigation of potential relationships among these tolerances in a future study.

In Table 9, we list the ROMs errors for the cross-validation regime with optimal tol in Algorithm 1 and optimal tol_L and tol_S in Algorithm 2. These

| r | G-ROM | 2S-DD-VMS-ROM | 3S-DD-VMS-ROM | | |
|-----|--------------------|--------------------|---------------|---------|--------------------|
| | $\mathcal{E}(L^2)$ | $\mathcal{E}(L^2)$ | r_1 | tol_L | $\mathcal{E}(L^2)$ |
| 3 | 1.181e-01 | 1.133e-02 | 2 | 1e-01 | 8.085e-03 |
| 7 | 1.828e-01 | 2.590e-02 | 6 | 1e-03 | 1.762e-02 |
| 11 | 1.258e-01 | 3.607e-02 | 10 | 1e-02 | 2.390e-02 |
| 17 | 6.551e-02 | 5.029e-02 | 16 | 1e-02 | 1.486e-02 |

Table 6: Burgers equation, $\nu = 10^{-3}$, reconstructive regime: $tol = tol_S = 10^0$ and optimal tol_L . Average L^2 error for G-ROM, 2S-DD-VMS-ROM, and 3S-DD-VMS-ROM for different r values.

| r | G-ROM | 2S-DD-VMS-ROM | 3S-DD-VMS-ROM | | |
|-----|--------------------|--------------------|---------------|---------|--------------------|
| | $\mathcal{E}(L^2)$ | $\mathcal{E}(L^2)$ | r_1 | tol_L | $\mathcal{E}(L^2)$ |
| 3 | 1.181e-01 | 3.729e-03 | 2 | 1e-02 | 2.568e-03 |
| 7 | 1.828e-01 | 4.232e-03 | 4 | 1e-03 | 3.678e-03 |
| 11 | 1.258e-01 | 4.556e-03 | 10 | 1e-02 | 3.995e-03 |
| 17 | 6.551e-02 | 5.962e-03 | 16 | 1e-02 | 2.995e-03 |

Table 7: Burgers equation, $\nu = 10^{-3}$, reconstructive regime: $tol = tol_S = 10^{-1}$ and optimal tol_L . Average L^2 error for G-ROM, 2S-DD-VMS-ROM, and 3S-DD-VMS-ROM for different r values.

| r | G-ROM | 2S-DD-VMS-ROM | 3S-DD-VMS-ROM | | |
|-----|--------------------|--------------------|---------------|---------|--------------------|
| | $\mathcal{E}(L^2)$ | $\mathcal{E}(L^2)$ | r_1 | tol_L | $\mathcal{E}(L^2)$ |
| 3 | 1.181e-01 | 1.548e-03 | 1 | 1e-02 | 1.548e-03 |
| 7 | 1.828e-01 | 1.062e-02 | 4 | 1e-04 | 1.688e-03 |
| 11 | 1.258e-01 | 2.213e-03 | 4 | 1e-04 | 1.675e-03 |
| 17 | 6.551e-02 | 2.312e-03 | 4 | 1e-04 | 1.974e-03 |

Table 8: Burgers equation, $\nu = 10^{-3}$, reconstructive regime: $tol = tol_S = 10^{-2}$ and optimal tol_L . Average L^2 error for G-ROM, 2S-DD-VMS-ROM, and 3S-DD-VMS-ROM for different r values.

results show that, for all r values, the 2S-DD-VMS-ROM and 3S-DD-VMS-ROM are several times (sometimes even one order of magnitude) more accurate than the standard G-ROM. Overall, the 3S-DD-VMS-ROM is more accurate than the 2S-DD-VMS-ROM.

In Table 10, we list the ROMs errors for the predictive regime with opti-

| r | G-ROM | 2S-DD-VMS-ROM | | 3S-DD-VMS-ROM | | | |
|-----|--------------------|---------------|--------------------|---------------|---------|---------|--------------------|
| | $\mathcal{E}(L^2)$ | tol | $\mathcal{E}(L^2)$ | r_1 | tol_S | tol_L | $\mathcal{E}(L^2)$ |
| 3 | 2.015e-01 | 1e-01 | 2.028e-02 | 2 | 1e-01 | 1e+00 | 1.863e-02 |
| 7 | 1.796e-01 | 5e-02 | 1.400e-02 | 3 | 5e-02 | 1e+00 | 1.188e-02 |
| 11 | 1.163e-01 | 3e-02 | 8.981e-03 | 6 | 3e-02 | 1e+00 | 8.383e-03 |
| 17 | 6.897e-02 | 1e-02 | 8.542e-03 | 6 | 1e-02 | 1e+00 | 8.452e-03 |

Table 9: Burgers equation, $\nu = 10^{-3}$, cross-validation regime, optimal tol , tol_S , and tol_L . Average L^2 error for G-ROM, 2S-DD-VMS-ROM, and 3S-DD-VMS-ROM for different r values.

mal tol in Algorithm 1 and optimal tol_L and tol_s in Algorithm 2. These results show that, for all r values, the 2S-DD-VMS-ROM and 3S-DD-VMS-ROM are several times (sometimes even one order of magnitude) more accurate than the standard G-ROM. Overall, the 3S-DD-VMS-ROM is more accurate than the 2S-DD-VMS-ROM.

| r | G-ROM | 2S-DD-VMS-ROM | | 3S-DD-VMS-ROM | | | |
|-----|--------------------|---------------|--------------------|---------------|---------|---------|--------------------|
| | $\mathcal{E}(L^2)$ | tol | $\mathcal{E}(L^2)$ | r_1 | tol_S | tol_L | $\mathcal{E}(L^2)$ |
| 3 | 2.185e-01 | 1e-01 | 3.623e-02 | 2 | 1e-01 | 1e+00 | 3.029e-02 |
| 7 | 2.054e-01 | 3e-02 | 2.004e-02 | 6 | 5e-02 | 3e-02 | 1.428e-02 |
| 11 | 1.620e-01 | 3e-02 | 1.608e-02 | 10 | 5e-02 | 3e-02 | 1.418e-02 |
| 17 | 1.103e-01 | 1e-02 | 1.524e-02 | 6 | 1e-02 | 1e-01 | 1.506e-02 |

Table 10: Burgers equation, $\nu = 10^{-3}$, predictive regime, optimal tol , tol_S , and tol_L . Average L^2 error for G-ROM, 2S-DD-VMS-ROM, and 3S-DD-VMS-ROM for different r values.

3.3. Flow Past A Cylinder

In this section, we investigate the 2S-DD-VMS-ROM (19) and the new 3S-DD-VMS-ROM (25) in the numerical simulation of a 2D channel flow past a circular cylinder at Reynolds numbers $Re = 100$, $Re = 500$, and $Re = 1000$.

Computational Setting. As a mathematical model, we use the NSE (8)–(9). The computational domain is a 2.2×0.41 rectangular channel with a radius $= 0.05$ cylinder, centered at $(0.2, 0.2)$, see Fig. 2.

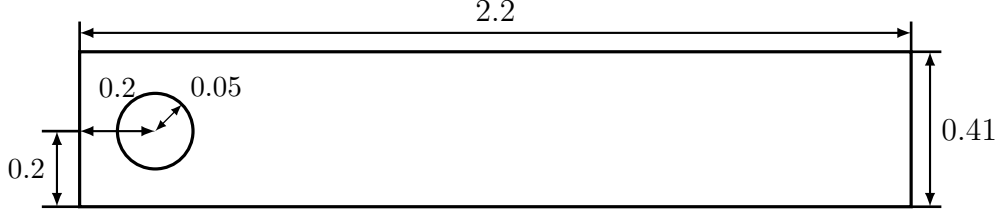

Figure 2: Geometry of the flow past a circular cylinder numerical experiment.

We prescribe no-slip boundary conditions on the walls and cylinder, and the following inflow and outflow profiles [34, 44, 45, 58]:

$$u_1(0, y, t) = u_1(2.2, y, t) = \frac{6}{0.41^2} y(0.41 - y), \quad (39)$$

$$u_2(0, y, t) = u_2(2.2, y, t) = 0, \quad (40)$$

where $\mathbf{u} = \langle u_1, u_2 \rangle$. There is no forcing and the flow starts from rest.

Snapshot Generation. For the spatial discretization, we use the pointwise divergence-free, LBB stable (P_2, P_1^{disc}) Scott-Vogelius finite element pair on a barycenter refined regular triangular mesh [36]. The mesh provides $103K$ (102962) velocity and $76K$ (76725) pressure degrees of freedom. We utilize the commonly used linearized BDF2 temporal discretization and a time step size $\Delta t = 0.002$ for both FOM and ROM time discretizations. On the first time step, we use a backward Euler scheme so that we have two initial time step solutions required for the BDF2 scheme.

ROM Construction. The FOM simulations achieve the statistically steady state at different time instances for the three Reynolds numbers used in the numerical investigation: For $Re = 100$, after $t = 5s$; for $Re = 500$, after $t = 7s$; and for $Re = 1000$, after $t = 13s$. To build the ROM basis functions, we decided to use $10s$ of FOM data. Thus, to ensure a fair comparison of the numerical results at different Reynolds numbers, we collect FOM snapshots on the following time intervals: For $Re = 100$, from $t = 7$ to $t = 17$; for $Re = 500$, from $t = 7$ to $t = 17$; and for $Re = 1000$, from $t = 13$ to $t = 23$.

To train \tilde{A}, \tilde{B} (for the 2S-DD-VMS-ROM) and \tilde{A}_L, \tilde{B}_L and \tilde{A}_S, \tilde{B}_S (for the 3S-DD-VMS-ROM), we use FOM data for one period in the reconstructive and cross-validation regimes, and FOM data for half a period in the predictive regime. We note that the period length of the statistically steady state is

different for the three different Reynolds numbers: From $t = 7$ to $t = 7.332$ for $Re = 100$; from $t = 7$ to $t = 7.442$ for $Re = 500$; and from $t = 13$ to $t = 13.268$ for $Re = 1000$. Thus, the reconstructive and cross-validation regimes, we collect 167 snapshots for $Re = 100$; 222 snapshots for $Re = 500$; and 135 snapshots for $Re = 1000$. For the predictive regime, we collect 84 snapshots for $Re = 100$; 111 snapshots for $Re = 500$; and 68 snapshots for $Re = 1000$.

3.3.1. Numerical Results for $Re = 100$

In this section, we present numerical results for the flow past a cylinder at $Re = 100$.

In Table 11, for different r values, we list the average L^2 error (36) for the G-ROM, the 2S-DD-VMS-ROM, and the new 3S-DD-VMS-ROM in the reconstructive regime. We also list the r_1 values for the 3S-DD-VMS-ROM. These results show that, for all r values, the 2S-DD-VMS-ROM and 3S-DD-VMS-ROM are several times (sometimes one and even two orders of magnitude) more accurate than the standard G-ROM. Furthermore, the 3S-DD-VMS-ROM is generally more accurate than the 2S-DD-VMS-ROM, especially for large r values: For example, for $r = 8$, the 3S-DD-VMS-ROM is *more than twice more accurate* than the 2S-DD-VMS-ROM. We also note that the ROM errors in Table 11 converge to 0 according to an even/odd pattern: The ROM errors for even r values converge to 0 and the ROM errors for odd r values also converge to 0. This behavior is related to the flow past a cylinder configuration, in which the ROM modes appear in pairs. We emphasize, however, that for large r values, we recover the asymptotic convergence that does not depend on the odd/even r values, just as in the Burgers equation test case (Section 3.2.1).

In Table 12, for different r values, we list the average L^2 error (36) for the G-ROM, the 2S-DD-VMS-ROM, and the new 3S-DD-VMS-ROM in the cross-validation regime. These results show that, for all r values, the 2S-DD-VMS-ROM and 3S-DD-VMS-ROM are several times (sometimes even two orders of magnitude) more accurate than the standard G-ROM. Furthermore, the 3S-DD-VMS-ROM is generally more accurate than the 2S-DD-VMS-ROM, especially for large r values: For example, for $r = 8$, the 3S-DD-VMS-ROM is *almost three times more accurate* than the 2S-DD-VMS-ROM.

In Table 13, for different r values, we list the average L^2 error (36) for the G-ROM, the 2S-DD-VMS-ROM, and the new 3S-DD-VMS-ROM in the

| r | G-ROM | 2S-DD-VMS-ROM | 3S-DD-VMS-ROM | |
|-----|--------------------|--------------------|---------------|--------------------|
| | $\mathcal{E}(L^2)$ | $\mathcal{E}(L^2)$ | r_1 | $\mathcal{E}(L^2)$ |
| 2 | 9.902e-02 | 5.118e-04 | 1 | 5.088e-04 |
| 3 | 1.029e-01 | 3.208e-02 | 2 | 3.018e-02 |
| 4 | 5.840e-02 | 1.553e-03 | 2 | 1.479e-03 |
| 5 | 6.492e-02 | 2.270e-02 | 4 | 2.191e-02 |
| 6 | 1.370e-02 | 5.336e-04 | 1 | 4.804e-04 |
| 7 | 1.403e-02 | 6.038e-03 | 6 | 5.817e-03 |
| 8 | 1.214e-02 | 9.302e-04 | 6 | 4.415e-04 |

Table 11: Flow past a cylinder, $Re = 100$, reconstructive regime. Average L^2 errors for G-ROM, 2S-DD-VMS-ROM, and 3S-DD-VMS-ROM for different r values.

| r | G-ROM | 2S-DD-VMS-ROM | 3S-DD-VMS-ROM | |
|-----|--------------------|--------------------|---------------|--------------------|
| | $\mathcal{E}(L^2)$ | $\mathcal{E}(L^2)$ | r_1 | $\mathcal{E}(L^2)$ |
| 2 | 4.891e-01 | 1.536e-03 | 1 | 1.458e-03 |
| 3 | 4.088e-01 | 3.514e-02 | 2 | 3.106e-02 |
| 4 | 9.291e-02 | 2.187e-03 | 2 | 2.015e-03 |
| 5 | 1.013e-01 | 2.279e-02 | 4 | 2.220e-02 |
| 6 | 3.270e-02 | 5.113e-04 | 2 | 4.921e-04 |
| 7 | 3.059e-02 | 7.476e-03 | 1 | 7.260e-03 |
| 8 | 3.600e-02 | 1.221e-03 | 6 | 4.385e-04 |

Table 12: Flow past a cylinder, $Re = 100$, cross-validation regime. Average L^2 errors for G-ROM, 2S-DD-VMS-ROM, and 3S-DD-VMS-ROM for different r values.

predictive regime. These results show that, for all r values, the 2S-DD-VMS-ROM and 3S-DD-VMS-ROM are several times (sometimes even one order of magnitude) more accurate than the standard G-ROM. Furthermore, the 3S-DD-VMS-ROM is generally more accurate than the 2S-DD-VMS-ROM: Specifically, for $r \geq 4$, the 3S-DD-VMS-ROM is at least *twice more accurate* than the 2S-DD-VMS-ROM.

In Figure 3, for $r = 4, 6, 7$, we plot the time evolution of the kinetic energy of the DNS, the G-ROM, the 2S-DD-VMS-ROM, and the new 3S-DD-VMS-ROM in the reconstructive regime. These plots support the conclusions in Table 11: Both the 3S-DD-VMS-ROM and the 2S-DD-VMS-ROM accurately approximate the DNS kinetic energy and are significantly more accurate than

| r | G-ROM | 2S-DD-VMS-ROM | 3S-DD-VMS-ROM | |
|-----|--------------------|--------------------|---------------|--------------------|
| | $\mathcal{E}(L^2)$ | $\mathcal{E}(L^2)$ | r_1 | $\mathcal{E}(L^2)$ |
| 2 | 3.883e-01 | 8.172e-02 | 1 | 7.388e-02 |
| 3 | 3.616e-01 | 3.374e-02 | 1 | 3.141e-02 |
| 4 | 1.366e-01 | 8.127e-03 | 2 | 4.115e-03 |
| 5 | 1.464e-01 | 4.248e-02 | 3 | 2.602e-02 |
| 6 | 1.348e-01 | 5.946e-03 | 4 | 1.051e-03 |
| 7 | 1.291e-01 | 1.529e-02 | 3 | 6.613e-03 |
| 8 | 9.638e-02 | 6.798e-03 | 6 | 3.170e-03 |

Table 13: Flow past a cylinder, $Re = 100$, predictive regime. Average L^2 errors for G-ROM, 2S-DD-VMS-ROM, and 3S-DD-VMS-ROM for different r values.

the standard G-ROM. Furthermore, 3S-DD-VMS-ROM is slightly more accurate than the 2S-DD-VMS-ROM, especially for $r = 7$.

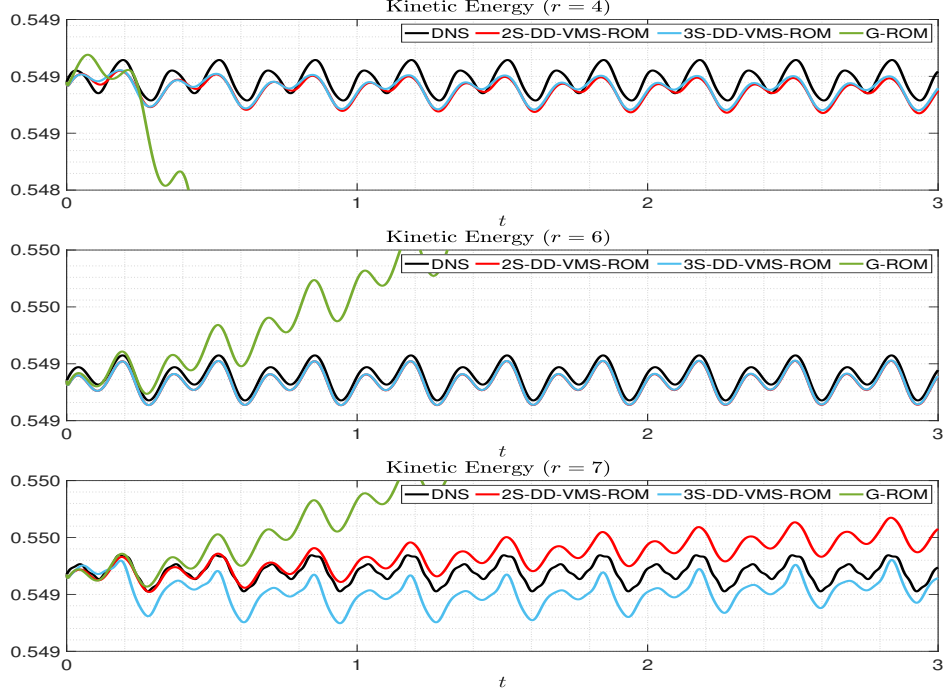

Figure 3: Flow past a cylinder, $Re = 100$, reconstructive regime. Time evolution of the kinetic energy for G-ROM, 2S-DD-VMS-ROM, and 3S-DD-VMS-ROM for different r values.

In Figure 4, for $r = 4, 6, 7$, we plot the time evolution of the kinetic energy of the DNS, the G-ROM, the 2S-DD-VMS-ROM, and the new 3S-DD-VMS-ROM in the cross-validation regime. For all cases, the evolution of the G-ROM kinetic energy is very inaccurate. In contrast, for $r = 4$ and $r = 6$, both the 3S-DD-VMS-ROM and the 2S-DD-VMS-ROM successfully reproduce the DNS kinetic energy. For $r = 7$, the 3S-DD-VMS-ROM accurately approximates the DNS kinetic energy between $t = 0$ and $t = 4$. For $t \geq 4$, although the 3S-DD-VMS-ROM and 2S-DD-VMS-ROM kinetic energy approximations are not as accurate, they are still much more accurate than the G-ROM kinetic energy approximation.

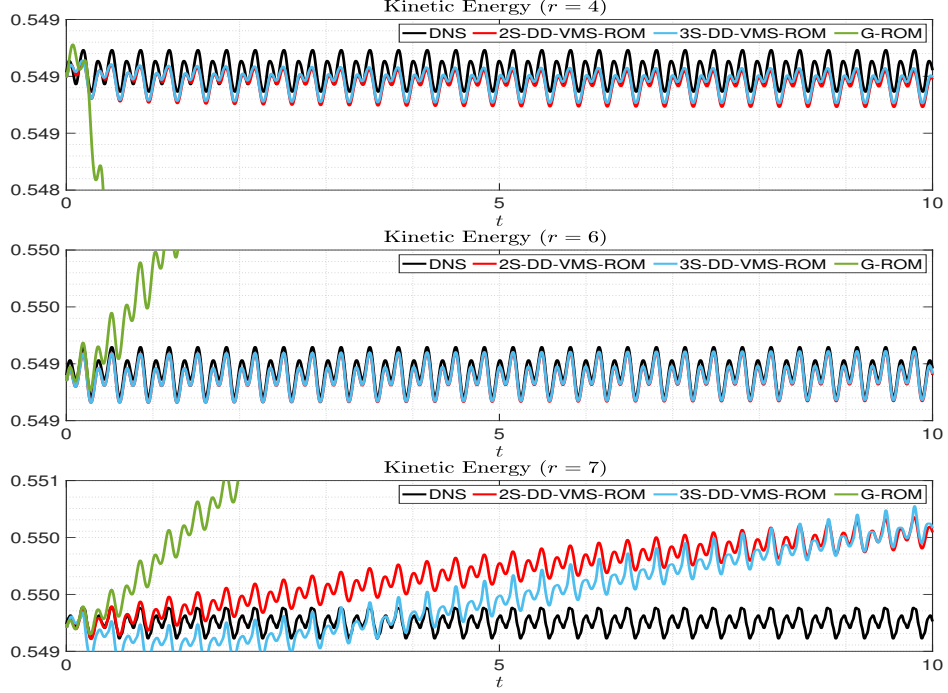

Figure 4: Flow past a cylinder, $Re = 100$, cross-validation regime. Time evolution of the kinetic energy for G-ROM, 2S-DD-VMS-ROM, and 3S-DD-VMS-ROM for different r values.

In Figure 5, for $r = 4, 6, 7$, we plot the time evolution of the kinetic energy of the DNS, the G-ROM, the 2S-DD-VMS-ROM, and the new 3S-DD-VMS-ROM in the predictive regime. For all r values, the G-ROM kinetic energy approximation is very inaccurate. In contrast, the new 3S-DD-VMS-ROM accurately approximates the exact DNS kinetic energy for $r = 4, 6, 7$. The 2S-DD-VMS-ROM kinetic energy approximation is accurate for $r = 6$, but not for $r = 4$ and, especially, for $r = 7$.

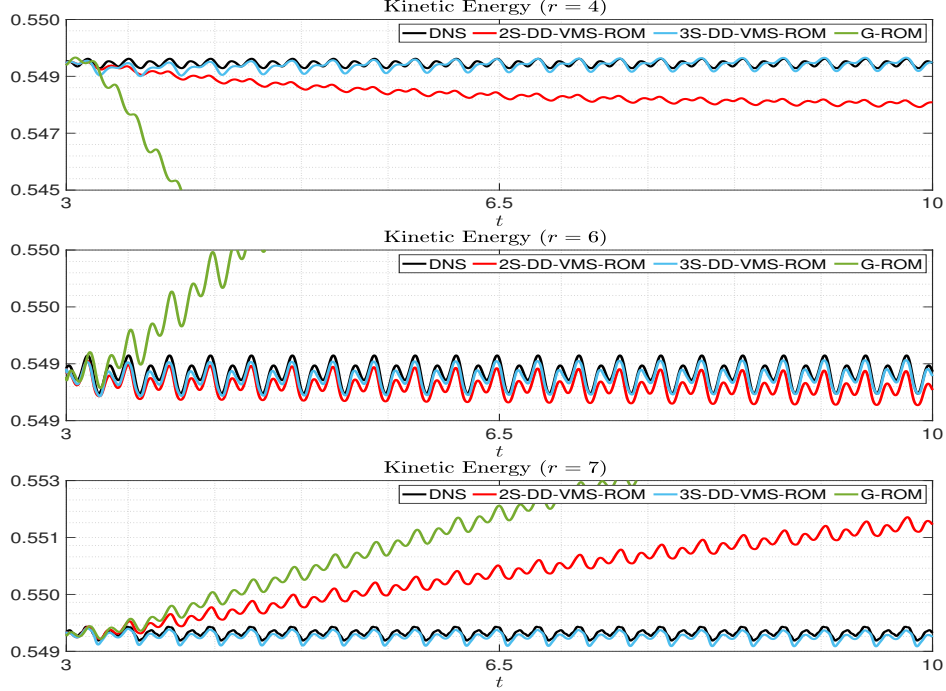

Figure 5: Flow past a cylinder, $Re = 100$, predictive regime. Time evolution of the kinetic energy for G-ROM, 2S-DD-VMS-ROM, and 3S-DD-VMS-ROM for different r values.

The errors listed in Tables 11–13 and the plots in Figures 3–5 show that, in the reconstructive, cross-validation, and predictive regimes, the 3S-DD-VMS-ROM is consistently the most accurate ROM. Furthermore, the 3S-DD-VMS-ROM is more accurate than the 2S-DD-VMS-ROM, especially in the predictive regime.

3.3.2. Numerical Results for $Re = 500$

In this section, we present numerical results for the flow past a cylinder at $Re = 500$.

In Table 14, for different r values, we list the average L^2 error (36) for the G-ROM, the 2S-DD-VMS-ROM, and the new 3S-DD-VMS-ROM in the reconstructive regime. We also list the r_1 values for the 3S-DD-VMS-ROM. These results show that, for all r values, the 2S-DD-VMS-ROM and 3S-DD-VMS-ROM are several times (sometimes more than one order of magnitude)

more accurate than the standard G-ROM. Furthermore, the 3S-DD-VMS-ROM is generally more accurate than the 2S-DD-VMS-ROM. For example, for $r = 2$, the 3S-DD-VMS-ROM is almost twice more accurate as the 2S-DD-VMS-ROM.

| r | G-ROM | 2S-DD-VMS-ROM | 3S-DD-VMS-ROM | |
|-----|--------------------|--------------------|---------------|--------------------|
| | $\mathcal{E}(L^2)$ | $\mathcal{E}(L^2)$ | r_1 | $\mathcal{E}(L^2)$ |
| 2 | 2.892e-01 | 7.029e-03 | 1 | 3.937e-03 |
| 3 | 3.344e-01 | 8.138e-02 | 2 | 7.517e-02 |
| 4 | 3.478e-01 | 4.195e-03 | 3 | 4.145e-03 |
| 5 | 3.795e-01 | 6.811e-02 | 2 | 5.915e-02 |
| 6 | 6.338e-02 | 3.864e-03 | 2 | 3.294e-03 |
| 7 | 5.738e-02 | 1.789e-02 | 2 | 1.563e-02 |
| 8 | 5.339e-02 | 5.734e-03 | 6 | 4.809e-03 |

Table 14: Flow past a cylinder, $Re = 500$, reconstructive regime. Average L^2 errors for G-ROM, 2S-DD-VMS-ROM, and 3S-DD-VMS-ROM for different r values.

In Table 15, for different r values, we list the average L^2 error (36) for the G-ROM, the 2S-DD-VMS-ROM, and the new 3S-DD-VMS-ROM in the cross-validation regime. We also list the r_1 values for the 3S-DD-VMS-ROM. These results show that, for all r values, the 2S-DD-VMS-ROM and 3S-DD-VMS-ROM are several times (sometimes even two orders of magnitude) more accurate than the standard G-ROM. Furthermore, the 3S-DD-VMS-ROM is generally more accurate than the 2S-DD-VMS-ROM. Specifically, for $r = 4, 5, 8$, the 3S-DD-VMS-ROM is almost twice more accurate than the 2S-DD-VMS-ROM.

In Table 16, for different r values, we list the average L^2 error (36) for the G-ROM, the 2S-DD-VMS-ROM, and the new 3S-DD-VMS-ROM in the predictive regime. We also list the r_1 values for the 3S-DD-VMS-ROM. These results show that, for all r values, the 2S-DD-VMS-ROM and 3S-DD-VMS-ROM are several times (sometimes even more than one order of magnitude) more accurate than the standard G-ROM. More importantly, for all r values (but especially for large r values), the 3S-DD-VMS-ROM is significantly more accurate than the 2S-DD-VMS-ROM: For example, for $r = 5, 6, 7$, and 8 , the 3S-DD-VMS-ROM is *more than twice more accurate* than the 2S-DD-VMS-ROM.

| r | G-ROM | 2S-DD-VMS-ROM | 3S-DD-VMS-ROM | |
|-----|--------------------|--------------------|---------------|--------------------|
| | $\mathcal{E}(L^2)$ | $\mathcal{E}(L^2)$ | r_1 | $\mathcal{E}(L^2)$ |
| 2 | 1.071e+00 | 2.015e-02 | 1 | 1.501e-02 |
| 3 | 8.280e-01 | 1.101e-01 | 2 | 8.428e-02 |
| 4 | 6.258e-01 | 1.218e-02 | 3 | 4.648e-03 |
| 5 | 6.440e-01 | 1.557e-01 | 3 | 7.329e-02 |
| 6 | 1.898e-01 | 5.733e-03 | 3 | 4.056e-03 |
| 7 | 1.531e-01 | 3.550e-02 | 2 | 2.033e-02 |
| 8 | 1.678e-01 | 9.050e-03 | 1 | 5.480e-03 |

Table 15: Flow past a cylinder, $Re = 500$, cross-validation regime. Average L^2 errors for G-ROM, 2S-DD-VMS-ROM, and 3S-DD-VMS-ROM for different r values.

| r | G-ROM | 2S-DD-VMS-ROM | 3S-DD-VMS-ROM | |
|-----|--------------------|--------------------|---------------|--------------------|
| | $\mathcal{E}(L^2)$ | $\mathcal{E}(L^2)$ | r_1 | $\mathcal{E}(L^2)$ |
| 2 | 7.351e-01 | 1.004e-01 | 1 | 1.004e-01 |
| 3 | 7.088e-01 | 8.838e-02 | 2 | 8.497e-02 |
| 4 | 5.871e-01 | 8.785e-03 | 1 | 8.785e-03 |
| 5 | 6.231e-01 | 9.735e-02 | 2 | 3.640e-02 |
| 6 | 1.293e-01 | 2.288e-02 | 4 | 9.051e-03 |
| 7 | 1.069e-01 | 2.816e-02 | 6 | 1.480e-02 |
| 8 | 1.130e-01 | 1.402e-02 | 6 | 5.544e-03 |

Table 16: Flow past a cylinder, $Re = 500$, predictive regime. Average L^2 errors for G-ROM, 2S-DD-VMS-ROM, and 3S-DD-VMS-ROM for different r values.

In Figure 6, for $r = 4, 6, 7$, we plot the time evolution of the kinetic energy of the DNS, the G-ROM, the 2S-DD-VMS-ROM, and the new 3S-DD-VMS-ROM in the reconstructive regime. For all r values, the G-ROM kinetic energy approximation is very inaccurate. In contrast, the new 3S-DD-VMS-ROM accurately approximates the exact DNS kinetic energy for $r = 4, 6, 7$. The 2S-DD-VMS-ROM kinetic energy approximation is accurate for $r = 4$ and $r = 6$, but not for $r = 7$.

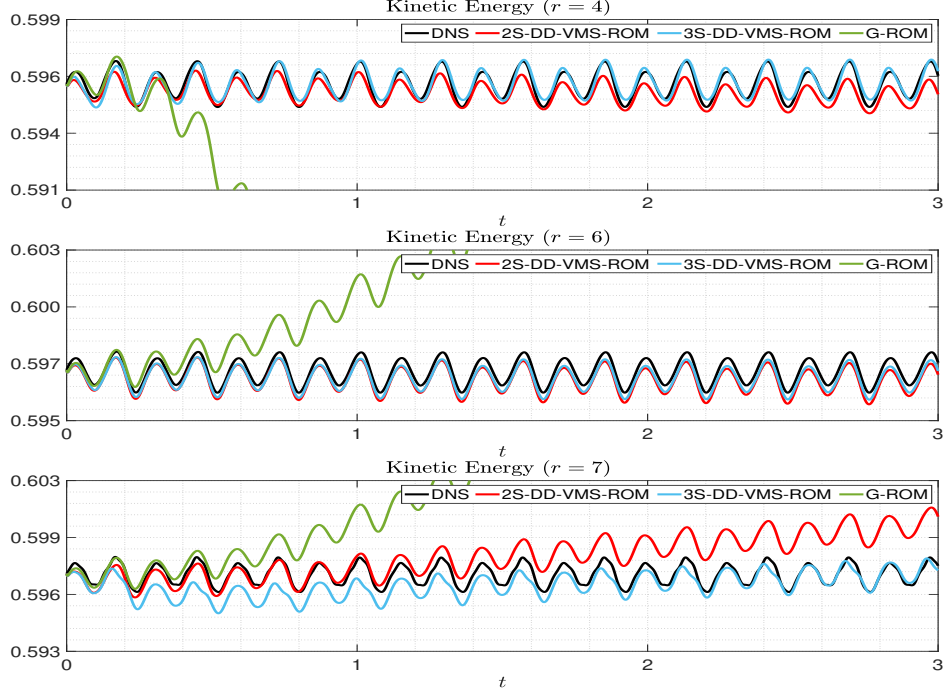

Figure 6: Flow past a cylinder, $Re = 500$, reconstructive regime. Time evolution of the kinetic energy for G-ROM, 2S-DD-VMS-ROM, and 3S-DD-VMS-ROM for different r values.

In Figure 7, for $r = 4, 6, 7$, we plot the time evolution of the kinetic energy of the DNS, the G-ROM, the 2S-DD-VMS-ROM, and the new 3S-DD-VMS-ROM in the cross-validation regime. For all r values, the G-ROM kinetic energy approximation is very inaccurate. In contrast, the new 3S-DD-VMS-ROM accurately approximates the exact DNS kinetic energy for $r = 4, 6, 7$. The 2S-DD-VMS-ROM kinetic energy approximation is accurate for $r = 4$ and $r = 6$, but not for $r = 7$.

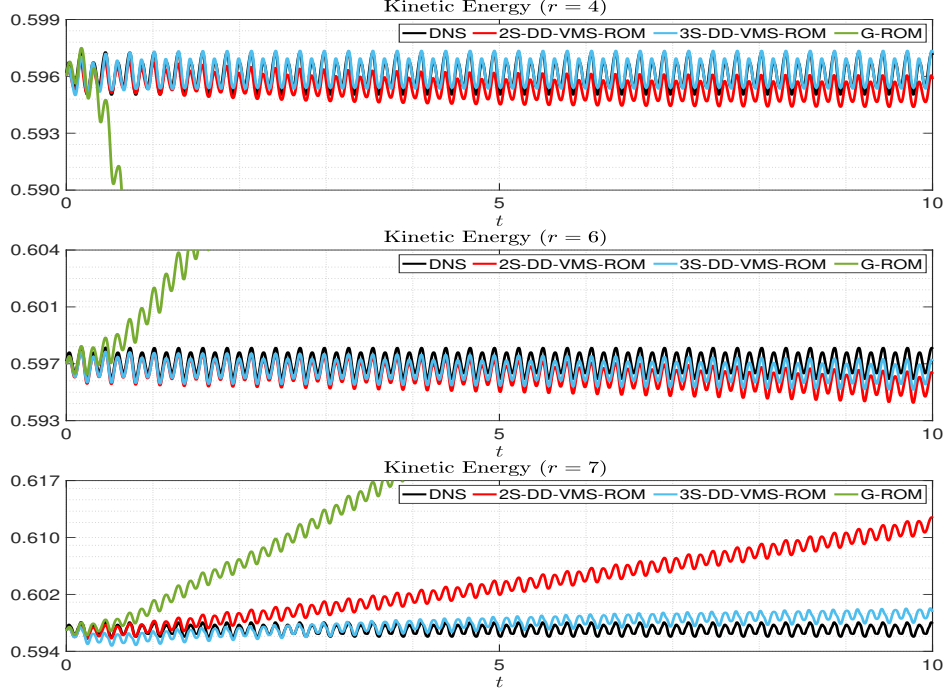

Figure 7: Flow past a cylinder, $Re = 500$, cross-validation regime. Time evolution of the kinetic energy for G-ROM, 2S-DD-VMS-ROM, and 3S-DD-VMS-ROM for different r values.

In Figure 8, for $r = 4, 6, 7$, we plot the time evolution of the kinetic energy of the DNS, the G-ROM, the 2S-DD-VMS-ROM, and the new 3S-DD-VMS-ROM in the predictive regime. For all r values, the G-ROM kinetic energy approximation is very inaccurate. In contrast, the new 3S-DD-VMS-ROM accurately approximates the DNS kinetic energy for $r = 6$ and $r = 7$. For $r = 6$ and $r = 7$, the 2S-DD-VMS-ROM kinetic energy approximation is less accurate than the 3S-DD-VMS-ROM kinetic energy approximation but more accurate than the G-ROM kinetic energy approximation. For $r = 4$, both the 3S-DD-VMS-ROM and the 2S-DD-VMS-ROM kinetic energy approximations are accurate.

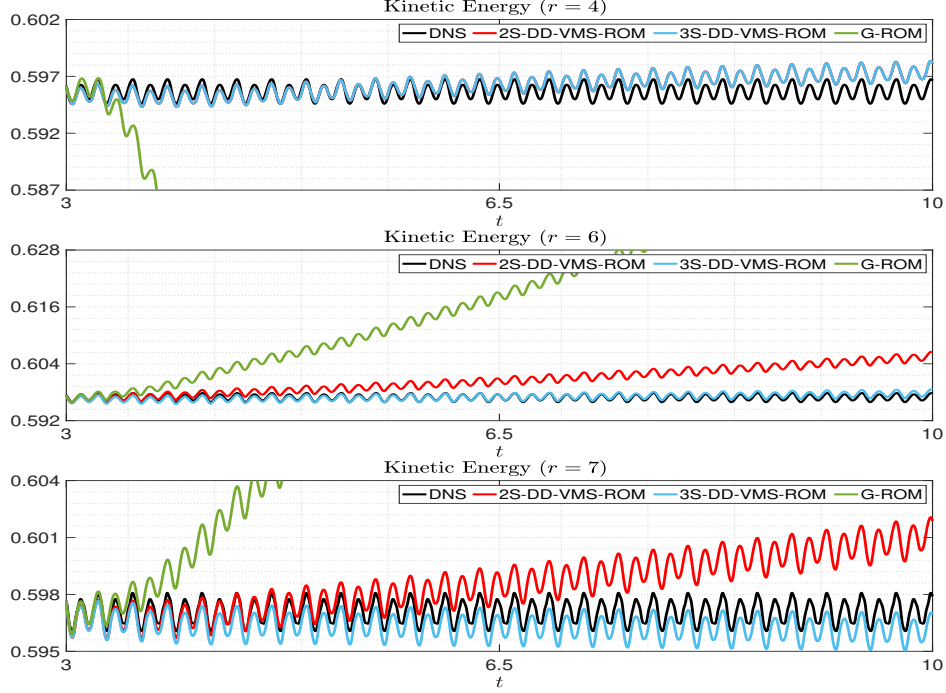

Figure 8: Flow past a cylinder, $Re = 500$, predictive regime. Time evolution of the kinetic energy for G-ROM, 2S-DD-VMS-ROM, and 3S-DD-VMS-ROM for different r values.

The errors listed in Tables 14–16 and the plots in Figures 6–8 show that, in the reconstructive, cross-validation, and predictive regimes, the 3S-DD-VMS-ROM is consistently the most accurate ROM. Furthermore, the 3S-DD-VMS-ROM is more accurate than the 2S-DD-VMS-ROM, especially in the predictive regime.

3.3.3. Numerical Results for $Re = 1000$

In this section, we present numerical results for the flow past a cylinder at $Re = 1000$.

In Table 17, for different r values, we list the average L^2 error (36) for the G-ROM, the 2S-DD-VMS-ROM, and the new 3S-DD-VMS-ROM in the reconstructive regime. We also list the r_1 values for the 3S-DD-VMS-ROM. These results show that, for all r values, the 2S-DD-VMS-ROM and 3S-DD-VMS-ROM are several times (sometimes even more than one order of

magnitude) more accurate than the standard G-ROM. Furthermore, the 3S-DD-VMS-ROM is generally more accurate than the 2S-DD-VMS-ROM. For example, for $r = 5$ and $r = 8$, the 3S-DD-VMS-ROM is *almost twice more accurate* than the 2S-DD-VMS-ROM.

| r | G-ROM | 2S-DD-VMS-ROM | 3S-DD-VMS-ROM | |
|-----|--------------------|--------------------|---------------|--------------------|
| | $\mathcal{E}(L^2)$ | $\mathcal{E}(L^2)$ | r_1 | $\mathcal{E}(L^2)$ |
| 2 | 4.937e-01 | 6.704e-03 | 1 | 6.692e-03 |
| 3 | 5.112e-01 | 6.804e-02 | 1 | 6.794e-02 |
| 4 | 5.980e-01 | 1.287e-02 | 2 | 9.869e-03 |
| 5 | 6.579e-01 | 1.794e-01 | 3 | 9.184e-02 |
| 6 | 1.503e-01 | 1.086e-02 | 4 | 8.210e-03 |
| 7 | 1.365e-01 | 2.848e-02 | 5 | 2.235e-02 |
| 8 | 7.076e-02 | 7.550e-03 | 4 | 4.836e-03 |

Table 17: Flow past a cylinder, $Re = 1000$, reconstructive regime. Average L^2 errors for G-ROM, 2S-DD-VMS-ROM, and 3S-DD-VMS-ROM for different r values.

In Table 18, for different r values, we list the average L^2 error (36) for the G-ROM, the 2S-DD-VMS-ROM, and the new 3S-DD-VMS-ROM in the cross-validation regime. These results show that, for all r values, the 2S-DD-VMS-ROM and 3S-DD-VMS-ROM are several times (sometimes even two orders of magnitude) more accurate than the standard G-ROM. Furthermore, the 3S-DD-VMS-ROM is generally more accurate than the 2S-DD-VMS-ROM, especially for large r values. In particular, for $r = 5$, the 3S-DD-VMS-ROM is *almost five times more accurate* than the 2S-DD-VMS-ROM.

In Table 19, for different r values, we list the average L^2 error (36) for the G-ROM, the 2S-DD-VMS-ROM, and the new 3S-DD-VMS-ROM in the predictive regime. We also list the r_1 values for the 3S-DD-VMS-ROM. These results show that, for all r values, the 2S-DD-VMS-ROM and 3S-DD-VMS-ROM are significantly (sometimes several times) more accurate than the standard G-ROM. More importantly, for all r values (but especially for large r values), the 3S-DD-VMS-ROM is significantly more accurate than the 2S-DD-VMS-ROM: For example, for $r = 6$, the 3S-DD-VMS-ROM is *more than five times more accurate* than the 2S-DD-VMS-ROM.

In Figure 9, for $r = 4, 6, 7$, we plot the time evolution of the kinetic

| r | G-ROM | 2S-DD-VMS-ROM | 3S-DD-VMS-ROM | |
|-----|--------------------|--------------------|---------------|--------------------|
| | $\mathcal{E}(L^2)$ | $\mathcal{E}(L^2)$ | r_1 | $\mathcal{E}(L^2)$ |
| 2 | 1.509e+00 | 1.504e-02 | 1 | 1.503e-02 |
| 3 | 8.595e-01 | 8.024e-02 | 1 | 8.024e-02 |
| 4 | 6.583e-01 | 2.538e-02 | 2 | 1.503e-02 |
| 5 | 7.095e-01 | 5.156e-01 | 3 | 1.026e-01 |
| 6 | 5.562e-01 | 3.132e-02 | 4 | 1.018e-02 |
| 7 | 4.760e-01 | 6.482e-02 | 6 | 3.505e-02 |
| 8 | 2.692e-01 | 1.691e-02 | 5 | 5.791e-03 |

Table 18: Flow past a cylinder, $Re = 1000$, cross-validation regime. Average L^2 errors for G-ROM, 2S-DD-VMS-ROM, and 3S-DD-VMS-ROM for different r values.

| r | G-ROM | 2S-DD-VMS-ROM | 3S-DD-VMS-ROM | |
|-----|--------------------|--------------------|---------------|--------------------|
| | $\mathcal{E}(L^2)$ | $\mathcal{E}(L^2)$ | r_1 | $\mathcal{E}(L^2)$ |
| 2 | 1.146e+00 | 3.857e-01 | 1 | 2.860e-01 |
| 3 | 9.217e-01 | 4.522e-01 | 1 | 1.357e-01 |
| 4 | 7.207e-01 | 1.679e-01 | 2 | 7.070e-02 |
| 5 | 7.281e-01 | 5.620e-01 | 3 | 2.331e-01 |
| 6 | 3.545e-01 | 2.279e-01 | 2 | 3.733e-02 |
| 7 | 3.027e-01 | 2.273e-01 | 3 | 7.922e-02 |
| 8 | 1.587e-01 | 5.849e-02 | 3 | 4.394e-02 |

Table 19: Flow past a cylinder, $Re = 1000$, predictive regime. Average L^2 errors for G-ROM, 2S-DD-VMS-ROM, and 3S-DD-VMS-ROM for different r values.

energy of the DNS, the G-ROM, the 2S-DD-VMS-ROM, and the new 3S-DD-VMS-ROM in the reconstructive regime. For all cases, the evolution of the G-ROM kinetic energy is very inaccurate. In contrast, for $r = 4$ and $r = 6$, both the 3S-DD-VMS-ROM and the 2S-DD-VMS-ROM successfully reproduce the DNS kinetic energy. For $r = 7$, 3S-DD-VMS-ROM kinetic energy yields small oscillations in the first 1s, but it quickly converges to the DNS kinetic energy after $t > 1$. On the other hand, the 2S-DD-VMS-ROM kinetic energy approximation is not accurate.

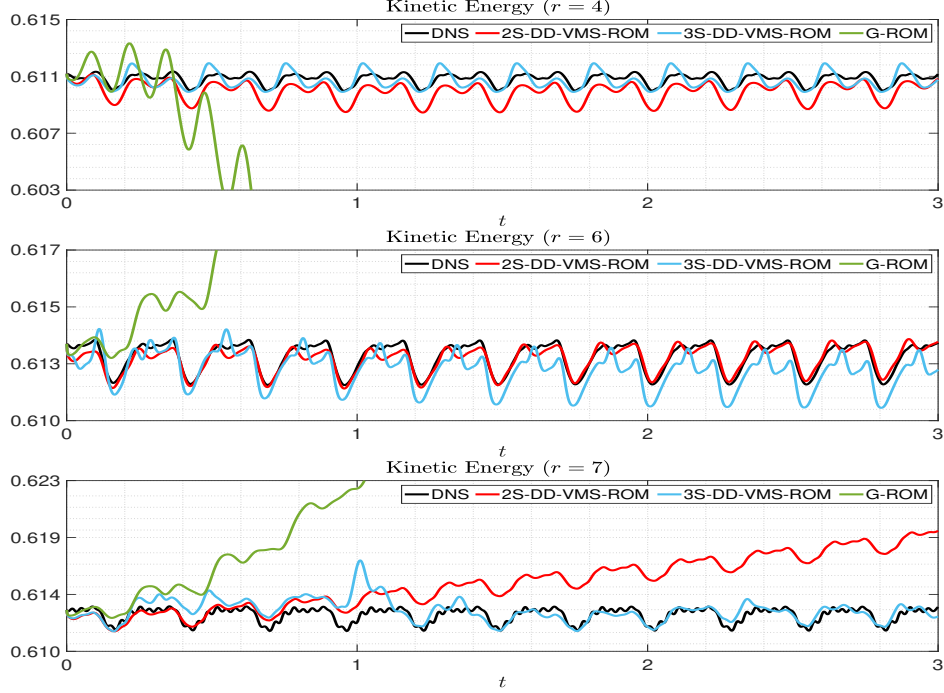

Figure 9: Flow past a cylinder, $Re = 1000$, reconstructive regime. Time evolution of the kinetic energy for G-ROM, 2S-DD-VMS-ROM, and 3S-DD-VMS-ROM for different r values.

In Figure 10, for $r = 4, 6, 7$, we plot the time evolution of the kinetic energy of the DNS, the G-ROM, the 2S-DD-VMS-ROM, and the new 3S-DD-VMS-ROM in the cross-validation regime. For all cases, the evolution of the G-ROM kinetic energy is very inaccurate. In contrast, for all cases, the 3S-DD-VMS-ROM successfully reproduces the exact DNS kinetic energy. The 2S-DD-VMS-ROM kinetic energy is accurate for $r = 4$, but not for $r = 6$ and, especially, for $r = 7$.

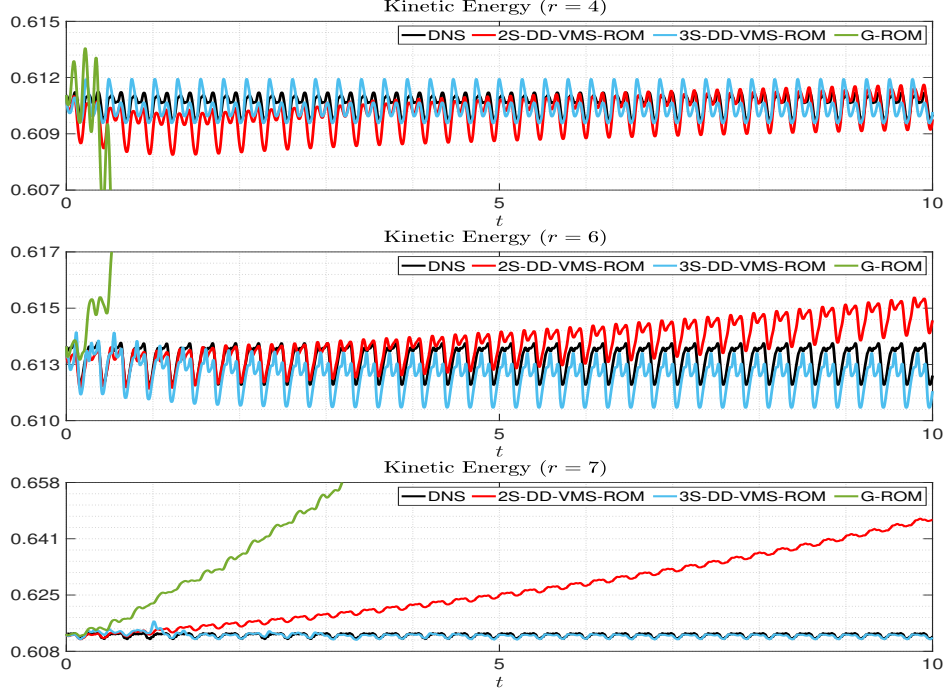

Figure 10: Flow past a cylinder, $Re = 1000$, cross-validation regime. Time evolution of the kinetic energy for G-ROM, 2S-DD-VMS-ROM, and 3S-DD-VMS-ROM for different r values.

In Figure 11, for three r values, we plot the time evolution of the kinetic energy of the G-ROM, the 2S-DD-VMS-ROM, and the new 3S-DD-VMS-ROM in the predictive regime. For all cases, the evolution of the G-ROM kinetic energy is very inaccurate. For $r = 4$, the 3S-DD-VMS-ROM kinetic energy approximation is accurate, whereas the 2S-DD-VMS-ROM and the G-ROM kinetic energies are inaccurate. For $r = 6$ and $r = 7$, although the 3S-DD-VMS-ROM kinetic energy approximations are not as accurate, they are still much more accurate than the 2S-DD-VMS-ROM and, especially, the G-ROM kinetic energy approximations.

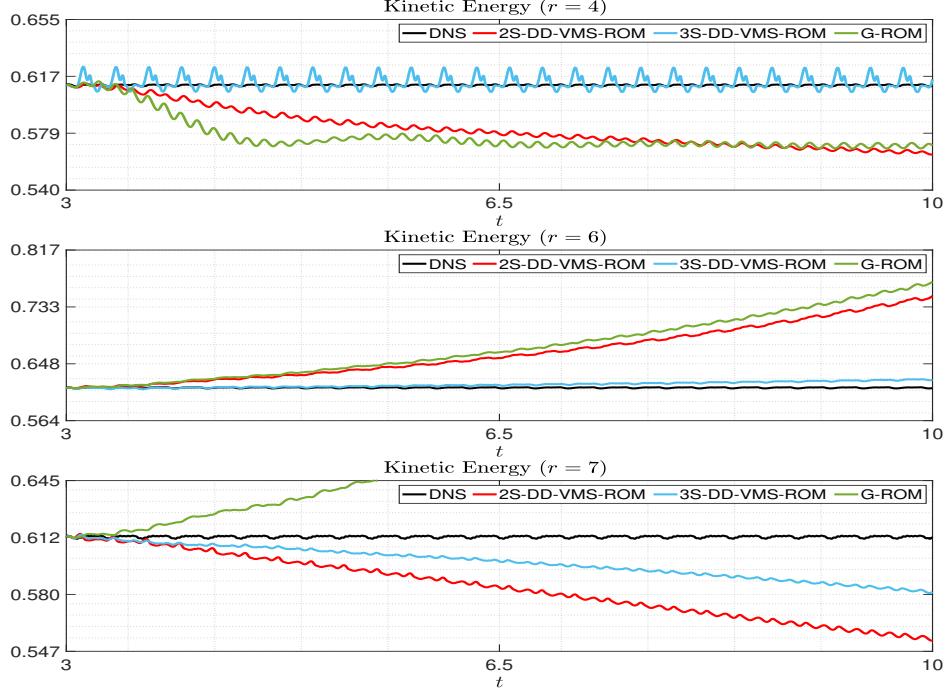

Figure 11: Flow past a cylinder, $Re = 1000$, predictive regime. Time evolution of the kinetic energy for G-ROM, 2S-DD-VMS-ROM, and 3S-DD-VMS-ROM for different r values.

The errors listed in Tables 17–19 and the plots in Figures 9–11 show that, in the reconstructive, cross-validation, and predictive regimes, the 3S-DD-VMS-ROM is consistently the most accurate ROM. Furthermore, the 3S-DD-VMS-ROM is more accurate than the 2S-DD-VMS-ROM, especially in the predictive regime.

4. Conclusions and Outlook

In this paper, we propose a new data-driven variational multiscale reduced order model (DD-VMS-ROM) framework. We construct the new DD-VMS-ROM framework in two steps: In the first step, we leverage the VMS methodology and the hierarchical structure of the ROM basis to provide explicit mathematical formulas for the interaction among the ROM spatial scales. In the second step, we use the available full order model (FOM)

data to construct structural VMS-ROM closure models for the interactions among scales. We investigate two DD-VMS-ROMs: (i) The two-scale DD-VMS-ROM (2S-DD-VMS-ROM) considers two scales: resolved scales and unresolved scales. For the 2S-DD-VMS-ROM, we construct one ROM closure model for the interaction between the resolved and unresolved scales. (ii) The three-scale DD-VMS-ROM (3S-DD-VMS-ROM) considers three scales: resolved large scales, resolved small scales, and unresolved scales. For the 3S-DD-VMS-ROM, we construct one ROM closure model for the interaction between the resolved large and resolved small scales, and another ROM closure model for the interaction between resolved small scales and unresolved scales. We test the 2S-DD-VMS-ROM and 3S-DD-VMS-ROM in the numerical simulation of the 1D Burgers equation, and the 2D flow past a circular cylinder in the reconstructive, cross-validation, and predictive regimes. The numerical results show that both the 2S-DD-VMS-ROM and the 3S-DD-VMS-ROM are more accurate than the standard Galerkin ROM (G-ROM) in the reconstructive, cross-validation, and predictive regimes. More importantly, the 3S-DD-VMS-ROM is more accurate than the 2S-DD-VMS-ROM, especially in the predictive regime.

We intend to pursue several research avenues in the development of the new DD-VMS-ROM framework. The first research direction that we plan to investigate is finding the optimal parameter r_1 and the optimal tolerances tol_L and tol_S in the new 3S-DD-VMS-ROM. In this paper, we used a trial and error approach to find these parameters. We intend to investigate whether providing rigorous error estimates [24, 32, 55] or leveraging physical insight [26] can provide parameters that yield more accurate results. Another research direction that we plan to pursue is the development of new DD-VMS-ROM closure models by leveraging ideas from VMS methods for finite element discretizations (see, e.g., Section 8.8 in [35]), e.g., the time-dependent subscale-orthogonal methods [12, 60, 61]. We also plan to explore different topological structures for the ROM closure term. In the present study, we assume that the structure of the ROM closure model function \mathbf{g} is similar to the structure of the Galerkin model function \mathbf{f} and we utilize a least squares approach to determine the shape of \mathbf{g} . We emphasize that, without loss of generality, our DD-VMS-ROM framework can be formulated by utilizing a supervised machine learning approach [57, 64, 65, 66], a topic that we would like to explore in the future. Finally, we intend to explore the extension of the new DD-VMS-ROM to the Petrov-Galerkin framework [9, 10, 20, 52].

Acknowledgements

The work of the first, second, and fourth authors was supported by National Science Foundation grants DMS-1821145 and BMMB-1929731. The work of the third author was supported by the U.S. Department of Energy, Office of Science, Office of Advanced Scientific Computing (ASCR), under Award number DE-SC0019290.

References

- [1] M. Ahmed and O. San. Stabilized principal interval decomposition method for model reduction of nonlinear convective systems with moving shocks. *Comp. Appl. Math.*, 37(5):6870–6902, 2018.
- [2] N. Ahmed, T. C. Rebollo, V. John, and S. Rubino. A review of variational multiscale methods for the simulation of turbulent incompressible flows. *Arch. Comput. Method. E.*, 24(1):115–164, 2017.
- [3] J. Baiges, R. Codina, I. Castanar, and E. Castillo. A finite element reduced order model based on adaptive mesh refinement and artificial neural networks. 2019.
- [4] J. Baiges, R. Codina, and S. Idelsohn. Reduced-order subscales for POD models. *Comput. Methods Appl. Mech. Engrg.*, 291:173–196, 2015.
- [5] M. J. Balajewicz, I. Tezaur, and E. H. Dowell. Minimal subspace rotation on the Stiefel manifold for stabilization and enhancement of projection-based reduced order models for the compressible Navier–Stokes equations. *J. Comput. Phys.*, 321:224–241, 2016.
- [6] M. Benosman, J. Borggaard, O. San, and B. Kramer. Learning-based robust stabilization for reduced-order models of 2D and 3D Boussinesq equations. *Appl. Math. Model.*, 49:162–181, 2017.
- [7] M. Bergmann, C. H. Bruneau, and A. Iollo. Enablers for robust POD models. *J. Comput. Phys.*, 228(2):516–538, 2009.
- [8] S. L. Brunton and J. N. Kutz. *Data-driven science and engineering: Machine learning, dynamical systems, and control*. Cambridge University Press, 2019.

- [9] K. Carlberg, M. Barone, and H. Antil. Galerkin v. least-squares Petrov–Galerkin projection in nonlinear model reduction. *J. Comput. Phys.*, 330:693–734, 2017.
- [10] K. Carlberg, C. Bou-Mosleh, and C. Farhat. Efficient non-linear model reduction via a least-squares Petrov–Galerkin projection and compressive tensor approximations. *Int. J. Num. Meth. Eng.*, 86(2):155–181, 2011.
- [11] M. D. Chekroun, H. Liu, and J. C. McWilliams. Variational approach to closure of nonlinear dynamical systems: Autonomous case. *J. Stat. Phys.*, pages 1–88, 2019.
- [12] R. Codina. Stabilized finite element approximation of transient incompressible flows using orthogonal subscales. *Comput. Methods Appl. Mech. Engrg.*, 191(39-40):4295–4321, 2002.
- [13] M. Couplet, C. Basdevant, and P. Sagaut. Calibrated reduced-order POD-Galerkin system for fluid flow modelling. *J. Comput. Phys.*, 207(1):192–220, 2005.
- [14] D. T. Crommelin and A. J. Majda. Strategies for model reduction: comparing different optimal bases. *J. Atmos. Sci.*, 61:2206–2217, 2004.
- [15] V. DeCaria, T. Iliescu, W. Layton, M. McLaughlin, and M. Schneier. An artificial compression reduced order model. *SIAM J. Numer. Anal.*, 2020. accepted.
- [16] F. G. Eroglu, S. Kaya, and L. G. Rebholz. A modular regularized variational multiscale proper orthogonal decomposition for incompressible flows. *Comput. Meth. Appl. Mech. Eng.*, 325:350–368, 2017.
- [17] L. Fick, Y. Maday, A. T. Patera, and T. Taddei. A stabilized POD model for turbulent flows over a range of Reynolds numbers: Optimal parameter sampling and constrained projection. *J. Comp. Phys.*, 371:214–243, 2018.
- [18] B. Galletti, C. H. Bruneau, L. Zannetti, and A. Iollo. Low-order modelling of laminar flow regimes past a confined square cylinder. *J. Fluid Mech.*, 503:161–170, 2004.

- [19] A. Gouasmi, E. J. Parish, and K. Duraisamy. A priori estimation of memory effects in reduced-order models of nonlinear systems using the Mori–Zwanzig formalism. *Proc. R. Soc. A*, 473(2205):20170385, 2017.
- [20] S. Grimberg, C. Farhat, and NN. Youkilis. On the stability of projection-based model order reduction for convection-dominated laminar and turbulent flows. *arXiv preprint*, <http://arxiv.org/abs/2001.10110>, 2020.
- [21] F. Güler Eroğlu, S. Kaya, and L. G. Rebholz. Decoupled modular regularized VMS-POD for Darcy-Brinkman equations. *IAENG Int. J. Appl. Math.*, 2019.
- [22] M. Gunzburger, N. Jiang, and M. Schneier. An ensemble-proper orthogonal decomposition method for the nonstationary Navier-Stokes equations. *SIAM J. Numer. Anal.*, 55(1):286–304, 2017.
- [23] D. Hartmann, M. Herz, and U. Wever. Model order reduction a key technology for digital twins. In *Reduced-order modeling (ROM) for simulation and optimization*, pages 167–179. Springer, Cham, Switzerland, 2018.
- [24] J. S. Hesthaven, G. Rozza, and B. Stamm. *Certified Reduced Basis Methods for Parametrized Partial Differential Equations*. Springer, 2015.
- [25] S. Hijazi, G. Stabile, A. Mola, and G. Rozza. Data-driven POD-Galerkin reduced order model for turbulent flows. *arXiv preprint*, <http://arxiv.org/abs/1907.09909>, 2019.
- [26] P. Holmes, J. L. Lumley, and G. Berkooz. *Turbulence, Coherent Structures, Dynamical Systems and Symmetry*. Cambridge, 1996.
- [27] T. J. R. Hughes, G. R. Feijóo, L. Mazzei, and J.-B. Quinicy. The variational multiscale method – a paradigm for computational mechanics. *Comput. Methods Appl. Mech. Engrg.*, 166(1):3–24, 1998.
- [28] T. J. R. Hughes, L. Mazzei, and K. E. Jansen. Large eddy simulation and the variational multiscale method. *Comput. Vis. Sci.*, 3:47–59, 2000.
- [29] T. J. R. Hughes, L. Mazzei, A. Oberai, and A. Wray. The multiscale formulation of large eddy simulation: Decay of homogeneous isotropic turbulence. *Phys. Fluids*, 13(2):505–512, 2001.

- [30] T. J. R. Hughes, A. Oberai, and L. Mazzei. Large eddy simulation of turbulent channel flows by the variational multiscale method. *Phys. Fluids*, 13(6):1784–1799, 2001.
- [31] T. Iliescu and Z. Wang. Variational multiscale proper orthogonal decomposition: Convection-dominated convection-diffusion-reaction equations. *Math. Comput.*, 82(283):1357–1378, 2013.
- [32] T. Iliescu and Z. Wang. Are the snapshot difference quotients needed in the proper orthogonal decomposition? *SIAM J. Sci. Comput.*, 36(3):A1221–A1250, 2014.
- [33] T. Iliescu and Z. Wang. Variational multiscale proper orthogonal decomposition: Navier-Stokes equations. *Num. Meth. P.D.E.s*, 30(2):641–663, 2014.
- [34] V. John. Reference values for drag and lift of a two dimensional time-dependent flow around a cylinder. *Int. J. Num. Meth. Fluids*, 44:777–788, 2004.
- [35] V. John. *Finite element methods for incompressible flow problems*. Springer, 2016.
- [36] V. John, A. Linke, C. Merdon, M. Neilan, and L. G. Rebholz. On the divergence constraint in mixed finite element methods for incompressible flows. *SIAM Rev.*, 2016.
- [37] K. Kunisch and S. Volkwein. Galerkin proper orthogonal decomposition methods for parabolic problems. *Numer. Math.*, 90(1):117–148, 2001.
- [38] K. K. Lin and F. Lu. Data-driven model reduction, Wiener projections, and the Mori-Zwanzig formalism. *arXiv preprint arXiv:1908.07725*, 2019.
- [39] J.-C. Loiseau and S. L. Brunton. Constrained sparse Galerkin regression. *J. Fluid Mech.*, 838:42–67, 2018.
- [40] F. Lu, K. K. Lin, and A. J. Chorin. Data-based stochastic model reduction for the Kuramoto–Sivashinsky equation. *Phys. D*, 340:46–57, 2017.

- [41] A. J. Majda and N. Chen. Model error, information barriers, state estimation and prediction in complex multiscale systems. *Entropy*, 20(9):644, 2018.
- [42] A. J. Majda and J. Harlim. Physics constrained nonlinear regression models for time series. *Nonlinearity*, 26(1):201, 2012.
- [43] R. Maulik, A. Mohan, B. Lusch, S. Madireddy, and P. Balaprakash. Time-series learning of latent-space dynamics for reduced-order model closure. *arXiv preprint*, <http://arxiv.org/abs/1906.07815>, 2019.
- [44] M. Mohebujjaman, L. G. Rebholz, and T. Iliescu. Physically-constrained data-driven correction for reduced order modeling of fluid flows. *Int. J. Num. Meth. Fluids*, 89(3):103–122, 2019.
- [45] M. Mohebujjaman, L. G. Rebholz, X. Xie, and T. Iliescu. Energy balance and mass conservation in reduced order models of fluid flows. *J. Comput. Phys.*, 346:262–277, 2017.
- [46] C. Mou, H. Liu, D. R. Wells, and T. Iliescu. Data-driven correction reduced order models for the quasi-geostrophic equations: A numerical investigation. *Int. J. Comput. Fluid Dyn.*, 2019. to appear.
- [47] B. R. Noack, M. Morzynski, and G. Tadmor. *Reduced-Order Modelling for Flow Control*, volume 528. Springer Verlag, 2011.
- [48] B. R. Noack, P. Papas, and P. A. Monkewitz. The need for a pressure-term representation in empirical Galerkin models of incompressible shear flows. *J. Fluid Mech.*, 523:339–365, 2005.
- [49] A. A. Oberai and J. Jagalur-Mohan. Approximate optimal projection for reduced-order models. *Int. J. Num. Meth. Engng.*, 105(1):63–80, 2016.
- [50] J. Östh, B. R. Noack, S. Krajnović, D. Barros, and J. Borée. On the need for a nonlinear subscale turbulence term in POD models as exemplified for a high-Reynolds-number flow over an Ahmed body. *J. Fluid Mech.*, 747:518–544, 2014.
- [51] S. Pagani, A. Manzoni, and K. Carlberg. Statistical closure modeling for reduced-order models of stationary systems by the ROMES method. *arXiv preprint*, <http://arxiv.org/abs/1901.02792>, 2019.

- [52] E. J. Parish, C. Wentland, and K. Duraisamy. The adjoint Petrov-Galerkin method for non-linear model reduction. *arXiv preprint arXiv:1810.03455*, 2019.
- [53] B. Peherstorfer and K. Willcox. Data-driven operator inference for non-intrusive projection-based model reduction. *Comput. Methods Appl. Mech. Engrg.*, 306:196–215, 2016.
- [54] S. Perotto, A. Reali, P. Rusconi, and A. Veneziani. HIGAMod: A Hierarchical IsoGeometric Approach for MODEL reduction in curved pipes. *Comput. & Fluids*, 142:21–29, 2017.
- [55] A. Quarteroni, A. Manzoni, and F. Negri. *Reduced Basis Methods for Partial Differential Equations: An Introduction*, volume 92. Springer, 2015.
- [56] Sk. M. Rahman, S. Pawar, O. San, A. Rasheed, and T. Iliescu. A non-intrusive reduced order modeling framework for quasigeostrophic turbulence. *Phys. Rev. E*, 100:053306, 2019.
- [57] Sk. M. Rahman, O. San, and A. Rasheed. A hybrid approach for model order reduction of barotropic quasi-geostrophic turbulence. *Fluids*, 3(4):86, 2018.
- [58] L. Rebholz and M. Xiao. Improved accuracy in algebraic splitting methods for Navier-Stokes equations. *SIAM J. Sci. Comput.*, 39(4):A1489–A1513, 2017.
- [59] T. C. Rebollo, E. D. Avila, M. G. Mármol, F. Ballarin, and G. Rozza. On a certified Smagorinsky reduced basis turbulence model. *SIAM J. Numer. Anal.*, 55(6):3047–3067, 2017.
- [60] R. Reyes and R. Codina. Projection-based reduced order models for flow problems: A variational multiscale approach. *Comput. Methods Appl. Mech. Engrg.*, 2019. submitted.
- [61] R. Reyes, R. Codina, J. Baiges, and S. Idelsohn. Reduced order models for thermally coupled low mach flows. *Adv. Model. Simul. Eng. Sci.*, 5(1):28, 2018.

- [62] J. P. Roop. A proper-orthogonal decomposition variational multiscale approximation method for a generalized Oseen problem. *Adv. Numer. Anal.*, 2013, 2013.
- [63] P. Sagaut. *Large Eddy Simulation for Incompressible Flows*. Scientific Computation. Springer-Verlag, Berlin, third edition, 2006.
- [64] O. San and R. Maulik. Extreme learning machine for reduced order modeling of turbulent geophysical flows. *Phys. Rev. E*, 97(4):042322, 2018.
- [65] O. San and R. Maulik. Machine learning closures for model order reduction of thermal fluids. *Appl. Math. Model.*, 60:681–710, 2018.
- [66] O. San and R. Maulik. Neural network closures for nonlinear model order reduction. *Adv. Comput. Math.*, 44(6):1717–1750, 2018.
- [67] T. P. Sapsis and P. F. J. Lermusiaux. Dynamically orthogonal field equations for continuous stochastic dynamical systems. *Phys. D*, 238(23-24):2347–2360, 2009.
- [68] S. Shah and E. Bou-Zeid. Very-large-scale motions in the atmospheric boundary layer educed by snapshot proper orthogonal decomposition. *Bound.-Lay. Meteorol.*, 153(3):355–387, 2014.
- [69] G. Stabile, F. Ballarin, G. Zuccarino, and G. Rozza. A reduced order variational multiscale approach for turbulent flows. *Adv. Comput. Math.*, pages 1–20, 2019.
- [70] R. Ștefănescu, A. Sandu, and I. M. Navon. POD/DEIM reduced-order strategies for efficient four dimensional variational data assimilation. *J. Comput. Phys.*, 295:569–595, 2015.
- [71] K. Taira, M. S. Hemati, S. L. Brunton, Y. Sun, K. Duraisamy, S. Bagheri, S. T. M. Dawson, and C.-A. Yeh. Modal analysis of fluid flows: Applications and outlook. *AIAA J.*, pages 1–25, 2019.
- [72] A. Tello, R. Codina, and J. Baiges. Fluid structure interaction by means of variational multiscale reduced order models. *Int. J. Num. Meth. Eng.*, 2019.

- [73] Z. Y. Wan, P. Vlachas, P. Koumoutsakos, and T. Sapsis. Data-assisted reduced-order modeling of extreme events in complex dynamical systems. *PloS One*, 13(5):e0197704, 2018.
- [74] Z. Wang, I. Akhtar, J. Borggaard, and T. Iliescu. Proper orthogonal decomposition closure models for turbulent flows: A numerical comparison. *Comput. Meth. Appl. Mech. Eng.*, 237-240:10–26, 2012.
- [75] X. Xie, M. Mohebbujjaman, L. G. Rebholz, and T. Iliescu. Data-driven filtered reduced order modeling of fluid flows. *SIAM J. Sci. Comput.*, 40(3):B834–B857, 2018.
- [76] M. Zhang and R. J. A. M. Stevens. Characterizing the coherent structures within and above large wind farms. *Bound.-Lay. Meteorol.*, 174:61–80, 2020.