Dialog-based Interactive Image Retrieval

Xiaoxiao Guo[†]

IBM Research AI
xiaoxiao.guo@ibm.com

Hui Wu[†]

IBM Research AI
wuhu@us.ibm.com

Yu Cheng

IBM Research AI
chengyu@us.ibm.com

Steven Rennie

Fusemachines Inc.
srennie@gmail.com

Rogério Schmidt Feris

IBM Research AI
rsferis@us.ibm.com

Abstract

Existing methods for interactive image retrieval have demonstrated the merit of integrating user feedback, improving retrieval results. However, most current systems rely on restricted forms of user feedback, such as binary relevance responses, or feedback based on a fixed set of relative attributes, which limits their impact. In this paper, we introduce a new approach to interactive image search that enables users to provide feedback via natural language, allowing for more natural and effective interaction. We formulate the task of dialog-based interactive image retrieval as a reinforcement learning problem, and reward the dialog system for improving the rank of the target image during each dialog turn. To avoid the cumbersome and costly process of collecting human-machine conversations as the dialog system learns, we train our system with a user simulator, which is itself trained to describe the differences between target and candidate images. The efficacy of our approach is demonstrated in a footwear retrieval application. Extensive experiments on both simulated and real-world data show that 1) our proposed learning framework achieves better accuracy than other supervised and reinforcement learning baselines and 2) user feedback based on natural language rather than pre-specified attributes leads to more effective retrieval results, and a more natural and expressive communication interface.

1 Introduction

The volume of searchable visual media has grown tremendously in recent years, and has intensified the need for retrieval systems that can more effectively identify relevant visual information, with applications in domains such as e-commerce [1, 2], video surveillance [3, 4], and internet search [5, 6]. Despite the significant progress made in visual recognition and search with deep learning methods [7, 8, 9], creating such image search systems remains a challenge, due to the well-known *semantic gap* between visual features and high-level semantic concepts, as well as the difficulty of fully understanding the user’s search intent.

A typical approach to improve the effectiveness of image search is to allow the user to interact with the system [10, 11]. In particular, the user provides iterative feedback about retrieved images, so that the system can refine the results, allowing the user and system to engage in a “conversation” to resolve what the user wants to retrieve. For example, as shown in Figure 1, feedback about relevance [12] allows users to indicate what images are “similar” or “dissimilar” to the desired image, and relative attribute feedback [13] allows the comparison of the desired image with candidate images based on a fixed set of attributes. While these feedback paradigms are effective, the restrictions on the specific

[†]These two authors contributed equally to this work.

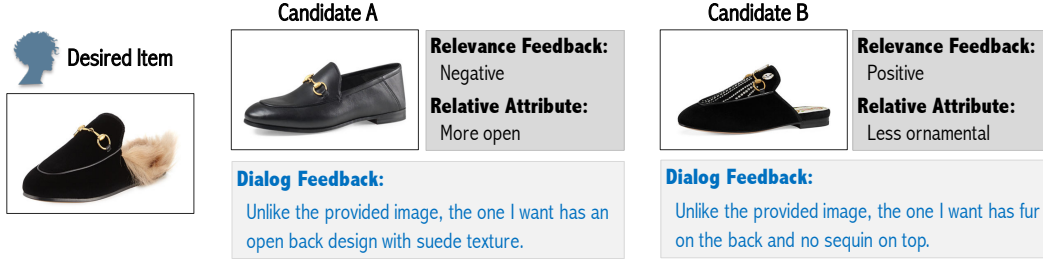

Figure 1: In the context of interactive image retrieval, the agent incorporates the user’s feedback to iteratively refine retrieval results. Different from existing works which are based on relevance feedback or relative attribute feedback, our approach allows the user to provide feedback in natural language.

form of feedback largely constrain the information that a user can convey to benefit the retrieval process.

In this work, we propose a new approach to interactive image search by introducing a *novel form of user feedback based on natural language*. The proposed approach, which we call dialog-based interactive retrieval, enables users to directly express in natural language, what the most prominent visual attributes of the image they have in mind are, improving image search results and allowing for a more natural human-computer interaction. We formulate the task as a reinforcement learning (RL) problem, and train a dialog system that takes natural language responses as user input, and produces retrieved images as output. We train this system by directly optimizing the rank of the target image, which is a non-differentiable objective. To avoid the cumbersome, inefficient, and costly process of collecting and annotating human-machine dialogs as the system learns, we utilize a model-based reinforcement learning approach by training a user simulator based on human-written relative descriptions. Specifically, to emulate a single dialog turn, where the user provides feedback regarding a candidate image relative to what the user has in mind, the user simulator generates a *relative caption* describing the differences between a retrieved candidate image and the user’s desired image.¹ Whereas there is a lot of prior work in image captioning [14, 15, 16], to our knowledge we are the first to explore the problem of *relative image captioning*, a general approach to more expressive and natural communication of relative preferences to machines, and use it as part of a user simulator to train a dialog system.

The efficacy of our approach is evaluated in a real-world application scenario of interactive footwear retrieval. Experimental results with both real and simulated users show that the proposed reinforcement learning framework achieves better accuracy than existing retrieval techniques. In particular, we show that feedback based on natural language is more effective than an existing system based on pre-defined relative attributes, and furthermore that our RL approach of directly optimizing the rank of the target image outperforms triplet loss by a large margin.

The main contributions of this work are as follows:

- A novel approach to interactive image search, called dialog-based interactive image retrieval, which allows the user to give feedback using natural language.
- An end-to-end deep dialog manager framework for interactive image retrieval using natural language, which is learned via an efficient policy optimization strategy based on triplet loss and model-based policy improvement [17].
- The introduction of a novel vision task, *relative image captioning*, where the generated captions can describe the visual differences between two images, and the contribution of the first dataset which supports further research on the task of relative image captioning.

¹In this work, the user simulator is trained on single-turn data. This reduces the history of responses to a “bag” of responses, and implies that all sequences of a given set of actions (returned images) are equivalent. Nevertheless, the process of localizing the target image still hinges on feedback from the user: while the image responses that maximize future reward (target image rank) are a set, the process of building an instance of the set naturally hinges on all previous feedback from the user, and so this set can be efficiently constructed sequentially.

2 Related Work

Interactive Image Retrieval. Methods for improving image search results based on user interaction have been studied for more than 20 years [18, 11, 19]. Relevance feedback is perhaps the most popular approach, with user input specified either as binary feedback (“relevant” or “irrelevant”) [12] or based on multiple relevance levels [20]. More recently, relative attributes (e.g., “more formal than these”, “shinier than these”) have been exploited as a richer form of feedback for interactive image retrieval [13, 21, 22, 23, 24]. Along this line of work, techniques have been developed to account for different user perceptions of attributes [25], actively guide user feedback on selected images [22], and handle fine-grained visual comparisons [24]. Zhao et al [26] proposed a method for interactive fashion apparel search, where feedback is provided in the form of attribute manipulations (e.g., “blue, instead of pink”). All these methods rely on a fixed, pre-defined set of visual attributes, whereas our method relies on feedback based on natural language, providing more flexible and more precise descriptions of the items to be searched, and an end-to-end training mechanism which facilitates deployment of the system in other domains, without requiring the explicit definition of a new vocabulary of attributes.

Image Retrieval with Natural Language Queries. Significant progress has been recently made on methods that lie in the intersection of computer vision and natural language processing, such as image captioning [15, 16], visual question-answering [27, 28], visual-semantic embeddings [29, 30], and grounding phrases in image regions [31, 32]. In particular, our work is related to image or video retrieval methods based on natural language queries [33, 34, 35, 36]. Tellex and Roy [33] developed a system to search a corpus of surveillance video for clips that match spatial language queries such as “along the hallway” and “across the kitchen.” Barbu et al. [34] proposed an approach for video retrieval that uses compositional semantics to encode subtle meaning that is lost in other systems, such as the difference between sentences with identical words: “the person hit the ball” and “the ball hit the person.” Li et al. [35] addressed the problem of person search based on natural language description. Hu et al. [36] proposed a method to localize a target object within a given image based on a natural language query of the object. These methods, however, retrieve images and videos in a single turn, whereas our proposed approach aggregates history information from dialog-based feedback and iteratively provides more refined results.

Visual Dialog. Building conversational agents that can hold meaningful dialogs with humans has been a long-standing goal of Artificial Intelligence. Early systems were generally designed based on rule-based and slot-filling techniques [37, 38, 39], whereas modern approaches have focused on end-to-end training, leveraging the success of encoder-decoder architectures and sequence-to-sequence learning [40, 41, 42, 43]. Our work falls into the class of visually-grounded dialog systems [44, 45, 46, 47, 48]. Das et al [44] proposed the task of visual dialog, where the system has to answer questions about images based on a previous dialog history. De Vries et al. [45] introduced the *GuessWhat* game, where a series of questions are asked to pinpoint a specific object in an image, with restricted answers consisting of yes/no/NA. The *image guessing* game [47] has been used to demonstrate the emergence of grounded language and communication among visual dialog agents with no human supervision, using reinforcement learning to train the agents in a goal-driven dialog setting. However, the dialogs are purely text-based (for both the questioner and answerer agents), whereas in our work we address the interactive image retrieval problem, with an agent presenting one or more images to the user at each dialog turn, and the user providing feedback in natural language.

3 Method

Our framework, which we refer to as the *dialog manager*, considers a user interacting with an image retrieval agent via iterative dialog turns. At the t -th dialog turn, the dialog manager presents a candidate image a_t selected from a retrieval database $\mathcal{I} = \{I_i\}_{i=0}^N$ to the user. The user then provides a feedback sentence o_t , describing the differences between the candidate image a_t and the desired image. Based on the user feedback and the dialog history up to turn t , $H_t = \{a_1, o_1, \dots, a_t, o_t\}$, the dialog manager selects another candidate image a_{t+1} from the database and presents it to the user. This process continues iteratively until the desired image is selected or the maximum number of dialog turns is reached. In practice, the dialog manager could provide multiple images per turn to achieve better retrieval performance. In this work, however, we focus on a simplified scenario of

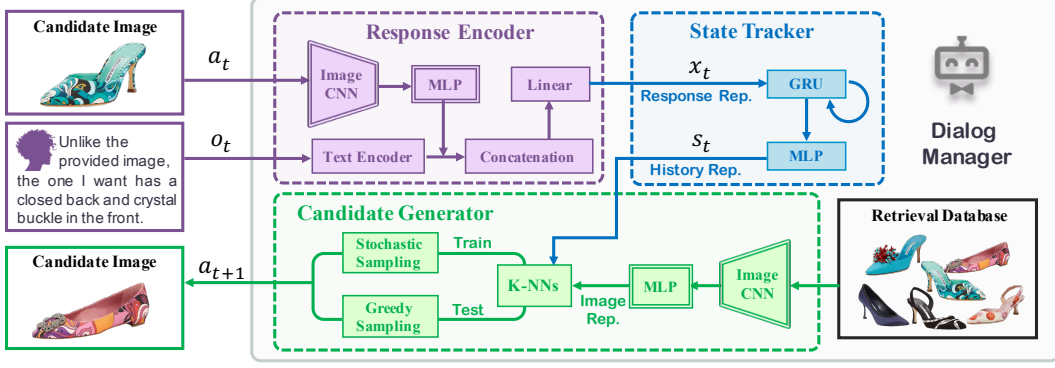

Figure 2: The proposed end-to-end framework for dialog-based interactive image retrieval.

a single image per interaction. We note that the same framework could be easily extended to the multiple-image case by allowing the user to select one image out of a list of candidate images to provide feedback on.

3.1 Dialog Manager: Model Architecture

Our proposed dialog manager model consists of three main components: a *Response Encoder*, a *State Tracker*, and a *Candidate Generator*, as shown in Figure 2. At the t -th dialog turn, the *Response Encoder* embeds the candidate image and the corresponding user feedback $\{a_t, o_t\}$ into a joint visual-semantic representation $x_t \in \mathbb{R}^D$. The *State Tracker* then aggregates this representation with the dialog history from previous turns, producing a new feature vector $s_t \in \mathbb{R}^D$. The *Candidate Generator* uses the aggregated representation s_t to select a new candidate image a_{t+1} that is shown to the user. Below we provide details on the specific design of each of the three model components.

Response Encoder The goal of the Response Encoder is to embed the information from the t -th dialog turn $\{a_t, o_t\}$ into a visual-semantic representation $x_t \in \mathbb{R}^D$. First, the candidate image is encoded using a deep convolutional neural network (CNN) followed by a linear transformation: $x_t^{\text{im}} = \text{ImgEnc}(a_t) \in \mathbb{R}^D$. The CNN architecture in our implementation is an ImageNet pre-trained ResNet-101 [49] and its parameters are fixed. Words in the user feedback sentence are represented with one-hot vectors and then embedded with a linear projection followed by a CNN as in [50]: $x_t^{\text{txt}} = \text{TxtEnc}(o_t) \in \mathbb{R}^D$. Finally, the image feature vector and the sentence representation are concatenated and embedded through a linear transformation to obtain the final response representation at time t : $x_t = W(x_t^{\text{im}} \oplus x_t^{\text{txt}})$, where \oplus is the concatenation operator and $W \in \mathbb{R}^{D \times 2D}$ is the linear projection. The learnable parameters of the Response Encoder are denoted as θ_r .

State Tracker The State Tracker is based on a gated recurrent unit (GRU) [51], which receives as input the response representation x_t , combines it with the history representation of previous dialog turns, and outputs the aggregated feature vector s_t . The forward dynamics of the State Tracker is written as: $g_t, h_t = \text{GRU}(x_t, h_{t-1})$, $s_t = W^s g_t$, where $h_{t-1} \in \mathbb{R}^D$ and $g_t \in \mathbb{R}^D$ are the hidden state and the output of the GRU respectively, h_t is the updated hidden state, $W^s \in \mathbb{R}^{D \times D}$ is a linear projection and $s_t \in \mathbb{R}^D$ is the history representation updated with the information from the current dialog turn. The learnable parameters of the State Tracker (GRU model) are denoted as θ_s . This memory-based design of the State Tracker allows our model to sequentially aggregate the information from user feedback to localize the candidate image.

Candidate Generator Given the feature representation of the images from the retrieval database, $\{x_i^{\text{im}}\}_{i=0}^N$, where $x_i^{\text{im}} = \text{ImgEnc}(I_i)$, we can compute a sampling probability based on the distances between the history representation s_t to each image feature, x_i^{im} . Specifically, the sampling probability is modeled using a softmax distribution over the top- K nearest neighbors of s_t : $\pi(j) = e^{-d_j} / \sum_{k=1}^K e^{-d_k}$, $j = 1, 2, \dots, K$, where d_k is the $L2$ distance of s_t to its k -th nearest neighbor in $\{x_i^{\text{im}}\}_{i=0}^N$. Given the sampling distribution, two approaches can be taken to sample the candidate image, denoted as $a_{t+1} = I_{j'}$: (1) stochastic approach (used at training time), where $j' \sim \pi$, and (2) greedy approach (used at inference time), where $j' = \arg \max_j (\pi_j)$.

Combining the three components of the model architecture, the overall learnable parameters of the dialog manager model is $\theta = \{\theta_r, \theta_s\}$. Next, we explain how the network is trained end-to-end.

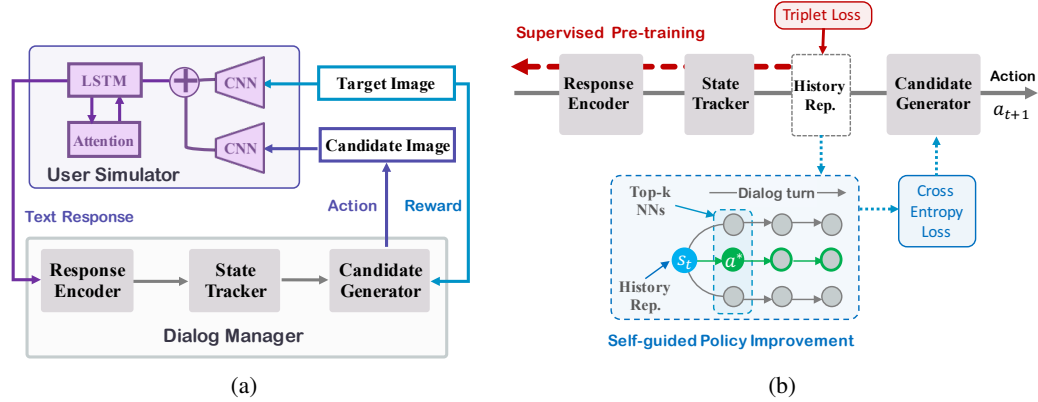

Figure 3: The learning framework: (a) The user simulator enables efficient exploration of the retrieval dialogs (Section 3.2.1); and (b) the policy network is learned using a combination of supervised pre-training and model-based policy improvement (Section 3.2.2).

3.2 Training the Dialog Manager

Directly optimizing the ranking percentile metric in a supervised learning scheme is challenging since it is a non-differentiable function. Instead, we model the ranking percentile as the environment reward received by the agent and frame the learning process in a reinforcement learning setting with the goal of maximizing the expected sum of discounted rewards: $\max_{\pi} \mathcal{U}^{\pi} = \mathbb{E}[\sum_{t=1}^T \gamma^{t-1} r_t | \pi_{\theta}]$, where $r_t \in \mathbb{R}$ is the reward representing the ranking percentile of the target image at the t -th interaction, γ is a discount factor determining the trade-off between short-term and long-term rewards, T is the maximum number of dialog turns, and π_{θ} is the policy determined by network parameters θ .

Training an RL model for this problem requires extensive exploration of the action space, which is only feasible if a large amount of training data is available. However, collecting and annotating human-machine dialog data for our task is expensive. This problem is exacerbated in the situation of natural language based user feedback, which incurs an even larger exploration space as compared to approaches based on a fixed set of attributes. In text-based dialog systems, it is common to circumvent this issue by relying on user simulators [52]. We adopt a similar strategy, where a user simulator, trained on human-written relative descriptions, substitutes the role of a real user in training the dialog manager (illustrated in Figure 3a). Below we further describe our user simulator, as well as the reinforcement learning techniques that we used to optimize our dialog manager.

3.2.1 User Simulator based on Relative Captioning

Here we propose the use of a *relative captioner* to simulate the user, which is a novel computer vision task in and of itself. It acts as a surrogate for real human users by automatically generating sentences that can describe the prominent visual differences between any pair of target and candidate images. We note that at each turn, our user simulator generates feedback independent of previous user feedback, and previously retrieved images. While more sophisticated models that consider the dialog history could potentially be much more expressive, training such systems well may require orders of magnitude more annotated data. In addition, back-referencing in dialogs can inherently be ambiguous, inefficient, and complex to resolve, even for humans. Based on these considerations, we decided to first investigate the use of a single-turn simulator. In the appendix, we show that our relative captioner based user model serves as a good proxy for real users.

We experimented with several different ways of combining the visual features of the target and retrieved images, and utilized the approach that resulted in the best captioning quality according to human evaluation². Specifically, we used a convolutional layer to fuse the image features of the

²We include a comprehensive study of different models for the user simulator in the Appendix C.

target and the reference image pair and applied the model of *Show, Attend, and Tell* [53] to generate the relative captions using a long short-term memory network (LSTM). For image feature extraction, we adopted the architecture of ResNet101 [49] pre-trained on ImageNet; and to better capture the localized visual differences between the input pair of images, we added a visual attention mechanism; the loss function of the relative captioner is the sum of the negative log likelihood of the correct words and the doubly stochastic regularizer on attention weights [53]. Since the task of relative captioning is a novel vision problem, there is no existing dataset supporting this task. Therefore, we collected a new dataset for this task, which will be introduced in Section 4.

3.2.2 Policy Learning

Supervised Pre-training When the network parameters are randomly initialized at the beginning, the history representations s_t are nearly random. To facilitate efficient exploration during RL training, we first pre-train the policy using a supervised learning objective, which is common in practice [54, 16]. While maximum likelihood-based pre-training is more common, here we pre-train using the more discriminative triplet loss objective:

$$\mathcal{L}^{\text{sup}} = \mathbb{E} \left[\sum_{t=0}^T \max(0, \|s_t - x^+\|_2 - \|s_t - x^-\|_2 + m) \right] \quad (1)$$

where x^+ and x^- are the image features of the target image and a random image sampled from the retrieval database respectively, and m is a constant for the margin. Intuitively, by ensuring the proximity of the target image and the images returned by the system, the rank of the target image can be improved without costly policy search from random initialization. However, entirely relying on this supervised learning objective deviates from our main learning objective, since the triplet loss objective does not jointly optimize the set of candidate images to maximize expected future reward (target image rank).

Model-Based Policy Improvement Given the known dynamics of the environment (in our case, the user simulator), it is often advantageous to leverage its behavior for policy improvement. Here we adapt the policy improvement [17] to our model based policy learning. Given the current policy π and the user simulator, the value of taking an action a_t using test-time configuration can be efficiently computed by look-ahead policy value estimation $Q^\pi(h_t, a_t) = \mathbb{E} \left[\sum_{t'=t}^T \gamma^{t'-t} r_{t'} | \pi \right]$. Because our user simulator is essentially deterministic, one trajectory is sufficient to estimate one action value. Therefore, an improved policy π' can be derived from the current policy π by selecting the best action given the value of the current policy, $\pi'(h_t) \equiv a_t^* = \arg \max_a Q^\pi(h_t, a)$. Specifically, we minimize the cross entropy loss given the derived action, a^* ,

$$\mathcal{L}^{\text{imp}} = \mathbb{E} \left[- \sum_{t=0}^T \log \left(\pi(a_t^* | h_t) \right) \right] \quad (2)$$

Compared to traditional policy gradient methods, the model-based policy improvement gradients have much lower variance, and converge much faster. In Section 5, we further demonstrated the effectiveness of model-based policy improvement by comparing it with a recent policy gradient method. Figure 3b illustrates our policy learning method described above.

4 Data: Relative Captioning

The desired behavior of the user simulator is to capture the rich and flexible language which describes the visual differences of any given image pair. Consequently, the relative captioning dataset should also satisfy this property. We situated the data collection procedure in a scenario of a shopping chatting session between a shopping assistant and a customer. The annotator was asked to take the role of the customer and provide a natural expression to inform the shopping assistant about the desired footwear item. To promote more regular, specific, and relative user feedback, we provided a sentence prefix for the annotator to complete when composing their response to a retrieved image³. Otherwise the annotator response is completely free-form: no other constraints on the response were

³The interface is shown in Figure 8 in the Appendix.

imposed. We used Amazon Mechanical Turk [55] to crowdsource the relative expressions. After manually removing erroneous annotations, in total, we collected 28,751 captions, with one caption per pair of images. More details about the data collection procedure and the dataset itself are provided in the Appendix. To facilitate the reproduction of our results and to encourage future research on relative captioning and retrieval, we will make our dataset available for public use.

5 Experimental Results

In Section 5.1, we assess the contribution of each component of our pipeline for policy learning. To evaluate the value of using free-form dialog feedback, we show experiments considering both simulated user feedback (Section 5.2) and real-world user feedback (Section 5.3).

All experiments were performed on the *Shoes* dataset [56], with the same training and testing data split: 10,000 database images were used during training, and the model is tested by retrieving images from a held-out testing set of 4,658 images. Image retrieval performance is quantified by the average rank percentile of the image returned by the dialog manager on the test set, starting from a random initial candidate image, as a function of the number of dialog turns. The user simulator was trained using image pairs sampled from the training set with no overlap with the testing images. For all methods, the embedding dimensionality of the feature space is set to $D = 256$, and the networks are trained using ADAM [57] optimizer with an initial learning rate of 0.001.

5.1 Analysis of the Learning Framework

We use our proposed user simulator to generate data and provide an extensive quantitative analysis on the contribution of each component to policy learning.

Results on Relative Captioner. Figure 5 provides some examples of the automatically generated feedback from the user simulator and the collected user annotations. An interesting observation is that even though the user simulator only occasionally produces expressions that exactly match the user annotation (the third example in Figure 5), it can still summarize the main visual differences between the two images, since inherently there are many ways to describe the differences between two images. Qualitative examination of the generated relative expressions showed that the user simulator can approximate the feedback of real users at a very low annotation cost (more analysis is provided in Appendix C).

Policy Learning Results. To investigate how retrieval performance is affected by each component of the dialog manager, we compare our approach, denoted as **Ours**, against two variants: (1) **SL**: supervised learning where the agent is trained only with triplet loss; (2) **RL-SCST**: policy learning using Self-Critical Sequence Training (SCST) [16] after pre-training the network using the triplet loss objective. SCST is a recently proposed algorithm that improves the performance of the basic policy gradient method when the reward achieved under the test-time inference algorithm can be accessed during training. The idea of SCST is to use test-time inference reward as the baseline for policy gradient learning by encouraging policies performing above the baseline while suppressing policies underperforming the baseline. Taking advantage of the user simulator, we can easily compute the test-time rewards of the dialog manager (by greedily decoding rather than sampling the image to return at each dialog turn). As shown in Figure 4 (solid lines), the average ranking percentile of the target image in all methods increases monotonically as the number of dialog turns increases. Both RL-based retrieval algorithms outperform the supervised pre-training, **SL**, which is expected since the triplet loss function does not directly optimize the retrieval ranking objective. Finally, **Ours**

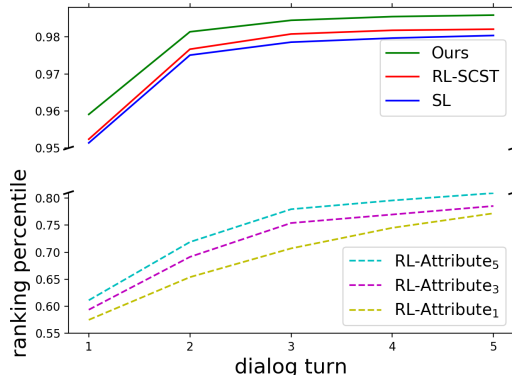

Figure 4: Quantitative comparison with variants of our method and methods using feedback based on a pre-defined set of relative attributes.

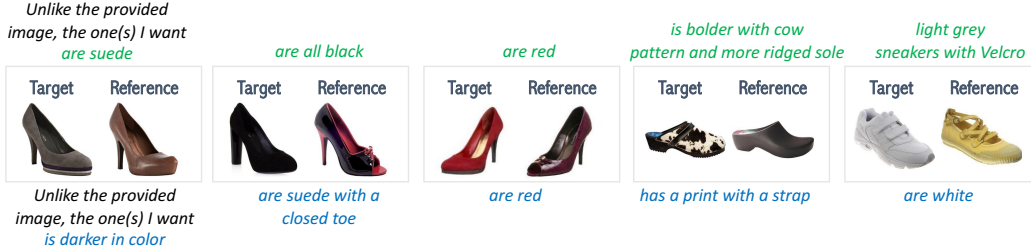

Figure 5: Examples of human provided (green) and captioner generated relative descriptions (blue). While generated relative captions don’t resemble human annotations in most cases, they can nonetheless capture the main visual differences between the target image and the reference image.

achieves 98% average ranking percentile with only two dialog turns and consistently outperforms **RL-SCST** across different dialog turns, which demonstrates the benefit of the model-based policy improvement component.

5.2 Effectiveness of Natural Language Feedback

In this section, we empirically evaluate the effect of natural language feedback, compared to pre-defined, relative attribute-based user feedback.

Generating Attribute Feedback. Each image in the Shoes dataset is associated with a 10-D attribute vector [13].⁴ We adopted a rule-based feedback generator which works by concatenating the respective attribute words with “more” or “less”, depending on the relative attribute values of a given image pair. For example, if the “shiny” value of the candidate image and the target image are 0.9 and 1.0 respectively, then the rule-based feedback is “more shiny”. The attributes are randomly sampled. This process is similar to the relative attribute feedback generation in [13]. To simulate the scenario when users provide feedbacks using multiple attributes, the feedback is generated by combining the individual attribute phrases using “and”.

Results. We trained the dialog manager using both dialog-based feedback and attribute-based feedback (**RL-attribute_n**), where the subscript number denotes the number of attributes used in the rule-based feedback generator. The empirical result is summarized in Figure 4, including relative attribute feedback using one, three and five attribute phrases. Across different numbers of dialog turns, the natural language based agent produced significantly higher target image average ranking percentile than the attribute based methods. The results suggest that relative feedback based on unrestricted natural language is a more effective basis for retrieval than the predefined set of relative attributes used in [13]. This is expected as the vocabulary of relative attributes in [13] is limited. In particular, using free-form dialog feedback circumvents the need to construct a reliable and comprehensive attribute taxonomy, which in itself is a non-trivial task [58].

5.3 User Study of Dialog-based Image Retrieval

In this section, we demonstrate the practical use of the proposed system with real users. We compare our system with an existing method, WhittleSearch [13], on the task of interactive footwear retrieval. WhittleSearch works by representing each image as a feature vector in a pre-defined 10-D attribute space, and iteratively refines the retrieval results by incorporating the user’s relative feedback on the attributes to gradually narrow down the search space of the target image. For both methods, at each turn, one image is presented to the user to seek feedback, and each dialog consists of five turns. In total, we collected 50 dialogs for both methods. For WhittleSearch, the users can choose to use any amount of attributes to provide relative feedback on during each interaction. The resulting average ranking percentile of the dialog manager and WhittleSearch are 89.9% and 70.3% respectively. In addition to improved retrieval accuracy, the users also reported that providing dialog-based feedback is more natural compared to selecting the most relevant attributes from a pre-defined list.

Figure 6 shows examples of retrieval dialogs from real users. We observe that, users often start the dialog with a coarse description of the main visual features (color, category) of the target image,

⁴The attributes on shoes include pointy-at-the-front, open, bright-in-color, covered-with-ornaments, shiny, high-at-the-heel, long-on-the-leg, formal, sporty, feminine.

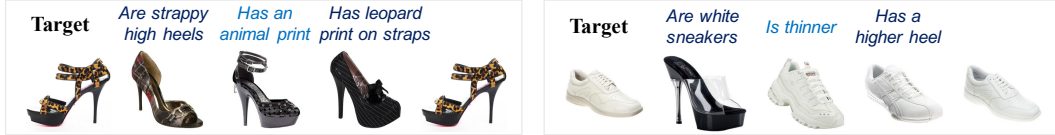

Figure 6: Examples of the user interacting with the proposed dialog-based image retrieval framework.

then as the dialog progresses, users give more specific feedback on fine-grained visual differences. The benefit of using free-form dialog can be seen from the flexible usage of rich attribute words (“leopard print on straps”), as well as relative phrases (“thinner”, “higher heel”). In Appendix D, we provide more detailed analysis of the performance of the dialog manager on real users. Overall, these results show that the proposed framework for the dialog manager exhibits promising behavior on generalizing to real-world applications.

6 Conclusions

In this paper, we introduced two novel tasks that reside at the intersection of computer vision and language: relative captioning, and dialog-based interactive image retrieval. Ultimately, techniques that are successful on such tasks will form the basis for the high fidelity, multi-modal, intelligent conversational systems of the future, and thus represent important milestones in this quest. We demonstrated the value of these tasks in the context of an interactive fashion retrieval application. Our proposed approach, which enables users to provide feedback via natural language, significantly outperforms traditional methods that rely on a pre-defined vocabulary of relative attributes, while offering a more natural human-machine communication. As future work, we plan to leverage side information, such as textual descriptions associated with product items, to further enhance our dialog-based image retrieval approach. Additionally, we plan to investigate models of the user simulator that are conditioned on the previous dialog history, allowing for more expressive and natural interaction.

Acknowledgement We would like to give special thanks to Professor Kristen Grauman for helpful discussions.

References

- [1] Junshi Huang, Rogerio S Feris, Qiang Chen, and Shuicheng Yan. Cross-domain image retrieval with a dual attribute-aware ranking network. In *ICCV*, 2015.
- [2] Ziwei Liu, Ping Luo, Shi Qiu, Xiaogang Wang, and Xiaoou Tang. Deepfashion: Powering robust clothes recognition and retrieval with rich annotations. In *CVPR*, 2016.
- [3] Daniel A Vaquero, Rogerio S Feris, Duan Tran, Lisa Brown, Arun Hampapur, and Matthew Turk. Attribute-based people search in surveillance environments. In *WACV*, 2009.
- [4] Zhiyuan Shi, Timothy M Hospedales, and Tao Xiang. Transferring a semantic representation for person re-identification and search. In *CVPR*, 2015.
- [5] Albert Gordo, Jon Almazán, Jerome Revaud, and Diane Larlus. Deep image retrieval: Learning global representations for image search. In *ECCV*, 2016.
- [6] Herve Jegou, Florent Perronnin, Matthijs Douze, Jorge Sánchez, Patrick Perez, and Cordelia Schmid. Aggregating local image descriptors into compact codes. *IEEE Transactions on Pattern Analysis and Machine Intelligence*, 34(9):1704–1716, 2012.
- [7] Alex Krizhevsky, Ilya Sutskever, and Geoffrey E Hinton. Imagenet classification with deep convolutional neural networks. In *NIPS*, 2012.
- [8] Jiang Wang, Yang Song, Thomas Leung, Chuck Rosenberg, Jingbin Wang, James Philbin, Bo Chen, and Ying Wu. Learning fine-grained image similarity with deep ranking. In *CVPR*, 2014.
- [9] Albert Gordo, Jon Almazan, Jerome Revaud, and Diane Larlus. End-to-end learning of deep visual representations for image retrieval. *International Journal of Computer Vision*, 124(2):237–254, 2017.
- [10] Xiang Sean Zhou and Thomas S Huang. Relevance feedback in image retrieval: A comprehensive review. *Multimedia systems*, 8(6):536–544, 2003.
- [11] Bart Thomee and Michael S Lew. Interactive search in image retrieval: a survey. *International Journal of Multimedia Information Retrieval*, 1(2):71–86, 2012.

- [12] Yong Rui, Thomas S Huang, Michael Ortega, and Sharad Mehrotra. Relevance feedback: a power tool for interactive content-based image retrieval. *IEEE Transactions on circuits and systems for video technology*, 8(5):644–655, 1998.
- [13] Adriana Kovashka, Devi Parikh, and Kristen Grauman. Whittlesearch: Image search with relative attribute feedback. In *CVPR*, 2012.
- [14] Girish Kulkarni, Visruth Premraj, Sagnik Dhar, Siming Li, Yejin Choi, Alexander C Berg, and Tamara L Berg. Baby talk: Understanding and generating image descriptions. In *CVPR*, 2011.
- [15] Oriol Vinyals, Alexander Toshev, Samy Bengio, and Dumitru Erhan. Show and tell: A neural image caption generator. In *CVPR*, 2015.
- [16] Steven J Rennie, Etienne Marcheret, Youssef Mroueh, Jarret Ross, and Vaibhava Goel. Self-critical sequence training for image captioning. In *CVPR*, 2017.
- [17] Richard S Sutton and Andrew G Barto. *Reinforcement learning: An introduction*. MIT Press, 1998.
- [18] Myron Flickner, Harpreet Sawhney, et al. Query by image and video content: The qbic system. *IEEE Computer*, 28(9):23–32, 1995.
- [19] Yong Rui, Thomas S Huang, and Shih-Fu Chang. Image retrieval: Current techniques, promising directions, and open issues. *Journal of visual communication and image representation*, 10(1):39–62, 1999.
- [20] Hong Wu, Hanqing Lu, and Songde Ma. Willhunter: interactive image retrieval with multilevel relevance. In *ICPR*, 2004.
- [21] Adriana Kovashka and Kristen Grauman. Attributes for image retrieval. In *Visual Attributes*. Springer, 2017.
- [22] Adriana Kovashka and Kristen Grauman. Attribute pivots for guiding relevance feedback in image search. In *ICCV*, 2013.
- [23] Devi Parikh and Kristen Grauman. Relative attributes. In *ICCV*, 2011.
- [24] Aron Yu and Kristen Grauman. Fine-grained comparisons with attributes. In *Visual Attributes*. Springer, 2017.
- [25] A. Kovashka and K. Grauman. Discovering shades of attribute meaning with the crowd. In *ECCV Workshop on Parts and Attributes*, 2014.
- [26] Bo Zhao, Jiashi Feng, Xiao Wu, and Shuicheng Yan. Memory-augmented attribute manipulation networks for interactive fashion search. In *CVPR*, 2017.
- [27] Stanislaw Antol, Aishwarya Agrawal, Jiasen Lu, Margaret Mitchell, Dhruv Batra, C Lawrence Zitnick, and Devi Parikh. Vqa: Visual question answering. In *ICCV*, 2015.
- [28] Makarand Tapaswi, Yukun Zhu, Rainer Stiefelhof, Antonio Torralba, Raquel Urtasun, and Sanja Fidler. Movieqa: Understanding stories in movies through question-answering. In *CVPR*, 2016.
- [29] Andrea Frome, Greg S Corrado, Jon Shlens, Samy Bengio, Jeff Dean, Tomas Mikolov, et al. Devise: A deep visual-semantic embedding model. In *NIPS*, 2013.
- [30] Liwei Wang, Yin Li, and Svetlana Lazebnik. Learning deep structure-preserving image-text embeddings. In *CVPR*, 2016.
- [31] Anna Rohrbach, Marcus Rohrbach, Ronghang Hu, Trevor Darrell, and Bernt Schiele. Grounding of textual phrases in images by reconstruction. In *ECCV*, 2016.
- [32] Bryan A Plummer, Liwei Wang, Chris M Cervantes, Juan C Caicedo, Julia Hockenmaier, and Svetlana Lazebnik. Flickr30k entities: Collecting region-to-phrase correspondences for richer image-to-sentence models. In *ICCV*, 2015.
- [33] Stefanie Tellex and Deb Roy. Towards surveillance video search by natural language query. In *ACM International Conference on Image and Video Retrieval*, 2009.
- [34] Andrei Barbu, N Siddharth, and Jeffrey Mark Siskind. Saying what you’re looking for: Linguistics meets video search. *IEEE Transactions on Pattern Analysis and Machine Intelligence*, 38(10), 2016.
- [35] Shuang Li, Tong Xiao, Hongsheng Li, Bolei Zhou, Dayu Yue, and Xiaogang Wang. Person search with natural language description. In *CVPR*, 2017.
- [36] Ronghang Hu, Huazhe Xu, Marcus Rohrbach, Jiashi Feng, Kate Saenko, and Trevor Darrell. Natural language object retrieval. In *CVPR*, 2016.
- [37] Joseph Weizenbaum. Eliza—a computer program for the study of natural language communication between man and machine. *Communications of the ACM*, 9(1):36–45, 1966.
- [38] Jason D Williams and Steve Young. Partially observable markov decision processes for spoken dialog systems. *Computer Speech & Language*, 21(2):393–422, 2007.

- [39] Zhuoran Wang and Oliver Lemon. A simple and generic belief tracking mechanism for the dialog state tracking challenge: On the believability of observed information. In *SIGDIAL*, 2013.
- [40] Ilya Sutskever, Oriol Vinyals, and Quoc V Le. Sequence to sequence learning with neural networks. In *NIPS*, 2014.
- [41] Kyunghyun Cho, Bart Van Merriënboer, et al. Learning phrase representations using rnn encoder-decoder for statistical machine translation. In *EMNLP*, 2014.
- [42] Iulian Vlad Serban, Alessandro Sordani, Yoshua Bengio, Aaron C Courville, and Joelle Pineau. Building end-to-end dialogue systems using generative hierarchical neural network models. In *AAAI*, 2016.
- [43] Antoine Bordes and Jason Weston. Learning end-to-end goal-oriented dialog. In *ICLR*, 2017.
- [44] Abhishek Das, Satwik Kottur, Khushi Gupta, Avi Singh, Deshraj Yadav, José MF Moura, Devi Parikh, and Dhruv Batra. Visual dialog. In *CVPR*, 2017.
- [45] Harm de Vries, Florian Strub, Sarath Chandar, Olivier Pietquin, Hugo Larochelle, and Aaron Courville. Guesswhat?! visual object discovery through multi-modal dialogue. In *CVPR*, 2017.
- [46] Paul Hongsuck Seo, Andreas Lehrmann, Bohyung Han, and Leonid Sigal. Visual reference resolution using attention memory for visual dialog. In *NIPS*, 2017.
- [47] Abhishek Das, Satwik Kottur, José MF Moura, Stefan Lee, and Dhruv Batra. Learning cooperative visual dialog agents with deep reinforcement learning. In *ICCV*, 2017.
- [48] Florian Strub, Harm de Vries, Jeremie Mary, Bilal Piot, Aaron Courville, and Olivier Pietquin. End-to-end optimization of goal-driven and visually grounded dialogue systems. In *IJCAI*, 2017.
- [49] Kaiming He, Xiangyu Zhang, Shaoqing Ren, and Jian Sun. Deep residual learning for image recognition. In *CVPR*, 2016.
- [50] Yoon Kim. Convolutional neural networks for sentence classification. In *EMNLP*, 2014.
- [51] Junyoung Chung, Caglar Gulcehre, KyungHyun Cho, and Yoshua Bengio. Empirical evaluation of gated recurrent neural networks on sequence modeling. *arXiv preprint arXiv:1412.3555*, 2014.
- [52] Xiujuan Li, Zachary C Lipton, Bhuwan Dhingra, Lihong Li, Jianfeng Gao, and Yun-Nung Chen. A user simulator for task-completion dialogues. *arXiv preprint arXiv:1612.05688*, 2016.
- [53] Kelvin Xu, Jimmy Ba, Ryan Kiros, Kyunghyun Cho, Aaron Courville, Ruslan Salakhudinov, Rich Zemel, and Yoshua Bengio. Show, attend and tell: Neural image caption generation with visual attention. In *ICML*, 2015.
- [54] David Silver, Julian Schrittwieser, Karen Simonyan, Ioannis Antonoglou, Aja Huang, Arthur Guez, Thomas Hubert, Lucas Baker, Matthew Lai, Adrian Bolton, et al. Mastering the game of go without human knowledge. *Nature*, 550(7676):354, 2017.
- [55] Michael Buhrmester, Tracy Kwang, and Samuel D Gosling. Amazon’s mechanical turk: A new source of inexpensive, yet high-quality, data? *Perspectives on psychological science*, 6(1):3–5, 2011.
- [56] Tamara L Berg, Alexander C Berg, and Jonathan Shih. Automatic attribute discovery and characterization from noisy web data. In *ECCV*, 2010.
- [57] D Kinga and J Ba Adam. Adam: A method for stochastic optimization. In *ICLR*, 2015.
- [58] Subhransu Maji. Discovering a lexicon of parts and attributes. In *ECCV*, 2012.

Appendix

A Data Collection

In the following, we explain the details on how we collected the relative captioning dataset for training the user simulator and provide insights on the dataset properties. Unlike existing datasets which aim to capture the visual differences purely using “more” or “less” relations on visual attributes [13], we want to collect data which captures comparative visual differences that are hard to describe merely using a pre-defined set of attributes. As shown in Figure 8, we designed the data collection interface in the context of fashion footwear retrieval, where a conversational shopping assistant interacts with a customer and whose goal is to efficiently retrieve and present the product that matches the user’s mental image of the desired item.

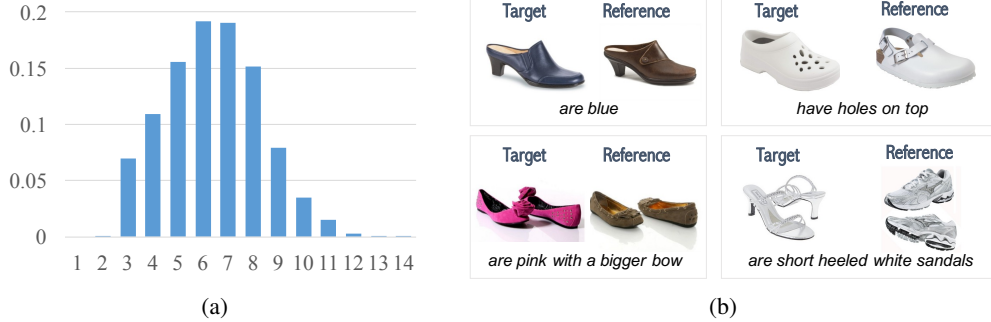

Figure 7: Length distribution of the relative captioning dataset (a), and examples of relative captions collected in the dataset (b). The leading phrase “Unlike the provided image, the ones I want” is omitted for brevity.

Collecting Relative Expressions

The desired annotation for relative captioning should be free-form and introduce minimum constraints on how a user might construct the feedback sentence. On the other hand, we want the collected feedback to be concise and relevant for retrieval and avoid casual and non-informative phrases (such as “thank you”, “oh, well”). Bearing the two goals in mind, we designed a data collection interface as shown in Figure 8, which provided the beginning phrase of the user’s response (“Unlike the provided ...”) and the annotators only needed to complete the sentence by giving an informative relative expression. This way, we can achieve a balance between sufficient lexical flexibility and avoiding irrelevant and casual phrases. After manual data cleaning, we are left with 10,751 relative expressions with one annotation per image pair.

Augmenting Dataset Using Direct Captions During our data collection procedure for relative expressions, we observed that when the target image and the reference image are visually distinct (fourth example in Figure 7(b)), users often don’t refer to the reference image. Instead, in this case they would directly describe the visual appearance of the target image. Inspired by this, we asked annotators to give direct descriptions on 3600 images without the use of reference images. We then paired each image in this set with five visually distinct reference images (selected using deep feature similarity). This data augmentation procedure further boosted the size of our dataset at a relatively low annotation cost. In total, our dataset contains 28,751 pairs of images with one relative expression per image pair.

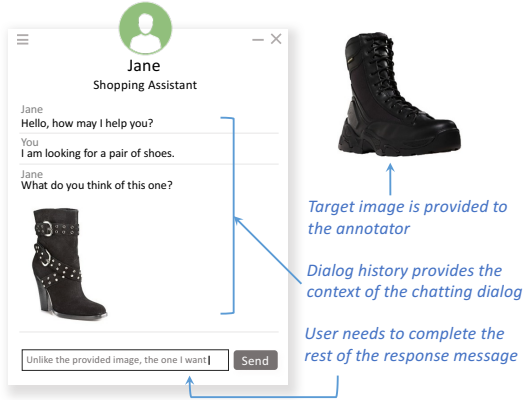

Figure 8: AMT annotation interface. Annotators need to assume the role of the customer and complete the rest of the response message. The collected captions are concise, and only contain phrases that are useful for image retrieval.



Figure 9: Visualization of the rich vocabulary discovered from the relative captioning dataset. The size of each rectangle is proportional to the word count of the corresponding word.

B Dataset analysis

Examples of the collected relative expressions are shown in Figure 7(b). We observed that, in some cases, users apply a concise phrase to describe the key visual difference (first example); but most often, users adopt more complicated phrases (second and third examples). The benefit of using free-form feedback can be seen in the second example: when the two shoes are exactly the same on most attributes (white color, flat heeled, clog shoes), the user resorts to using composition of a fine-grained visual attribute (“holes”) with spatial reference (“on the top”). Without free-form dialog based feedback, this intricate visual difference would be hard to convey.

Figure 7(a) shows the length distribution of the collected captions. Most captions are very concise (between 4 to 8 words), yet composing a large body of highly rich vocabularies as shown in Figure 9⁵. Interestingly, although annotators have the freedom to give feedback in terms of comparison on a single visual attribute (such as “is darker”, “is more formal”), most feedback expressions consist of compositions of multiple phrases that often include spatial or structural details (Table 1).

C Human Evaluation of Relative Captioning Results

We tested a variety of relative captioning models based on different choices of feature fusion and the use of attention mechanism. Specifically, we tested one *Show and Tell* [15] based model, **RC-FC** (using concatenated deep features as input), and three *Show, Attend and Tell* [53] based models, including **RC-FCA** (feature concatenation), **RC-LNA** (feature fusion using a linear layer) and **RC-CNA** (feature fusion using a convolutional layer). For all methods, we adopted the architecture of ResNet101 [49] pre-trained on ImageNet to extract deep feature representation.

Given the intrinsic flexibility in describing visual differences between two images, and the lack of comprehensive variations of human annotations for each pair of images, common image captioning metrics (such as BLEU) can not provide reliable evaluation of the actual quality of the generated captions. Therefore, to better evaluate the caption quality, we directly conducted human evaluation, following the same rating scheme used in [15]. We collected user ratings on relative captions generated by each model and those provided by humans on 1000 image pairs.

⁵A few common words are removed from this chart to save space, including “has/have”, “is/are”, “a”, “with”.

Single Phrase (36%)	Composition of Phrases (63%)	Propositional Phrases (40%)
are brownish	is more athletic and is white	is lower on the ankle and blue
have a zebra print	has a larger sole and is not a high top	have rhinestones across the toe and a strap
have a thick foot sheath	has lower heel and exposes more foot and toe	are brown with a side cut out
are low-top canvas sneakers	is white , and has high heels , not platforms	is in neutrals with buckled strap and flatter toe
have polka dot linings	is alligator , not snake print , and a pointy tip	is more rugged with textured sole

Table 1: Examples of relative expressions. Around two thirds of the collected expressions contain composite feedback on more than one types of visual feature. And 40% of the expressions contain propositional phrases that provides information containing spatial or structural details.

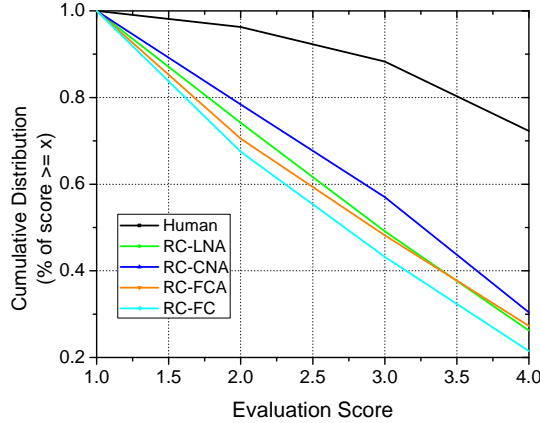

Figure 10: Ratings of relative captions provided by humans and different relative captioner models. The raters were asked to give a score from 1 to 4 on the quality of the captions: no errors (4), minor errors (3), somewhat related (2) and unrelated (1).

The results are summarized in Figure 10. Among all relative captioning models, **RC-CNA** achieves the best performance, indicating the benefit of CNN-based feature fusion and the use of attention. It is also noticeable that there is a gap between human provided descriptions and all automatically generated captions. This indicates the inherent complexity of task of relative image captioning and room for improvement of the user simulator, which will lead to more robust and generalizable dialog agents.

D More Results on User Study of the Dialog Manager

We provide more user interaction results in Figure 11. In all three interactions, the target image reached ranking within the top 100 images (about 97% in ranking percentile) after four turns. Close observation on the user feedback revealed that, visible improvement of retrieval results resulted from a mixed usage of direct reference, comparative feedbacks and composition of phrases. This further shows that free-form dialog feedback is able to capture different types of visual differences with great lexical flexibility and therefore leads potentially better retrieval results.

We would like to point out a few possible directions of improvement for the current framework. The first one being the system forgetting information from past turns in certain cases. For example, in the second example, the second turn imposed a “yellow accents” requirement to the target image. While this feedback is reflected in the immediate next turn, it is missing from the later turns of the dialog. We believe model architectures which can better incorporate the dialog history can help to alleviate this issue. Further, we observed that the system tends to be less responsive to certain low-frequency words (such as “slouchy” in the third example). Finally, an



Figure 11: Examples of users interacting with the proposed system for dialog-based interactive image retrieval.

interesting direction of future work is to finetune the system on real users so that it can directly adapt to the real users' behavior.